



Modular Building (Classroom)
Addendum #1 – Acknowledgement Required
Biloxi Public School District



BILOXI PUBLIC SCHOOL DISTRICT

**160 ST PETER STREET
BILOXI, MISSISSIPPI 39530
(228) 374-1810**

Modular Building (Classroom) Addendum #1 – Acknowledgement Required

This addendum is to provide clarification and to answer questions regarding specifications and information regarding our request for bid on Modular Buildings (Classrooms) released on July 10, 2023 and due on August 8, 2023 at 1:00 PM CDT. Acknowledgement of this addendum is required as part of submission of bid (see final page).

Prior to removal of existing buildings, the Biloxi Public School District will disconnect all utilities to existing buildings and will provide:

- Removal of decks, steps, ramps and awnings
- Removal of some skirting to access utilities
- Removal of mini split units
- Removal of chain link fence for access only

The Biloxi Public School District will provide:

- A site plan for permitting
- Installation of decks, steps, ramps and awnings
- Connection of fire alarm systems, intercom systems and IT
- All bath accessories and installation of such accessories (including grab bars, mirrors, toilet tissue, paper towel and soap dispensers)

Vendor/Contractor to provide:

- A full set of plans for permitting to be incorporated with site plans provided by the Biloxi Public School District
- Permitting for project (no fee charged by City)
- Removal of all remaining skirting on current buildings
- Preparation of site pad with a sandy/clay mix, crowned or sloped so that storm water will not flow or pond under building
- Pouring of strip footers with rebar under the length to support piers. Piers must be cement bonded and anchored per foundation plan.
- Connection of water, sewer and power

Building General Specifications

- 2021 IBC, 2023 NEC
- 150 MPH wind speed
- Perimeter frame
- Steel floor joists
- ¾" Sturd-I-floor plywood decking – option double 5/8"
- VCT floor with rubber base cove – option LVT with rubber base cove
- Solid core interior door with closer
- 2x6 exterior walls at 16" OC
- 2x4 interior walls at 16" OC
- Double top plate, single bottom plate
- 5/8" type X vinyl covered walls – option tape/mud/sand/prime/2 coats of paint (type determined by Biloxi Public School District)
- Optional: FRP wall covering in restroom
- Walls to roof decking
- 2X2 Ceiling grid
- LED light fixtures, including one in restroom
- Power for Smart Board
- J boxes for pull stations, alarm systems and intercom
- Wall hung HVAC with commercial room ventilation (fresh air intake)
- Metal gable roof with 4" overhangs or less to freight as a 14' wide
- Trusses at 16" OC
- ADA restroom with vitreous china toilet and sink and wall support for sink
- Full OSB sheathing and moisture wrap
- Hi rib steel siding and trim
- 36" X 60" IMPACT RATED vinyl windows, low E, with mini blinds
- (2) Steel doors in steel jamb with 4" x 24" view block, IMPACT RATED
- Steel skirting kit
- Fire extinguisher in semi recessed cabinet
- 8' Tackboard
- 8' Dry Erase Board

Frequently Asked Questions

- Are there any photos of existing units?

See attached photos after “Frequently Asked Questions” section.

- What is the anticipated start date and completion date of the project?

Once bid is awarded, the Biloxi Public School District will negotiate with the winning bidder as to the start and completion date of the project.

- Can the existing buildings be demolished onsite or must they be transported offsite for demolition? If offsite, are the axles, tires and hitches under the existing modulars?

The buildings cannot be demolished onsite due to the proximity of the playground and school potentially being in session. Demolition of buildings must be offsite. See attached photos of tires, tongues and axles after “Frequently Asked Questions” section.

- Who is responsible for demolishing the existing decks, steps, ramps and awnings?

The Biloxi Public School District will demolish existing decks, steps, ramps and awnings.

- Does the Biloxi Public School District have desired building specifications and floorplans for the new modulars?

See “Building General Specifications” included herein. A sample floorplan is also attached.

- Who is responsible for the following:

- Disconnecting all utilities from buildings to be demolished?
- Connecting utilities to new modular buildings?
- Providing new utilities to the new modular site for classrooms 7 & 8?

The Biloxi Public School District will disconnect all utilities from the existing buildings prior to removal. The winning bidder will connect utilities to the new modular buildings. In the event that a bid with classrooms 7 and 8 are awarded, the Biloxi Public School District will provide utilities to the new classroom sites.

- Is there a fire alarm or fire sprinklers systems in the existing modulars? If so, who is responsible for disconnecting and reconnecting?

What currently exists will be removed by the Biloxi Public School District. The BPSD will be responsible for replacing and connecting systems.

- Are there any speaker, PA or IT data systems in the existing modulars? If so, who is responsible for disconnecting and reconnecting?

Yes. The Biloxi Public School System will disconnect and reconnect any systems.

- Are there any site plans showing utilities and elevations?

No, there are no site plans showing utilities and elevations.

- Is there an existing soil report available for the current existing modular sites and the new site area?

No, there is not a soil report available.

- Are there below grade footers currently and will they be required for the new modulares?

There are no current footers on existing modulares but yes they will be required per Addendum #1.

- Are ABS pier pads acceptable?

No, they are not acceptable.

- Are whiteboards and/or tackboards required?

Yes, whiteboards and tackboards are required.

- Who is installing the new ramps, decks, steps and awnings?

The Biloxi Public School District will install the new ramps, decks, steps and awnings.

- What is the desired box size? 32' or 36'?

Either is acceptable.

BILOXI PUBLIC SCHOOL DISTRICT
MODULAR BUILDING BID
EXISTING PORTABLES





Sample Floorplan

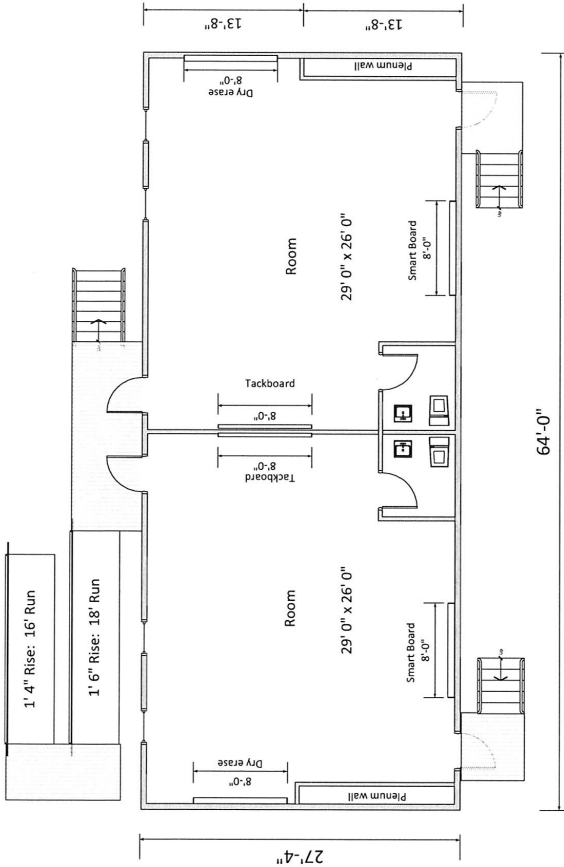

**Biloxi Public School District
Modular Building (Classroom)
Addendum #1
Acknowledge and Certification Form**

By signing below, I certify that:

- I have read and agree to adhere to the conditions and building specifications contained herein in Addendum #1
- I understand that I must submit this acknowledgement form with my sealed bid to the Biloxi Public School District by Tuesday, August 8, 2023 at 1:00 P.M. Bids and attachments should be submitted to:

Purchasing Department
Attn: Jennifer Gibson
160 St. Peter St.
Biloxi, MS 39530

Bids and attachments may also be submitted electronically through the website www.centralauctionhouse.com.

My signature certifies that, as agent for:

Company/Firm Name

Signature

Date