

SPECIFICATIONS FOR NEW 6 CLASSROOM MODULAR W/ RESTROOMS
LOCATED 424 MARTIN LUTHER KING DRIVE PURVIS, MS 39475
NEW 2 CLASSROOM MODULAR W/ RESTROOMS
LOCATED 198 TODD ROAD SUMRALL, MS 39482

PART 1 - GENERAL

1.1 SUMMARY FOR 6 CLASSROOM W/ RESTROOM

1. Lamar County School District is asking for pricing to Purchase a new 6 classroom unit with boys, girls and family restrooms and janitors closet approximately 96 X 64 in size. Pricing to include purchase of unit, delivery, freight, block and level, tie downs, underpin and aluminum ramps with labor to install all aspects.
 - a. Provide proof of liability insurance
 - b. The specific geographical region and occupancy of the building may require a variance of these specifications
 - c. Separation of freight, labor and cost of building must be separated on quote given.
 - d. Preferable Layout at end of document (#1)

1.1 Construction type:

Wood

A. Floor:

1. 12" Outrigger Frame w/Cross Members
2. Bottom: 1 Mil Cross-woven polypropylene fabric under flooring
3. Frame Insulation: (thickness per code)
4. Joists: 2 X 8 @ 16' o/c
5. Decking: Single Layer 3/4 inch T&G Plywood Underlayment
6. Finish: 1/8"LVT No wax Vinyl tile.

B. Exterior and interior Walls:

1. Studs: 2 X 4 #2 @ 16" o/c with top and bottom plate
2. Interior: 1/2 "gypsum
3. Insulation: Thickness (per code)
4. Covering: Vinyl covered wall paper applied to gypsum
5. Structural Sheathing: 7/16 OSB
6. Moisture Sheathing: Building wrap
7. Exterior Siding: Aluminum .019 Textured Panels
8. Base: 4" Vinyl Base throughout
9. Corners & battens: Vinyl covered
10. Ceiling: 2 X 2 Suspended ceiling with wall angle for T-grid ceiling

D. Roof:

1. Mate Line: (1) Layer 1-1/2", 2.0 LVL
2. Rafters: 2 X 8 or 2 X 10 Roof rafters @ 16" o/c
3. Insulation: Un-faced (thickness per code)
4. Sheathing: 7/16 OSB plus manufactures requirements for roofing material.
5. Roofing: .060 TPO (white). Provide minimum 15 year warranty
6. Gutters: Aluminum full length with downspouts

E. Windows:

1. Type: 3/0 X 5/0 White Vinyl framed single hung w/ Fiberglass insect screens
2. Glazing: "Low E" double insulated glass
3. Trim: Vinyl covered wood return and casing
4. Blinds: 1" Vinyl mini blinds

F. Ramps:

1. ADA compliant at each exit doors and to match door size egress.

G. Interior doors:

1. Size / Type: 3/0 X 6/8 Solid core pre-finished wood grain
2. Frame: Steel painted jam
3. Hinges and door Trim: Standard
4. Lever locks: Classroom function

H. Exterior Doors:

1. Size / Type: Pair 3/0 X 6/8 Pre-hung 20 ga Commercial w/18 ga frame
2. Hinges: Standard
3. Trim: Brushed aluminum
4. Closer: Grade 2
5. Panic: Grade 2
6. Lever: Graded 2

J. Restroom Accessories:

1. TP holder, soap dispenser, Paper towel holders are not part of this package.

2. Mirror: 18 X 30 Framed mirror
3. Grab Bar: Stainless steel and size per accessibility code.
4. Partitions: HDPE solid plastic with continuous panel brackets.

K. Mechanical, Electric, Plumbing:

HVAC

1. Wall mount unit: Electric 36,000 BTU (3 ton) with green refrigerant R-410A
2. Supply/ Return: F/G in ceiling w/ 24 X 24 adjustable diffusers
3. Thermostat: 7-day Programmable heat/ cool
4. Exhaust: 150 cfm exhaust fan

L. Plumbing:

1. Supply: PEX pipe and fitting. Final connections by others.
2. Waste: Schedule 40 PVC and fitting. Final connections by others.
3. Lavatory: ADA Accessible wall hung china
4. Faucet: Single control with extra-long lever handle
5. Toilet: Low Consumption Elongated bowl ADA compliant
6. Urinal: Low Consumption China
7. Water Cooler: Wall mounted bi-level cooler
8. Water heater: electric compact heater mounted above mop sink in Janitors closet. Provide drain pan under heater to mop sink below
9. Mop sink: floor mounted with mop holders.

M. Electrical:

1. Panel: Each Module to have (1) single phase 100-150 amp sub panel. Final power connections by others.
2. Lights: 2 X 4 LED lay in fixtures
3. Raceway: Romex/ MC cable Per NEC (12 AWG minimum)
4. Receptacles: 120V/ 15A duplex "white" with GFI near plumbing
5. Switch: 120V 15A "white" toggle

6. Exit / Light: Rust proof Vandal-Resistant wall/ceiling Luminaire
7. Emergency: Dual Head exit/emergency light with 90 minute battery back-up
8. Voice / Data / Security: Locations w/single gang boxes and 1/2 flexible conduit to above ceiling. 4 drops per classroom. Locations TBD. Provide PVC 1-1/2 race way from underneath of trailer to above ceiling at each rear classroom.

PART 2 - GENERAL

2.1 SUMMARY FOR 2 CLASSROOM W/ RESTROOMS

2. Lamar County School District is asking for pricing to Purchase a new 2 classroom unit w/ restrooms approximately 24 X 64 in size.

- a. Provide proof of liability insurance
- a. The specific geographical region and occupancy of the building may require a variance of these specifications
- b. Separation of freight, labor and cost of building must be separated on quote given.
- c. Preferable Layout at end of document (#2)
- d. Unit will need to be set at approximately 4 -5 ft. floor level height. (High set) To match existing units.

1.1 Construction type:

Wood

A. Floor:

1. 12" Outrigger Frame w/Cross Members
2. Bottom: 1 Mil Cross-woven polypropylene fabric under flooring
3. Frame Insulation: (thickness per code)
4. Joists: 2 X 8 @ 16' o/c
5. Decking: Single Layer 3/4 inch T&G Plywood Underlayment
6. Finish: 1/8" LVT No wax Vinyl tile.

B. Exterior and interior Walls:

1. Studs: 2 X 4 #2 @ 16" o/c with top and bottom plate
2. Interior: 1/2 "gypsum
3. Insulation: Thickness (per code)
4. Covering: Vinyl covered wall paper applied to gypsum
5. Structural Sheathing: 7/16 OSB
6. Moisture Sheathing: Building wrap
7. Exterior Siding: Aluminum .019 Textured Panels
8. Base: 4" Vinyl Base throughout

10. Ceiling: 2 X 2 Suspended ceiling with wall angle for T-grid ceiling

D. Roof:

1. Mate Line: (1) Layer 1-1/2", 2.0 LVL
2. Rafters: 2 X 8 Roof rafters @ 24" o/c
3. Insulation: Un-faced (thickness per code)
4. Sheathing: 7/16 OSB plus manufactures requirements for roofing material.
5. Roofing: .060 TPO (white) with minimum 15 yr. Warranty
Optional roof: 24 ga metal w/ ridge cap
6. Gutters: None

E. Windows:

1. Type: 3/0 X 5/0 White Vinyl framed single hung w/ Fiberglass insect screens
2. Glazing: "Low E" double insulated glass
3. Trim: Vinyl covered wood return and casing
4. Blinds: 1" Vinyl mini blinds

F. Ramps:

1. Not part of this package

G. Interior doors:

1. Size / Type: 3/0 X 6/8 Hollow core pre-finished wood grain
2. Frame: Pre-finished wood
3. Hinges and door Trim: Standard
4. Lever locks: restroom function

H. Exterior Doors:

1. Size / Type: 3/0 X 6/8 Pre-hung 20 ga Commercial w/18 ga frame
2. Hinges: Standard
3. Trim: Brushed aluminum
4. Closer: Grade 2
5. Lever: Classroom function

J. Restroom Accessories:

1. TP holder, soap dispenser, Paper towel holders are not part of this package.

2. Mirror: 18 X 30 Framed mirror
3. Grab Bar: Stainless steel and size per accessibility code

2.0. Mechanical, Electric, Plumbing:

A. HVAC

1. Wall mount unit: Electric 36,000 BTU (3 ton) with green refrigerant R-410A
2. Supply/ Return: F/G in ceiling w/ 24 X 24 adjustable diffusers
3. Thermostat: 7-day Programmable heat/ cool
4. Exhaust: 60 cfm minimum exhaust fan

B. Plumbing:

1. Supply: PEX pipe and fitting. Final connections by others.
2. Waste: Schedule 40 PVC and fitting. Final connections by others.
3. Lavatory: ADA Accessible wall hung china
4. Faucet: Single control with extra-long lever handle
5. Toilet: Low Consumption Elongated bowl ADA compliant
6. Water heater: electric inline water heater installed under each lavatory

C. Electrical:

1. Panel: Each Module to have (1) single phase 100-150 amp sub panel. Final power connections by others.
2. Lights: 2 X 4 LED lay in fixtures
3. Raceway: Romex/ MC cable Per NEC (12 AWG minimum)
4. Receptacles: 120V/ 15A duplex "white" with GFI near plumbing
5. Switch: 120V 15A "white" toggle
6. Exit / Light: Rust proof Vandal-Resistant wall/ceiling Luminaire
7. Emergency: Dual Head exit/emergency light with 90 minute battery back-up
8. Voice / Data / Security: Locations w/single gang boxes and 1/2 flexible conduit to above ceiling. 4 drops per classroom. Locations TBD. Provide PVC 1-1/2 race way from underneath of trailer to above ceiling.



#2

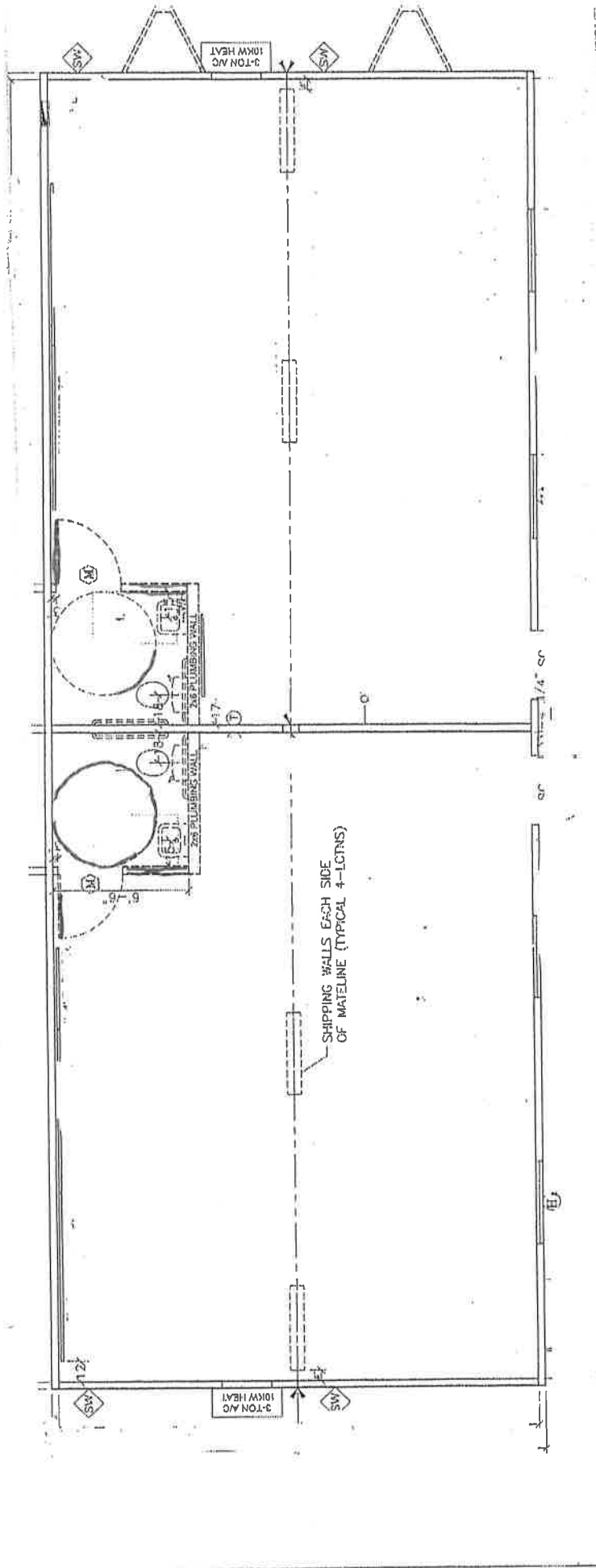



LAMAR COUNTY
School District

Purvis / Sumrall Classrooms w/Restroom Bid Info

Vendor Name	Contact Phone	Email	Estimated delivery

Modular Cost	Delivery	Labor (set-up, anchor)	Total Price