



Prices effective February 5, 2018

Exclave®

Introduction	page 2
Exclave®	3
Tables	5
Rail & Inserts	12
Media Tile	13
Stowage	14
Boards	17
Carts	22
Accessories	24
Indices	31
By Name	31
By Number	33
Appendices	
20-Day or Less/Assigned Lead-Time Order Information	
Stain-to-Match Program	
Proprietary Textiles Application Chart-Workspaces	
Proprietary Textile Colors-Workspaces	
For the latest materials information, refer to the Materials pages on HermanMiller.com.	

Introduction

A Note on the Organization of This Book

There are a few signals that will help you understand the organization of this book. Once you know them, you should be able to find your way around easily.

Like a newspaper, this book is formatted with columns of text and illustrations that run vertically.

Information wraps from one column to the next and continues for as many pages as it needs to.

Black bars are clues.

A black bar at the top of a page signals the start of information about a product.

This information is divided into two sections, each signaled by a black bar. Product Information includes a description, additional notes, and dimensional drawings. Specification Information, which always begins at the top of a column, includes a series of steps. Each step represents a decision you need to make in order to complete your product number. Steps must be followed sequentially. The number of pages needed to complete information on a product varies; some will be complete in one page; others may fill three or four pages. Just continue going through the steps until you run into the next product, signaled by the black bar at the top of the page.

Black tabs running along the outside edge of the page help you locate what section you are in or what section you want to go to. You can thumb forwards or backwards to find a section; tabs and text appear on both sides of the page.

The additional pages in the back of the book include the appendices and indices. They are signaled by a long black bar running along the outside edge of the page.

The index is presented two ways.

The first index is in alphabetical order by product name. It can be helpful if you are new to the products and numbering scheme or if you are looking for a type of product, such as work chair or round table. The second index is by product number. It lists, in alphanumeric order, the base product number, typically a five-digit number.

General Information

This book is effective February 5, 2018, subject to change without notice. Products may be purchased from authorized Herman Miller dealers who will quote prices upon request. For more information about our products and services or to see a list of dealers, visit www.HermanMiller.com.

All prices are list prices. Additional services, such as planning services, design, storage, and installation, are not included and must be added to these prices when the additional services are requested.

Illustrations, specifications, and prices are based on the latest information at the time of publication. The right is reserved to make changes at any time without notice in prices, fabrics, finishes, materials, specifications, and models, and also to discontinue models and finishes.

Dimensions shown in the drawings are engineering drawing dimensions rounded up to the nearest 1/8". Product is shipped set up or knocked down. Products that include "Shipped knocked down" in the description require some assembly. If this statement does not appear in the description, the product is shipped assembled.

Service problems are normally handled by a Herman Miller authorized dealer. Where this cannot be accomplished on a local level, service problems should be referred to the Customer Care Representative for your region, Herman Miller, Inc., Zeeland, Michigan 49464.

20-Day or Less/Assigned Lead-Time Shipments

All products and options in this price book not designated by an Assigned Program icon  will ship in **20 business days or less** after being acknowledged by Herman Miller.

Products and options designated by an  are on the assigned lead-time program and may ship in 20 days, less than 20 days, or more than 20 days from order acknowledgement.

Tables

Rail & Inserts

Media Tile

Stowage

Boards

Carts

Accessories



Tear Drop Table

EXTD.

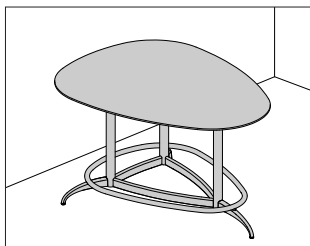

Product Information

Description

The tear drop table shape enables clear visibility of content and participants, both local and remote. It is available in 4 sizes and 2 heights, 29" and 39", to support varied work activities. Tables 39" high and 72" wide and wider are available with or without a foot rest for better ergonomics while standing. Table is available with or without an electrical cutout. Electrical accessories ordered separately. Shipped knocked down.

Notes

Actual table dimensions:

Table—Dimensions

042—42"W×44"D

072—71"W×53⁴/₅"D

096—94⁴/₅"W×55"D

114—114⁴/₅"W×81¹/₂"D

Available only with thin edge.

Foot rest finish is stainless.

Order the following products separately. Refer to Exclave® Planning Guide and Thrive® Portfolio price book for additional details:

- For 4' table (042), order Logic mini electrical distributor (Y1414.)
- For 6' table (072), 8' table (096), and 9¹/₂' table (114), order 6 wide G1000 grommet mounted electrical distributor (Y1425.D or Y1425.G)
- Logic HD cable manager (Y1424.)
- Umbilical riser (Y1430.); order riser height to match table height

Video conference friendly finishes are provided for guidance only.

Customer lighting, color palette, video conferencing equipment, and other non-Exclave specified furnishings and tools may affect experience.

Dimensions

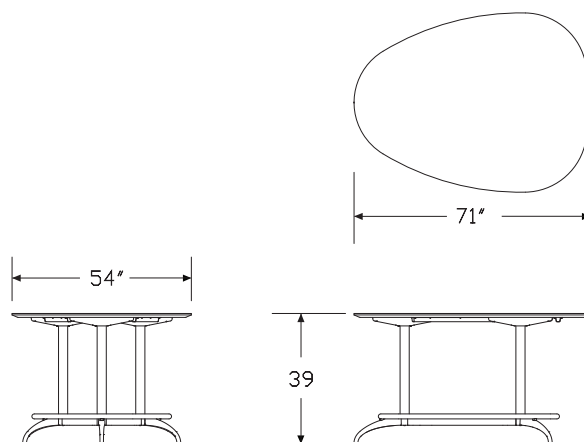
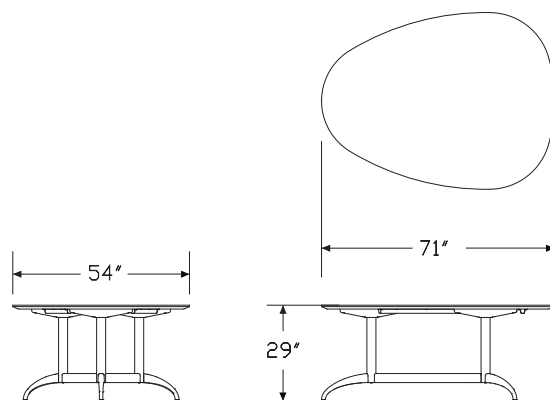

Tear Drop Table *continued*

Specification Information							
Step 1.							
EXTD.							
Step 2. Edge							
T	thin-edge						
Step 3. Height							
29	29" high						
39	39" high						
Step 4. Width/Depth							
042	42" wide x 44" deep						
072	72" wide x 54" deep						
096	96" wide x 54" deep						
114	114" wide x 82" deep						
Step 5. Foot Rest							
For 29" high (29) with 42" wide x 44" deep (042), 72" wide x 54" deep (072), 96" wide x 54" deep (096), or 114" wide x 82" deep (114)							
N	no foot rest						
For 39" high (39) with 42" wide x 44" deep (042)							
N	no foot rest						
For 39" high (39) with 72" wide x 54" deep (072), 96" wide x 54" deep (096), or 114" wide x 82" deep (114)							
N	no foot rest						
F	foot rest						
Step 6. Electrical Cutout Type							
N	no cutout						
C	cutout						
Step 7. Surface Material							
L	laminate						
T	formcoat®						
W	veneer						
Prices for Steps 1-7.							
		042NNL	042NNT	042NNW	042NCL	042NCT	042NCW
EXTD.	T 29	\$2308	2308	2727	2308	2308	2844
	39	\$3463	3463	3882	3463	3463	3998

		072NNL	072NNT	072NNW	072NCL	072NCT	072NCW
EXTD.	T 29	\$4907	4907	5584	4907	4907	5700
	39	\$7952	7952	8554	7952	7952	8657
		072FNL	072FNT	072FNW	072FCL	072FCT	072FCW
EXTD.	T 39	\$8947	8947	9624	8947	8947	9740
		096NNL	096NNT	096NNW	096NCL	096NCT	096NCW
EXTD.	T 29	\$5773	5773	7124	5773	5773	7240
	39	\$8723	8723	9923	8723	8723	10027
		096FNL	096FNT	096FNW	096FCL	096FCT	096FCW
EXTD.	T 39	\$9813	9813	11164	9813	9813	11280
		114NNL	114NNT	114NNW	114NCL	114NCT	114NCW
EXTD.	T 29	\$6348	6348	7720	6348	6348	7836
	39	\$9234	9234	10453	9234	9234	10556
		114FNL	114FNT	114FNW	114FCL	114FCT	114FCW
EXTD.	T 39	\$10388	10388	11760	10388	10388	11876
Step 8. Video Conferencing Friendly Finishes							
VCN	all finishes						+\$0
VCY	video conferencing friendly finishes						+\$0

Step 9. Table Top Finish

For laminate (L) with all finishes (VCN)

8Q	folkstone grey	+\$0
91	white	+\$0
98	studio white	+\$0
CL	cool grey neutral	+\$0
HF	inner tone light	+\$0
HT	inner tone	+\$0
LU	soft white	+\$0
WL	sandstone	+\$0
WN	warm grey neutral	+\$0
76	light brown walnut	+\$0
HM	natural maple	+\$0
HP	light anigre	+\$0
HX	aged cherry	+\$0
HY	walnut on cherry	+\$0
LA	light ash	+\$0
LBA	clear on ash	+\$0
LBB	oak on ash	+\$0
LBC	walnut on ash	+\$0
LBD	dark brown walnut	+\$0
LBE	medium red walnut	+\$0
LBF	neutral twill	+\$0
LBG	sarum twill	+\$0
LBH	earthen twill	+\$0
LBJ	graphite twill	+\$0
LBQ	white twill	+\$0
LBK	pewter mesh	+\$0
LBL	steel mesh	+\$0
LBM	crisp linen	+\$0
LBN	classic linen	+\$0
LBP	casual linen	+\$0

Solid-Color Laminate

For laminate (L) with video conferencing friendly finishes (VCY)

8Q	folkstone grey	+\$0
WL	sandstone	+\$0

Linen Laminate

For laminate (L) with video conferencing friendly finishes (VCY)

LBN	classic linen	+\$0
LBP	casual linen	+\$0

Mesh Laminate

For laminate (L) with video conferencing friendly finishes (VCY)

LBK	pewter mesh	+\$0
LBL	steel mesh	+\$0

Twill Laminate

For laminate (L) with video conferencing friendly finishes (VCY)

LBF	neutral twill	+\$0
LBG	sarum twill	+\$0
LBH	earthen twill	+\$0

Wood-Grain Laminate

For laminate (L) with video conferencing friendly finishes (VCY)

LBA	clear on ash	+\$0
LBB	oak on ash	+\$0
LBC	walnut on ash	+\$0

For formcoat® (T) with all finishes (VCN)

8Q	folkstone grey	+\$0
91	white	+\$0
WL	sandstone	+\$0

For formcoat® (T) with video conferencing friendly finishes (VCY)

8Q	folkstone grey	+\$0
WL	sandstone	+\$0

For veneer (W) with all finishes (VCN), or video conferencing friendly finishes (VCY)

ET	clear on ash	+\$0
EU	oak on ash	+\$0
EV	walnut on ash	+\$0

Tear Drop Table *continued*

Exclave® Tables

Step 10. Edge Finish		
<i>For laminate (L) with all finishes (VCN)</i>		
76	light brown walnut	+\$0
8Q	folkstone grey	+\$0
91	white	+\$0
98	studio white	+\$0
CL	cool grey neutral	+\$0
LA	light ash	+\$0
LBA	clear on ash	+\$0
LBB	oak on ash	+\$0
LBC	walnut on ash	+\$0
LBD	dark brown walnut	+\$0
LBE	medium red walnut	+\$0
LBF	neutral twill	+\$0
LBG	sarum twill	+\$0
LBH	earthen twill	+\$0
LBJ	graphite twill	+\$0
LBK	pewter mesh	+\$0
LBL	steel mesh	+\$0
LBM	crisp linen	+\$0
LBN	classic linen	+\$0
LBP	casual linen	+\$0
LBQ	white twill	+\$0
WL	sandstone	+\$0
WN	warm grey neutral	+\$0
HF	inner tone light	+\$0
HM	natural maple	+\$0
HP	light anigre	+\$0
HT	inner tone	+\$0
HX	aged cherry	+\$0
HY	walnut on cherry	+\$0
LU	soft white	+\$0

Step 11. Column/Leg Finish		
8Q	folkstone grey	+\$0
91	white	+\$0
G1	graphite	+\$0

Step 12. Grommet Selection		
<i>For 42" wide x 44" deep (042) with cutout (C) with laminate (L) with all finishes (VCN)</i>		
91	white	+\$0
G1	graphite	+\$0

Guitar Pick Table

EXTT.

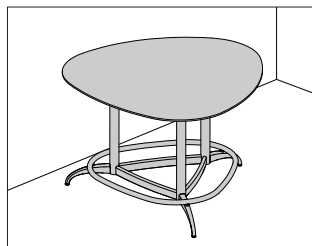

Product Information

Description

The guitar pick table shape enables clear visibility of content and participants, both local and remote. It is available in 2 sizes and 2 heights, 29" and 39", to support varied work activities. Tables 39" high are available with or without a foot rest for better ergonomics while standing. Table is available with or without an electrical cutout. Electrical accessories ordered separately. Shipped knocked down.

Notes

Actual table dimensions:

Table—Dimensions

o60—59¹/₅"W×60¹/₂"D

o84—81¹/₅"W×82¹/₅"D

Available only with thin edge.

Foot rest finish is stainless.

Order the following products separately. Refer to Exclave® Planning Guide and Thrive® Portfolio price book for additional details:

- For 5' table (o60), order 5 wide G1000 grommet mounted electrical distributor (Y1425.C or Y1425.F)
- For 7' table (o84), order 6 wide G1000 grommet mounted electrical distributor (Y1425.D or Y1425.G)
- Logic HD cable manager (Y1424.)
- Umbilical riser (Y1430.); order riser height to match table height

Video conference friendly finishes are provided for guidance only.

Customer lighting, color palette, video conferencing equipment, and other non-Exclave specified furnishings and tools may affect experience.

Dimensions

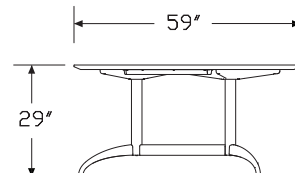
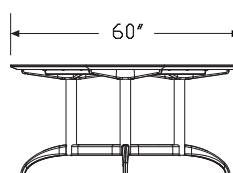
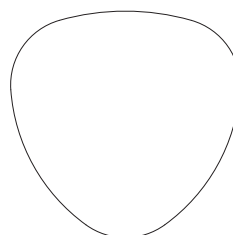
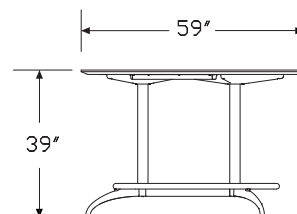
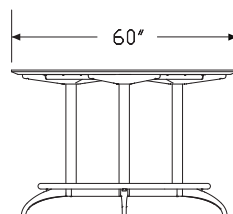
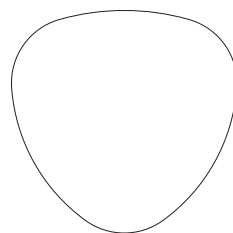

Specification Information								
Step 1.								
EXTT.								
Step 2. Edge								
T	thin-edge							
Step 3. Height								
29	29" high							
39	39" high							
Step 4. Width/Depth								
060	60" wide x 60" deep							
084	84" wide x 84" deep							
Step 5. Foot Rest								
For 29" high (29)								
N	no foot rest							
For 39" high (39)								
N	no foot rest							
F	foot rest							
Step 6. Electrical Cutout Type								
N	no cutout							
C	cutout							
Step 7. Surface Material								
L	laminate							
T	formcoat®							
W	veneer							
Prices for Steps 1-7.								
		060NNL	060NNT	060NNW	060NCL	060NCT	060NCW	
EXTT.	T	29	\$3609	3609	4167	3609	3609	4283
		39	\$6799	6799	7295	6799	6799	7398
		060FNL	060FNT	060FNW	060FCL	060FCT	060FCW	
EXTT.	T	39	\$7649	7649	8207	7649	7649	8323
		084NNL	084NNT	084NNW	084NCL	084NCT	084NCW	
EXTT.	T	29	\$5195	5195	6510	5195	5195	6626
		39	\$8209	8209	9377	8209	8209	9481
		084FNL	084FNT	084FNW	084FCL	084FCT	084FCW	
EXTT.	T	39	\$9235	9235	10550	9235	9235	10666

Step 8. Video Conferencing Friendly Finishes		
VCN	all finishes	+\$0
VCY	video conferencing friendly finishes	+\$0

Step 9. Table Top Finish		
<i>For laminate (L) with all finishes (VCN)</i>		
8Q	folkstone grey	+\$0
91	white	+\$0
98	studio white	+\$0
CL	cool grey neutral	+\$0
HF	inner tone light	+\$0
HT	inner tone	+\$0
LU	soft white	+\$0
WL	sandstone	+\$0
WN	warm grey neutral	+\$0
76	light brown walnut	+\$0
HM	natural maple	+\$0
HP	light anigre	+\$0
HX	aged cherry	+\$0
HY	walnut on cherry	+\$0
LA	light ash	+\$0
LBA	clear on ash	+\$0
LBB	oak on ash	+\$0
LBC	walnut on ash	+\$0
LBD	dark brown walnut	+\$0
LBE	medium red walnut	+\$0
LBF	neutral twill	+\$0
LBG	sarum twill	+\$0
LBH	earthen twill	+\$0
LBJ	graphite twill	+\$0
LBQ	white twill	+\$0
LBK	pewter mesh	+\$0
LBL	steel mesh	+\$0
LBM	crisp linen	+\$0
LBN	classic linen	+\$0
LBP	casual linen	+\$0

Solid-Color Laminate		
<i>For laminate (L) with video conferencing friendly finishes (VCY)</i>		
8Q	folkstone grey	+\$0
WL	sandstone	+\$0
Linen Laminate		
<i>For laminate (L) with video conferencing friendly finishes (VCY)</i>		
LBN	classic linen	+\$0
LBP	casual linen	+\$0

Mesh Laminate

For laminate (L) with video conferencing friendly finishes (VCY)

LBK	pewter mesh	+\$0
LBL	steel mesh	+\$0

Twill Laminate

For laminate (L) with video conferencing friendly finishes (VCY)

LBF	neutral twill	+\$0
LBG	sarum twill	+\$0
LBH	earthen twill	+\$0

Wood-Grain Laminate

For laminate (L) with video conferencing friendly finishes (VCY)

LBA	clear on ash	+\$0
LBB	oak on ash	+\$0
LBC	walnut on ash	+\$0

For formcoat® (T) with all finishes (VCN)

8Q	folkstone grey	+\$0
91	white	+\$0
WL	sandstone	+\$0

For formcoat® (T) with video conferencing friendly finishes (VCY)

8Q	folkstone grey	+\$0
WL	sandstone	+\$0

For veneer (W) with all finishes (VCN), or video conferencing friendly finishes (VCY)

ET	clear on ash	+\$0
EU	oak on ash	+\$0
EV	walnut on ash	+\$0

Step 10. Edge Finish

For laminate (L) with all finishes (VCN)

76	light brown walnut	+\$0
8Q	folkstone grey	+\$0
91	white	+\$0
98	studio white	+\$0
CL	cool grey neutral	+\$0
LA	light ash	+\$0
LBA	clear on ash	+\$0
LBB	oak on ash	+\$0
LBC	walnut on ash	+\$0
LBD	dark brown walnut	+\$0
LBE	medium red walnut	+\$0
LBF	neutral twill	+\$0
LBG	sarum twill	+\$0
LBH	earthen twill	+\$0
LBJ	graphite twill	+\$0
LBK	pewter mesh	+\$0
LBL	steel mesh	+\$0
LBM	crisp linen	+\$0
LBN	classic linen	+\$0
LBP	casual linen	+\$0
LBQ	white twill	+\$0
WL	sandstone	+\$0
WN	warm grey neutral	+\$0
HF	inner tone light	+\$0
HM	natural maple	+\$0
HP	light anigre	+\$0
HT	inner tone	+\$0
HX	aged cherry	+\$0
HY	walnut on cherry	+\$0
LU	soft white	+\$0

Step 11. Column/Leg Finish

8Q	folkstone grey	+\$0
91	white	+\$0
G1	graphite	+\$0

Wall Rails

EXRL.

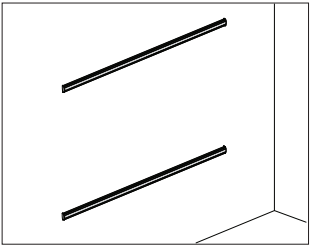

Product Information

Description

This set of top and bottom rails attaches to architectural walls to support Exclave® components. Rails attach directly to 5/8" thick or thicker drywall using included wall anchors; wall stud attachment is not required. Rails come with inserts to finish the rail fronts and conceal mounting screws. Rails and inserts can be field cut to length.

Notes

Actual rail lengths are 49" (48) and 97" (96).

Order wall rail end caps (EXREC.) separately.

Anodized (AN) rails will come with folkstone grey (8Q) inserts.

White (91) rails will come with white (91) inserts.

Graphite (G1) rails will come with graphite (G1) inserts.

Dimensions

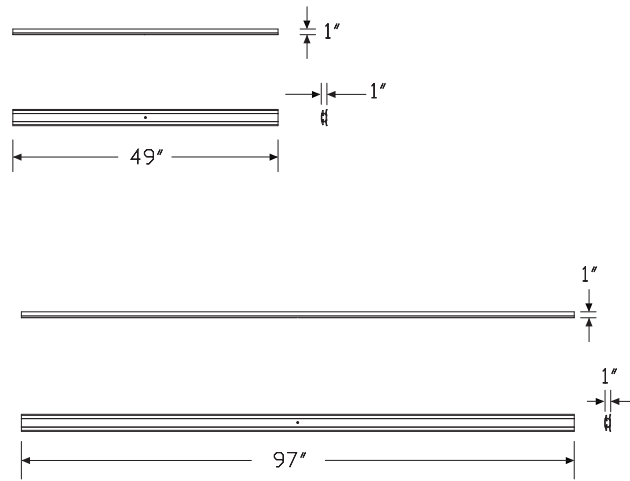

Specification Information

Step 1.		
EXRL.		
Step 2. Width of Rails (sets of 2)		
48	48" wide	
96	96" wide	
Prices for Steps 1-2.		
EXRL.	48	\$396
	96	\$612
Step 3. Rail Color		
91	white	+\$0
AN	anodized	+\$0
G1	graphite	+\$0

Media Tile

EXMT.

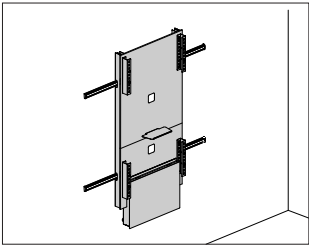

Product Information
Description
This media tile supports digital media equipment within meeting spaces. It holds single or dual TV screens and comes with 1 or 2 screen mounting brackets, a camera shelf, and technology box mounted below the tile. A speaker bar mount is optional.
Notes
Media tile hangs on Exclave® wall rails (EXRL.).
TV screen mounting brackets accommodate screen widths of 42" to 70".
Camera shelf finish will match specified panel finish.
Technology box accommodates 2RU of componentry. Finish will match specified panel finish.
Dimensions

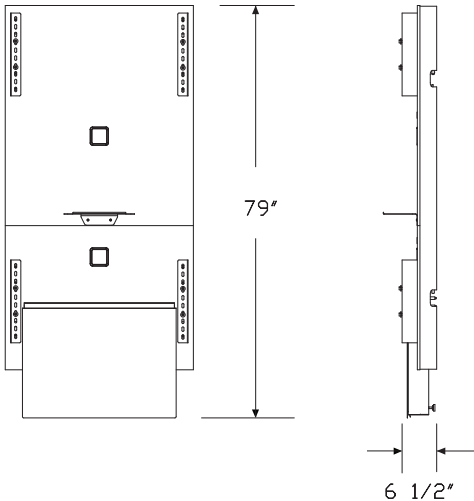
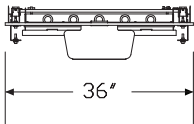

Specification Information				
Step 1.				
EXMT.				
Step 2. Material				
L	laminate			
Step 3. Technology Integration				
1	one screen set-up			
2	two screen set-up			
Step 4. Speaker Bar Mount				
1	no speaker bar mount			
2	with speaker bar mount			
Step 5. Technology Box				
Y	with technology box			
Prices for Steps 1-5.				
			1Y	2Y
EXMT.	L	1	\$5292	5474
		2	\$6484	6666
Step 6. Panel Finish				
91	white			+\$0
G1	graphite			+\$0
Step 7. Side Trim Finish				
91	white			+\$0
G1	graphite			+\$0

Exclave® Media Tile

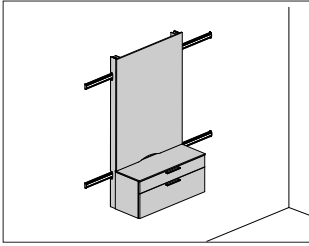

Product Information

Description

This 2-drawer stowage unit hangs on Exclave® wall rails. It is available with a laminate case and front, laminate case with veneer front, or veneer case and front. Drawers have bar pulls and full-extension ball-bearing slides. Comes with a whiteboard or tackable fabric backdrop.

Notes

Actual stowage unit depth is 11".

Specify backdrop tackable fabric to match fabric selection on other Exclave boards with tackable fabric option (EXSB.T or EXLB.T), ordered separately.

Video conference friendly finishes are provided for guidance only. Customer lighting, color palette, video conferencing equipment, and other non-Exclave specified furnishings and tools may affect experience.

Dimensions

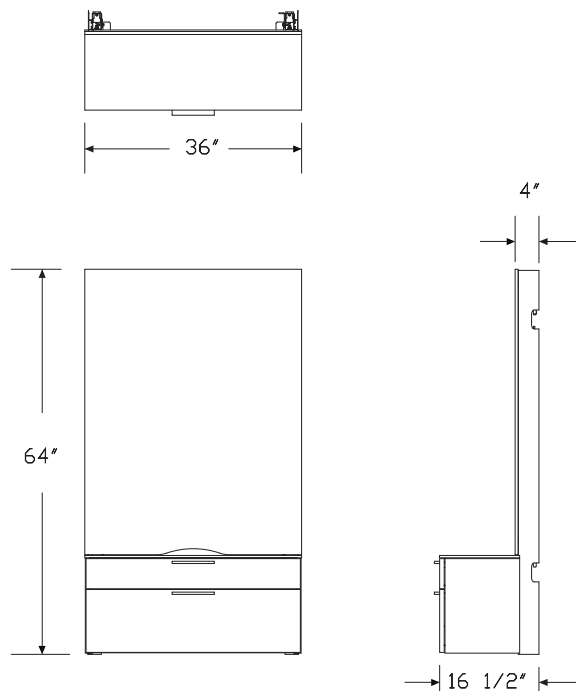

Specification Information

Step 1.

EXSTW.

Step 2. Pull Type

K bar pull

Step 3. Width

36 36" wide

Step 4. Depth

12 12" deep

Step 5. Configuration

A box 5" H / box 10" H

Step 6. Case/Front Material

L laminate case/front

C laminate case/veneer front

W veneer case/front

Step 7. Board Back Drop

T tackable fabric

W whiteboard

Prices for Steps 1-7.

		12ALT	12ALW	12ACT	12ACW	12AWT	12AWW
EXSTW.K	36	\$2245	2327	2582	2663	3452	3532

Step 8. Side Trim Finish

91 white +\$0

G1 graphite +\$0

Step 9. Video Conferencing Friendly Finishes

VCN all finishes +\$0

VCY video conferencing friendly finishes +\$0

Step 10. Case Finish

Solid-Color Laminate

For laminate case/front (L) or laminate case/veneer front (C) with all finishes (VCN)

8Q	folkstone grey	+\$0
91	white	+\$0
98	studio white	+\$0
CL	cool grey neutral	+\$0
G1	graphite	+\$0
HF	inner tone light	+\$0
LU	soft white	+\$0
WL	sandstone	+\$0
WN	warm grey neutral	+\$0
X1	chalk white	+\$0

Wood-Grain Laminate

For laminate case/front (L) or laminate case/veneer front (C) with all finishes (VCN)

76	light brown walnut	+\$0
LA	light ash	+\$0
LBA	clear on ash	+\$0
LBB	oak on ash	+\$0
LBC	walnut on ash	+\$0
LBD	dark brown walnut	+\$0
LBE	medium red walnut	+\$0
HM	natural maple	+\$0
HP	light anigre	+\$0
HX	aged cherry	+\$0
HY	walnut on cherry	+\$0

Solid-Color Laminate

For laminate case/front (L) or laminate case/veneer front (C) with video conferencing friendly finishes (VCY)

8Q	folkstone grey	+\$0
WL	sandstone	+\$0

Wood-Grain Laminate

For laminate case/front (L) or laminate case/veneer front (C) with video conferencing friendly finishes (VCY)

LBA	clear on ash	+\$0
LBB	oak on ash	+\$0
LBC	walnut on ash	+\$0

For veneer case/front (W) with all finishes (VCN), or video conferencing friendly finishes (VCY)

ET	clear on ash	+\$0
EU	oak on ash	+\$0
EV	walnut on ash	+\$0

Step 11. Front Finish

For laminate case/front (L) with all finishes (VCN)

8Q	folkstone grey	+\$0
91	white	+\$0
98	studio white	+\$0
CL	cool grey neutral	+\$0
G1	graphite	+\$0
HF	inner tone light	+\$0
LU	soft white	+\$0
WL	sandstone	+\$0
WN	warm grey neutral	+\$0
X1	chalk white	+\$0

Linen Laminate

For laminate case/front (L) with all finishes (VCN)

LBM	crisp linen	+\$0
LBN	classic linen	+\$0
LBP	casual linen	+\$0

Mesh Laminate

For laminate case/front (L) with all finishes (VCN)

LBK	pewter mesh	+\$0
LBL	steel mesh	+\$0

For laminate case/front (L) with all finishes (VCN)

LBF	neutral twill	+\$0
LBG	sarum twill	+\$0
LBH	earthen twill	+\$0
LBJ	graphite twill	+\$0
LBQ	white twill	+\$0

Wood-Grain Laminate

For laminate case/front (L) with all finishes (VCN)

76	light brown walnut	+\$0
LA	light ash	+\$0
LBA	clear on ash	+\$0
LBB	oak on ash	+\$0
LBC	walnut on ash	+\$0
LBD	dark brown walnut	+\$0
LBE	medium red walnut	+\$0
HM	natural maple	+\$0
HP	light anigre	+\$0
HX	aged cherry	+\$0
HY	walnut on cherry	+\$0

For laminate case/front (L) with video conferencing friendly finishes (VCY)

8Q	folkstone grey	+\$0
WL	sandstone	+\$0

Linen Laminate

For laminate case/front (L) with video conferencing friendly finishes (VCY)

LBN	classic linen	+\$0
LBP	casual linen	+\$0

Mesh Laminate

For laminate case/front (L) with video conferencing friendly finishes (VCY)

LBK	pewter mesh	+\$0
LBL	steel mesh	+\$0

For laminate case/front (L) with video conferencing friendly finishes (VCY)

LBF	neutral twill	+\$0
LBG	sarum twill	+\$0
LBH	earthen twill	+\$0

Wood-Grain Laminate

For laminate case/front (L) with video conferencing friendly finishes (VCY)

LBA	clear on ash	+\$0
LBB	oak on ash	+\$0
LBC	walnut on ash	+\$0

For laminate case/veneer front (C) or veneer case/front (W) with all finishes (VCN), or video conferencing friendly finishes (VCY)

ET	clear on ash	+\$0
EU	oak on ash	+\$0
EV	walnut on ash	+\$0

Step 12. Pull Finish

MS	metallic silver	+\$0
-----------	-----------------	------

Step 13. Fabric

For tackable fabric (T) with all finishes (VCN)

Price Category 1	+\$0
Price Category 2	+\$12
Price Category 3	+\$29
Price Category 4	+\$51
Price Category 5	+\$86

For tackable fabric (T) with video conferencing friendly finishes (VCY)

Price Category 1	+\$0
Price Category 2	+\$12
Price Category 3	+\$29
Price Category 4	+\$51

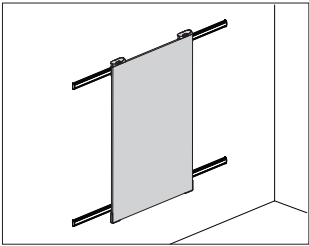

Product Information
Description
These small Eco boards hang on Exclave® wall rails or Exclave small and large mobile carts. Boards can stack up to 4 deep on rails, and 3 boards can be transported on each side of the small or large cart, for a total of 6 boards. They have top clips for hanging and bottom bumpers. These boards are available with a dry-erase writeable or nonwriteable surface. Eco boards have a cardboard honeycomb core, and are a tackable, recyclable alternative to foam core. They come in packages of 4, and can be used with other Exclave elements.
Notes
Actual board dimensions are 31"W×47"L×1/2"D.
Bottom bumpers and clip attachment screws are folkstone grey (8Q).
Dimensions

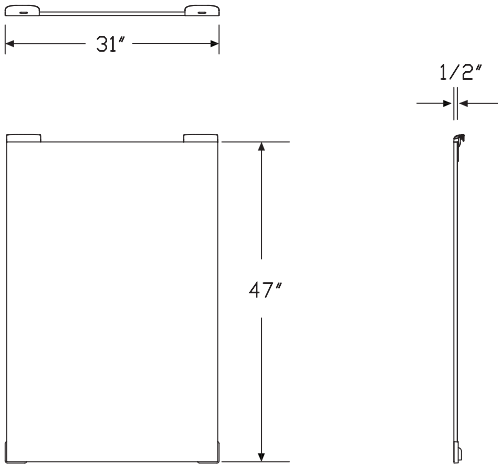

Specification Information
Step 1.
EXSB.
Step 2. Board Type
E eco board - writeable
N eco board - non-writeable
Step 3. Board Quantity
4 package of 4
Prices for Steps 1-3.
EXSB. E
N
Step 4. Clip Finish
8Q folkstone grey
G1 graphite
TRQ turquoise

Exclave® Boards

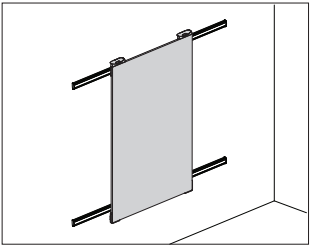

Product Information

Description

These small boards hang on Exclave® wall rails or Exclave small and large mobile carts. Boards can stack up to 4 deep on rails, and 3 boards can be transported on each side of the small or large cart, for a total of 6 boards. They have top clips for hanging and bottom bumpers. These boards are available in 2 types: a nonmagnetic whiteboard, or a tackable fabric board. Both board types can be used with other Exclave elements.

Notes

Actual board dimensions are 31"W×47"L×1/2"D.

For whiteboards, bottom bumpers are folkstone grey (8Q).

For tackable fabric boards, bottom bumper color matches the specified clip finish.

Video conference friendly finishes for tackable fabric boards are provided for guidance only. Customer lighting, color palette, video conferencing equipment, and other non-Exclave specified furnishings and tools may affect experience.

Dimensions

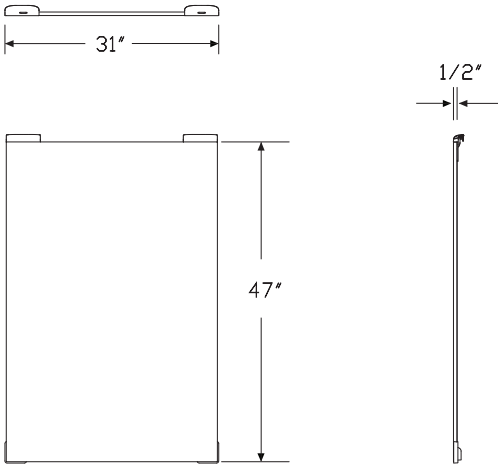

Specification Information

Step 1.

EXSB.

Step 2. Board Type

T tackable fabric

W whiteboard

Step 3. Board Quantity

For tackable fabric (T)

1 package of 1

2 package of 2

4 package of 4

For whiteboard (W)

1 package of 1

2 package of 2

Prices for Steps 1-3.

	1	2	4
EXSB. T	\$642	1227	2432
W	\$722	1387	—

Step 4. Clip Finish

8Q folkstone grey

G1 graphite

TRQ turquoise

Step 5. Video Conferencing Friendly Finishes

For tackable fabric (T)

VCN all finishes

VCY video conferencing friendly finishes

Step 6. Fabric

For tackable fabric (T) AND all finishes (VCN)

	1	2	4
Price Category 1	+\$0	0	0
Price Category 2	+\$12	24	48
Price Category 3	+\$29	58	116
Price Category 4	+\$51	102	204
Price Category 5	+\$86	172	344

Exclave® Boards

<i>For tackable fabric (T) AND video conferencing friendly finishes (VCY)</i>			
	1	2	4
Price Category 1	+\$0	0	0
Price Category 2	+\$12	24	48
Price Category 3	+\$29	58	116
Price Category 4	+\$51	102	204

Large Boards - Eco Boards

EXLB.

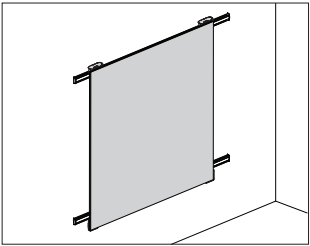

Product Information

Description

These large Eco boards hang on Exclave® wall rails or an Exclave large mobile cart. Boards can stack up to 4 deep on rails, and 3 boards can be transported on each side of the large cart, for a total of 6 boards. They have top clips for hanging and bottom bumpers. These boards are available with a dry-erase writeable or nonwriteable surface. Eco boards have a cardboard honeycomb core, and are a tackable, recyclable alternative to foam core. They come in packages of 4, and can be used with other Exclave elements.

Notes

Actual board dimensions are 47"W×47"L×1/2"D.
Bottom bumpers and clip attachment screws are folkstone grey (8Q).

Dimensions

Exclave® Boards

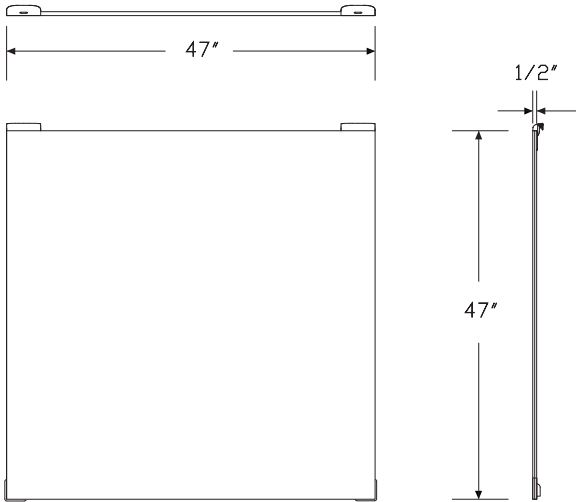

Specification Information

Step 1.

EXLB.

Step 2. Board Type

E	eco board - writeable
N	eco board - non-writeable

Step 3. Board Quantity

4	package of 4
----------	--------------

Prices for Steps 1-3.

		4
EXLB.	E	\$1235
	N	\$705

Step 4. Clip Finish

8Q	folkstone grey	+\$0
G1	graphite	+\$0
TRQ	turquoise	+\$0

Large Boards

EXLB.

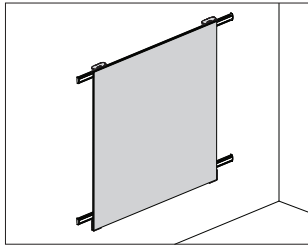

Product Information

Description

These large boards hang on Exclave® wall rails or an Exclave large mobile cart. Boards can stack up to 4 deep on rails, and 3 boards can be transported on each side of the large cart, for a total of 6 boards. They have top clips for hanging and bottom bumpers. These boards are available in 2 types: a nonmagnetic whiteboard, or a tackable fabric board. Both board types can be used with other Exclave elements.

Notes

Actual board dimensions are 47"W x 47"L x 1/2"D.

For whiteboards, bottom bumpers are folkstone grey (8Q).

For tackable fabric boards, bottom bumper color matches the specified clip finish.

Video conference friendly finishes for tackable fabric boards are provided for guidance only. Customer lighting, color palette, video conferencing equipment, and other non-Exclave specified furnishings and tools may affect experience.

Dimensions

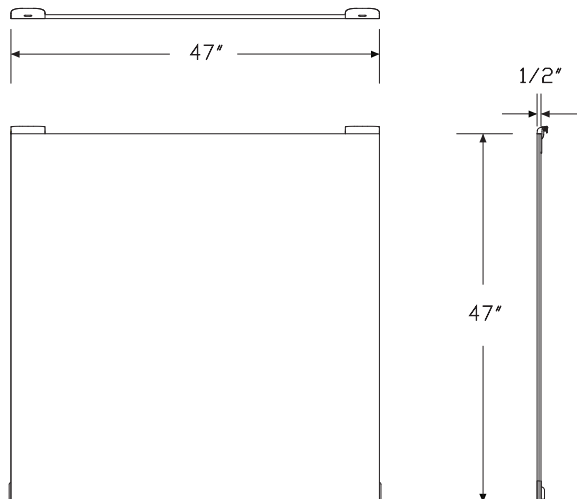

Specification Information

Step 1.

EXLB.

Step 2. Board Type

T	tackable fabric
W	whiteboard

Step 3. Board Quantity

1	package of 1
2	package of 2
4	package of 4

Prices for Steps 1-3.

	1	2	4
EXLB. T	\$802	1548	3072
W	\$963	1868	3713

Step 4. Clip Finish

8Q	folkstone grey		+\$0
G1	graphite		+\$0
TRQ	turquoise		+\$0

Step 5. Video Conferencing Friendly Finishes

For tackable fabric (T)

VCN	all finishes		+\$0
VCY	video conferencing friendly finishes		+\$0

Step 6. Fabric

For tackable fabric (T) AND all finishes (VCN)

	1	2	4
Price Category 1	+\$0	0	0
Price Category 2	+\$12	24	48
Price Category 3	+\$29	58	116
Price Category 4	+\$51	102	204
Price Category 5	+\$86	172	344

For tackable fabric (T) AND video conferencing friendly finishes (VCY)

	1	2	4
Price Category 1	+\$0	0	0
Price Category 2	+\$12	24	48
Price Category 3	+\$29	58	116
Price Category 4	+\$51	102	204

Small Mobile Cart

EXSC.

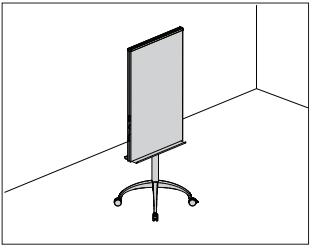

Product Information

Description

This dual-sided cart has magnetic whiteboard surfaces on each side and can support 3 small Exclave® hanging boards on each side, for a total of 6 boards. The metal marker and eraser tray extends on both sides. The cart comes with 2 leather pull straps, 1 on each side, and has a metal bracket on each side that can support the cup-style holder from the Exclave marker and eraser kit, ordered separately. The cart has 4 casters, 2 locking and 2 nonlocking.

Notes

Cart side edge color is folkstone grey (8Q).

Order the following products separately:

- Exclave small board (EXSB.)
- Exclave marker & eraser kit (EXMK.)

Dimensions

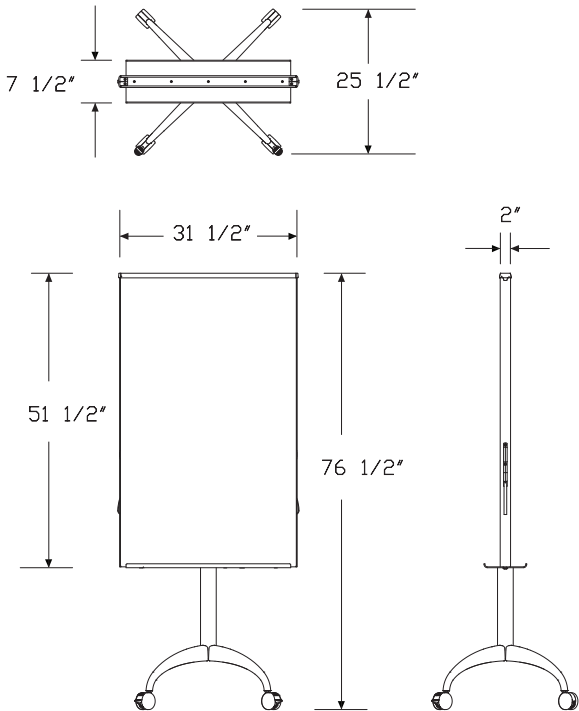

Specification Information

Step 1.		
EXSC.		
Step 2. Material		
MW	magnetic whiteboard	
Step 3. Pull Handle		
L	leather	
Prices for Steps 1-3.		
EXSC. MW		L \$2245
Step 4. Pull Handle Finish		
BK	black	+\$0
Step 5. Cart Side/Tray Finish		
8Q	folkstone grey	+\$0
Step 6. Base Finish		
8Q	folkstone grey	+\$0
91	white	+\$0

Large Mobile Cart

EXLC.

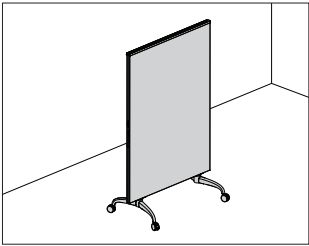

Product Information
Description
This dual-sided cart has magnetic whiteboard surfaces on each side and can support 3 large or 3 small Exclave® hanging boards on each side, for a total of 6 boards. The cart comes with 2 leather pull straps, 1 on each side, and has a metal bracket on each side that can support the cup-style holder from the Exclave marker and eraser kit, ordered separately. The cart has 4 casters, 2 locking and 2 nonlocking.
Notes
Cart side edge color is folkstone grey (8Q).
Order the following products separately:
<ul style="list-style-type: none">• Exclave large board (EXLB.)• Exclave small board (EXSB.)• Exclave marker & eraser kit (EXMK.)
Dimensions

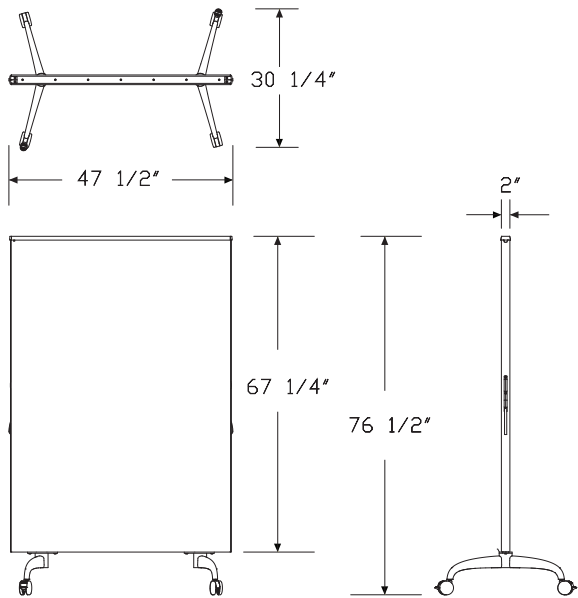

Specification Information		
Step 1.		
EXLC.		
Step 2. Material		
MW	magnetic whiteboard	
Step 3. Pull Handle		
L	leather	
Prices for Steps 1-3.		
		L
EXLC.	MW	\$3527
Step 4. Pull Handle Finish		
BK	black	+\$0
Step 5. Cart Side Finish		
8Q	folkstone grey	+\$0
Step 6. Base Finish		
8Q	folkstone grey	+\$0
91	white	+\$0

Exclave® Carts

Board Clips

EXBC.

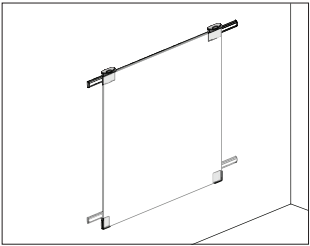

Product Information

Description

These clips are used to create new small or large boards to hang on Exclave® wall rails and carts. 1 clip set includes 2 top clips, 2 bottom bumpers, 4 barrel nuts and clip screws. Package contains 4 clip sets, enough to make 4 new boards. Boards not included.

Notes

Clips accommodate Exclave Eco boards or foam core up to 1/2" thick. Bottom bumper and barrel nut finishes are folkstone grey (8Q).

Dimensions

Specification Information

Step 1.

EXBC.

Step 2. Accessory Type

SC board clips

Step 3. Accessory Quantity

4 package of 4 sets

Prices for Steps 1-3.

4

EXBC. SC

\$253

Step 4. Finish

8Q folkstone grey

+\$0

G1 graphite

+\$0

TRQ turquoise

+\$0

Exclave® Accessories

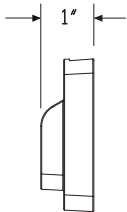
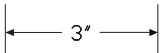
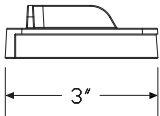
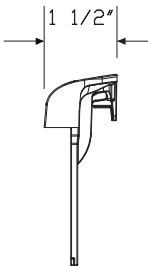
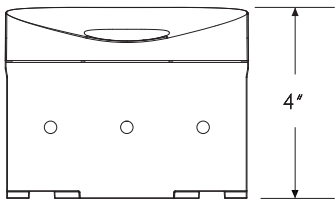
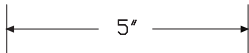
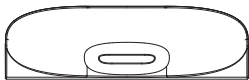

Flip Chart Hooks

EXFH.

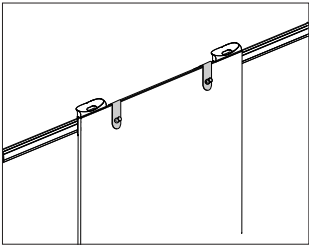

Product Information
Description
This flip chart hook attaches to Exclave® boards to hold flip chart paper. Paper not included. Package contains 8 hooks.
Dimensions

Specification Information
Step 1.
EXFH.
Step 2. Accessory Quantity
8 package of 8
Prices for Steps 1-2.
EXFH. 8 \$73
Step 3. Finish
79 green apple +\$0
G1 graphite +\$0
HY1 hyper-orange +\$0
TRQ turquoise +\$0

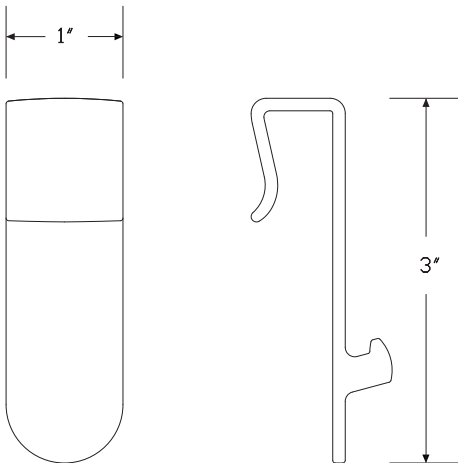
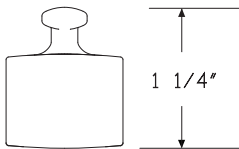

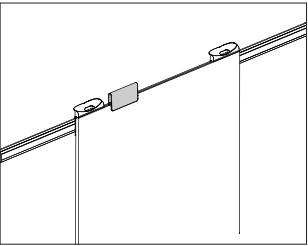

Product Information
Description
This tab is a writeable identification tab that clips onto the top of Exclave® boards to identify content on boards stacked up to 4 deep on wall rails or 3 deep on Exclave carts. Package contains 4 tabs.
Notes
Finish is a writeable dry-erase surface.
Order boards separately:
<ul style="list-style-type: none">• Exclave small board (EXSB.)• Exclave large board (EXLB.)
Dimensions

Specification Information
Step 1.
EXBT.
Step 2. Accessory Quantity
4 package of 4
Prices for Steps 1-2.
EXBT. 4 \$113

Exclave® Accessories

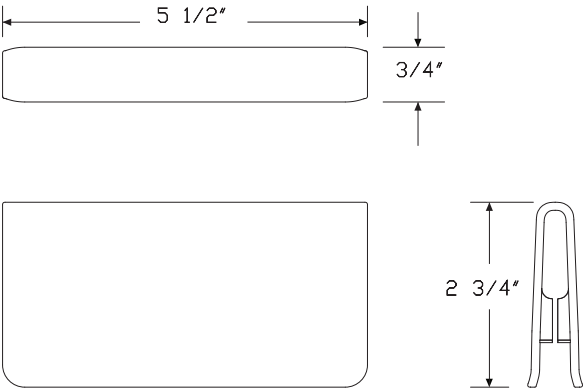

Marker & Eraser Kit

EXMK.

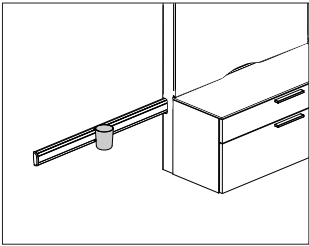

Product Information
Description
This marker and eraser kit comes with 1 cup-style holder, 4 dry erase markers (1 each of black, red, blue, and green), and 1 eraser. The holder attaches to Exclave® wall rails and to the sides of small and large Exclave carts.
Dimensions

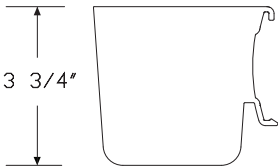
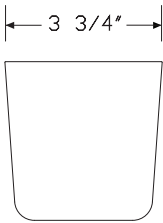
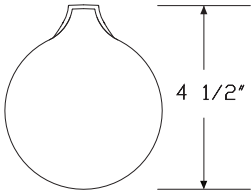

Specification Information
Step 1.
EXMK.
Step 2. Accessory Quantity
1 one kit
Prices for Steps 1-2.
EXMK. 1 \$113
Step 3. Finish
79 green apple +\$0
G1 graphite +\$0
HY1 hyper-orange +\$0
TRQ turquoise +\$0

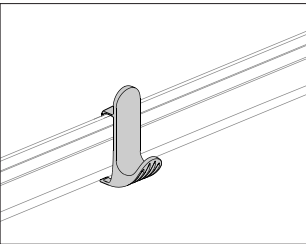

Product Information
Description
This clip attaches to Exclave® wall rails to hold coats and bags. Package contains 8 clips.
Notes
It is recommended to use clips on top rail for coats and on bottom rail for bags.
Dimensions

Specification Information
Step 1.
EXRC.
Step 2. Accessory Quantity
8 package of 8
Prices for Steps 1-2.
EXRC. 8 \$169
Step 3. Finish
79 green apple +\$0
G1 graphite +\$0
HY1 hyper-orange +\$0
TRQ turquoise +\$0

Exclave® Accessories

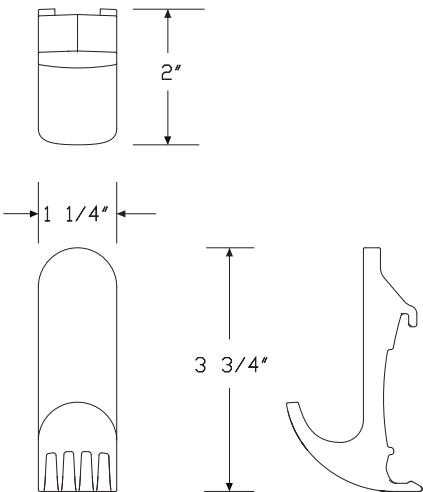

Rail End Caps

EXREC.

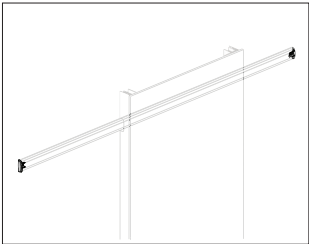

Product Information
Description
These plastic inserts finish the ends of Exclave® wall rails. Package contains 4 end caps.
Notes
For anodized (AN) wall rails (EXRL.), order folkstone grey (8Q) end caps.
For white (G1) wall rails (EXRL.), order white (G1) end caps.
For graphite (G1) wall rails (EXRL.), order graphite (G1) end caps.
Order wall rail (EXRL.) separately.
Dimensions

Specification Information
Step 1.
EXREC.
Step 2. Accessory Quantity
4 package of 4
Prices for Steps 1-2.
EXREC. 4 \$57
Step 3. Finish
8Q folkstone grey +\$0
91 white +\$0
G1 graphite +\$0

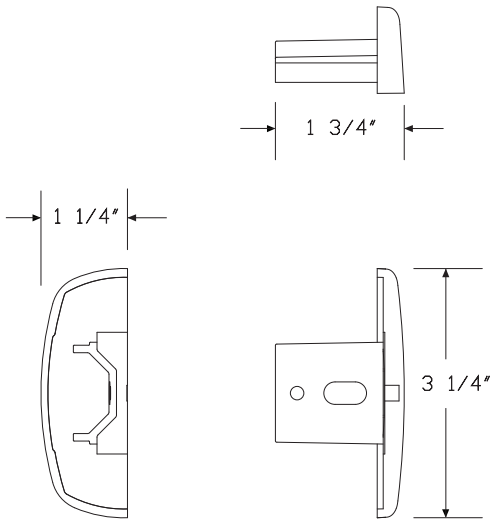

Index by Product Name

Exclave®	
Board Clips	page(s) 24
Board Info Tabs	26
Flip Chart Hooks	25
Guitar Pick Table	9
Large Boards	21
Large Boards - Eco Boards	20
Large Mobile Cart	23
Marker & Eraser Kit	27
Media Tile	13
Rail Coat & Bag Clips	28
Rail End Caps	29
Small Boards	18
Small Boards - Eco Boards	17
Small Mobile Cart	22
Stowage	14
Tear Drop Table	5
Wall Rails	12



Index by Product Number



EXBC.	Board Clips	page(s) 24
EXBT.	Board Info Tabs	26
EXFH.	Flip Chart Hooks	25
EXLB.	Large Boards	21
EXLB.	Large Boards - Eco Boards	20
EXLC.	Large Mobile Cart	23
EXMK.	Marker & Eraser Kit	27
EXMT.	Media Tile	13
EXRC.	Rail Coat & Bag Clips	28
EXREC.	Rail End Caps	29
EXRL.	Wall Rails	12
EXSB.	Small Boards	18
EXSB.	Small Boards - Eco Boards	17
EXSC.	Small Mobile Cart	22
EXSTW.	Stowage	14
EXTD.	Tear Drop Table	5
EXTT.	Guitar Pick Table	9



20-Day or Less/Assigned Lead-Time Order Information

20-Day or Less and Assigned Lead-Time Programs

20-day or less and assigned lead-time products are designed for established Herman Miller dealers with pre-approved credit.

Products are distributed from multiple manufacturing facilities across the United States. All products and options not designated by an Assigned Lead-Time icon  will ship in 20 business days or less after being acknowledged by Herman Miller. Products and options designated by an  are on the assigned lead-time program and will ship in 20 days, less than 20 days, or more than 20 days from order acknowledgement.

Ordering Procedure

Please place orders through Order Manager. If this is not available to you, place orders through mail or fax. Verbal purchase orders will not be accepted.

Order Entry fax number for Passage®, 5000 Series, and Meridian® Filing and Storage: (616) 846 9236.

Order Entry fax number for all other products:
(616) 654 3085.

For more information, contact your Customer Care representative at:
(866) 854 3048 EXT 3400.

Shipments and Delivery

Per Herman Miller Terms and Conditions.

Changes and Cancellation

Per Herman Miller Terms and Conditions.

Stain-to-Match Program

Stain-to-Match Program

Program Overview

The Stain-to-Match program gives you the option of using veneer finishes that are not listed in the standard offering. The program allows Herman Miller to match a customer's existing recut or natural veneer, or create a new finish that is unique to an installation.

Specific information on approval, ordering, pricing, and warranty for the Stain-to-Match program is listed below. Questions and requests for assistance may be directed to Herman Miller Options at:
(800) 654 3910

Stain-to-Match Process

1. Fill out the Options Stain-to-Match Request Form and send along with a color sample (2" x 3" minimum) to the Herman Miller Options Applications Team at the address provided on the form. The form can be found on Omni.
2. Within 7-10 working days, Herman Miller Options will send a sample of the color-matched stain on Herman Miller veneer to the requester for the customer's signed approval.
3. If the sample meets the customer's approval, sign the reverse side of the sample, scan and email the approval to:
options@hermanmiller.com.
4. After the stain has been approved, a formal quotation with special number and pricing can be provided, or the product can be specified through the Vary Easy program, if available. Work with the Options team on final product needs and how to specify.
5. A purchase order can then be placed.

Stain-to-Match Warranty

Herman Miller warrants its products to be free from defects in craftsmanship from the date of delivery for the applicable warranty period. Herman Miller is responsible for the physical properties of the veneers available through the Stain-to-Match program, which include:

- STA: Stain-to-Match on Recut Ash
- STB: Stain-to-Match on Beech
- STC: Stain-to-Match on Cherry
- STD: Stain-to-Match on Oak
- STK: Stain-to-Match on Reltech Anigre (Geiger)
- STM: Stain-to-Match on Recut Mahogany
- STP: Stain-to-Match on Maple
- STU: Stain-to-Match on Walnut (Geiger)

See your specification tool for product specific finish offering limitations.

Proprietary Textiles Application Chart – Workspaces

• Available

A Assigned lead-time textile.

See page 3 for exception notes.

Price Category 1																																	
COM	Customer's Own Material A	1	1	1	1	1		1	1	1	1		•	1	1	1		1		1	1	1						1	1		3	1	
8A__	Bubblotack™																																
2V__	Chain	•	•	•	•	•		•	22	•	•		•	•	•	•		•		•	•							•		•	3		
8T__	Crossing (85__)	2	2	2	•	•		•	•	2	•		•	•	•	•	•	•	•		•	•					•	8	•		•	3	18
95__	Gem	2	2	2	•	•		•	•	2	•		•	•	•													•	•	•	3	•	
2I__	Grasscloth	•	•	•	•	•		•	•	•	•		•		•	•	•	•	•		•	•						•	•	•	3		
1MN__	Monologue	2	2	2	•	•		•	•	2	•		•	•	•	•	•	•	•		•	•						•	•	•		•	
8B__	Multiscrim™						•																•		•			•	•	•			
5T__	Resonance	•	•	•	•	•		•	•	•	•		•	•	•													•	•	•			
8C__	Scrim Trim																										•						
22W__	Shade											•																					
2M__	Silkworm	•	•	•	•	•		•	•	•	•		•	•	•													•	•	•	3		
22F__	Slant	6		•		•		•	•		•		•	•	•													•		•	3		
235__	Tailored A	•	•		•	•		•	•	•	•		•	•	•													•		•		•	
1WS__	Whisper	2	2	2	•	•		•	•	2	•		•	•	•	•	•	•	•	•	•	•						•	•			•	
Price Category 2																																	
1CD__	Code	•	•	•	•	•		•	•	•	•		•	•	•												•		•				
3P__	ColorGuard		2		•																											•	
51__	Cord	•	•	•	•	•		•	•	•	•		•	•	•													•		•	3		
92__	Crepe	2	•	•	•	•		•	•	•	•		•	•	•			•									•	8	•	•		3	•
22Q__	Fish Net		2	2	•	•		•	•	2	•			•				•			•											•	
57__	Frost	•	•	•	•	•		•	•	•	•		•	•	•	•		•		•	•	•						•	•	•	3		
84__	Grosgrain	4	•	•	•	•		•	•	•	•			•	19														•	19	•	3	
4N__	Horizon	2	2	2	•	•		•	•	•	•		•	•	•													•	•	•	3		
1LM__	Loom	2	2	2	•	•		•	•	•			•	•	•	•		•		•	•	•					•		•			•	
1HA__	Medley	2	2	2	•	•		•	•	•	•		•	•	•	•	•	•	•	•	•	•				•	8	•	•			•	
3A__	Moiré		2	2	•	•		•	22	2	•		•	•	•	•		•		•	•	•								•	3	•	
1RV__	Rivet	2	2	2	•	•		•	•	2	•		•		•		•		•	•	•								•	•		•	
43__	Tape								•	•	•		•		•															•			
8R__	Twist (5S__)	5	2	2	•	•		•	•	2	•		•	•	•	•	•	•	•	•	•	•						•	•	•	3	18	
22T__	Well Suited		2		•	•		•	2	•																						•	
Price Category 3																																	
70__	Bento	2	2	2	•			•	2	•		•		•	•	•		•		•	•	•						•		•	3	•	
1FB__	Connection	•	•	•	•	•		•	•	•	•		•	•	•	•			•									•	•	•	3		
1FC__	Current	•	•	•	•	•		•	•	•	•		•	•	•	•		•										•	•	•	3		
8Z__	Glaze	•	•	•	•	•		•	•	•	•		•	•	•													•	•	•	3		
47__	Ground Cloth®	•	•	•	•	•		•	•	•	•		•	•	•	•		•		•	•	•	14			•	8	•	•	•	3		
5D__	Kira 2	2	2	2	•	•		•	•	2	•		•	•	•	•		•		•	•	•	14					•	•	•	3		
22R__	Pins and Needles	2	2		•	•		•	•	2	•		•	•	•													•				•	
8L__	Savannah	•	20		•	•		•	•	•	•		•	•	•								14							•			
8U__	Stitches (5Z__)	2	2	2	•			•	2	•			•	•														•		•	3	18	
8W__	Strands	•	•	•	•	•		•	•	•	•		•	•	•	•		•		•	•	•						•	•	•	3		
22V__	String Plaid	2	2	2	•	•		•	•	2	•		•	•	•	•		•		•	•	•						•					

continued on next page

Proprietary Textiles Application Chart – Workspaces

continued

Proprietary Textiles Application Chart — Workspaces

continued

	Action Office® Panels/Connectors	Action Office/Ethospace® B-Style Storage	Action Office B-Style Tackboards	Action Office/Ethospace E-Style Storage	Ethospace Tiles/Connectors	Ethospace Work Surface-Attached Screens	Ethospace/Canvas Office Landscape® Privacy Doors	Canvas Tiles/Extended Width Tiles	Canvas B-/E-Style Storage	Canvas Standing Screen and Team Wall Infill	Canvas Signature Screen	Canvas Tackboards	Layout Studio® Framed Screen	Locale® Display Tackboard	Locale Freestanding Screen and Workbase Screen	Locale L-Desk/D-Desk Screens	Pari™ Screens	Prospect™ Exterior Acoustic Pad	Public Office Landscape® Screen/Desktop Top Divider	Renew™ Link Screens	Resolve® Boundary Screens/Flags	Resolve Display Screens	Resolve Rolling Screens/Canopies	Exclave® Tackable Boards and Stowage Tackable Backdrop	Exclave Video-Friendly Tackable Boards and Stowage Tackable Backdrop	Intersect® Screens	Thrive® Personal Side Screen	Tu® Wood Storage Cubby Tackboard	5000 Series Storage and Tackboards	Seating		
Price Category 4																																
2X__ Glisten	•	•	•	•	•		•	•	•	•		•	•	•						•						•		•	•	3		
22L__ Loft A		2	2	•	•		•	•	2	•		•	•	•	•	•	•	•	•	•				•	8		•	•	•	•	3	
6S__ Quilty	2	2	2	•	•		•	•	2				•	•												•	•		3	•		
63__ Sironetta	•	•	•	•	•		•	•	•	•		•	•	•	•		•		•	•						•	•	•	3			
Price Category 5																																
14A__ Hopsak	2	2	2	•	•		•	2	•			•	•	•										•		•		•		•		
Price Category 6																																
No fabrics available at this time.																																

- 1 Refer to price book appendices and Omni for COM information.
- 2 Available on all products except 54" and 60" wide.
- 3 Fabric is railroaded for all widths.
- 4 Not available on Action Office (AO®) acoustical panels.
- 5 (8R__), (8T__), (85__), and (5S__) not available on AO acoustical panels and not available on 54"- or 60"-wide products.
- 6 Not available on Action Office (AO®) connectors, cable management, and spacers.
- 8 Available in select colors. See the "Proprietary Textile Colors – Workspaces" appendix.
- 14 Not available on Resolve flags.
- 18 Available on seating products in select colors. See the "Proprietary Textile Colors – Seating" appendix.
- 19 Not available in Grosgrain (84__) fabric colors 8401, 8405, and 8413.
- 20 Available only on Ethospace B-Style.
- 22 Not available as railroaded application option for Chain (2Voo) and Moiré (3Aoo) on Canvas Extended Width Tiles.
- 24 Not available on Ethospace cable access tile, cable channel tile, or beltline face tile.

Application Note: Herman Miller cannot guarantee material/pattern alignment in adjacent products. For example, a fabric's pattern may not align from one screen to the next, or from one panel to the next.

Proprietary Textile Colors – Workspaces

Price Category 1

Customer's Own Material
See Order Information in
Appendices.
Assigned lead-time textile. A

Bubbletack™
100% polyester

8A01	Seashell White
8A02	Pearl Grey
8A05	Dune Beige
8A07	Pebble Beige
8A09	Olive Green
8A13	Slate Purple
8A19	Spa Blue
8A24	Sable Grey
8A27	Summer White
8A28	Moth Grey
8A29	Tea Leaf Grey
8A30	Blue Grey
8A31	Dusty Bronze
8A32	Slate Blue
8A33	Caramel Beige
8A34	Kiwi Green

Chain
66" wide
100% recycled polyester

2V01	Pearl
2V02	Oyster
2V03	Wheat
2V04	Linen
2V05	Wicker
2V06	Bamboo
2V07	Sage
2V08	Spring Wood
2V09	Iceberg

Crossing
54" wide
86% antimony-free polyester
14% polyester

8T03	Wicker *
8T04	Porcelain *
8T05	Warm Grey *
8T06	Sepia
8T07	Pumpkin
8T08	Copper
8T09	Cranberry
8T10	Tomato
8T11	Mulberry
8T12	Plum
8T13	Green Apple
8T14	Loden
8T15	Spruce
8T16	Periwinkle
8T17	Cerulean
8T18	Indigo
8T19	Shale *
8T20	Brownstone
8T21	Bark
8T22	Tin *
8T23	Graphite
8T24	Black

Crossing
For workspaces products only.
54" wide
86% antimony-free polyester
14% polyester

8501	Ivory *
8502	Oyster *

* Colors available on Exclave®
Video-friendly Tackable Boards
and Stowage Tackable Backdrop

Gem
54" wide
100% antimony-free polyester

9501	Sesame
9502	Tangerine
9503	Red
9504	Red Violet
9505	Mulberry
9506	Java
9507	Twilight
9508	Bayou
9509	Iris
9510	Berry Blue
9511	Aqua Green
9512	Green Apple
9513	Spruce
9514	Black
9515	Slate Grey
9516	Fog

Grasscloth
66" wide
100% recycled polyester

2I01	Silver Birch
2I02	Pampas
2I03	Sedge
2I07	Lea
2I08	Taro
2I09	Steam Grey
2I10	Cayenne
2I11	Bottle Green
2I12	Surf
2I13	Gravel

Monologue
54" wide
56% recycled polyester
44% polyester

1MN01	Linen
1MN02	Alabaster
1MN03	Truffle
1MN04	Folkstone
1MN05	Silver Pine
1MN06	Slate
1MN07	Seed
1MN08	Yellow Oxide
1MN09	Persimmon
1MN10	Tundra
1MN11	Meadow
1MN12	Blue Sky
1MN13	Blue Spruce
1MN14	Deep Sea

Multiscrim™
60" wide
100% polyester

8B01	Seashell White
8B02	Pearl Grey
8B05	Dune Beige
8B07	Pebble Beige
8B09	Olive Green
8B15	Slate Purple
8B19	Spa Blue
8B24	Sable Grey
8B27	Summer White
8B28	Moth Grey
8B29	Tea Leaf Grey
8B30	Blue Grey
8B31	Dusty Bronze
8B32	Slate Blue
8B33	Caramel Beige
8B34	Kiwi Green

Proprietary Textile Colors – Workspaces

continued

Price Category 1

continued

Resonance

66" wide
100% polyester
5T04 Greige
5T05 Porcelain
5T06 Alabaster
5T15 Iris
5T28 Sugar
5T47 Tobacco
5T54 Saltbush
5T57 Seed
5T58 Sepia
5T59 Tundra
5T60 Iceberg
5T61 Black
5T62 Chamois
5T63 Citrus
5T64 Tangerine
5T65 Red
5T66 Wild Berry
5T67 Boysenberry
5T68 Pistachio
5T69 Green Apple
5T70 Forest
5T71 Jade
5T72 Blue Green
5T73 Bright Turquoise
5T74 Twilight

Scrim Trim

61" wide
82% polyester
18% spandex
8C01 Seashell White
8C02 Pearl Grey
8C22 Winter Grey
8C24 Sable Grey

Shade

91% polypropylene
9% polyester
22W02 Tin
22W03 Graphite

Silkworm

66" wide
58% recycled polyester
42% polyester
2M01 Cocoon
2M02 Pongee
2M03 Saffron
2M04 Tussah
2M05 Ceylon
2M06 Jasmine
2M07 Shale
2M08 Monsoon

Slant

66" wide
51% polyester
49% recycled polyester
22F01 Beech Nut
22F02 Chamois
22F03 Chartreuse
22F04 Pesto
22F05 Peacock
22F06 Neptune
22F07 Blueberry
22F08 Boysenberry
22F09 Magenta
22F10 Pumpkin
22F11 Cranberry
22F12 Silver Birch
22F13 Bluestone
22F14 Truffle
22F15 Shale

Tailored

Assigned lead-time textile. ^A
54" wide
56% polyester
44% recycled polyester
23501 Studio White
23502 Sugar
23503 Tomato
23504 Orchid
23505 Boysenberry
23506 Chive
23507 Bluegrass
23508 Cobalt
23509 Cadet
23510 Fog
23511 Graphite
23512 Black
23513 Coffee

Whisper

54" wide
73% recycled polyester
27% polyester
1WS01 Sand Dollar
1WS02 Pebble
1WS03 Silver Birch
1WS04 Iceberg
1WS05 Silver Pine
1WS06 Carbon
1WS07 Cumin
1WS08 Adobe
1WS09 Strawberry
1WS10 Blush
1WS11 Eggplant
1WS12 Willow
1WS13 Sea Grass
1WS14 Pool
1WS15 Blueberry

Price Category 2

Code

66" wide
100% Repreve recycled polyester
1CD01 Linen
1CD02 Khaki
1CD03 Iceberg
1CD04 Zinc
1CD05 Blue Black

ColorGuard

54" wide
100% vinyl
3P01 Grey
3P02 Navy
3P03 Spruce ^A
3P04 Jade ^A
3P05 Natural ^A
3P08 Blueberry ^A
3P09 Coal ^A
3P12 Black Plum ^A
3P14 Black
3P15 New Burgundy ^A
3P17 Burgundy ^A
3P19 Slate
3P31 Horizon Blue ^A
3P33 Pumice
3P54 Candy Apple ^A
3P58 Beige ^A
3P66 Deep Clay ^A
3P72 Allspice ^A
3P90 Green Tea ^A
3P93 Camelback ^A
3P96 Manzanita ^A
3P97 Fudge ^A
3PB2 Sea Grass ^A
3PB5 Vizcaya Palm ^A
3PB9 Neptune ^A
3PC7 Bucksuede ^A
3PD4 Otter ^A

^A Assigned lead-time color.

Proprietary Textile Colors – Workspaces

continued

Price Category 2

continued

Cord

66" wide
51% antimony-free polyester
49% polyester
5101 Ivory
5102 White Ash
5103 Linen
5104 Bamboo
5105 Sepia
5106 Wicker
5107 Sesame
5108 Kiwi Green
5109 Bayou
5110 Shade
5111 Spring Wood
5112 Summer White

Crepe

54" wide
100% recycled polyester
9201 Licorice
9203 Smoke
9207 Cherry
9209 Claret
9212 Raisin
9218 Aquamarine
9223 Cadet
9241 Beachglass
9243 Midnight
9244 Artichoke
9248 Warm White *
9249 Stone *
9250 Earth
9251 Fog *
9252 Slate Grey
9253 Yellow Dark
9254 Coral
9255 Blush Grey *
9256 Wild Berry
9257 Clover
9258 Caribbean
9259 Cerulean
9260 Brownstone

* Colors available on Exclave®
Video-friendly Tackable Boards
and Stowage Tackable Backdrop

Crepe continued

9261 Shale
9262 Graphite
9263 Tomato
9264 Green Apple

Fish Net

55" wide
100% recycled polyester
22Q01 Oyster
22Q02 Stone
22Q03 Citrus
22Q04 Curry
22Q05 Chipotle
22Q06 Cherry
22Q07 Fuschia
22Q08 Claret
22Q09 Purple
22Q10 Clover
22Q11 Pesto
22Q12 Peacock
22Q13 Lagoon
22Q14 Twilight
22Q15 Bluestone
22Q16 Storm
22Q17 Black
22Q18 Cocoa

Frost

66" wide
100% recycled polyester
5701 Bisque
5702 Abalone
5703 Porcelain
5704 Honey
5705 Iceberg
5706 Sage
5707 Reed
5708 Steam Grey
5709 Gunmetal
5710 Sable Grey

Grosgrain

66" wide
100% recycled polyester
8401 Pearl *
8402 White Ash
8403 Warm Grey
8404 Khaki
8405 Oyster *
8406 Celadon
8408 Spa Blue
8409 Bud
8410 Kiwi Green
8411 Bayou
8412 Tin
8413 Iceberg *

* Colors not available on Canvas
Dock Mounted Screens, Locale®
Workbase Screen, Public Office
Landscape® Screen/Desk Top
Divider, and Thrive® Personal
Side Screen.

Horizon

54" wide
65% antimony-free polyester
35% polyester
4N01 Rye Grass
4N02 Sugar Pine
4N03 Silver Pine
4N04 White Ash
4N05 Spring Wood
4N06 Tamarack
4N07 Mushroom
4N08 Haystack
4N09 Oat Grass
4N10 Forest Moss
4N11 Hickory
4N12 Beech Nut
4N13 Pine Cone
4N14 Poplar
4N15 Elderberry

Loom

54" wide
100% polyester
1LM01 Linen
1LM02 Brown Sugar and Spice
1LM03 Brick and Mortar
1LM04 Salt and Pepper
1LM05 Black
1LM06 Lemongrass
1LM07 Poppy
1LM08 Wild Berry
1LM09 Loden
1LM10 Jade
1LM11 Deep Sea

Medley

54" wide
100% polyester
1HA01 Stone *
1HA02 Trail
1HA03 Charcoal
1HA04 Cinder
1HA05 Citrus
1HA06 Papaya
1HA07 Chutney
1HA08 Tundra
1HA09 Feather Grey *
1HA10 Chartreuse
1HA11 Loden
1HA12 Peacock
1HA13 Bayou *
1HA14 Blue Grotto
1HA15 Blueberry
1HA22 Khaki
1HA23 Pewter
1HA24 Yellow Oxide
1HA25 Vintage Rose
1HA26 Raspberry
1HA27 Acai Berry

* Colors available on Exclave®
Video-friendly Tackable Boards
and Stowage Tackable Backdrop

Proprietary Textile Colors – Workspaces

continued

Price Category 2

continued

Moiré	
54" wide	
100% recycled polyester	
3A01	Concrete
3A02	Biscotti
3A03	Rattan
3A04	Chambray
3A05	Fern
3A08	Violet
3A09	Zin
3A10	Curry
3A11	Spice
3A12	Cork

Rivet	
54" wide	
100% recycled polyester	
1RV01	Twig
1RV02	Deep Clay
1RV03	Woodrose
1RV04	Otter
1RV05	Hemlock
1RV06	Olive
1RV07	Lagoon
1RV08	Deep Sea
1RV09	Charcoal
1RV10	Grey Brindle

Tape	
66" wide	
52% polypropylene	
48% recycled polyester	
4301	Pearl
4302	Oyster
4303	Wicker
4304	Reed
4305	Straw
4306	Celadon
4307	Alabaster
4308	Bamboo
4309	Feather Grey
4310	Iceberg

Twist	
54" wide	
80% antimony-free polyester	
13% recycled polyester	
7% polyester	
8R05	Wicker
8R10	Poppy
8R14	Tin
8R15	Shale
8R16	Graphite
8R17	Birch
8R18	Sepia
8R22	Blueberry
8R23	Green Apple
8R26	Gunmetal
8R27	Cinder
8R28	Citrus
8R29	Pekoe
8R30	Tangerine
8R31	Red Plum
8R32	Wisteria
8R33	Forest
8R34	Jade Dark
8R35	Waterfall
8R36	Midnight Blue
8R37	Carbon Dark

Twist	
For workspaces products only.	
54" wide	
80% antimony-free polyester	
13% recycled polyester	
7% polyester	
5S01	Pearl
5S02	Ivory
5S03	Oyster

Well Suited	
55" wide	
79% polyester	
21% recycled polyester	
22T01	Oyster
22T02	Raffia
22T03	Peppermint
22T04	Wild Berry
22T05	Spring Green
22T06	Mint
22T07	Periwinkle
22T08	Cool Grey
22T09	Citrus
22T10	Pumpkin
22T11	Red
22T12	Fuschia
22T13	Orchid
22T14	Chartreuse
22T15	Green Apple
22T16	Jade
22T17	Peacock
22T18	Blueberry
22T19	Bluestone
22T20	Mink

Price Category 3

Bento	
54" wide	
100% antimony-free polyester	
7001	Frost
7002	Linen
7003	Khaki
7004	Truffle
7005	Grey Black
7006	Pumpkin
7007	Cranberry
7008	Everglade
7009	Cobalt

Connection	
66" wide	
100% antimony-free polyester	
1FB1	Oyster
1FB2	Linen
1FB3	Iceberg
1FB4	Silver Pine
1FB5	Apricot
1FB6	Cumin
1FB7	Green Apple
1FB8	Slate Blue
1FB9	Metal

Proprietary Textile Colors – Workspaces

continued

Price Category 3

continued

Current	
66" wide	
100% antimony-free polyester	
1FC1	Oyster
1FC2	Linen
1FC3	Iceberg
1FC4	Silver Pine
1FC5	Apricot
1FC6	Cumin
1FC7	Green Apple
1FC8	Slate Blue
1FC9	Metal

Glaze	
66" wide	
100% recycled polyester	
8Z01	Wicker
8Z02	Honey
8Z03	Porcelain
8Z04	Celadon
8Z06	Rye
8Z07	Frost
8Z08	Silver Birch

Ground Cloth®	
66" wide	
100% polyester	
4701	Vapor Grey
4721	Warm White *
4722	Fog *
4723	Straw *
4724	Red Orange *
4725	Wild Berry *
4726	Green Apple *
4727	Caribbean *
4728	Midnight *
4729	Cappuccino *

* Colors available on Exclave®
Video-friendly Tackable Boards
and Stowage Tackable Backdrop

Kira 2	
54" wide	
100% recycled polyester	
5D11	Flaxen
5D12	Papyrus
5D13	Oasis
5D14	Incense
5D15	Ash
5D16	Falcon

Pins and Needles	
58" wide	
76% recycled polyester	
24% polyester	
22R01	Day and Night
22R02	Night and Day

Savannah	
66" wide	
76% recycled polyester	
24% polypropylene	
8L01	Pearl
8L02	Oyster
8L03	Wheat
8L04	Jute
8L05	Bamboo
8L06	Metal
8L07	Linen
8L08	Celadon
8L09	Moss
8L10	Frost
8L11	Shale
8L12	Pewter

Stitches	
54" wide	
54% polyester	
46% recycled polyester	
8U02	Rye
8U03	Khaki
8U04	Honey
8U05	Cattail
8U06	Pumpkin
8U07	Brick
8U08	Cool Grey
8U09	Slate Blue
8U10	Juniper
8U11	Evening Blue
8U12	Charcoal
8U13	Kiwi Green
8U14	Olive
8U15	Pesto
8U16	Cocoa
8U17	Seed

Stitches	
For workspaces products only.	
54" wide	
54% polyester	
46% recycled polyester	
5Z01	White Ash

Strands	
66" wide	
100% recycled polyester	
8W01	Pebble
8W02	Porcelain
8W03	Taupe
8W04	Honey
8W05	Khaki
8W06	Rye
8W07	Wicker
8W08	Tin
8W09	Cool Grey

String Plaid	
54" wide	
100% recycled polyester	
22V01	Warm White on Khaki
22V02	Mint on Yellow Green
22V03	Mist on Blue Grey
22V04	Sky Blue on Red
22V05	Lime on Magenta
22V06	Bright Green on Green
22V07	Aqua Blue on Cerulean
22V08	Ivory on Black

Proprietary Textile Colors – Workspaces

continued

Price Category 4

Glisten	
66" wide	
84% polyester	
16% recycled polyester	
2X02 Rye	
2X05 Iceberg	
2X09 Pewter	
2X10 Ash	
Loft	
Assigned lead-time textile. A	
54" wide	
100% wool	
22L01	Heathered Light Green
22L02	Heathered Dark Green
22L03	Heathered Turquoise
22L04	Heathered Navy
22L05	Heathered Orange
22L06	Heathered Red
22L07	Heathered Tan *
22L08	Heathered Grey *
22L09	Heathered Blue *
22L10	Heathered Brown
22L11	Heathered Dark Grey
22L12	Heathered Denim

* Colors available on Exclave®
Video-friendly Tackable Boards
and Stowage Tackable Backdrop

Quilty	
56" wide	
100% antimony-free polyester	
GreenShield	
6S03 Khaki	
6S04 Straw	
6S07 Brick	
6S10 Mink	
6S11 Green Apple	
6S13 Indigo	
6S14 Zinc	
6S15 Slate	
6S16 Beachwood	
6S17 Paprika	
6S18 Plum	
6S19 Juniper	
6S20 Grey Black	

Sironetta	
66" wide	
100% recycled polyester	
6301 Acapella	
6302 Sonata	
6303 Interlude	
6304 Legato	
6308 Harmony	
6309 Ensemble	

Price Category 5

Hopsak	
56" wide	
100% recycled polyester	
14A20	Black
14A22	Raw Umber Dark
14A26	Grey Blue Dark
14A30	Sepia Dark
14A38	Emerald Dark
14A39	Yellow Dark
14A40	Orange
14A41	Sienna
14A42	Olive Green Dark
14A43	Crimson
14A44	Crimson Dark Dark
14A45	Violet Dark
14A46	Pink Dark Dark
14A47	Ultramarine Dark
14A48	Cobalt Blue
14A49	Terra Cotta
14A50	Ochre Dark

For more information about our products and services or to see a list of dealers, please visit us at HermanMiller.com or call (800) 851 1196.

© 2018 Herman Miller, Inc., Zeeland, Michigan

® **HermanMiller**, 3D Intelligent, AO, Action Office, Aeron, ArcSpan, Aside, Avall, Avive, Bubble Lamps, Canvas Office Landscape, Caper, Celle, Co/Struc, Daisiyone, Distil, Eames, Eco-Dematerialized, Embody, Envelop, Equa 2, Ergon 3, Ethospace, Exclave, Fine-Tune, FlexFront, Flo, Formcoat, Formwork, Ground Cloth, Herman Miller for the Home, Herman Miller for Healthcare, Intersect, Kinemat, Lapjack, Layout Studio, Lifework, Limerick, Live Unframed, Living Office, Locale, Maharam, Meridian, Mirra, Passage, Pellicle, Perspectives, PostureFit, Public Office Landscape, Resolve, Rodney, Sayl, Setu, Thrive, Tu, Wishbone, and Y-Tower are among the registered trademarks of Herman Miller, Inc., and its owned subsidiaries.

™ 8Z Pellicle, About Face, AireWeave, Albert, Backfit, Bubbletack, Burdick Group, Butterfly Back, Celeste, Cellular Suspension, Clam, Compass, Connect, Cubert, DOT, Duracare, Durawrap, Eames Soft Pad, EnhancedAccess, Everywhere, Flex-Edge, Flute, Harmonic, Herman Miller Select, Hopsak 2, Intent, Iota, Jaw, Keyless Entry, Keyn Chair Group by Herman Miller, Latitude, Locale, Logic Mini, Logic Power Access Solutions, Live OS, Loop, Lyris, Lyris 2, Made-to-Measure Storage, Metaform Portfolio, Mora, Motia, Multiscrim, Nelson, Pari, Pixelated Support, Plex, PostureFit SL, Prospect, Q, Renew, Sense, Soft Pad, Stackable, Stackable Storage, Striad, Swoop, Tone, TriFlex, Twist, Ubi, Verus and Wireframe are among the trademarks of Herman Miller, Inc., and its owned subsidiaries.

SM Herman Miller Options is among the service marks of Herman Miller, Inc.

Alexander Girard® is a registered trademark of The Alexander Girard Estate.

Chemsurf® is a registered trademark of Wilsonart International.

Corian® is a registered trademark of E. I. du Pont de Nemours and Company Corporation.

Crypton® is a registered trademark of Crypton, Inc.

DACRON® is a registered trademark of INVISTA S.a r.l.

Edelman® Leather is a registered trademark of Edelman Leather, Inc.

FENIX NTM® is a registered trademark of Arpa Industriale S.p.A.

FLEXNET™ is a trademark of Milliken & Company.

Floor Saver Glide® is a registered trademark of Carpin Manufacturing, Inc.

Geiger® is a registered trademark, and Bumper™, Saiba™, and Ward Bennett™ are trademarks, of Geiger International.

Goetz™ is a trademark of Mark W. Goetz.

Hang-It-All® is a registered trademark of Lucia Eames Demetrios, d.b.a. Eames Office.

Holophane® is a registered trademark of Holophane.

Ingeo™ is a trademark of Cargill Dow LLC.

iPad® is a registered trademark of Apple, Inc.

LifeSize® is a registered trademark of LifeSize Communications, Inc.

Magis®, Bombo®, and Me Too® are registered trademarks of Magis S.p.A.

Microsoft® and Natural® Keyboard are registered trademarks of Microsoft Corporation.

Noguchi® and the Noguchi table configuration (trade dress) are registered trademarks, and Rudder Table™ is a trademark, of The Isamu Noguchi Foundation and Garden Museum.

Place Textiles® is a registered trademark of Place Textiles.

SuperSeat™ is a trademark of Dahti Seating, a division of ITW.