

## Expanse M12 T-code sensor cable connector kit

With the new Expanse cable connector kit, you can terminate Expanse sensor cables in the field. This makes installation easier than ever, because it's now possible to pull the cable through conduit from either end and terminate the cable into this connector when you're done.

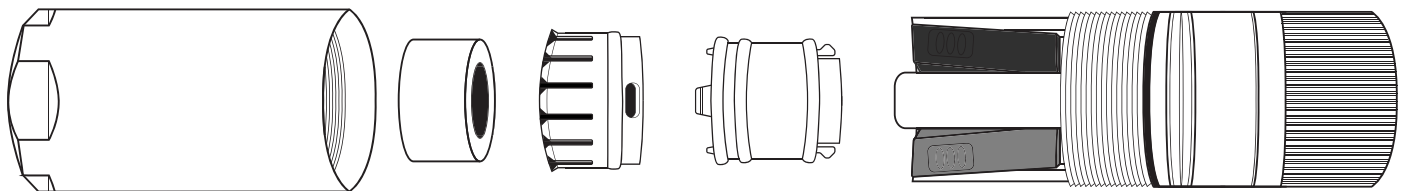

- Compatible with the Expanse Link Cable, Expanse Link S Cable, and equivalent third-party cables
- Cable conductors can be easily stripped and terminated in the field
- Cable connector can be connected using two wrenches (20 mm and 21 mm)
- Terminating the cable conductors in the field makes it easier to buy cable in bulk and cut it to size, and to pull the cable through conduit from whichever end will be most convenient for your installation
- Can accommodate cables from 3–11 mm in diameter
- Connector is keyed to the connector on Expanse sensors, to ensure proper installation
- Watertight to IP65 standard
- Kit includes two rubber seals to accommodate different sizes of cables
- One connector is included with each sensor order; connectors can also be purchased separately as needed



## Expanse Cable Connector technical specifications

### Physical properties

- Physical dimensions: 2.68 in. × 0.91 in. (68 mm × 23 mm)
- Weight: 0.20 lbs (90.95 g)
- Back shell/Front shell material: Nickel-plated brass
- Included components:
  - Small rubber seal: 0.24–0.31 in. (6–8 mm)
  - Large rubber seal: 0.31–0.43 in. (8–11 mm)

### Operating conditions

- Temperature range: -40°F to 185°F (-40°C to 85°C)

### Connections

- Gold contact surfaces
- Push-lock spring connection
- Connector terminable in field

### Communication

- Cable diameter range: 0.24–0.43 in. (6–11 mm)
- Accepted wire gauge: 16–14 AWG (without ferrule)

### Testing

- IP65

### Support

- Extended support options available; contact a Wavetronix representative for more information
- Comprehensive user guide

### Warranty

- Five-year warranty against material and workmanship defect

## Ordering information

Expanse Cable Connector  
**101-0481**

### Optional accessories (sold separately)

**101-0468/0469/0470** – Expanse Link Cable,  
5000'/1000'/500' spool

**101-0463/0464/0465** – Expanse Link S Cable,  
5000'/1000'/500' spool

### Contact us

801.734.7200  
sales@wavetronix.com  
www.wavetronix.com