

APPLICATION FOR MULTIPLE COMPLETION

Field Name Gwinville County Jefferson Davis Date 4-15-71
 Operator James W. Harris Lease Gwinville Gas Unit 119 Well No. 1

Location of Well 660' S of N/L and 660' E of W/L of NE $\frac{1}{4}$ of NW $\frac{1}{4}$ of Section 35, T9N, R19W

1. Have the reservoirs herein requested to be used for multiple completion heretofore been approved for multiple completion by the Board after notice and hearing? All except the 11,350' Paluxy Pool
2. Identify one instance (operator, lease, well number) wherein the _____ granted multiple completion involving these same reservoirs in this field.

3. The following facts are submitted:

	Upper Zone	Intermediate Zone	Lower Zone
a. Name of reservoir	<u>11,100' Paluxy Pool</u>	<u>Not Defined</u>	<u>11,970' Paluxy Pool</u>
b. Top and bottom of pay section (perforations)	<u>10,908, 10,934</u>	<u>11,352, 11,362</u>	<u>11,708, 11,849</u>
c. Type of production (Oil or Gas)	<u>Gas</u>	<u>Gas</u>	<u>Gas</u>
d. Method of Production (Flg. or Art. Lift)	<u>Flowing</u>	<u>Flowing</u>	<u>Flowing</u>

4. The following are attached. (Please mark YES or NO)

Yes a. Electrical log or other acceptable log with tops and bottoms of producing zones and perforated intervals shown and marked.

Yes b. Packer Setting Report.

Yes c. Diagrammatic Sketch of Multiple Completion Installation.

Yes d. Packer Leakage Test.

Yes e. Plat showing the location of all wells on applicant's lease, all offset wells on offset leases and the names and addresses of operators of all leases off-setting applicant's lease.

5. List all offset operators to the lease on which this well is located together with their correct mailing address.

Humble Oil & Refining Company, P. O. Box 16626, New Orleans, Louisiana 70160

Gulf Oil Corporation, P. O. Box 1269, Jackson, Mississippi, 39205

James W. Harris, P. O. Box 1027, Jackson, Mississippi, 39205

6. Yes The operators listed in Item 5 above have been notified and furnished a copy of this application. (Yes or No)
 Date furnished 4-30-71

7. No Waivers consenting to such multiple completion from each of the above offset operators attached. (Yes or No)

8. No Copies of letters requesting such waivers from each of these offset operators attached, in lieu of waivers. (Yes or No)

Executed this the 4th day of May, 19 71
 State of Mississippi
 County of Hinds

Wilbur R. Lilly
 Signature of Affiant

Before me, the undersigned authority, on this day personally appeared Wilbur R. Lilly known to me to be the person whose name is subscribed to the above instrument, who being by me duly sworn on oath states, that he is duly authorized to make the above report and that he has knowledge of the facts stated therein, and that said report is true and correct.

Subscribed and sworn to before me this 4th day of May, 19 71

Lucy M. Ruffin
 Notary Public in and for Hinds
 County, Mississippi

SEAL
 My commission expires My Commission Expires June 17, 1974

Said application shall accompany petition for hearing before the State Oil and Gas Board.

RECEIVED MAY 13 1971 STATE OIL & GAS BOARD	MISSISSIPPI STATE OIL AND GAS BOARD
	Application for Multiple Completion
	FORM 6-a - IOCC P-3
	Authorized by Order No. 118-58 Effective November 1, 1958

APPLICATION FOR PERMIT TO DRILL, WORKOVER OR CHANGE OPERATOR

APPLICATION TO DRILL ☐ WORKOVER ☒ CHANGE OPERATOR ☐

DATE May 23, 1973

NAME OF COMPANY OR OPERATOR

JAMES W. HARRIS PRODUCTION CORPORATION

Address City State
1840 Capital Towers Jackson Mississippi

DESCRIPTION OF WELL AND LEASE

Name of lease Well number Elevation (ground)
Gwinville Gas Unit 119 1 502

Well location (give footage from section lines) Section—township—range or block & survey
660' South of North Line & 660' East of West Line NE 1/4 NW 1/4 35-9N-19W

Field & reservoir (If wildcat, so state) County
Gwinville-Paluxy Jefferson Davis

Check the type of proposed well Oil Gas ☒ Other (Name)

Nearest distance from proposed location to drilling unit line Distance from proposed location to nearest drilling, completed or applied—for well
660' feet 350' feet

Proposed depth: Proposed length of Approx. date work will start
feet surface casing feet May 25, 1973

Number of acres in drilling unit Name of drilling contractor Deepwell Service Company
Address P. O. Box 12 City Columbia State Ms.

STATE OIL AND GAS BOARD OFFICES: P. O. Box 181, Natchez, Miss. Tel. 445-5041
P. O. Box 2782 CS, Laurel, Miss. Tel. 428-4044
P. O. Box 1332, Jackson, Miss. Tel. 354-7104 or 354-7108

NOTE: Notify nearest field office or Jackson office on dates of spudding and reaching total depth.

Remarks: (If this is an application for workover, briefly describe work to be done, giving present producing zone and expected new producing zone)

It is proposed to squeeze perforations in the 11,970' Paluxy Pool, 11,350' Paluxy Pool and 11,100' Paluxy Pool; then reperforate and test the 11,970' and 11,100' Paluxy Pools and perforate the 11,800' Washita-Fredericksburg Pool from 10,516-30'.
10,800
10,700

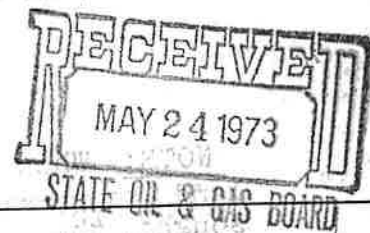

Executed this the 23 day of May, 1973
State of Mississippi
County of Hinds

Signature of Affiant
Wilbur R. Lilly

Wilbur R. Lilly

Before me, the undersigned authority, on this day personally appeared _____ known to me to be the person whose name is subscribed to the above instrument, who being by me duly sworn on oath states, that he is duly authorized to make the above report and that he has knowledge of the facts stated therein, and that said report is true and correct.

Subscribed and sworn to before me this 23 day of May

Signature of Notary Public
Lucy M. Ruffin
Notary Public in and for Hinds County, Mississippi

SEAL
My commission expires June 17, 1974

MISSISSIPPI STATE OIL AND GAS BOARD

Form No. 2
A P I Well Number
State County Well

Permit Number: W.O. # 193
Approval Date: 5-24-75
Approved: Quincy R. Hodges/By JCO
Notice: Before sending in this form be sure that you have given all information requested.

See Instructions on Reverse Side of Form

MISSISSIPPI STATE OIL & GAS BOARD

WELL COMPLETION OR RECOMPLETION REPORT AND WELL LOG

Form No. 3

DESIGNATE TYPE OF COMPLETION:

New Well ☐ Work-Over ☒ Deepen ☐ Plug Back ☐ Same Reservoir ☐ Different Reservoir ☐ Oil ☐ Gas ☐ Dry ☐

DESCRIPTION OF WELL AND LEASE

Operator JAMES W. HARRIS PRODUCTION CORP.		Address 1840 Capital Towers, Jackson, Ms.	
Lease Name Gwinville Gas Unit 119		Well Number 1	Field & Reservoir Gwinville-Wash.-Fred
Location 660' South of North Line & 660' East of West Line of NE$\frac{1}{4}$ NW$\frac{1}{4}$ 35-9N-19W			
County Jefferson Davis	Permit number WO 79	Date Issued 2/5/75	Previous permit number
Date spudded	Date total depth reached	Date completed, ready to produce	Elevation (DF, RKB, RT or Gr.) feet
Total depth	P.B.T.D. 10,680	Single, dual or triple completion? Single	If this is a dual or triple completion, furnish separate report for each completion.
Producing interval (s) for this completion None		Rotary or cable tools used (interval)	Drilling Contractor
Was this well directionally drilled?	Was directional survey made?	Was copy of directional survey filed?	Date filed
Type of electrical or other logs run (check logs filed with the commission)			Date filed

CASING RECORD

Casing (report all strings set in well—conductor, surface, intermediate, producing, etc.)

Purpose	Size hole drilled	Size casing set	Weight (lb./ft.)	Depth set

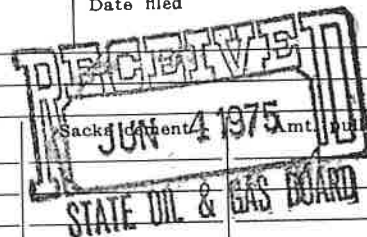

TUBING RECORD

LINER RECORD

Size	Depth set	Packer set at	Size	Top	Bottom	Sacks cement	Screen (ft.)
2-3/8 in.	10,483 ft.	10,483 Top	in.	ft.	ft.		

PERFORATION RECORD

ACID, SHOT, FRACTURE, CEMENT SQUEEZE RECORD

Number per ft.	Size & type	Depth Interval	Am't. & kind of material used	Depth Interval
4	1-1/16" Tub. Jet	10,517-31	90 sx. Cl. H Cmt.	10,517-31

INITIAL PRODUCTION

Date of first production 5/26/75		Producing method (indicate if flowing, gas lift or pumping—if pumping, show size & type of pump:) Swabbing				
Date of test 5/26/75	Hrs. tested 8	Choke size OH	Oil prod. during test 0 bbls.	Gas prod. during test 0 MCF	Water prod. during test 50 bbls.	Oil gravity * API (Corr)
Tubing pressure 0	Casing pressure 0	Cal'd rate of Production per 24 hrs.	Oil 0 bbls.	Gas 0 MCF	Water 150 bbls.	Gas-oil ratio

Disposition of gas (state whether vented, used for fuel or sold):

For Sour Gas or Oil Amount H₂S: Amount CO₂:

Executed this the **2nd** day of **June**, 19 **75**
 State of **MISSISSIPPI**
 County of **HINDS**

Signature of Affiant

Before me, the undersigned authority, on this day personally appeared **Wilbur R. Lilly** known to me to be the person whose name is subscribed to the above instrument, who being by me duly sworn on oath states that he is duly authorized to make the above report and that he has knowledge of the facts stated therein, and that said report is true and correct.

Subscribed and sworn to before me this **2nd** day of **June**, 19 **75**

Notary Public in and for **Hinds** County, **Mississippi**

SEAL My Commission Expires **June 17, 1978**
 My commission expires

Casing tests as required by Statewide Rules 11 and 12 must be made.

APPLICATION FOR PERMIT TO DRILL, WORKOVER OR CHANGE OPERATOR

APPLICATION TO DRILL ☒

WORKOVER ☐

CHANGE OPERATOR ☐

DATE 4-15-71

NAME OF COMPANY OR OPERATOR

James W. Harris

Address

P. O. Box 1027

City

Jackson

State

Miss. 39205

DESCRIPTION OF WELL AND LEASE

Name of lease

Gwinville Gas Unit 119

Well number

1

Elevation (ground)

502

Well location

(give footage from section lines)

Section--township--range, or block & survey

660' S of N/L + 660' E of W/L of NE/4 of NW/4

35 - 9N - 19W

Field & reservoir (If wildcat, so state)

Gwinville - 11,350' Paluxy Pool

County

Jefferson Davis

Check the type of proposed well Oil ☐ Gas ☒ Other (Name) _____

Nearest distance from proposed location to drilling unit line

660 feet

Distance from proposed location to nearest drilling, completed or applied for well

300 feet

Proposed depth:

12,600 feet

Proposed length of

surface casing 1,708 feet

Approx. date work will start

4-1-71

Number of acres in drilling unit

320

Name of drilling contractor

Larco Drilling and Exploration Co.

Address

City Jackson

State Miss.

STATE OIL AND GAS
BOARD OFFICES:

P. O. Box 181
NATCHEZ, MISS.
Tel. 445-5041

P. O. Box 2782 CS
LAUREL, MISS.
Tel. 428-4044

P. O. Box 1332
JACKSON, MISS.
Tel. 355-9361; Ext. 301 or 303

NOTE: Notify nearest field office or Jackson office on dates of spudding and reaching total depth.

Remarks: (If this is an application to workover, briefly describe work to be done, giving present producing zone and expected new producing zone)

Docket No. 101-71-9
Order No. 128-71

Executed this the 15 day of April, 1971.
State of Mississippi }
County of Rankin }

Wilbur R. Lilly
Signature of Affiant

Wilbur R. Lilly

Before me, the undersigned authority, on this day personally appeared _____ known to me to be the person whose name is subscribed to the above instrument, who being by me duly sworn on oath states, that he is duly authorized to make the above report and that he has knowledge of the facts stated therein, and that said report is true and correct.

Subscribed and sworn to before me this 15 day of April, 1971

Terrell A. Jekin
Notary Public in and for Rankin

SEAL

My commission expires _____

County, Mississippi

Permit Number:

499

Approval Date:

5-27-71

Approved By:

J. F. BORTHWICK, JR./By *RBW*

Notice: Before sending in this form be sure that you have given all information requested.

See Instructions on Reverse Side of Form

MISSISSIPPI STATE OIL AND GAS BOARD

Form No. 2

A P I Well Number

State

23

County

065

Well

20029

APPLICATION FOR PERMIT TO DRILL, WORKOVER OR CHANGE OPERATOR

APPLICATION TO DRILL ☒

WORKOVER ☐

CHANGE OPERATOR ☐

NAME OF COMPANY OR OPERATOR James W. Harris

DATE 4-15-71

P. O. Box 1027

Jackson

Mississippi 39205

Address

City

State

DESCRIPTION OF WELL AND LEASE

Name of lease Gwinville Gas Unit 119 Well number 1 Elevation (ground) 502

Well location (give footage from section lines) 660' S of N/L + 660' E of W/L of NE/4 of SE/4 Section—township—range or block & survey 35 - 9N - 19W

Field & reservoir (If wildcat, so state) Gwinville - 11,100' Paluxy Pool County Jefferson Davis

Check the type of proposed well Oil Gas ☒ Other (Name) _____

Nearest distance from proposed location to drilling unit line 660 feet Distance from proposed location to nearest drilling, completed or applied for well 300 feet

Proposed depth: 12,600 feet Proposed length of surface casing 1,708 feet Approx. date work will start 4-1-71

Number of acres in drilling unit 320 Name of drilling contractor Larco Drilling & Exploration Co.

Address _____ City Jackson State MS

STATE OIL AND GAS BOARD OFFICES:

P. O. Box 181
NATCHEZ, MISS.
Tel. 445-5041

P. O. Box 2782 CS
LAUREL, MISS.
Tel. 428-4044

P. O. Box 1332
JACKSON, MISS.
Tel. 355-9361; Ext. 301 or 303

NOTE: Notify nearest field office or Jackson office on dates of spudding and reaching total depth.

Remarks: (If this is an application to workover, briefly describe work to be done, giving present producing zone and expected new producing zone)

Docket No. 101-71-9
Order No. 128-71

Executed this the 15 day of April, 1971
State of Mississippi
County of Rankin

RECEIVED
MAY 26 1971
STATE OIL & GAS BOARD
Signature of Affiant Wilbur R. Lilly

Before me, the undersigned authority, on this day personally appeared Wilbur R. Lilly known to me to be the person whose name is subscribed to the above instrument, who being by me duly sworn on oath states, that he is duly authorized to make the above report and that he has knowledge of the facts stated therein, and that said report is true and correct.

Subscribed and sworn to before me this 15 day of April, 1971

SEAL

My commission expires _____

Notary Public in and for Rankin County, Mississippi

Permit Number:

Approval Date:

Approved By:

Notice: Before sending in this form be sure that you have given all information requested.

See Instructions on Reverse Side of Form

MISSISSIPPI STATE OIL AND GAS BOARD

Form No. 2

A P I Well Number

State

23

County

065

Well

20029

WELL COMPLETION OR RECOMPLETION REPORT AND WELL LOG

DESIGNATE TYPE OF COMPLETION:

New Well ☒ Work-Over ☐ Deepen ☐ Plug Back ☐ Same Reservoir ☐ Different Reservoir ☐ Oil ☐ Gas ☒ Dry ☐

DESCRIPTION OF WELL AND LEASE

Operator James W. Harris		Address P. O. Box 1027, Jackson, Mississippi	
Lease Name Gwinville Gas Unit No. 119-L		Well Number 1	Field & Reservoir Gwinville-11,970 Paluxy Pool
Location 660' S of N/L & 660' E of W/L of NE 1/4 of NW 1/4		Sec.-TWP-Range or Block & Survey 35 - 9N - 19W	
County Jefferson Davis	Permit number 283	Date Issued 12-7-70	Previous permit number --
Date spudded 1-1-71	Date total depth reached 2-9-71	Date completed, ready to produce 4-26-71	Elevation (DF, RKB, RT or Gr.) feet 514
Total depth 12,582	P.B.T.D. 12,147	Single, dual or triple completion? Triple	
Producing interval (s) for this completion Various-11,716 - 11,846		Rotary tools used (Interval) TD	Cable tools used (Interval) ---
Was this well directionally drilled? No	Was directional survey made? --	Was copy of directional survey filed? --	Date filed ---
Type of electrical or other logs run (check logs filed with the commission) Dual Induction-Laterolog (x) Formation Density		Filed by Schlumberger	

CASING RECORD

Casing (report all strings set in well—conductor, surface, intermediate, producing, etc.)

Purpose	Size hole drilled	Size casing set	Weight (lb./ft.)	Depth set	Sacks cement	Amt. pulled
Conductor	20"	16"	65	60'	To Surface	--
Surface	12"	10-3/4"	40.5	1709'	1920	--
Production	9"	7"	23, 26, 29	12,147'	1100	--

TUBING RECORD

LINER RECORD

Size	Depth set	Packer set at	Size	Top	Bottom	Sacks cement	Screen (ft.)
2-3/8 in.	11,552 ft.	11,552 ft.	in.	ft.	ft.		

PERFORATION RECORD

ACID, SHOT, FRACTURE, CEMENT SQUEEZE RECORD

Number per ft.	Size & type	Depth Interval	Amt. & kind of material used	Depth Interval
4	1-11/16 Tbg.	11,716-36; 11,794-806;	40,000# 20-40 sand	All Perfs.
		11,815-19; 11,827-29;	56,000 gals. of water	
		11,842-46		

INITIAL PRODUCTION

Date of first production 2-27-71		Producing method (Indicate if flowing, gas lift or pumping—if pumping, show size & type of pump:) Flowing					
Date of test 5-1-71	Hrs. tested 24	Choke size 11/64	Oil prod. during test 14 bbls.	Gas prod. during test 1400 MCF	Water prod. during test 40 bbls.	Oil gravity 46 ° API (Corr)	
Tubing pressure 2100	Casing pressure 0	Cal'ed rate of Production per 24 hrs. 14 bbls.	Oil 14 bbls.	Gas 1400 MCF	Water 40 bbls.	Gas-oil ratio 100,000/1	

Disposition of gas (state whether vented, used for fuel or sold):

Sold

Executed this the 4th day of May, 1971
 State of Mississippi
 County of Hinds

Wilbur R. Lilly
 Signature of Affiant

Wilbur R. Lilly

Before me, the undersigned authority, on this day personally appeared Wilbur R. Lilly known to me to be the person whose name is subscribed to the above instrument, who being by me duly sworn on oath states, that he is duly authorized to make the above report and that he has knowledge of the facts stated therein, and that said report is true and correct.

Subscribed and sworn to before me this 4th day of May, 1971

Leroy M. Ruffin
 Notary Public in and for Hinds
 County, Mississippi

SEAL

My Commission Expires June 17, 1974

Casing tests as required by Statewide Rules 11 and 12 must be made.

MISSISSIPPI STATE OIL AND GAS BOARD
 Well Completion or Recompletion Report and Well Log
 FORM 3 - IOCC P-7

Authorized by Order No. 118-58

Effective November 1, 1958

PACKER LEAKAGE TEST

Field Name

County

Gwinville

Jefferson Davis

Operator

Address

James W. Harris

P. O. Box 1027, Jackson, Mississippi

Lease

Well Number

Location 660' S of N/L & 660' E of W/L of NE $\frac{1}{4}$ of NW $\frac{1}{4}$
Section 35, T9N, R19W

Gwinville Gas Unit 119

1

TEST NO. 1

Well Shut In Date	Time	Completion Producing (Indicate Casing or Tubing)	Reservoir	Completion Shut In (Indicate Casing or Tubing)	Reservoir
4-28-71	7:00 A. M.	2" Tubing	11,970	2" Tubing	11,350 & 11,100

DATA ON PRODUCING COMPLETION **GGU 119-L**

Stabilized Shut In Pressure Prior to Test (P.S.I.)	Producing Completion—Well Opened Date	Time	Choke Size (Inches)	Stabilized Flowing Pressure During Test (P.S.I.)
2500	4-29-71	7:00 A. M.	11/64	2150

Time Required For Stabilization of Flowing Pressure (HRS)	Stabilized Shut In Pressure At End of Test (P.S.I.)	Time Required For Obtaining This Stabilized Shut In Pressure (HRS)
2	2150	3

DATA ON SHUT IN COMPLETION

Stabilized Shut In Pressure Prior To Test (P.S.I.)	Shut In Pressure During Test: Minimum (P.S.I.)	Maximum (P.S.I.)	Stabilized Shut In Pressure at the End of Test: (P.S.I.)
119-M 3400; 119-U 3900	Same	Same	Same—No Changes in Shut In Pressures

Length of Time Required For Obtaining Stabilized Pressure at End of Test (HRS.)	Maximum Pressure Change of Shut-In Completion During Test Increase (P.S.I.)	Decrease (P.S.I.)
	No Change	No Change

TEST NO. 2

Well Shut In Date	Time	Completion Producing (Indicate Casing or Tubing)	Same Well-Bore as Test No. 1 But With: And Completion Shut In (Indicate Casing or Tubing)
4-28-71	7:00 A. M.	2" Tubing - 11,350' zone	2" Tubing 11,950' zone; 1 $\frac{1}{2}$ " tubing 11,100' zone

DATA ON PRODUCING COMPLETION **GGU 119-M**

Stabilized Shut In Pressure Prior to Test (P.S.I.)	Producing Completion—Well Opened Date	Time	Choke Size (Inches)	Stabilized Flowing Pressure During Test (P.S.I.)
3400	7-30-71	1:00 P. M.	11/64	2700

Time Required For Stabilization of Flowing Pressure (HRS)	Stabilized Shut In Pressure at End of Test (P.S.I.)	Time Required for Obtaining This Stabilized Shut In Pressure (HRS)
4	3400	2

DATA ON SHUT IN COMPLETION

Stabilized Shut In Pressure Prior to Test (P.S.I.)	Shut In Pressure During Test: Minimum (P.S.I.)	Maximum (P.S.I.)	Stabilized Shut In Pressure At The End of Test (P.S.I.)
11,970'-2500#; 11,100'-3900#	Same	Same	No Change

Length of Time Required For Obtaining Stabilized Pressure at End of Test (Hrs)	Maximum Pressure Change of Shut In Completion During Test: Increase (P.S.I.)	Decrease (P.S.I.)
	No change	No change

Class of Completion Testing, Whether Oil Well or Gas Well: Tubing

Was The Notified of Test 24 Hours Prior to The Shut In of Both Completions At The Start of Test (Yes or No)

Gas - 3 tubing strings

(SEE SECOND SHEET FOR REMAINDER OF TEST)

Executed this the day of 1971

State of Mississippi

County of Hinds

Signature of Affiant

Before me, the undersigned authority, on this day personally appeared William R. Lacey known to me to be the person whose name is subscribed to the above instrument, who being by me duly sworn on oath states, that he is duly authorized to make the above report and that he has knowledge of the facts stated therein, and that said report is true and correct.

Subscribed and sworn to before me this 12 day of May 1971

SEAL

My Commission Expires June 17, 1974

My commission expires

Notary Public in and for

County, Hinds

The undersigned representative of the (witnessed and/or checked) the foregoing test.

Representative

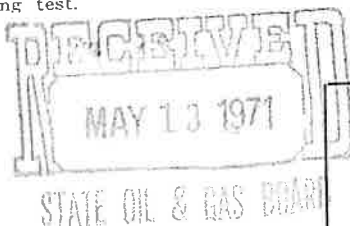

MISSISSIPPI STATE OIL AND GAS BOARD

Packer Leakage Test

FORM 6-c - IOCC P-5

Authorized by Order No. 118-58

Effective November 1, 1958

PACKER LEAKAGE TEST(Continued)

Page 2

Field Name Gwinville County Jefferson Davis
 Operator James W. Harris Address P. O. Box 1027, Jackson, Mississippi
 Lease Gwinville Gas Unit 119 Well Number 1 Location

TEST NO. 3

Well Shut In Date 4-28-71 Time 7:00 A. M. Completion Producing (Indicate Casing or Tubing) Tubing Reservoir 11,100' Paluxy Completion Shut In (Indicate Casing or Tubing) Tubing Reservoir 11,970' & 11,350'

DATA ON PRODUCING COMPLETION GGU 119-U

Stabilized Shut In Pressure Prior to Test (P.S.I.) <u>3900#</u>	Producing Completion—Well Opened Date <u>5-1-71</u>	Time <u>6:00 P. M.</u>	Choke Size (Inches) <u>11/64</u>	Stabilized Flowing Pressure During Test (P.S.I.) <u>3400#</u>
Time Required For Stabilization of Flowing Pressure (Hrs) <u>1 1/2</u>	Stabilized Shut In Pressure At End of Test (P.S.I.) <u>3900</u>		Time Required For Obtaining This Stabilized Shut In Pressure (HRS) <u>45 minutes</u>	

DATA ON SHUT IN COMPLETION

Stabilized Shut In Pressure Prior To Test (P.S.I.) <u>11,970' - 2500; 11,350' - 3400</u>	Shut In Pressure During Test: Minimum (P.S.I.) <u>Same</u>	Maximum (P.S.I.) <u>Same</u>	Stabilized Shut In Pressure at the End of Test: (P.S.I.) <u>No Change</u>
Length of Time Required For Obtaining Stabilized Pressure at End of Test (HRS.)	Maximum Pressure Change of Shut-In Completion During Test Increase (P.S.I.) <u>No change</u>		Decrease (P.S.I.) <u>No change</u>

TEST NO. 2

Well Shut In Date Time Completion Producing (Indicate Casing or Tubing) Same Well-Bore as Test No. 1 But With: Completion Shut In (Indicate Casing or Tubing)

DATA ON PRODUCING COMPLETION

Stabilized Shut In Pressure Prior to Test (P.S.I.)	Producing Completion—Well Opened: Date <u></u>	Time <u></u>	Choke Size (Inches) <u></u>	Stabilized Flowing Pressure During Test (P.S.I.)
Time Required for Stabilization of Flowing Pressure (HRS)	Stabilized Shut In Pressure at End of Test (P.S.I.)		Time Required for Obtaining This Stabilized Shut In Pressure (HRS)	

DATA ON SHUT IN COMPLETION

Stabilized Shut In Pressure Prior to Test (P.S.I.)	Shut In Pressure During Test: Minimum (P.S.I.) <u></u>	Maximum (P.S.I.) <u></u>	Stabilized Shut In Pressure At The End of Test (P.S.I.)
Length of Time Required For Obtaining Stabilized Pressure at End of Test (Hrs)	Maximum Pressure Change of Shut In Completion During Test: Increase (P.S.I.) <u></u>		Decrease (P.S.I.) <u></u>
Class of Completion Testing, Whether Oil Well or Gas Well: Tubing	Was The 24 Hours Prior to The Shut In of Both Completions At The Start of Test (Yes or No)		<u></u>

Executed this the 4th day of May, 19 71

State of Mississippi

County of Hinds

Signature of Affiant

Before me, the undersigned authority, on this day personally appeared Wilbur R. Lilly known to me to be the person whose name is subscribed to the above instrument, who being by me duly sworn on oath states, that he is duly authorized to make the above report and that he has knowledge of the facts stated therein, and that said report is true and correct.

Subscribed and sworn to before me this 4th day of May, 19 71

SEAL My Commission Expires June 17, 1974
 My commission expires

Notary Public in and for Hinds
 County, Mississippi

The undersigned representative of the (witnessed and/or checked) the foregoing test.

Representative

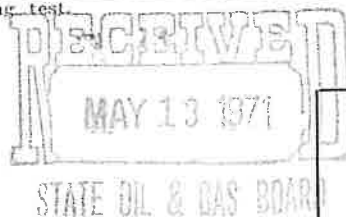

MISSISSIPPI STATE OIL AND GAS BOARD

Packer Leakage Test
 FORM 6-c - IOCC P-5

Authorized by Order No. 118-58

Effective November 1, 1958

WELL COMPLETION OR RECOMPLETION REPORT AND WELL LOG

DESIGNATE TYPE OF COMPLETION:

New Well ☒ Work-Over ☐ Deepen ☐ Plug Back ☐ Same Reservoir ☐ Different Reservoir ☐ Oil ☐ Gas ☒ Dry ☐

DESCRIPTION OF WELL AND LEASE

Operator James W. Harris		Address P. O. Box 1027, Jackson, Mississippi	
Lease Name Gwinville Gas Unit No. 119-M		Well Number 1	Field & Reservoir Gwinville - 11,300' Paluxy
Location 660' S of N/L and 660' E of W/L of NE ¹ / ₄ of NW ¹ / ₄		Sec.—TWP—Range or Block & Survey 35 - 9N - 19W	
County Jefferson Davis	Permit number 283	Date Issued 12-7-70	Previous permit number --
Date spudded 1-1-71	Date total depth reached 2-9-71	Date completed, ready to produce 4-26-71	Elevation (DF, RKB, RT or Gr.) feet 514
Total depth 12,582	P.B.T.D. 12,147	Single, dual or triple completion? Triple	
Producing interval (s) for this completion 11,352-60		Rotary tools used (Interval) TD	
Was this well directionally drilled? No		Was directional survey made? --	
Type of electrical or other logs run (check logs filed with the commission) Dual Induction-Latero Log (x) Formation Density		Cable tools used (Interval) MAY 16 1971	
		Date filed --	
		STATE OIL & GAS BOARD Filed by Schlumberger	

CASING RECORD

Casing (report all strings set in well—conductor, surface, intermediate, producing, etc.)

Purpose	Size hole drilled	Size casing set	Weight (lb./ft.)	Depth set	Sacks cement	Amt. pulled
Conductor	20"	16"	65	60'	To Surface	--
Surface	12"	10-3/4"	40.5	1709	1920	--
Production	9"	7"	23, 26, 29	12,147	1100	--

TUBING RECORD

LINER RECORD

Size	Depth set	Packer set at	Size	Top	Bottom	Sacks cement	Screen (ft.)
2-3/8 in.	11,275 ft.	11,275 ft.	in.	ft.	ft.		

PERFORATION RECORD

ACID, SHOT, FRACTURE, CEMENT SQUEEZE RECORD

Number per ft.	Size & type	Depth Interval	Amt. & kind of material used	Depth Interval
4	3 1/4" Shaped	11,443-5; 451-53; 460-61	Sqzd. w/125 sx.	All perfs.
4	3 1/4" Shaped	11,352-60; 11,422-30;	Fracture 16,400 gals.	10,000# 10/40 Sand
		11,352-60		

INITIAL PRODUCTION

Date of first production 4-2-71		Producing method (Indicate if flowing, gas lift or pumping—if pumping, show size & type of pump:) Flowing					
Date of test 4-2-71	Hrs. tested 24	Choke size 17/64	Oil prod. during test 10 bbls.	Gas prod. during test 2500 MCF	Water prod. during test 0 bbls.	Oil gravity 48 ° API (Corr)	
Tubing pressure 2700	Casing pressure 0	Cal'd rate of Production per 24 hrs. 2500	Oil 10 bbls.	Gas 2500 MCF	Water 0 bbls.	Gas-oil ratio 250,000/1	

Disposition of gas (state whether vented, used for fuel or sold):

Executed this the 4th day of May, 1971
 State of Mississippi
 County of Hinds

Wilbur R. Lilly
 Signature of Affiant

Wilbur R. Lilly

Before me, the undersigned authority, on this day personally appeared _____ known to me to be the person whose name is subscribed to the above instrument, who being by me duly sworn on oath states, that he is duly authorized to make the above report and that he has knowledge of the facts stated therein, and that said report is true and correct.

Subscribed and sworn to before me this 4th day of May, 1971

Lucy M. Ruffin
 Notary Public in and for Hinds
 County, Mississippi

SEAL My Commission Expires June 17, 1974

Casing tests as required by Statewide Rules 11 and 12 must be made.

MISSISSIPPI STATE OIL AND GAS BOARD
 Well Completion or Recompletion Report and Well Log
 FORM 3 - IOCC P-7

Authorized by Order No. 118-58

Effective November 1, 1958

WELL COMPLETION OR RECOMPLETION REPORT AND WELL LOG

DESIGNATE TYPE OF COMPLETION:

New Well ☒ Work-Over ☐ Deepen ☐ Plug Back ☐ Same Reservoir ☐ Different Reservoir ☐ Oil ☐ Gas ☒ Dry ☐

DESCRIPTION OF WELL AND LEASE

Operator James W. Harris		Address P. O. Box 1027, Jackson, Mississippi	
Lease Name Gwinville Gas Unit No. 119-U		Well Number 1	Field & Reservoir Gwinville - 11,100' Paluxy
Location 660' S of W/L & 660' E of W/L of NE $\frac{1}{4}$ of NW $\frac{1}{4}$		Sec.-TWP-Range or Block & Survey 35 - 9N - 19W	
County Jefferson Davis	Permit number 283	Date Issued 12-7-70	Previous permit number --
Date spudded 1-1-71	Date total depth reached 2-9-71	Date completed, ready to produce 4-26-71	Elevation (DF, RKB, RT or Gr.) 514 feet
Total depth 12,582	P.B.T.D. 12,147	Single, dual or triple completion? Triple	
Producing interval (s) for this completion 10,908-918		Rotary tools used (interval) TD	Cable tools used (interval) MAY 06 1971
Was this well directionally drilled? No	Was directional survey made? --	Was copy of directional survey filed? --	Date filed --
Type of electrical or other logs run (check logs filed with the commission) Dual Induction-Latero Log (x) Formation Density		Filed by Schlumberger	

CASING RECORD

Casing (report all strings set in well—conductor, surface, intermediate, producing, etc.)

Purpose	Size hole drilled	Size casing set	Weight (lb./ft.)	Depth set	Sacks cement	Amt. pulled
Surface	12"	10-3/4"	40.5	1709	1920	--
Production	9"	7"		12,147	1100	
Conductor	20"	16"	65	60'	--	--

TUBING RECORD

Size	Depth set	Packer set at	Size	Top	Bottom	Sacks cement	Screen (ft.)
1 $\frac{1}{2}$ in.	10,862 ft.	10,862 ft.	in.	ft.	ft.		

PERFORATION RECORD

Number per ft.	Size & type	Depth Interval	Amt. & kind of material used	Depth Interval
4	3 $\frac{1}{2}$ " Shaped Chg.	10,909-19	4,000 gals., 10% Hcl and HF	10,909-19

INITIAL PRODUCTION

Date of first production 4-7-71		Producing method (indicate if flowing, gas lift or pumping—if pumping, show size & type of pump:) Flowing					
Date of test 4-8-71	Hrs. tested 24	Choke size N/64	Oil prod. during test 8 bbls.	Gas prod. during test 2400 MCF	Water prod. during test 0 bbls.	Oil gravity 46 ° API (Corr)	
Tubing pressure 3400	Casing pressure 0	Cal'd rate of Production per 24 hrs.	Oil 8 bbls.	Gas 2400 MCF	Water 0 bbls.	Gas-oil ratio 137,500/1	

Disposition of gas (state whether vented, used for fuel or sold):

Executed this the 4th day of May, 19 71
 State of Mississippi
 County of Hinds

Wilbur R. Lilly
 Signature of Affiant

Before me, the undersigned authority, on this day personally appeared Wilbur R. Lilly known to me to be the person whose name is subscribed to the above instrument, who being by me duly sworn on oath states, that he is duly authorized to make the above report and that he has knowledge of the facts stated therein, and that said report is true and correct.

Subscribed and sworn to before me this 4th day of May, 19 71

Lucy M. Luff
 Notary Public in and for Hinds
 County, Mississippi

SEAL

My commission expires June 17, 1974

Casing tests as required by Statewide Rules 11 and 12 must be made.

MISSISSIPPI STATE OIL AND GAS BOARD
 Well Completion or Recompletion Report and Well Log
 FORM 3 - IOCC P-7

Authorized by Order No. 118-58

Effective November 1, 1958

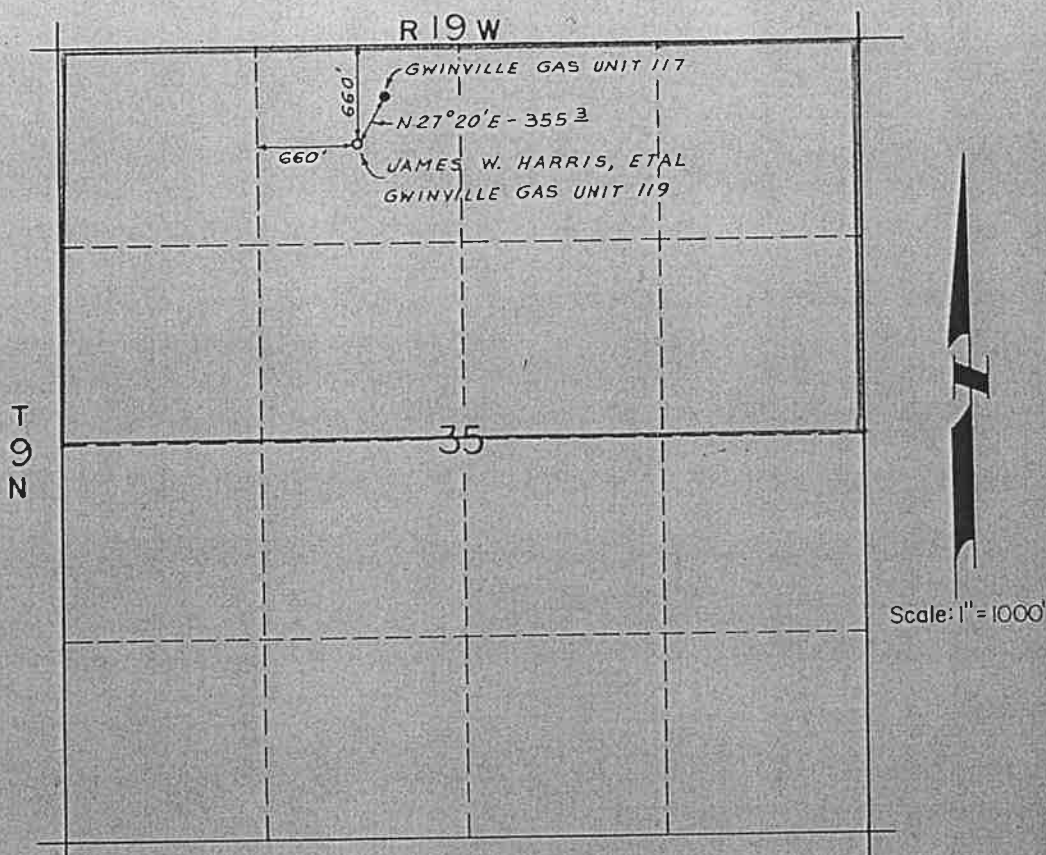

LOCATION PLAT OF

JAMES W. HARRIS, ETAL
GWINVILLE FIELD

GWINVILLE GAS UNIT 119
JEFFERSON DAVIS COUNTY, MISS.

LOCATION: Located 660 ft. South of the North Line and 660 ft. East of the West Line of the NE 1/4 of the NW 1/4 of Section 35, T 9 N, R 19 W - Jefferson Davis County, Miss.

DRILLING UNIT: The Gwinville Gas Unit No. 119

North 320 Acres Sec. 35 - T9N - R19W.

CERTIFICATION: This is to certify that I, L. A. Conerly, have staked the well location shown on this plat and that it is correct to the best of my knowledge.

Dated at Laurel, Miss. this the
1st day of December 1970.

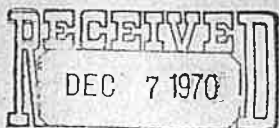

STATE OIL & GAS BOARD

L. A. Conerly
L. A. Conerly, Reg. P. E. No. 631

APPLICATION FOR PERMIT TO DRILL, WORKOVER OR CHANGE OPERATOR

APPLICATION TO DRILL ☒WORKOVER ☐CHANGE OPERATOR ☐

NAME OF COMPANY OR OPERATOR

DATE December 4, 1970

JAMES W. HARRIS et al

Address

P. O. Box 1027

City

Jackson

State

Mississippi

DESCRIPTION OF WELL AND LEASE

Name of lease

Gwinville Gas Unit 119

Well number

#1

Elevation (ground)

Well location

(give footage from section lines)

Section—township—range or block & survey

660' S of NL & 660' E of WL NE $\frac{1}{4}$ NW $\frac{1}{4}$

35

9N

19W

Field & reservoir (If wildcat, so state)

Gwinville Field - Paluxy

County

Jefferson Davis

Check the type of proposed well Oil ☐ Gas ☒

Other (Name)

Nearest distance from proposed location to drilling unit line

660

feet

Distance from proposed location to nearest drilling, completed or applied—for well

355

feet

Proposed depth:

12,000

feet

Proposed length of

surface casing

1800

feet

Approx. date work will start

12-15-70

Number of acres in drilling unit:

320 (N $\frac{1}{2}$ of Section 35)

Name of drilling contractor

Unknown

Address

City

State

STATE OIL AND GAS
BOARD OFFICES:P. O. Box 181
NATCHEZ, MISS.
Tel. 445-5041P. O. Box 2782 CS
LAUREL, MISS.
Tel. 428-4044P. O. Box 1332
JACKSON, MISS.
Tel. 355-9361; Ext. 301 or 303

NOTE: Notify nearest field office or Jackson office on dates of spudding and reaching total depth.

Remarks: (If this is an application to workover, briefly describe work to be done, giving present producing zone and expected new producing zone)

This well will be on same North 320 acre unit of Gwinville Gas Unit #117 and #114; however, will be completed in separate reservoir from other wells.

Executed this the 4th day of December, 19 70.
State of Mississippi
County of Hinds

Before me, the undersigned authority, on this day personally appeared James W. Harris known to me to be the person whose name is subscribed to the above instrument, who being by me duly sworn on oath states, that he is duly authorized to make the above report and that he has knowledge of the facts stated therein, and that said report is true and correct.

Subscribed and sworn to before me this 4th day of December, 19 70.

SEAL

My commission expires My Commission Expires June 17, 1974

Lucy M. Ruffin
Notary Public in and for Hinds
County, Mississippi

Permit Number:

283

Approval Date:

12-7-70

Approved By:

J. F. BORTHWICK, JR./By AB

Notice: Before sending in this form be sure that you have given all information requested.

See Instructions on Reverse Side of Form

MISSISSIPPI STATE OIL AND GAS BOARD

Form No. 2

A P I Well Number

State

County

23

065

20029