

SEATING

Price List
USA 2017



logiflex

Update Summary

The March 31, 2017 revision of the Seating price list presents these principal modifications:

DATE	SECTION	MODIFICATION
March 31, 2017	All the price list	<ul style="list-style-type: none"> • Revamp of the entire price list; • Sedia has been moved from the Armchair section to the Seating section; • Addition of Madrid chairs and their new product codes; • New product page order; • Addition of Typical Layouts for Clara and Infiniti collections; • The Tables section has been removed and can be found in the Tables price list; • Decorative piping has been removed; • CAL 133, non-flammable lining has been removed; • SIT accessories are now found in the Accessories section at the end of end of the price list.
	Appendix	<ul style="list-style-type: none"> • Addition of Appendix A, color and finishes; • Addition of Appendix B, COM Fabrics; • Addition of Appendix C, SIT: Manufacturing Standards, Wire Management and Connectivity Position; • Addition of Appendix D, Madrid, Color Selection.
	SIT	<ul style="list-style-type: none"> • Addition of Color combinations illustrations

Previous updates:

DATE	SECTION	MODIFICATION
December 1, 2016	All the price list	<ul style="list-style-type: none"> • Repair of non-functional links and images in the price list.
	Deleted Products	<ul style="list-style-type: none"> • TRORF3, UTWL and Kalypso tables as well as MAW edges on UTPM.
April 15, 2016	Warranty	<ul style="list-style-type: none"> • Update of the Logiflex warranty.
	Clara	<ul style="list-style-type: none"> • In the COM fabric section: update of the yards quantities of fabric needed for CLA, CLAS, CLAD and CLAB.

SEATING

Price List
USA 2017

Table of Contents

Introduction	5	Modular Section	30	Chairs	101
Product Map	6	SIT - Bench	31	High Back - Varnished or Stained Wood	102
Conditions of Sale	8	SIT - Corner Bench	33	High Back - Varnished or Stained Wood with Cushion	103
How to Use the Price List	10	SIT - Bench with Privacy Panel	34	High Back - Upholstered	104
Appendix A: Colors and Finishes	25	SIT - Corner Bench with Privacy Panel	35	Low Back - Varnished or Stained Wood	105
Appendix B: COM Fabric	26	SIT - Occasional Tables with Privacy Panel	44	Low Back - Upholstered	106
Appendix C : SIT	28	SIT - Occasional Tables	53	Sedia Chairs	107
Appendix D : Madrid Color Selection	29	Clara	61		
		Infiniti	65	Accessories	109
		Armchair Section	73	Miscellaneous Accessories	110
		Alpha	74	Electrical Accessories	111
		Bulexi	77		
		Dean	80		
		Flint	83		
		Magog	86		
		Monro	88		
		Orford	90		
		Stelli	92		
		Taylor	98		

Introduction

Product Map

Modular

SIT - Bench p. 31



SIT - Corner Bench p. 33



SIT - Bench with Privacy Panels p. 34



SIT - Corner Bench with Privacy Panels p. 35

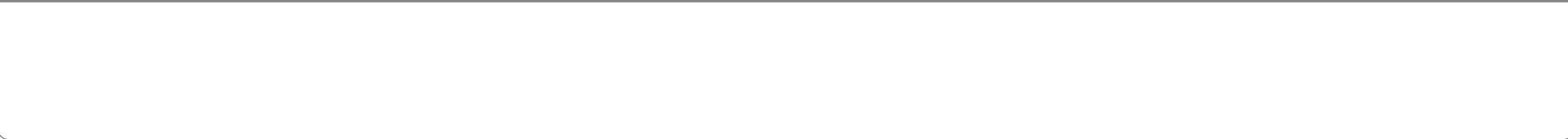

SIT - Occasional Tables with Privacy Panels p. 44



SIT - Occasional Tables p. 53



Fillers p. 110



Electrical Accessories p. 111



Clara p. 61



Infiniti p. 65



Introduction

Product Map

Armchairs

Alpha p. 74	Bulexi p. 77	Dean p. 80	Flint p. 83
Magog p. 86	Monro p. 88	Orford p. 90	Stelli p. 92
Taylor p. 98			

Seating

Madrid - dossier haut - bois p. 102	Madrid - dossier haut - bois avec coussin p. 103	Madrid - dossier haut - rembourré p. 104	Madrid - dossier bas - bois p. 105
Madrid - dossier bas - rembourré p. 106	Sedia p. 107		

Conditions of Sale

Prices

The amounts listed in this document are suggested retail prices and may be changed without notice. Applicable taxes are not included. If you have an open and active account with Logiflex, merchandise will be invoiced at the prices prevailing at the time of shipment. A deposit may be requested if the opening of your account has not been completed or if your account has become inactive.

Terms of Payment

Net 30 days F.O.B. Sherbrooke, Quebec. The invoice will be assigned the shipping date and is payable 30 days from that date. Logiflex remains the owner of the merchandise until the invoice is paid in full.

Customized Products (Special Items)

Price requests for customized products or special items can be submitted via the “[Online Services](#)” section of our website, at www.logiflex.ca. Our quotations department will study your request and send you a quotation and a technical drawing for approval as soon as possible. Modifications to quotations or technical drawings can be requested the same way. The approved quotation(s) and technical drawing(s) can then be attached to your purchase order.

Orders

An official purchase order must be issued for all purchases. Your purchase order must contain the following information:

- Your company letterhead
- Your reference number
- The delivery address (with contact name and phone number)
- The complete product codes
- Furniture colour(s)
- Quantities
- Descriptions
- Retail prices and net prices
- Project registration number (if applicable), and your approved quotation and technical drawing (for special items).

Please note that a quotation cannot serve as a purchase order.

Returns

All returns must first be approved by Logiflex. If the return is accepted, a Logiflex customer service representative will send you an official return authorization form in order to facilitate procedures between you, the carrier, and the Logiflex merchandise reception clerk. Additional costs for shipping or other expenses may be applied following any merchandise returns.

Modifications and/or Cancellations

You have 24 hours from the time we acknowledge receipt of your order to make any requests for corrections or modifications. You may cancel your order during this same 24-hour period. If you would like to modify or cancel your order after this 24-hour verification period, please check with a Logiflex customer service representative. Orders cannot be changed or cancelled if production has already begun or if Logiflex has already received the raw materials.

Liability

Logiflex's liability ends once the carrier has delivered all items in good condition. A delivery receipt signed by the customer acknowledges that the shipment is complete and has been received in good condition.

Claims

Logiflex recommends inspecting the shipment before signing the carrier's delivery receipt. You must notify Logiflex of any incomplete shipments or damaged furniture as soon as possible. Requests to replace damaged products can be made via the “[Online Services](#)” section of our website, at www.logiflex.ca. Our after-sales service department will examine your request and help you correct the situation.

Changes

Logiflex reserves the right to make changes to the materials, accessories, components, specifications and designs, and to discontinue collections and/or models, at any time and without prior notice.

Storage and/or Shipping Fees

If you would like to delay the delivery of an order already in production at Logiflex, weekly storage fees may be charged. The suggested retail prices in this list may include delivery; however, some conditions may apply. If your order is a minimum of \$10,000 net, the order can be shipped directly to your customer. In this case, a 53-foot unloading dock must be available at the time of delivery. This information must first be validated with your Logiflex customer service representative. Direct shipping is subject to additional fees. Any delay experienced by Logiflex carriers during delivery may also result in additional charges.

Conditions of Sale (continued)

Warranty

Logiflex warrants its products to the original purchaser for as long as the original purchaser owns the products. Logiflex guarantees that products bought new from an authorized Logiflex distributor are free from defects in materials and workmanship for the lifetime of their use. This warranty applies to all Logiflex products. Only if properly used, repair or replacement of any defect covered by the warranty will be at the discretion of Logiflex. Transportation and labor are not covered by this warranty. By accepting the product at its delivery, the buyer accepts its conditions. The warranty period shall be reduced proportionately if the products are used over a period exceeding the equivalent of a shift 40 hours/week. All replacement parts will be shipped to the original shipping address.

Limited Lifetime Warranty: Access, Knockout, Level, Logilife, Manhattan, Millenium, Reception and Tables (Conference, Occasional, Multimedias)

5 Year Warranty: Academic and Soft Seating

10 Year Warranty: Chairs

This warranty does not apply to defects or damages resulting from:

- Normal wear and tear occurring with the use of the product;
- Negligence, misuse, abuse or accident;
- Substitution, modification, transformation, repair, renovation or use of components or materials that have not been authorized by Logiflex;
- Renting to a third party;
- Natural properties of materials;
- For leather products: normal defects in leather such as: scars, marks or difference in stain within a leather skin or between different skins;
- Exposure to sunlight or environments with extreme temperature/humidity conditions;
- Damage caused by a carrier in transit, or delivery/ installation contractors.

This warranty does not include:

- Parts and materials supplied by the customer (COM);
- Special finishes applied to Logiflex products;
- The matching of colors, grains or textures of wood due to its natural properties;
- Non-standard Logiflex products;
- Logiflex product not installed or used in accordance with the Logiflex installation guidelines;
- Bulbs and ballasts.

Restrictions:

- 1 year warranty on electrical components;
- 5 year warranty on seat mechanisms, drawer slides and locks;
- 5 year warranty on urethane parts;
- 5 year warranty on upholstery and casters.

Introduction

How to Use the Price List

Interactive Menu

Product line → **Modular**

Product group → **Corner Bench with Corner Privacy Panel**

Product name → **CBP**

Product code → **CBP**

Product image →

Product Information →

Illustrated options →

Navigation Buttons (when blue) →

Ordering instructions →

Standard Product Code
Details as per the price listed

Options, if desired (\$)
Always after the product code

Combination of Colors
Laminate finishes and fabric choices

Navigation buttons
Previous View
Previous Page
Next Page
Product Map
Table of Contents

Product-specific manufacturing standards

Additional Product Information and Notes

Additional Product Information and Notes

Product Code

Prices

Blue text hyperlink

Manufacturing Standards

- 1" laminate privacy panel;
- Lacquered Russian plywood kick plate;
- 1" laminate construction;
- Velva firm density antibacterial foam;
- Single row of top stitching.

Fabric:
Fabric combination possible. Number of yards required:

Code	Total	Bench	Panel
CBP	2.5	2.5	-
CBFP	7	2.5	4.5

Note: It is recommend that you include a layout with all orders.

Prices

Code	COM	GR1	GR2	GR3	GR4	GR5	GR6
CBP	857	900	954	1008	1062	1116	
CBFP	1077	1221	1401	1581	1761	1941	

How to Order

SIT		CBP		CBFP		MH3C		MH3D		MH3C		MH3D		MH3C		MH3D		MH3C		MH3D	
series	code	panel fastener	panel orientation	connectivity	grommet position	panel	kick plate	supplier	pattern	color	panel	kick plate	supplier	pattern	color	panel	kick plate	supplier	pattern	color	
Example	SIT	CBP	L	L	MH3C	L	W	W	J. ENNIS	LOFT	34										

Introduction

Typical Layouts

SIT TYP-A

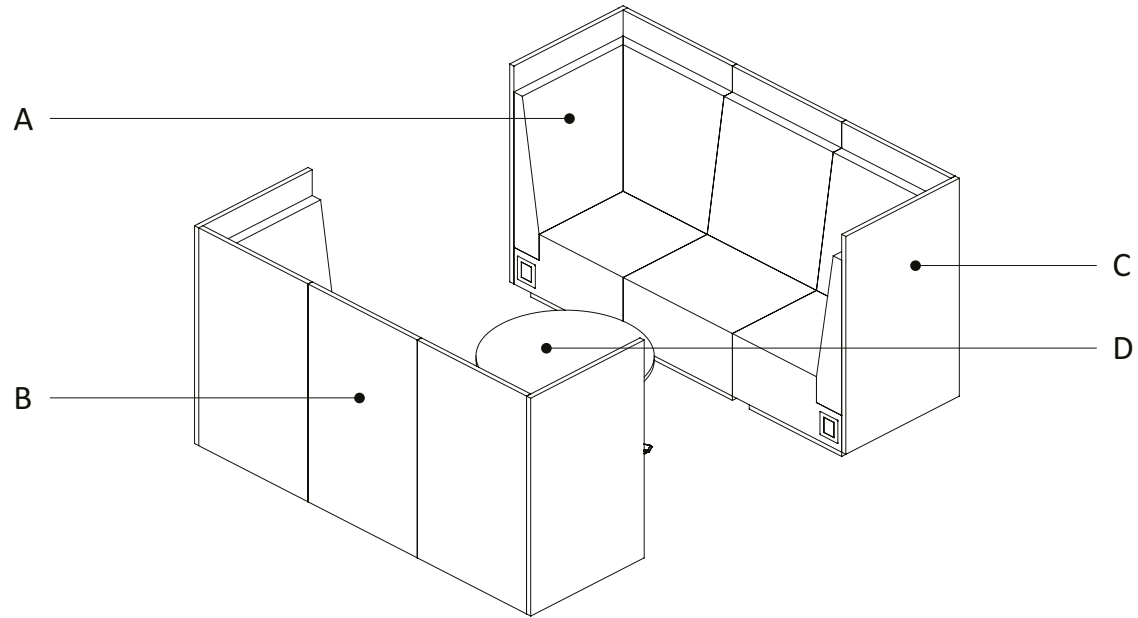
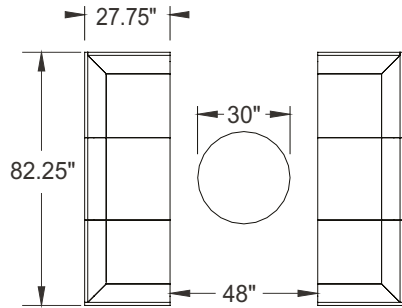

ITEM	QTY	CODE	DESCRIPTION	LIST PRICE \$	TOTAL \$
A	2	SIT CBH P R L	Corner bench 27.25" X 27.25 X 54" H with high back and laminate privacy panel - Grade 1	1955	3 910
	2	[MH3C L]	Connectivity unit	216	432
B	2	SIT BH P L R	Bench 26.25" X 27.25 X 54" with high back and laminate privacy panel - Grade 1	1295	2 590
C	2	SIT CBH P L R	Corner bench 27.25" X 27.25 X 54" H with high back and laminate privacy panel - Grade 1	1955	3 910
	2	[MH3C R]	Connectivity unit	216	432
D	1	OS 30 TR ORF4 CHR 20	Circular Orford table 30" X 30" X 20" H, chrome base	1582	1 582
				Total:	12 856
				Total without options:	11 992

Introduction

Typical Layouts

SIT TYP-B

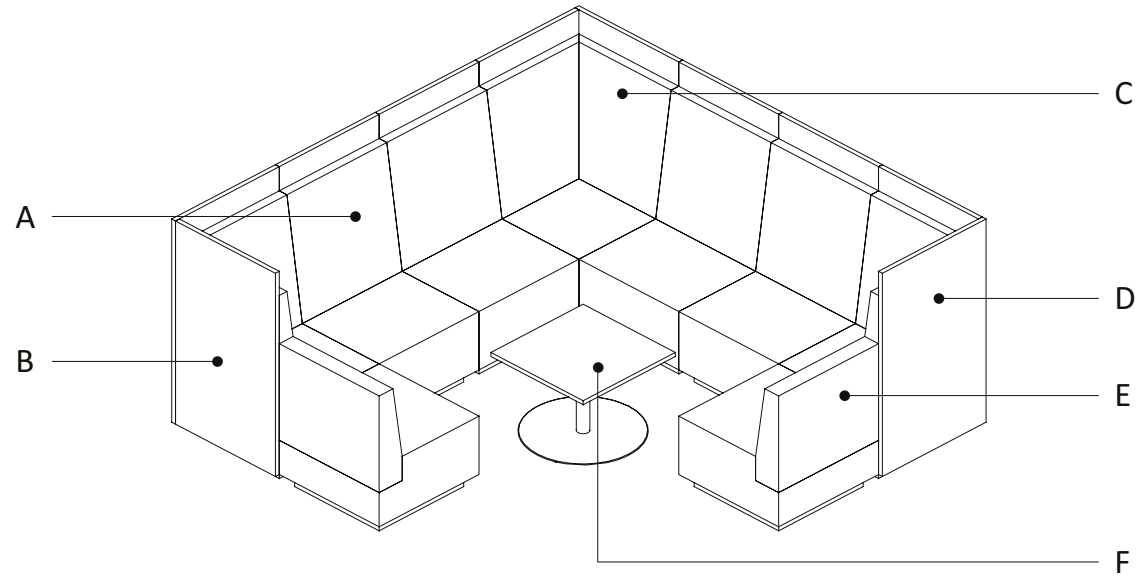
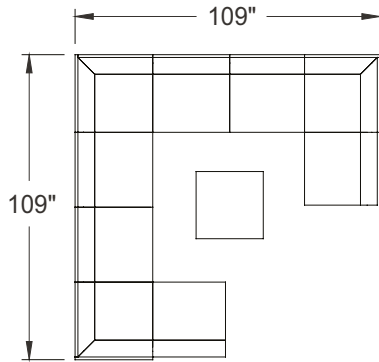

ITEM	QTY	CODE	DESCRIPTION	LIST PRICE \$	TOTAL \$
A	4	SIT BH P LR	Bench 26.25" X 27.25 X 54" with high back and laminate privacy panel - Grade 1	1295	5 180
B	1	SIT CBH P R R	Corner bench 27.25" X 27.25 X 54" H with high back and laminate privacy panel - Grade 1	1955	1 955
C	1	SIT CBH P LR R	Corner bench 27.25" X 27.25 X 54" H with high back and laminate privacy panel - Grade 1	1955	1 955
D	1	SIT CBH P L L	Corner bench 27.25" X 27.25 X 54" H with high back and laminate privacy panel - Grade 1	1955	1 955
E	2	SIT BM	Bench 26.25" X 27.25 X 36" H with medium back - Grade 1	1042	2 084
F	1	OS 24 TC MAG CHR 20	Square Magog table 24" X 24" X 20" H, Magog chrome base	868	868
Total:					13 997

Introduction

Typical Layouts

SIT TYP-C

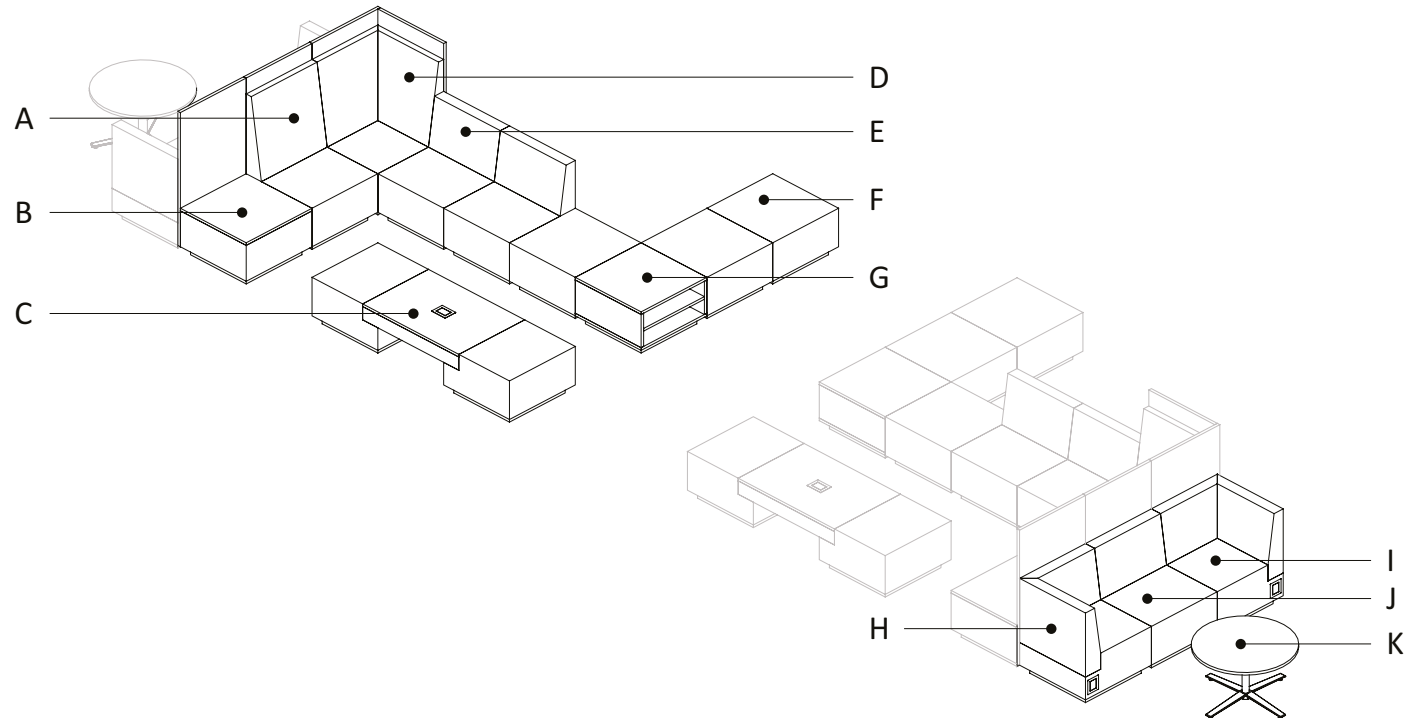
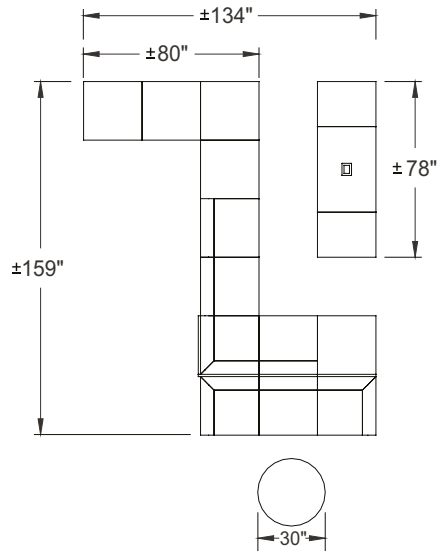

ITEM	QTY	CODE	DESCRIPTION	LIST PRICE \$	TOTAL \$
A	1	SIT BH P LR	Bench 26.25" X 27.25 X 54" H with high back and laminate privacy panel - Grade 1	1474	1 474
B	1	SIT FT P R	Occasional table 26.25" X 27.25 X 54" H fabric frame with laminate privacy panel - Grade 1	790	790
C	1	SIT 38 BFT	Bench with built-in table 78.5" X 26.25" X 18" H - Grade 1	1674	1 674
	1	[MH3C CC]	Connectivity unit	216	216
D	1	SIT CBH P L L	Corner bench 27.25" X 27.25 X 54" H with high back and laminate privacy panel - Grade 1	1955	1 955
E	2	SIT BM	Bench 26.25" X 26.25 X 36" H with medium back - Grade 1	1042	2 084
F	3	SIT B	Bench 26.25" X 26.25" X 18" H - Grade 1	742	2 226
G	1	SIT TB	Bookshelf table 26.25" X 26.25" X 18" H, open on 1 side	608	608
H	1	SIT CBM	Corner bench 26.25" X 26.25 X 36" H with medium back - Grade 1	1474	1 474
	1	[MH3C L]	Connectivity unit	216	216
I	1	SIT CBM	Corner bench 26.25" X 26.25 X 36" H with medium back - Grade 1	1474	1 474
	1	[MH3C R]	Connectivity unit	216	216
J	1	SIT BM	Bench 26.25" X 26.25 X 36" H with medium back - Grade 1	1042	1 042
K	1	OS 30 TR ORF4 CHR 20	Circular Orford table 30" X 30" X 20" H, chrome base	1582	1 582
Total:					17 031
Total without options:					16 383

Introduction

Typical Layouts

SIT TYP-D

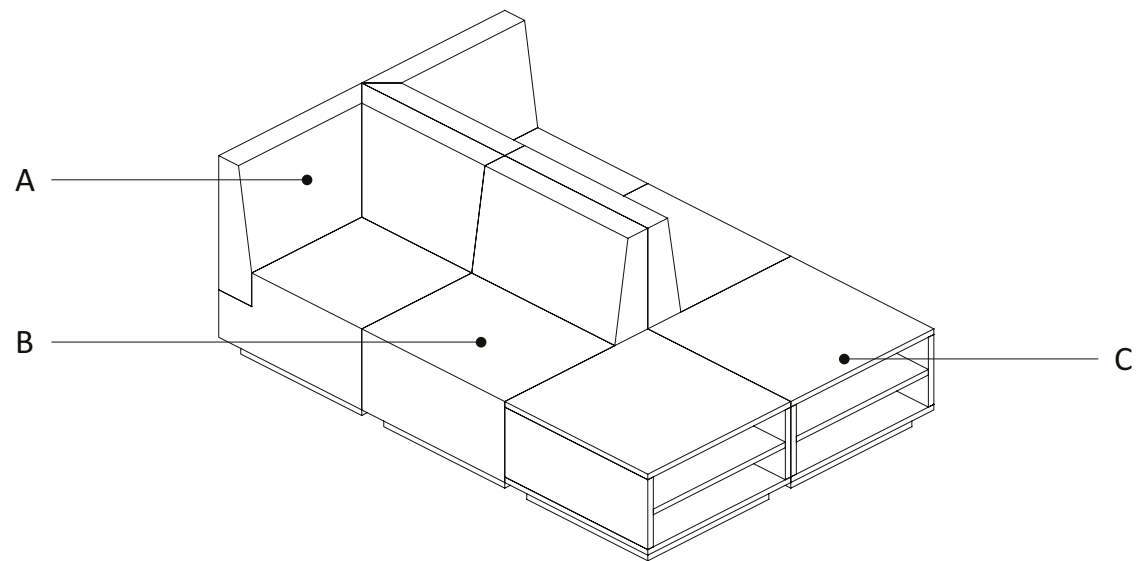
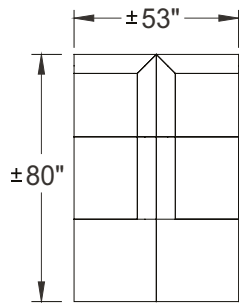

ITEM	QTY	CODE	DESCRIPTION	LIST PRICE \$	TOTAL \$
A	2	SIT CBM	Corner bench 26.25" X 26.25 X 36" H with medium back - Grade 1	1474	2 948
	2	SIT BM	Bench 26.25" X 26.25 X 36" H with medium back - Grade 1	1042	2 084
B	2	SITT B	Bookshelf table 26.25" X 26.25" X 18" H, open on 1 side	608	1 216
Total:					6 248

Introduction

Typical Layouts

SIT TYP-E

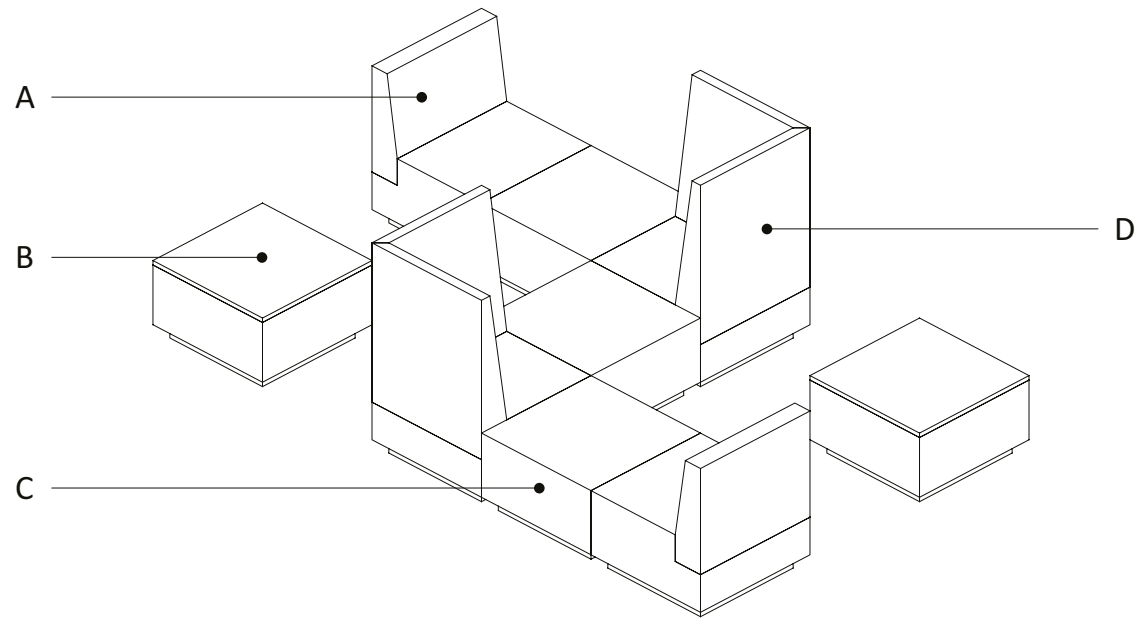
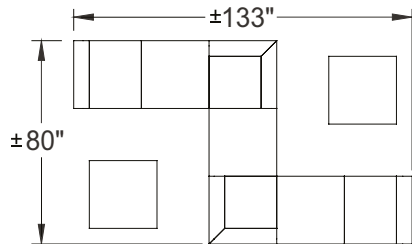

ITEM	QTY	CODE	DESCRIPTION	LIST PRICE \$	TOTAL \$
A	2	SIT BM	Bench 26.25" X 26.25 X 36" H with medium back - Grade 1	1042	2 084
B	3	SIT B	Bench 26.25" X 26.25" X 18" H - Grade 1	742	2 226
C	2	SIT FT	Occasional table 26.25" X 27.25 X 54" H fabric frame - Grade 1	591	3 304
D	2	SIT CBH	Corner bench 27.25" X 27.25 X 48" H with high back - Grade 1	1652	1 182
Total:					8 796

Introduction

Typical Layouts

SIT TYP-F

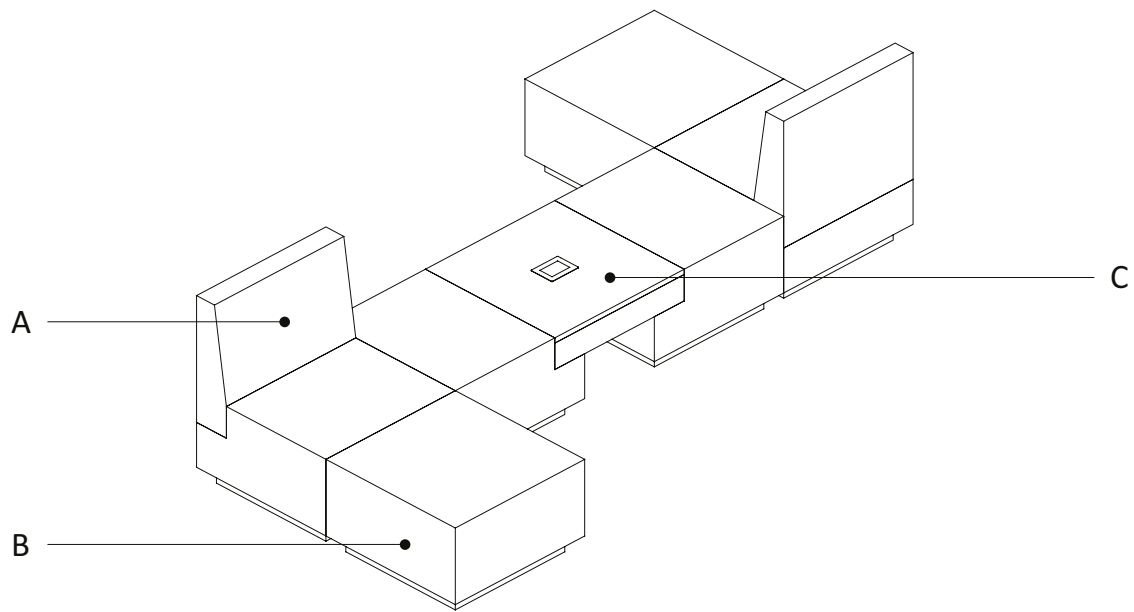
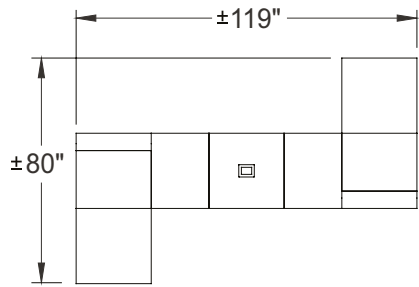

ITEM	QTY	CODE	DESCRIPTION	LIST PRICE \$	TOTAL \$
A	2	SIT BM	Bench 26.25" X 26.25 X 36" H with medium back - Grade 1	1042	2 084
B	2	SIT B	Bench 26.25" X 26.25" X 18" H - Grade 1	742	1 484
C	1	SIT 26 BFT	Bench with built-in table 66.5" X 26.25" X 18" H - Grade 1	1615	1 615
	1	[MH3C CC]	Connectivity unit	216	216
				Total:	5 399
				Total without options:	5 183

Typical Layouts

SIT TYP-G

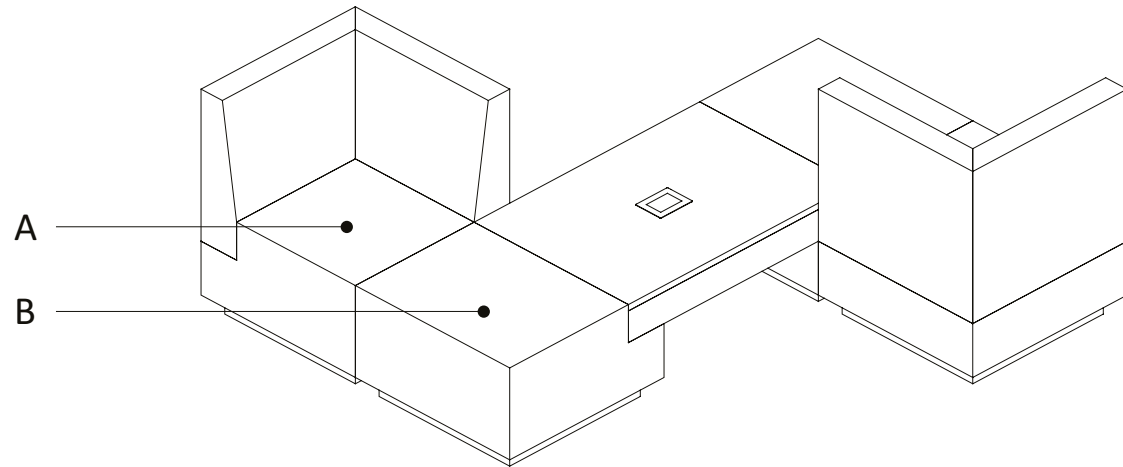
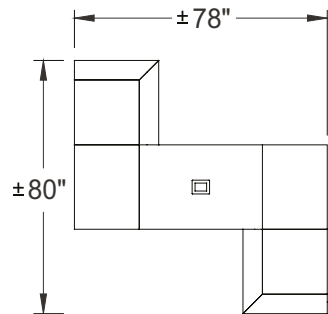

ITEM	QTY	CODE	DESCRIPTION	LIST PRICE \$	TOTAL \$
A	2	SIT CBM	Corner bench 26.25" X 26.25 X 36" H with medium back - Grade 1	1474	2 948
B	1	SIT 38 BFT	Bench with built-in table 78.5" X 26.25" X 18" H - Grade 1	1674	1 674
	1	[MH3C CC]	Connectivity unit	216	216
				Total:	4 838
				Total without options:	4 622

Introduction

Typical Layouts

SIT TYP-H

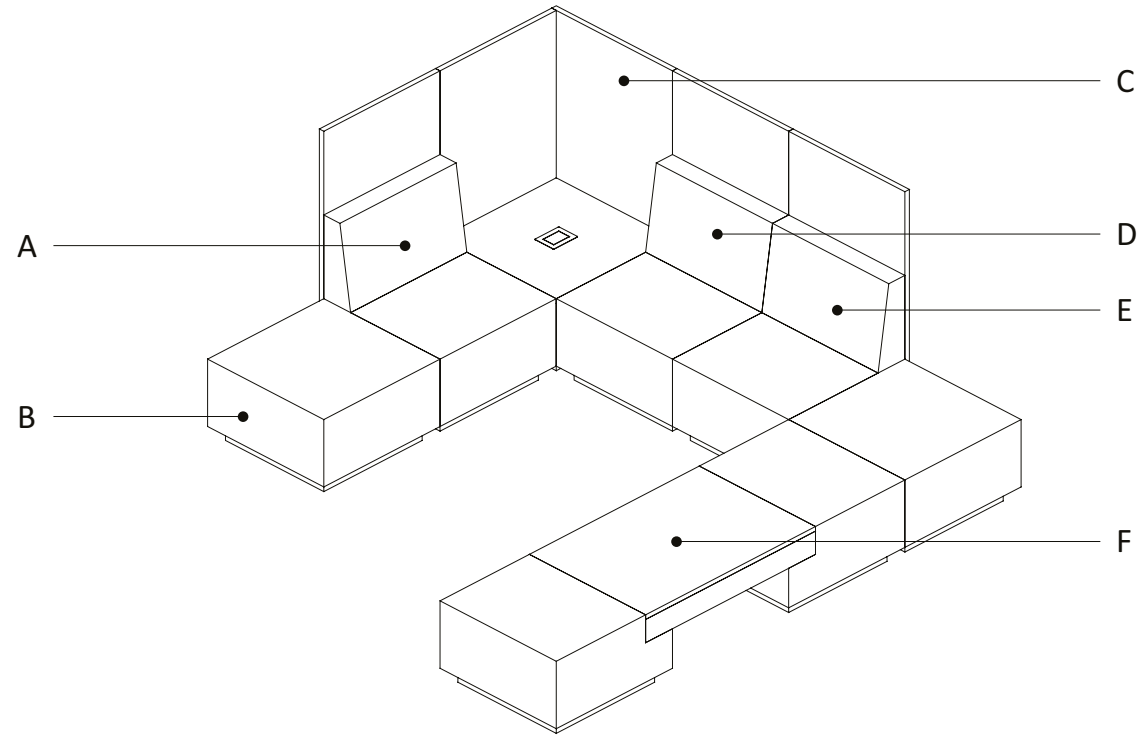
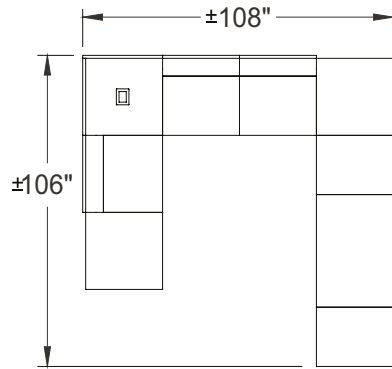

ITEM	QTY	CODE	DESCRIPTION	LIST PRICE \$	TOTAL \$
A	1	SIT BM P R	Bench 26.25" X 27.25 X 54" H with medium back and laminate privacy panel - Grade 1	1236	1 236
B	2	SIT B	Bench 26.25" X 26.25" X 18" H - Grade 1	742	1 484
C	1	SIT CFT P LR R	Occasional table 27.25" X 27.25 X 54" H with fabric frame and laminate privacy panel - Grade 1	874	874
D	1	SIT BM P LR	Bench 26.25" X 27.25 X 54" H with medium back and laminate privacy panel - Grade 1	1236	1 236
E	1	SIT BM P L	Bench 26.25" X 27.25 X 54" H with medium back and laminate privacy panel - Grade 1	1236	1 236
F	1	SIT 38 BFT	Bench with built-in table 78.5" X 26.25" X 18" H - Grade 1	1674	1 674
	1	[MH3C CC]	Connectivity unit	216	216
				Total:	7 956
				Total without options:	7 740

Introduction

Typical Layouts

SIT TYP-I

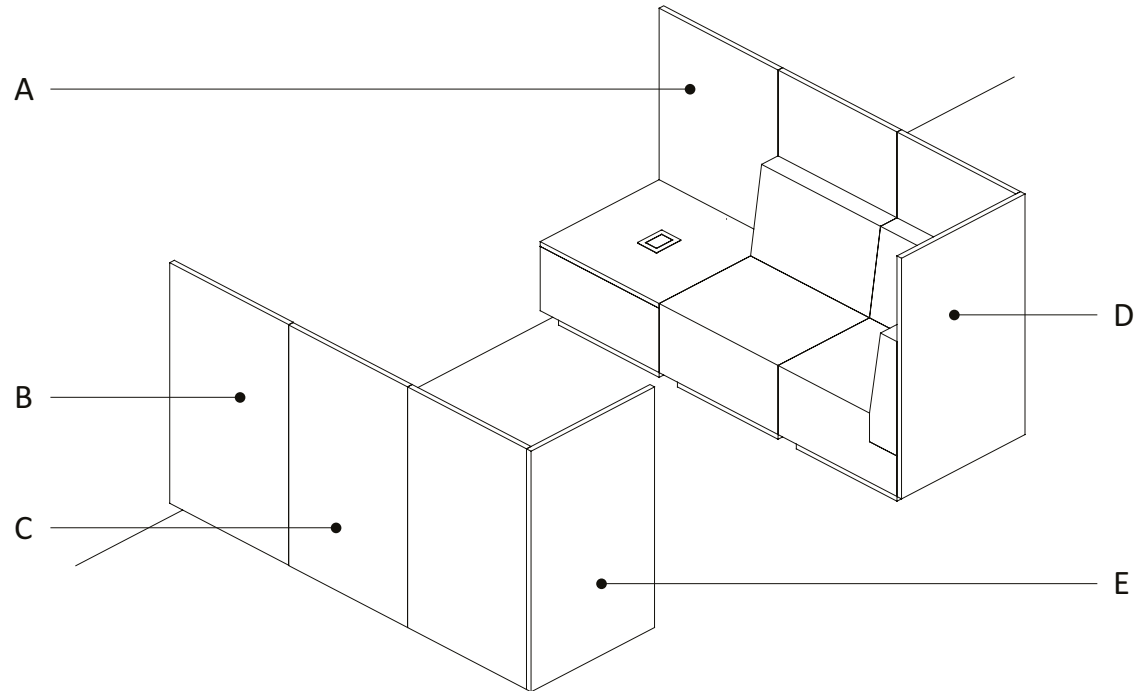
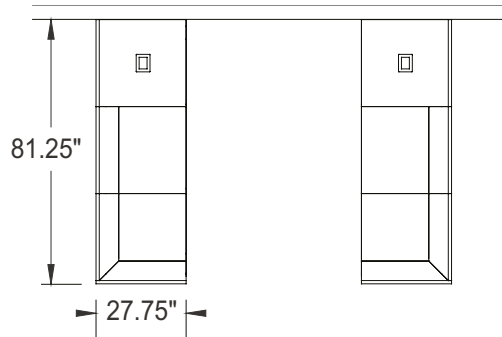

ITEM	QTY	CODE	DESCRIPTION	LIST PRICE \$	TOTAL \$
A	1	SIT FTP L	Occasional table 27.25" X 27.25 X 54" H with fabric frame and laminate privacy panel - Grade 1	790	790
	1	[MH3C CC]	Connectivity unit	216	216
B	1	SIT FTP R	Occasional table 27.25" X 27.25 X 54" H with fabric frame and laminate privacy panel - Grade 1	790	790
	1	[MH3C CC]	Connectivity unit	216	216
C	2	SIT BM P LR	Bench 26.25" X 27.25 X 54" H with medium back and laminate privacy panel - Grade 1	1236	2 472
D	1	SIT CBM P L R	Corner bench 26.25" X 26.25 X 54" H with medium back and laminate privacy panel - Grade 1	1777	1 777
E	1	SIT CBM P R L	Corner bench 26.25" X 26.25 X 54" H with medium back and laminate privacy panel - Grade 1	1777	1 777
				Total:	8 038
				Total without options:	7 606

Introduction

Typical Layouts

CLARA TYP-A

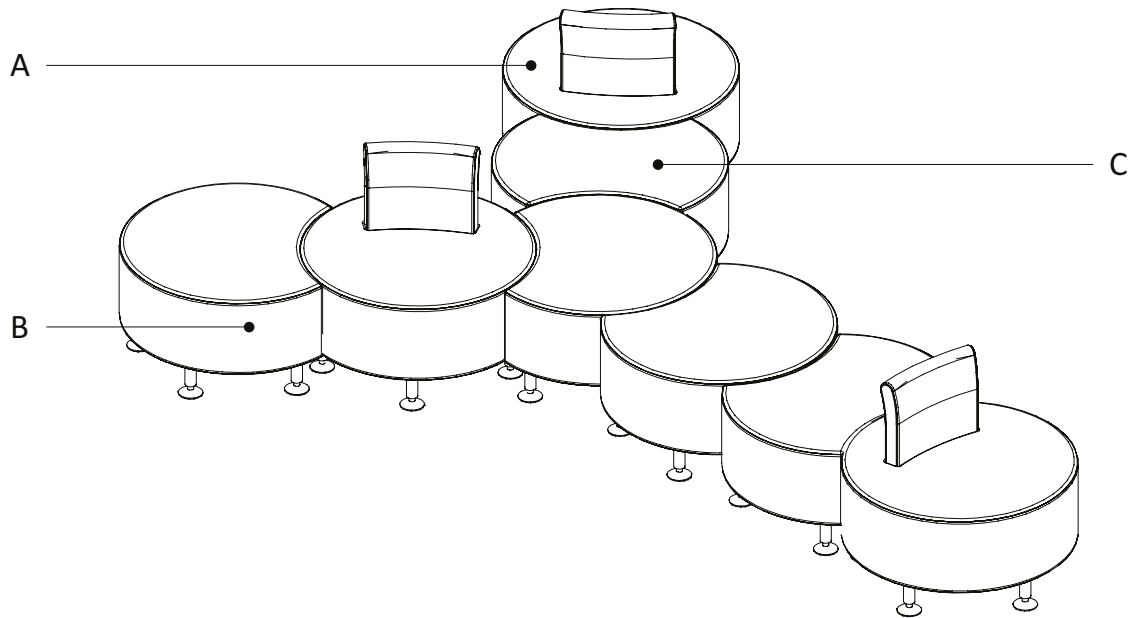
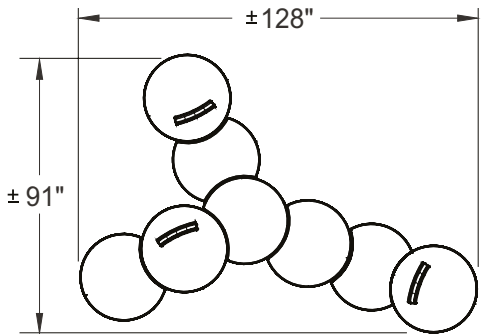

ITEM	QTY	CODE	DESCRIPTION	LIST PRICE \$	TOTAL \$
A	3	SS CLAB	Circular bench with back rest 29" x 29" x 15" H - Grade 1	1573	4 719
B	3	SS CLAS	Circular single nestle bench 29" x 29" x 15" H - Grade 1	918	2 754
C	2	SS CLAD	Circular double nestle bench 29" x 29" x 15" H - Grade 1	918	1 836
Total:					9 309

Introduction

Typical Layouts

CLARA TYP-B

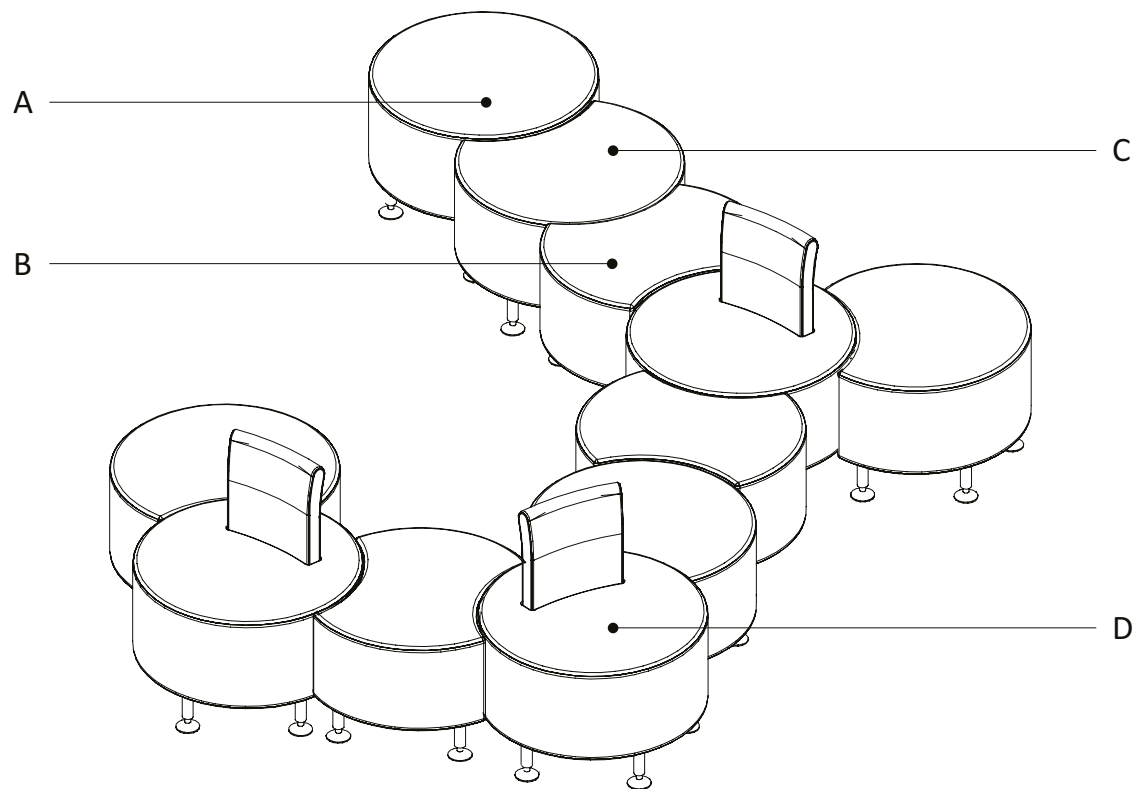
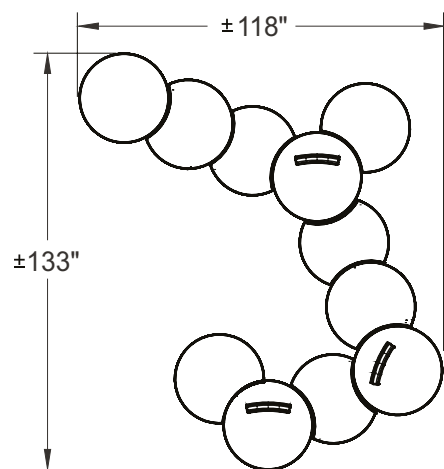

ITEM	QTY	CODE	DESCRIPTION	LIST PRICE \$	TOTAL \$
A	3	SS CLA	Circular bench 29" x 29" x 15" H - Grade 1	918	2 754
B	3	SS CLAD	Circular double nestle bench 29" x 29" x 15" H - Grade 1	918	2 754
C	2	SS CLAS	Circular single nestle bench 29" x 29" x 15" H - Grade 1	918	1 836
D	3	SS CLAB	Circular bench with back rest 29" x 29" x 15" H - Grade 1	1573	4 719
Total:					12 063

Introduction

Typical Layouts

INFINITI TYP-A

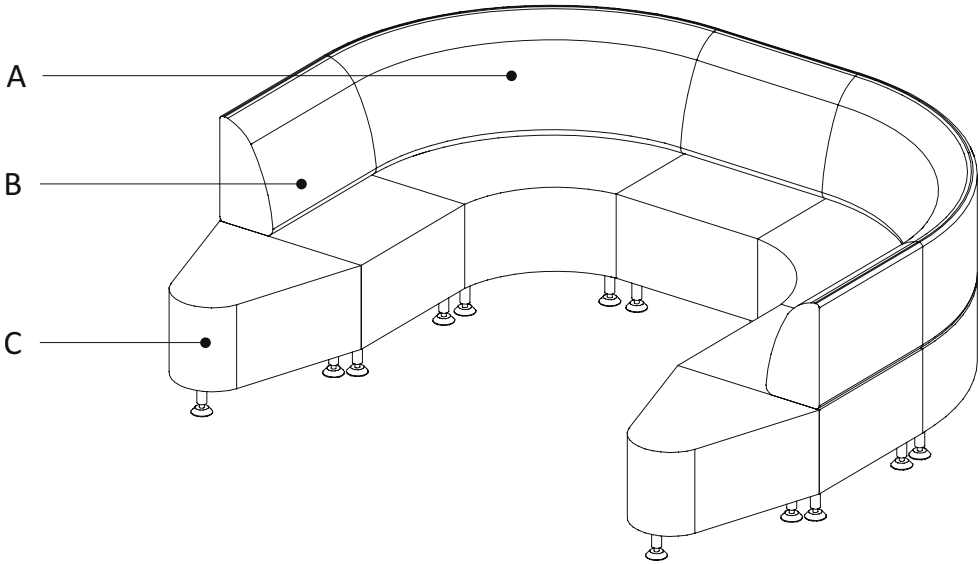
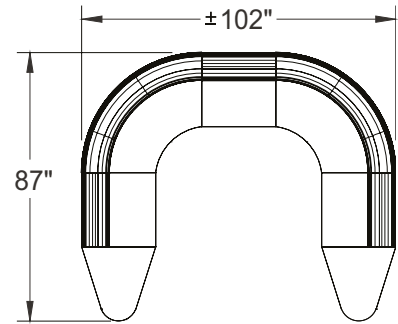

ITEM	QTY	CODE	DESCRIPTION	LIST PRICE \$	TOTAL \$
A	2	SS 020BARCOB PQS	Arched bench with outer back rest 55" x 28.5" x 33.5" H - Grade 1	1546	3 092
B	3	SS 010BSQ24B PQS	Square bench with back rest 24" x 24" x 33.5" H - Grade 1	951	2 853
C	2	SS 030BOV PQS	Oval bench 24" x 24" x 17.5" H - Grade 1	1735	3 470
Total:					9 415

Typical Layouts

INFINITI TYP-B

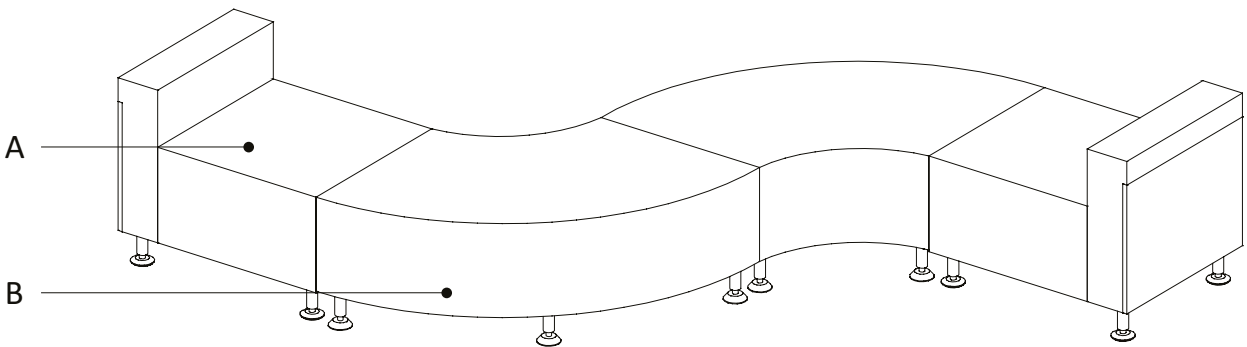
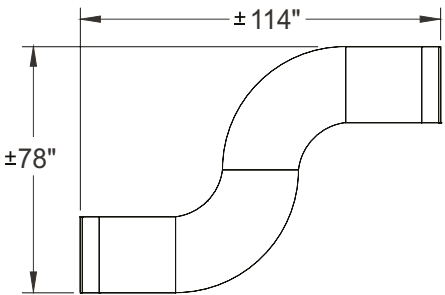

ITEM	QTY	CODE	DESCRIPTION	LIST PRICE \$	TOTAL \$
A	2	SS 045BSUA PQS	Square bench with padded arm and melamine panel 24" x 30" x 25.5"H - Grade 1	983	1 966
B	2	SS 020BARC	Arched bench 55" x 25.5" x 17.5" H - Grade 1	1087	2 174
Total:					4 140

Introduction

Typical Layouts

INFINITI TYP-C

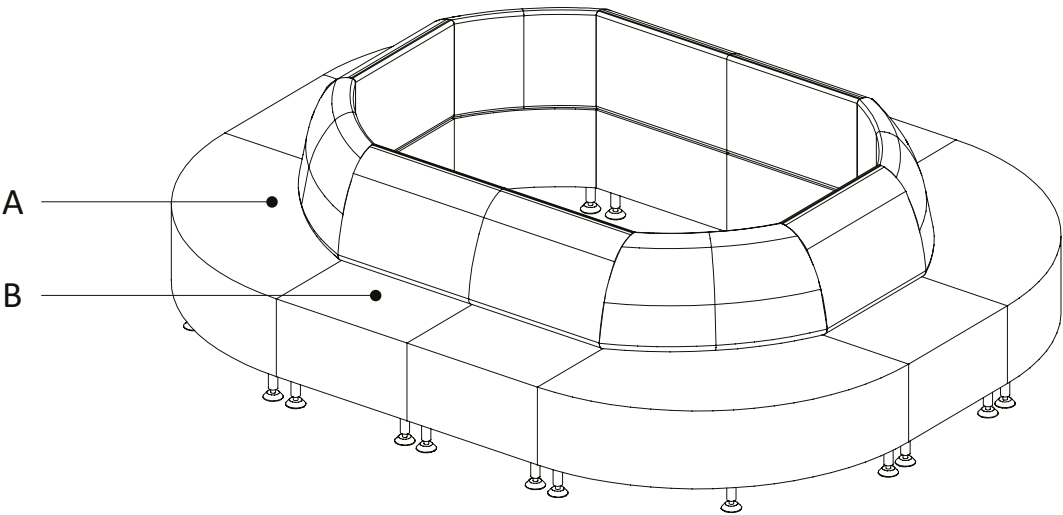
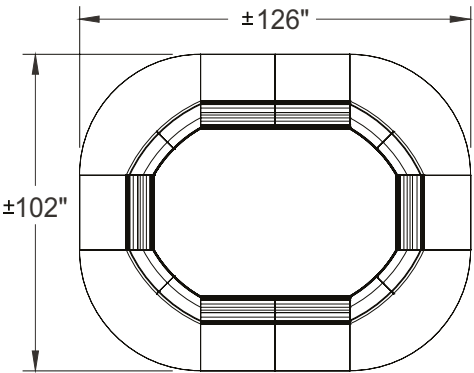

ITEM	QTY	CODE	DESCRIPTION	LIST PRICE \$	TOTAL \$
A	4	SS 020BARCIB PQS	Arched bench with inner back rest 55" x 28.5" x 33.5" H - Grade 1	1486	5 944
B	6	SS 010BSQ24B PQS	Square bench with back rest 24" x 24" x 33.5" H - Grade 1	951	5 706
Total:					11 650

Introduction

Appendix A: Colors and Finishes

How to specify your laminate colors

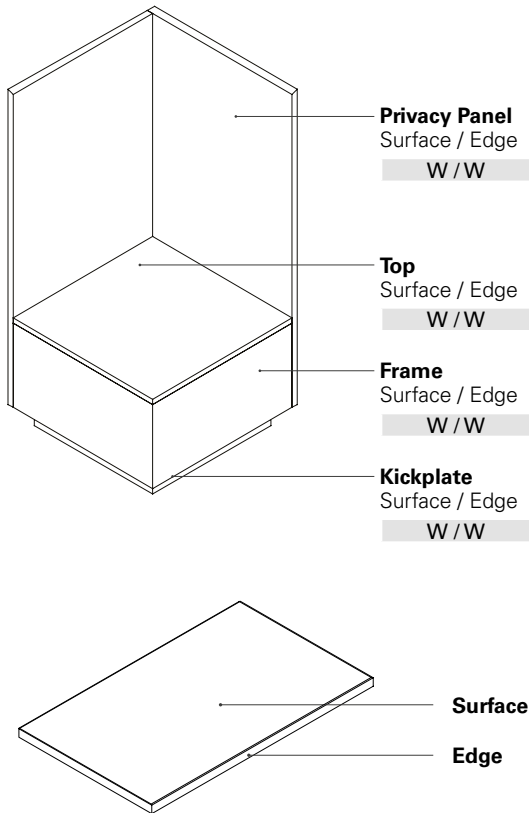

The edge is always the same color as the laminate surface color.

Wood Color

All wooden items offered in this price list are stained using the Logiflex wood finish laminate color.

Refer to our current color chart at:

Logiflex.ca > Finishes > **Colors & Finishes Guide**

Availability Chart

	Code	Color Couleur	HG Fronts Façades lustrées	Surfaces		Mouldings Moultures 1-5/8"		Knife Edge Chanfrein	Wood Components Composantes de bois	Panval Code
			5/8"	1"	1-5/8"	MAR	MAX	Z		
AURA Finish Fini	GIA	Ginger Root <i>Gingembre</i>		•				•	S	H72
	HAA	Haze <i>Brume</i>		•	•			•	P	H57
	STA	Storm <i>Tempête</i>		•	•			•	S	H58
	TUA	Tundra		•				•	P	H75
DOLOMITE Finish Fini	AU	Audacity <i>Audace</i>		•	•			•	S	241
	B	Jet Black <i>Noir intense**</i>		•	•			•	P	888 S405-CA
	BC	Brown cherry <i>Cerisier brun</i>		•	•		•	•	S	207
	C	Slate <i>Ardoise**</i>		•				•	P	801
	CA	Caramel	CAH*	•	•			•	S	G18 G18-GL
	CH	Cherry <i>Cerisier</i>		•	•	•	•	•	S	965
	CO	Cognac		•	•	•	•	•	S	260
	DL	Legno Dark <i>Legno foncé</i>		•	•			•	S	G52
	DR	Driftwood <i>Bois de rive</i>		•	•		•	•	S	744
	FI	Finesse		•				•	S	745
	G	Mink Grey <i>Gris vision</i>		•	•			•	P	805 OU-927
	GG	Grigio	GGH*	•	•			•	P	G17 G17-GL
	LL	Legno Light <i>Legno pâle</i>		•				•	S	G51
	LM	Light Maple <i>Érable clair</i>		•	•		•	•	S	992
	NC	Natural Cherry <i>Cerisier naturel</i>		•	•	•	•	•	S	239
	NM	Natural Maple <i>Érable naturel</i>		•	•	•	•	•	S	206
	PC	Coastal Pear <i>Poirier de la côte</i>	PCH*	•				•	P	G23 G23-GL
	PO	Porto		•	•	•	•	•	S	913 OU-648
	SW	Smoked Walnut <i>Noyer fumé</i>		•	•		•	•	S	G21
	T	Tan		•	•	•	•	•	S	259
	TO	Tobacco		•	•		•	•	S	205
	VA	Vanilla		•	•		•	•	P	G22
	W	Polar White <i>Blanc polaire</i>	W-H*	•	•			•	P	555 459-58 459-90
	WK	Whisky		•	•	•	•	•	S	245
	Z	Zebra		•	•	•	•	•	S	237

[P] Solid color painted wood | [S] Stained wood.

* Non recommended color for work surfaces. An upcharge applies on high gloss fronts.

* Non recommended color for work surfaces.

Colors may vary from 2% to 5% between tfl and hpl laminates due to different technical applications.

See our complete [Colors & Finishes Guide](#)

Appendix B: COM Fabric

Upholstery Specification

Logiflex offers two options for upholstery specification:

Option 1 :	Customers may specify an upholstery from any supplier. Logiflex will then confirm upholstery grade and seat cost.
Option 2 :	Customers may select and purchase upholstery of their choice and ship upholstery to Logiflex (COM)

Option 1 : Specified Upholstery

Customers may consult the websites of our principal suppliers to visualize their complete product range. It is then possible to consult the graded-in list available on Logiflex.ca to be informed of the appropriate Logiflex grade.

Website of the upholstery supplier gives essential information to the maintenance, availability, quality and performance of the selected upholstery. In all cases, the upholstery supplier's warranty will apply.

Information to provide with the order:

Customer name
Purchase order number
Upholstery supplier name
Pattern name/number
Color name/number
Number of yards to order

Principal suppliers:

Momentum Textiles	themomgroup.com
J.Ennis Fabrics	jennnisfabrics.com
Maharam	maharam.com
Designtex	designtex
Mayer Fabrics	mayerfabrics.com

See our Graded-In Program at:

www.logiflex.ca/data/files/Graded-In.pdf

Option 2 : Customer's Own Material (COM)

Logiflex offers the option of providing your own upholstery. The price will be based on the cushion grade 1. The upholstery must be received three weeks prior to the acknowledged ship date. Delay in COM receiving may cause shipment to be delayed.

Customers have the option to provide Logiflex with a sample for approval prior the order. If no sample is sent for approval in advance, Logiflex is not responsible of any cost caused by unsuitable upholstery for the product or the production process. Furthermore, Logiflex reserves the right to refuse any upholstery that does not meet Logiflex selection criteria.

COM must be delivered to the Logiflex factory with freight and duties paid. All charges to COM acquisition on the customer's behalf will be passed onto the customer.

Logiflex does not assume responsibility for upholstery availability, quality, performance or appearance, the Logiflex warranty excludes customer's own materials.

Upholstery yardage calculation:

Yardage is calculated in yards assuming that upholstery is 54" wide with no pattern.

Additional yardage may be needed if the upholstery is less than 54" wide, if there is a pattern repeat or if it is shipped in separate pieces. Please consult the following table in order to know the percentage of extra yardage required. The repeat of the pattern is calculated by adding up the horizontal and vertical repeat measurements.

Percentage of extra COM yardage table:

Upholstery width	Plain	Repeat 2" - 14"	Repeat 15" - 19"	Repeat 20" - 27"	Repeat 28" - 36"
36"	50%	60%	65%	70%	75%
45"	40%	50%	55%	60%	65%
48"	16%	25%	30%	35%	40%
50"- 53"	16%	20%	25%	30%	35%
54"	0%	10%	15%	20%	25%

COM upholstery delivery:

The following information must be included with the COM upholstery delivery and be communicated to the account manager along with the purchase order:

Customer name
Purchase order number
Upholstery supplier name
Pattern name/number
Color name/number
Number of yards delivered

Shipping address:

Logiflex
Attn: Receiver
1235 St-Roch North Road
Sherbrooke Quebec
Canada J1N 0H2

Note: A late reception of fabric may cause delivery delays.

Introduction

Appendix B: COM Fabric *(continued)*

Seams

Different top stitchings are available for different armchair models.

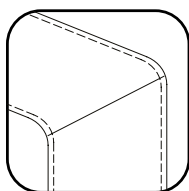

PQS

Single Top Stitch

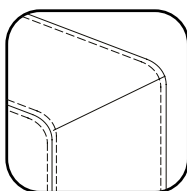

PQD

Double Top Stitch

Combining Fabrics

Different fabrics can be specified for the bench, back and privacy panel of the same seat at no extra cost.

Where this option is available, you will see the **Combination of Colors** indicator illustrations.

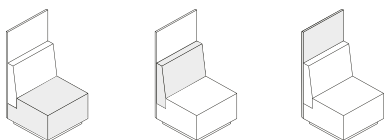

Example:

Bench: J. ENNIS / ORNAMENTAL / #302 GR3;
Back: J. ENNIS / BALANCE / #9009 GR1;
Privacy panel: J. ENNIS / WICKER / #302 GR3.

The price will be that of the highest-grade fabric chosen.

Fabric Quantities

The quantities of fabric yardage to order for each piece of furniture is indicated in the "Manufacturing Standard" section on the product page indicating the amount of yards required.

Note that these quantities are valid for fabrics whose pattern is 8" or less in width. If the fabric pattern is wider than 8", the amount of fabric needed may vary.

Where this option is available, you will see the following table in the "Manufacturing Standard" section on the product page indicating the amount of yards required:

Example:

COM Fabric:

Fabric combination possible. Number of yards required:

Code	Total	Bench	Back	Panel
BDFP	7	2.5	2	2.5
BMFP	7.5	2.5	2.5	2.5
BHFP	8.5	2.5	3.5	2.5

Note: It is recommend that you include a layout with all orders.

Graded-In List

Seat cost depends of selected upholstery. Grade is not established according to upholstery quality or performance, but to its purchase cost. In order to help customers researches, a graded-in list presenting the entire collections od Logiflex's principal suppliers has been prepared. It is possible to consult Logiflex graded-in list by visiting logiflex.ca

Note: The graded-in list is based on information at time of the publication of this document. As upholstery suppliers can discontinue products or increase their prices at their discretion, this list communicated for information purposes only and can not be considered as a sale commitment by Logiflex.

Application of Upholstery

Application of upholstery will follow the directional orientation of its pattern. Explicit instructions must be given to the customer's account manager if a specific direction is desired. Logiflex will not be responsible of problems related to upholstery direction or positioning unless formal instructions has been given along with the purchase order.

Instruction references:

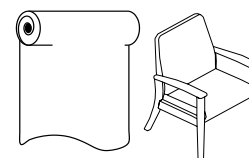

Up the Roll

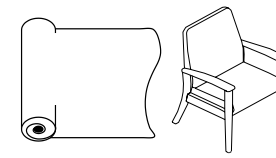

Across the Roll

Leather

All leathers used are "cowhide."

Please note that the warranty does not apply on leather's natural imperfections, such as: scars, marks, and difference in stain within a leather skin or different skins. This specification also applies for standard leather GR5 and Italian leather GR7 and up.

Polyurethane foam

The Velva and Celcor brand polyurethane foam used in the manufacturing of our armchairs is antibacterial.

Different densities exist and will vary from one armchair model to the other. Medium-density foam is used for back and seating parts, while the firmer-density foam is used for armrest parts.

Appendix C : SIT

Manufacturing Standards

Levellers

All modules with a kick plate sit on white nylon levellers.

Fasteners

All modules with a kick plate come with 2 fasteners to join to other modules.

Wiring Management

All kick plates include a half-round machine-cut on all four sides for feeding cables from one module to the next.

Dimensions

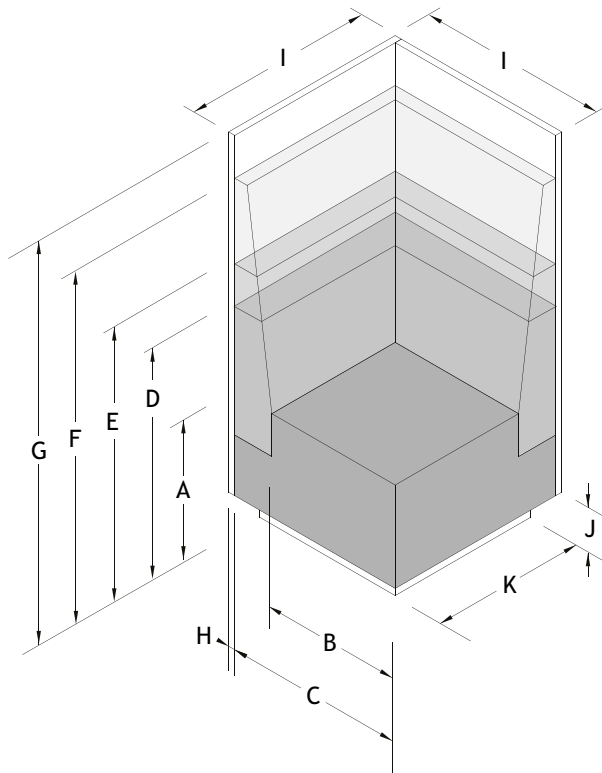

Bench

A. Height	18" *
B. Depth to back	20-3/4" *
C. Depth to panel	26-3/4" *

Back

D. Short back height	29"
E. Medium back height	36"
F. High back height	48"
(Angle of back 8°)	

Privacy panels

G. Height	54"
H. Thickness	1"
I. Width	27-3/4"

Kick Plate

J. Height	3-1/2"
K. Width	22"

* Dimensions may vary depending on selected fabric thickness.

Side view

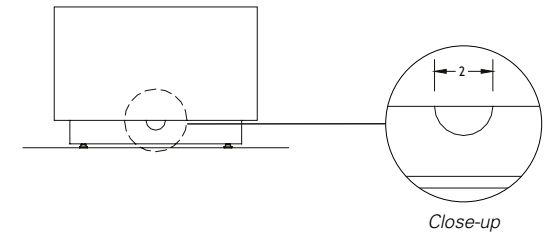

Installation example

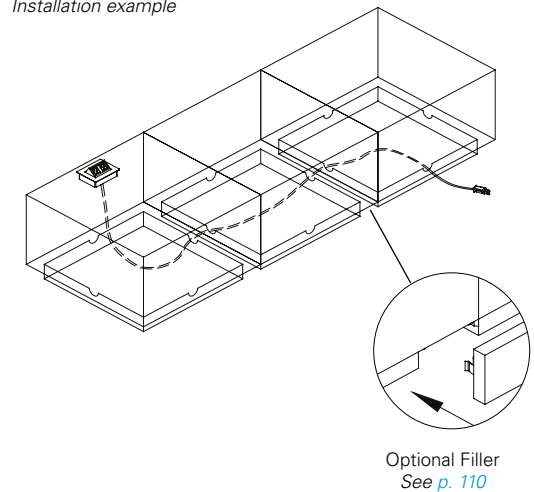

Optional Filler
See [p. 110](#)

Appendix C : SIT

MH3 - Connectivity - positions

Benches and tables

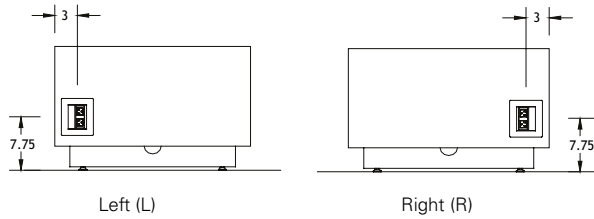

Benches with notch(es)

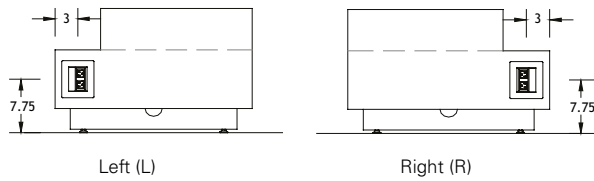
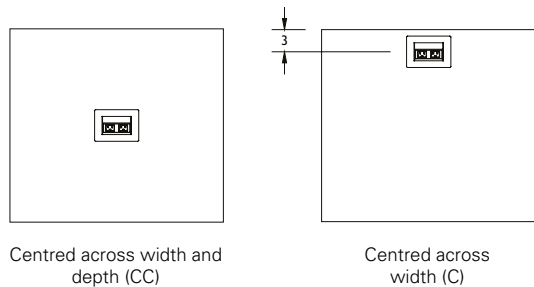
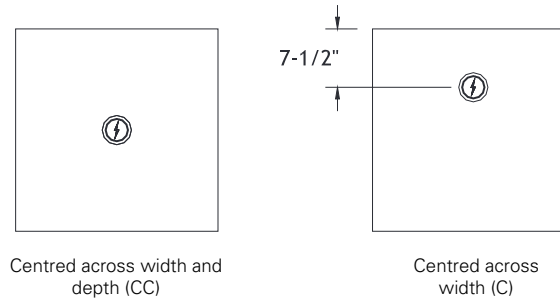

Table tops



Qi - Connectivity - positions



Appendix D : Madrid Color Selection

Logiflex offers varnish, stain and paint selection among the following colors for the Madrid collection:

Vernish



GW Golden Wheat

Stain



CT Chestnut



ES Espresso

Paint



B Opaque Black

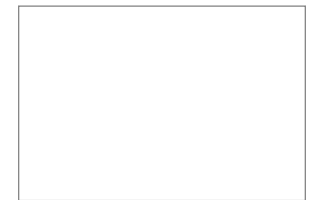

W Opaque White

Modular Section

Modular

Bench

B

Bench with kickplate

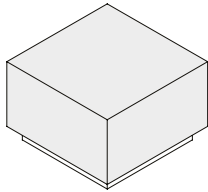

BC

Bench with ball casters

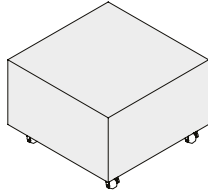

Combination of Colors



Bench



Kick Plate

Manufacturing Standards

- **B:** Lacquered Russian plywood kick plate;
- **BC:** 4 Ball casters with breaks;
- 1" laminate construction;
- Velva firm density antibacterial foam;
- Single row of top stitching.

Dimensions:

Code	Total width	Total depth	Total height
B	26.75"	26.75"	18"
BC	26.75"	26.75"	18"

COM Fabric: number of yards required:

Code	Total
B	2.5
BC	2.5

Note: It is recommend that you include a layout with all orders.

Options

Grommet Connectivity



\$216

\$286

Grommet Position

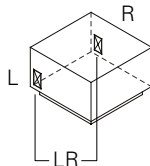

How to Order

Combination of Colors

Finishes
See the
Logiflex
Color Guide

Fabric
See the Logiflex Graded-in List

SIT	B BC	MH3C MH3D	L R LR				
series	code	connectivity	grommet position	kick plate	supplier	pattern	color

Example SIT B MH3C L W J. ENNIS LOFT 34

Prices

Code	COM GR1	GR2	GR3	GR4	GR5	GR6
B	742	790	850	910	970	889
BC	699	747	807	867	927	987

Modular

Bench with Back

BD

Bench with short back

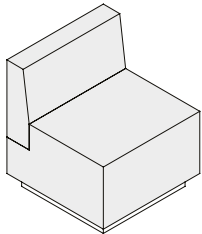

BM

Bench with medium back

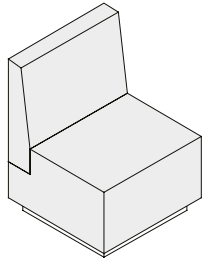

BH

Bench with high back

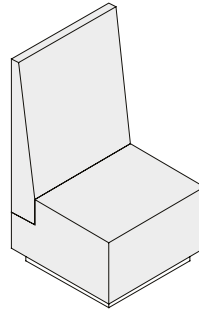

Combination of Colors

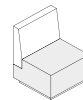

Bench

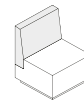

Back

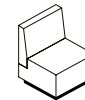

Kick Plate



Manufacturing Standards

- Lacquered Russian plywood kick plate;
- 1" laminate construction;
- Velva firm density antibacterial foam;
- Single row of top stitching.

Dimensions:

Code	Total width	Total depth	Total height
BD	26.75"	26.75"	29"
BM	26.75"	26.75"	36"
BH	26.75"	26.75"	48"

COM Fabric:

Fabric combination possible. Number of yards required:

Code	Total	Bench	Back
BD	4.5	2.5	2
BM	5	2.5	2.5
BH	6	2.5	3.5

Note: It is recommend that you include a layout with all orders.

Options

Grommet Connectivity



\$216

\$286

Grommet Position

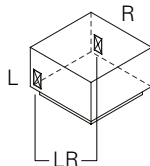

How to Order

Combination of Colors

Finishes

See the
Logiflex
Color Guide

Fabric

See the Logiflex Graded-in List

SIT	BD BM BH	MH3C MH3D	L R LR				
series	code	connectivity	grommet position	kick plate	supplier	pattern	color

Example SIT BD MH3C L W J. ENNIS LOFT 34



Prices

Code	COM GR1	GR2	GR3	GR4	GR5	GR6
BD	958	1030	1122	1210	1300	1390
BM	1042	1138	1258	1378	1498	1618
BH	1101	1221	1371	1521	1671	1821

Modular

Corner Bench with Back

CBD

Corner bench with short back

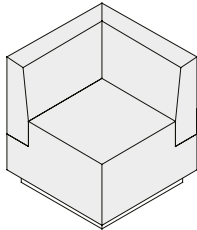

CBM

Corner bench with medium back

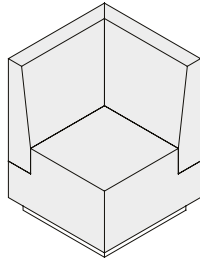

CBH

Corner bench with high back

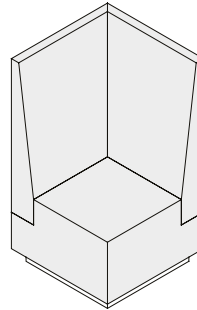

Combination of Colors



Bench



Back



Kick Plate

Manufacturing Standards

- Lacquered Russian plywood kick plate;
- 1" laminate construction;
- Velva firm density antibacterial foam;
- Single row of top stitching.

Dimensions:

Code	Total width	Total depth	Total height
CBD	26.75"	26.75"	29"
CBM	26.75"	26.75"	36"
CBH	26.75"	26.75"	48"

COM Fabric:

Fabric combination possible. Number of yards required:

Code	Total	Bench	Back
CBD	5.5	2.5	3
CBM	7.5	2.5	5
CBH	9.5	2.5	7

Note: It is recommend that you include a layout with all orders.

Options

Grommet Connectivity



\$216

\$286

Grommet Position

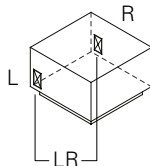

How to Order

Combination of Colors

Finishes

See the
Logiflex
Color Guide

Fabric

See the Logiflex Graded-in List

SIT	CBD CBM CBH	MH3C MH3D	L R LR	kick plate	supplier	pattern	color
series	code	connectivity	grommet position				
Example	SIT	CBD	MH3C	L	W	J. ENNIS	LOFT
							34

Prices

Code	COM GR1	GR2	GR3	GR4	GR5	GR6
CBD	1162	1258	1382	1498	1618	1738
CBM	1474	1618	1798	1978	2158	2338
CBH	1652	1844	2084	2324	2564	2804

Modular

Bench with Single Privacy Panel

BP

Laminate privacy panel

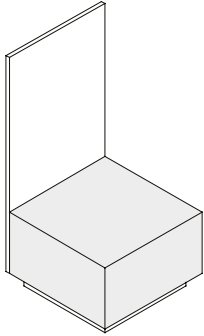

BFP

Fabric privacy panel

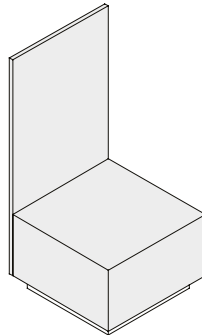

Combination of Colors

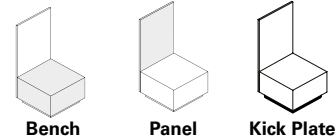

Manufacturing Standards

- 1" laminate privacy panel;
- Lacquered Russian plywood kick plate;
- 1" laminate construction;
- Velva firm density antibacterial foam;
- Single row of top stitching.

Dimensions:

Code	Total width	Total depth	Total height
BP	26.75"	26.75"	54"
BFP	26.75"	26.75"	54"

COM Fabric:

Fabric combination possible. Number of yards required:

Code	Total	Bench	Panel
BP	2.5	2.5	-
BFP	5	2.5	2.5

Note: It is recommend that you include a layout with all orders.

Options

Privacy Panel Fastener Position

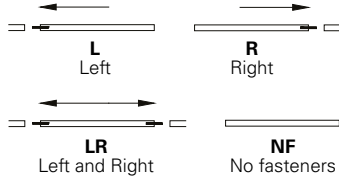

Grommet Connectivity

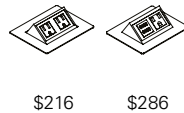

Grommet Position

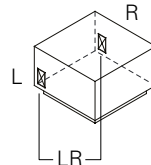

Prices

Code	COM GR1	GR2	GR3	GR4	GR5	GR6
BP	868	916	976	1036	1096	1156
BFP	991	1095	1225	1355	1485	1615

How to Order

Combination of Colors

Finishes
See the Logiflex Color Guide

Fabric
See the Logiflex Graded-in List

	BP BFP	L R LR NF	MH3C MH3D	L R LR					
SIT									
series	code	panel fastener	connectivity	grommet position	panel color	kick plate	supplier	pattern	color
Example	SIT	BP	L	MH3C	L	W	W	J. ENNIS	LOFT 34

Modular

Corner Bench with Corner Privacy Panel

CBP

Laminate privacy panel

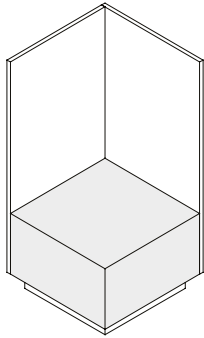

CBFP

Fabric privacy panel

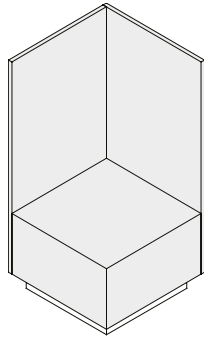

Combination of Colors

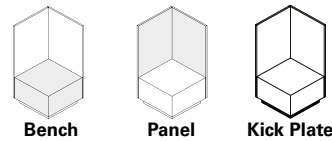

Manufacturing Standards

- 1" laminate privacy panel;
- Lacquered Russian plywood kick plate;
- 1" laminate construction;
- Velva firm density antibacterial foam;
- Single row of top stitching.

Dimensions:

Code	Total width	Total depth	Total height
CBP	26.75"	26.75"	54"
CBFP	26.75"	26.75"	54"

COM Fabric:

Fabric combination possible. Number of yards required:

Code	Total	Bench	Panel
CBP	2.5	2.5	-
CBFP	7	2.5	4.5

Note: It is recommend that you include a layout with all orders.

Options

Privacy Panel Fastener Position

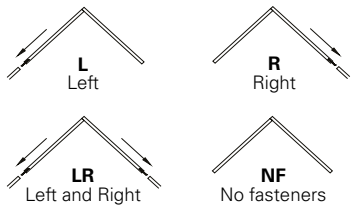

Panel Orientation

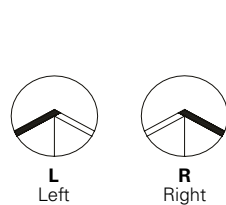

Grommet Connectivity

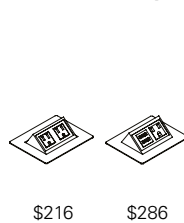

Grommet Position

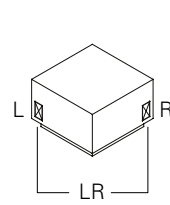

Prices

Code	COM	GR1	GR2	GR3	GR4	GR5	GR6
CBP	952	1000	1060	1120	1180	1240	
CBFP	1196	1356	1556	1756	1956	2156	

How to Order

						Combination of Colors				
		L R LR NF	L R	MH3C MH3D	L R LR	Finishes <i>See the Logiflex Color Guide</i>		Fabric <i>See the Logiflex Graded-in List</i>		
SIT	CBP CBFP					panel	kick plate	supplier	pattern	color
series	code	panel fastener	panel orientation	connectivity	grommet position					
Example	SIT	CBP	L	L	MH3C	L	W	W	J. ENNIS	LOFT 34

Modular

Bench with Back and Laminate Privacy Panel

BDP

Bench with short back

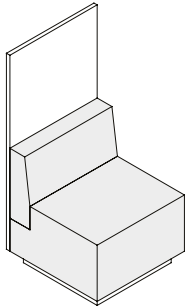

BMP

Bench with short back

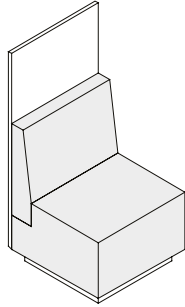

BHP

Bench with high back

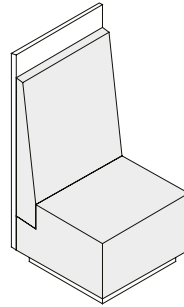

Combination of Colors

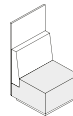

Bench

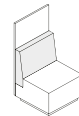

Back

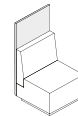

Panel

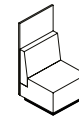

Kick Plate



Manufacturing Standards

- 1" laminate privacy panel;
- Lacquered Russian plywood kick plate;
- 1" laminate construction;
- Velva firm density antibacterial foam;
- Single row of top stitching.

Dimensions:

Code	Total width	Total depth	Back height	Total height
BDP	26.75"	26.75"	29"	54"
BMP	26.75"	26.75"	36"	54"
BHP	26.75"	26.75"	48"	54"

COM Fabric:

Fabric combination possible. Number of yards required:

Code	Total	Bench	Back
BDP	4.5	2.5	2
BMP	5	2.5	2.5
BHP	6	2.5	3.5

Note: It is recommend that you include a layout with all orders.

Options

Privacy Panel Fastener Position

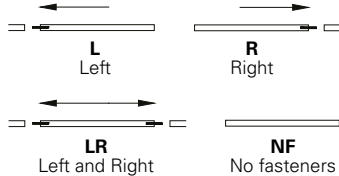

Grommet Connectivity



\$216

\$286

Grommet Position

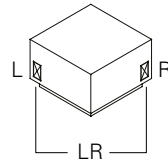

How to Order

					Combination of Colors				
SIT	BDP BMP BHP	L R LR NF	MH3C MH3D	L R LR	Finishes <i>See the Logiflex Color Guide</i>		Fabric <i>See the Logiflex Graded-in List</i>		
					panel	kick plate	supplier	pattern	color
Example	SIT	BDP	L	MH3C	L	W	W	J. ENNIS	LOFT 34

Prices

Code	COM GR1	GR2	GR3	GR4	GR5	GR6
BDP	1072	1144	1236	1324	1414	1504
BMP	1236	1332	1452	1572	1692	1812
BHP	1295	1415	1565	1715	1865	2015

Modular

Bench with Back and Fabric Privacy Panel

BDFP

Bench with short back

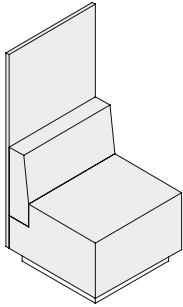

BMFP

Bench with short back

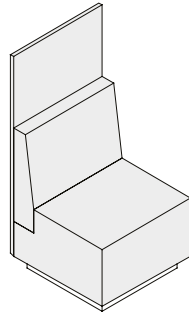

BHFP

Bench with high back

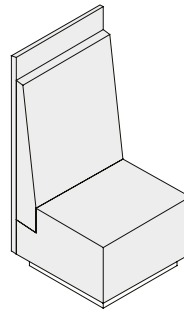

Combination of Colors

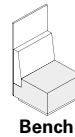

Bench

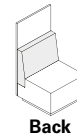

Back

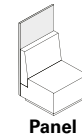

Panel

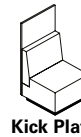

Kick Plate

Manufacturing Standards

- 1" laminate privacy panel;
- Lacquered Russian plywood kick plate;
- 1" laminate construction;
- Velva firm density antibacterial foam;
- Single row of top stitching.

Dimensions:

Code	Total width	Total depth	Back height	Total height
BDFP	26.75"	26.75"	29"	54"
BMFP	26.75"	26.75"	36"	54"
BHFP	26.75"	26.75"	48"	54"

COM Fabric:

Fabric combination possible. Number of yards required:

Code	Total	Bench	Back	Panel
BDFP	7	2.5	2	2.5
BMFP	7.5	2.5	2.5	2.5
BHFP	8.5	2.5	3.5	2.5

Note: It is recommend that you include a layout with all orders.

Options

Privacy Panel Fastener Position

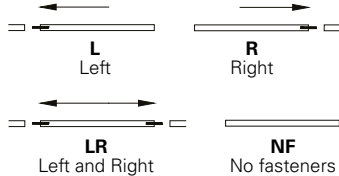

Grommet Connectivity

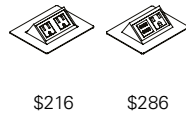

\$216

\$286

Grommet Position

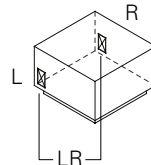

Prices

Code	COM GR1	GR2	GR3	GR4	GR5	GR6
BDFP	1195	1323	1485	1643	1803	1963
BMFP	1333	1485	1675	1865	2055	2245
BHFP	1392	1568	1788	2008	2228	2448

How to Order

		<div>+</div>			Combination of Colors				
BDFP BMFP BHFP		L R LR NF	MH3C MH3D	L R LR	Finishes <i>See the Logiflex Color Guide</i>	Fabric <i>See the Logiflex Graded-in List</i>			
SIT									
series	code	panel fastener	connectivity	grommet position	kick plate	supplier	pattern	color	
Example	SIT	BDFP	L	MH3C	L	W	J. ENNIS	LOFT	34

Modular

Corner Bench with Laminate Privacy Panel on Left

CBDLP

Corner bench with short back

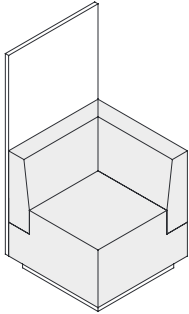

CBMLP

Corner bench with medium back

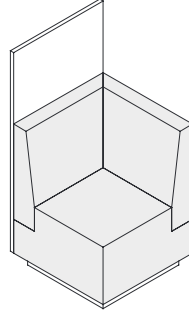

CBHLP

Corner bench with high back

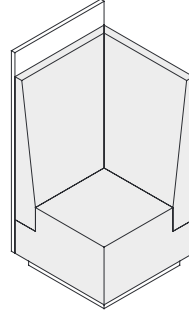

Combination of Colors

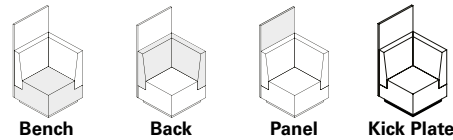

Manufacturing Standards

- 1" laminate privacy panel;
- Lacquered Russian plywood kick plate;
- 1" laminate construction;
- Velva firm density antibacterial foam;
- Single row of top stitching.

Dimensions:

Code	Total width	Total depth	Back height	Total height
CBDLP	26.75"	26.75"	29"	54"
CBMLP	26.75"	26.75"	36"	54"
CBHLP	26.75"	26.75"	48"	54"

COM Fabric:

Fabric combination possible. Number of yards required:

Code	Total	Bench	Back
CBDLP	6.5	2.5	4
CBMLP	7.5	2.5	5
CBHLP	9.5	2.5	7

Note: It is recommend that you include a layout with all orders.

Options

Privacy Panel Fastener Position

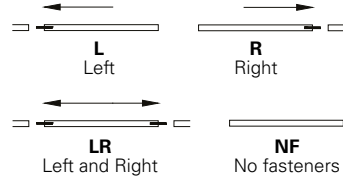

Grommet Connectivity

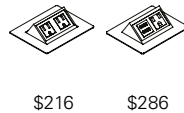

Grommet Position

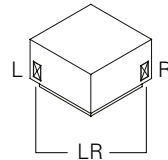

Prices

Code	COM GR1	GR2	GR3	GR4	GR5	GR6
CBDLP	1275	1371	1495	1611	1731	1851
CBMLP	1668	1812	1992	2172	2352	2532
CBHLP	1846	2038	2278	2518	2758	2998

How to Order

Combination of Colors					Finishes					Fabric				
SIT	CBDLP CBMLP CBHLP	L R LR NF	MH3C MH3D	L R LR	panel	kick plate	supplier	pattern	color	panel	kick plate	supplier	pattern	color
Example	SIT	CBDLP	L	MH3C	L	W	W	J. ENNIS	LOFT	34				

Modular

Corner Bench with Fabric Privacy Panel on Left

CBDLFP

Corner bench with short back

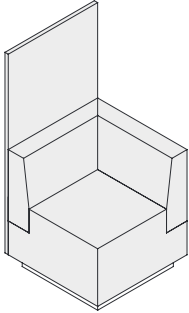

CBMLFP

Corner bench with medium back

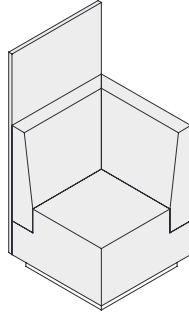

CBHLFP

Corner bench with high back

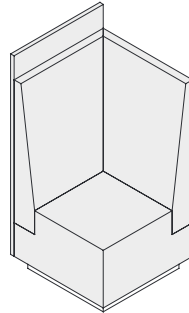

Combination of Colors

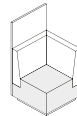

Bench

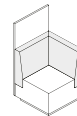

Back

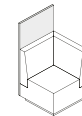

Panel

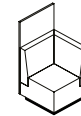

Kick Plate

Manufacturing Standards

- 1" laminate privacy panel;
- Lacquered Russian plywood kick plate;
- 1" laminate construction;
- Velva firm density antibacterial foam;
- Single row of top stitching.

Dimensions:

Code	Total width	Total depth	Back height	Total height
CBDLFP	26.75"	26.75"	29"	54"
CBMLFP	26.75"	26.75"	36"	54"
CBHLFP	26.75"	26.75"	48"	54"

COM Fabric:

Fabric combination possible. Number of yards required:

Code	Total	Bench	Back	Panel
CBDLFP	9	2.5	4	2.5
CBMLFP	10	2.5	5	2.5
CBHLFP	12	2.5	7	2.5

Note: It is recommend that you include a layout with all orders.

Options

Privacy Panel Fastener Position

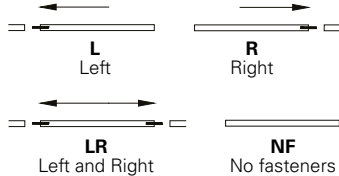

Grommet Connectivity

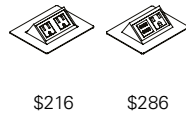

\$216

\$286

Grommet Position

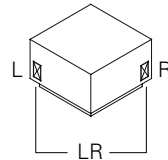

How to Order

					Combination of Colors				
					Finishes <i>See the Logiflex Color Guide</i>				
					Fabric <i>See the Logiflex Graded-in List</i>				
SIT									
series	code	panel fastener	connectivity	grommet position	kick plate	supplier	pattern	color	
Example	SIT	CBDLFP	L	MH3C	L	W	J. ENNIS	LOFT	34

Prices

Code	COM GR1	GR2	GR3	GR4	GR5	GR6
CBDLFP	1398	1550	1744	1930	2120	2310
CBMLFP	1765	1965	2215	2465	2715	2965
CBHLFP	1943	2191	2501	2811	3121	3431

Modular

Corner Bench with Laminate Privacy Panel on Right

CBDRP

Corner bench with short back

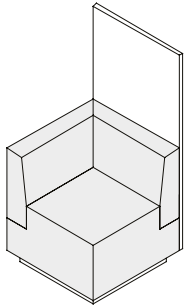

CBMRP

Corner bench with medium back

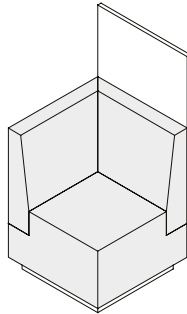

CBHRP

Corner bench with high back

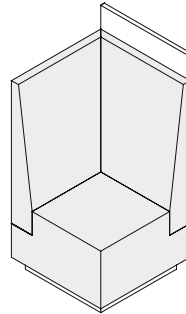

Combination of Colors

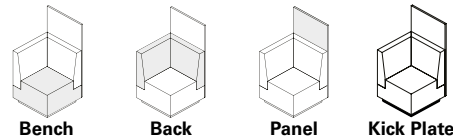

Manufacturing Standards

- 1" laminate privacy panel;
- Lacquered Russian plywood kick plate;
- 1" laminate construction;
- Velva firm density antibacterial foam;
- Single row of top stitching.

Dimensions:

Code	Total width	Total depth	Back height	Total height
CBDRP	26.75"	26.75"	29"	54"
CBMRP	26.75"	26.75"	36"	54"
CBHRP	26.75"	26.75"	48"	54"

COM Fabric:

Fabric combination possible. Number of yards required:

Code	Total	Bench	Back
CBDRP	6.5	2.5	4
CBMRP	7.5	2.5	5
CBHRP	9.5	2.5	7

Note: It is recommend that you include a layout with all orders.

Options

Privacy Panel Fastener Position

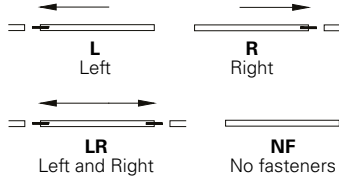

Grommet Connectivity

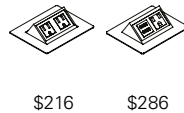

\$216

\$286

Grommet Position

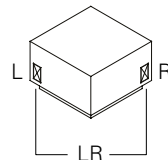

Prices

Code	COM GR1	GR2	GR3	GR4	GR5	GR6
CBDRP	1275	1371	1495	1611	1731	1851
CBMRP	1668	1812	1992	2172	2352	2532
CBHRP	1846	2038	2278	2518	2758	2998

How to Order

Combination of Colors

Finishes
See the Logiflex Color Guide

Fabric
See the Logiflex Graded-in List

SIT	CBDRP CBMRP CBHRP	L R LR NF	MH3C MH3D	L R LR	panel	kick plate	supplier	pattern	color
series	code	panel fastener	connectivity	grommet position					
Example SIT	CBDRP	L	MH3C	L	W	W	J. ENNIS	LOFT	34

Modular

Corner Bench with Fabric Privacy Panel on Right

CBDRFP

Corner bench with short back

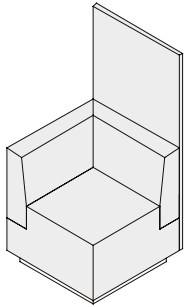

CBMRFP

Corner bench with medium back

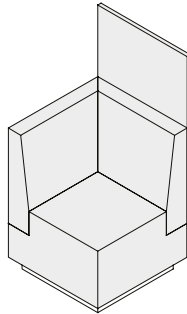

CBHRFP

Corner bench with high back

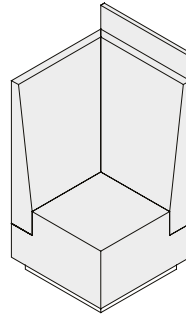

Combination of Colors

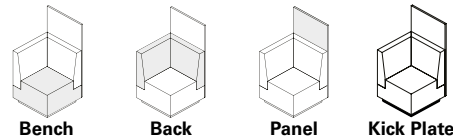

Manufacturing Standards

- 1" laminate privacy panel;
- Lacquered Russian plywood kick plate;
- 1" laminate construction;
- Velva firm density antibacterial foam;
- Single row of top stitching.

Dimensions:

Code	Total width	Total depth	Back height	Total height
CBDRFP	26.75"	26.75"	29"	54"
CBMRFP	26.75"	26.75"	36"	54"
CBHRFP	26.75"	26.75"	48"	54"

COM Fabric:

Fabric combination possible. Number of yards required:

Code	Total	Bench	Back	Panel
CBDRFP	9	2.5	4	2.5
CBMRFP	10	2.5	5	2.5
CBHRFP	12	2.5	7	2.5

Note: It is recommend that you include a layout with all orders.

Options

Privacy Panel Fastener Position

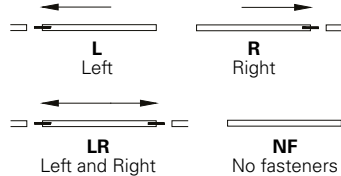

Grommet Connectivity

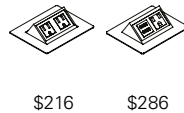

Grommet Position

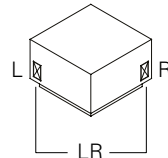

Prices

Code	COM GR1	GR2	GR3	GR4	GR5	GR6
CBDRFP	1398	1550	1744	1930	2120	2310
CBMRFP	1765	1965	2215	2465	2715	2965
CBHRFP	1943	2191	2501	2811	3121	3431

How to Order

		<div>+</div>			Combination of Colors				
		L R LR NF	MH3C MH3D	L R LR	Finishes <i>See the Logiflex Color Guide</i>	Fabric <i>See the Logiflex Graded-in List</i>			
SIT									
series	code	panel fastener	connectivity	grommet position	kick plate	supplier	pattern	color	
Example	SIT	CBDRFP	L	MH3C	L	W	J. ENNIS	LOFT	34

Modular

Corner Bench with Laminate Privacy Panel

CBDP

Corner bench with short back

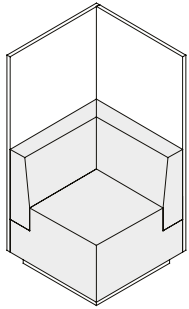

CBMP

Corner bench with medium back

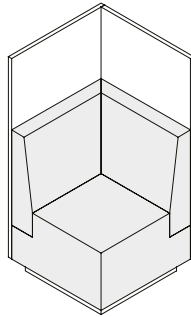

CBHP

Corner bench with high back

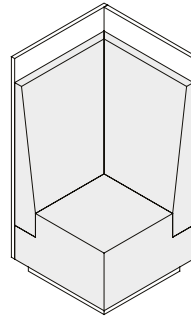

Combination of Colors

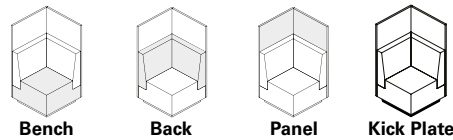

Manufacturing Standards

- 1" laminate privacy panel;
- Lacquered Russian plywood kick plate;
- 1" laminate construction;
- Velva firm density antibacterial foam;
- Single row of top stitching.

Dimensions:

Code	Total width	Total depth	Back height	Total height
CBDP	26.75"	26.75"	29"	54"
CBMP	26.75"	26.75"	36"	54"
CBHP	26.75"	26.75"	48"	54"

COM Fabric:

Fabric combination possible. Number of yards required:

Code	Total	Bench	Back
CBDP	6.5	2.5	4
CBMP	7.5	2.5	5
CBHP	9.5	2.5	7

Note: It is recommend that you include a layout with all orders.

Options

Privacy Panel Fastener Position

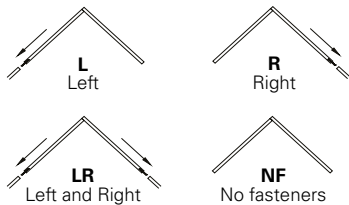

Panel Orientation

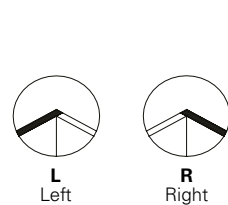

Grommet Connectivity

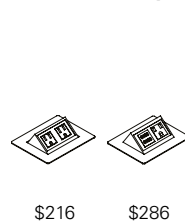

Grommet Position

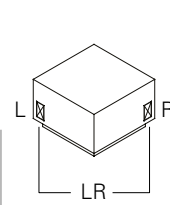

Prices

Code	COM GR1	GR2	GR3	GR4	GR5	GR6
CBDP	1387	1483	1607	1723	1843	1963
CBMP	1777	1921	2101	2281	2461	2641
CBHP	1955	2147	2387	2627	2867	3107

How to Order

						Combination of Colors				
		CBDP CBMP CBHP	L R LR NF	L R	MH3C MH3D	L R LR	Finishes <i>See the Logiflex Color Guide</i>		Fabric <i>See the Logiflex Graded-in List</i>	
SIT							panel	kick plate	supplier	pattern
series	code	panel fastener	panel orientation	connectivity	grommet position					color
Example	SIT	CBDP	L	L	MH3C	L	W	W	J. ENNIS	LOFT 34

Modular

Corner Bench with Fabric Privacy Panel

CBDFP

Corner bench with short back

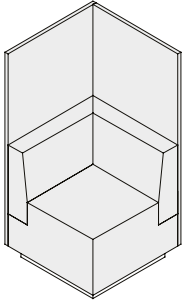

CBMFP

Corner bench with medium back

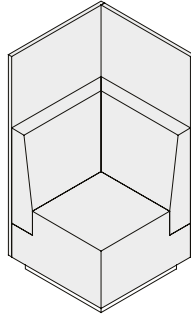

CBHFP

Corner bench with high back

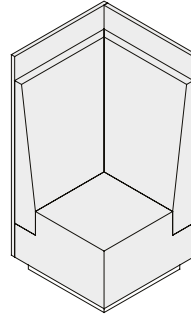

Combination of Colors

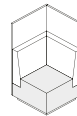

Bench

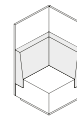

Back

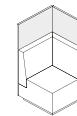

Panel

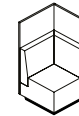

Kick Plate

Manufacturing Standards

- 1" laminate privacy panel;
- Lacquered Russian plywood kick plate;
- 1" laminate construction;
- Velva firm density antibacterial foam;
- Single row of top stitching.

Dimensions:

Code	Total width	Total depth	Back height	Total height
CBDFP	26.75"	26.75"	29"	54"
CBMFP	26.75"	26.75"	36"	54"
CBHFP	26.75"	26.75"	48"	54"

COM Fabric:

Fabric combination possible. Number of yards required:

Code	Total	Bench	Back	Panel
CBDFP	11	2.5	4	4.5
CBMFP	12	2.5	5	4.5
CBHFP	14	2.5	7	4.5

Note: It is recommend that you include a layout with all orders.

Options

Panel Orientation

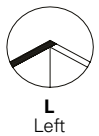

L
Left

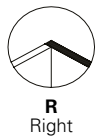

R
Right

Privacy Panel Fastener Position

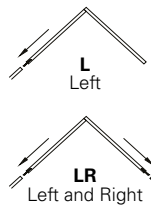

L
Left

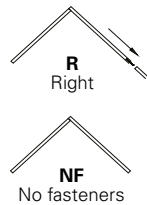

R
Right



LR
Left and Right



NF
No fasteners

Grommet Connectivity



\$216



\$286

Grommet Position

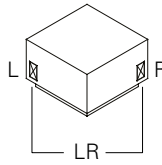

L

R

LR

Prices

Code	COM	GR1	GR2	GR3	GR4	GR5	GR6
CBDFP	1631	1839	2103	2359	2619	2879	
CBMFP	1970	2226	2546	2866	3186	3506	
CBHFP	2148	2452	2832	3212	3592	3972	

How to Order

Combination of Colors

Finishes
See the
Logiflex
Color Guide

Fabric
See the Logiflex Graded-in List

	CBDFP CBMFP CBHFP	L R LR NF	L R	MH3C MH3D	L R LR				
SIT									
series	code	panel fastener	panel orientation	connectivity	grommet position	kick plate	supplier	pattern	color
Example	SIT	CBDFP	L	L	MH3C	L	W	J. ENNIS	LOFT 34

Modular

Occasional Tables with Laminate Frame and Privacy Panel

TP

Laminate privacy panel

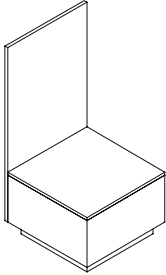

TFP

Fabric privacy panel

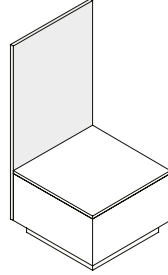

Combination of Colors

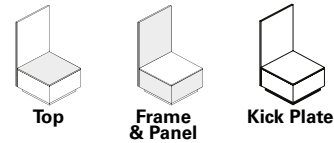

Manufacturing Standards

- 1" laminate privacy panel;
- Lacquered Russian plywood kick plate;
- 1" laminate construction;
- Single row of top stitching.

Dimensions:

Code	Total width	Total depth	Total height
TP	26.75"	26.75"	54"
TFP	26.75"	26.75"	54"

COM Fabric: number of yards required:

Code	Total	Panel
TFP	2.5	2.5

Note: It is recommend that you include a layout with all orders.

Options

Privacy Panel Fastener Position

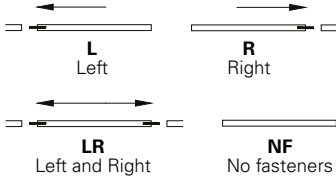

Grommet Connectivity

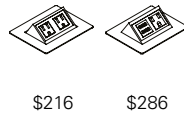

Grommet Position

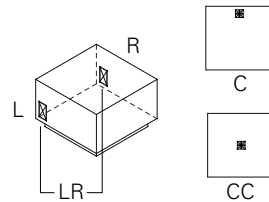

Air Charger

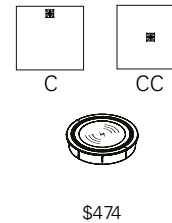

Prices

Code	TFL
TP	735

Code	COM	GR1	GR2	GR3	GR4	GR5	GR6
TFP	858	914	984	1054	1124	1194	

How to Order

Combination of Colors

Finishes

See the Logiflex Color Guide

Fabric

See the Logiflex Graded-in List

SIT	TP	TFP	L	R	LR	NF	MH3C	MH3D	L	R	LR	C	CC	QIBLC	QIBLCC
series	code	panel fastener	connectivity	grommet position	Qi (Appx. B)										
Example	SIT	TP	L	MH3C	L	QIBLCC									

Modular

Occasional Tables with Fabric Frame and Privacy Panel

FTP

Laminate privacy panel

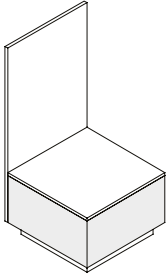

FTFP

Fabric privacy panel

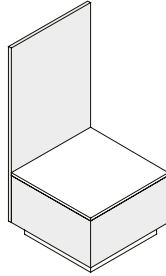

Combination of Colors

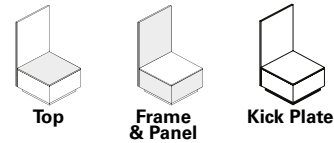

Manufacturing Standards

- 1" laminate privacy panel;
- Lacquered Russian plywood kick plate;
- 1" laminate construction;
- Single row of top stitching.

Dimensions:

Code	Total width	Total depth	Total height
FTP	26.75"	26.75"	54"
FTFP	26.75"	26.75"	54"

COM Fabric:

Fabric combination possible. Number of yards required:

Code	Total	Frame	Panel
FTP	2.5	2.5	-
FTFP	5	2.5	2.5

Note: It is recommend that you include a layout with all orders.

Options

Privacy Panel Fastener Position

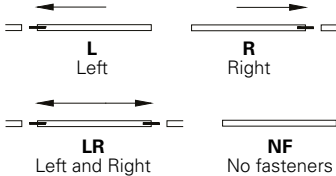

Grommet Connectivity

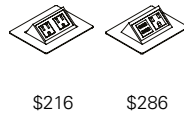

Grommet Position

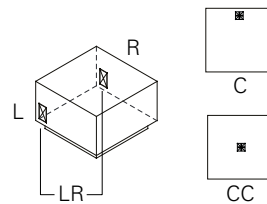

Air Charger

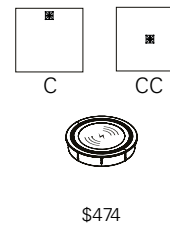

Prices

Code	COM GR1	GR2	GR3	GR4	GR5	GR6
FTP	790	838	898	958	1018	1078
FTFP	913	1017	1147	1277	1407	1537

How to Order

Combination of Colors

Finishes
See the Logiflex Color Guide

Fabric
See the Logiflex Graded-in List

SIT	FTP	FTFP	LR NF	MH3C MH3D	LR C CC	QIBLC QIBLCC	top	frame / panel	kick plate	supplier	pattern	color
-----	-----	------	-------	-----------	---------	--------------	-----	---------------	------------	----------	---------	-------

Example SIT FTP L MH3C L QIBLCC W W W J. ENNIS LOFT 34

Modular

Occasional Corner Tables with Laminate Frame and Privacy Panel

CTP

Laminate privacy panel

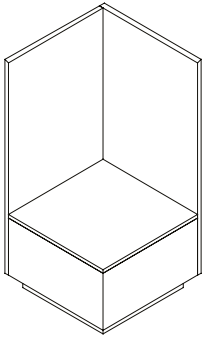

CTFP

Fabric privacy panel

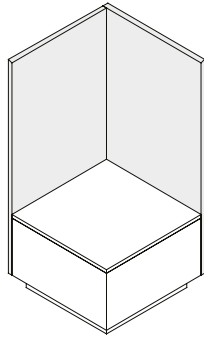

Combination of Colors

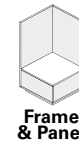
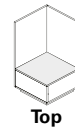

Manufacturing Standards

- 1" laminate privacy panel;
- Lacquered Russian plywood kick plate;
- 1" laminate construction;
- Single row of top stitching.

Dimensions:

Code	Total width	Total depth	Total height
CTP	26.75"	26.75"	54"
CTFP	26.75"	26.75"	54"

COM Fabric: number of yards required:

Code	Total	Panel
CTFP	4.5	4.5

Note: It is recommend that you include a layout with all orders.

Options

Privacy Panel Fastener Position

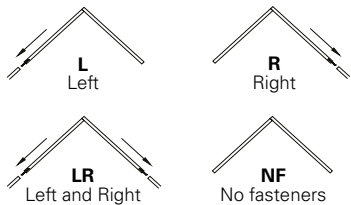

Panel Orientation

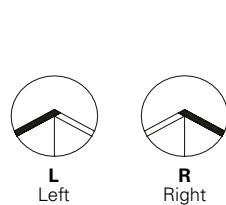

Grommet Connectivity

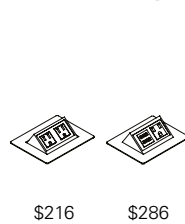

Grommet Position

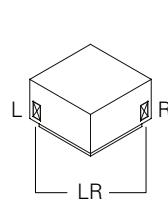

Air Charger

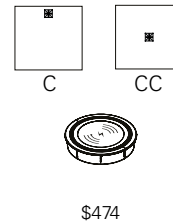

Prices

Code	TFL
CTP	819

Code	COM	GR1	GR2	GR3	GR4	GR5	GR6
CTFP	1063	1175	1315	1455	1595	1735	

How to Order

							Combination of Colors					
		CTP CTFP	L R LR NF	L R	MH3C MH3D	L R LR C CC	Finishes <i>See the Logiflex Color Guide</i>		Fabric <i>See the Logiflex Graded-in List</i>			
SIT												
series	code	panel fastener	panel orientation	connectivity	grommet position	Qi (Appx. B)	top	frame / panel	kick plate	supplier	pattern	color
Example	SIT CTP	L	L	MH3C	L	QIBLCC	W	W	W	J. ENNIS	LOFT	34

Modular

Occasional Corner Tables with Fabric Frame and Privacy Panel

CFTP

Laminate privacy panel

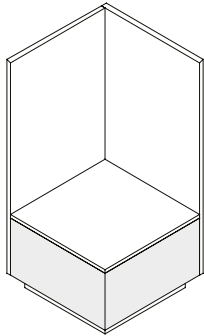

CFTFP

Fabric privacy panel

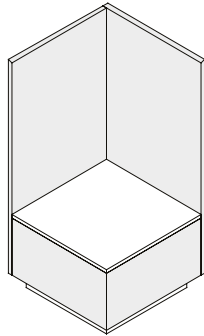

Combination of Colors

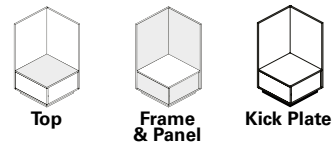

Manufacturing Standards

- 1" laminate privacy panel;
- Lacquered Russian plywood kick plate;
- 1" laminate construction;
- Single row of top stitching.

Dimensions:

Code	Total width	Total depth	Total height
CFTP	26.75"	26.75"	54"
CFTFP	26.75"	26.75"	54"

COM Fabric:

Fabric combination possible. Number of yards required:

Code	Total	Frame	Panel
CFTP	2.5	2.5	-
CFTFP	7	2.5	4.5

Note: It is recommend that you include a layout with all orders.

Options

Privacy Panel Fastener Position

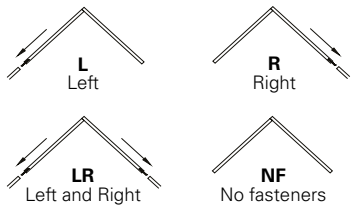

Panel Orientation

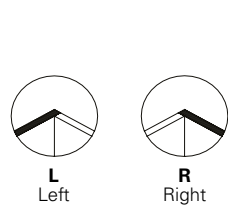

Grommet Connectivity

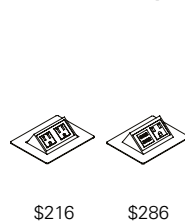

Grommet Position

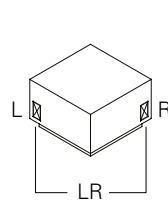

Air Charger

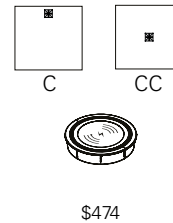

How to Order

Combination of Colors

Finishes
See the Logiflex Color Guide

Fabric
See the Logiflex Graded-in List

SIT	CFTP	CFTFP	L R LR NF	L R	MH3C MH3D	L R LR C CC	QIBLC QIBLCC	top	frame / panel	kick plate	supplier	pattern	color
series	code	panel fastener	panel orientation	connectivity	grommet position	Qi (Appx. B)							
Example	SIT	CFTP	L	L	MH3C	L	QIBLCC	W	W	W	J. ENNIS	LOFT	34

Modular

Bookshelf Tables with Privacy Panel

TBP

Laminate privacy panel

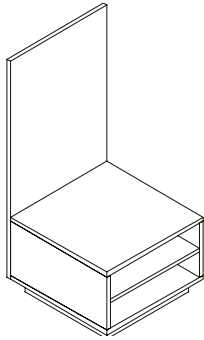

TBFP

Fabric privacy panel

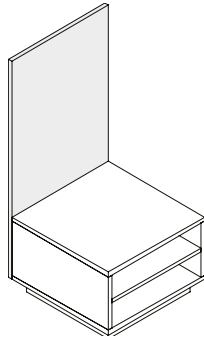

Combination of Colors

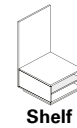
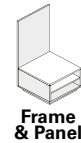
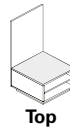

Manufacturing Standards

- 1" laminate top;
- Bookshelf with 1 fixed shelf;
- Vertical central separator;
- 1" laminate privacy panel;
- Lacquered Russian plywood kick plate;
- 1" laminate construction;
- Single row of top stitching.

Dimensions:

Code	Total width	Total depth	Total height
TBP	26.75"	26.75"	54"
TBFP	26.75"	26.75"	54"

COM Fabric: number of yards required:

Code	Total	Panel
TBFP	2.5	2.5

Note: It is recommend that you include a layout with all orders.

Options

Privacy Panel Fastener Position

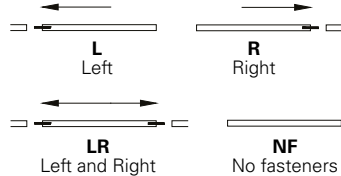

Prices

Code	TFL
TBP	713

Code	COM	GR1	GR2	GR3	GR4	GR5	GR6
TBFP	836	892	962	1032	1102	1172	

How to Order

Combination of Colors									
SIT	TBP TBFP	L R LR NF	Finishes <i>See the Logiflex Color Guide</i>				Fabric <i>See the Logiflex Graded-in List</i>		
			top	frame / panel	shelf	kick plate	supplier	pattern	color
Example	SIT	TBP	L	W	W	W	W	J. ENNIS	LOFT 34

Modular

Bookshelf Tables with Opening on Left and Privacy Panel

TBLP

Laminate privacy panel

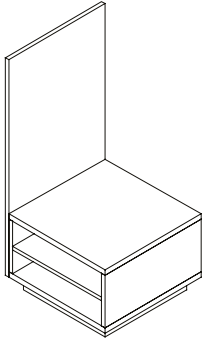

TBLFP

Fabric privacy panel

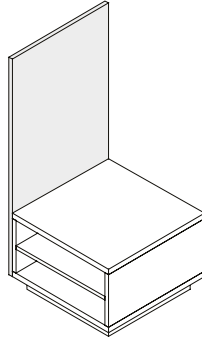

Combination of Colors

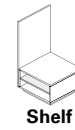
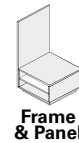
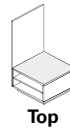

Manufacturing Standards

- 1" laminate top;
- 1 bookshelf with 1 fixed shelf;
- Vertical central separator;
- 1" laminate privacy panel;
- Lacquered Russian plywood kick plate;
- 1" laminate construction;
- Single row of top stitching.

Dimensions:

Code	Total width	Total depth	Total height
TBLP	26.75"	26.75"	54"
TBLFP	26.75"	26.75"	54"

COM Fabric: number of yards required:

Code	Total	Panel
TBLFP	2.5	2.5

Note: It is recommend that you include a layout with all orders.

Options

Privacy Panel Fastener Position

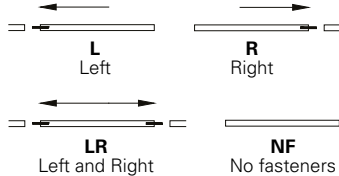

How to Order

Combination of Colors									
SIT	TBLP TBLFP	L R LR NF	Finishes <i>See the Logiflex Color Guide</i>				Fabric <i>See the Logiflex Graded-in List</i>		
			top	frame / panel	shelf	kick plate	supplier	pattern	color
Example	SIT	TBLP	L	W	W	W	W	J. ENNIS	LOFT 34

Prices

Code	TFL
TBLP	713

Code	COM	GR1	GR2	GR3	GR4	GR5	GR6
TBLFP	836	892	962	1032	1102	1172	

Modular

Bookshelf Tables with Opening on Right and Privacy Panel

TBRP

Laminate privacy panel

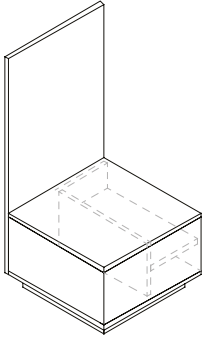

TBRFP

Fabric privacy panel

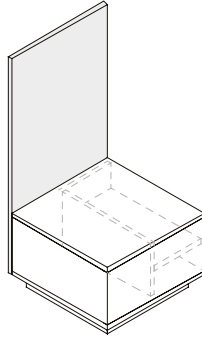

Combination of Colors

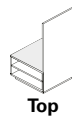

Top

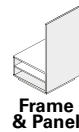

Frame & Panel

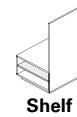

Shelf



Kick Plate

Manufacturing Standards

- 1" laminate top;
- 1 bookshelf with 1 fixed shelf;
- Vertical central separator;
- 1" laminate privacy panel;
- Lacquered Russian plywood kick plate;
- 1" laminate construction;
- Single row of top stitching.

Dimensions:

Code	Total width	Total depth	Total height
TBRP	26.75"	26.75"	54"
TBRFP	26.75"	26.75"	54"

COM Fabric: number of yards required:

Code	Total	Panel
TBRFP	2.5	2.5

Note: It is recommend that you include a layout with all orders.

Options

Privacy Panel Fastener Position

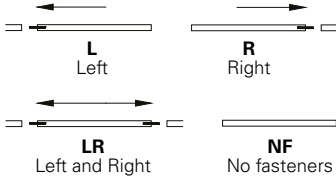

How to Order

Combination of Colors									
SIT	TBRP TBRFP	L R LR NF	Finishes <i>See the Logiflex Color Guide</i>				Fabric <i>See the Logiflex Graded-in List</i>		
			top	frame / panel	shelf	kick plate	supplier	pattern	color
Example	SIT	TBRP	L	W	W	W	W	J. ENNIS	LOFT 34

Prices

Code	TFL
TBRP	713

Code	COM	GR1	GR2	GR3	GR4	GR5	GR6
TBRFP	836	892	962	1032	1102	1172	

Modular

Corner Bookshelf Tables with Opening on Left and Privacy Panel

CTBLP

Laminate privacy panel

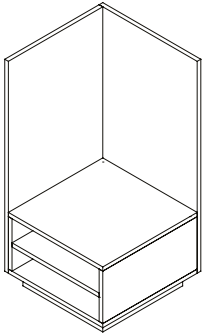

CTBLFP

Fabric privacy panel

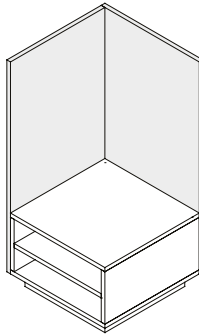

Combination of Colors

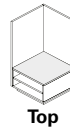

Top

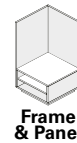

Frame & Panel

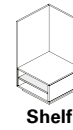

Shelf

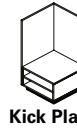

Kick Plate

Manufacturing Standards

- 1" laminate top;
- 1 bookshelf with 1 fixed shelf;
- Vertical central separator;
- 1" laminate privacy panel;
- Lacquered Russian plywood kick plate;
- 1" laminate construction;
- Single row of top stitching.

Dimensions:

Code	Total width	Total depth	Total height
CTBLP	26.75"	26.75"	54"
CTBLFP	26.75"	26.75"	54"

COM Fabric: number of yards required:

Code	Total	Panel
CTBLFP	4.5	4.5

Note: It is recommend that you include a layout with all orders.

Options

Privacy Panel Fastener Position

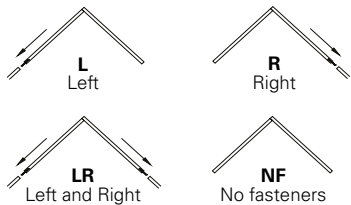

Panel Orientation

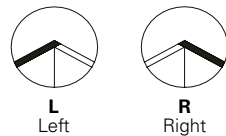

How to Order

Combination of Colors

Finishes See the Logiflex Color Guide

Fabric See the Logiflex Graded-in List

		<div><div></div><div>L R LR NF</div><div></div><div>L R</div></div>	Combination of Colors							
CTBLP CTBLFP			Finishes <i>See the Logiflex Color Guide</i>				Fabric <i>See the Logiflex Graded-in List</i>			
SIT										
series	code	panel fastener	panel orientation	top	frame / panel	shelf	kick plate	supplier	pattern	color
SIT	CTBLP	L	L	W	W	W	W	J. ENNIS	LOFT	34

Prices

Code	TFL
CTBLP	797

Code	COM GR1	GR2	GR3	GR4	GR5	GR6
CTBLFP	1041	1153	1293	1433	1573	1713

Modular

Corner Bookshelf Tables with Opening on Right and Privacy Panel

CTBRP

Laminate privacy panel

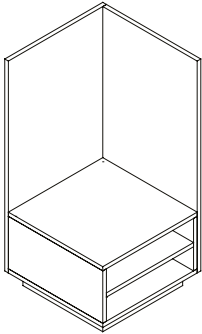

CTBRFP

Fabric privacy panel

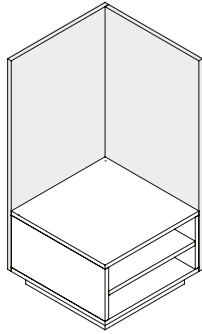

Combination of Colors

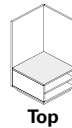

Top

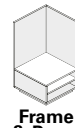

Frame
& Panel

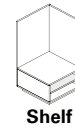

Shelf

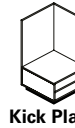

Kick Plate

Manufacturing Standards

- 1" laminate top;
- 1 bookshelf with 1 fixed shelf;
- Vertical central separator;
- 1" laminate privacy panel;
- Lacquered Russian plywood kick plate;
- 1" laminate construction;
- Single row of top stitching.

Dimensions:

Code	Total width	Total depth	Total height
CTBRP	26.75"	26.75"	54"
CTBRFP	26.75"	26.75"	54"

COM Fabric: number of yards required:

Code	Total	Panel
CTBLFP	4.5	4.5

Note: It is recommend that you include a layout with all orders.

Options

Privacy Panel Fastener Position

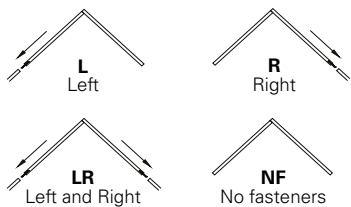

Panel Orientation

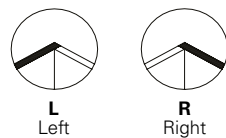

How to Order

Combination of Colors

Finishes
See the Logiflex Color Guide

Fabric
See the Logiflex Graded-in List

SIT	CTBRP CTBRFP	L R LR NF	L R							
				top	frame / panel	shelf	kick plate	supplier	pattern	color
series	code	panel fastener	panel orientation	W	W	W	W	J. ENNIS	LOFT	34

Example

Modular

Occasional Table with Laminate Frame

T

Laminate frame

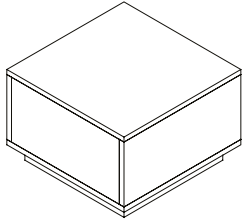

Combination of Colors



Top



Frame



Kick Plate

Manufacturing Standards

- 1" laminate top and frame;
- Lacquered Russian plywood kick plate;
- 1" laminate construction.

Dimensions:

Code	Total width	Total depth	Total height
T	26.75"	26.75"	18"

Note: It is recommend that you include a layout with all orders.

Options

Marker Board



MB

\$188

Grommet Connectivity



\$216

\$286

Grommet Position

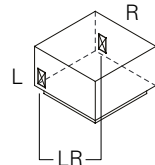

C



CC

Air Charger



C



CC



\$474

Prices

Code	COM
T	GR1 572

How to Order

Combination of Colors

Finishes

See the Logiflex Color Guide

Fabric

See the Logiflex Graded-in List

		MB	MH3C MH3D	L R C CC	QIBLC QIBLCC						
SIT	T										
series	code	marker board	connectivity	grommet position	Qi (Appx. B)	top	frame	kick plate	supplier	pattern	color
Example	SIT	T	MB	MH3C	L	QIBLCC	W	W	W	J. ENNIS	LOFT 34

Modular

Occasional Table with Fabric Frame

FT

Fabric frame

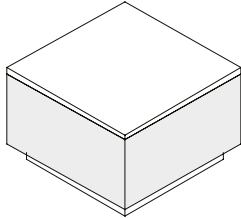

Combination of Colors

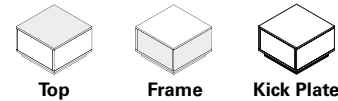

Manufacturing Standards

- 1" laminate top;
- Fabric frame
- Lacquered Russian plywood kick plate;
- 1" laminate construction.

Dimensions:

Code	Total width	Total depth	Total height
FT	26.75"	26.75"	18"

COM Fabric: number of yards required:

Code	Total	Frame
FT	2.5	2.5

Note: It is recommend that you include a layout with all orders.

Options

Marker Board



MB
\$188

Grommet Connectivity



\$216 \$286

Grommet Position

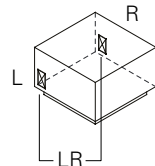

C



CC

Air Charger

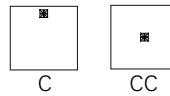

C



CC

\$474

Prices

Code	COM GR1	GR2	GR3	GR4	GR5	GR6
FT	591	639	699	759	819	879

How to Order

Combination of Colors

Finishes
See the Logiflex
Color Guide

Fabric
See the Logiflex Graded-in List

SIT	FT	MB	MH3C MH3D	L R C CC	QIBLC QIBLCC	top	kick plate	supplier	pattern	color
series	code	marker board	connectivity	grommet position	Qi (Appx. B)					
Example	SIT	FT	MB	MH3C	L	QIBLCC	W	W	J. ENNIS	LOFT 34

Modular

Bookshelf Tables with Laminate Frame

TB1

Open on 1 side

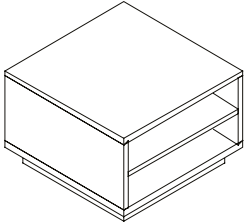

TB2

Open on 2 sides

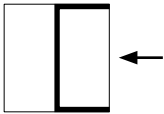
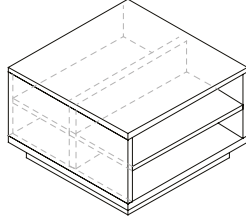

TB1- top view

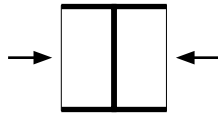

TB2- top view

Combination of Colors



Top



Frame



Shelf



Kick Plate

Manufacturing Standards

- 1" laminate top;
- Bookshelf with 1 fixed shelf per open side;
- Vertical central separator;
- Lacquered Russian plywood kick plate;
- 1" laminate construction.

Dimensions:

Code	Total width	Total depth	Total height
TB1	26.75"	26.75"	18"
TB2	26.75"	26.75"	18"

Note: It is recommend that you include a layout with all orders.

Options

Marker Board



MB
\$188

Prices

Code	
TB1	608
TB2	608

How to Order

				Combination of Colors			
				Finishes			
				See the Logiflex Color Guide			
SIT	TB1 TB2	MB		top	frame	shelf	kick plate
series	code	marker board					
Example SIT	TB1	MB		W	W	W	W

Modular

Occasional Table with Laminate Frame and Casters

TC

Laminate frame

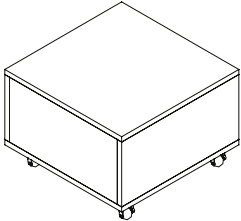

Manufacturing Standards

- 1" laminate top and frame;
- Four ball castors with breaks;
- 1" laminate construction.

Dimensions:

Code	Total width	Total depth	Total height
TC	26.75"	26.75"	18"

Note: It is recommend that you include a layout with all orders.

Combination of Colors



Top



Frame

Options

Marker Board



MB
\$188

Prices

Code	
TC	536

How to Order



Combination of Colors

Finishes
*See the Logiflex
Color Guide*

SIT	TC	MB		
series	code	marker board	top	frame

Example SIT TC MB W W

Modular

Occasional Table with Fabric Frame with Casters

FTC

Fabric frame

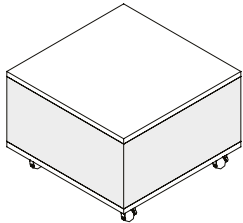

Combination of Colors



Top



Frame

Manufacturing Standards

- 1" laminate top;
- Fabric frame
- Four ball castors with breaks;
- 1" laminate construction.

Dimensions:

Code	Total width	Total depth	Total height
TC	26.75"	26.75"	18"

COM Fabric: number of yards required:

Code	Total	Frame
FTC	2.5	2.5

Note: It is recommend that you include a layout with all orders.

Options

Marker Board



MB
\$188

How to Order

			<div>+</div> <div>MB</div>	Combination of Colors			
				Finishes <i>See the Logiflex Color Guide</i>	Fabric <i>See the Logiflex Graded-in List</i>		
	SIT	FTC					
	series	code	marker board	top	supplier	pattern	color
Example	SIT	FTC	MB	W	J. ENNIS	LOFT	34

Prices

Code	COM GR1	GR2	GR3	GR4	GR5	GR6
FTC	583	631	691	751	811	871

Modular

Bookshelf Tables with Laminate Frame and Casters

TBC1

Open on 1 side

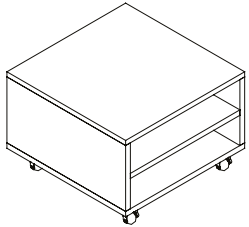

TBC2

Open on 2 sides

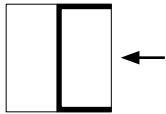
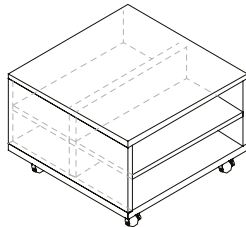

TBC1- top view

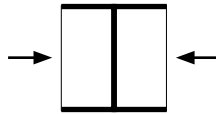

TBC2- top view

Combination of Colors



Manufacturing Standards

- 1" laminate top;
- Bookshelf with 1 fixed shelf per open side;
- Vertical central separator;
- Four ball castors with breaks;
- 1" laminate construction.

Dimensions:

Code	Total width	Total depth	Total height
TC	26.75"	26.75"	18"

Note: It is recommend that you include a layout with all orders.

+ Options

Marker Board



MB
\$188

\$ Prices

Code	TFL
TBC1	544
TBC2	544

How to Order



Combination of Colors

Finishes

See the Logiflex Color Guide

TBC1 TBC2			MB		
SIT					
series	code	marker board	top	frame	shelf
Example SIT	TBC1	MB	W	W	W

Modular

Bench with Fabric Frame and Built-in Table with Laminate Frame

26BT

Laminate frame table

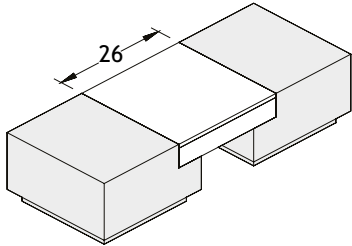

38BT

Laminate frame table

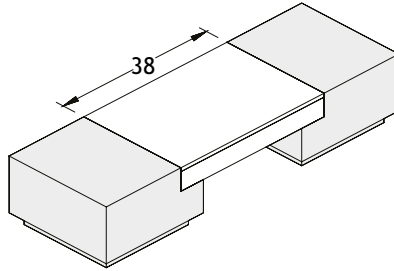

Combination of Colors

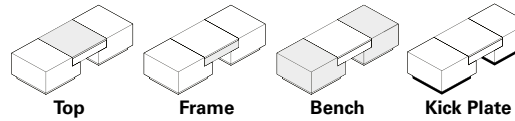

Manufacturing Standards

- 1" laminate top;
- 2 fabric benches;
- 1 built-in table with 1" 1" laminate top and frame;
- Lacquered Russian plywood kick plate;
- Velva firm density antibacterial foam;
- 1" laminate construction.

Dimensions:

Code	Largeur totale	Profondeur totale	Total height	Table length
26BT	66.50"	26.75"	18"	26"
38BT	26.75"	26.75"	18"	38"

COM Fabric: number of yards required:

Code	Total	Bench
26BT	5	5
38BT	5	5

Note: It is recommend that you include a layout with all orders.

Options

Grommet Connectivity



\$216

\$286

Grommet Position

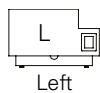

Left



C

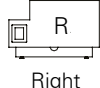

Right



CC

Air Charger



C



CC



\$474

Prices

Code	COM GR1	GR2	GR3	GR4	GR5	GR6
26BT	1792	1888	2008	2128	2248	2368
38BT	1828	1924	2044	2164	2284	2404

How to Order

Combination of Colors

Finishes

See the Logiflex Color Guide

Fabric

See the Logiflex Graded-in List

SIT	26BT 38BT	MH3C MH3D	L R C CC	QIBLC QIBLCC	top	frame	kick plate	supplier	pattern	color
series	code	connectivity	grommet position	Qi (Appx. B)						
Example SIT	26BT	MH3C	L	QIBLCC	W	W	W	J. ENNIS	LOFT	34

Modular

Bench with Fabric Frame and Built-in Table with Fabric Frame

26BFT

Fabric frame table

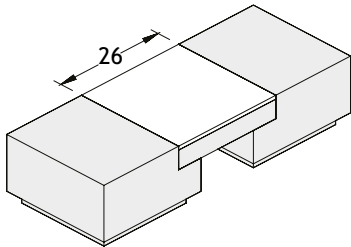

38BFT

Fabric frame table

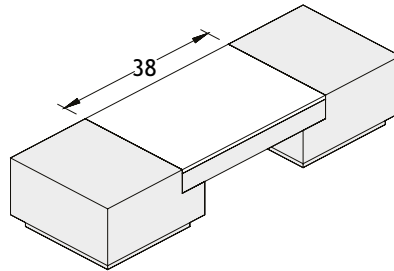

Combination of Colors

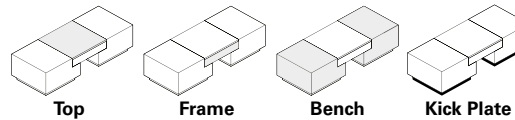

Manufacturing Standards

- 1" laminate top;
- 2 fabric benches;
- 1 built-in table with 1" laminate top and fabric frame;
- Lacquered Russian plywood kick plate;
- Velva firm density antibacterial foam;
- 1" laminate construction.

Dimensions:

Code	Largeur totale	Profondeur totale	Total height	Table length
26BFT	66.50"	26.75"	18"	26"
38BFT	26.75"	26.75"	18"	38"

COM Fabric:

Fabric combination possible. Number of yards required:

Code	Total	Bench	Table
26BFT	7	5	2
38BFT	7.5	5	2.5

Note: It is recommend that you include a layout with all orders.

Options

Grommet Connectivity



\$216

\$286

Grommet Position

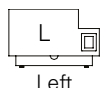

Left



C



Right



CC

Air Charger



C



CC



\$474

How to Order

Combination of Colors

Finishes
See the Logiflex
Color Guide

Fabric
See the Logiflex Graded-in List

	26BFT 38BFT	MH3C MH3D	L R C CC	QIBLC QIBLCC					
SIT									
series	code	connectivity	grommet position	Qi (Appx. B)	top	kick plate	supplier	pattern	color
Example	SIT	26BFT	MH3C	L	QIBLCC	W	W	J. ENNIS	LOFT 34

Prices

Code	COM GR1	GR2	GR3	GR4	GR5	GR6
26BFT	1615	1743	1903	2063	2223	2383
38BFT	1674	1810	1980	2150	2320	2490

Modular

Circular Bench

CLA

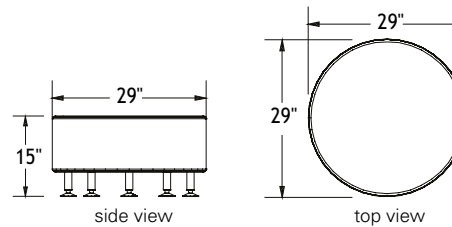
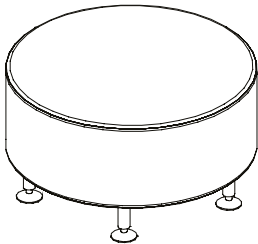

Manufacturing Standards

- 5 brushed chrome metal legs;
- Single top stitching;
- Firm density Velva foam on seat;
- 1/2" thick polyester on sides of the bench;
- Seat frame made out of recycled materials.

Double Stitching: Double stitching is an option on Grade 1 to 4 and COM fabrics. Double stitching is standard for Grade 5 and 6 fabrics.

COM Fabric: Number of yards required:

Code	Total
CLA	3

Note: It is recommend that you include a layout with all orders.

Options

Double Stitching

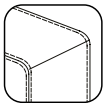

\$0

Prices

Code	COM					
	GR1	GR2	GR3	GR4	GR5	GR6
CLA	918	1020	1147	1275	1403	1530

How to Order

		PQD PQS (std)	Fabric See the Logiflex Graded-in List		
SS	CLA				
series	code	top stitching	supplier	pattern	color
Example SS	CLA	PQS	J. ENNIS	ASTRAL	71

Modular

Circular Single Nestle Bench

CLAS

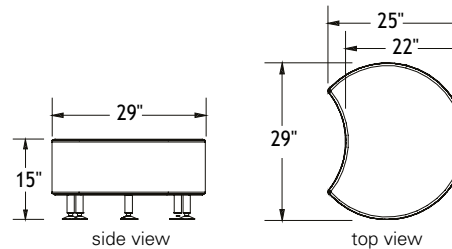
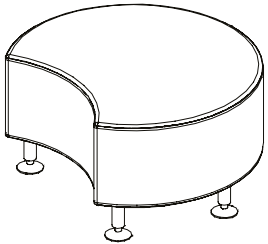

Manufacturing Standards

- 5 brushed chrome metal legs;
- Single top stitching;
- Firm density Velva foam on seat;
- 1/2" thick polyester on sides of the bench;
- Seat frame made out of recycled materials.

Double Stitching: Double stitching is an option on Grade 1 to 4 and COM fabrics. Double stitching is standard for Grade 5 and 6 fabrics.

COM Fabric: Number of yards required:

Code	Total
CLAS	3

Note: It is recommend that you include a layout with all orders.

Options

Double Stitching

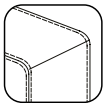

\$0

Prices

Code	COM	GR1	GR2	GR3	GR4	GR5	GR6
CLAS	918	1020	1147	1275	1403	1530	

How to Order

		PQD PQS (std)	Fabric See the Logiflex Graded-in List		
SS	CLAS				
series	code	top stitching	supplier	pattern	color
Example SS	CLAS	PQS	J. ENNIS	ASTRAL	71

Modular

Circular Double Nestle Bench

CLAD

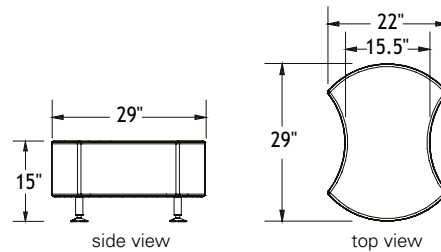
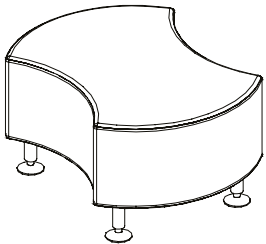

Manufacturing Standards

- 5 brushed chrome metal legs;
- Single top stitching;
- Firm density Velva foam on seat;
- 1/2" thick polyester on sides of the bench;
- Seat frame made out of recycled materials.

Double Stitching: Double stitching is an option on Grade 1 to 4 and COM fabrics. Double stitching is standard for Grade 5 and 6 fabrics.

COM Fabric: Number of yards required:

Code	Total
CLAD	2

Note: It is recommend that you include a layout with all orders.

Options

Double Stitching

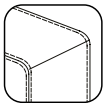

\$0

Prices

Code	COM	GR1	GR2	GR3	GR4	GR5	GR6
CLAD	918	1020	1147	1275	1403	1530	

How to Order

		PQD PQS (std)	Fabric See the Logiflex Graded-in List		
SS	CLAD				
series	code	top stitching	supplier	pattern	color
Example SS	CLAD	PQS	J. ENNIS	ASTRAL	71

Modular

Circular Bench With Back Rest

CLAB

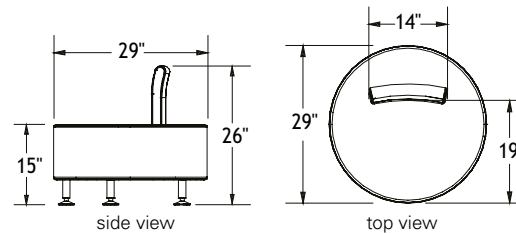
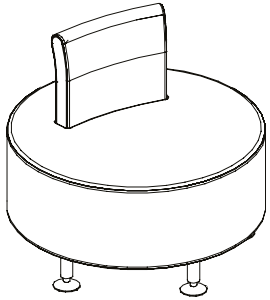

Manufacturing Standards

- 5 brushed chrome metal legs;
- Single top stitching;
- Elastic straps on back;
- Firm density Velva foam on seat;
- 1/2" thick polyester on sides of the bench;
- Seat frame made out of recycled materials.

Double Stitching: Double stitching is an option on Grade 1 to 4 and COM fabrics. Double stitching is standard for Grade 5 and 6 fabrics.

COM Fabric: Number of yards required:

Code	Total
CLAB	3

Note: It is recommend that you include a layout with all orders.

Options

Double Stitching

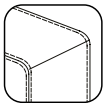

\$0

Prices

Code	COM	GR1	GR2	GR3	GR4	GR5	GR6
CLAB	1573	1709	1879	2049	2219	2389	

How to Order

		PQD PQS (std)	Fabric See the Logiflex Graded-in List		
SS	CLAB				
series	code	top stitching	supplier	pattern	color
Example SS	CLAB	PQS	J. ENNIS	ASTRAL	71

Modular

Square Bench

010BSQ24

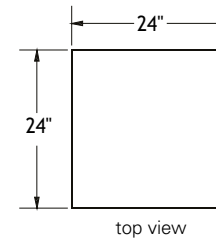
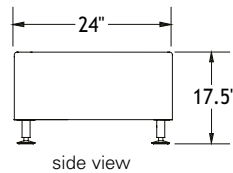
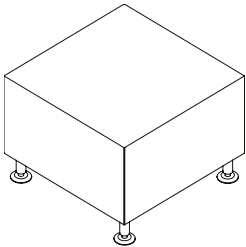

Manufacturing Standards

- 4 brushed chrome metal legs;
- Single top stitching;
- Elastic straps on seat;
- Firm density Velva foam on seat;
- 1/2" thick polyester on sides;
- Frame made out of recycled materials.

Double Stitching: Double stitching is an option on Grade 1 to 4 and COM fabrics. Double stitching is standard for Grade 5 and 6 fabrics.

COM Fabric: Number of yards required:

Code	Total
010BSQ24	2

Note: It is recommended that you include a layout with all orders.

Options

Double Stitching



\$0

Prices

Code	COM	GR1	GR2	GR3	GR4	GR5	GR6
010BSQ24	603	650	737	837	1162	1299	

How to Order

		PQD PQS (std)	Fabric See the Logiflex Graded-in List		
SS	010BSQ24				
series	code	top stitching	supplier	pattern	color
Example SS	010BSQ24	PQS	J. ENNIS	ASTRAL	71

Modular

Arched bench

020BARC

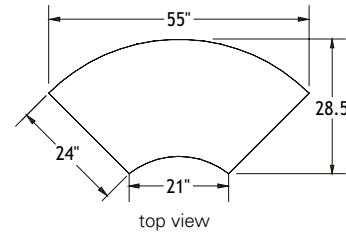
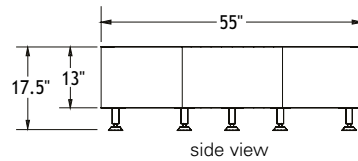
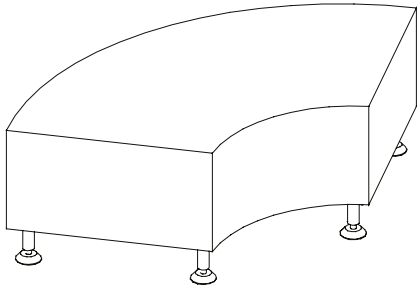

Manufacturing Standards

- 5 brushed chrome metal legs;
- Single top stitching;
- Elastic straps on seat;
- Firm density Velva foam on seat;
- 1/2" thick polyester on sides;
- Frame made out of recycled materials.

Double Stitching: Double stitching is an option on Grade 1 to 4 and COM fabrics. Double stitching is standard for Grade 5 and 6 fabrics.

COM Fabric: Number of yards required:

Code	Total
020BARC	3

Note: It is recommend that you include a layout with all orders.

Options

Double Stitching



\$0

Prices

Code	COM	GR1	GR2	GR3	GR4	GR5	GR6
020BARC	1087	1171	1262	1352	1560	1710	

How to Order

		PQD PQS (std)	Fabric See the Logiflex Graded-in List		
SS	020BARC				
series	code	top stitching	supplier	pattern	color
Example SS	020BARC	PQS	J. ENNIS	ASTRAL	71

Modular

Oval Bench

030BOV

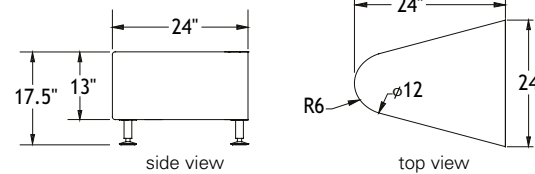
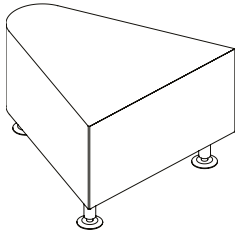

Manufacturing Standards

- 3 brushed chrome metal legs;
- Single top stitching;
- Elastic straps on seat;
- Firm density Velva foam on seat;
- 1/2" thick polyester on sides;
- Frame made out of recycled materials.

Double Stitching: Double stitching is an option on Grade 1 to 4 and COM fabrics. Double stitching is standard for Gade 5 and 6 fabrics.

COM Fabric: Number of yards required:

Code	Total
030BOV	2

Note: It is recommend that you include a layout with all orders.

Options

Double Stitching

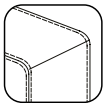

\$0

Prices

Code	COM	GR1	GR2	GR3	GR4	GR5	GR6
030BOV	615	672	757	842	1174	1311	

How to Order

		PQD PQS (std)	Fabric See the Logiflex Graded-in List		
SS	030BOV				
series	code	top stitching	supplier	pattern	color
Example SS	030BOV	PQS	J. ENNIS	ASTRAL	71

Modular

Square Bench with Padded Arm

040BSUA

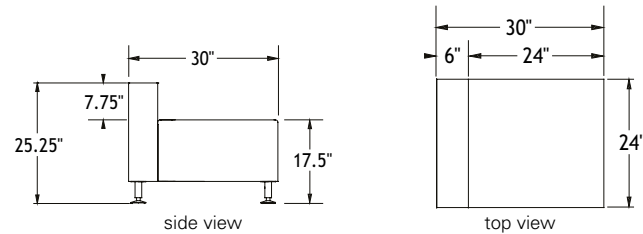
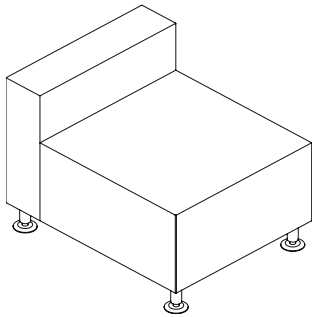

Manufacturing Standards

- 4 brushed chrome metal legs;
- Single top stitching;
- Elastic straps on seat;
- Firm density Velva foam on seat and arm;
- 1/2" thick polyester on sides of the bench;
- Arm and seat frames made out of recycled materials.

Double Stitching: Double stitching is an option on Grade 1 to 4 and COM fabrics. Double stitching is standard for Grade 5 and 6 fabrics.

COM Fabric: Number of yards required:

Code	Total
040BSUA	3

Note: It is recommend that you include a layout with all orders.

Options

Double Stitching

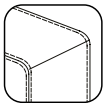

\$0

Prices

Code	COM	GR1	GR2	GR3	GR4	GR5	GR6
040BSUA	864	961	1074	1188	1710	1922	

How to Order

		PQD PQS (std)	Fabric See the Logiflex Graded-in List		
SS	040BSUA				
series	code	top stitching	supplier	pattern	color
Example SS	040BSUA	PQS	J. ENNIS	ASTRAL	71

Modular

Square Bench with Padded Arm and Laminate Panel

045BSUAM

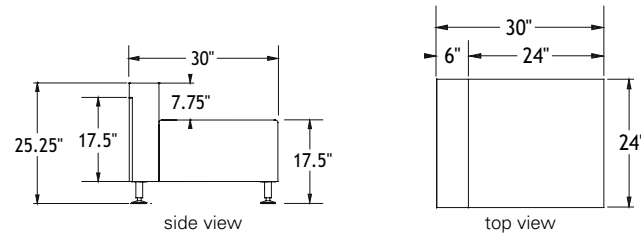
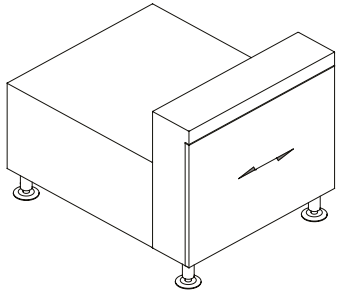

Manufacturing Standards

- 4 brushed chrome metal legs;
- Single top stitching;
- Elastic straps on seat;
- Firm density Velva foam on seat and arm;
- 1/2" thick polyester on sides of the bench;
- 5/8" thick laminate panel back and 24"L x 17"H height (choice of Logiflex wood finish laminate color);
- Arm and seat frames made out of recycled materials.

Double Stitching: Double stitching is an option on Grade 1 to 4 and COM fabrics. Double stitching is standard for Grade 5 and 6 fabrics.

COM Fabric: Number of yards required:

Code	Total
045BSUAM	3

Note: It is recommend that you include a layout with all orders.

Options

Double Stitching

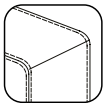

\$0

Prices

Code	COM	GR1	GR2	GR3	GR4	GR5	GR6
045BSUAM	983	1078	1192	1305	1822	2034	

How to Order

		PQD PQS (std)	Fabric See the Logiflex Graded-in List		
SS	045BSUAM				
series	code	top stitching	supplier	pattern	color
Example SS	045BSUAM	PQS	J. ENNIS	ASTRAL	71

Modular

Square Bench with Back Rest

010BSQ24B

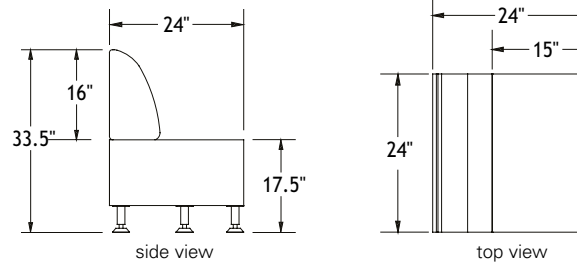
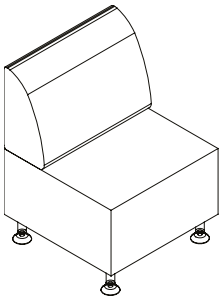

Manufacturing Standards

- 4 brushed chrome metal legs;
- Single top stitching;
- Elastic straps on seat;
- Firm density Velva foam on seat and arm;
- 1/2" thick polyester on sides of the bench;
- Arm and seat frames made out of recycled materials.

Double Stitching: Double stitching is an option on Grade 1 to 4 and COM fabrics. Double stitching is standard for Grade 5 and 6 fabrics.

COM Fabric: Number of yards required:

Code	Total
01BSQ24B	3.5

Note: It is recommend that you include a layout with all orders.

Options

Double Stitching

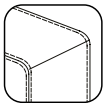

\$0

Prices

Code	COM					
	GR1	GR2	GR3	GR4	GR5	GR6
010BSQ24B	951	1034	1166	1311	1681	1851

How to Order

		PQD PQS (std)		Fabric See the Logiflex Graded-in List		
SS	01BSQ24B					
series	code	top stitching	supplier	pattern	color	
Example SS	01BSQ24B	PQS	J. ENNIS	ASTRAL	71	

Modular

Arched Bench with Inner Back Rest

020BARCIB

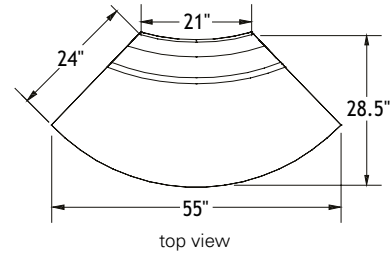
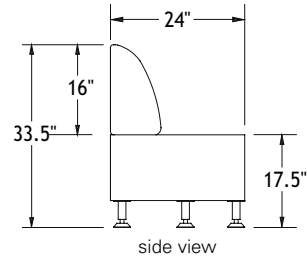
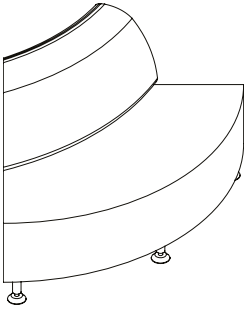

Manufacturing Standards

- 5 brushed chrome metal legs;
- Single top stitching;
- Elastic straps on seat;
- Firm density Velva foam on seat and arm;
- 1/2" thick polyester on sides of the bench;
- Arm and seat frames made out of recycled materials.

Double Stitching: Double stitching is an option on Grade 1 to 4 and COM fabrics. Double stitching is standard for Grade 5 and 6 fabrics.

COM Fabric: Number of yards required:

Code	Total
020BARCIB	5.5

Note: It is recommend that you include a layout with all orders.

Options

Double Stitching



\$0

Prices

Code	COM	GR1	GR2	GR3	GR4	GR5	GR6
020BARCIB	1486	1633	1802	1967	2253	2481	

How to Order

		<div>+</div> PQD PQS (std)	Fabric See the Logiflex Graded-in List		
SS	020BARCIB				
series	code	top stitching	supplier	pattern	color
Example SS	020BARCIB	PQS	J. ENNIS	ASTRAL	71

Modular

Arched Bench with Outer Back Rest

020BARCOB

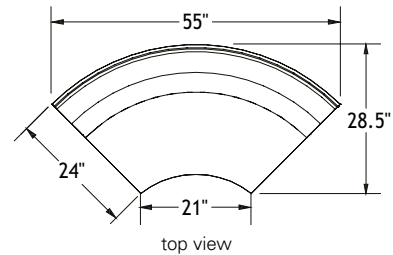
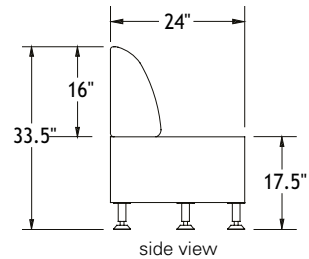
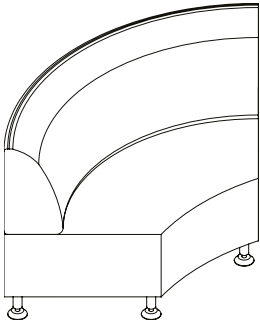

Manufacturing Standards

- 5 brushed chrome metal legs;
- Single top stitching;
- Elastic straps on seat;
- Firm density Velva foam on seat and arm;
- 1/2" thick polyester on sides of the bench;
- Arm and seat frames made out of recycled materials.

Double Stitching: Double stitching is an option on Grade 1 to 4 and COM fabrics. Double stitching is standard for Grade 5 and 6 fabrics.

COM Fabric: Number of yards required:

Code	Total
020BARCOB	6

Note: It is recommend that you include a layout with all orders.

Options

Double Stitching



\$0

Prices

Code	COM					
	GR1	GR2	GR3	GR4	GR5	GR6
020BARCOB	1546	1705	1889	2069	2370	2613

How to Order

			Fabric		
			See the Logiflex Graded-in List		
SS	020BARCOB	PQD PQS (std)			
series	code	top stitching	supplier	pattern	color
Example SS	020BARCOB	PQS	J. ENNIS	ASTRAL	71

Armchair Section

Soft Seating

Alpha Single Armchair

1403

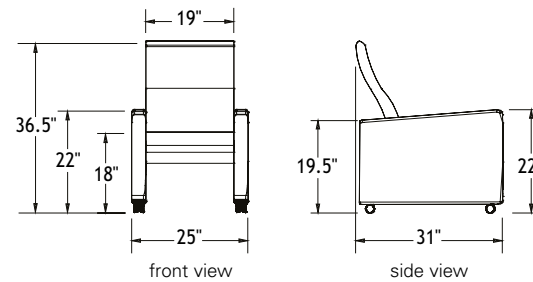
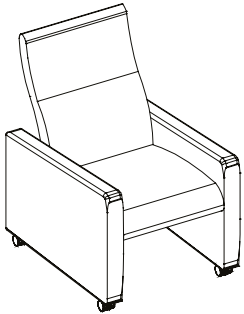

Manufacturing Standards

- 4 wheels;
- Single top stitching;
- Medium-density Velva foam on seat;
- 1" memory foam on back seat;
- Molded wood boards for seat and back;
- Rest of frame made out of recycled materials.

COM Fabric: Number of yards required:

Code	Total
1403	5

Options

Leveller
7/8" diameter

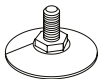

N
\$0

Prices

Code	COM	GR1	GR2	GR3	GR4	GR5	GR6
1403	915	1010	1124	1237	1706	1884	

How to Order

			Fabric		
			<i>See the Logiflex Graded-in List</i>		
SS	1403	N			
series	code	leveller	supplier	pattern	color
Example SS	1403	N	J. ENNIS	ASTRAL	GRAY #71

Soft Seating

Alpha Double Armchair

1405

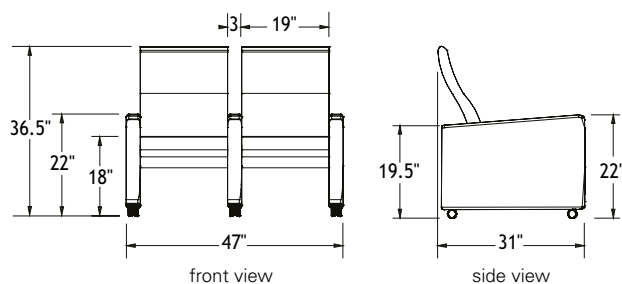
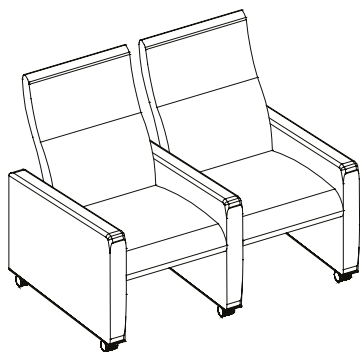

Manufacturing Standards

- 6 wheels;
- Single top stitching;
- Medium-density Velva foam on seat;
- 1" memory foam on back seat;
- Molded wood boards for seat and back;
- Rest of frame made out of recycled materials.

COM Fabric: Number of yards required:

Code	Total
1405	7

Options

Leveller

7/8" diameter



N
\$0

Prices

Code	COM	GR1	GR2	GR3	GR4	GR5	GR6
	GR1						
1405	1414	1555	1725	1895	2479	2717	

How to Order

			Fabric See the Logiflex Graded-in List		
		N			
SS	1405				
series	code	leveller	supplier	pattern	color
Example SS	1405	N	J. ENNIS	ASTRAL	GRAY #71

Soft Seating

Alpha Triple Armchair

1407

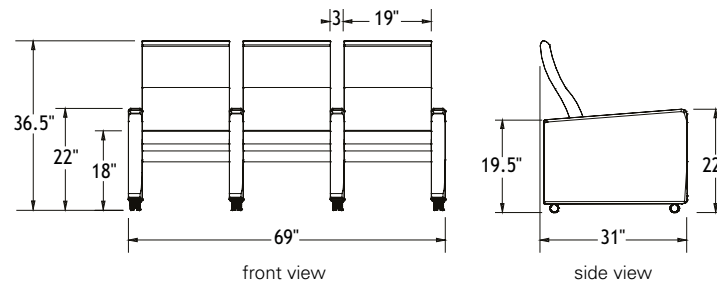
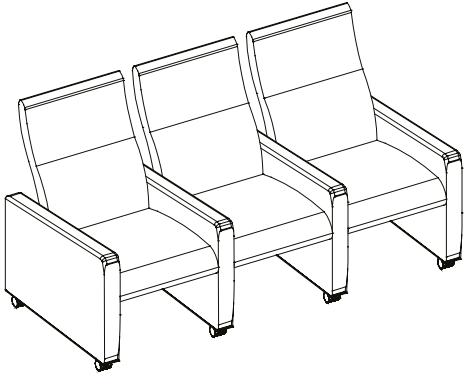

Manufacturing Standards

- 8 wheels;
- Single top stitching;
- Medium-density Velva foam on seat;
- 1" memory foam on back seat;
- Molded wood boards for seat and back;
- Rest of frame made out of recycled materials.

COM Fabric: Number of yards required:

Code	Total
1407	11

Options

Leveller

7/8" diameter

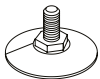

N
\$0

Prices

Code	COM	GR1	GR2	GR3	GR4	GR5	GR6
1407	1789	1959	2186	2412	3133	3490	

How to Order

			Fabric		
			See the Logiflex Graded-in List		
SS	1407	N	supplier	pattern	color
series	code	leveller			
Example SS	1407	N	J. ENNIS	ASTRAL	GRAY #71

Soft Seating

Bulexi Armchair

5010

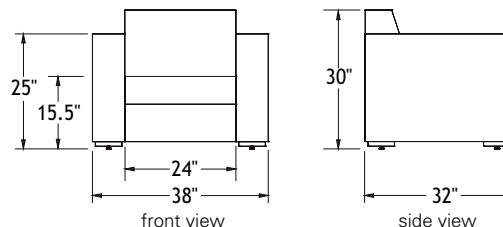
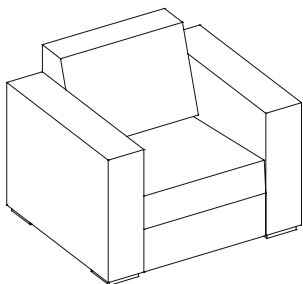

Manufacturing Standards

- 4 wooden legs BWL, choice of Logiflex wood finish laminate color;
- Double top stitching;
- Elastic straps on back;
- 9 GA springs within the seat;
- Medium-density Velva foam on the seat;
- Medium-density Velva foam with 1" of memory foam for the back;
- All cushions are covered with stitched Dacron;
- Back seat cushions are fixed to the structure by a zipper;
- Made out of recycled materials, seating and back structure made of hardwood and plywood.

Option: Set of 4 chrome metal legs, BCHR.

COM Fabric: Number of yards required:

Code	Total
5010	8

Options

Legs

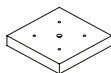

Prices

Code	COM					
	GR1	GR2	GR3	GR4	GR5	GR6
5010 BWL	1539	1663	1805	1947	2419	2657
5010 BCHR	1869	1993	2135	2277	2749	2987

How to Order

		BCHR BWL (std)	Finishes <i>See the Logiflex Color Guide</i>	Fabric <i>See the Logiflex Graded-in List</i>		
SS	5010					
series	code	legs	leg color	supplier	pattern	color
Example	SS	5010	BWL	WK	J. ENNIS	ASTRAL GRAY #71

Soft Seating

Bulexi Loveseat

5020

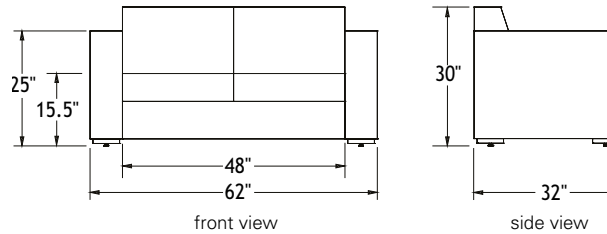
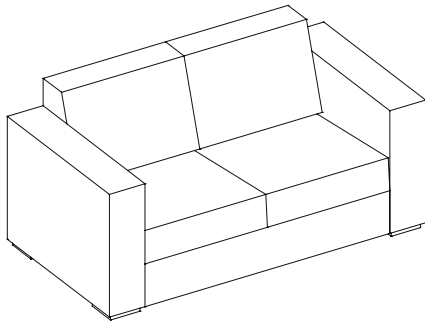

Manufacturing Standards

- 4 wooden legs BWL, choice of Logiflex wood finish laminate color;
- Double top stitching;
- Elastic straps on back;
- 9 GA springs within the seat;
- Medium-density Velva foam on the seat;
- Medium-density Velva foam with 1" of memory foam for the back;
- All cushions are covered with stitched Dacron;
- Back seat cushions are fixed to the structure by a zipper;
- Made out of recycled materials, seating and back structure made of hardwood and plywood.

Option: Set of 4 chrome metal legs, BCHR.

COM Fabric: Number of yards required:

Code	Total
5020	11

Options

Legs

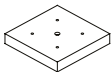

Prices

Code	COM	GR1	GR2	GR3	GR4	GR5	GR6
5020 BWL	2122	2292	2518	2745	3133	3490	
5020 BCHR	2452	2622	2848	3075	3463	3820	

How to Order

		BCHR BWL (std)		Finishes See the Logiflex Color Guide		Fabric See the Logiflex Graded-in List	
SS	5020						
series	code	legs	leg color	supplier	pattern	color	
Example SS	5020	BWL	WK	J. ENNIS	ASTRAL	GRAY #71	

Soft Seating

Bulexi Sofa

5030

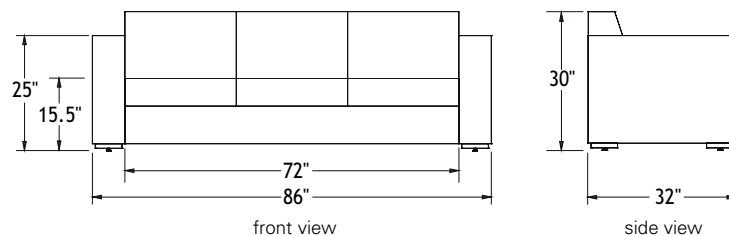
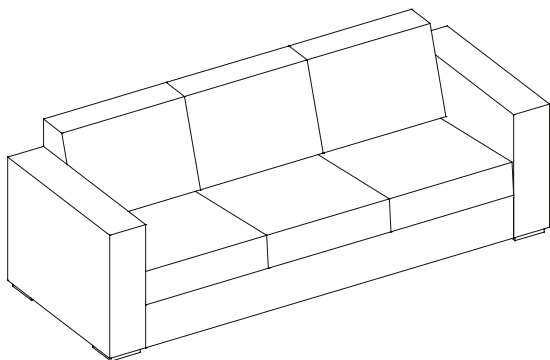

Manufacturing Standards

- 4 wooden legs BWL, choice of Logiflex wood finish laminate color;
- Double top stitching;
- Elastic straps on back;
- 9 GA springs within the seat;
- Medium-density Velva foam on the seat;
- Medium-density Velva foam with 1" of memory foam for the back;
- All cushions are covered with stitched Dacron;
- Back seat cushions are fixed to the structure by a zipper;
- Made out of recycled materials, seating and back structure made of hardwood and plywood.

Option: Set of 4 chrome metal legs, BCHR.

COM Fabric: Number of yards required:

Code	Total
5030	14

Options

Legs

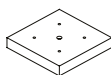

Prices

Code	COM	GR1	GR2	GR3	GR4	GR5	GR6
5030 BWL	2657	2861	3104	3349	4203	4679	
5030 BCHR	2452	2622	2848	3075	3463	3820	

How to Order

		BCHR BWL (std)		Finishes See the Logiflex Color Guide		Fabric See the Logiflex Graded-in List	
SS	5030						
series	code	legs	leg color	supplier	pattern	color	
Example SS	5030	BWL	WK	J. ENNIS	ASTRAL	GRAY #71	

Soft Seating

Dean Armchair

DEA1

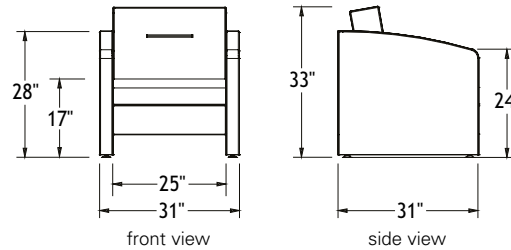
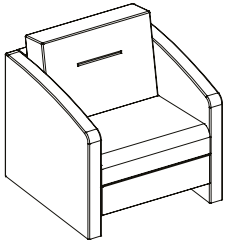

Manufacturing Standards

- Springs for the seat and back;
- Single top stitching;
- Medium-density Celcor foam;
- Frame made out of recycled and recyclable particles.

Option: Set of 4 metal oval legs in satin nickel finish, OVAMSN.

COM Fabric: Number of yards required:

Code	Total
DEA1	7

Options

Legs



\$0

Prices

Code	COM	GR1	GR2	GR3	GR4	GR5	GR6
DEA1	1055	1215	1430	1643	1857	2071	

How to Order

		OVAMSN		Finishes <i>See the Logiflex Color Guide</i>			Fabric <i>See the Logiflex Graded-in List</i>	
SS	DEA1							
series	code	legs	leg color	supplier	pattern	color		
Example SS	DEA1	OVAMSN	WK	J. ENNIS	ASTRAL	GRAY #71		

Soft Seating

Dean Loveseat

DEA2

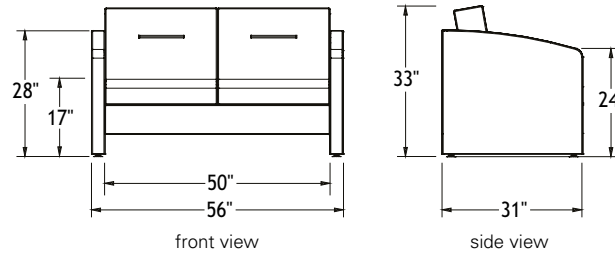
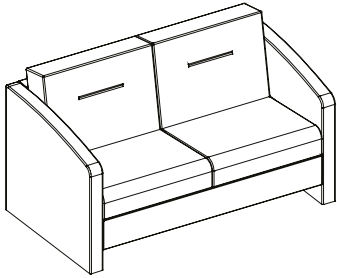

Manufacturing Standards

- Springs for the seat and back;
- Single top stitching;
- Medium-density Celcor foam;
- Frame made out of recycled and recyclable particles.

Option: Set of 4 metal oval legs in satin nickel finish, OVAMSN.

COM Fabric: Number of yards required:

Code	Total
DEA2	10

Options

Legs



\$0

Prices

Code	COM	GR1	GR2	GR3	GR4	GR5	GR6
DEA2	1390	1618	1908	2189	2475	2760	

How to Order

		<div> <div></div> <div>OVAMSN</div> </div>		<div> <div>Finishes</div> <div>See the Logiflex Color Guide</div> </div>			<div> <div>Fabric</div> <div>See the Logiflex Graded-in List</div> </div>	
SS	DEA2							
series	code	legs	leg color	supplier	pattern	color		
Example SS	DEA2	OVAMSN	WK	J. ENNIS	ASTRAL	GRAY #71		

Soft Seating

Dean Sofa

DEA3

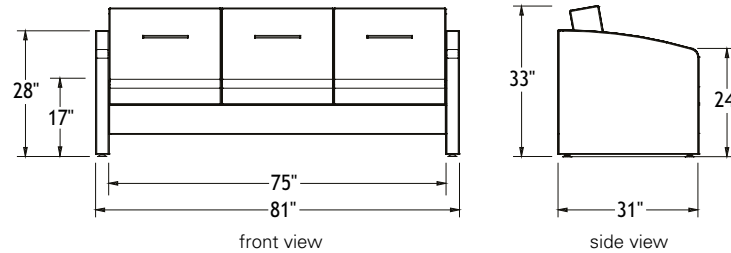
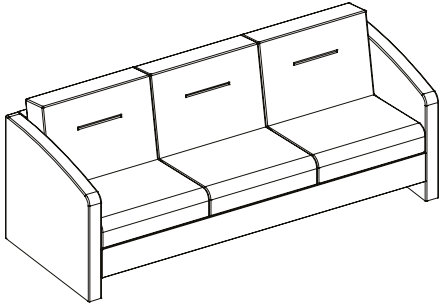

Manufacturing Standards

- Springs for the seat and back;
- Single top stitching;
- Medium-density Celcor foam;
- Frame made out of recycled and recyclable particles.

Option: Set of 4 metal oval legs in satin nickel finish, OVAMSN.

COM Fabric: Number of yards required:

Code	Total
DEA3	13

Options

Legs



\$0

Prices

Code	COM	GR1	GR2	GR3	GR4	GR5	GR6
DEA3	1851	2151	2536	2913	3293	3678	

How to Order

		OVAMSN		Finishes See the Logiflex Color Guide			Fabric See the Logiflex Graded-in List	
SS	DEA3							
series	code	legs	leg color	supplier	pattern	color		
Example SS	DEA3	OVAMSN	WK	J. ENNIS	ASTRAL	GRAY #71		

Soft Seating

Flint Armchair

3010FBW

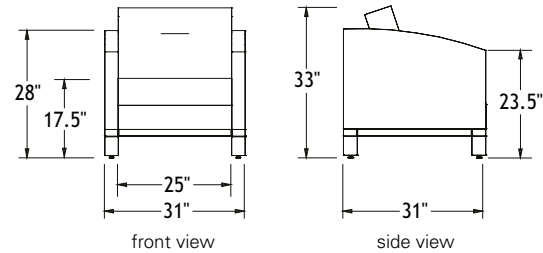
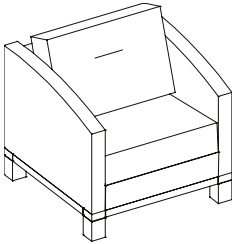

Manufacturing Standards

- Wooden base FBW with 4 legs, choice of Logiflex wood finish laminate color;
- Single top stitching;
- 9 GA springs for the seat and 11 GA for the back;
- Medium-density Velva foam on seat and back;
- Firm density Velva foam on top of the arms;
- Frame made out of recycled materials and hardwood for seating base.

COM Fabric: Number of yards required:

Code	Total
3010FBW	7

Options

Double Stitching

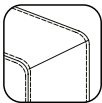

\$0

Prices

Code	COM	GR1	GR2	GR3	GR4	GR5	GR6
3010FBW	1140	1344	1587	1831	2032	2182	

How to Order

		PSD PQS (std)	Finishes <i>See the Logiflex Color Guide</i>				Fabric <i>See the Logiflex Graded-in List</i>	
SS	3010FBW							
series	code	legs	leg color	supplier	pattern	color		
Example SS	3010FBW	PSQ	WK	J. ENNIS	ASTRAL	GRAY #71		

Soft Seating

Flint Loveseat

3020FBW

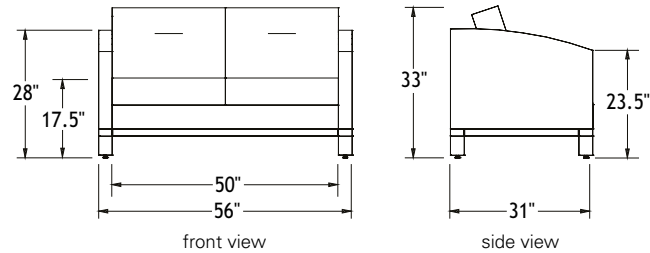
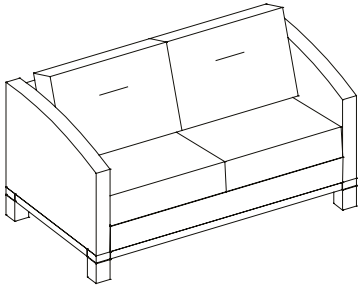

Manufacturing Standards

- Wooden base FBW with 4 legs, choice of Logiflex wood finish laminate color;
- Single top stitching;
- 9 GA springs for the seat and 11 GA for the back;
- Medium-density Velva foam on seat and back;
- Firm density Velva foam on top of the arms;
- Frame made out of recycled materials and hardwood for seating base.

COM Fabric: Number of yards required:

Code	Total
3020FBW	10

Options

Double Stitching

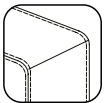

\$0

Prices

Code	COM	GR1	GR2	GR3	GR4	GR5	GR6
3020FBW	1570	1740	1966	2193	2759	3213	

How to Order

		PSD PQS (std)	<div> <div>Finishes See the Logiflex Color Guide</div> <div>Fabric See the Logiflex Graded-in List</div> </div>			
SS	3020FBW					
series	code	legs	leg color	supplier	pattern	color
Example SS	3020FBW	PSQ	WK	J. ENNIS	ASTRAL	GRAY #71

Soft Seating

Flint Sofa

3030FBW

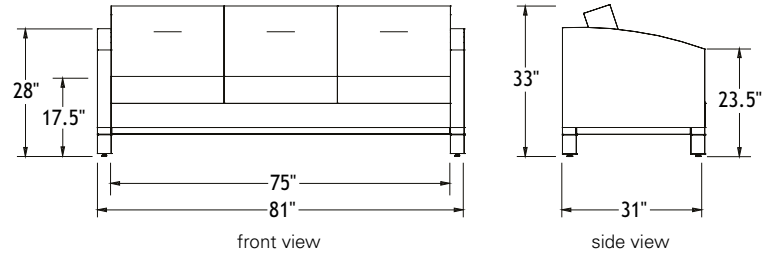
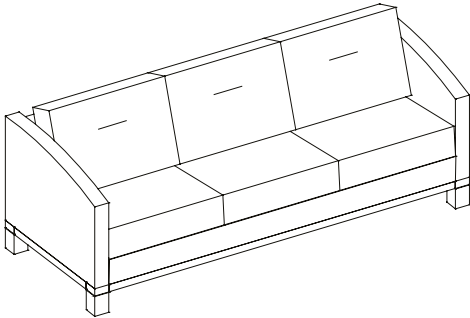

Manufacturing Standards

- Wooden base FBW with 4 legs, choice of Logiflex wood finish laminate color;
- Single top stitching;
- 9 GA springs for the seat and 11 GA for the back;
- Medium-density Velva foam on seat and back;
- Firm density Velva foam on top of the arms;
- Frame made out of recycled materials and hardwood for seating base.

COM Fabric: Number of yards required:

Code	Total
3030FBW	13

Options

Double Stitching

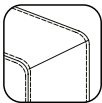

\$0

Prices

Code	COM	GR1	GR2	GR3	GR4	GR5	GR6
3030FBW	1976	2179	2424	2667	3904	4651	

How to Order

		PSD PQS (std)	Finishes <i>See the Logiflex Color Guide</i>	Fabric <i>See the Logiflex Graded-in List</i>		
SS	3030FBW					
series	code	legs	leg color	supplier	pattern	color
Example SS	3030FBW	PSQ	WK	J. ENNIS	ASTRAL	GRAY #71

Magog Armchair

MAG

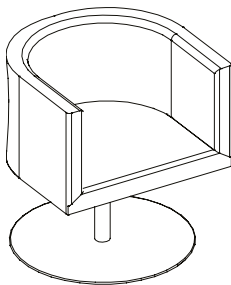

Manufacturing Standards

- 180° swivel armchair that returns to its initial position;
- Single top stitching;
- Medium-density Celcor foam;
- Circular base (24" diameter) with glides.

COM Fabric: Number of yards required:

Code	Total	Seat	Back
MAG	3	1	2

Prices

Code	COM					
	GR1	GR2	GR3	GR4	GR5	GR6
MAG SN	1477	1554	1652	1749	1847	1944
MAG CHR	1619	1681	1757	1833	1911	1987

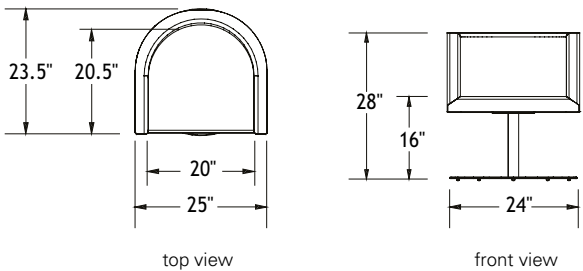

How to Order

			SN	Fabric		
			CHR	<i>See the Logiflex Graded-in List</i>		
SS	MAG					
series	code	base		supplier	pattern	color
Example	SS	MAG	CHR	MOMENTUM	ACE	CARBON

Soft Seating

Magog Stool

MAGST

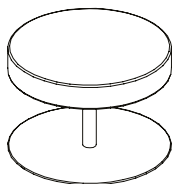

Manufacturing Standards

- 180° swivel stool that returns to its initial position;
- Single top stitching;
- Medium-density Celcor foam;
- Circular base (24" diameter) with glides.

COM Fabric: Number of yards required:

Code	Total	Seat
MAGST	1	1

Prices

Code	COM					
	GR1	GR2	GR3	GR4	GR5	GR6
MAGST SN	803	836	878	919	960	1001
MAGST CHR	1122	1149	1183	1217	1251	1285

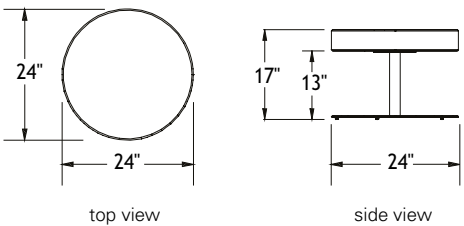

How to Order

			SN CHR	Fabric <i>See the Logiflex Graded-in List</i>		
SS	MAGST					
series	code	base	supplier	pattern	color	
Example	SS	MAGST	CHR	MOMENTUM	ACE	CARBON

Soft Seating

Monro Armchair

4010

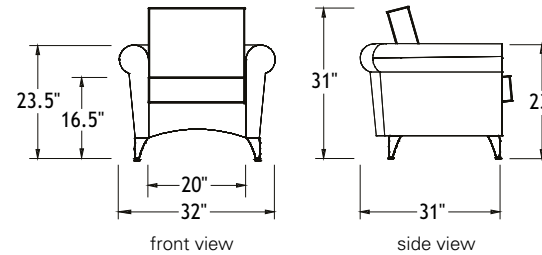
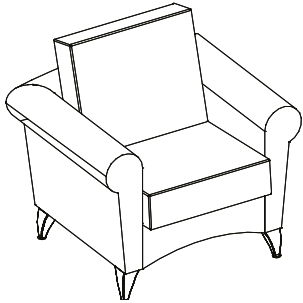

Manufacturing Standards

- 4 metal legs MPAL, 4.25" H polished aluminum;
- Decorative piping on seat and back;
- Elastic straps on seat;
- Medium-density Velva foam on seat and back;
- Frame made out of recycled materials.

Wooden Legs option: Set of 4 wooden legs, MWL, available in Logiflex wood finish laminate colors.

COM Fabric: Number of yards required:

Code	Total
4010MPAL	7

Options

Wooden Legs



MWL
\$298

Single Stitching

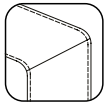

\$0

Double Stitching

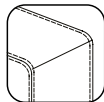

\$0

Prices

Code	COM GR1	GR2	GR3	GR4	GR5	GR6
4010 MPAL	1340	1465	1607	1748	1889	2030
4010 MWL	1624	1749	1891	2032	2173	2314

How to Order

		<div> <div></div> <div>MWL MPAL (std)</div> <div>PQS PQD CPG (std)</div> </div>		<div> <div>Finishes See the Logiflex Color Guide</div> <div>Fabric See the Logiflex Graded-in List</div> </div>			
SS	4010						
series	code	legs	top stitch	leg color	supplier	pattern	color
Example SS	4010	MPAL	CPG	WK	J. ENNIS	ASTRAL	GRAY #71

Soft Seating

Monro Loveseat

4020

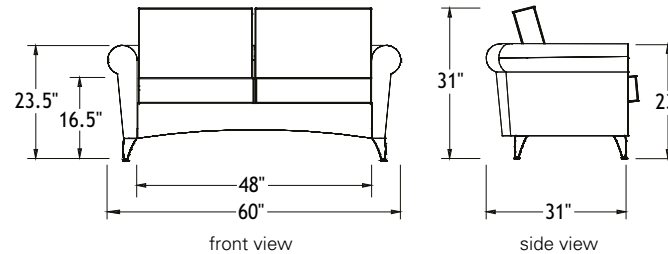
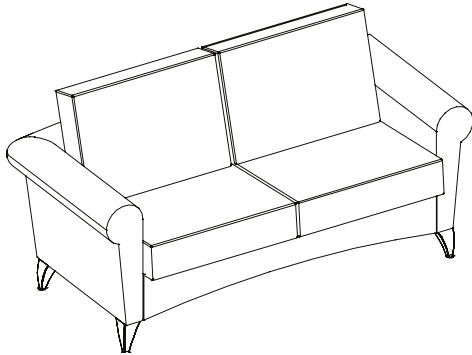

Manufacturing Standards

- 4 metal legs MPAL, 4.25" H polished aluminum;
- Decorative piping on seat and back;
- Elastic straps on seat;
- Medium-density Velva foam on seat and back;
- Frame made out of recycled materials.

Wooden Legs option: Set of 4 wooden legs, MWL, available in Logiflex wood finish laminate colors.

COM Fabric: Number of yards required:

Code	Total
4020MPAL	10

Options

Wooden Legs



MWL
\$298

Single Stitching

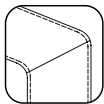

\$0

Double Stitching

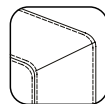

\$0

Prices

Code	COM					
	GR1	GR2	GR3	GR4	GR5	GR6
4020 MPAL	1956	2126	2353	2579	3428	3884
4020 MWL	2240	2410	2637	2863	3712	4168

How to Order

		<div> <div></div> <div>MWL MPAL (std)</div> <div>PQS PQD CPG (std)</div> </div>		<div> <div>Finishes See the Logiflex Color Guide</div> <div>Fabric See the Logiflex Graded-in List</div> </div>			
SS	4020						
series	code	legs	top stitch	leg color	supplier	pattern	color
Example SS	4020	MPAL	CPG	WK	J. ENNIS	ASTRAL	GRAY #71

Soft Seating

Orford Armchair

ORF

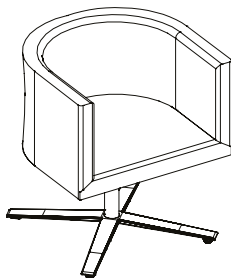

Manufacturing Standards

- 180° swivel armchair that returns to its initial position;
- Single top stitching;
- Medium-density Celcor foam;
- Aluminum base with glides;
- Footing dimension: 30" wide.

COM Fabric: Number of yards required:

Code	Total	Seat	Back
ORF	3	1	2

Prices

Code	COM					
	GR1	GR2	GR3	GR4	GR5	GR6
ORF SN	1677	1751	1844	1936	2031	2122
ORF CHR	1792	1853	1929	2006	2083	2159

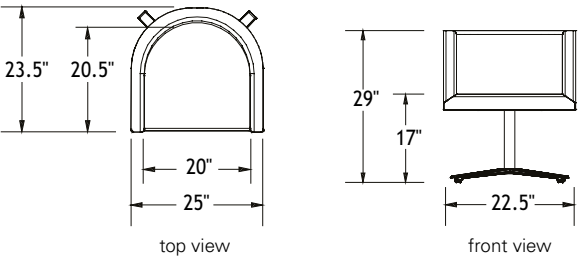

How to Order

			SN CHR	Fabric <i>See the Logiflex Graded-in List</i>		
SS	ORF					
series	code	base	supplier	pattern	color	
Example	SS	ORF	CHR	MOMENTUM	ACE	CARBON

Soft Seating

Orford Stool

ORFST

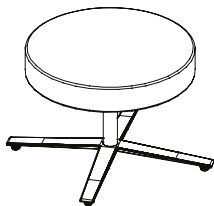

Manufacturing Standards

- 180° swivel stool that returns to its initial position;
- Single top stitching;
- Medium-density Celcor foam;
- 4-point aluminum base with glides, Satin Nickel (SN) or Chrome (CHR) finish;
- Footing dimension: 30" wide.

COM Fabric: Number of yards required:

Code	Total	Seat
ORFST	1	1

Prices

Code	COM GR1	GR2	GR3	GR4	GR5	GR6
ORFST SN	1085	1118	1159	1200	1241	1282
ORFST CHR	1304	1331	1365	1399	1433	1467

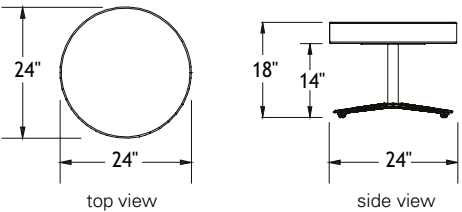

How to Order

		SN CHR	Fabric <i>See the Logiflex Graded-in List</i>		
SS	ORFST				
series	code	base	supplier	pattern	color
Example SS	ORFST	CHR	MOMENTUM	ACE	CARBON

Soft Seating

Stelli Armchair

6750

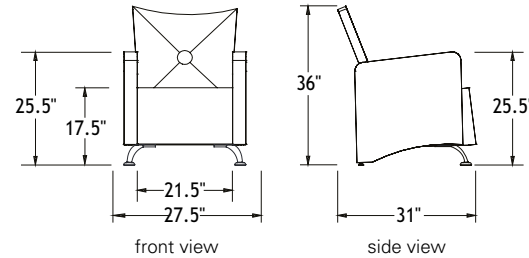
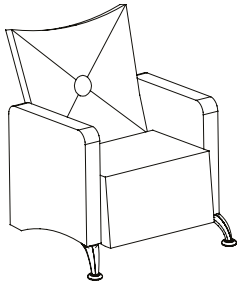

Manufacturing Standards

- 2 metal legs PM (brushed nickel finish) in front and 2 levers in the back;
- Single top stitching;
- Elastic straps on seat and back;
- Medium-density Velva foam on seat and back;
- Firm density Velva foam on top of the arms;
- Standard button and "X" stitch in the back;
- Frame made out of recycled materials.

Wooden Legs option: 2 wooden legs, WL, 3" x 3" x 3-3/4" with levers, choice of Logiflex wood finish laminate color.

No Button: option to remove the button and the decorative "X" on the back.

Pivoting Shelf: 20" x 11-5/8" pivoting shelf of 3/4" hardwood, choice of Logiflex wood finish laminate color.

COM Fabric: Number of yards required:

Code	Total
6750	5

Options

Wooden Legs



WL
\$57

Double Stitching

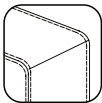

\$0

No Button



SBX
\$0

Pivoting Shelf

Left



SPL
\$250

Right



SPR
\$250

How to Order

		<div> <div>WL PM (std)</div> <div>PQD PQS (std)</div> <div>SBX</div> <div>SPL SPR</div> </div>				<div>Fabric</div> <div>See the Logiflex Graded-in List</div>		
SS	6750							
series	code	legs	top stitch	no button	pivoting shelf	supplier	pattern	color
Example SS	6750	PM	PSQ			J. ENNIS	ASTRAL	GRAY #71

Prices

Code	COM					
	GR1	GR2	GR3	GR4	GR5	GR6
6750 PM	1164	1260	1373	1486	1765	2062
6750 WL	1219	1315	1428	1541	1820	2117

Soft Seating

Stelli Loveseat

6753

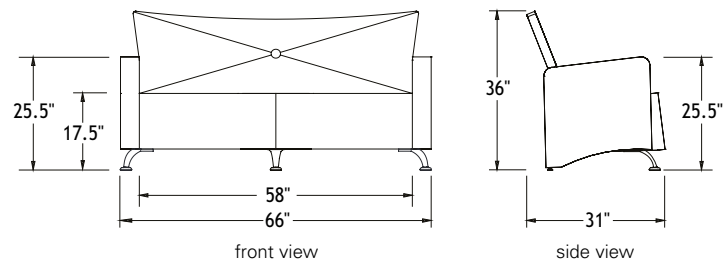
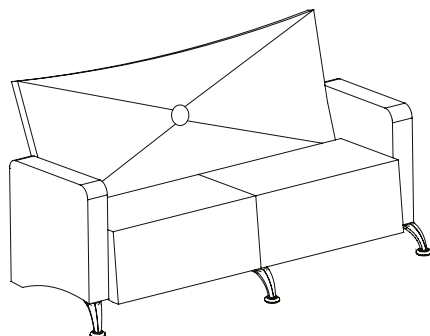

Manufacturing Standards

- 3 metal legs PM (brushed nickel finish) in front and 2 levellers in the back;
- Single top stitching;
- Elastic straps on seat and back;
- Medium-density Velva foam on seat and back;
- Firm density Velva foam on top of the arms;
- Standard button and "X" stitch in the back;
- Frame made out of recycled materials.

Wooden Legs option: 3 wooden legs, WL, 4" x 4" x 3-3/4" levellers, choice of Logiflex wood finish laminate color.

No Button: option to remove the button and the decorative "X" on the back.

Pivoting Shelf: 20" x 11-5/8" pivoting shelf of 3/4" hardwood, choice of Logiflex wood finish laminate color.

COM Fabric: Number of yards required:

Code	Total
6753	7

Options

Wooden Legs

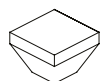

WL

\$57

Double Stitching

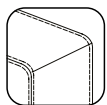

\$0

No Button



SBX

\$0

Pivoting Shelf

Left



SPL

\$250

Right



SPR

\$250

How to Order

		<div><div><div>WL</div><div>PM (std)</div></div><div><div>PQD</div><div>PQS (std)</div></div><div>SBX</div><div><div>SPL</div><div>SPR</div></div></div> <div><div><div>Fabric</div><div>See the Logiflex Graded-in List</div></div></div>						
SS	6753							
series	code	legs	top stitch	no button	pivoting shelf	supplier	pattern	color
Example SS	6753	PM	PSQ			J. ENNIS	ASTRAL	GRAY #71

Prices

Code	COM					
	GR1	GR2	GR3	GR4	GR5	GR6
6753 PM	1663	1805	1975	2144	2657	2895
6753 WL	1718	1860	2030	2199	2712	2950

Soft Seating

Stelli Sofa

6757

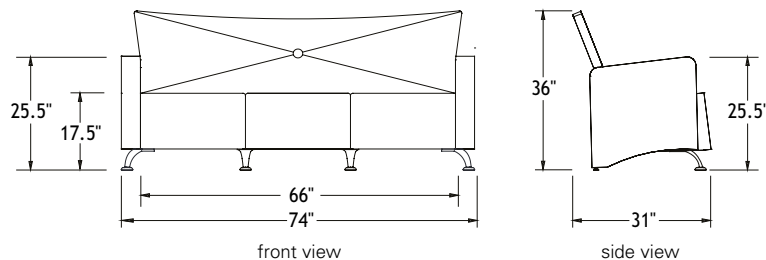
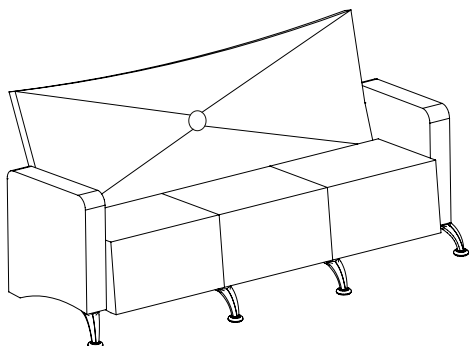

Manufacturing Standards

- 4 metal legs PM (brushed nickel finish) in front and 2 lellers in the back;
- Single top stitching;
- Elastic straps on seat and back;
- Medium-density Velva foam on seat and back;
- Firm density Velva foam on top of the arms;
- Standard button and "X" stitch in the back;
- Frame made out of recycled materials.

Wooden Legs option: 4 wooden legs, WL, 4" x 4" x 3-3/4" lellers, choice of Logiflex wood finish laminate color.

No Button: option to remove the button and the decorative "X" on the back.

Pivoting Shelf: 20" x 11-5/8" pivoting shelf of 3/4" hardwood, choice of Logiflex wood finish laminate color.

COM Fabric: Number of yards required:

Code	Total
6757	9

Options

Wooden Legs

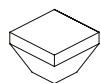

WL

\$57

Double Stitching

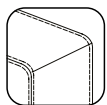

\$0

No Button



SBX

\$0

Pivoting Shelf

Left



SPL

\$250

Right



SPR

\$250

How to Order

		<div><div>WL</div><div>PM (std)</div></div> <div><div>PQD</div><div>PQS (std)</div></div> <div>SBX</div> <div><div>SPL</div><div>SPR</div></div>				<div>Fabric</div> <div>See the Logiflex Graded-in List</div>		
SS	6757							
series	code	legs	top stitch	no button	pivoting shelf	supplier	pattern	color
SS	6757	PM	PSQ			J. ENNIS	ASTRAL	GRAY #71

Prices

Code	COM					
	GR1	GR2	GR3	GR4	GR5	GR6
6757 PM	1872	2041	2268	2495	3405	4028
6757 WL	1927	2096	2323	2550	3460	4083

Soft Seating

Stelli Ottoman

6755S

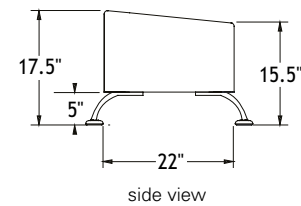
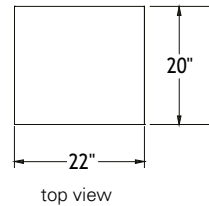
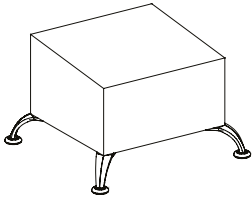

Manufacturing Standards

- 4 metal legs PM (brushed nickel finish);
- Single top stitching;
- Medium-density Velva foam;
- Frame made out of recycled materials.

Wooden Legs option: 4 wooden legs, WL, with 3" x 3" x 3-3/4" levellers, choice of Logiflex wood finish laminate color.

COM Fabric: Number of yards required:

Code	Total
6755S	2

Options

Wooden Legs

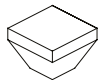

WL
\$57

Double Stitching

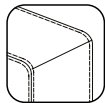

\$0

Prices

Code	COM					
	GR1	GR2	GR3	GR4	GR5	GR6
6755S PM	575	626	724	822	1160	1316
6755S WL	630	681	779	877	1215	1371

How to Order

		<div> <div>WL</div> <div>PM (std)</div> </div> <div> <div>PQS</div> <div>(std)</div> </div>		<div>Fabric</div> <div>See the Logiflex Graded-in List</div>		
SS	6755S					
series	code	legs	top stitch	supplier	pattern	color
Example SS	6755S	PM	PSQ	J. ENNIS	ASTRAL	GRAY #71

Stelli Triangular Ottoman

6755T

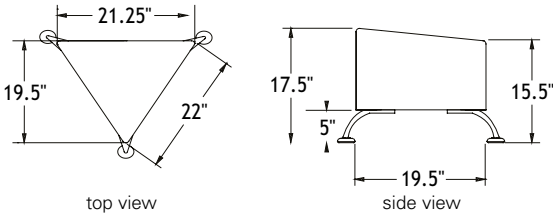
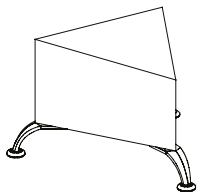

Manufacturing Standards

- 3 metal legs PM (brushed nickel finish);
- Single top stitching;
- Medium-density Velva foam;
- Frame made out of recycled materials.

COM Fabric: Number of yards required:

Code	Total
6755T	2

Options

Double
Stitching

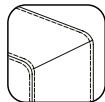

PQD
\$0

Prices

Code	COM	GR1	GR2	GR3	GR4	GR5	GR6
	GR1						
6755T	533	587	679	783	1122	1265	

How to Order

		<div>+</div> PQD PQS (std)	Fabric <i>See the Logiflex Graded-in List</i>		
SS	6755T				
series	code	top stitch	supplier	pattern	color
Example SS	6755T	PSQ	J. ENNIS	ASTRAL	GRAY #71

Soft Seating

Stelli Armchair

6759

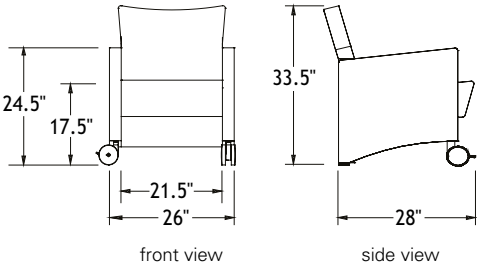
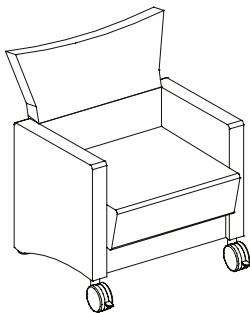

Manufacturing Standards

- 2 standard wheels in front and 2 leellers in the back;
- Single top stitching;
- Elastic straps on seat;
- Medium-density Velva foam on seat and back;
- Firm density Velva foam on top of the arms of the chair;
- Fabric handle in the top of the back;
- Frame made out of recycled materials.

COM Fabric: Number of yards required:

Code	Total
6759	5

Options

Double
Stitching

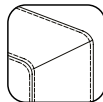

\$0

Prices

Code	COM	GR1	GR2	GR3	GR4	GR5	GR6
6759	929	952	1083	1278	1799	1994	

How to Order

		<div><div></div><div>PQD PQS (std)</div></div>	<div>Fabric</div> <div>See the Logiflex Graded-in List</div>			
SS	6759					
series	code	top stitch	supplier	pattern	color	
Example SS	6759	PSQ	J. ENNIS	ASTRAL	GRAY #71	

Soft Seating

Taylor Armchair

TAY1

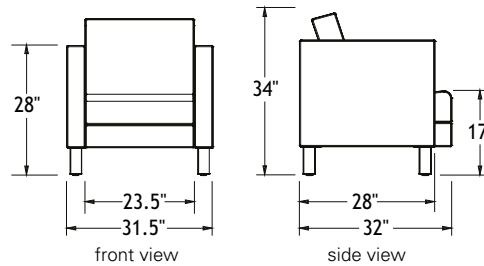
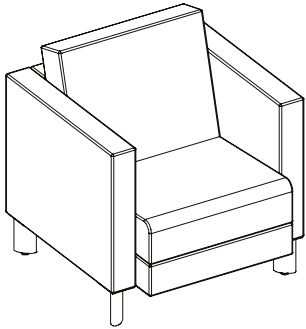

Manufacturing Standards

- Elastic straps on seat;
- Medium-density Celcor foam;
- Frame made out of recycled and recyclable particles;
- Oval metal legs 6" H, satin nickel finish.

COM Fabric: Number of yards required:

Code	Total
TAY1	6

Prices

Code	COM	GR1	GR2	GR3	GR4	GR5	GR6
TAY1	877	973	1091	1319	1491	1672	

How to Order

Finishes
See the
Logiflex
Color Guide

Fabric
See the Logiflex Graded-in List

SS	TAY1				
series	code	leg color	supplier	pattern	color

Example **SS** **TAY1** **WK** **J. ENNIS** **ASTRAL** **GRAY #71**

Soft Seating

Taylor Loveseat

TAY2

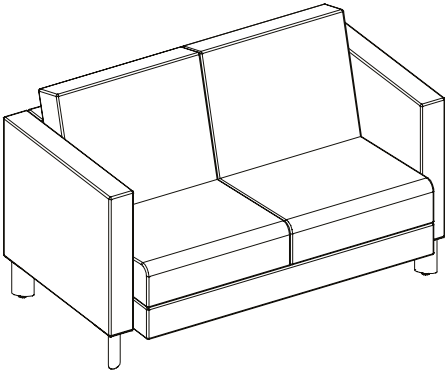

Manufacturing Standards

- Elastic straps on seat;
- Medium-density Celcor foam;
- Frame made out of recycled and recyclable particles;
- Oval metal legs 6" H, satin nickel finish.

COM Fabric: Number of yards required:

Code	Total
TAY2	9

Prices

Code	COM	GR1	GR2	GR3	GR4	GR5	GR6
TAY2	1137	1279	1457	1843	2084	2334	

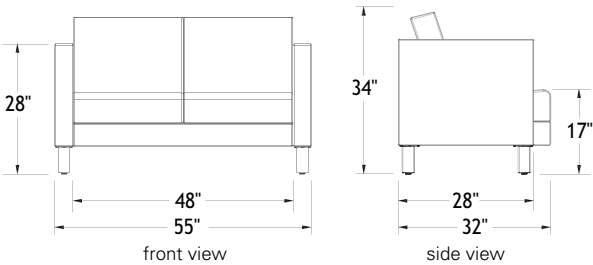

How to Order

		Finishes <i>See the Logiflex Color Guide</i>		Fabric <i>See the Logiflex Graded-in List</i>		
series	code	leg color	supplier	pattern	color	
Example SS	TAY2	WK	J. ENNIS	ASTRAL	GRAY #71	

Soft Seating

Taylor Sofa

TAY3

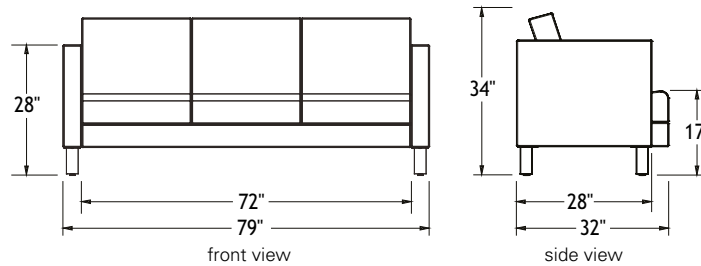
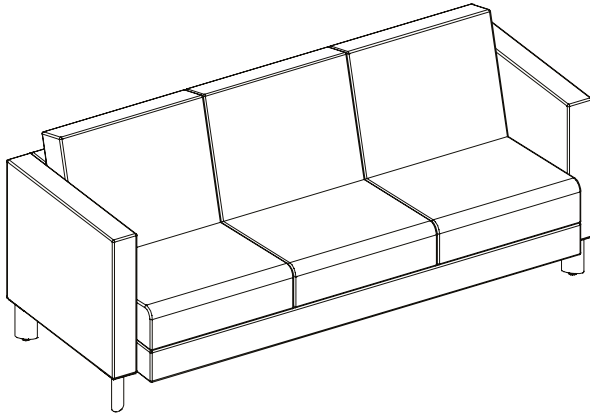

Manufacturing Standards

- Elastic straps on seat;
- Medium-density Celcor foam;
- Frame made out of recycled and recyclable particles;
- Oval metal legs 6" H, satin nickel finish.

COM Fabric: Number of yards required:

Code	Total
TAY3	12

Prices

Code	COM	GR1	GR2	GR3	GR4	GR5	GR6
TAY3	1428	1498	2022	2449	2788	3138	

How to Order

Finishes
See the
Logiflex
Color Guide

Fabric
See the Logiflex Graded-in List

SS	TAY3				
series	code	leg color	supplier	pattern	color

Example SS TAY3 WK J. ENNIS ASTRAL GRAY #71

Chairs

Seats

High Back - Varnished or Stained Wood

HWDE-T01

HWDE-B01

HWDE-G01

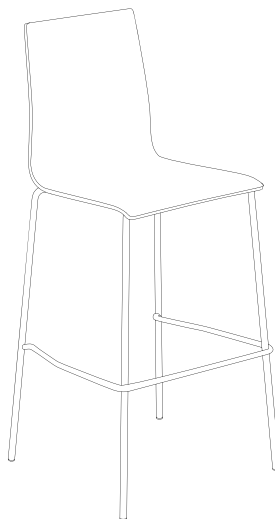
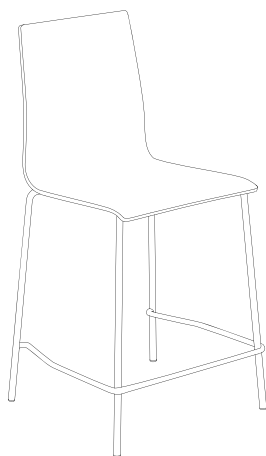

Manufacturing Standards

- Chromed metal legs;
- 2 plies of 1/36" high density maple;
- 2 plies of 1/52" high density cherrywood;
- 8 plies of 1/21" high density beech wood.

Finish: Golden Wheat varnish or stain and paint selection among the following colors: Chestnut, Espresso, Opaque Black and Opaque White.

Dimensions:

Code	Table Height	Width	Depth	Height
T01	29"	20-1/4"	21-1/2"	31"
B01	36"	18-1/2"	20-7/8"	37"
G01	42"	19-1/2"	20-7/8"	43"

Prices

Height	
T01	359
B01	473
G01	473

How to Order

			T01 B01 G01
MADR	H	WDE	
series	back	finish (Appx. A)	leg

Example MADR H WDE T01

Seats

High Back - Varnished or Stained Wood with Cushion

HWFE-T01

HWFE-B01

HWFE-G01

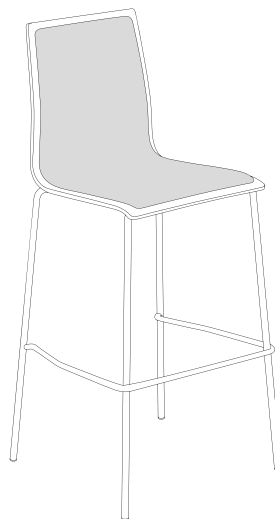
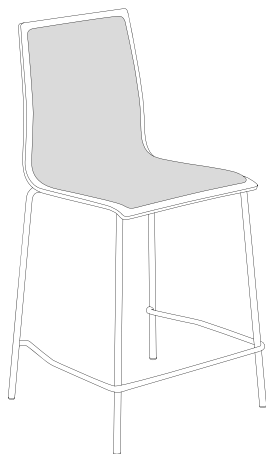
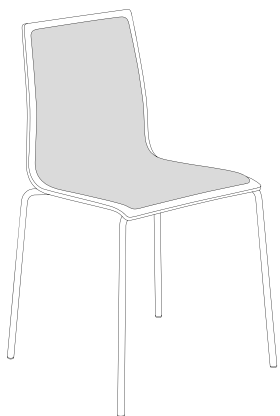

Note: The upholstered cushion cannot be in vinyl or leather.

Manufacturing Standards

- Chromed metal legs;
- 2 plies of 1/36" high density maple;
- 2 plies of 1/52" high density cherrywood;
- 8 plies of 1/21" high density beech wood;
- Upholstered cushion on the wooden seat.

Finish: Golden Wheat varnish or stain and paint selection among the following colors: Chestnut, Espresso, Opaque Black and Opaque White.

Selection of fabrics by the customer from the supplier of their choice.

Dimensions:

Code	Table Height	Width	Depth	Height
T01	29"	20-1/4"	21-1/2"	31"
B01	36"	18-1/2"	20-7/8"	37"
G01	42"	19-1/2"	20-7/8"	43"

COM Fabric: Number of yards required:

Code	Total
T01	2
B01	2
G01	2

Prices

Height	GR1/ COM	GR2	GR3	GR4	GR5	GR6
T01	490	504	520	537	554	571
B01	591	604	621	638	655	672
G01	591	604	621	638	655	672

How to Order

			T01 B01 G01
MADR	H	WFE	
series	back	finish (Appx. A)	leg

Example **MADR** **H** **WFE** T01

Seats

High Back - Upholstered

HFBR-T01

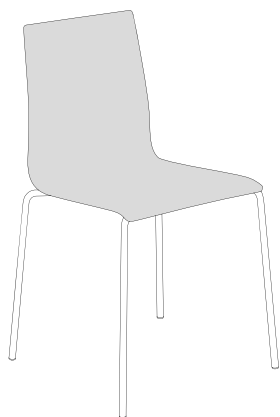

HFBR-B01

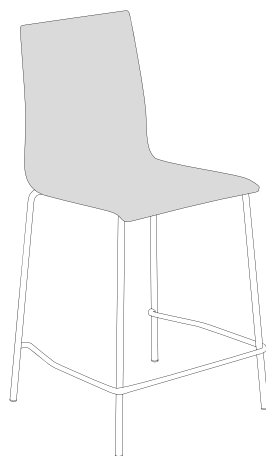

HFBR-G01

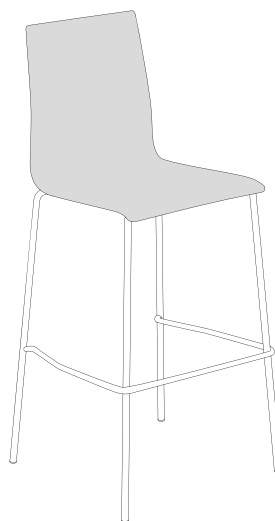

Manufacturing Standards

- Chromed metal legs;
- 3 plies of 1/16" high density beech wood;
- 0.5" thick Velve foam with 60 pounds compression.

Finish: Selection of fabrics or vinyl by the customer from the supplier of their choice.

Dimensions:

Code	Table Height	Width	Depth	Height
T01	29"	20-1/4"	21-1/2"	31"
B01	36"	18-1/2"	20-7/8"	37"
G01	42"	19-1/2"	20-7/8"	43"

COM Fabric: Number of yards required:

Code	Total
T01	2
B01	2
G01	2

Prices

Height	GR1/COM	GR2	GR3	GR4	GR5	GR6
T01	389	404	423	442	461	480
B01	502	517	536	555	574	593
G01	502	517	536	555	574	593

How to Order

			T01 B01 G01
MADR	H	FBR	
series	back	finish (Appx. A)	leg

Example MADR H FBR T01

Seats

Low Back - Varnished or Stained Wood

LWDE-T01

LWDE-B01

LWDE-G01

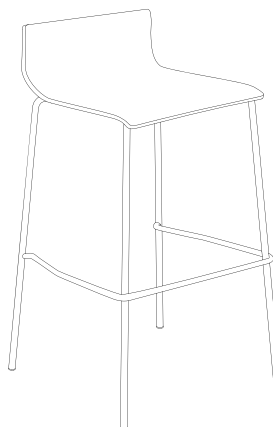
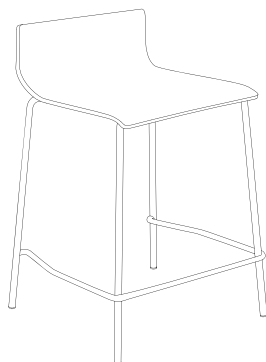

Manufacturing Standards

- Chromed metal legs;
- 2 plies of 1/36" high density maple;
- 2 plies of 1/52" high density cherrywood;
- 8 plies of 1/21" high density beech wood.

Finish: Golden Wheat varnish or stain and paint selection among the following colors: Chestnut, Espresso, Opaque Black and Opaque White.

Dimensions:

Code	Table Height	Width	Depth	Height
T01	29"	20-1/4"	19-1/4"	23"
B01	36"	18-1/2"	18-7/8"	28-5/8"
G01	42"	19-1/2"	18-7/8"	34-5/8"

Prices

Height	
T01	359
B01	473
G01	473

How to Order

			T01 B01 G01
MADR	L	WDE	
series	back	finish (Appx. A)	leg
Example	MADR	L	WDE
			T01

Seats

Low Back - Upholstered

LFBR-T01



LFBR-B01

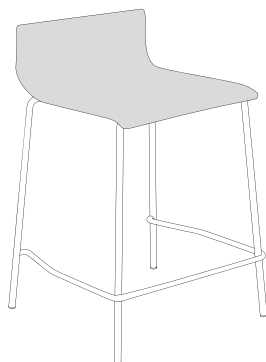

LFBR-G01

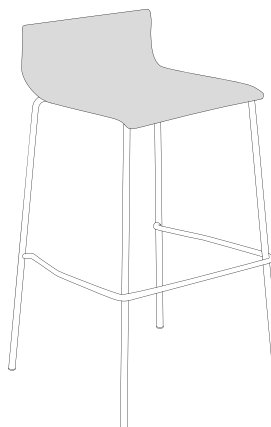

Manufacturing Standards

- Chromed metal legs;
- 3 plies of 1/16" high density beech wood;
- 0,5" thick Velve foam with 60 pounds compression.

Finish: Selection of fabrics or vinyl by the customer from the supplier of their choice.

Dimensions:

Code	Table Height	Width	Depth	Height
T01	29"	20-1/4"	19-1/4"	23"
B01	36"	18-1/2"	18-7/8"	28-5/8"
G01	42"	19-1/2"	18-7/8"	34-5/8"

COM Fabric: Number of yards required:

Code	Total
T01	2
B01	2
G01	2

Prices

Height	GR1/COM	GR2	GR3	GR4	GR5	GR6
T01	389	404	423	442	461	480
B01	502	517	536	555	574	593
G01	502	517	536	555	574	593

How to Order

			T01 B01 G01
MADR	L	FBR	
series	back	finish (Appx. A)	leg

Example **MADR** **L** **FBR** T01

Seats

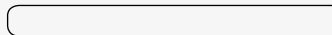

Sedia Chairs

803

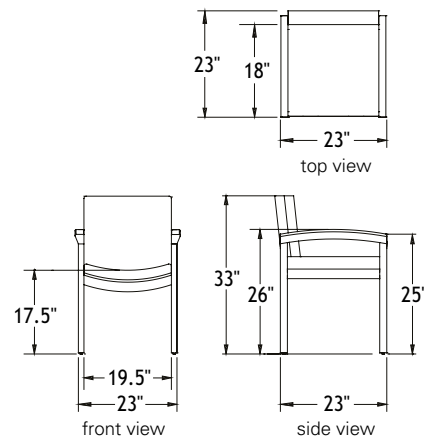
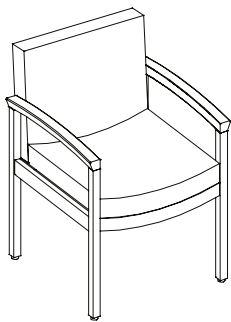

Manufacturing Standards

- Single top stitching;
- Elastic straps on seat and back;
- Medium-density Velva* foam on seat;
- Low density Velva* foam on back;
- Frame made out of hardwood, choice of Logiflex wood finish laminate color.

COM Fabric: Number of yards required:

Code	Total
803	5

Options

Double Stitching

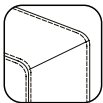

\$0

Prices

Code	COM	GR1	GR2	GR3	GR4	GR5	GR6
803	596	600	663	725	850	974	

How to Order

		<div>+</div> PQD PQS (std)	Finishes See the Logiflex Color Guide	Fabric See the Logiflex Graded-in List		
SS	803					
series	code	top stitch	base	supplier	pattern	color
Example SS	803	PSQ	WK	J. ENNIS	ASTRAL	GRAY #71

Seats

Sedia Chairs

804

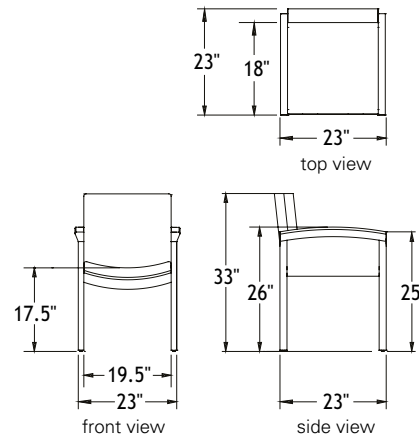
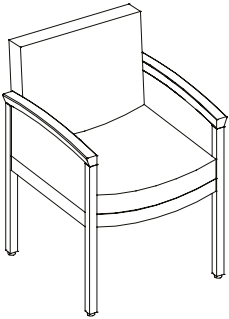

Manufacturing Standards

- Single top stitching;
- Elastic straps on seat and back;
- Medium-density Velva* foam on seat;
- Low density Velva* foam on back;
- Frame made out of hardwood, choice of Logiflex wood finish laminate color.

COM Fabric: Number of yards required:

Code	Total
804	5

Options

Double Stitching

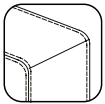

\$0

Prices

Code	COM	GR1	GR2	GR3	GR4	GR5	GR6
804	734	791	876	961	974	1037	

How to Order

		<div>+</div> PQD PQS (std)	<div>Finishes</div> <div>See the Logiflex Color Guide</div> <div>Fabric</div> <div>See the Logiflex Graded-in List</div>			
SS	804					
series	code	top stitch	base	supplier	pattern	color
Example SS	804	PSQ	WK	J. ENNIS	ASTRAL	GRAY #71

Accessories

Accessories

Miscellaneous Accessories

FILLER4

Filler

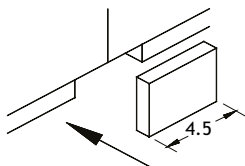

- 4-1/2" removeable joint for junctions between kick plates
- Lacquered Russian plywood.

For best results, order 2 fillers for each module junction.

Code	\$	Description
FILLER 4	25	

FILLER5

Filler

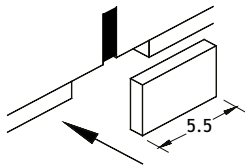

- 5-1/2" removeable joint for junctions between kick plates with privacy panels
- Lacquered Russian plywood.

For best results, order 2 fillers for each module junction.

Code	\$	Description
FILLER 5	25	

BCHR

Metal Legs

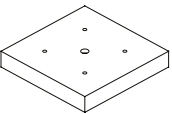

Set of 4 chrome metal legs.

Code	\$	Description
BCHR	346	

OVAMSN

Oval Corner Leg

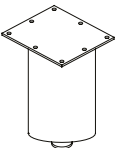

- Oval metal corner leg / on leveller;
- Finish: Satin Nickel (SN);
- Height: 4"

Code	\$	Description
OVAM	49	

Accessories

Electrical Accessories

MH3C

Connectivity unit

- Retractable connectivity unit with 72" cord.

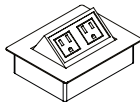

Code	\$	Description
MH3C	216	Electrical outlet / Electrical outlet

MH3D

Connectivity unit

- Retractable connectivity unit with 72" cord.

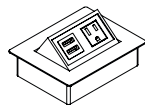

Code	\$	Description
MH3D	286	Electrical outlet / USB outlet

QIBL

Wireless Charger

- Air charger wireless;
- Qi compatible device;
- Finish: Black.

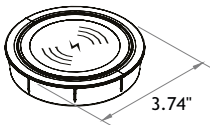

Code	\$	Description
QIBL	474	

QIRE

Qi Adapter

- Receiver to adapt devices not Qi compatible.
- Built-in connections for Apple 30 pin and lightning, Micro-USB.



Code	\$	Description
QIRE	130	

As our product line is constantly evolving and expanding, we recommend that you visit logiflex.ca for updates.

logiflex

1235 St-Roch N., Sherbrooke QC J1N 0H2 Canada
T : 1.877.864.9323 | F : 1.800.474.7830 | logiflex.ca

LOGIFLEX | SEATING

