

Logic Reach™ Canvas Dock

System Start

Y1461.

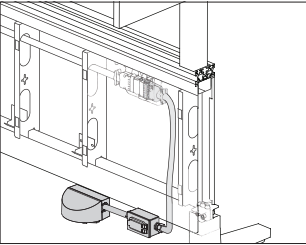

Product Information

Description

This Logic Reach™ Canvas Dock System Start draws single circuit power from a Canvas Dock workstation on circuit A. It is rated at 20 amps and connects to 1 or 2 Under-Carpet Tracks. It is UL Listed.

Notes

Includes an integrated, resettable 20-amp Class A GFCI device.

The start should be installed up to 36" from end of Dock and does not take up a receptacle location.

To continue a run of track and hubs, order Logic Reach under-carpet track (Y1470.) and electrical hub (Y1480.) separately.

Dimensions

Specification Information

Step 1.

Y1461. A

Step 2. Circuit

A circuit a A

Prices for Steps 1-2.

Y1461. A \$981

Step 3. Surface Finish

DCR dark carbon A +\$0

DVP dark mineral A +\$0

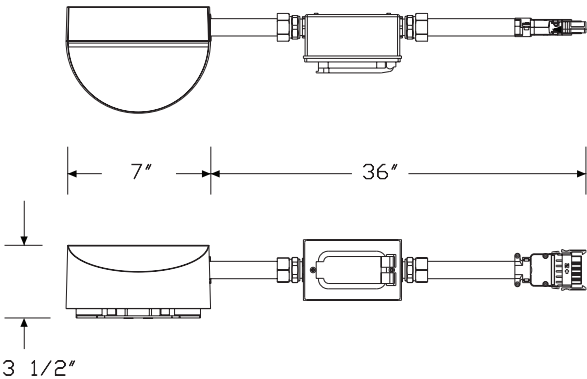

Logic Reach™ Canvas Channel
System Start

Y1462.

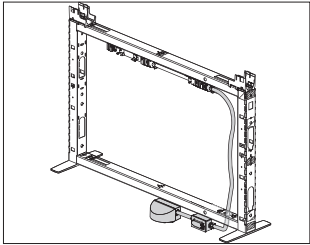

Product Information

Description

This Logic Reach™ Canvas Channel System Start draws single circuit power from a Canvas Channel workstation on circuit A. It is rated at 20 amps and connects to 1 or 2 Under-Carpet Tracks. It is UL Listed.

Notes

Includes an integrated, resettable 20-amp Class A GFCI device.

Whip for open base (B) application enters bottom of frame. See planning guide for appropriate dimension locations.

For open base (B) application, the start must connect into the lowest power in the channel and does not take up a receptacle location.

For tiles to-the-floor (T) application, the start must be within 15" of receptacle opening and takes up a receptacle location.

To continue a run of track and hubs, order Logic Reach under-carpet track (Y1470.) and electrical hub (Y1480.) separately.

Dimensions

Right Facing Whip

Left Facing Whip

Specification Information

Step 1.

Y1462. ☐ A

Step 2. Circuit

A circuit a ☐ A

Step 3. Application

T tiles to floor ☐ A

B open base ☐ A

Step 4. Direction

L left facing whip ☐ A

R right facing whip ☐ A

Prices for Steps 1-4.

	L	R
Y1462. A T	\$981	981
B	\$981	981

Step 5. Surface Finish

DCR	dark carbon <input type="checkbox"/> A	+\$0
DVP	dark mineral <input type="checkbox"/> A	+\$0

Logic Reach™ Canvas Vista

System Start

Y1464.

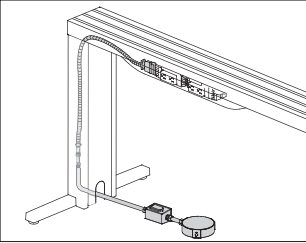

Product Information

Description

This Logic Reach™ Canvas Vista System Start connects to the Canvas Vista leg on single circuit A and terminates in a modified Electrical Hub. It is rated at 20 amps and connects to 1, 2 or 3 Under-Carpet Tracks. It is UL Listed.

Notes

Includes an integrated, resettable 20-amp Class A GFCI device.

Modified electrical hub provides 2 receptacle locations.

The modified electrical hub receptacle location that has the liquid tight conduit replaces the receptacle position that is oriented ground-pin-down.

Modified electrical hub should be installed 18", +/- 12", from leg, and does not take up a receptacle location in the chase.

Whip includes 30" of liquid tight conduit for all whip lengths.

Remaining length is flexible conduit.

To continue a run of track and hubs, order Logic Reach under-carpet track (Y1470.) and electrical hubs (Y1480.) separately.

Dimensions

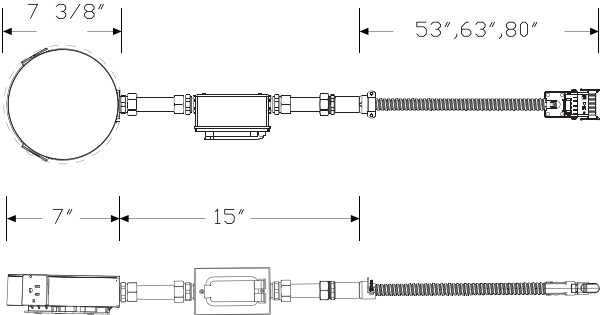

Specification Information

Step 1.

Y1464.

Step 2. Circuit

A circuit a

Step 3. Whip Length

053 53" long

063 63" long

080 80" long

Prices for Steps 1-3.

	053	063	080
Y1464. A	\$1147	1147	1147

Step 4. Surface Finish

DCR dark carbon +\$0

DVP dark mineral +\$0

Logic Reach™ Overlay System
Start

Y1465.

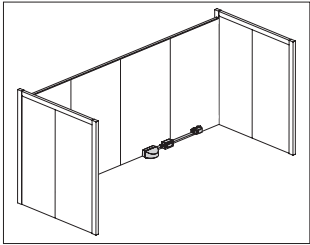

Product Information

Description

This Logic Reach™ Overlay System Start draws single circuit power from an Overlay Performance Wall on circuit A. It is rated at 20 amps and connects to the Under-Carpet Track. It is UL Listed.

Notes

Includes an integrated, resettable 20-amp Class A GFCI device.

Whip length is 15" and uses a receptacle location on the Overlay Performance Wall.

To continue a run of track and hubs, order Logic Reach under-carpet track (Y1470.) and electrical hub (Y1480.) separately.

Dimensions

Right Facing Whip

Left Facing Whip

Specification Information

Step 1.

Y1465.

A

Step 2. Circuit

A circuit a

A

Step 3. Direction

L left facing whip

A

R right facing whip

A

Prices for Steps 1-3.

	L	R
Y1465. A	\$981	981

Step 4. Surface Finish

DCR dark carbon

A

 +\$0

DVP dark mineral

A

 +\$0

Logic Reach™ Under Carpet Track Y1470.

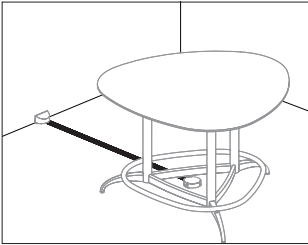

Product Information

Description

This Logic Reach™ Under Carpet Track attaches to a Logic Reach start and routes single circuit power and either flat or round Category 5 or Category 6 data wires to an Electrical Hub. Ramps are included in track specification. Attachment hardware not included. Track is rated at 20 amps. It is ADA compliant and UL Listed.

Notes

Product not compatible with Chicago Electrical Code.
Track must be covered by carpet tiles.
Attachment hardware not included. See planning guide for hardware suggestions based on floor type.
Thickness of flat data track and ramp is 3/16" and width is 9 7/8".
Thickness of round data track is 5/16" and width is 18 1/8".
Flat data track application can accommodate up to 2 Category 5 or Category 6 flat data cables. Round data track application can accommodate up to 8 Category 5 or Category 6 round data cables.
Order Logic Reach start (Y1450., Y1451., Y1460., Y1461., Y1462., Y1464., Y1465.) and electrical hub (Y1480.) separately.

Dimensions

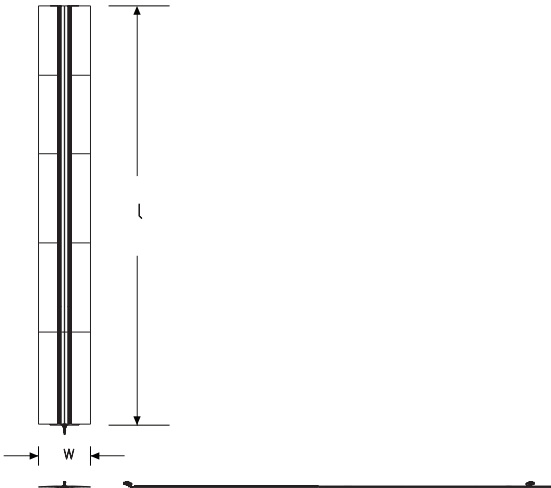

Specification Information

Step 1.

Y1470. ☐ A

Step 2. Circuit

A circuit a ☐ A

Step 3. Track Type

- 1 power and flat data track ☐ A
- 2 power and round data track ☐ A

Step 4. Length

- 036 36" long ☐ A
- 048 48" long ☐ A
- 060 60" long ☐ A
- 072 72" long ☐ A
- 084 84" long ☐ A
- 096 96" long ☐ A
- 108 108" long ☐ A
- 120 120" long ☐ A
- 132 132" long ☐ A
- 144 144" long ☐ A

Prices for Steps 1-4.

		036	048	060	072	084	096
Y1470. A	1	\$408	429	454	474	497	518
	2	\$524	552	584	615	648	698
				108	120	132	144
Y1470. A	1			\$564	587	610	656
	2			\$778	855	939	1003