

Logic Reach™ Electrical Hub

Y1480.

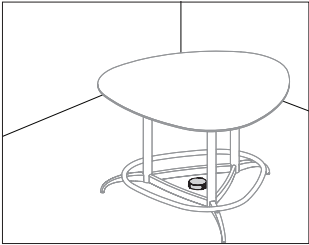

Product Information
Description
This Logic Reach™ Electrical Hub connects to a Logic Reach Under-Carpet Track to provide 3 AC single circuit A power receptacles. The Electrical hub attaches to the subfloor. Attachment hardware not included. Hub is rated at 20 amps with 15-amp receptacles and is UL Listed.
Notes
Each receptacle is oriented differently to accommodate typical plug configurations including offset power supply transformers.
Attachment hardware not included. See planning guide for hardware suggestions based on floor type.
Electrical hub can accommodate carpet thickness up to 0.28".
Order Logic Reach start (Y1450., Y1451., Y1460., Y1461., Y1462., Y1464., Y1465.) and under-carpet track (Y1470.) separately.
Dimensions

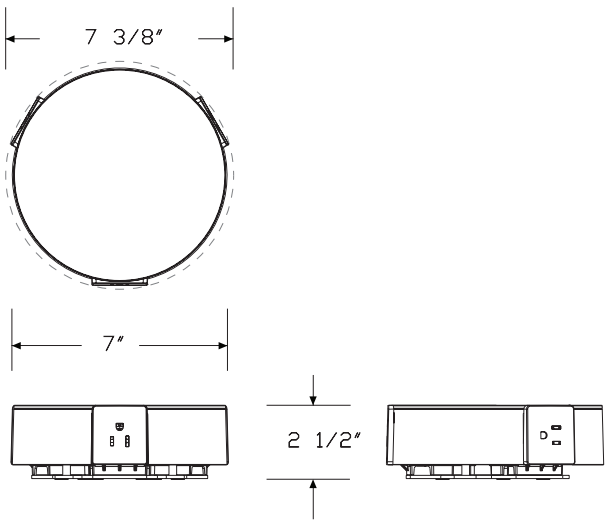

Specification Information
Step 1.
Y1480. <input type="checkbox"/> A
Step 2. Circuit
A circuit a <input type="checkbox"/> A
Prices for Steps 1-2.
Y1480. A \$429
Step 3. Surface Finish
DCR dark carbon <input type="checkbox"/> A +\$0
DVP dark mineral <input type="checkbox"/> A +\$0

Thrive™ Power and Data Support

Logic Mini Grommet

Y1412.

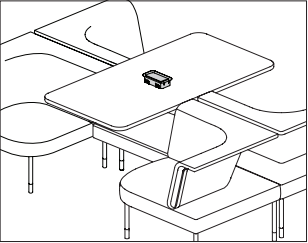

Product Information

Description

This Logic Power Access Solutions™ plastic grommet is available in mini rectangle or mini square configuration. The integrated flaps can hide the things below the surface while also retaining power and data cords.

Notes

This grommet is installed in some HermanMiller applications. Verify your application before ordering grommet separately.

Dimensions

Specification Information

Step 1.

Y1412.

Step 2. Configuration

1

mini rectangle grommet

2

mini square grommet

Prices for Steps 1-2.

Y1412. 1

\$40

2

\$45

Step 3. Finish

91

white

+\$0

98

studio white

+\$0

BK

black

+\$0

G1

graphite

+\$0

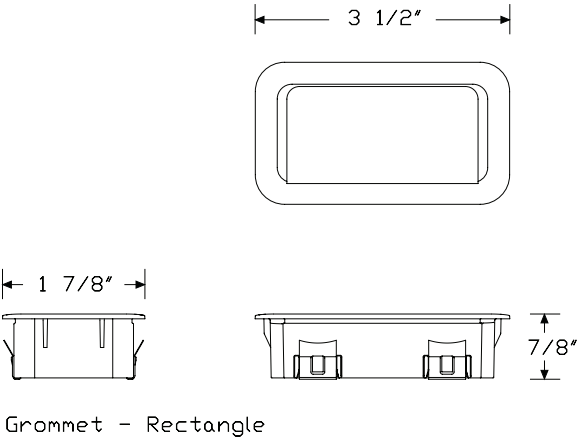

Grommet - Rectangle

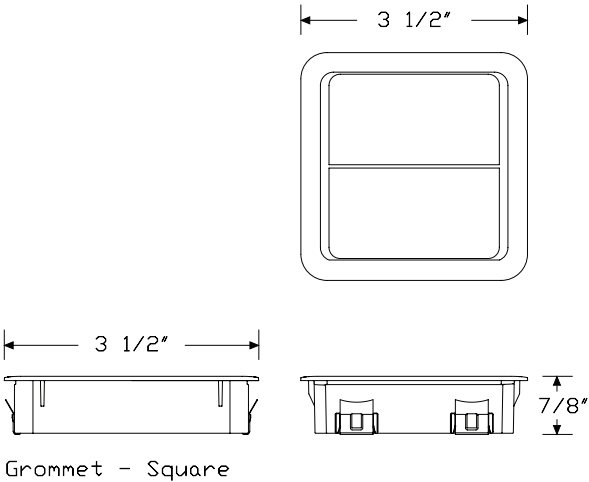

Grommet - Square

Logic G1200 Grommet Pass Thru Y1420.

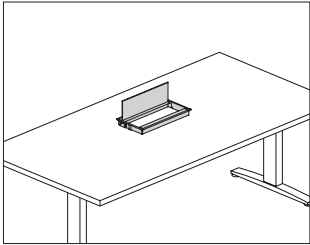

Product Information
Description
This Logic Power Access Solutions™ grommet mounted metal enclosure provides access to cords kept beneath the surface. The unit has an integrated cord keeper.
Notes
Unit size is based on the grommet mounted electrical distributor (Y1425.) with simplex receptacles.
Dimensions

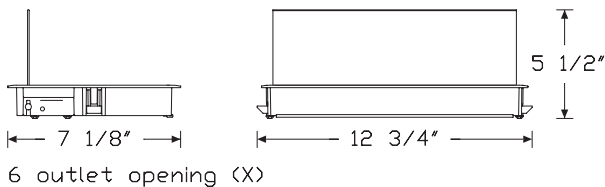
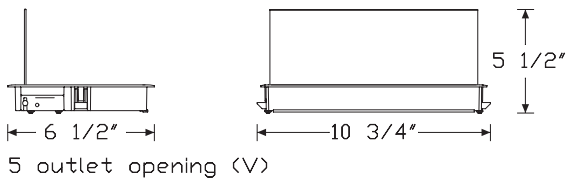
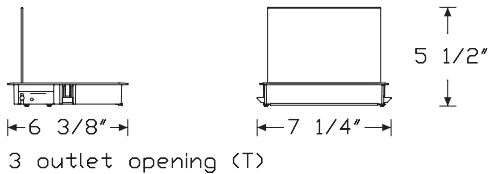

Specification Information
Step 1.
Y1420.
Step 2. Configuration
T three outlet opening
V five outlet opening
X six outlet opening
Prices for Steps 1-2.
Y1420. T \$294
V \$323
X \$351
Step 3. Finish
91 white A +\$0
98 studio white A +\$0
BK black A +\$0
G1 graphite A +\$0
MS metallic silver A +\$0

Logic HD Cable Manager

Y1424.

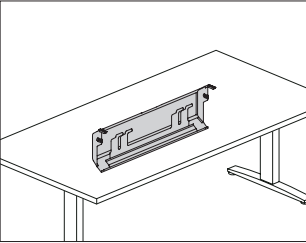

Product Information
Description
This Logic Power Access Solutions™ stand-alone cable management tray mounts to the underside of most surfaces. It can be used with a Logic unit for cord storage, or used alone with cords routed through the back side of the unit. Tray drops down and holds cords in place while working and can be easily stowed back in place.
Dimensions

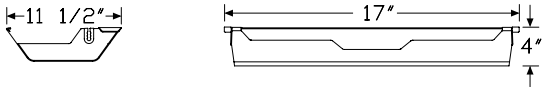

Specification Information
Step 1.
Y1424.
Step 2. Size
17 17" wide tray
Prices for Steps 1-2.
Y1424. 17 \$323
Step 3. Finish
SNA satin aluminum +\$0
SNB satin bronze +\$0
SNC satin carbon +\$0
91 white <input type="checkbox"/> +\$0
98 studio white <input type="checkbox"/> +\$0
BK black <input type="checkbox"/> +\$0
G1 graphite <input type="checkbox"/> +\$0
MS metallic silver <input type="checkbox"/> +\$0

Logic Micro Tower

Y1490.

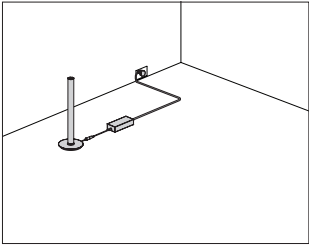

Product Information
Description
This freestanding micro tower has 1 USB-A port and 1 USB-C port. It plugs into an AC outlet and is designed to sit on the floor. It is ETL Listed. Cord is black.
Notes
Cord length is 8¼ feet.
USB-A port is rated at 12W; USB-C port is rated at 60W.
Dimensions

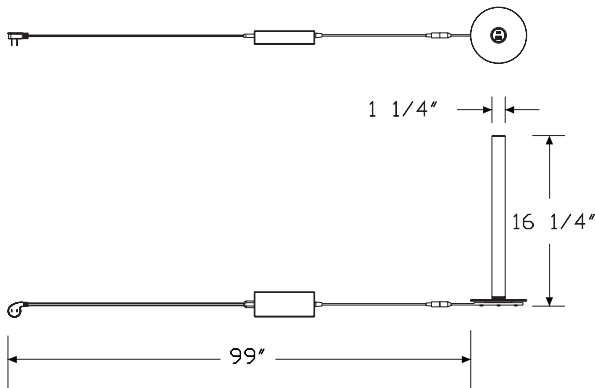

Specification Information
Step 1.
Y1490. A
Step 2. Configuration
1 configured with 1 USB-A port and 1 USB-C port A
Prices for Steps 1-2.
Y1490. 1 \$847
Step 3. Surface Finish
Sand Texture Paint
98 studio white A +\$0
BK black A +\$0

Thrive™ Power and Data Support

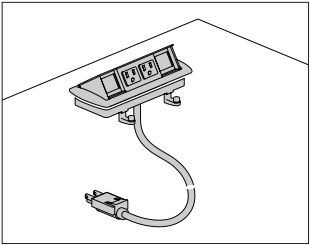

Product Information

Description
This electrical distributor mounts flush in a surface and has a one-touch pop-up mechanism for accessing power and data. It has 2 simplex receptacles and 2 data openings, and is available with a power cord with plug end, or electrical conduit for hardwire connection. A voice/data adapter kit is included, allowing the data openings to accept various manufacturers’ couplers and jacks. Attachment hardware and cord/cable clips are also included. Product is UL listed.

Notes

Field cutting of surface may be required. Information on surface cutout size is included on instruction sheet.

Dimensions

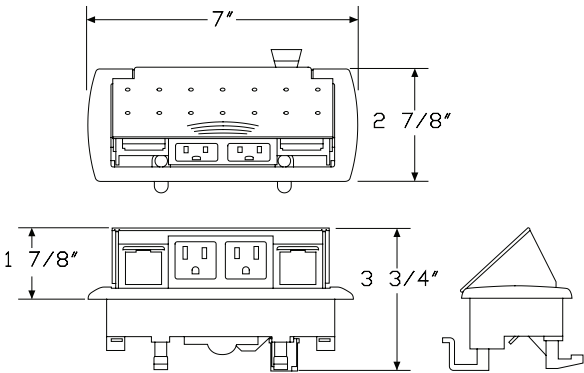

Specification Information

Step 1.
Y1321.

Step 2. Power Type

- A** power cord with plug end
- B** conduit with open end, for hard-wiring

Step 3. Cord/Conduit Length

- 03** 3’ cord/conduit
- 06** 6’ cord/conduit
- 10** 10’ cord/conduit
- 20** 20’ cord/conduit

Prices for Steps 1-3.

	03	06	10	20
Y1321. A	\$290	290	302	371
B	\$363	363	377	445

Step 4. Wiring Type

- 4Z** standard +\$0

Step 5. Finish

- 0H** black +\$0