

Remote Controlled Monitor - Up To 1500 GPM Designed for Ladder and Platform Applications

The Typhoon RC for Ladder or Platform installations is similar to the standard Typhoon RC. This model has the horizontal travel limited to 90 degrees left and right (180 degrees total). Various models are available with different elevation ranges –see the figure and table below for details. Ladder and Platform models include an electronics enclosure and 10' of cable to connect signals from the primary control station (such as the turntable toggle switches). These signals can either be hard wired or from a Canbus output module. The Platform model's electronics enclosure contains an additional 10' cable to connect signals from a secondary control station (such as from basket toggle switches). The primary control signals will always override any signals from the secondary control or the monitor operator station. The electronics enclosure is factory configured to accept +12/24 VDC signals, but can be reconfigured in the field to accept ground signals. This electronics enclosure also includes a relay to indicate when the monitor is in the PARK position and contacts that can be connected to the Canbus or multiplex system. A monitor mounted control panel allows vertical, horizontal, and nozzle pattern adjustments and programmable PARK and Oscillate. See pages 174-177 for additional control stations. For wireless operation, purchase wireless operator station package on page 175.

Ladder/platform electronics enclosures includes inputs for DEPLOY monitor, INHIBIT monitor, and LIMIT VERTICAL movement on -L** models with extra travel.

All TFT RC monitors are capable of being controlled by a programmable logic controller with full three-axis position control & feedback using the Allen Bradley EtherNet/IP protocol. Contact factory for details.

Inlet Options A & B increase operating clearance by offsetting the monitor inlet by 1.5".

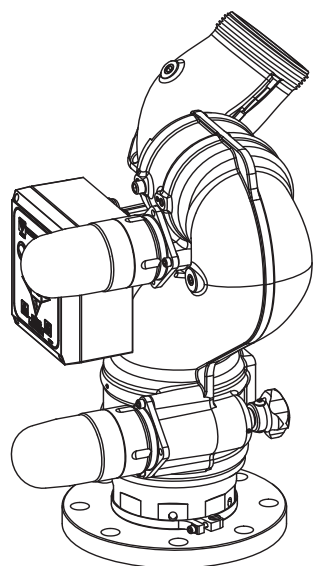

Y5-E21A-L
\$8245.00
37.2 lbs (16.9 kg).



SAMPLE PART NUMBER
Specify Inlet and Outlet by
number from chart

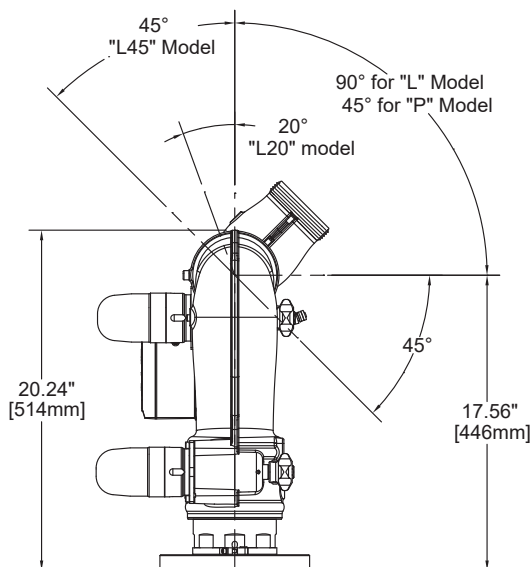
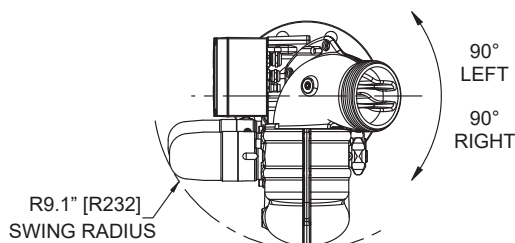
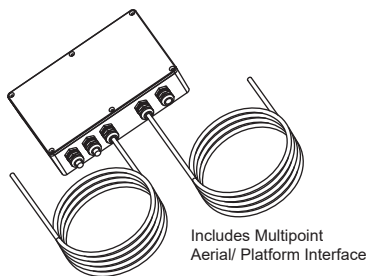

Y5-E

Inlet	Outlet
A) 1.5" Offset for VUM	1) 3.5"-6 NH Male
B) 1.5" Offset for 4" ANSI 150	2) 3.5"-11 BSP Male
1) 3" ANSI 150	3) 3.5"-8 NPSH Male
2) 4" ANSI 150	4) 4.0"-11 BSP Male
3) 6" ANSI 150	9) Special
4) DN80, PN16	
5) DN100, PN16	
6) 3" NPT Female	
7) 4" NPT Female	
8) 3" BSP Male	
9) 4" BSP Male	
L) TFT CODE-RLF *	
P) TFT CODE-RPF **	
Q) 4.5"NH Quick Connect for VUM +	
R) 4.5"NH Quick Connect with 4" ANSI 150 +	
S) 4.5"NH Quick Connect with 4" NPT female +	
T) 4.5"NH Quick Connect with CODE-RLF* +	
U) 4.5"NH Quick Connect with CODE-RPF** +	
X) TFT CODE RRM fits 4" IVUM and OUM +	

* TFT CODE-RLF fits Extend-A-Gun and Extend-A-Gun RC3

** TFT CODE-RPF fits Extend-A-Gun RC4, VUM and HUM

+ Horizontal Axis Travel Limited to ±135°

A

Configuration
-L) Ladder
-P) Platform
-L20) Ladder w/20° Extra Elevation
-L30) Ladder w/30° Extra Elevation
-L45) Ladder w/45° Extra Elevation

Typhoon RC Package Suggested Options

Rated to 1500 gpm, and 200 psi, the Typhoon RC is a remotely controlled fixed station or truck mounted monitor with electric remote control of horizontal rotation, elevation, nozzle pattern and Park & Oscillate. The unit has an electrically operated elevation control from 45° below horizontal up to a maximum of 45° past vertical for a total possible travel of 180°. Unit has elevation travel limit stops that can reduce the travel to 20° past vertical or less in 10° increments. The unit has an electrically operated 450° maximum horizontal travel, stainless steel worm gear, and horizontal travel limit stops in 45° increments. Knobs are mounted on the vertical and horizontal drives for manual override. User operation controls are mounted on the monitor, and include rotation, elevation, and nozzle stream pattern control. Optional remote wired, tethered, and wireless remote controls are available. The discharge elbow includes an integral stream straightener. The monitor is constructed of hardcoat anodized aluminum alloy and has a silver powder coat finish inside and out.

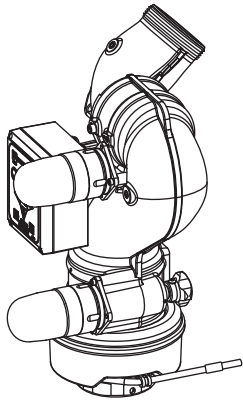

CE

For Pumper Applications
\$8245.00
 Page 159

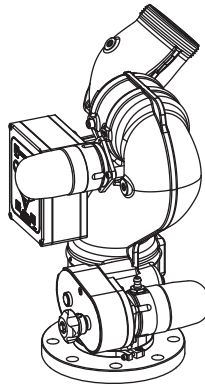

CE

For Ladders
\$8245.00
 Page 160

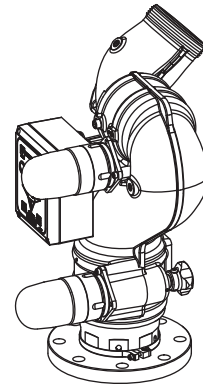

CE

For Platforms
\$8245.00
 Page 160

CONTROLLER CHOICE



YE-RF-BT
 Tactile Touch Screen Controller
\$600.00 - Page 145



YE-BT1
 Bluetooth® Adapter
\$400.00 - Page 145



Y4E-RP-D
 Panel Mount Monitor Operator
 Station with Display
\$1260.00 - Page 174

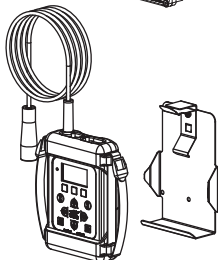

Y4E-CT-30-D
 30' Tethered Monitor Operator
 Station with Display
\$1370.00 - Page 174

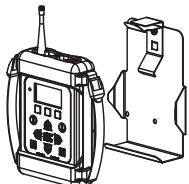

YE-RF-900-D
 Wireless Monitor Operator
 Station with Display
\$2245.00 - Page 175

For Non-Display Models See Page 174-177

NOZZLE CHOICE

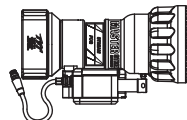

\$2035.00
 Page 131

M-ERP1000-NN — 3.5"NH
 100 psi Masterstream 1000
 Automatic Pressure
 150-1000 gpm Flow Range

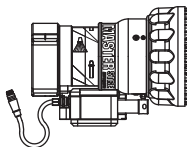

\$2140.00
 Page 132

M-ERP1250-NN — 3.5"NH
 70-120 psi Master Stream 1250
 Automatic Pressure
 300-1250 gpm Flow Range

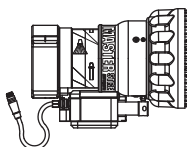

\$2140.00
 Page 135

M-ERP1500-NN — 3.5"NH
 70-120 psi Master Stream 1500
 Automatic Pressure
 300-1500 gpm Flow Range

EXTEND-A-GUN RC4

XGA48- (see chart)**
 18" Remote Controlled
 Telescoping Waterway
\$5050.00
 Page 141

Panel Mount RC
 Extend-A-Gun Operator
 Station available
 separately, see page
 175.

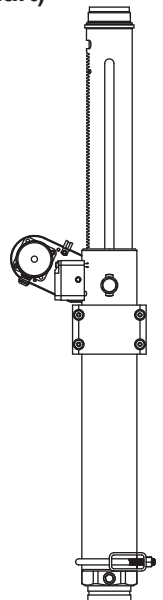

4"
BRACKET
SET
CHOICE

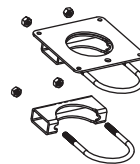

XGB-43
PLATE/SADDLE
\$170.00
 Page 141



XGB-53
SADDLE/SADDLE
\$155.00
 Page 141

Manually Controlled Monitor - Up To 1250 GPM

The Monsoon is a manually operated monitor designed for flows up to 1250 gpm (4750 l/min). Maximum operating pressure is 200 psi (14 bar). Unique patented segmented waterway has only 6 psi (.4 bar) friction loss at 1250 gpm. Water makes very few turns as it travels through the monitor resulting in low friction loss and a far-reaching effective stream. Elevation range is 90 degrees above horizontal to 45 degrees below. Field changeable elevation travel stops at 45 degrees above, 30 degrees above, and 30 degrees below horizontal. The manual model has continuous horizontal rotation with field changeable stops at 45, 90 and 135 either side of a center position. Available with various inlet flanges and threaded fittings. Inlet also made for direct connection to TFT's Extend-A-Gun series and Valve Under Monitor series. Several outlet thread sizes are available. See chart on next page for model numbers. Main waterway made from hardcoat anodized ANSI 356-T6 aluminum.

Silver powder coat finish inside and out is standard, except when "- Z" is added to the end of the model number. Models ending in "- Z" have American Red powder coat finish and aluminum crank handles rather than polymer handwheels. Standard outlet is 2.5"NH (64 mm) male thread; other outlets available.

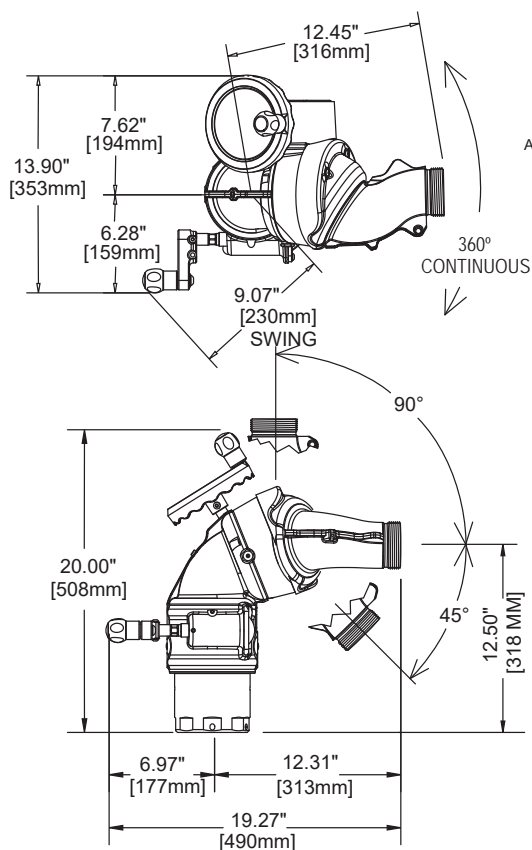

Y4-M15A
\$2840.00
25.0 lb (11.4 kg)

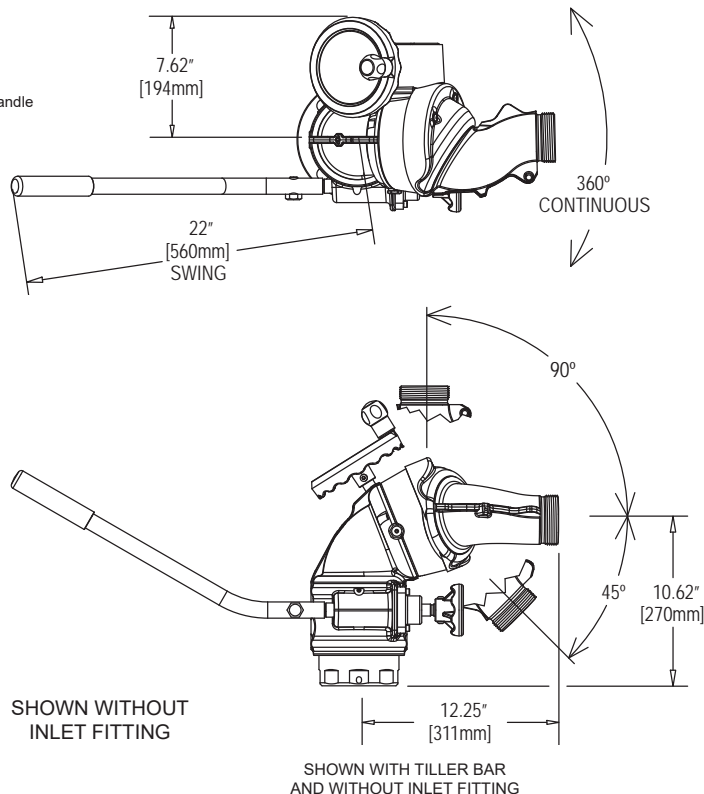

Y4-T15A
\$2840.00
26.0 lb (11.8 kg)



SAMPLE PART NUMBER
Specify Inlet and Outlet by
number from chart

When ordering a Monsoon monitor, choose one option from each category below. For example Model Y4-M25A is a manual aluminum monitor with 4" ANSI 150 flange inlet and 2.5" NH male threaded outlet. For assistance in ordering, please call 1-800-348-2686 and speak to a nozzle specialist. Flange Specifications are on page 218.

Y4-

Actuation	Inlet	Outlet	A
M) Manual	1) 3" ANSI 150	5) 2.5" NHM	Optional -Z) Industrial Model with American Red powdered coat and aluminum crank handles (omit for standard silver models)
T) Tiller	2) 4" ANSI 150	6) 2.5" BSPM	
	3) 6" ANSI 150	7) 2.5" NPSHM	
	4) DN80, PN16	8) SPECIAL	
	5) DN100, PN16		
	6) 3" NPT Female		
	7) 4" NPT Female		
	8) 3" BSP Male		
	9) 4" BSP Male		
	L) TFT CODE-RLF*		
	P) TFT CODE-RPF*		
	Q) 4.5"NH Quick Connect for VUM		
	R) 4.5"NH Quick Connect with 4" ANSI 150		
	S) 4.5"NH Quick Connect with 4" NPT female		
	T) 4.5"NH Quick Connect with CODE-RLF*		
	U) 4.5"NH Quick Connect with CODE-RPF**		
	W) Swivel Base for Booster OSC		
	X) TFT CODE-RRM***		

* TFT CODE-RLF fits Extend-A-Gun and Extend-A-Gun RC3

** TFT CODE-RPF fits Extend-A-Gun RC4, VUM and HUM

*** TFT Code-RRM fits 4" IVUM and OUM

Remote Controlled Deck Monitor - Up To 1250 GPM

Designed for Pumper Applications

The Monsoon RC for pumper installations is an electric remote controlled monitor that has all the benefits of the Monsoon monitor with the addition of powered operation. It has a greater horizontal sweep angle than the RC model for Ladder or Platform installations. Designed for 12 VDC or 24 VDC operation, selection is automatic. The Monsoon RC comes with a factory installed control panel mounted on the monitor for controlling horizontal rotation, elevation, nozzle pattern and programmable PARK and Oscillate. See page 174-177 for additional control stations. The motor control circuits are factory installed on the monitor and use position encoders and current limiting to protect the drive train at the ends of travel. Unit comes with 30 feet of ultra-flexing robotics cable already wired to the monitor so installation effort is minimized. Cable has only four conductors (two for power and two for communications), further easing the installation effort. Cable is enclosed in a unique wire guide that allows 450° of horizontal travel (225° either side of a center position), which is far more reliable than slip rings or coil cords. Knobs for manual override are provided on the horizontal rotation and elevation drive. TFT's Master ERP nozzles plug into the factory installed nozzle power wire. Electric drives and control box are waterproof. Main waterway made from hardcoat anodized ANSI 356-T6 aluminum. Silver powder coat finish inside and out. Standard outlet is 2.5" NH (64 mm) rigid male thread. Other outlets are available. For wireless operation, purchase wireless operator station and radio/antenna on page 175.

All TFT RC monitors are capable of being controlled by a programmable logic controller with full three-axis position control & feedback using the Allen Bradley EtherNet/IP protocol. Contact factory for details.

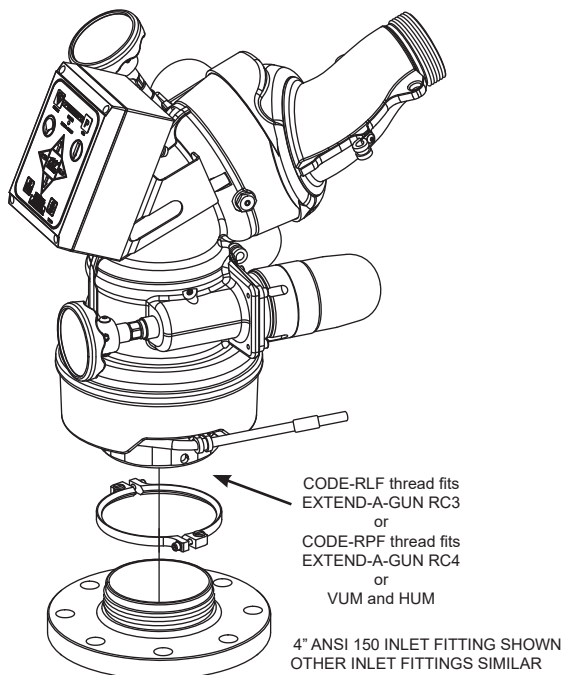

Y4-E25A
\$7635.00
37.0 lb (16.8 kg)



SAMPLE PART NUMBER
Specify Inlet and Outlet by
number from chart

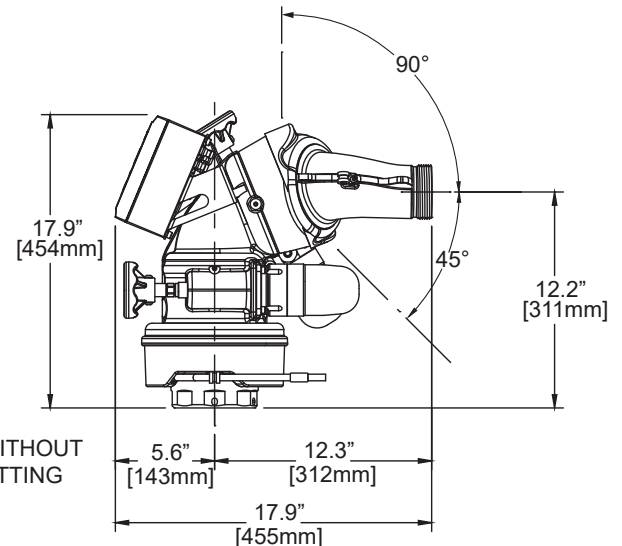
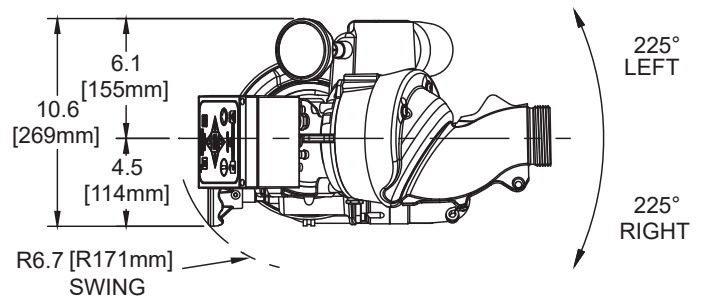

SHOWN WITHOUT
 INLET FITTING

When ordering a Monsoon monitor, choose one option from each category below. For example Model Y4E-25A is an electric aluminum monitor with 4" ANSI 150 flange inlet and 2.5" NH male threaded outlet. For assistance in ordering, please call 1-800-348-2686 and speak to a nozzle specialist. Flange Specifications are on page 218.

Y4-

			A	
Actuation E) Electric	Inlet 1) 3" ANSI 150 2) 4" ANSI 150 3) 6" ANSI 150 4) DN80, PN16 5) DN100, PN16 6) 3" NPT Female 7) 4" NPT Female 8) 3" BSP Male 9) 4" BSP Male	L) TFT CODE-RLF for Extend-A-Gun RC3 N) TFT CODE-RPF for VUM and HUM P) TFT CODE-RPF Extend-A-Gun RC4 Q) 4.5"NH Quick Connect for VUM + R) 4.5"NH Quick Connect with 4" ANSI 150 + S) 4.5"NH Quick Connect with 4" NPT female + T) 4.5"NH Quick Connect with CODE-RLF* + U) 4.5"NH Quick Connect with CODE-RPF** + X) TFT CODE-RRM fits 4" IVUM and OUM +	Outlet 5) 2.5" NHM 6) 2.5" BSPM 7) 2.5" NPSHM 9) SPECIAL	Optional -Z) Industrial Model with American Red powdered coat (omit for standard silver models)

* TFT CODE-RLF fits Extend-A-Gun and Extend-A-Gun RC3

** TFT CODE-RPF fits Extend-A-Gun RC4, VUM and HUM

+ Horizontal Axis Travel Limited to ±135°

Remote Controlled High Clearance Monitor - Up To 1250 GPM Designed For Ladder and Platform Applications

The Monsoon RC for Ladder or Platform installations is similar to the standard Monsoon RC. This model of Monsoon RC has the control box mounted at the top to give a reduced swing radius, thereby giving more clearance for Ladder Truck or Platform installations. Knobs for manual override are provided on the horizontal rotation and elevation drive. Also comes with factory installed travel stops to limit the horizontal travel to 180 degrees (90 degrees either side of a center position). Ladder and Platform models include an electronics enclosure and 10' of cable to connect signals from the primary control station (such as the turntable toggle switches). These signals can either be hard wired or from a Canbus output module output. The Platform model's electronics enclosure contains an additional 10' cable to connect signals from a secondary control station (such as from basket toggle switches). The primary control signals will always override any signals from the secondary control or the monitor operator station. The electronics enclosure is factory configured to accept +12/24 VDC signals, but can be reconfigured in field to accept ground signals. This electronics enclosure also includes a relay to indicate when the monitor is in PARK position and has contacts that can be connected into the Canbus or multiplex system. A monitor mounted control panel allows vertical, horizontal nozzle pattern adjustments and programmable PARK and Oscillate. See pages 174-177 for additional control stations. For wireless operation, purchase wireless operator station and radio/antenna on page 175.

Ladder/platform electronics enclosure includes inputs for DEPLOY monitor and INHIBIT monitor.

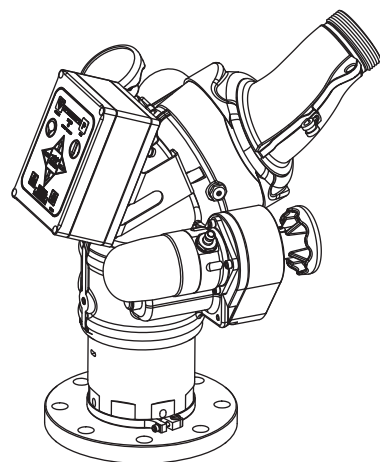

4" ANSI 150 INLET FITTING SHOWN
OTHER INLET FITTINGS SIMILAR

Y4-E25A-L
\$7635.00
37.0 lb (16.8 kg)



SAMPLE PART NUMBER
Specify Inlet and Outlet by
number from chart

Example: Y4-E21A-L is an
electric aluminum monitor
for ladders with a 4" ANSI
150 flange inlet and 3-1/2" NH
male threaded outlet.

All TFT RC monitors are capable of being
controlled by a programmable logic controller
with full three-axis position control & feedback
using the Allen Bradley EtherNet/IP protocol.
Contact factory for details.

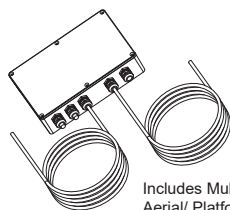
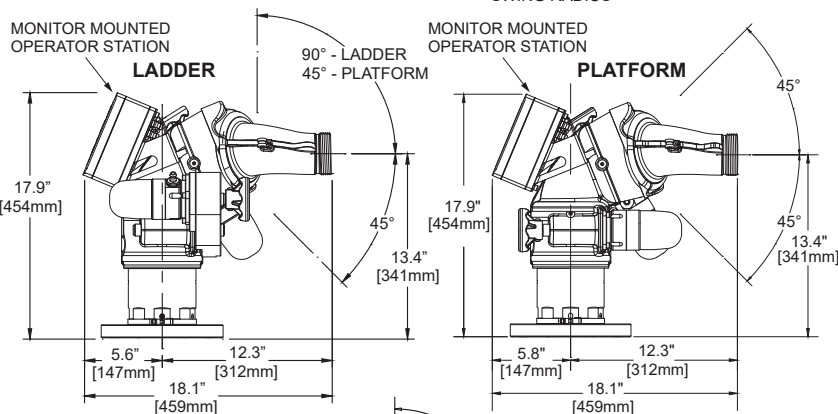
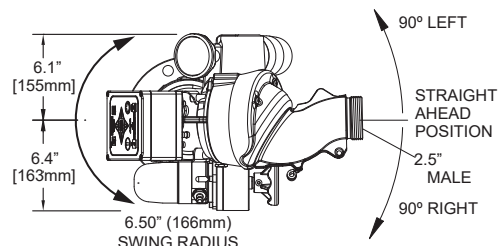

Includes Multipoint
Aerial/ Platform Interface

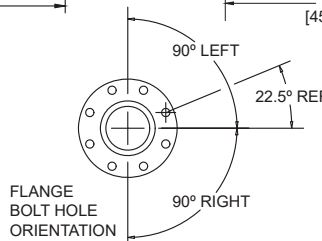

Y4-E

Inlet 1) 3" ANSI 150 2) 4" ANSI 150 3) 6" ANSI 150 4) DN80, PN16 5) DN100, PN16 6) 3" NPT Female 7) 4" NPT Female 8) 3" BSP Male 9) 4" BSP Male	A) 1.5" Offset for VUM B) 1.5" Offset for 4" ANSI 150 L) TFT CODE-RLF* P) TFT CODE-RPF** Q) 4.5"NH Quick Connect for VUM + R) 4.5"NH Quick Connect with 4" ANSI 150 + S) 4.5"NH Quick Connect with 4" NPT female + T) 4.5"NH Quick Connect with CODE-RLF* + U) 4.5"NH Quick Connect with CODE-RPF** + X) TFT CODE-RRM fits 4" IVUM and OUM +	Outlet 5) 2.5" NHM 6) 2.5" BSPM 7) 2.5" NPSHM 9) SPECIAL
---	---	---

A

Configuration -L) Ladder -P) Platform
--

* TFT CODE-RLF fits Extend-A-Gun and Extend-A-Gun RC3

** TFT CODE-RPF fits Extend-A-Gun RC4, VUM and HUM

+ Horizontal Axis Travel Limited to ±135°

Monsoon RC 1250 Package Suggested Options

Rated to 1250 gpm, 200 psi, the Monsoon RC is a remotely controlled fixed station or truck mounted monitor with electric remote control of rotation, elevation angle and nozzle pattern. The unit has an electrically operated elevation control from 90° above and 45° below horizontal through a segmented waterway with minimal waterway turning angles and built-in stream shaping vane. The unit has an electrically operated 450° maximum horizontal travel, stainless steel worm gear, and user installed travel limit stops. User operation controls are mounted on the monitor, and include rotation, elevation, nozzle stream pattern control, and Park & Oscillate. Optional remote wired, tethered and wireless remote controls are available. The monitor is hardcoat anodized aluminum alloy with a silver powder coat finish inside and out.

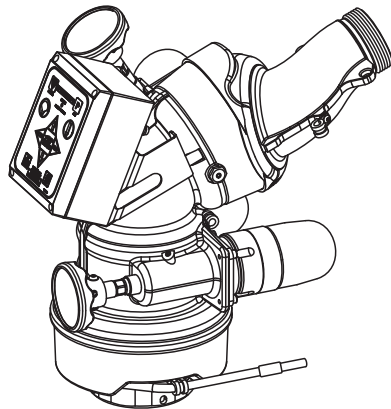

For Pumper Applications
\$7635.00
 Page 163

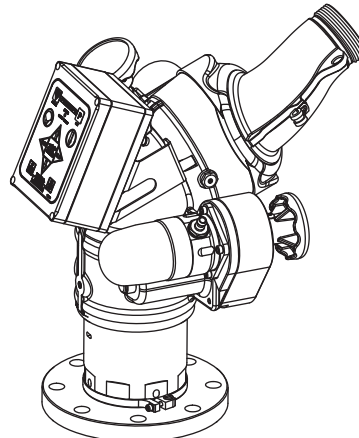

For Ladders
\$7635.00
 Page 164

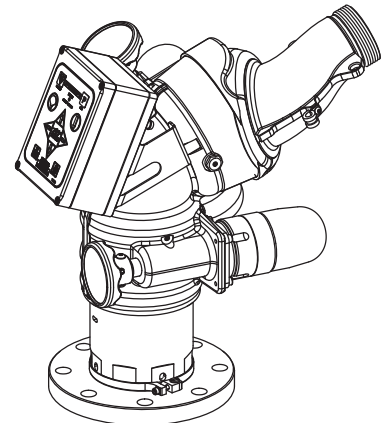

For Platforms
\$7635.00
 Page 164

CONTROLLER CHOICE



YE-RF-BT
 Tactile Touch Screen Controller
\$600.00 - Page 145



YE-BT1
 Bluetooth® Adapter
\$400.00 - Page 145



Y4E-RP-D
 Panel Mount Monitor Operator
 Station with Display
\$1260.00 - Page 174



Y4E-CT-30-D
 30' Tethered Monitor Operator
 Station with Display
\$1370.00 - Page 174

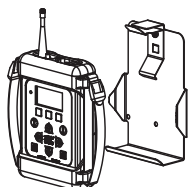

YE-RF-900-D
 Wireless Monitor Operator
 Station with Display
\$2245.00 - Page 175

For Non-Display Models See Page 174-177

NOZZLE CHOICE

\$2035.00
 Page 131

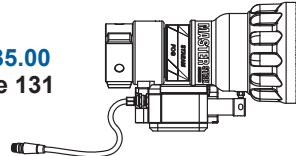

M-ERP1000-NJ — 2.5" NH
 100 psi Master Stream 1000
 Automatic Pressure
 150-1000 gpm Flow Range

\$2035.00
 Page 132

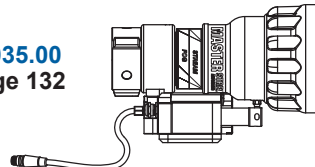

M-ERP1250SNJ — 2.5" NH
 100 psi Master Stream 1250
 Automatic Pressure
 300-1250 gpm Flow Range

\$2140.00
 Page 132

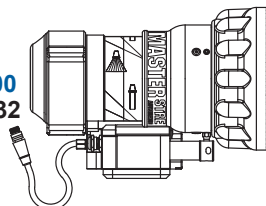

M-ERP1250NJ — 2.5" NH
 100 psi Master Stream 1250
 Automatic Pressure
 300-1250 gpm Flow Range

EXTEND-A-GUN RC3

XGA3*- (see chart)**
 12" or 18" Remote Controlled
 Telescoping Waterway
\$4310.00
 Page 140

Panel Mount RC
 Extend-A-Gun Oper-
 ator Station available
 separately, see page
 140.

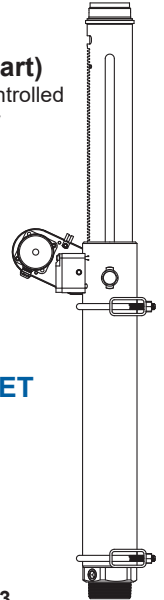

3" BRACKET SET CHOICE

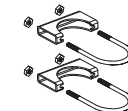

XGB-33
SADDLE/SADDLE
\$140.00
 Page 140

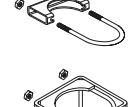

XGB-23
PLATE/SADDLE
\$155.00
 Page 140

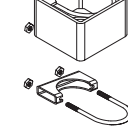

XGB-13
TUBE/SADDLE
\$170.00
 Page 140

Manually Controlled Monitor - Up To 2000 GPM

The Monsoon is a manually operated monitor designed for flows up to 2000 gpm (7600 l/min). Maximum operating pressure is 200 psi (14 bar). Unique patented segmented waterway has only 15 psi (1 bar) friction loss at 2000 gpm. Water makes very few turns as it travels through the monitor resulting in low friction loss and a far-reaching effective stream. Elevation range is 90 degrees above horizontal to 45 degrees below. Field changeable elevation travel stops at 45 degrees above, 30 degrees above, and 30 degrees below horizontal. The manual model has continuous horizontal rotation with field changeable stops at 45, 90 and 135 either side of a center position. Available with various inlet flanges and threaded fittings. Inlet also made for direct connection to TFT's Extend-A-Gun series and Valve Under Monitor series. Several outlet thread sizes are available. See chart on next page for model numbers. Main waterway made from hardcoat anodized ANSI 356-T6 aluminum.

Silver powder coat finish inside and out is standard, except when "- Z" is added to the end of the model number. Models ending in "- Z" have American Red powder coat finish and aluminum crank handles rather than polymer handwheels. Standard outlet is 3.5"NH (90 mm) male thread; other outlets available.

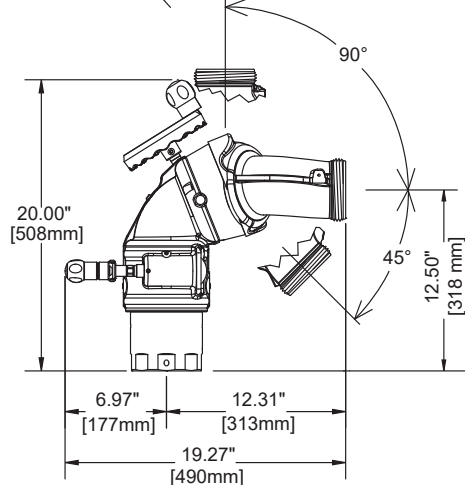
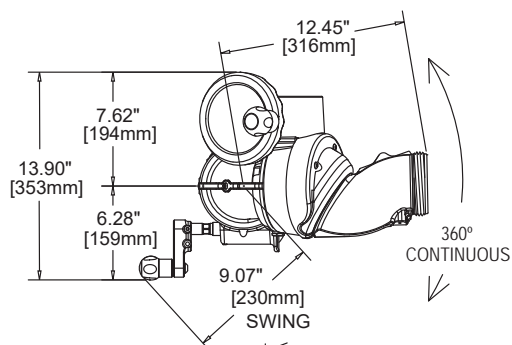

Y4-M11A
\$4030.00
25.0 lb (11.4 kg)

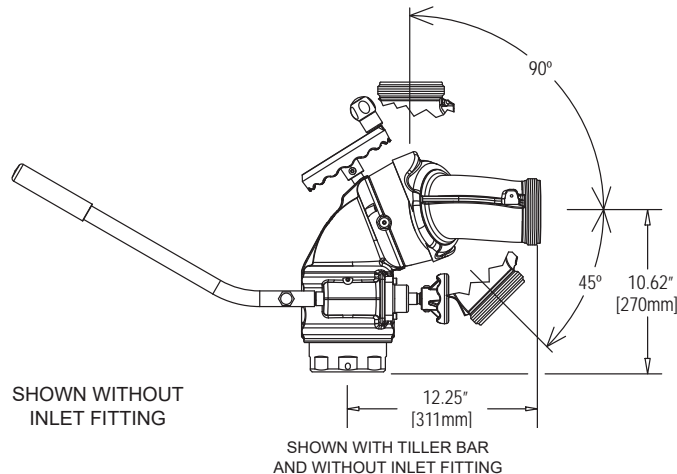
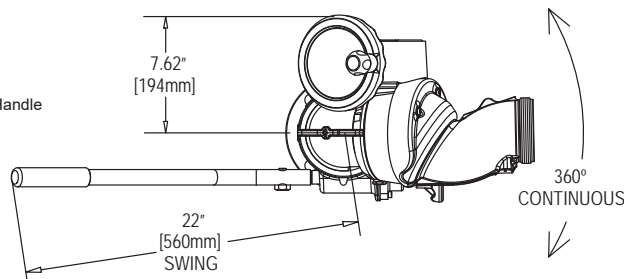

SAMPLE PART NUMBER
Specify Inlet and Outlet by
number from chart

Y4-T11A
\$4030.00
26.0 lb (11.8 kg)



When ordering a Monsoon monitor, choose one option from each category below. For example Model Y4-M21A is a manual aluminum monitor with 4" ANSI 150 flange inlet and 3.5" NH male threaded outlet. For assistance in ordering, please call 1-800-348-2686 and speak to a nozzle specialist. Flange Specifications are on page 218.

Y4-

Actuation	Inlet	Outlet	A
M) Manual	1) 3" ANSI 150	1) 3.5"-6 NH Male	Optional
T) Tiller	2) 4" ANSI 150	2) 3.5"-11 BSP Male	-Z) Industrial Model
	3) 6" ANSI 150	3) 3.5"-8 NPSH Male	with American Red
	4) DN80, PN16	4) 4.0"-11 BSP Male	powdered coat and
	5) DN100, PN16	9) Special	aluminum crank
	6) 3" NPT Female		handles
	7) 4" NPT Female		(omit for standard
	8) 3" BSP Male		silver models)
	9) 4" BSP Male		
	L) TFT CODE-RLF*		
	P) TFT CODE-RPF*		
	Q) 4.5"NH Quick Connect for VUM		
	R) 4.5"NH Quick Connect with 4" ANSI 150		
	S) 4.5"NH Quick Connect with 4" NPT female		
	T) 4.5"NH Quick Connect with CODE-RLF*		
	U) 4.5"NH Quick Connect with CODE-RPF**		
	W) Swivel Base for Booster OSC		
	X) TFT CODE-RRM***		

* TFT CODE-RLF fits Extend-A-Gun and Extend-A-Gun RC3

** TFT CODE-RPF fits Extend-A-Gun RC4, VUM and HUM

*** TFT Code-RRM fits 4" IVUM and OUM

Remote Controlled Deck Monitor - Up To 2000 GPM

Designed for Pumper Applications

The Monsoon RC for pumper installations is an electric remote controlled monitor that has all the benefits of the Monsoon monitor with the addition of powered operation. It has a greater horizontal sweep angle than the RC model for Ladder or Platform installations. Designed for 12 VDC or 24 VDC operation, selection is automatic. The Monsoon RC comes with a factory installed control panel mounted on the monitor for controlling horizontal rotation, elevation, nozzle pattern and programmable PARK and Oscillate. See page 174-177 for additional control stations. The motor control circuits are factory installed on the monitor and use position encoders and current limiting to protect the drive train at the ends of travel. Unit comes with 30 feet of ultra-flexing robotics cable already wired to the monitor so installation effort is minimized. Cable has only four conductors (two for power and two for communications), further easing the installation effort. Cable is enclosed in a unique wire guide that allows 450° of horizontal travel (225° either side of a center position), which is far more reliable than slip rings or coil cords. Knobs for manual override are provided on the horizontal rotation and elevation drive. TFT's Master ERP nozzles plugs into the factory installed nozzle power wire. Electric drives and control box are waterproof. Main waterway made from hardcoat anodized ANSI 356-T6 aluminum. Silver powder coat finish inside and out. Standard outlet is 3.5" NH (90 mm) rigid male thread. Other outlets are available. For wireless operation, purchase wireless operator station and radio/antenna on page 175.

All TFT RC monitors are capable of being controlled by a programmable logic controller with full three-axis position control & feedback using the Allen Bradley EtherNet/IP protocol. Contact factory for details.

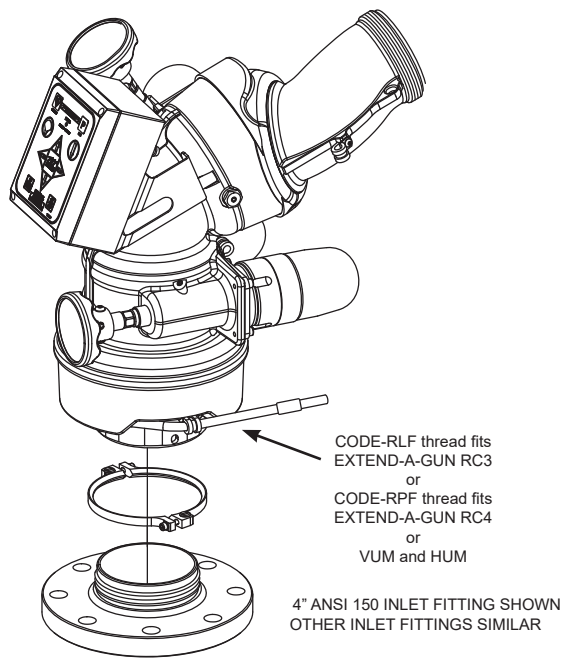

Y4-E11A
\$8825.00
37.0 lb (16.8 kg)



SAMPLE PART NUMBER
Specify Inlet and Outlet by
number from chart

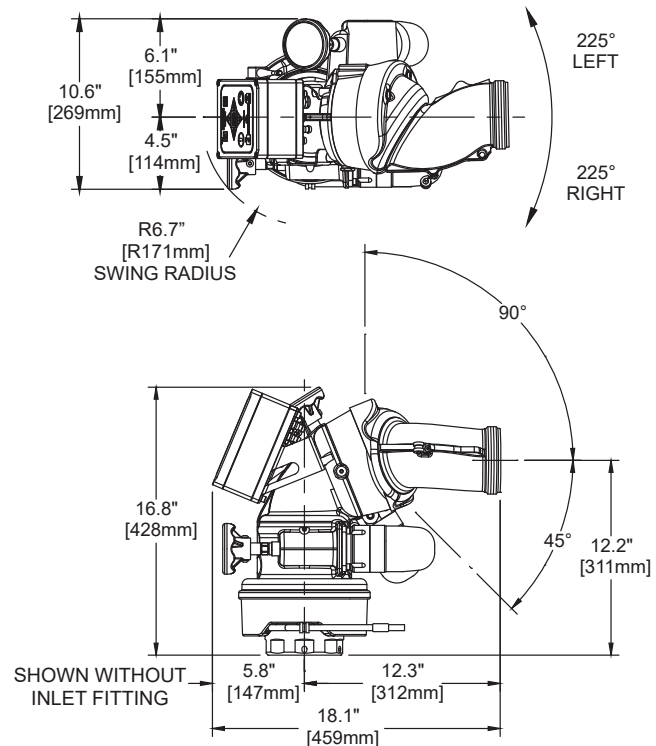

When ordering a Monsoon monitor, choose one option from each category below. For example Model Y4-E21A is a manual aluminum monitor with 4" ANSI 150 flange inlet and 3.5" NH male threaded outlet. For assistance in ordering, please call 1-800-348-2686 and speak to a nozzle specialist. Flange Specifications are on page 218.

Y4-

				A	
Actuation E) Electric	Inlet 1) 3" ANSI 150 2) 4" ANSI 150 3) 6" ANSI 150 4) DN80, PN16 5) DN100, PN16 6) 3" NPT Female 7) 4" NPT Female 8) 3" BSP Male 9) 4" BSP Male	L) TFT CODE-RLF for Extend-A-Gun RC3 N) TFT CODE-RPF for VUM and HUM P) TFT CODE-RPF Extend-A-Gun RC4 Q) 4.5"NH Quick Connect for VUM + R) 4.5"NH Quick Connect with 4" ANSI 150 + S) 4.5"NH Quick Connect with 4" NPT female + T) 4.5"NH Quick Connect with CODE-RLF* + U) 4.5"NH Quick Connect with CODE-RPF** + X) TFT CODE-RRMfits 4" IVUM and OUM +	Outlet 1) 3.5"-6 NH Male 2) 3.5"-11 BSP Male 3) 3.5"-8 NPSH Male 4) 4.0"-11 BSP Male 9) Special		Optional -Z) Industrial Model with American Red powdered coat (omit for standard silver models)

* TFT CODE-RLF fits Extend-A-Gun and Extend-A-Gun RC3

** TFT CODE-RPF fits Extend-A-Gun RC4, VUM and HUM

+ Horizontal Axis Travel Limited to $\pm 135^\circ$

Remote Controlled High Clearance Monitor - Up To 2000 GPM

Designed For Ladder and Platform Applications

The Monsoon RC for Ladder or Platform installations is similar to the standard Monsoon RC. This model of Monsoon RC has the control box mounted at the top to give a reduced swing radius, thereby giving more clearance for Ladder Truck or Platform Installations. Knobs for manual override are provided on the horizontal rotation and elevation drive. Also comes with factory installed travel stops to limit the horizontal travel to 180 degrees (90 degrees either side of a center position). Ladder and Platform models include an electronics enclosure and 10' of cable to connect signals from the primary control station (such as the turntable toggle switches). These signals can either be hard wired or from a Canbus output module output. The Platform model's electronics enclosure contains an additional 10' cable to connect signals from a secondary control station (such as from basket toggle switches). The primary control signals will always override any signals from the secondary control or the monitor operator station. The electronics enclosure is factory configured to accept +12/24 VDC signals, but can be reconfigured in field to accept ground signals. This electronics enclosure also includes a relay to indicate when the monitor is in PARK position and has contacts that can be connected into the Canbus or multiplex system. A monitor mounted control panel allows vertical, horizontal nozzle pattern adjustments and programmable PARK and Oscillate. RC Monitor delivered with wireless antenna installed. For wireless operation, purchase wireless operator station package on page 175.

Ladder/platform electronics enclosures includes inputs for DEPLOY monitor, INHIBIT monitor

All TFT RC monitors are capable of being controlled by a programmable logic controller with full three-axis position control & feedback using the Allen Bradley EtherNet/IP protocol. Contact factory for details.

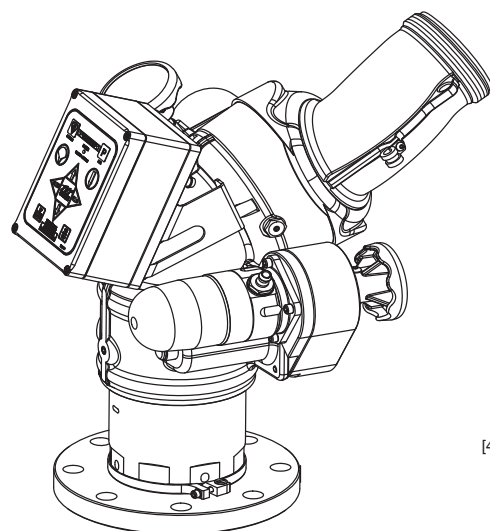

4" ANSI 150 INLET FITTING SHOWN
OTHER INLET FITTINGS SIMILAR

Y4-E21A-L
\$8825.00
37.0 lb (16.8 kg)



SAMPLE PART NUMBER
Specify Inlet and Outlet by
number from chart

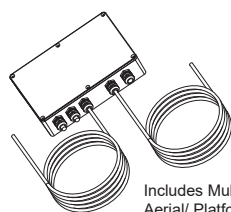

Includes Multipoint
Aerial/ Platform Interface

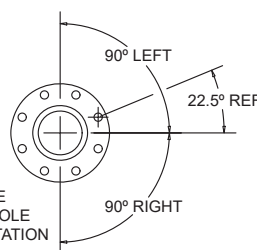

FLANGE
BOLT HOLE
ORIENTATION

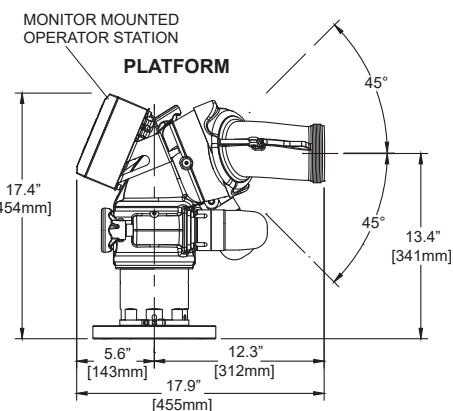
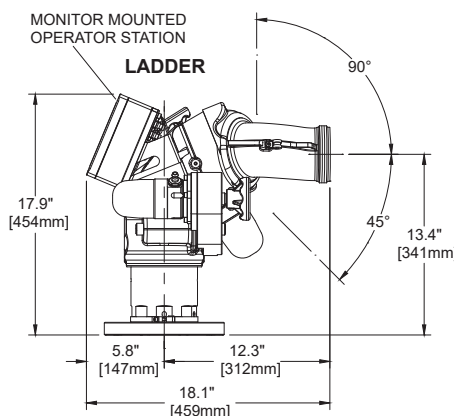
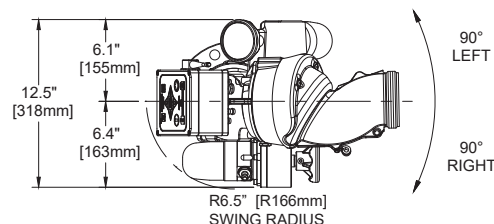

Y4-E

Inlet	Outlet
1) 3" ANSI 150	L) TFT CODE-RLF*
2) 4" ANSI 150	P) TFT CODE-RPF**
3) 6" ANSI 150	Q) 4.5"NH Quick Connect for VUM +
4) DN80, PN16	R) 4.5"NH Quick Connect with 4" ANSI 150 +
5) DN100, PN16	S) 4.5"NH Quick Connect with 4" NPT female +
6) 3" NPT Female	T) 4.5"NH Quick Connect with CODE-RLF* +
7) 4" NPT Female	U) 4.5"NH Quick Connect with CODE-RPF* +
8) 3" BSP Male	X) TFT CODE-RRM fits 4" IVUM and OUM +
9) 4" BSP Male	

* TFT CODE-RLF fits Extend-A-Gun and Extend-A-Gun RC

** TFT CODE-RPF fits Extend-A-Gun RC4, VUM and HUM

+ Horizontal Axis Travel Limited to $\pm 135^\circ$

A

Configuration
-L) Ladder
-P) Platform

Example: Y4-E21A-L is an electric aluminum monitor for ladders with a 4" ANSI 150 flange inlet and 3-1/2" NH male threaded outlet.

Monsoon RC 2000 GPM Package Suggested Options

Rated to 2000 gpm, 200 psi, the Monsoon RC is a remotely controlled fixed station or truck mounted monitor with electric remote control of rotation, elevation angle and nozzle pattern. The unit has an electrically operated elevation control from 90° above and 45° below horizontal through a segmented waterway with minimal waterway turning angles and built-in stream shaping vane. The unit has an electrically operated 450° horizontal rotational travel, stainless steel worm gear, and user installed travel limit stops. User operation controls are mounted on the monitor, and include rotation, elevation, nozzle stream pattern control, and Park & Oscillate. Optional remote wired, tethered and wireless remote controls are available. The monitor is hardcoat anodized aluminum alloy with a silver powder coat finish inside and out.

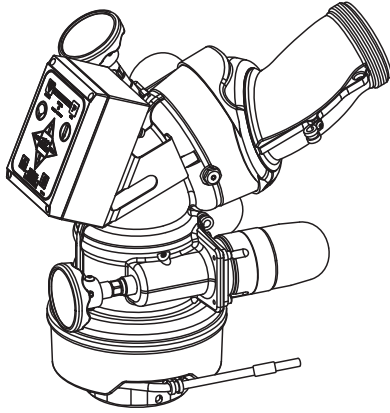

For Pumper Applications
\$8825.00
 Page 167

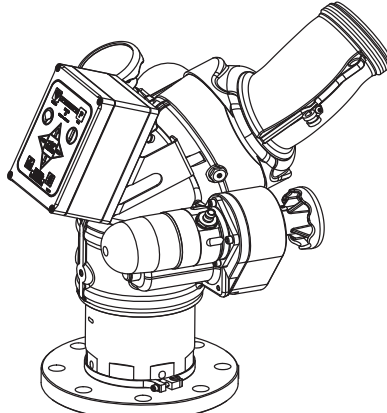

For Ladders
\$8825.00
 Page 168

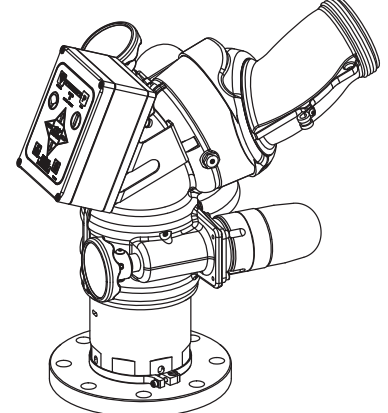

For Platforms
\$8825.00
 Page 168

CONTROLLER CHOICE



YE-RF-BT
 Tactile Touch Screen Controller
\$600.00 - Page 145



YE-BT1
 Bluetooth® Adapter
\$400.00 - Page 145



Y4E-RP-D
 Panel Mount Monitor Operator
 Station with Display
\$1260.00 - Page 174

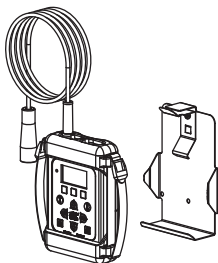

Y4E-CT-30-D
 30' Tethered Monitor Operator
 Station with Display
\$1370.00 - Page 174

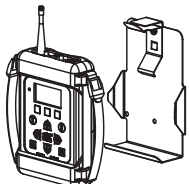

YE-RF-900-D
 Wireless Monitor Operator
 Station with Display
\$2245.00 - Page 175

For Non-Display Models See Pages 174-177

NOZZLE CHOICE

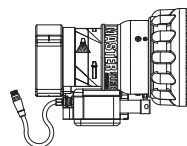

\$2140.00
 Page 132

M-ERP1250-NN — 3.5"NH
 100 psi Masterstream 1250
 Automatic Pressure
 150-1250 gpm Flow Range

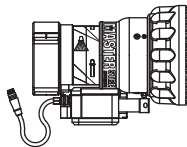

\$2140.00
 Page 135

M-ERP1500-NN — 3.5"NH
 70-120 psi Master Stream 1500
 Automatic Pressure
 300-1500 gpm Flow Range

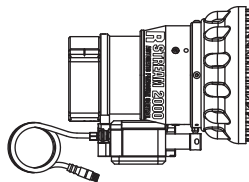

\$2850.00
 Page 136

M-ERP2000-NN — 3.5"NH
 80-120 psi Master Stream 2000
 Automatic Pressure
 300-2000 gpm Flow Range

EXTEND-A-GUN RC4

XGA48- (see chart)**
 18" Remote Controlled
 Telescoping Waterway
\$5050.00
 Page 141

Panel Mount RC
 Extend-A-Gun Oper-
 ator Station available
 separately, see page
 175.

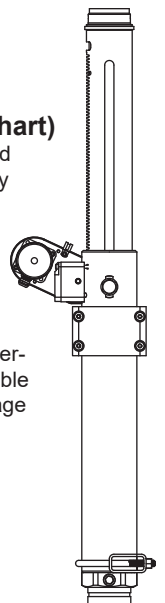

BRACKET CHOICE

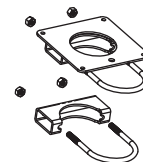

**XGB-43
 PLATE/SADDLE**
\$170.00
 Page 141

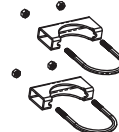

**XGB-53
 SADDLE/SADDLE**
\$155.00
 Page 141

The Tsunami monitor is capable of flowing 8000 gpm (30000 l/min). Waterway with turning vane has only 27 psi (1.9 bar) friction loss at 8000 gpm (30000 l/min). Elevation range is 90° above horizontal to 10° below. Field changeable elevation travel stops. Horizontal travel is 320° (160° either side of a center position). Field changeable horizontal travel stops. Dual handwheels are provided for horizontal rotation and elevation drive. Main waterway made from hardcoat anodized ANSI 356-T6 aluminum. Silver powder coat finish inside and out.

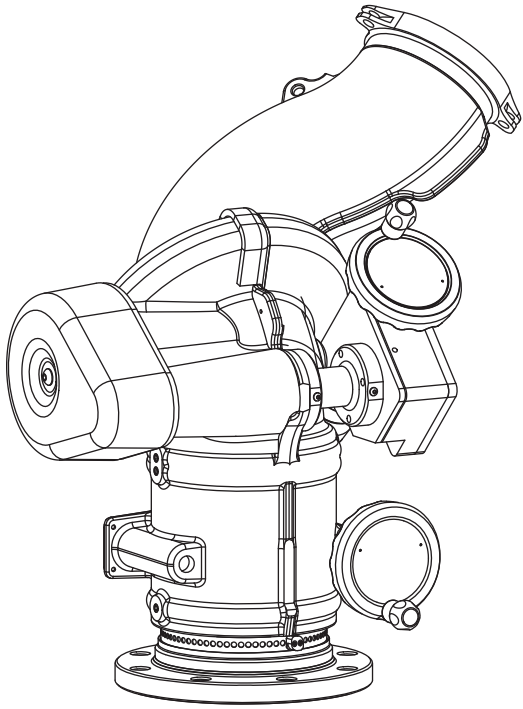

Y8-M11A
\$46000.00
 138.0 lb (62.6 kg)
 Inlet is 8" ANSI 150
 Outlet is Quick Connect

