

# Capture<sup>®</sup> System >





## Capture Functionality.

With a clean, refined design the Capture™ System embodies ease and performance for today's work environment. You'll appreciate its smart design and thoughtful details that deliver greater efficiency. Details like Slatwall Work Tools to keep your desktop clear. Smart options like Marker Board Tiles and Top-Mounted, Dual-Sided Storage do double-duty to make the most of your space. From strong, beautiful trim to crisp refined tiles, to efficient storage options, Capture delivers on all fronts.





# Capture User Needs.

Capture meets the real needs of users today. Exceptionally easy to install, design, and reconfigure, Capture offers extensive solutions for a broad range of workstations. Access power at work surface level or base raceway. Select Glass Stackers that let the daylight in and offer user views. Choose from many steel and laminate storage options designed to integrate beautifully with the system. And when your needs change, reconfigure Capture quickly and easily.

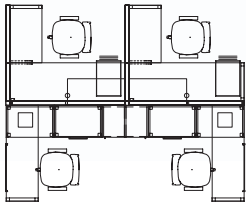

# Capture Collaboration and Concentration.

Capture includes lower panel and storage heights to maximize daylight, views and visual access to team members. Glazing options and frameless screens provide the amount of transparency you need while maintaining a sense of privacy. Laminate tiles afford an upscale aesthetic that's easy to maintain and blends beautifully with Trendway's entire product line.

When greater concentration is desired, Capture's broad range of panel types and sizes makes it just as easy to design semi-private spaces that meet any user's needs. Capture lets you create a range of spaces — for both collaboration and concentration.

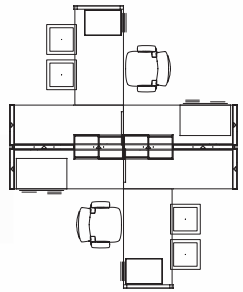
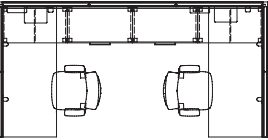



# Capture Reception.

Set the tone of elegance and sophistication with a beautiful Capture Reception Station.

## Capture the Details.

Capture's generous range of design options lets you create solutions to support every user's requirements and work style. You can even create a new look quickly, without tools — Capture Tiles install in seconds.



Aluminum trim reflects a clean and streamlined aesthetic.



Tiles easily and firmly click into position — no tools required.



Top mounted, dual-sided storage brings efficiency to planning while easily meeting user needs and budget requirements.

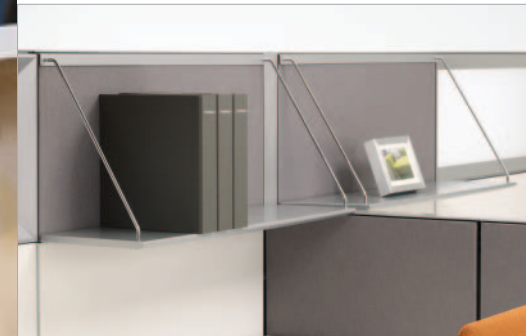

Hanging shelves provide extra storage with a minimalist approach.



Channel-mounted Frameless Glass Screens offer a feeling of privacy without blocking daylight. Screens can span panels for a clean, seamless look. Marker Board Tiles allow vertical surfaces to work harder.



Steel Tile options add great function for users, while offering exceptional durability.



Slatwall and Work Tools get clutter off the work surface and give users more choices. Available in Smoke (shown) or Frost.



Power and data location options make it easy to meet the needs of users on the go! Choose from Beltline or Base Raceway routing and access.



Leg options provide a light, open alternative to end panels.

# Capture Easy Installation!

The Capture system is engineered for fast and easy installations and reconfigurations. Possibly the fastest-to-assemble system on the market, Capture brings quality construction together for a beautiful office in a matter of minutes. Whether it's the first installation or the fourth reconfiguration, the Capture system maintains its design integrity and comes together quickly. That means less downtime for your teams and more up time to get things done. Capture easy installation for yourself!

## Capture Ideas.



Capture options.



Capture storage.



Capture warmth.



Capture teamwork.

Visit [Trendway.com/CaptureIdeas](http://Trendway.com/CaptureIdeas) to see more possibilities.



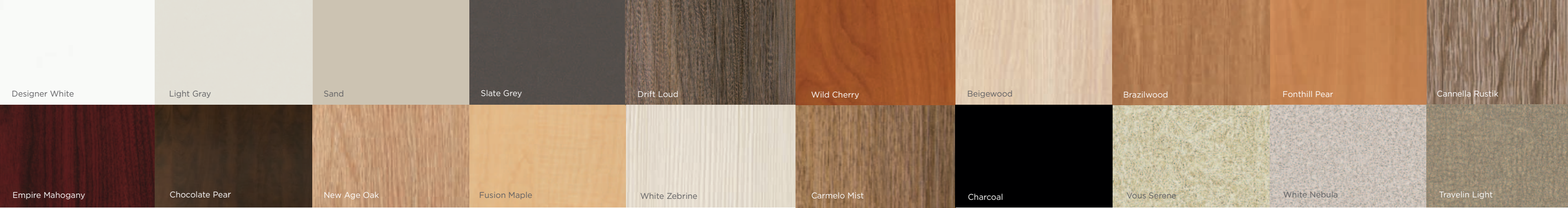

^ LAMINATES - More than 200 HPL colors available.

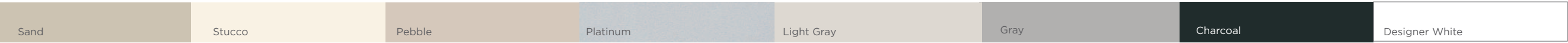

< TRIM COLORS

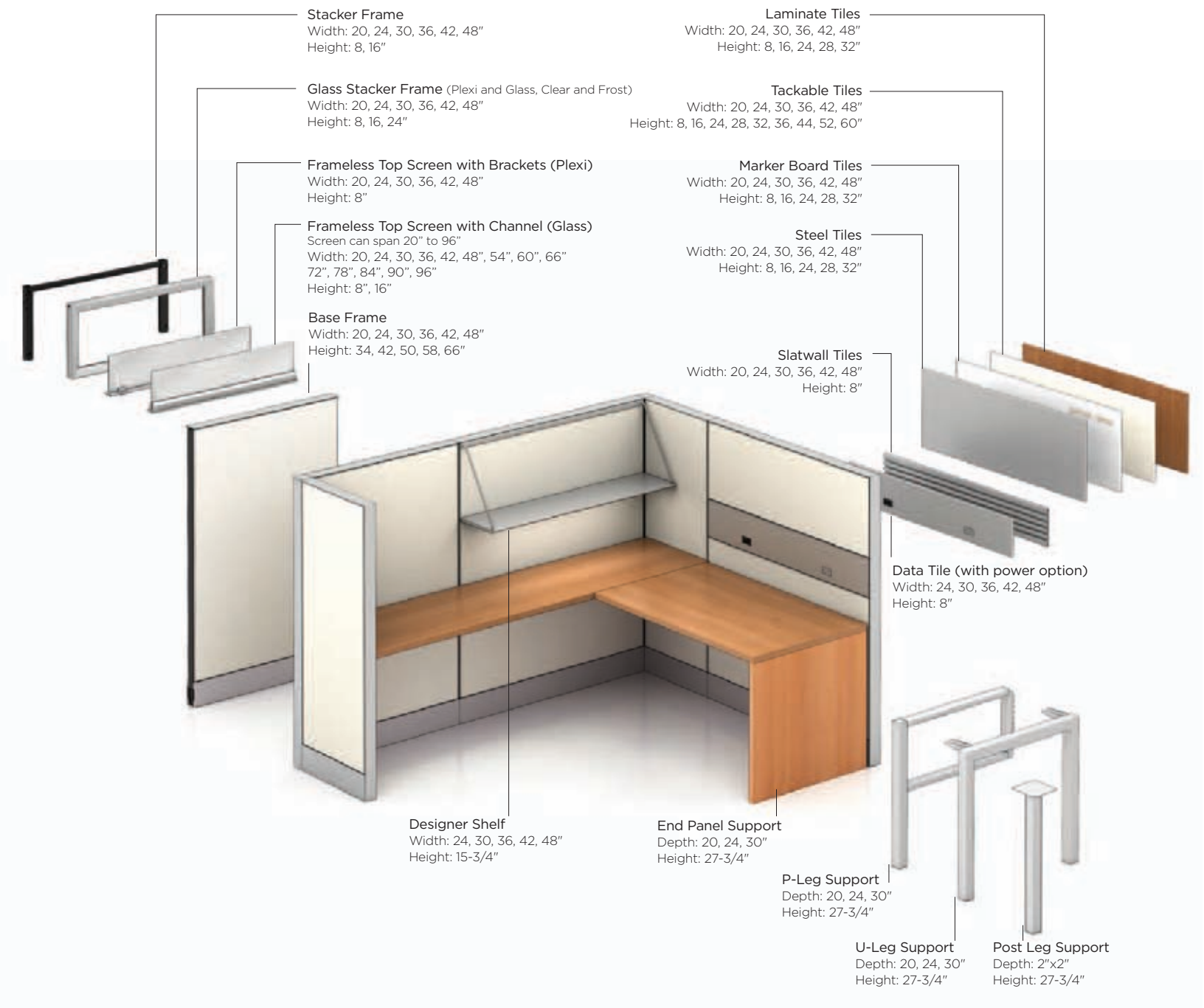

^ PULLS



^ FILING + STORAGE

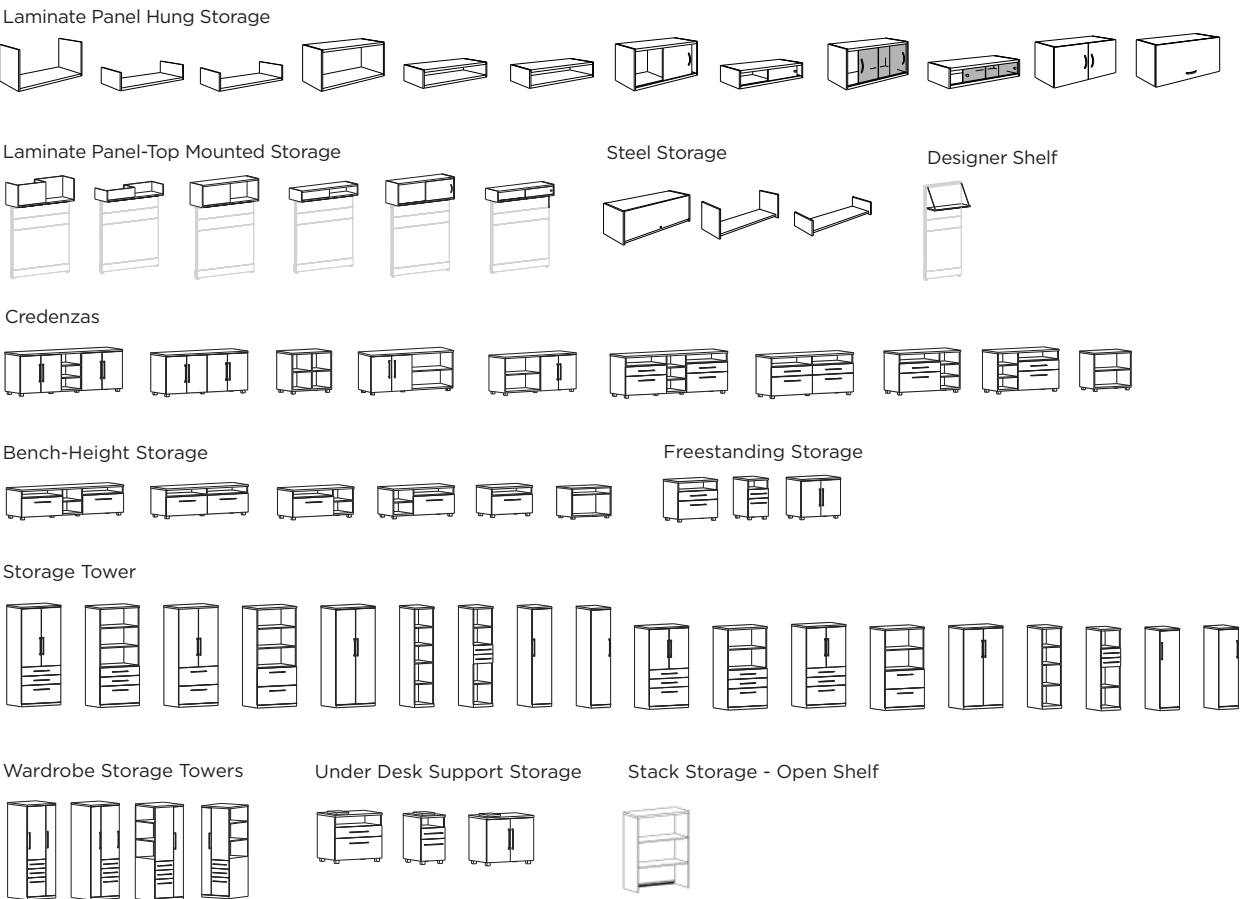

All Pack™ Steel Storage can be specified with Capture.



HEADQUARTERS | Holland, Michigan | 800.968.5344 | [Trendway.com](http://Trendway.com)

ATLANTA | CHICAGO | DALLAS | INDIANAPOLIS | LOS ANGELES | WASHINGTON, DC

November 2014 | PRI-110A | Proudly printed in the USA on SFI certified paper

Trendway is a Veteran/Employee Owned Company and a Federal Government Contractor.

Trendway is a Zero Waste to Landfill operation.

Visit [Trendway.com/scs](http://Trendway.com/scs) to view SCS Indoor Advantage certificates for specific Trendway products.

