

WORKSURFACES System

PRICE LIST

JULY 2023

PRODUCT INFORMATION

UNIVERSAL WORKSURFACES

Rectangular	2
Rectangular with cutout	4
Corner round front 120°	5
Corner straight front 90°	5
Corner round front 90°	5
Extended corner round front	6
Rectangular 45° edge cut	7
Peninsula straight end	8
Peninsula D end	8
Peninsula D extended	9
Quarter circle 90°	10
For curved panel	10
Half moon	10
Transaction countertop	11
Transaction countertop 120°	12

UNIVERSAL WORKSURFACES WITH GROMMETS

Rectangular	13
Rectangular with cutout	15
Corner round front 120°	16
Corner straight front 90°	16
Corner round front 90°	16
Extended corner round front	17
Rectangular 45° edge cut	18
Peninsula straight end	19
Peninsula D end	19
Peninsula D extended	20

TABLE TOP SURFACES

Half circle	21
-------------------	----

TABLE TOP FOR LATRAL FILE

Curved	21
--------------	----

PRODUCT DETAILS

GRADE A LAMINATES

Name	Code
Frosty	A01
Cambridge Walnut	10C
Glacial Ash	16N
Hickory Frida	9AR
Natural Grey	U12
Black	231
Light Elm	04R
Black Oak	75V
Colorado Oak	97V
Eternity Oak	4AE
Grey Oak	91B
Sinatra Oak	20N
Wheat Oak	42B

GRADE B LAMINATES

Name	Code
Carvalho Cinza	7935-58
Celeste Noce	1049-58
Ciocolata	7927-58
Dove Grey	2207-58
Maple	7902-58
Russet Linosa	1042-58
Titan	3737-58
Ultra Black	0015-58
Ultra White	0100-58
Ultragrey	0055-58
Weathered Ash	8842-58
White Ash	8841-58

GRADE C LAMINATES

Name	Code
Aged Ash	8844-58
Smoky Brown	5488-58
Black Riftwood	6414-58
Silver Riftwood	6413-58
Bleached Legno	8845-58
Natura Ash	8843-58

WORKSURFACES-System

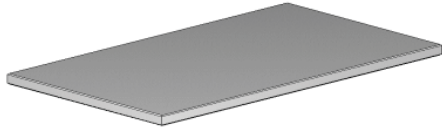

Rectangular

Description

High preassure laminate with PVC square edge, hangs from panel or wall strips.
Includes attachment hardware in Black finish.

24" Deep	Product No.	Width	A	B	C
	TWRS2424	24"	294	327	344
	TWRS3024	30"	314	349	396
	TWRS3624	36"	372	413	464
	TWRS4224	42"	397	441	503
	TWRS4824	48"	421	468	512
	TWRS5124	51"	468	520	640
	TWRS5224	51.5"	468	520	640
	TWRS5424	54"	488	542	640
	TWRS6024	60"	534	593	651
	TWRS6324	63"	554	615	761
	TWRS6424	63.5"	554	615	761
	TWRS6624	66"	562	625	761
	TWRS7224	72"	620	689	774
	TWRS7524	75"	642	713	722
	TWRS7624	75.5"	642	713	867
	TWRS7824	78"	670	744	847
	TWRS8424	84"	695	772	855
	TWRS9624	96"	832	925	1000
30" Deep					
	TWRS2430	24"	313	341	365
	TWRS3030	30"	480	537	582
	TWRS3630	36"	487	554	599
	TWRS4230	42"	494	550	595
	TWRS4830	48"	671	756	825
	TWRS5130	51"	762	873	955
	TWRS5230	51.5"	858	975	1070
	TWRS5430	54"	858	975	1070
	TWRS6030	60"	865	983	1077
	TWRS6330	63"	942	1072	1177
	TWRS6430	63.5"	942	1072	1177
	TWRS6630	66"	942	1072	1177
	TWRS7230	72"	993	1131	1241
	TWRS7530	75"	997	1145	1256
	TWRS7630	75.5"	997	1146	1256
	TWRS7830	78"	1116	1273	1399
	TWRS8430	84"	1231	1296	1516
	TWRS9630	96"	1240	1306	1528
36" Deep					
	TWRS6036	60"	952	1002	1172
	TWRS6636	66"	1040	1095	1281
	TWRS7236	72"	1086	1143	1337
42" Deep					
	TWRS4842	48"	689	725	848
	TWRS6042	60"	956	1007	1178
	TWRS7242	72"	1230	1295	1515
	TWRS9642	96"	1251	1317	1541
48" Deep					
	TWRS4848	48"	693	729	853
	TWRS6048	60"	961	1012	1184
	TWRS7248	72"	1230	1295	1515
	TWRS9648	96"	1250	1316	1539

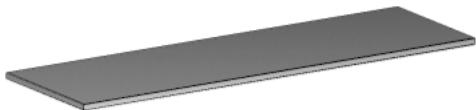

Rectangular return

Description
High preassure laminate with PVC square edge, hangs from panel or wall strips.
Includes attachment hardware in Black finish.

24" Deep	Product No.	Width	A	B	C
	TWRS2418	24"	277	308	381
	TWRS3018	30"	302	336	390
	TWRS3618	36"	392	413	483
	TWRS4218	42"	400	421	493
	TWRS4818	48"	498	525	614

WORKSURFACES-System

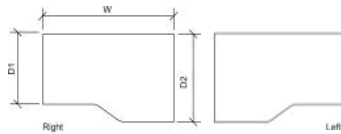

Rectangular worksurface with cutout

Description

High pressure laminate with PVC square edge, hangs from panel or wall strips.
Cutout is for easy access to the worksurface corner.
Includes attachment hardware in Black finish.

24"		Product No.	W	D1	D2	A	B	C
Right		TWRC3600	36"	24"	30"	634	668	781
		TWRC4200	42"	24"	30"	706	744	870
		TWRC4800	48"	24"	30"	712	749	876
		TWRC5400	54"	24"	30"	998	1051	1229
		TWRC6000	60"	24"	30"	1036	1090	1275
		TWRC6600	66"	24"	30"	1131	1190	1393
		TWRC7200	72"	24"	30"	1188	1251	1463
		TWRC7800	78"	24"	30"	1327	1397	1634
Left		TWRD3600	36"	24"	30"	634	668	781
		TWRD4200	42"	24"	30"	702	739	865
		TWRD4800	48"	24"	30"	711	748	875
		TWRD5400	54"	24"	30"	998	1051	1229
		TWRD6000	60"	24"	30"	1038	1092	1278
		TWRD6600	66"	24"	30"	1133	1192	1395
		TWRD7200	72"	24"	30"	1186	1249	1461
		TWRD7800	78"	24"	30"	1327	1397	1634

WORKSURFACES-System

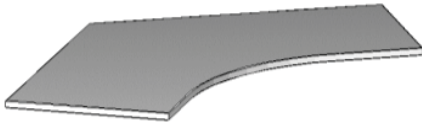

Corner workspace

Description

High preassure laminate with PVC square edge, hangs from panel or wall strips.
Cutout is for easy access to the workspace corner.
Includes attachment hardware in Black finish.

Round front, 120°		Product No.	W1	W2	Deep	A	B	C
Ms		VWCB3624	36"	36"	24"	1203	1266	1481
		VWCB4224	42"	42"	24"	1370	1442	1687
		VWCB4824	48"	48"	24"	1379	1452	1699
Link		TWCB3624	36"	36"	30"	1203	1266	1481
		TWCB4224	42"	42"	30"	1370	1442	1687
		TWCB4824	48"	48"	30"	1379	1452	1699



Straight front, 90°		Product No.	W1	W2	Deep	A	B	C
24"		TWCS3624	36"	36"	24"	570	634	660
		TWCS4224	42"	42"	24"	625	695	816
		TWCS4824	48"	48"	24"	686	763	864
30"		TWCS3630	36"	36"	30"	694	771	734
		TWCS4230	42"	42"	30"	786	845	885
		TWCS4830	48"	48"	30"	794	883	934



Round front, 90°		Product No.	W1	W2	Deep	A	B	C
24"		TWCR3624	36"	36"	24"	570	634	660
		TWCR4224	42"	42"	24"	625	695	816
		TWCR4824	48"	48"	24"	686	763	864
30"		TWCR4230	42"	42"	30"	786	845	885
		TWCR4830	48"	48"	30"	794	883	934

Round front, 90°		Product No.	W1	W2	Deep	A	B	C
24"		TWCR362418R	36"	36"	24"	536	564	660
		TWCR362418L	42"	42"	24"	536	564	660

WORKSURFACES-System

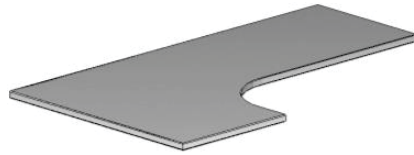

Extended corner worksurface

Description

Crystal tempered top section.

Structural panel frame, painted top cap, leveling glides.

Connectors, raceway cover and finished ends must be ordered separately.

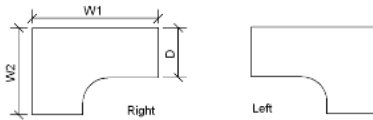

36"	Product No.	W	W2	D	A	B	C
Right	TWCE6036	60"	36"	24"	902	1002	1209
	TWCE6636	66"	36"	24"	1048	1103	1291
	TWCE7236	72"	36"	24"	1084	1141	1335
	TWCE7836	78"	36"	24"	1105	1163	1360
	TWCE8436	84"	36"	24"	1238	1304	1525
Left	TWCF6036	60"	36"	24"	902	1002	1209
	TWCF6636	66"	36"	24"	1048	1103	1291
	TWCF7236	72"	36"	24"	1099	1157	1354
	TWCF7836	78"	36"	24"	1105	1163	1360
	TWCF8436	84"	36"	24"	1238	1304	1525

42"	Product No.	W	W2	D	A	B	C
Right	TWCE6042	60"	42"	24"	998	1051	1229
	TWCE6642	66"	42"	24"	1138	1198	1402
	TWCE7242	72"	42"	24"	1193	1256	1470
	TWCE7842	78"	42"	24"	1293	1361	1592
	TWCE8442	84"	42"	24"	1345	1416	1656
Left	TWCF6042	60"	42"	24"	998	1051	1229
	TWCF6642	66"	42"	24"	1138	1198	1402
	TWCF7242	72"	42"	24"	1193	1256	1470
	TWCF7842	78"	42"	24"	1293	1361	1592
	TWCF8442	84"	42"	24"	1345	1416	1656

48"	Product No.	W	W2	D	A	B	C
Right	TWCE6048	60"	48"	24"	988	1040	1216
	TWCE6648	66"	48"	24"	1152	1212	1418
	TWCE7248	72"	48"	24"	1207	1271	1486
	TWCE7848	78"	48"	24"	1306	1375	1609
	TWCE8448	84"	48"	24"	1359	1430	1673
Left	TWCF6048	60"	48"	24"	988	1040	1216
	TWCF6648	66"	48"	24"	1152	1212	1418
	TWCF7248	72"	48"	24"	1207	1271	1486
	TWCF7848	78"	48"	24"	1306	1375	1609
	TWCF8448	84"	48"	24"	1359	1430	1673

WORKSURFACES-System



Rectangular worksurface with 45° edge cutout

Description

High pressure laminate with PVC square edge, hangs from panel or wall strips. Includes attachment hardware in Black finish. Order base separately.

Extended corner, round frc	Product No.	Width	Deep	A	B	C
Right	TWRK4824	48"	24"	463	487	570
	TWRK5424	54"	24"	650	684	801
	TWRK6024	60"	24"	693	729	853
	TWRK6624	66"	24"	722	760	889
	TWRK7224	72"	24"	752	792	927
	TWRK7824	78"	24"	826	869	1017
	TWRK8424	84"	24"	836	880	1030
Left	TWRK9624	96"	24"	847	892	1044
	TWRL4824	48"	24"	463	487	570
	TWRL5424	54"	24"	650	684	801
	TWRL6024	60"	24"	693	729	853
	TWRL6624	66"	24"	722	760	889
	TWRL7224	72"	24"	752	792	927
	TWRL7824	78"	24"	831	875	1023
	TWRL8424	84"	24"	836	880	1030
	TWRL9624	96"	24"	847	892	1044

WORKSURFACES-System

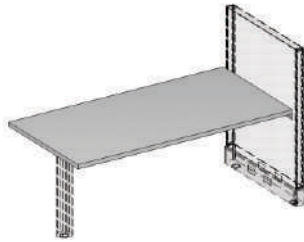

Peninsula worksurface

Description

High pressure laminate with PVC square edge, hangs from panel or wall strips.
Includes attachment hardware in Black finish. Order base separately.

Peninsula, straight end	Product No.	Width	Deep	A	B	C
24"	TWPS6024	60"	24"	654	689	806
	TWPS6624	66"	24"	753	793	928
	TWPS7224	72"	24"	789	831	972
30"	TWPS6030	60"	30"	903	950	1112
	TWPS6630	66"	30"	991	1043	1220
	TWPS7230	72"	30"	1044	1099	1286
	TWPS7830	78"	30"	1296	1364	1596
	TWPS8430	84"	30"	1301	1370	1602

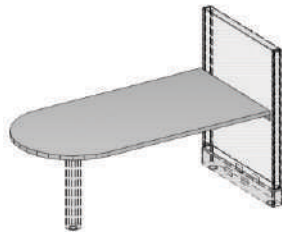

D end	Product No.	Width	Deep	A	B	C
24"	TWPR6024	60"	24"	654	689	806
	TWPR6624	66"	24"	794	836	978
	TWPR7224	72"	24"	833	877	1026
	TWPR7824	72"	24"	933	982	1149
	TWPR8424	84"	24"	941	990	1158
30"	TWPR6030	60"	30"	943	992	1161
	TWPR6630	66"	30"	1038	1092	1278
	TWPR7230	72"	30"	1044	1099	1286
	TWPR7830	78"	30"	1296	1364	1596
	TWPR8430	84"	30"	1301	1370	1602
36"	TWPR7236	84"	30"	1184	1246	1458
				#N/A	#N/A	#N/A

WORKSURFACES-System

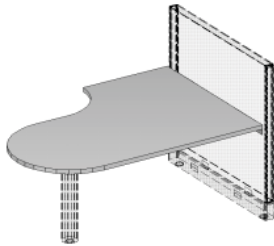

Peninsula workspace

Description

High pressure laminate with PVC square edge, hangs from panel or wall strips.
Includes attachment hardware in Black finish. Order base separately.

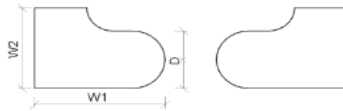

D end extended		Product No.	W1	W2	D	A	B	C
42"	Right	TWPE6042	60"	42"	30"	1067	1123	1314
		TWPE6642	66"	42"	30"	1294	1362	1593
		TWPE7242	72"	42"	30"	1363	1434	1678
		TWPE7842	78"	42"	30"	1538	1619	1894
		TWPE8442	84"	42"	30"	1548	1629	1906
	Left	TWPF6042	60"	42"	30"	1067	1123	1314
		TWPF6642	66"	42"	30"	1294	1362	1593
		TWPF7242	72"	42"	30"	1363	1434	1678
		TWPF7842	78"	42"	30"	1538	1619	1894
		TWPF8442	84"	42"	30"	1548	1629	1906
48"	Right	TWPE6048	60"	48"	30"	1183	1245	1457
		TWPE6648	66"	48"	30"	1300	1368	1601
		TWPE7248	72"	48"	30"	1369	1441	1686
		TWPE7848	78"	48"	30"	1548	1629	1906
		TWPE8448	84"	48"	30"	1552	1634	1911
	Left	TWPF6048	60"	48"	30"	1183	1245	1457
		TWPF6648	66"	48"	30"	1300	1368	1601
		TWPF7248	72"	48"	30"	1369	1441	1686
		TWPF7848	78"	48"	30"	1548	1629	1906
		TWPF8448	84"	48"	30"	1552	1634	1911

WORKSURFACES-System

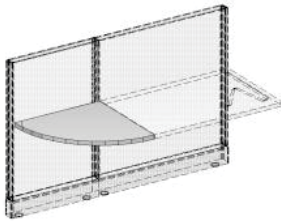

Radiused worksurfaces

Description

High preassure laminate with PVC square edge, hangs from panel or wall strips.
Includes attachment hardware in Black finish.
Order base separately.

Interior	Product No.	Width	Deep	A	B	C
	TWQR2424	24"	24"	249	262	306
	TWQR3030	30"	30"	488	514	601
	TWQR3024	30"	24"	483	508	595
	TWQL3024	30"	24"	483	508	595

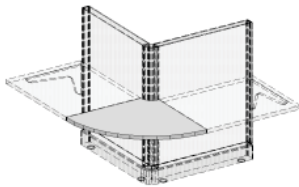

Exterior	Product No.	Width	Deep	A	B	C
	60° VWQW2424	24"	24"	237	250	292
	90° VWQR2424	30"	30"	237	250	292
	Ms VWQR3030	30"	24"	466	490	574
	60° TWQW2424	30"	24"	249	262	306
	90° TWQX2424	24"	24"	249	262	306



For curved panel	Product No.	Width	Deep	A	B	C
	TWQC2424	24"	24"	250	263	308

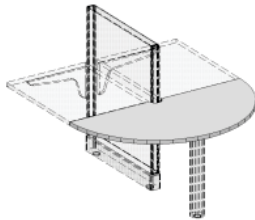

Half moon	Product No.	Width	Deep	A	B	C
Link	TWHR5124L	51"	24"	1058	1114	1303
	TWHR6330L	63"	30"	1285	1352	1582
Ms	VWHR5124	51"	24"	1058	1114	1303
	VWHR6330	63"	30"	1285	1352	1582

WORKSURFACES-System



Transaction countertops

Description

High pressure laminate with PVC square edge, hangs from panel or wall strips.
Includes attachment hardware in Black finish.
Order base separately.

Rectangular	Product No.	Width	Deep	A	B	C
	TWTS2414	24"	14"	201	211	247
	TWTS3014	30"	14"	232	244	286
	TWTS3614	36"	14"	251	264	309
	TWTS4214	42"	14"	299	315	368
	TWTS4814	48"	14"	304	320	375
	TWTS5414	54"	14"	352	371	434
	TWTS6014	60"	14"	352	371	434
	TWTS6614	66"	14"	401	422	494
	TWTS7214	72"	14"	401	422	494

Rectangular, double round end	Product No.	Width	Deep	A	B	C
	TWTR3814	38"	14"	225	237	277
	TWTR4414	44"	14"	281	296	346
	TWTR5014	50"	14"	384	404	472
	TWTR5614	56"	14"	425	448	524
	TWTR6214	62"	14"	432	454	532
	TWTR6814	68"	14"	462	486	569
	TWTR7414	74"	14"	515	542	634

Corner	Product No.	Width	Deep	A	B	C
	TWTK3314	33"	14"	669	704	824
	TWTK3914	39"	14"	674	710	830
	TWTK4514	45"	14"	680	716	838

For curved panel	Product No.	Width	Deep	A	B	C
	TWTV3314	33	14"	669	704	824



WORKSURFACES-System



Transaction countertops

Description

High pressure laminate with PVC square edge, hangs from panel or wall strips.
Includes attachment hardware in Black finish.
Order base separately.

For 120° corner 1 piece	Product No.	W1	W2	Deep	A	B	C
Ms	VWTH3314	33"	33"	14"	1272	1339	1566
	VWTH3914	39"	39"	14"	1277	1344	1573
	VWTH4514	45"	45"	14"	1283	1351	1580
	TWTH3314	33"	33"	14"	1272	1339	1566
	TWTH3914	39"	39"	14"	1277	1344	1573
	TWTH4514	45"	45"	14"	1283	1351	1580

For 120° corner, sectioned	Product No.	Width	Deep	A	B	C
Ms	VWTM3314	33"	14"	330	348	407
	VWTM3914	39"	14"	356	375	439
	VWTM4514	45"	14"	277	292	341
Left	VWTN3314	33"	14"	330	348	407
	VWTN3914	39"	14"	373	393	459
	VWTN4514	45"	14"	278	293	342
Link	TWTM3314	33"	14"	330	348	407
	TWTM3914	39"	14"	338	355	416
	TWTM4514	45"	14"	278	293	342
Left	TWTN3314	33"	14"	330	348	407
	TWTN3914	39"	14"	338	355	416
	TWTN4514	45"	14"	278	293	342

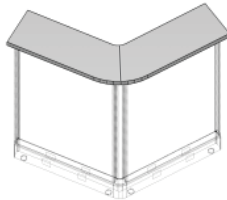

WORKSURFACES-System



Rectangular with grommet

Description

High preassure laminate with PVC square edge, hangs from panel or wall strips.
Includes attachment hardware in Black finish and 1 grommet.
For 60" or larger worksurfaces, 2 grommets are included.

24" deep	Product No.	Width	A	B	C
	TWRS2424WG	24"	294	327	361
	TWRS3024WG	30"	314	349	414
	TWRS3624WG	36"	372	413	461
	TWRS4224WG	42"	397	441	521
	TWRS4824WG	48"	421	468	530
	TWRS5124WG	51"	468	520	657
	TWRS5224WG	51.5"	468	520	657
	TWRS5424WG	54"	488	542	657
	TWRS6024WG	60"	534	593	669
	TWRS6324WG	63"	554	615	778
	TWRS6424WG	63.5"	554	615	778
	TWRS6624WG	66"	562	625	778
	TWRS7224WG	72"	620	689	792
	TWRS7524WG	75"	642	713	740
	TWRS7624WG	75.5"	642	713	885
	TWRS8424WG	84"	695	772	872
	TWRS9624WG	96"	832	925	1018
30" deep					
	TWRS2430WG	24"	318	348	372
	TWRS3030WG	30"	485	542	587
	TWRS3630WG	36"	492	559	604
	TWRS4230WG	42"	499	555	600
	TWRS4830WG	48"	677	762	830
	TWRS5130WG	51"	767	878	960
	TWRS5230WG	51.5"	860	978	1072
	TWRS5430WG	54"	862	980	1075
	TWRS6030WG	60"	874	991	1086
	TWRS6330WG	63"	951	1082	1186
	TWRS6630WG	66"	955	1085	1190
	TWRS7230WG	72"	998	1136	1246
	TWRS7530WG	75"	1006	1155	1265
	TWRS7630WG	75.5"	1007	1155	1266
	TWRS7830WG	78"	1125	1282	1408
	TWRS8430WG	84"	1131	1289	1415
	TWRS9630WG	96"	1255	1321	1545