

MUSIC SYSTEMS CATALOG

S I N C E  1 8 9 8

Sheldon
LABORATORY SYSTEMS

PLANNING MUSIC FACILITIES FOR EDUCATION

Music Education, an integral part of the school curriculum, requires specialized, carefully planned facilities. The Music Department is one of the most expensive areas of construction in a modern school system, and should be designed to offer maximum opportunity to all students.

Of primary importance is the physical facility. While this Sheldon catalog presents an offering of storage equipment for the entire music department, Sheldon Music should be considered more than a variety of cabinets and designs. It is a complete program designed to facilitate Music Education in the 80's.

Throughout the years the Music Educators National Conference publications have guided Sheldon in its selection of leading music educators to help Sheldon design Music Education facilities. This professional guidance has kept Sheldon Music storage equipment in agreement with suggestions published by the Music Educators National Conference. Their 1975 publication, "Planning and Equipping Education Facilities" should be used as a guide for all who plan music education facilities. Specific items shown in this Sheldon catalog should be selected after space, light, ventilation, and acoustic treatments of the areas are established.

SHELDON MUSIC STORAGE CABINETS

Sheldon offers the finest constructed cabinet available for music storage facilities with a wide range of materials to insure it will be the correct product.

Large storage cabinets required for instrument storage are best used in large rehearsal rooms where students may have ready access. Since acoustics play a major role in the design of music rooms, cabinet surfaces must be carefully considered. Sheldon offers a variety of cabinet fronts allowing easy access, acoustic enhancement, elimination of the need for added storage rooms, thereby saving construction dollars.

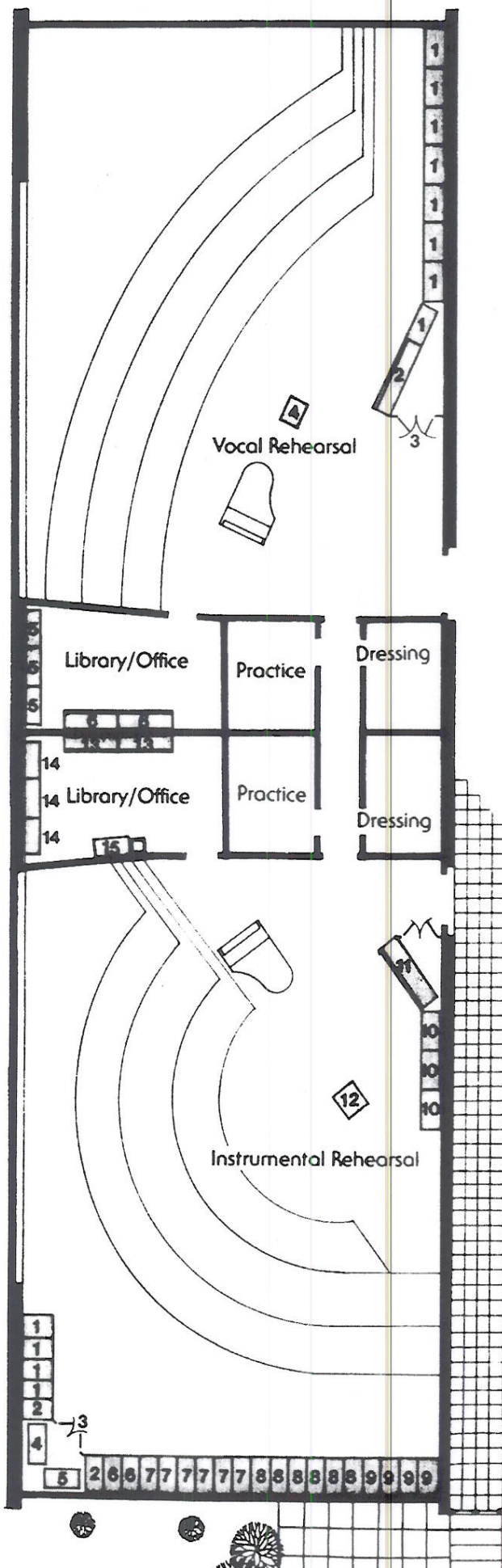

EQUIPMENT LIST

1. 20810 Gown Storage
2. 40005 Chalkboard Assembly
3. 12000 Case Front
4. 30850 Director's Stand
5. 31055 Music Storage
6. 40002 Sorting Rack

The two teacher music department shown requires approximately 6500 sq. ft. of floor space. It is typical of the most popular designs in use with the exception of using separate rooms for instrument and uniform/gown storage. Instead, Sheldon storage cases have been strategically placed within the rehearsal areas. Dispersion and propagation of sound were improved by setting Sheldon storage cases at angles and by equipping selected cases with sound absorptive and reflective doors.

EQUIPMENT LIST

1. 10031 Instrument Storage
2. 10041 Instrument Storage
3. 12000 Case Front
4. 12050 Cello Rack
5. 12150 SousaPhone Rack
6. 10001 Instrument Storage
7. 10015 Instrument Storage
8. 10025 Instrument Storage
9. 10051 Instrument Storage
10. 20830 Uniform Storage
11. 40005 Chalkboard Assembly
12. 30850 Director's Stand
13. 40002 Sorting Rack
14. 31055 Music Storage
15. 40840 Instrument Repair

Planning Guide

The chart at the right represents the ultimate in band room planning. For your convenience, the average no. of various instruments required for band sizes of 52, 80, and 120 students have been listed. In addition, we have included the approx. instrument size and the Sheldon compartment that is compatible for storage. You need only total the qty. of the various compartment sizes needed to fit your band size and relate them to the instrument storage cases listed in this catalog.

Instrument	Department Size for Band of approx.			Instrument Size			Storage Compartment
	52	80	120				
Piccolo Flute	3	6	8	10	4	2	A-1
E♭ Clarinet	1	1	1	18½	11	4½	A-1
B♭ Clarinet	12	24	30	15	11	4½	A-1
Metal Clarinet				24½	6	4	A-1
Alto Clarinet	2	2	4	27½	11½	6	B-2
Bass Clarinet	1	2	4	36	12	6½	B-2
Oboe	1	2	2	16½	9½	4	A-1
English Horn	1	1	1	20	9	3½	A-1
Soprano Sax	1	2	3				A-1
Tenor Sax	2	2	3	32½	13	7½	B-2
Alto Sax	3	5	6	24½	12	7	B-1
Baritone Sax	1	1	2	43	17	9	E-1
Bass Sax	1	1	1	56	18½	13½	E-1
Bassoon	1	2	3	28½	12	5	B-2
Cornet-Trumpet	8	12	15	22	13	6½	B-1
French Horn	4	6	8	27	18½	16	D-2
Mellophone	1	1	1	26	18	13	D-1
Baritone Horn	2	3	4	37	19	15	D-2
Euphonium				36	22	18	D-2
Alto Horn	2	3	4	26	22	18	D-1
Trombone	3	6	9	36	11½	9½	B-2
Bass Trombone	1	1	1	38	13	10½	F-1
Bass Horn	2	4	8		Varies		Rack
Sousaphone	2	4	6	52	30	27	Rack
Flugelhorn	1	1	1	19	16	6	D-1
Valve Trombone				34	15	8½	D-2
Violin	12	20	36	33	10½	8	B-2
Viola	4	8	12	33	12	8	B-2
Cello	4	8	12	50	18	10	E-1 or rack
Bass Viol-¾	4	6	10	72	26	17	G-2
Bass Viol-½	2	4	6	65	22	14	G-2
Bass Drum	1	1	1	38	38	18	F-2
Field Drum	4	6	8	18	18	15	D-1 or rack
Snare Drum	2	3	4	16	16	9	D-1 or rack
Tympani	2	3	3	33	33	34	Shelf
Bell-Glockenspiel	1	2	3				Shelf

Instrument Storage Cases

'A' Units



10001 INSTRUMENT STORAGE CASE 24"W 27"D 82 3/4"H

Provides 15 A-1 compartments, 14 1/4" x 6 1/2" x 26", each with metal door and built-in padlock hasp. Padlocks not included.

10002 Similar to 10001 but with full height door of oak veneer or plastic laminate in lieu of individual metal doors.

10003 Same as 10002 but with sound absorptive door.

10004 Includes 15 compartments identical in size to above but without doors.

'B' Units

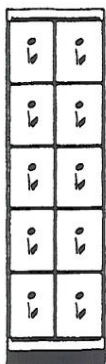

10010 INSTRUMENT STORAGE CASE 24"W 27"D 82 3/4"H

Provides 10 B-1 compartments, 10 1/2" x 14 1/4" x 26", each with metal door and built-in padlock hasp. Padlocks not included.

10011 Similar to 10010 but with full height door of oak veneer or plastic laminate in lieu of individual metal doors.

10012 Same as 10011 but with sound absorptive door.

10013 Includes 10 compartments identical in size to above but without doors.

10015 INSTRUMENT STORAGE CASE 24"W 40"D 82 3/4"H

Provides 10 B-2 compartments, 10 1/2" x 14 1/4" x 39", each with metal door and built-in padlock hasp. Padlocks not included.

10016 Similar to 10015 but with full height door of oak veneer or plastic laminate in lieu of individual metal doors.

10017 Same as 10016 but with sound absorptive door.

10018 Includes 10 compartments identical in size to above but without doors.

'D' Units



10020 INSTRUMENT STORAGE CASE 24"W 27"D 82 3/4"H

Provides 3 D-1 compartments, 22 3/4" x 24 1/4" x 26", each with metal door and built-in padlock hasp. Padlocks not included.

10021 Similar to 10020 but with full height door of oak veneer or plastic laminate in lieu of individual metal doors.

10022 Same as 10021 but with sound absorptive door.

10023 Includes 3 compartments identical in size to above but without doors.

10025 INSTRUMENT STORAGE CASE 24"W 40"D 82 3/4"H

Provides 3 D-2 compartments, 22 3/4" x 24 1/4" x 39", each with metal door and built-in padlock hasp. Padlocks not included.

10026 Similar to 10025 but with full height door of oak veneer or plastic laminate in lieu of individual metal doors.

10027 Same as 10026 but with sound absorptive door.

10028 Includes 3 compartments identical in size to above but without doors.

'E' Units

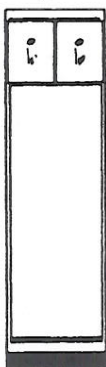

10030 INSTRUMENT STORAGE CASE 24"W 27"D 82 1/4"H

Provides 1 E-1 compartment, 22 1/4" x 59" x 26", without door, and 2 B-1 compartments with metal door and built-in padlock hasp. Padlocks not included.
10031 Similar to 10030 but with full height door of oak veneer or plastic laminate in lieu of 2 small metal doors.
10032 Same as 10031 but with sound absorptive door.

'F' Units



10040 INSTRUMENT STORAGE CASE 24"W 27"D 82 1/4"H

Provides 1 F-1 compartment, 22 1/4" x 49" x 26", without door, and 1 D-1 compartment with metal door and built-in padlock hasp. Padlocks not included.
10041 Similar to 10040 but with full height door of oak veneer or plastic laminate in lieu of single metal door.
10042 Same as 10041 but with sound absorptive door.

10045 INSTRUMENT STORAGE CASE 24"W 40"D 82 1/4"H

Provides 1 F-2 compartment 22 1/4" x 49" x 39", without door, and 1 D-2 compartment with metal door and built-in padlock hasp. Padlocks not included.
10046 Similar to 10045 but with full height door of oak veneer or plastic laminate in lieu of single metal door.
10047 Same as 10046 but with sound absorptive door.

'G' Units

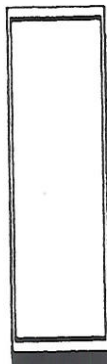

10050 INSTRUMENT STORAGE CASE 24"W 27"D 82 1/4"H

Provides 1 G-1 compartment, 22 1/4" x 74" x 26", without door.
10051 Similar to 10050 but with full height door of oak veneer or plastic laminate.
10052 Same as 10051 but with sound absorptive door.

10055 INSTRUMENT STORAGE CASE 24"W 40"D 82 1/4"H

Provides 1 G-2 compartment, 22 1/4" x 74" x 39", without door.
10056 Similar to 10055 but with full height door of oak veneer or plastic laminate.
10057 Same as 10056 but with sound absorptive door.

Uniforms & Gowns



20800 UNIFORM OR GOWN STORAGE
 47"W 27"D 82 3/4"H
 Stores 21 uniforms or gowns on included removable hangers. Top shelf is fixed.
 20810 Same as 20800 but with sound absorptive doors.

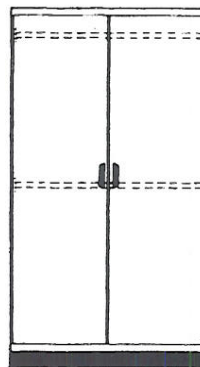

20820 UNIFORM STORAGE
 47"W 27"D 82 3/4"H
 Stores 42 uniforms on included removable hangers. Lower rod assembly is removable.
 20830 Same as 20820 but with sound absorptive doors.

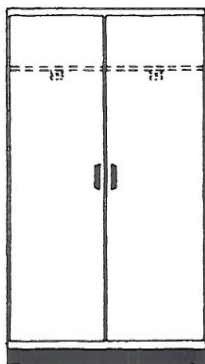

20840 UNIFORM STORAGE
 47"W 27"D 82 3/4"H
 Stores uniforms on 2 special pullout racks. Top shelf is non-adjustable.
 20850 Same as 20840 but with sound absorptive doors.

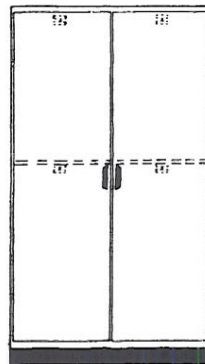

20860 UNIFORM STORAGE
 47"W 27"D 82 3/4"H
 Stores uniforms on 4 special pullout racks. Top shelf is non-adjustable.
 20870 Same as 20860 but with sound absorptive doors.

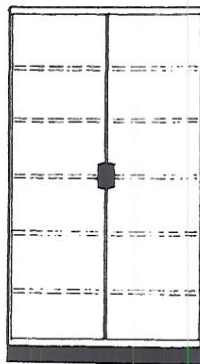

20880 HAT STORAGE
 47"W 27"D 82 3/4"H
 Hats are stored on 5 perforated metal shelves to allow proper drying of dampened items.
 20890 Same as 20880 but with sound absorptive doors.

Specialized

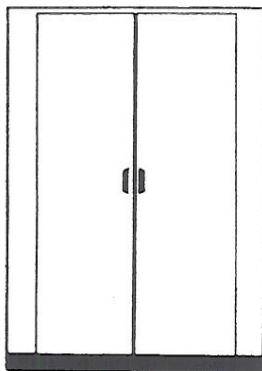

12000 CASE FRONT 62"W 27"D 82 3/4"H

Sheldon case fronts are designed for installation between walls or adjacent cabinets to maintain the uniform appearance of a cabinet assembly and provide concealed storage space that might otherwise be wasted. Since there is no bottom, free and unobstructed movement of instrument racks or instruments on casters is permitted.

12001 Same as 12000 but with sound absorptive doors.

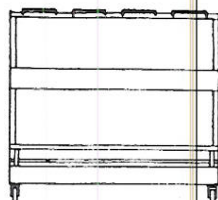

12050 CELLO RACK 50"W 24"D 44"H

Rolls into 12000 series case fronts for storage. Rack holds 4 cellos and bows. Available in solid oak only.

12150 SOUSAPHONE RACK

Same as 12050 Cello rack except holds 2 sousaphone.

12190 SNARE DRUM RACK

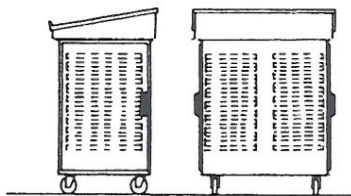

30850 DIRECTOR'S STAND 32"W 24"D 43"H

This portable stand is finished on all four sides. Raised edge on lectern top prevents music from sliding off. Each side contains 24 individual compartments for storage of folders or sheet music.



40500 DIRECTOR'S PLATFORM 30"W 30"D 8"H

Slip proof ribbed rubber top. Completely portable for use in rehearsal rooms or on field.

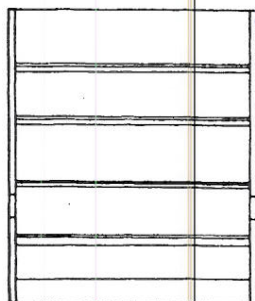

40001 MUSIC SORTING RACK 60"W 16"D 68"H

This rack offers maximum visibility of shelf contents when sorting music. Four shelves are fixed at the proper angles for viewing. Available in oak only.

40002 Same as 40001 but 72"W.

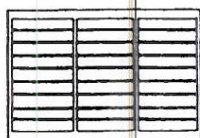

31050 MUSIC STORAGE 47"W 16"D 30"H

Cabinets may be set on counters or mounted directly on wall. Contains 27 compartments approximately 14" wide, 14" deep, and 2" high.

31055 MUSIC STORAGE 47"W 16"D 48"H

Similar to 31050 except unit is 48" high and contains 32 individual compartments.

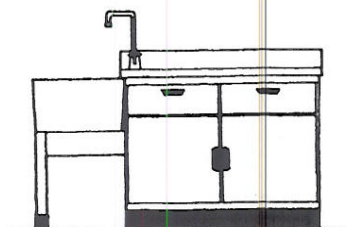
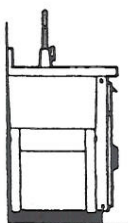

40840 INSTRUMENT REPAIR CENTER 72"W 27"D 37"H

Provides extensive facilities for instrument repair and maintenance. Base cabinet has 2 drawers and a cupboard with adjustable shelf. Work surface is 2 1/4" thick hardwood. Unit includes fiberglass sink and single handle cold water gooseneck faucet.

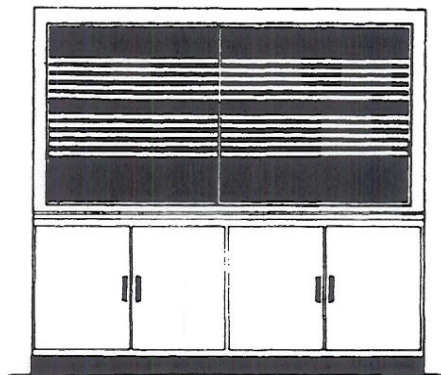

40005 CHALKBOARD ASSEMBLY 96''W 24''D 82¾''H
 Aluminum framed chalkboard assembly includes four separate sliding panels providing nearly 16 lineal feet of chalkboard surface. Two open shelf storage cabinets with three adjustable shelves are accessible when panels are moved aside. Base cabinets contain one adjustable shelf each. Staff lines on chalkboard surface are standard.

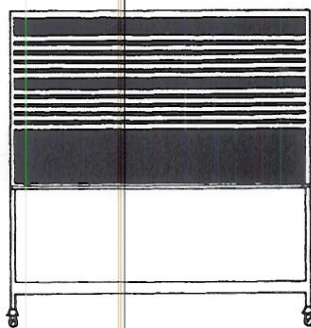

40006 PORTABLE CHALKBOARD 72''W 24''D 72''H
 Chalkboard surface is 72'' x 36'' and has double set of staff lines. Framing is of aluminum.