

Circulation Desks

Cambre™

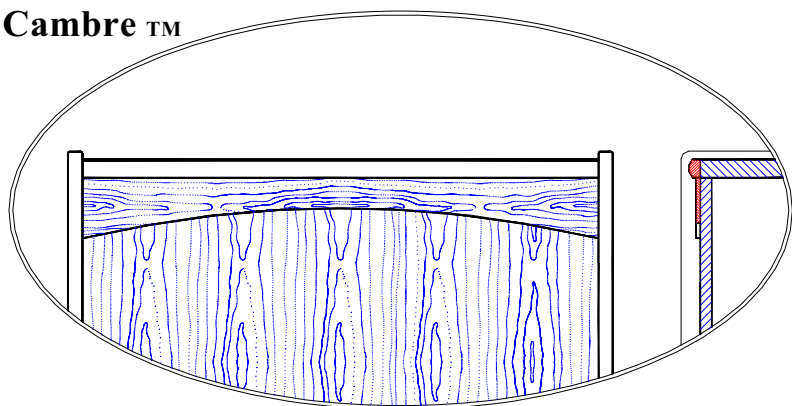

The Cambre package adds a 4"W x 1/4"T solid red oak trim with an arch on the bottom edges. The trim is added at the top of the modesty panel and is captured by the end panels. Arched trim will finished to match.

NOTE: This package is not available on radiused desk or corner units.

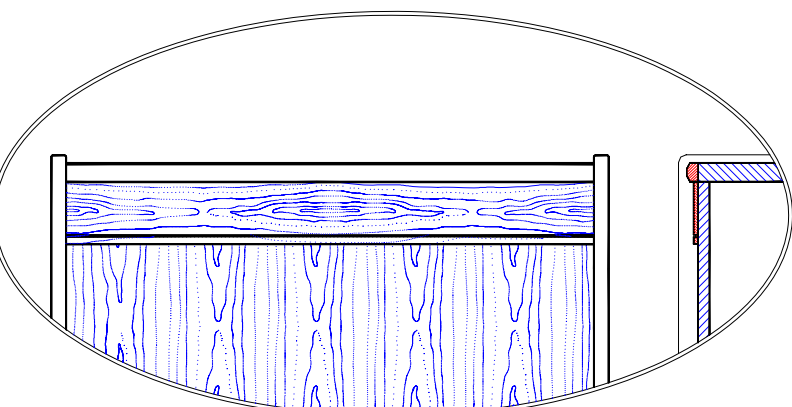

The Canale package adds a 4"W x 1/4"T solid red oak trim with a 1/8" x 1/8" reveal located 3/4" from the bottom of the trim. Reveal will be finished flat black. The trim is added at the top of the modesty panel and is captured by the end panels. Trim will be finished to match.

NOTE: This package is not available on radiused desk or corner units.

Canale™

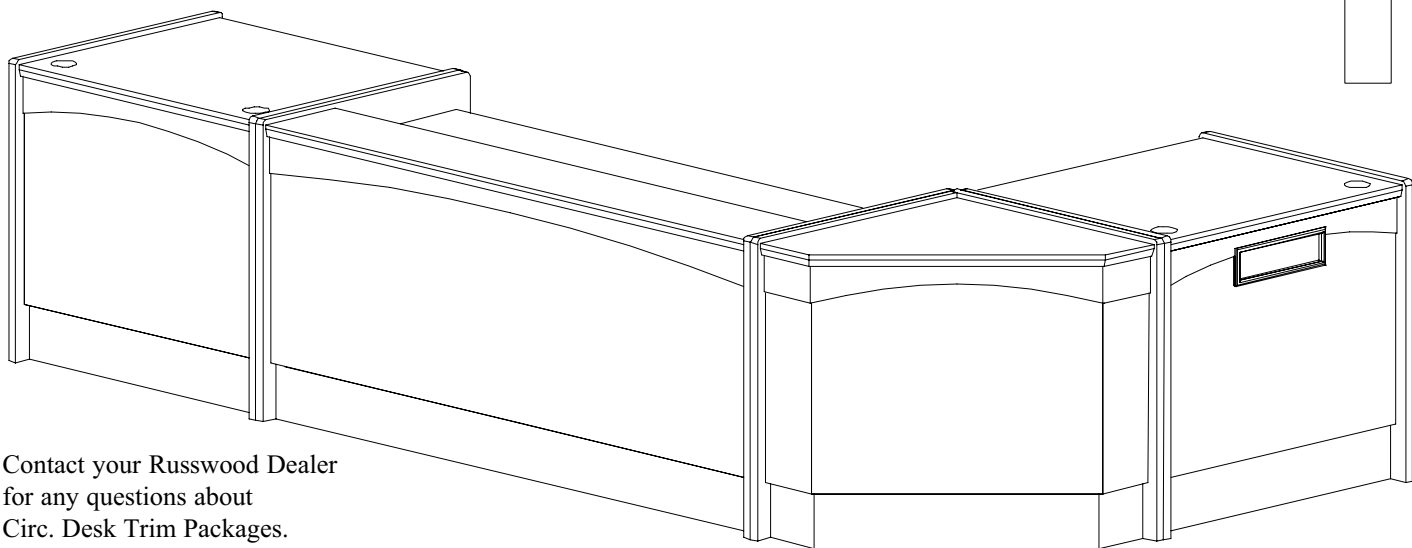

Contact your Russwood Dealer  
for any questions about  
Circ. Desk Trim Packages.

Catalog #	Description	Single W" per unit upcharge	Double W unit upcharge \$
CBM -1	Cambre Trim Package for ModuFlex Series		
CLM-1	Canale Trim Package for ModuFlex Series		
	<b>To figure upcharge:</b>	# 36"W units (x) upcharge per unit =	
		# 72"W units (x) upcharge per unit = +	
		Total upcharge \$	

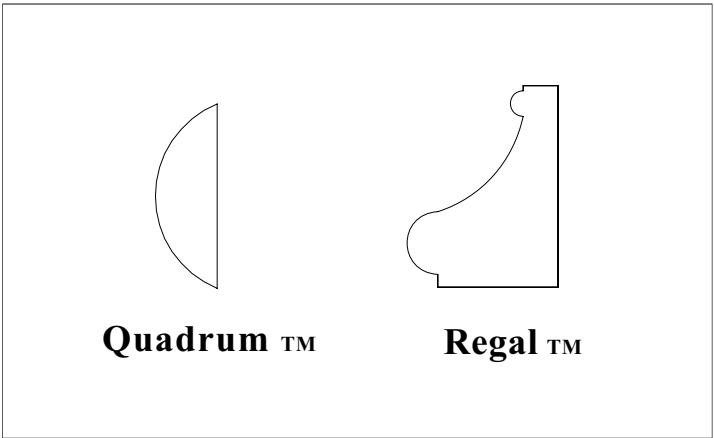
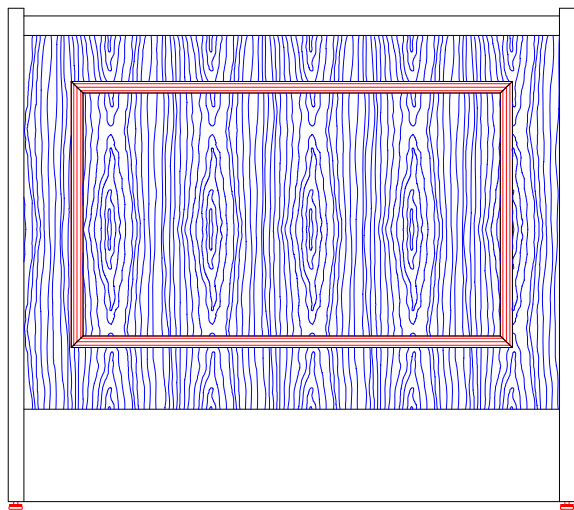

The Quadrum and Regal packages can be applied to any flat modesty panel or end panel. The treatment forms a rectangle that is about 3" from all edges. The trim package comes with the choice of two moldings. The Quantum and Regal edge details of these two moldings can be seen above. Note: this treatment is not available on radius units. On 36" circulation desks the modesty panels receives one such rectangle while a 72" unit would receive two such rectangles

NOTE: The Quadrum and Regal packages are not available on radiused desk or corner units.

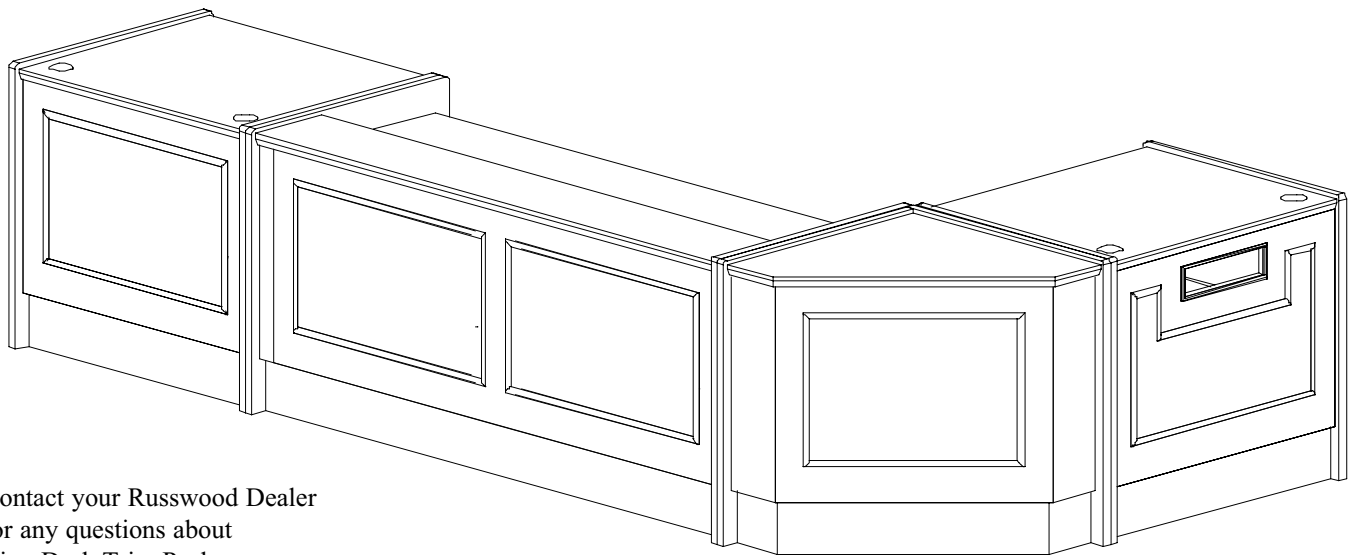

Contact your Russwood Dealer  
for any questions about  
Circ. Desk Trim Packages.

Catalog #	Description	Single W" unit upcharge	Double W" unit upcharge
QDM-1	Quadrum Trim Package for ModuFlex Series		
RGM -1	Regal Trim Package for ModuFlex Series		
To figure upcharge:		# 36"W units (x) upcharge per unit =	
		# 72"W units (x) upcharge per unit = +	
		Total upcharge \$	

## For the ultimate in versatility...

Combine any of our desk units in this series with any of the following mobile units.

Combining mobile units and desk units allows you to change the function of any of your circulation desk work stations at a moment's notice. Units with permanent features can be used with desks that use mobile units.

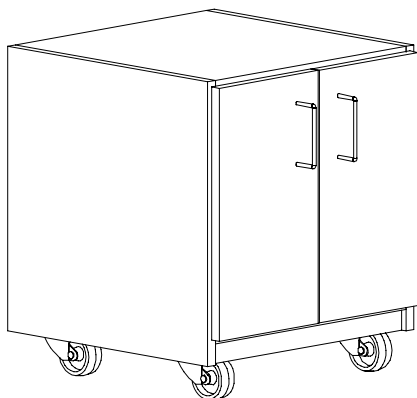

### Mobile Cupboard Unit

This unit is supplied with two (2) shelves for the adult height and one (1) shelf for the elementary height. The back is supplied with grommets for wire management.

Catalog #	Description	Height"	Width"	Depth"	Price
A-27	Elementary height	26	25	20	
A-28	Adult height	36	25	20	

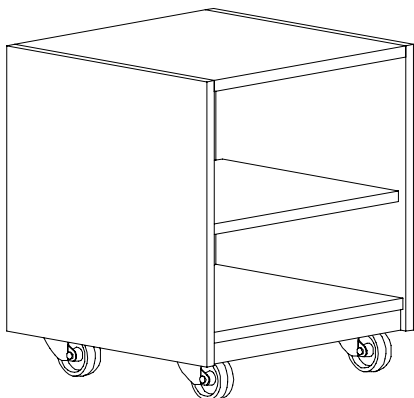

### Mobile Open Shelf Unit

This unit is supplied with two (2) shelves for the adult height and one (1) shelf for the elementary height. The back is supplied with grommets for wire management.

Catalog #	Description	Height"	Width"	Depth"	Price
A-29	Elementary height	26	25	20	
A-30	Adult height	30	25	20	

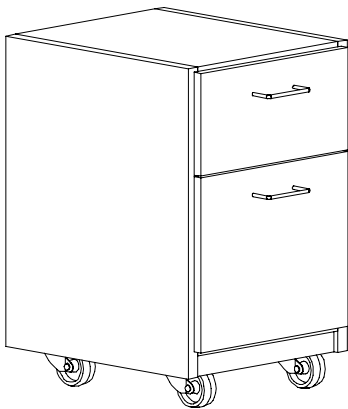
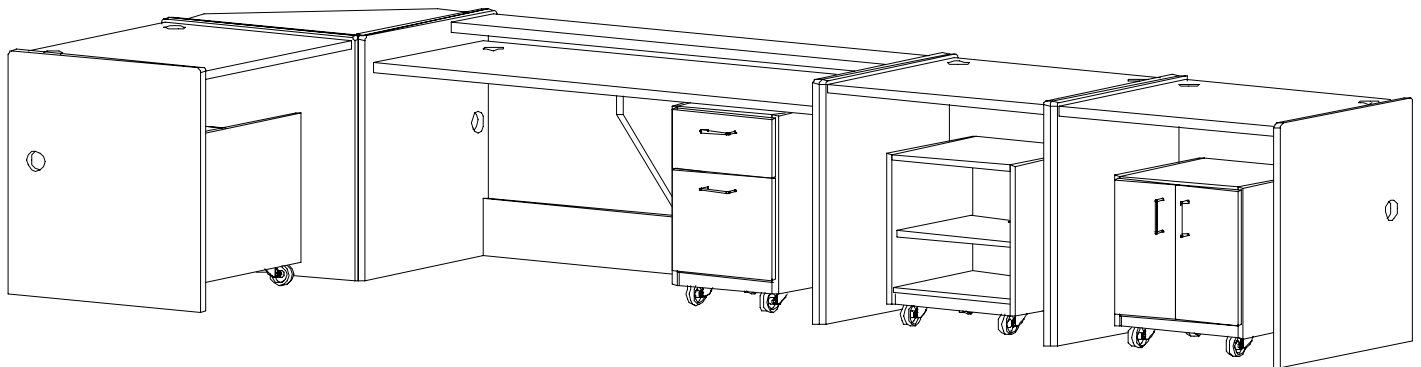

### Mobile File Cabinet

The elementary height unit is supplied with (1) box and (1) file drawer. The intermediate height unit is supplied with (2) boxes and (1) file. The adult height unit is supplied with (1) box drawer and (2) file drawers. The box drawer is 14-7/8"W x 18"D x 5-1/4"H. The file drawer is 14-7/8"W x 18"D x 10-1/2"H. The unit is counterbalanced so that it does not tip over under normal use when the file drawer is opened.

Catalog #	Description	Height"	Width"	Depth"	Price
A-23	Elementary height	25	17	19	
A-23A	Intermediate height	31	17	19	
A-23B	Adult height	36	17	19	

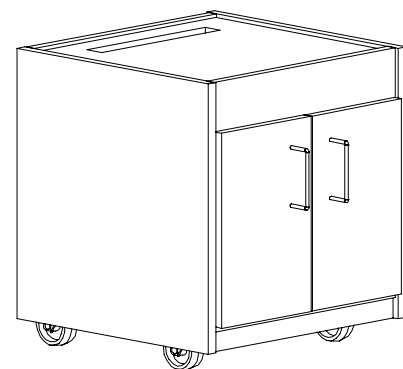

### Mobile Printer Stand

Unit end panels are constructed of 1"T red oak veneer plywood. All other components are constructed with 3/4"T red oak veneer plywood. Unit is supplied with one (1) adjustable shelf and one (1) base shelf. The shelf is 22-134"W x 17"D x 3/4"T. Adj. Shelf is notched for wiring management. All exposed edges are edgebanded with 1/4"T solid red oak. Doors have satin chrome pulls. The bottom is supplied with a grommet for wire management. Wheels are 210 lbs rated ball-bearing swivel casters. The top is removable and is slotted for printer paper.

Catalog #	Description	Height"	Width"	Depth"	Price
A-24	Universal height	21	21	19	

## Circulation Desks

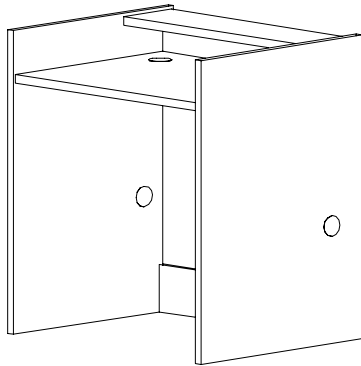

### Patron Desk Unit

Inside dimensions are 34"W x 27-1/2"D. Units will have a work surface height of 29". All units will have a recessed work surface measuring 34"W x 27-1/2"D at a height of 29". Patron ledge is 6" deep. A grommet will be located in the center at the rear of the work surface unless otherwise specified.

Catalog #	Description	Height"	Width"	Depth"	Price
CDM-3202	Elementary Height	32	36	30	
CDM-3902	Intermediate Height	39	36	30	
CDM-4202	Adult Height	42	36	30	

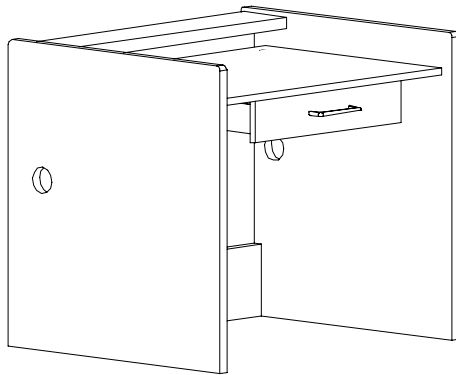

### Patron Desk With Pencil Drawer Unit

Inside dimensions are 34"W x 27-1/2"D. All units will have a recessed work surface measuring 34"W x 27-1/2"D at a height of 29". Patron ledge is 6" deep. A grommet will be located in the center at the rear of the work surface unless otherwise specified. A pencil drawer will be centered under the work surface and will measure 18"W x 14-7/8"D x 3"H.

Catalog #	Description	Height"	Width"	Depth"	Price
CDM-3235	Elementary Height	32	36	30	
CDM-3935	Intermediate Height	39	36	30	
CDM-4235	Adult Height	42	36	30	

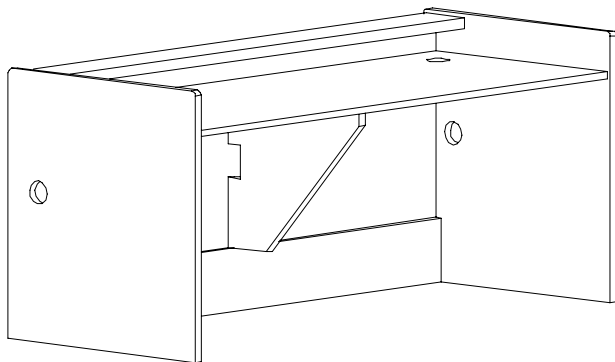

### Double-Width Patron Desk Unit

Inside dimensions are 70"W x 27-1/2"D. All units will have a work surface height of 29". Patron ledge is 6" deep. Work surface is 70"W x 27-1/2"D. Two (2) grommets will be located at the rear of the work surface on each side unless otherwise specified. The work surface will be supported at midspan with a 1" thick stiffknee that rests on top of the toe board.

Catalog #	Description	Height"	Width"	Depth"	Price
CDM-3203	Elementary Height	32	72	30	
CDM-3903	Intermediate Height	39	72	30	
CDM-4203	Adult Height	42	72	30	

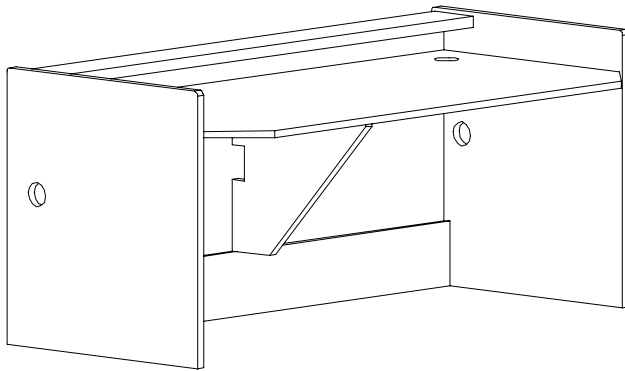

### Double-Width Extended Work Surface Patron Desk Unit

Inside dimensions are 70"W x 27-1/2"D. All units will have a work surface height of 29". Patron ledge is 6" deep. Two (2) grommets will be located at the rear of the work surface on each side unless otherwise specified. The work surface will be supported at midspan with a 1" thick stiffknee that rests on top of the toe board. Work surface is 70"W x 30"D.

Catalog #	Description	Height"	Width"	Depth"	Price
CDM-3203-EW	Elementary Height	32	72	32	
CDM-3903-EW	Intermediate Height	39	72	32	
CDM-4203-EW	Adult Height	42	72	32	

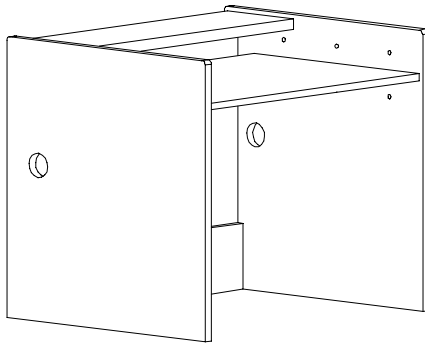

### Patron Desk with adjustable work surface

This unit provides a 6"D patron ledge. The work surface is adjustable to accommodate a variety of possible needs. On the adult height unit, the work surface possibilities are 29"H, 32"H, and 39"H. On the intermediate height unit, the work surface possibilities are 27"H, 29"H, and 32"H. On the elementary height unit, the work surface possibilities are 27"H, and 29"H. A grommet will be located in the center at the rear of the work surface unless otherwise specified. Work surface is 34"W x 27-1/2"D.

Catalog #	Description	Height"	Width"	Depth"	Price
CDM-3248	Elementary Height	32	36	30	
CDM-3948	Intermediate Height	39	36	30	
CDM-4248	Adult Height	42	36	30	

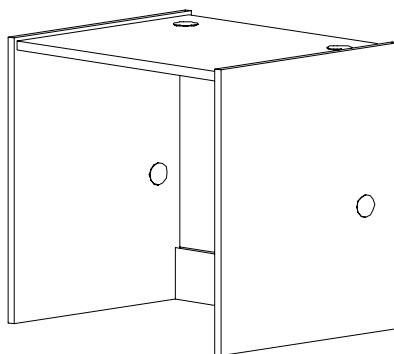

### Desk Unit

Each unit will have inside dimensions of 34"W x 27-1/2"D. Two (2) grommets will be located at the rear of the work surface on each side unless otherwise specified.

Catalog #	Description	Height"	Width"	Depth"	Price
CDM-3234	Elementary Height	32	36	30	
CDM-3934	Intermediate Height	39	36	30	
CDM-4234	Adult Height	42	36	30	

## Circulation Desks

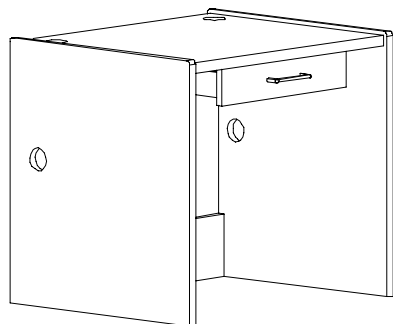

### Desk Unit With Pencil Drawer

Each Unit will have an inside dimension of 34"W x 27-1/2"D. A grommet will be located near each edge of the unit unless otherwise specified. A pencil drawer will be located underneath the middle of the work surface and will measure 18"W x 14-7/8"D x 3"H.

Catalog #	Description	Height"	Width"	Depth"	Price
CDM-3247	Elementary Height	32	36	30	
CDM-3947	Intermediate Height	39	36	30	
CDM-4247	Adult Height	42	36	30	

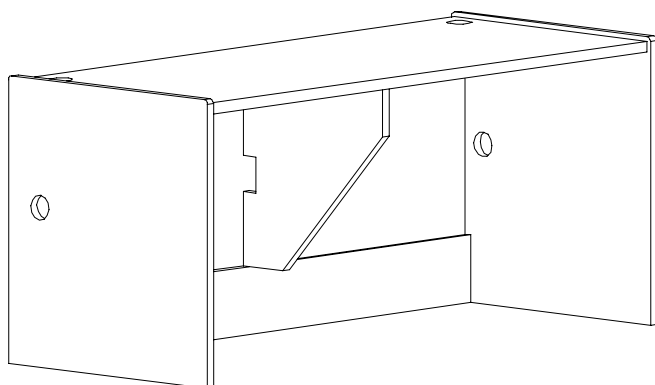

### Double Width Desk Unit

Each Unit will have an inside dimension of 70"W x 27-1/2"D. This unit will be supplied with two (2) grommets located at each end of the work surface unless otherwise specified. The work surface will be supported at midspan with a 1" thick stiffknee that rests on top of the toe board.

Catalog #	Description	Height"	Width"	Depth"	Price
CDM-3253	Elementary Height	32	72	30	
CDM-3953	Intermediate Height	39	72	30	
CDM-4253	Adult Height	42	72	30	

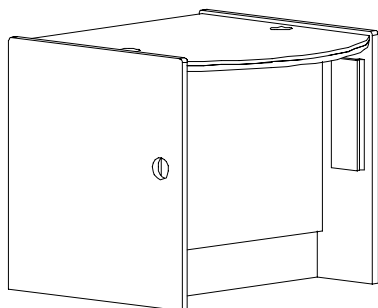

### ADA Transaction Unit

The unit will have modesty panel mounted along the midline. The modesty panel is recessed from the patron side to provide room for wheelchair access. This unit will be supplied with two (2) grommets located at each end of the work surface unless otherwise specified. A wire chase is supplied to ensure wire concealment.

Catalog #	Description	Height"	Width"	Depth"	Price
CDM-3220	ADA 32"H - use of all heights	32	36	36	

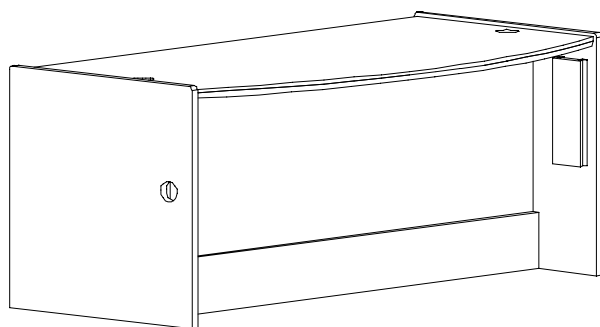

### Double-Width ADA Transaction Unit

The unit will have modesty panel mounted along the midline. The modesty panel is recessed from the patron side to provide room for wheelchair access. This unit will be supplied with two (2) grommets located at each end of the work surface unless otherwise specified. A wire chase is supplied to ensure wire concealment.

Catalog #	Description	Height"	Width"	Depth"	Price
CDM-3221	ADA max height 32"H	32	72	36	

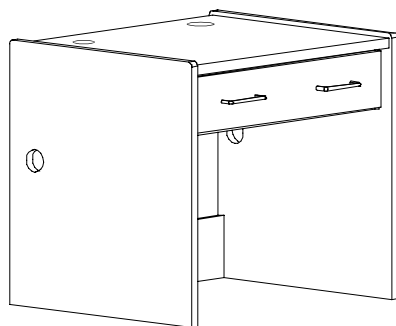

### Single Drawer Knee Space Unit

The inside dimensions of the unit are 34"W x 27-1/2"D. The unit is supplied with a 31-1/2"W x 18"D x 5-1/4"H drawer. This unit will be supplied with two (2) grommets located at each end of the work surface unless otherwise specified.

Catalog #	Description	Height"	Width"	Depth"	Price
CDM-3236	Elementary Height	32	36	30	
CDM-3936	Intermediate Height	39	36	30	
CDM-4236	Adult Height	42	36	30	

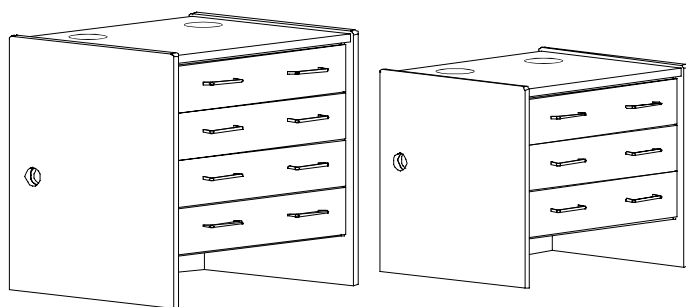

Shown Adult & Elementary

### Single Drawer Stack Unit

This unit will consist of a stack of full width drawers 31-1/2"W x 18"D x 5-1/4"H. The adult and intermediate height units will receive four (4) drawers and the elementary unit will receive three (3) drawers. This unit will be supplied with two (2) grommets located at each end of the work surface unless otherwise specified.

Catalog #	Description	Height"	Width"	Depth"	Price
CDM-3222	Elementary Height	32	36	30	
CDM-3922	Intermediate Height	39	36	30	
CDM-4222	Adult Height	42	36	30	



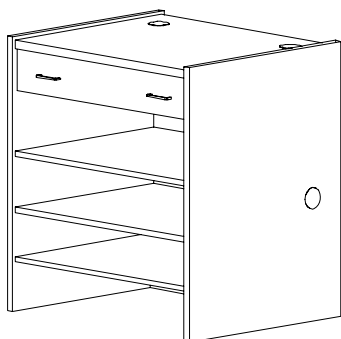

### Single Drawer Open Shelf Unit

Unit is supplied with a full-width, 31-1/2"W x 18"D x 5-1/4"H drawer over open shelving. Adult and intermediate units are supplied with two full-depth, adjustable shelves. The elementary height unit is supplied with one full-depth, adjustable shelf. This unit will be supplied with two (2) grommets located at each end of the work surface unless otherwise specified. The shelf is 32-1/4"W x 23"D x 3/4"T

Catalog #	Description	Height"	Width"	Depth"	Price
CDM-3246	Elementary Height	32	36	30	
CDM-3946	Intermediate Height	39	36	30	
CDM-4246	Adult Height	42	36	30	

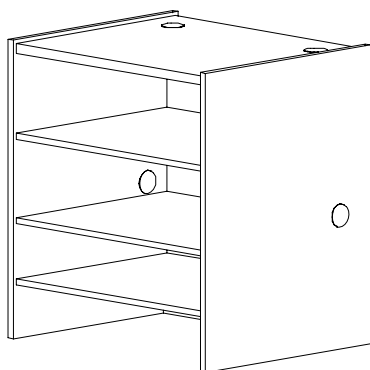

### Open Shelf Unit

Adult and Intermediate height units will be supplied with two full-depth, adjustable shelves. Elementary height units will be supplied with one shelf. This unit will be supplied with two (2) grommets located at each end of the work surface unless otherwise specified. The shelf is 32-1/4"W x 23"D x 3/4"T

Catalog #	Description	Height"	Width"	Depth"	Price
CDM-3208	Elementary Height	32	36	30	
CDM-3908	Intermediate Height	39	36	30	
CDM-4208	Adult Height	42	36	30	

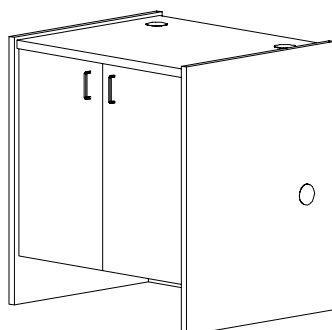

### Cupboard Unit

Adult and Intermediate height units are supplied with two full-depth, adjustable shelves. Elementary height units will be supplied with one shelf. Hinged doors will have a lock and door pulls. This unit will be supplied with two (2) grommets located at each end of the work surface unless otherwise specified. The shelf is 32-1/4"W x 23"D x 3/4"T

Catalog #	Description	Height"	Width"	Depth"	Price
CDM-3210	Elementary Height	32	36	30	
CDM-3910	Intermediate Height	39	36	30	
CDM-4210	Adult Height	42	36	30	

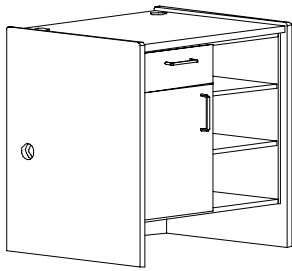

Shown Adult &amp; Elementary

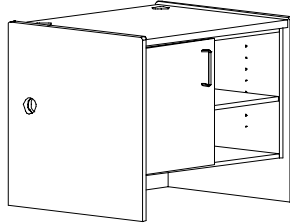

### Left Cupboard Open Shelf Unit

On the left side, the adult and intermediate units will be supplied with a locking box drawer and a cupboard space with two (2) adjustable shelves. The elementary unit will be supplied with a cupboard unit with (1) adj. shelf. The right side of the unit will be open adj. shelving. The adult and intermediate height units will be supplied with (2) adj. shelves, and the elementary height unit will be supplied with (1) adj. shelf. This unit will be supplied with (2) grommets located at each end of the work surface unless otherwise specified. The shelf is 15-5/8"W x 23"D x 3/4"T. The box drawer is 14-7/8"W x 18"D x 5-1/4"H.

Catalog #	Description	Height"	Width"	Depth"	Price
CDM-3242	Elementary Height	32	36	30	
CDM-3942	Intermediate Height	39	36	30	
CDM-4242	Adult Height	42	36	30	

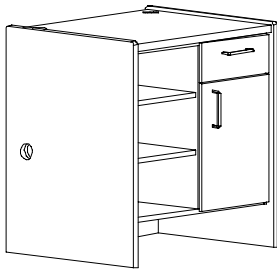

Shown Adult &amp; Elementary

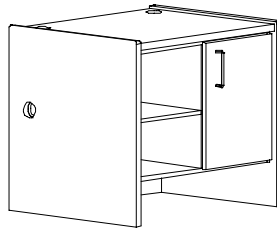

### Right Cupboard Open Shelf Unit

On the right side, the adult and intermediate units will be supplied with a locking box drawer and a cupboard space with two (2) adjustable shelves. The elementary unit will be supplied with a cupboard unit with (1) adj. shelf. The left side of the unit will be open adj. shelving. The adult and intermediate height units will be supplied with (2) adj. shelves, and the elementary height unit will be supplied with (1) adj. shelf. This unit will be supplied with (2) grommets located at each end of the work surface unless otherwise specified. The shelf is 15-5/8"W x 23"D x 3/4"T. The box drawer is 14-7/8"W x 18"D x 5-1/4"H.

Catalog #	Description	Height"	Width"	Depth"	Price
CDM-3243	Elementary Height	32	36	30	
CDM-3943	Intermediate Height	39	36	30	
CDM-4243	Adult Height	42	36	30	

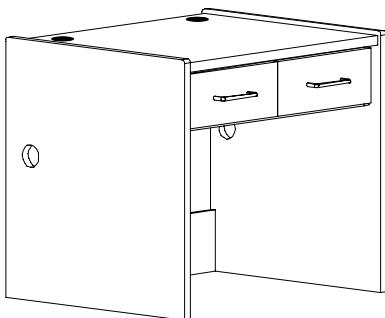

### Double Drawer Knee Space Unit

Each unit is supplied with two (2) lockable equal-width drawers each measuring 14-7/8"W x 18"D x 5-1/4"H. Inside measures 34"W x 27-1/2"D. This unit will be supplied with two (2) grommets located at each end of the work surface unless otherwise specified.

Catalog #	Description	Height"	Width"	Depth"	Price
CDM-3209	Elementary Height	32	36	30	
CDM-3909	Intermediate Height	39	36	30	
CDM-4209	Adult Height	42	36	30	

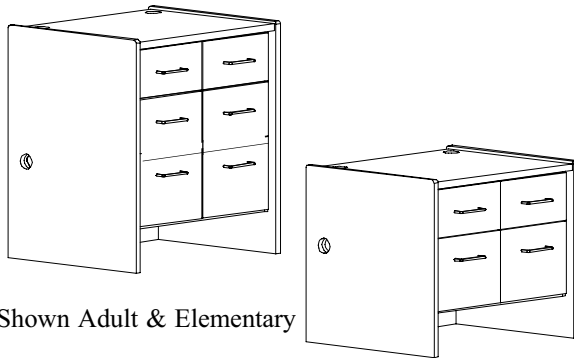

Shown Adult & Elementary

### Double Drawer Stack Unit

This unit consist of a double stack of drawers. The adult height unit takes four (4) files drawers and two (2) box drawers. The intermediate unit takes four (4) file drawers. The elementary takes two (2) file drawers and two (2) box drawers. The box drawer is 14-7/8"W x 18"D x 5-1/4"H. The file drawer is 14-7/8"W x 18"D x 10.5"H. Supplied with two (2) grommets located at each end of the work surface unless otherwise specified.

Catalog #	Description	Height"	Width"	Depth"	Price
CDM-3229	Elementary Height	32	36	30	
CDM-3929	Intermediate Height	39	36	30	
CDM-4229	Adult Height	42	36	30	

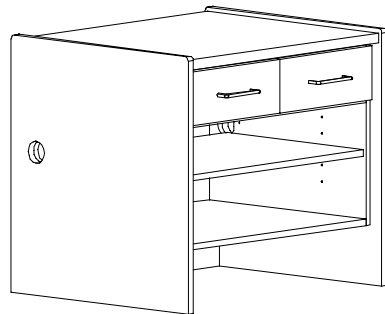

### Double-Drawer Open Shelf Unit

Each unit is supplied with two equal-width locking drawers, each measuring 14-7/8"W x 18"D x 5-1/4"H over open shelving. Adult and Intermediate height units will be supplied with two full-depth adjustable shelves. Elementary height units will be supplied with one shelf. The shelf is 32-1/4"W x 23"D x 3/4"T. Supplied with two (2) grommets located at each end of the work surface unless otherwise specified.

Catalog #	Description	Height"	Width"	Depth"	Price
CDM-3237	Elementary Height	32	36	30	
CDM-3937	Intermediate Height	39	36	30	
CDM-4237	Adult Height	42	36	30	

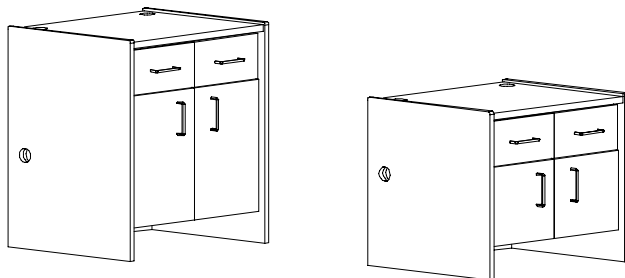

Shown Adult & Elementary

### Double Drawer Cupboard Unit

Unit is supplied with two equal width box drawers, each measuring 14-7/8"W x 18"D x 5-1/4"H. These drawers are mounted over the cupboard storage space. Adult and Intermediate units have 2 adjustable shelves. Elementary unit has 1 adjustable shelf. The shelf is 34-1/4"W x 23"D x 3/4"T. Supplied with two (2) grommets located at each end of the work surface unless otherwise specified.

Catalog #	Description	Height"	Width"	Depth"	Price
CDM-3238	Elementary Height	32	36	30	
CDM-3938	Intermediate Height	39	36	30	
CDM-4238	Adult Height	42	36	30	

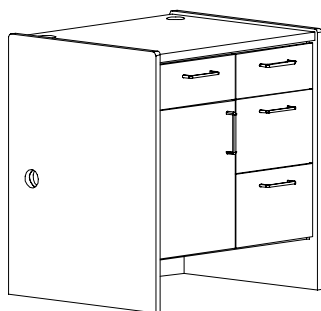

Shown Adult &  
Elementary

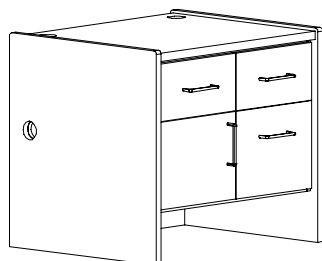

### Double Drawer, *Left* Cupboard & File Unit

The left side all heights will have (1) locking box drawer over a cupboard storage area. On the right side, the adult height unit will have (1) locking box drawer, two (2) file drawers, the intermediate will have (2) file drawers, and the elementary will have (1) locking box drawer and (1) file drawer. The adult and intermediate will have (2) adjustable shelves and the elementary will have (1) adjustable shelf. The box drawers are 14-7/8"W x 18"D x 5-1/4"H. The file drawers are 14-7/8"W x 18"D x 10-1/2"H. The shelf is 15-5/8"W x 23"D x 3/4"T. Supplied with (2) grommets located at each end of the work surface unless otherwise specified.

Catalog #	Description	Height"	Width"	Depth"	Price
CDM-3254	Elementary Height	32	36	30	
CDM-3954	Intermediate Height	39	36	30	
CDM-4254	Adult Height	42	36	30	

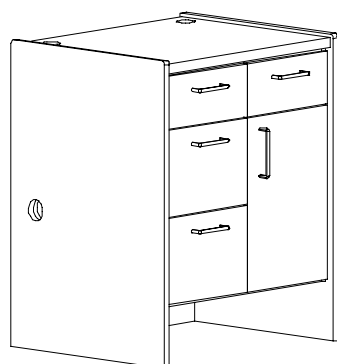

Shown Adult & Elementary

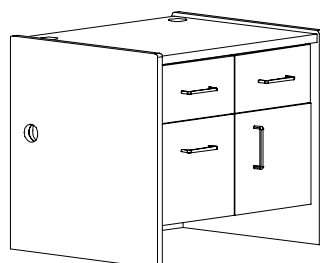

### Double Drawer, *Right* Cupboard & File Unit

The right side all heights will have (1) locking box drawer over a cupboard storage area. On the left side, the adult height unit will have one (1) locking box drawer, (2) file drawers, the intermed. will have (2) file drawers, and the elementary will have (1) locking box drawer and (1) file drawer. The adult & intermed. will have (2) adjustable shelves and the elementary will have (1) adjustable shelf. The box drawers are 14-7/8"W x 18"D x 5-1/4"H. The file drawers are 14-7/8"W x 18"D x 10-1/2"H. The shelf is 15-5/8"W x 23"D x 3/4"T. Supplied with (2) grommets located at each end of the work surface unless otherwise specified.

Catalog #	Description	Height"	Width"	Depth"	Price
CDM-3241	Elementary Height	32	36	30	
CDM-3941	Intermediate Height	39	36	30	
CDM-4241	Adult Height	42	36	30	

*"The only person who is educated  
is the one who has learned how to learn..."*  
*Carl R. Rogers*

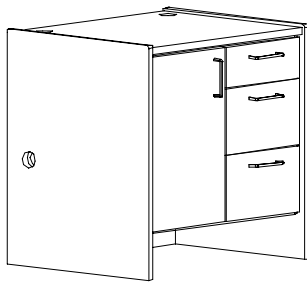

Shown Adult & Elementary

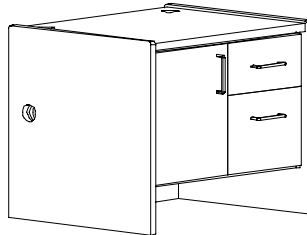

### File Drawer *Left* Cupboard Unit

The cupboard unit will be on the left side, the drawer stack will be on the right side. Each adult height unit will have (1) box drawer, (2) file drawers and (2) adjustable shelves. Intermed. height units will have (2) file drawers and (2) adjustable shelves. Elem. height units have one (1) box drawer, (1) file drawer and (1) adjustable shelf. The top drawer and cupboard door will receive a lock. The box drawers are 14-7/8"W x 18"D x 5-1/4"H. The file drawers are 14-7/8"W x 18"D x 10-1/2"H. The shelf is 15-5/8"W x 23"D x 3/4"T. This unit will be supplied with (2) grommets located at each end of the work surface unless otherwise specified.

Catalog #	Description	Height"	Width"	Depth"	Price
CDM-3240	Elementary height	32	36	30	
CDM-3940	Intermediate height	39	36	30	
CDM-4240	Adult height	42	36	30	

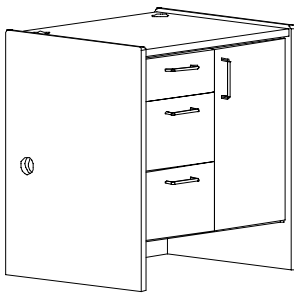

Shown Adult & Elementary

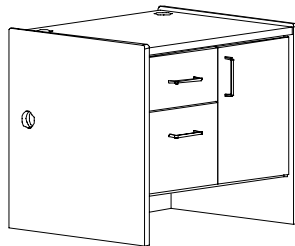

### File Drawer *Right* Cupboard Unit

The drawer stack will be on the left side and the cupboard unit will be on the right side. Each adult height units will have (1) box drawer, (2) file drawers and (2) adjustable shelves. Intermed. height units will have (2) file drawers and (2) adjustable shelves. Elem. height units have (1) box drawer, (1) file drawer and (1) adjustable shelf. The top drawer and cupboard door will receive a lock. The box drawers are 14-7/8"W x 18"D x 5-1/4"H. The file drawers are 14-7/8"W x 18"D x 10-1/2"H. The shelf is 15-5/8"W x 23"D x 3/4"T. This unit will be supplied with (2) grommets located at each end of the work surface unless otherwise specified.

Catalog #	Description	Height"	Width"	Depth"	Price
CDM-3239	Elementary height	32	36	30	
CDM-3939	Intermediate height	39	36	30	
CDM-4239	Adult height	42	36	30	

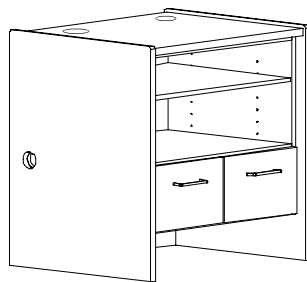

Shown Adult & Elementary

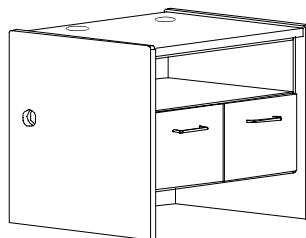

### Two-Drawer File Open Top Shelf Unit

Each unit is an Open Shelf Unit with two letter file drawers. Adult and Intermediate height units are supplied with one full-depth, adjustable shelf. Elementary height units will not have an adjustable shelf. The file drawers are 14-7/8"W x 18"D x 10-1/2"H. The shelf is 15-5/8"W x 23"D x 3/4"T. This unit will be supplied with (2) grommets located at each end of the work surface unless otherwise specified.

Catalog #	Description	Height"	Width"	Depth"	Price
CDM-3214	Elementary height	32	36	30	
CDM-3914	Intermediate height	39	36	30	
CDM-4214	Adult height	42	36	30	

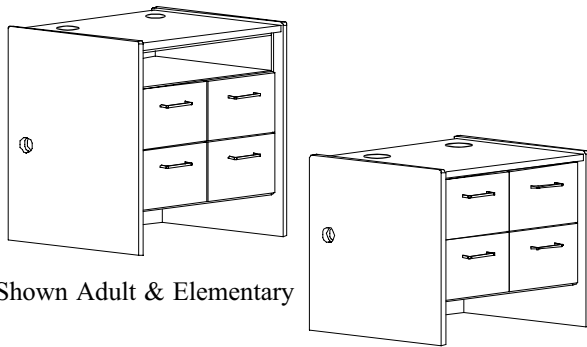

Shown Adult &amp; Elementary

### Four-Drawer File Open Top Shelf Unit

Each unit is an Open Shelf Unit with four letter file drawers. Adult and Intermediate height units have open storage provided above drawers measuring. Elementary height units will not have open storage. The file drawers are 14-7/8"W x 18"D x 10-1/2"H.

Catalog #	Description	Height"	Width"	Depth"	Price
CDM-3215	Elementary height	32	36	30	
CDM-3915	Intermediate height	39	36	30	
CDM-4215	Adult height	42	36	30	

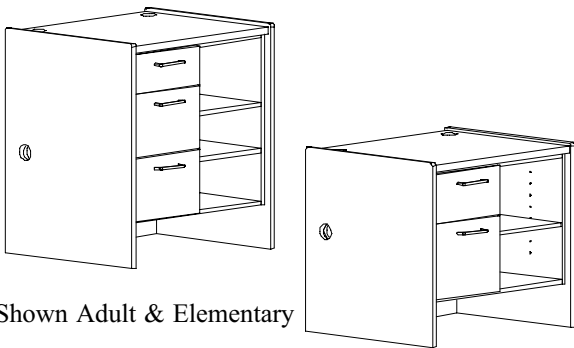

Shown Adult &amp; Elementary

### Left File Drawer Open Side Shelf Unit

The drawer stack will be on the left side and the open shelf will be on the right. Adult units have (1) lockable box drawer, 2 file drawers, and 2 adjustable shelves in the open space. Intermediate units have 2 file drawers and 2 adjustable shelves. Elementary units have 1 box drawer, 1 file drawer and 1 adjustable shelf. The box drawers are 14-7/8"W x 18"D x 5-1/4"H. The file drawers are 14-7/8"W x 18"D x 10-1/2"H. The shelf is 15-5/8"W x 23"D x 3/4"T

Catalog #	Description	Height"	Width"	Depth"	Price
CDM-3244	Elementary height	32	36	30	
CDM-3944	Intermediate height	39	36	30	
CDM-4244	Adult height	42	36	30	



Shown Adult &amp; Elementary

### Right File Drawer Open Side Shelf Unit

The drawer stack will be on the right side and the open shelf will be on the left. Adult units have (1) lockable box drawer, 2 file drawers, and 2 adjustable shelves in the open space. Intermediate units have 2 file drawers and 2 adjustable shelves. Elementary units have 1 box drawer, 1 file drawer and 1 adjustable shelf. The box drawers are 14-7/8"W x 18"D x 5-1/4"H. The file drawers are 14-7/8"W x 18"D x 10-1/2"H. The shelf is 15-5/8"W x 23"D x 3/4"T

Catalog #	Description	Height"	Width"	Depth"	Price
CDM-3245	Elementary height	32	36	30	
CDM-3945	Intermediate height	39	36	30	
CDM-4245	Adult height	42	36	30	

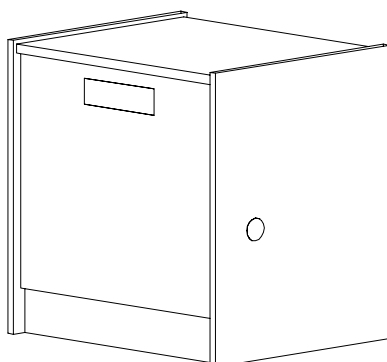

### Book Return Unit

Inside dimensions are 34"W x 27-1/2"D. The front panel will have a 3"H x 12"W book-return slot, fully edgebanded, with an internal wood chute so as to allow gentle deposit of books into book truck. A rear-mounted 3/4"T edgebanded wood book chute allows for the gentle deposit of reading materials. (BT-D39 for adult & intermediate height units or BT-D32 for elementary-height units).

See Mobile Units for Depressible Book Trucks

Catalog #	Description	Height"	Width"	Depth"	Price
CDM-3205	Elementary height	32	36	30	
CDM-3905	Intermediate height	39	36	30	
CDM-4205	Adult height	42	36	30	

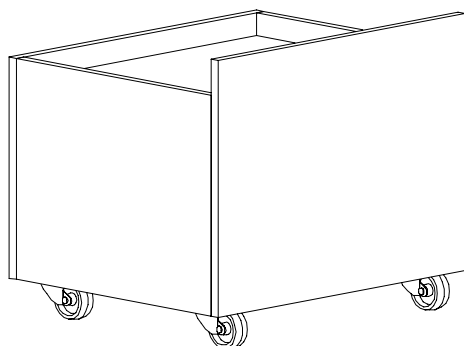

### Depressible Book Truck

Each unit will have a depressible platform that will hold approximately 70 books. Each unit will have four 3" swivel casters mounted directly to a 3/4"T red oak veneer plywood bottom using 5/16" dia bolts with are received on the top size of plywood via T-nuts.

Catalog #	Description	Height"	Width"	Depth"	Price
BT-D32	Elementary height	22	26	22	
BT-D39	Adult height	29	26	22	

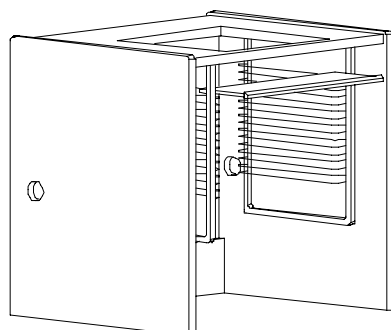

### NOVA Unit

Each unit will have a NOVA assembly mounted to the underside of the work surface to accommodate a computer monitor, and pullout keyboard tray. A corresponding 18-1/4"L x 18-1/4"W viewport will be machined into the continuous top to accommodate monitor viewing.

Catalog #	Description	Height"	Width"	Depth"	Price
CDM-3230	Elementary Height	32"	36"	30"	
CDM-3930	Intermediate Height	39"	36"	30"	
CDM-4230	Adult Height	42"	36"	30"	

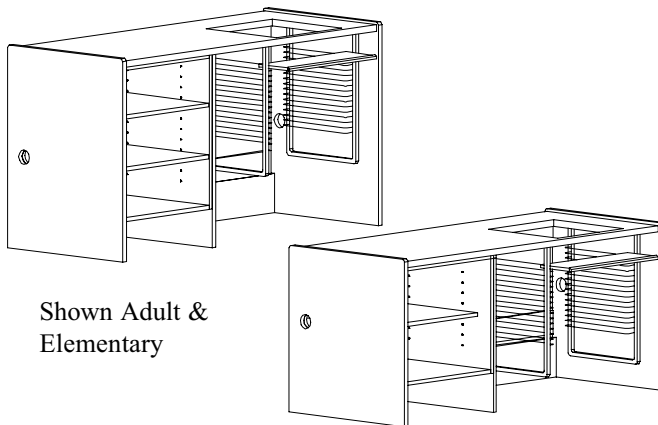

Shown Adult &  
Elementary

### NOVA and Open Shelf Unit

Each unit will have a NOVA assembly mounted to the underside of the work surface to accommodate a computer monitor, and pullout keyboard tray. A corresponding 18-1/4" L x 18-1/4" W viewport will be machined into the continuous top to accommodate monitor viewing. Each unit will also have adjustable shelves measuring 23-3/4" W x 27-1/2" D. Adult and Intermediate height units will have two (2) adjustable shelves and elementary height units will have one (1) adjustable shelf.

Catalog #	Description	Height"	Width"	Depth"	Price
CDM-3231	Elementary Height	32	72	30	
CDM-3931	Intermediate Height	39	72	30	
CDM-4231	Adult Height	42	72	30	

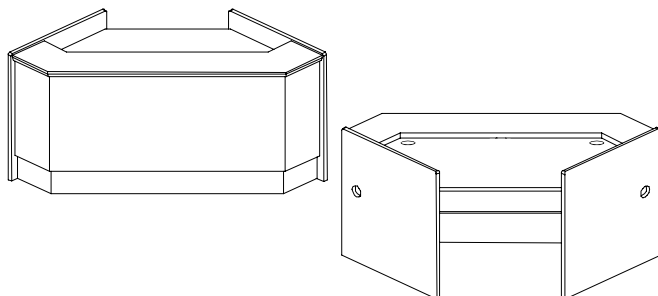

### Corner Patron Desk Unit

Each unit is designed to provide a 90-degree transition in any desk arrangement, while providing a corner work space with a recessed work surface and patron ledge. The recessed work surface will be mounted at 29"H using metal cleats. The working width for staff-side accessibility will be 35"W. This unit is supplied with two (2) work surface grommets located at each end unless otherwise specified. The patron ledge is 6" deep.

Catalog #	Description	Height"	Width"	Depth"	Price
CDM-3232	Elementary Height	32	78-5/8	30	
CDM-3932	Intermediate Height	39	78-5/8	30	
CDM-4232	Adult Height	42	78-5/8	30	

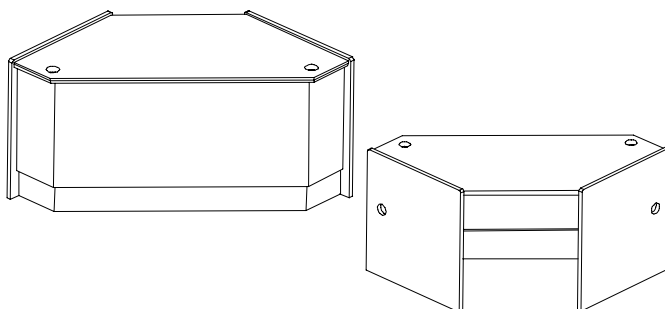

### Corner Desk Unit

Each unit is designed to provide a 90-degree transition in any desk arrangement, while providing a corner work space. The working width for staff-side accessibility will be 35"W. This unit is supplied with two (2) work surface grommets located at each end unless otherwise specified.

Catalog #	Description	Height"	Width"	Depth"	Price
CDM-3233	Elementary Height	32	78-5/8	30	
CDM-3933	Intermediate Height	39	78-5/8	30	
CDM-4233	Adult Height	42	78-5/8	30	



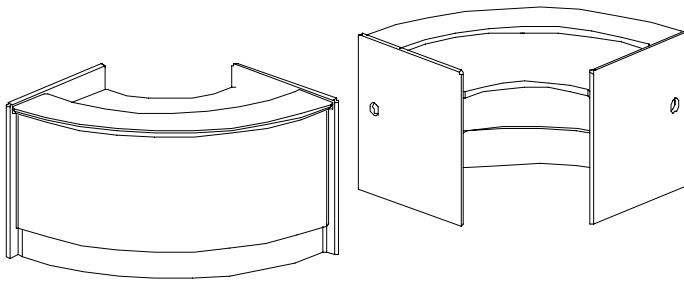

### Rounded Corner Patron Desk Unit

Each unit is designed to provide a radiused 90-degree transition in any desk arrangement, while providing a corner work space with a recessed work surface and patron ledge. The recessed work surface will be mounted at 29"H using metal cleats. The working width for staff-side accessibility will be 35"W. This unit is supplied with two (2) work surface grommets located at each end unless otherwise specified. The patron ledge is 6"D.

Catalog #	Description	Height"	Width"	Depth"	Price
CDM-3250	Elementary Height	32	78-5/8"	30	
CDM-3950	Intermediate Height	39	78-5/8"	30	
CDM-4250	Adult Height	42	78-5/8"	30	

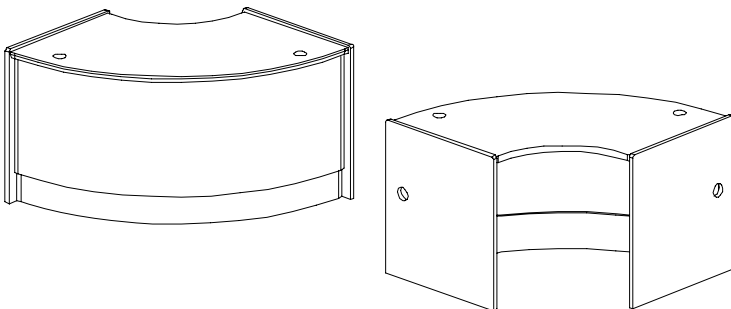

### Rounded Corner Desk Unit

Each unit is designed to provide a radiused 90-degree transition in any desk arrangement, while providing a corner work space. The working width for staff-side accessibility will be 35"W. This unit is supplied with two (2) work surface grommets located at each end unless otherwise specified.

Catalog #	Description	Height"	Width"	Depth"	Price
CDM-3251	Elementary Height	32	78-5/8"	30	
CDM-3951	Intermediate Height	39	78-5/8"	30	
CDM-4251	Adult Height	42	78-5/8"	30	

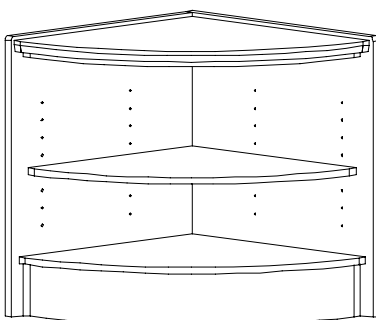

### 90 Degree Radiused Corner Open Shelf Unit

Each unit will be triangular, with a radiused, open-face design and will be used to form a 90-degree transition in any desk arrangement. Adult and Intermediate height units will be supplied with two (2) adjustable shelves and elementary height units will be supplied with one (1) adjustable shelf. Open shelf corner units do not provide for wire access. Shelves will be accessible from patron side of circulation desk.

Catalog #	Description	Height"	Width"	Depth"	Price
CDM-3228	Elementary Height	32	30	30	
CDM-3928	Intermediate Height	39	30	30	
CDM-4228	Adult Height	42	30	30	

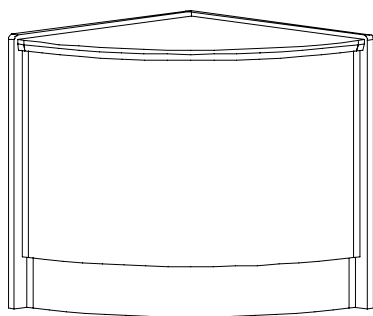
**90 Degree Radiused Closed Corner Unit**

Each unit will be triangular, with a radiused, closed-face design and will be used to form a 90-degree transition in any desk arrangement. This unit is supplied with an internal wire manager unless otherwise specified.

Catalog #	Description	Height"	Width"	Depth"	Price
CDM-3226	Elementary Height	32	30	30	
CDM-3926	Intermediate Height	39	30	30	
CDM-4226	Adult Height	42	30	30	

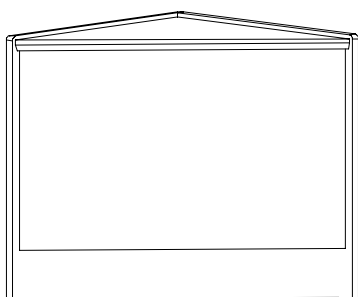
**90 Degree Flat Corner Unit**

Each unit will be triangular with a flat closed -front design and will be used to form a 90-degree transition in any desk arrangement. This unit is supplied with an internal wire manager unless otherwise specified.

Catalog #	Description	Height"	Width"	Depth"	Price
CDM-3252	Elementary Height	32	30	30	
CDM-3952	Intermediate Height	39	30	30	
CDM-4252	Adult Height	42	30	30	

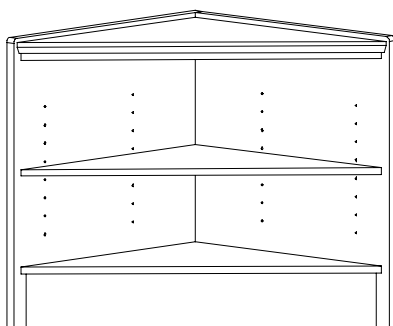
**90 Degree Flat Corner Open Shelf Unit**

Each unit will be triangular with an flat open-front design and will be used to form a 90-degree transition in any desk arrangement. Each unit will have one (1) fixed base shelf and adjustable shelves according to unit height. Adult and Intermediate height units will be supplied with two (2) adjustable shelves and elementary height units will be supplied with one (1) adjustable shelf. Shelves will be accessible from patron side of circulation desk. Open shelf corner units do not provide for wire access.

Catalog #	Description	Height"	Width"	Depth"	Price
CDM-3223	Elementary Height	32	36	30	
CDM-3923	Intermediate Height	39	36	30	
CDM-4223	Adult Height	42	36	30	

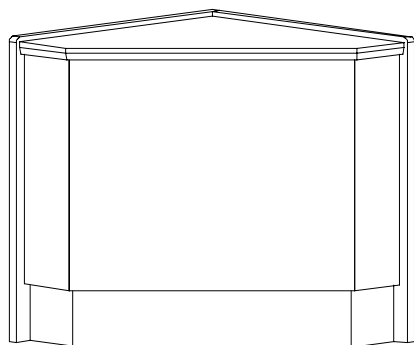

### 90 Degree Closed Corner Unit

Each unit will be triangular with an angled, closed-face design and will be used to form a 90-degree transition in any desk arrangement. This unit is supplied with an internal wire manager unless otherwise specified.

Catalog #	Description	Height"	Width"	Depth"	Price
CDM-3216	Elementary Height	32	30	30	
CDM-3916	Intermediate Height	39	30	30	
CDM-4216	Adult Height	42	30	30	

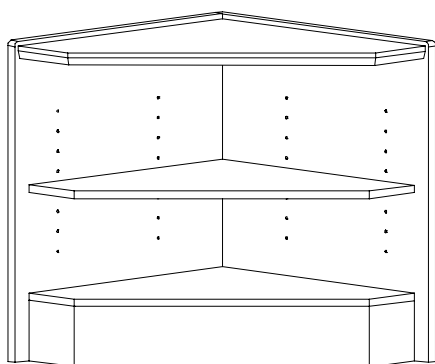

### 90 Degree Corner Open Shelf Unit

Each unit will be triangular with an angled open-front design and will be used to form a 90-degree transition in any desk arrangement. Each unit will have one (1) fixed base shelf and adjustable shelves according to unit height. Adult and Intermediate height units will be supplied with two (2) adjustable shelves and elementary-height units will be supplied with one (1) adjustable shelf. Shelves will be accessible from patron side of circulation desk. Open shelf corner units do not provide for wire access.

Catalog #	Description	Height"	Width"	Depth"	Price
CDM-3217	Elementary Height	32	30	30	
CDM-3917	Intermediate Height	39	30	30	
CDM-4217	Adult Height	42	30	30	

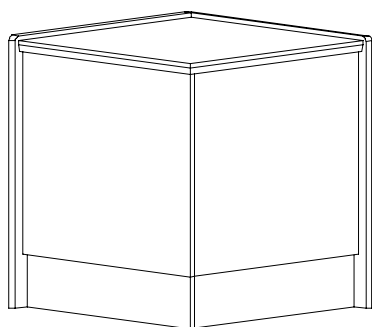

### Square Corner Unit

Each unit will be square, closed-face design and will be used to form a 90-degree transition in any desk arrangement. This unit is supplied with an internal wire manager unless otherwise specified.

Catalog #	Description	Height"	Width"	Depth"	Price
CDM-3224	Elementary Height	32	30	30	
CDM-3924	Intermediate Height	39	30	30	
CDM-4224	Adult Height	42	30	30	

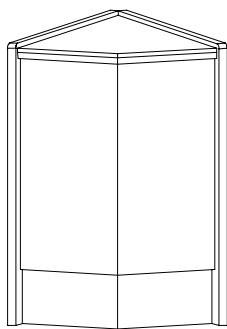

### 45 Degree Closed Corner Unit

Each unit will be triangular, with an angled, closed-face design and will be used to form a 45-degree transition in any desk arrangement. This unit is supplied with an internal wire manager unless otherwise specified.

Catalog #	Description	Height"	Width"	Depth"	Price
CDM-3225	Elementary Height	32	21	30	
CDM-3925	Intermediate Height	39	21	30	
CDM-4225	Adult Height	42	21	30	

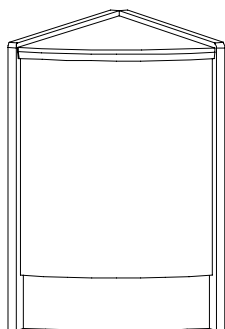

### 45 Degree Radiused Corner Unit

Each unit will be triangular, with a radiused, closed-face design and will be used to form a 45-degree transition in any desk arrangement. This unit is supplied with an internal wire manager unless otherwise specified.

Catalog #	Description	Height"	Width"	Depth"	Price
CDM-3227	Elementary Height	32	21	30	
CDM-3927	Intermediate Height	39	21	30	
CDM-4227	Adult Height	42	21	30	

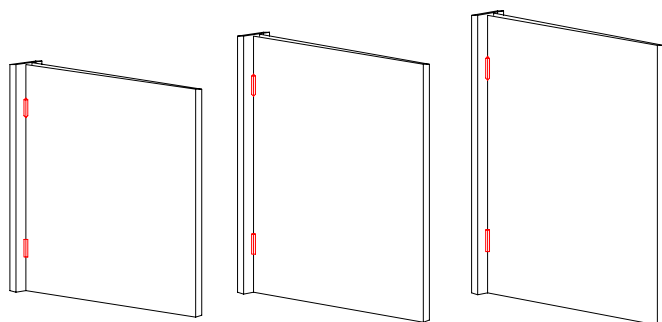

### Swinging Gate

When specified, gates will be mounted to walls or finished end panels on the circulation desk. Gates will be constructed using banded, matching 1" T veneer-core plywood in widths of up to 36". Single-action gates are supplied with stop moulding. **The desired width of the gate and hinge type (single or double action) MUST BE quoted in advance and specified on the order.**

Catalog #	Description	Height"	Width"	Thickness"	Price
CDM-1G 32	Elementary height, single action hinge	32	Specify	1	based on width
CDM-2G 32	Elementary height, double action hinge	32	Specify	1	based on width
CDM-1G 39	Intermediate height, single action hinge	39	Specify	1	based on width
CDM-2G 39	Intermediate height, double action hinge	39	Specify	1	based on width
CDM-1G 42	Adult height, single action hinge	42	Specify	1	based on width
CDM-2G 42	Adult height, double action hinge	42	Specify	1	based on width

### Planning For & Ordering Edgeband for ModuFlex Series

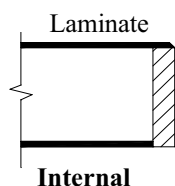

Staff side of the work surface comes with a 1/4" internal solid red oak edgeband.

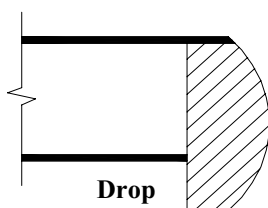
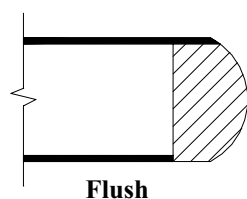

When choosing an edgeband for patron side you can either have the edgeband placed flush with the bottom of the top or dropped below the bottom.

Work surfaces will be constructed with a 3/4" T solid red oak edgeband and can be ordered with any one of a variety of internal or external edgeband details.

See below for edge details for the ModuFlex Series.

#### Edge Details for ModuFlex Series

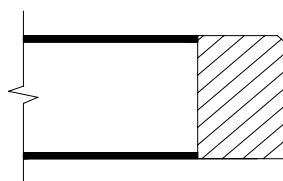

1 1/4" thick top (External)  
**Montana Flush**

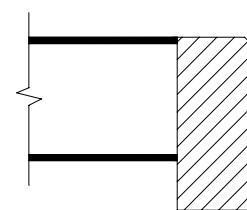

1 1/4" thick top (External)  
**Montana Drop**

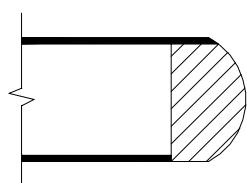

1 1/4" thick top (Internal)  
**Shallow Bullnose Flush**

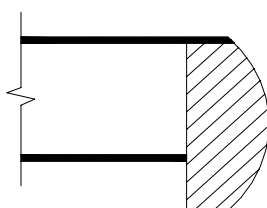

1 1/4" thick top (Internal)  
**Shallow Bullnose Drop**

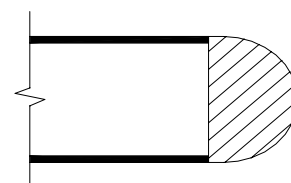

1 1/4" thick top (External)  
**Bullnose Flush**

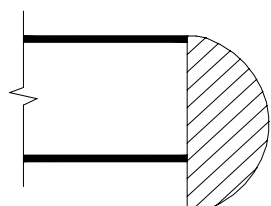

1 1/4" thick top (External)  
**Bullnose Drop**

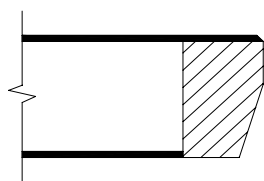

1 1/4" thick top (Internal)  
**Premier Flush**

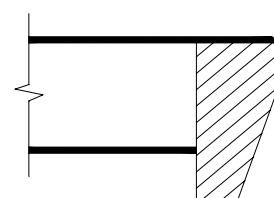

1 1/4" thick top (Internal)  
**Premier Drop**

## GENERAL SPECIFICATIONS

The Orbis Series is designed to blend high utility with the warmth of beautiful curves.

## CONSTRUCTION AND MATERIALS

Each desk unit end panel will be constructed from 1" T multi-ply, cross-grain, plain-slice face veneer plywood. Front panels are 3/4" T multi-ply, cross-grain, rift-cut faced veneer plywood. All other panels will be multi-ply, cross-grain, plain-slice face veneer plywood.

**The exposed edges** of all unit panels will be banded with 1/4" T matching solid red oak. All *end panel edges* will be banded with 1/2" T matching solid wood.

**Front panels** will be matched for color and grain characteristics to provide uniformity of grain across the entire desk arrangement. Each unit is constructed with a 4" H x 3" D toe space covered with flat black laminate on the patron and staff side.

**Adjustable shelves** will be constructed from matching 3/4" T multi-ply, cross-grain, plain-slice face veneer plywood. Shelves will be adjustable on no greater than 2" centers supported by 1/4" shelf pins. The exposed edges of all shelves will be banded with 1/4" T eased matching solid red oak.

**Individual tops** will be 1-1/8" T particleboard\* with .050" high pressure laminate on the face and .020" backer sheet on the underside of the top. Laminate color is chosen from supplied color samples. The entire top will be internally banded with 1/4" T matching solid red oak on the staff side and 3/4" T matching solid red oak on the patron side.

## HARDWARE

All wire grommets through the work surface will be 3" Dia. All units except the Book Return will be constructed with a wire chase in the base of the unit with a removable top for ease of access. Access between unit wire chases is provided through 3" grommets in the base of the each end panel.

Full width and box drawers will be of English dovetail design and will be constructed using 1/2" thick solid northern grown red oak with a 1/4" thick veneer core plywood bottom.

The box drawer is 14-7/8" W x 18" D x 5-1/4" H. The single drawer is 33-1/2" x 18" D x 5-1/4" H.

**Drawer glides, pulls** All drawers will be constructed to an overall depth of 18" and will be mounted on 18" full-extension, ballbearing glides with a load rating of 100 pounds per pair. On a given desk arrangement, all locks will be keyed identically. All doors will be hung with 110-degree opening, self-closing Salice hinges (180-degree available if specified) and and Salice Smove(tm) door cushions.

Pulls for drawers will be satin chrome 5/16" diameter wire pulls. Pull substitutions may be made at customer's request [an additional cost may occur].

All door units will be provided with locks. Pulls for both doors and drawers will be satin chrome 5/16" diameter wire pulls. Pull substitutions may be made at customer's request [an additional cost may occur].

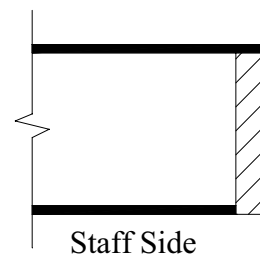

Staff side work surfaces are internally banded with 1/4" T solid red oak.

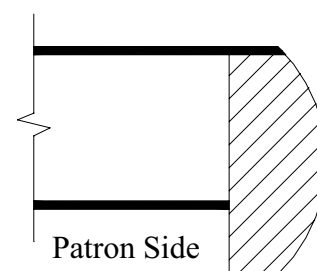

The Patron side is banded with 3/4" T solid red oak with a Bullnose Drop edge detail.

**FINISH** - See page 5 for finish specifications.

Visit our website at [www.russwood.net](http://www.russwood.net)

**The *Orbis Series* circulation desks feature the stylish rounded corner patron service units with work surfaces permanently attached**

**Orbis Classic**

Includes these units

CDO-2901

CDO-2903

CDO-2905

CDO-2907

BT-D29

**Orbis Major**

Includes these units

CDO-2901

CDO-2903

CDO-2905

CDO-2907

CDO-2908

BT-D29

If you desire a service unit that is not shown here then you can choose from the many others that follow.

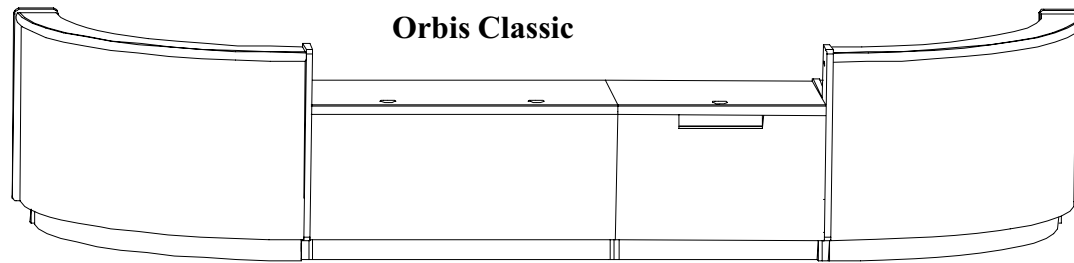

**Orbis Classic**

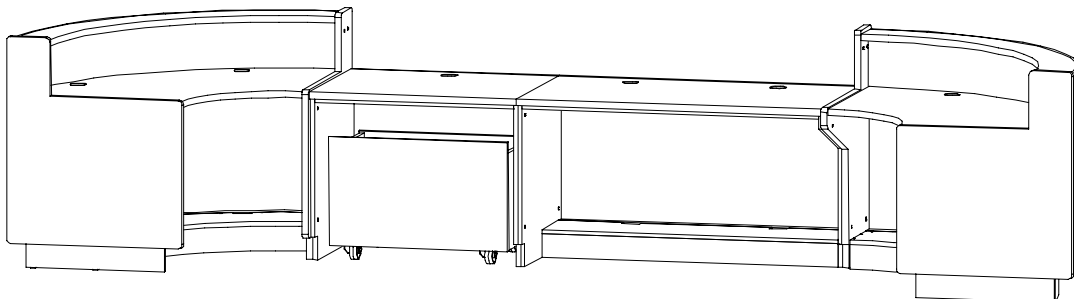

**Orbis Major**

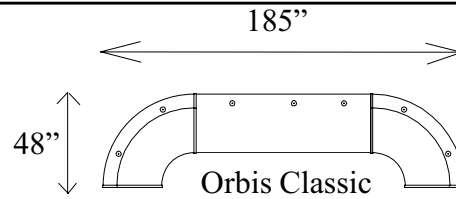
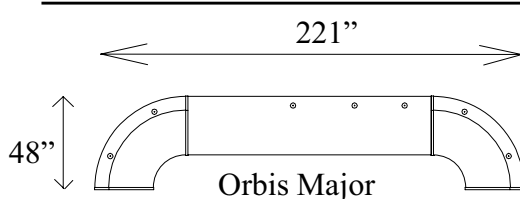
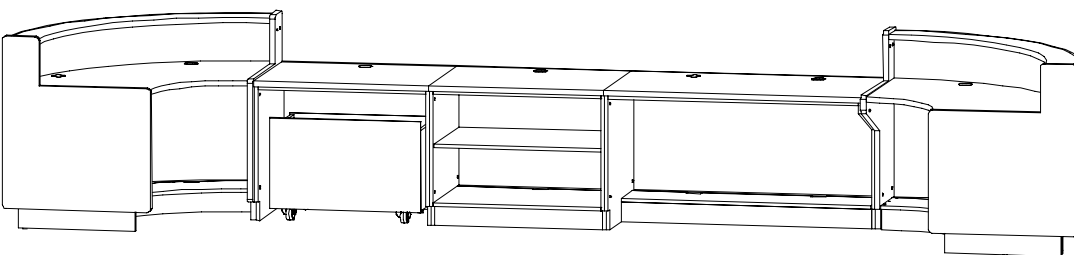
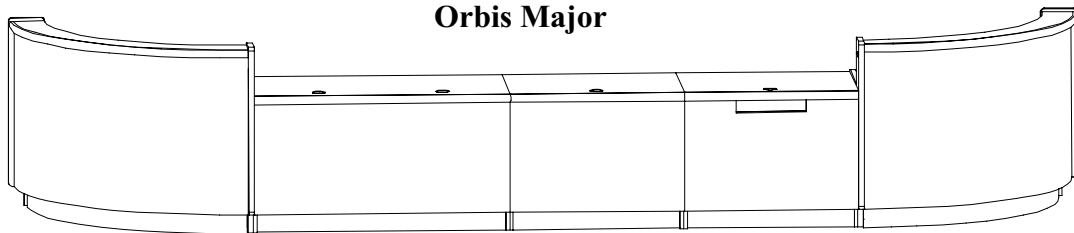

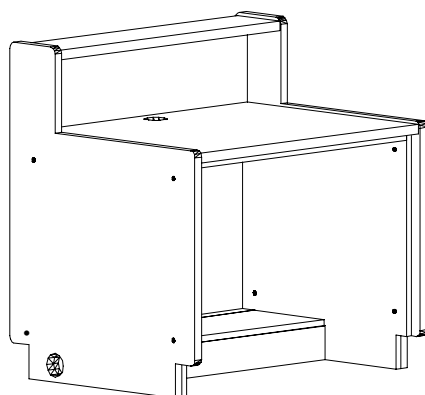

### Patron Desk Unit

The work surface of this unit is 29"H. The patron ledge is 7" deep. A grommet is located at the midpoint of the top. This unit also includes a wire chase in the base with a removable access cover for easy accessibility.

Catalog #	Description	Over All Height "	Work Surface Ht"	Width"	Depth"	Price
CDO-2912	Patron Desk Unit	39-1/4	29	38	30-1/2	

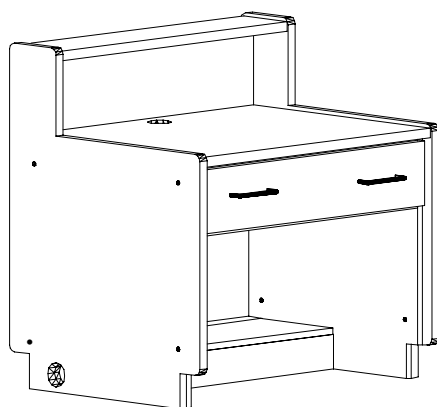

### Patron Single Drawer Knee Space Unit

The work surface of this unit is 29"H. The patron ledge is 7" deep. A grommet is located at the midpoint of the top. This unit also includes a wire chase in the base with a removable access cover for easy accessibility. Each unit will have one (1) drawer measuring 33-1/2"W x 18"D x 5-1/4"H.

Catalog #	Description	Over All Height "	Work Surface Ht"	Width"	Depth"	Price
CDO-2913	Patron Sing Drawer Knee Space Unit	39-1/4	29	38	30-1/2	

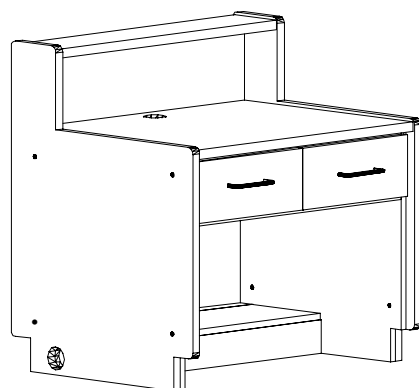

### Patron Double Drawer Knee Space Unit

The work surface of this unit is 29"H. The patron ledge is 7" deep. A grommet is located at the midpoint of the top. This unit also includes a wire chase in the base with a removable access cover for easy accessibility. Each unit will have two (2) equal-width drawers measuring 14-7/8"W x 18"D x 5-1/4"H.

Catalog #	Description	Over All Height "	Work Surface Ht"	Width"	Depth"	Price
CDO-2910	Patron Doub Drawer Knee Space Unit	39-1/4	29	38	30-1/2	



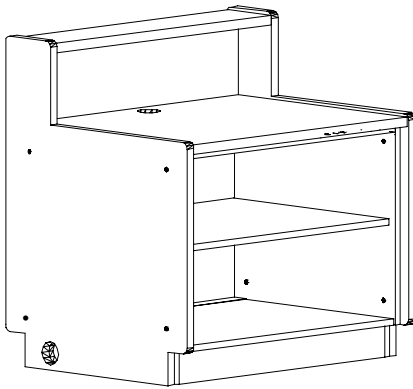

### Patron Open Shelf Unit

The work surface of this unit is 29"H. The patron ledge is 7" deep. A grommet is located at the midpoint of the top. This unit also includes a wire chase in the base with a removable access cover for easy accessibility. The open shelf compartment has one adjustable shelf. The shelf is 34-1/4"W x 26"D x 3/4"T.

Catalog #	Description	Over All Height "	Work Surface Ht"	Width"	Depth"	Price
CDO-2911	Patron Open Shelf Unit	39-1/4	29	38	30-1/2	

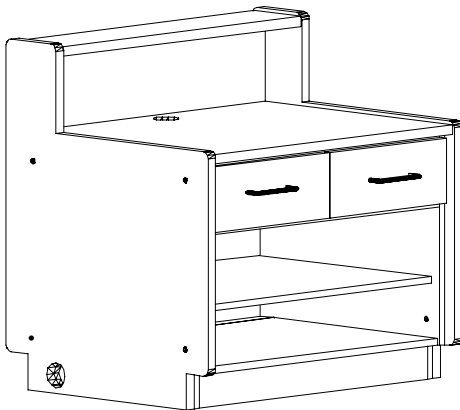

### Patron Double Drawer Open Shelf Unit

The work surface of this unit is 29"H. The patron ledge is 7" deep. A grommet is located at the midpoint of the top. This unit also includes a wire chase in the base with a removable access cover for easy accessibility. Each unit will have two (2) equal-width drawers measuring 14-7/8"W x 18"D x 5-1/4"H. The open shelf compartment has one adjustable shelf. The shelf is 34-1/4"W x 26"D x 3/4"T.

Catalog #	Description	Over All Height "	Work Surface Ht"	Width"	Depth"	Price
CDO-2909	Patron Doub Drawer Open Shelf Unit	39-1/4	29	38	30-1/2	

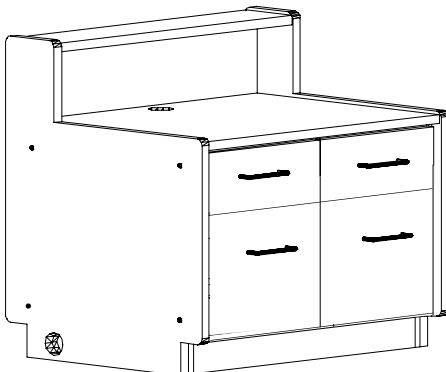

### Patron Drawer Unit

The work surface of this unit is 29"H. The patron ledge is 7" deep. A grommet is located at the midpoint of the top. This unit also includes a wire chase in the base. Drawers are removeable for access to wire chase. Each unit will have two (2) equal-width drawer stacks containing a box drawer and file drawer. Box drawers measure 14-7/8"W x 18"D x 5-1/4"H. File drawers measure 14-7/7"W x 18"D x 10-1/2"H.

Catalog #	Description	Over All Height "	Work Surface Ht"	Width"	Depth"	Price
CDO-2926	Patron Drawer Unit	39-1/4	29	38	30-1/2	

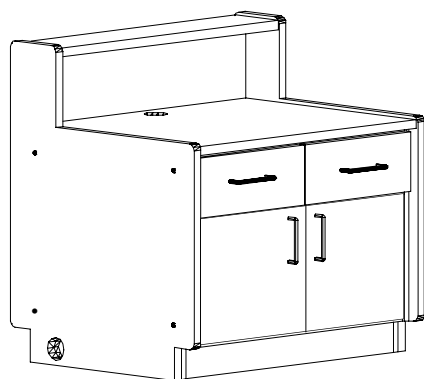

### Patron Double Drawer Cupboard Unit

The work surface of this unit is 29"H. The patron ledge is 7" deep. A grommet is located at the midpoint of the top. This unit also includes a wire chase in the base with a removable access cover for easy accessibility. Each unit will have two (2) box drawers measuring 14-7/8"W x 18"D x 5-1/4"H. The cupboard has one adjustable shelf. The shelf is 34-1/4"W x 26"D x 3/4"T.

Catalog #	Description	Over All Height "	Work Surface Ht"	Width"	Depth"	Price
CDO-2927	Patron Double Drawer Cupboard Unit	39-1/4	29	38	30-1/2	

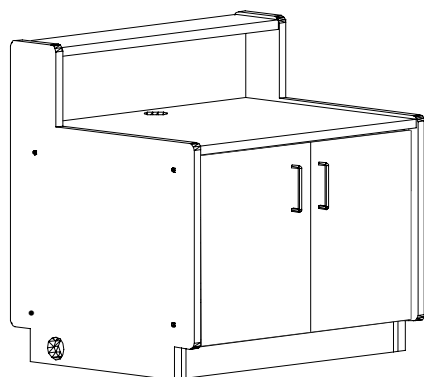

### Patron Cupboard Unit

The work surface of this unit is 29"H. The patron ledge is 7" deep. A grommet is located at the midpoint of the top. This unit also includes a wire chase in the base with a removable access cover for easy accessibility. The cupboard has one adjustable shelf. The shelf is 34-1/4"W x 26"D x 3/4"T.

Catalog #	Description	Over All Height "	Work Surface Ht"	Width"	Depth"	Price
CDO-2928	Patron Cupboard Unit	39-1/4	29	38	30-1/2	

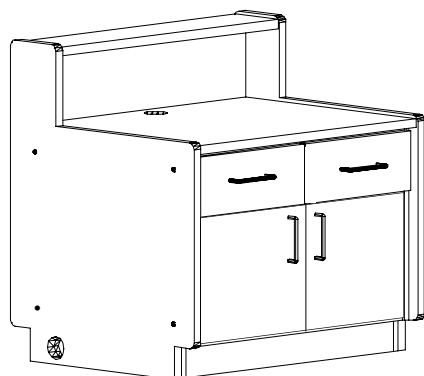

### Patron Single Drawer Cupboard Unit

The work surface of this unit is 29"H. The patron ledge is 7" deep. A grommet is located at the midpoint of the top. This unit also includes a wire chase in the base with a removable access cover for easy accessibility. Each unit will have 1 full width drawer measuring 33-1/2"W x 18"D x 5-1/4"H. The cupboard has one adjustable shelf. The shelf is 34-1/4"W x 26"D x 3/4"T.

Catalog #	Description	Over All Height "	Work Surface Ht"	Length"	Width"	Price
CDO-2914	Patron Single Drawer Cupboard	39-1/4	29	38	30-1/2	



### Open Shelf Unit

The work surface of this unit is 29"H. A grommet is located at the midpoint of the top. This unit also includes a wire chase in the base with a removable access cover for easy accessibility. The open shelf compartment has one adjustable shelf. The shelf is 34-3/8"W x 26"D x 3/4"T.

Catalog #	Description	Over All Height "	Work Surface Ht"	Width"	Depth"	Price
CDO-2908	Open Shelf Unit	29	29	36	30	



### Double Drawer Open Shelf Unit

The work surface of this unit is 29"H. A grommet is located at the midpoint of the top. This unit also includes a wire chase in the base with a removable access cover for easy accessibility. Each unit will have two (2) equal-width drawers measuring 14-7/8"W x 18"D x 5-1/4"H. The open shelf compartment has one adjustable shelf. The shelf is 34-1/4"W x 26"D x 3/4"T.

Catalog #	Description	Over All Height "	Work Surface Ht"	Width"	Depth"	Price
CDO-2929	Double Drawer Open Shelf Unit	29	29	36	30	

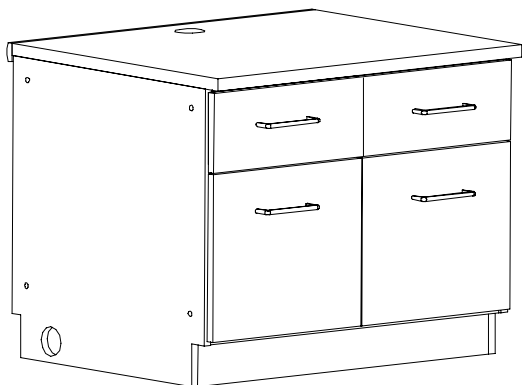

### File Drawer Unit

The work surface of this unit is 29"H. A grommet is located at the midpoint of the top. This unit also includes a wire chase in the base with a removable access cover for easy accessibility. Each unit will have two (2) equal-width drawer stacks containing a box drawer and file drawer. Box drawers measure 14-7/8"W x 18"D x 5-1/4"H. File drawers measure 14-7/8"W x 18"D x 10-1/2"H.

Catalog #	Description	Over All Height "	Work Surface Ht"	Width"	Depth"	Price
CDO-2930	Drawer Unit	29	29	36	30	

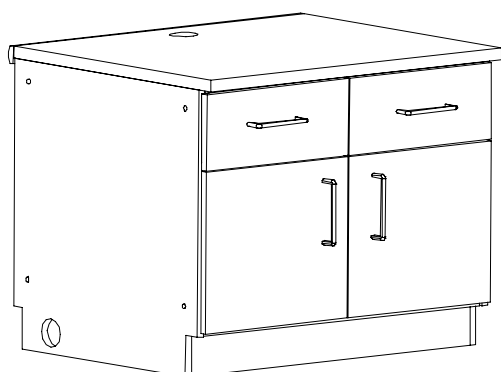

### Double Drawer Cupboard Unit

The work surface of this unit is 29"H. A grommet is located at the midpoint of the top. This unit also includes a wire chase in the base with a removable access cover for easy accessibility. Each unit will have two (2) box drawers measuring 14-7/8"W x 18"D x 5-1/4"H. The cupboard has one adjustable shelf. The shelf is 34-1/4"W x 26"D x 3/4"T.

Catalog #	Description	Over All Height "	Work Surface Ht"	Width"	Depth"	Price
CDO-2931	Double Drawer Cupboard Unit	29	29	36	30	

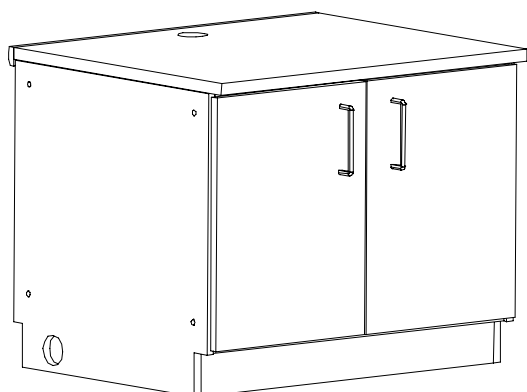

### Cupboard Unit

The work surface of this unit is 29"H. A grommet is located at the midpoint of the top. This unit also includes a wire chase in the base with a removable access cover for easy accessibility. The cupboard has one adjustable shelf. The shelf is 34-1/4"W x 26"D x 3/4"T.

Catalog #	Description	Over All Height "	Work Surface Ht"	Width"	Depth"	Price
CDO-2932	Cupboard Unit	29	29	36	30	

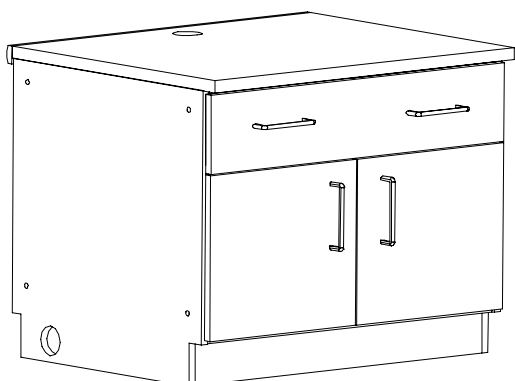

### Single Drawer Cupboard Unit

The work surface of this unit is 29"H. A grommet is located at the midpoint of the top. This unit also includes a wire chase in the base with a removable access cover for easy accessibility. Each unit will have 1 full width drawer measuring 31-1/2"W x 18"D x 5-1/4"H. The cupboard has one adjustable shelf. The shelf is 34-1/4"W x 26"D x 3/4"T.

Catalog #	Description	Over All Height "	Work Surface Ht"	Width"	Depth"	Price
CDO-2933	Single Drawer Cupboard Unit	29	29	36	30	

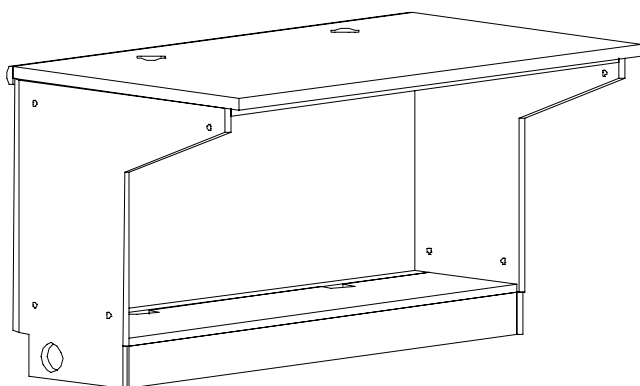

### Computer Desk Double Knee Space

This unit provides continuous knee space on both sides. The work surface of this unit is 29"H. Two grommets are located at the rear approximately one quarter from each side. This unit also includes a wire chase in the base with a removable access cover for easy accessibility.

NOTE: Knee space end panels only connect to knee space end panels.

Catalog #	Description	Over All Height "	Work Surface Ht"	Width"	Depth"	Price
CDO-2915	Double Knee Space Computer Desk	29	29	53	30	

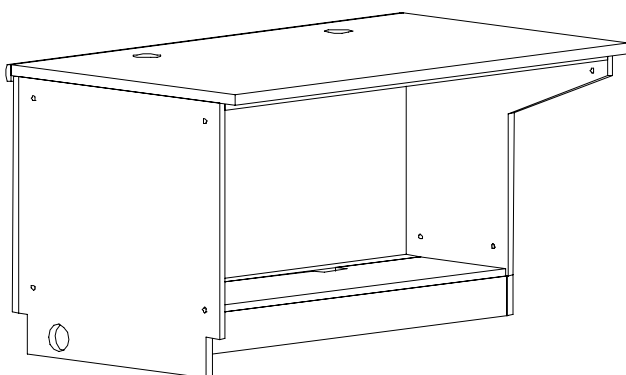

### Computer Desk Left Connector Right Knee Space

This unit provides knee space access on the right side. The work surface of this unit is 29"H. Two grommets are located at the rear approximately one quarter from each side. This unit also includes a wire chase in the base with a removable access cover for easy accessibility.

NOTE: Knee space end panels only connect to knee space end panels.

Catalog #	Description	Over All Height "	Work Surface Ht"	Width"	Depth"	Price
CDO-2905	Double Right Knee Computer Desk	29	29	53	30	

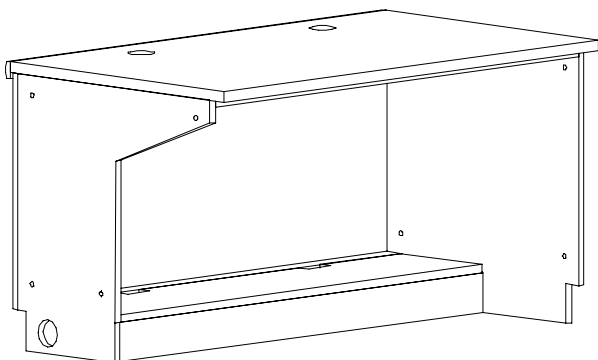

### Computer Desk Left Knee Space Right Connector

This unit provides knee space access on the left side. The work surface of this unit is 29"H. Two grommets are located at the rear approximately one quarter from each side. This unit also includes a wire chase in the base with a removable access cover for easy accessibility.

NOTE: Knee space end panels only connect to knee space end panels.

Catalog #	Description	Over All Height "	Work Surface Ht"	Width"	Depth"	Price
CDO-2906	Double Left Knee Computer Desk	29	29	53	30	

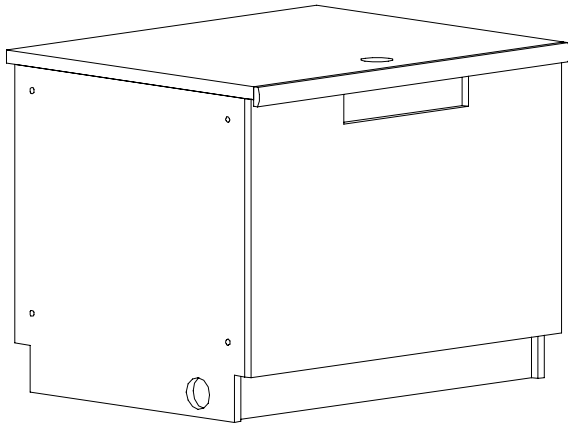

### Book Return

The work surface of this unit is 29"H. This unit also includes J-Channel wire management along the back of the unit. The front panel will have a 14"W x 3"H book-return slot, fully edge banded, with an internal wood chute so as to allow gentle deposit of books into book truck. The depressible book truck that is used with this unit BT-D29 is ordered separately.

Catalog #	Description	Over All Height "	Work Surface Ht"	Width"	Depth"	Price
CDO-2907	Book Return Unit	29	29	36	30	

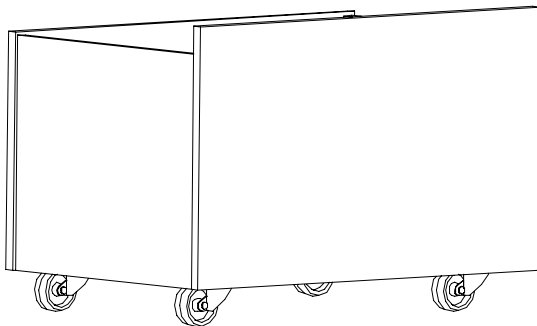

### Depressible Book Truck

Each unit will have a depressible platform that will hold approximately 70 books. Depressible book trucks employ a spring mechanism which allows for the gentle deposit of reading materials by reducing the distance a book must drop once deposited. Each unit will have four 3" swivel casters directly bolted to the bottom of the book truck to ensure stability.

Catalog #	Description	Over All Height "	Work Surface Ht"	Width"	Depth"	Price
BT-D29	Depressible Book Truck	20-15/16		31	21	

"Try not to have a good time...  
 ——— this is supposed to be educational."  
 ————— Charles M. Shultz

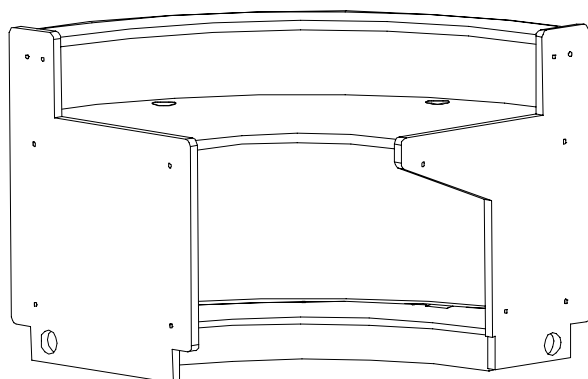

See unit CDO 2902 if Left finished end is desired.

**90 Degree Corner Patron Desk**  
**Left Connector Right Knee Space**

This unit provides continuous knee space on the right side. The work surface of this unit is 29"H. The patron ledge is 7" deep. Two grommets are located at the rear approximately one quarter from each side. This unit also includes a wire chase in the base with a removable access cover for easy accessibility.

NOTE: Knee space end panels only connect to knee space end panels.

Catalog #	Description	Over All Height "	Work Surface Ht"	Width"	Depth"	Price
CDO-2916	90° (R) Knee Corner Patron Desk	39-3/4	29	48	48	

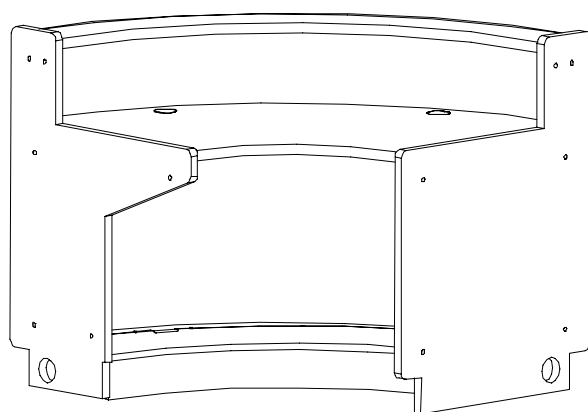

See CDO 2901 if Right Finished end is desired.

**90 Degree Corner Patron Desk**  
**Left Knee Space Right Connector**

This unit provides continuous knee space on left side. The work surface of this unit is 29"H. The patron ledge is 7" deep. Two grommets are located at the rear approximately one quarter from each side. This unit also includes a wire chase in the base with a removable access cover for easy accessibility.

NOTE: Knee space end panels only connect to knee space end panels.

Catalog #	Description	Over All Height "	Work Surface Ht"	Width"	Depth"	Price
CDO-2917	90° (L) Knee Corner Patron Desk	39-3/4	29	48	48	

---

*"They say that we are better educated than our parents' generation. What they mean is that we go to school longer. It is not the same thing."*  
*Richard Yates*

---

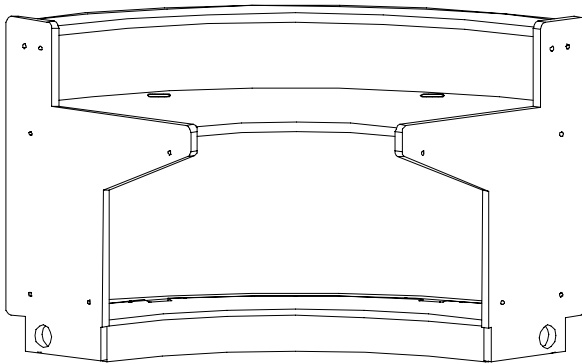

NOTE: Knee space end panels only connect to knee space end panels.

### 90 Degree Corner Patron Desk Double Knee Space

This unit provides continuous knee space on both sides. The work surface of this unit is 29"H. The patron ledge is 7" deep. Two grommets are located at the rear approximately one quarter from each side. This unit also includes a wire chase in the base with a removable access cover for easy accessibility.

Catalog #	Description	Over All Height "	Work Surface Ht"	Width"	Depth"	Price
CDO-2921	90° Double Knee Corner Patron	39-3/4	29	48	48	

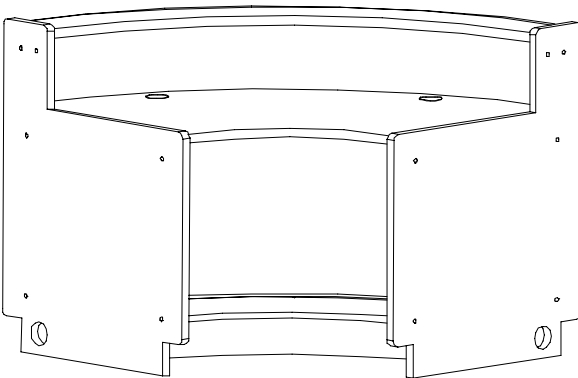

### 90 Degree Corner Patron Desk Double Connector

The work surface of this unit is 29"H. The patron ledge is 7" deep. Two grommets are located at the rear approximately one quarter from each side. This unit also includes a wire chase in the base with a removable access cover for easy accessibility.

See CDO-2903 or CDO-2904 if finished end panel is desired.

Catalog #	Description	Over All Height "	Work Surface Ht"	Width"	Depth"	Price
CDO-2918	90° Double Connect Corner Patron	39-3/4	29	48	48	

*"Education would be much more effective if its purpose was to ensure that by the time they leave school every boy and girl should know how much they do not know, and be imbued with a lifelong desire to know it."*  
William H. H. Hall



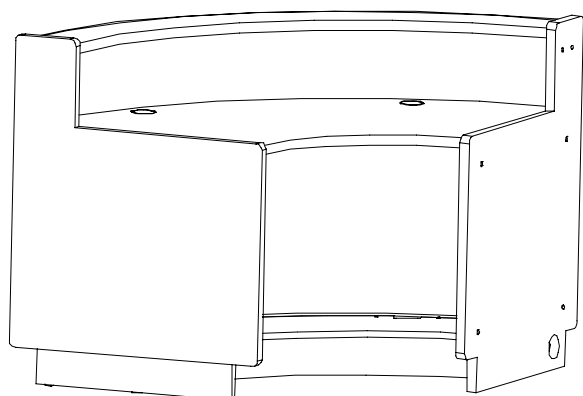

Constructed w/ Finished End

### 90 Degree Corner Patron Desk *Left Finished End Right Connector*

The work surface of this unit is 29"H. The patron ledge is 7" deep. Two grommets are located at the rear approximately one quarter from each side. The left side of this unit provides a finished end with a matching flat black laminate toe kick. This unit also includes a wire chase in the base with a removable access cover for easy accessibility.

This unit can only connect to other units on the right panel.

Catalog #	Description	Over All Height "	Work Surface Ht"	Width"	Depth"	Price
CDO-2903	90° (L) Finish (Rt) Connect Patron Desk	39-3/4	29	48	48	

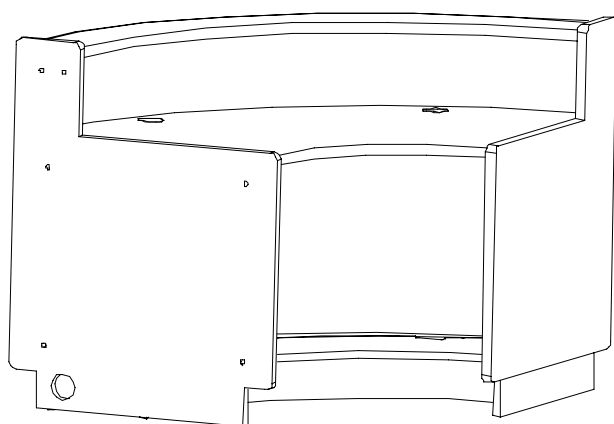

Constructed w/ Finished End

### 90 Degree Corner Patron Desk *Right Finished End Left Connector*

The work surface of this unit is 29"H. The patron ledge is 7" deep. Two grommets are located at the rear approximately one quarter from each side. The right side of this unit provides a finished end with a matching flat black laminate toe kick. This unit also includes a wire chase in the base with a removable access cover for easy accessibility.

This unit can only connect to other units on the left panel.

Catalog #	Description	Over All Height "	Work Surface Ht"	Width"	Depth"	Price
CDO-2904	90° (Rt) Finish (L) Connect Patron Desk	39-3/4	29	48	48	

*"Education's purpose is to replace an empty*

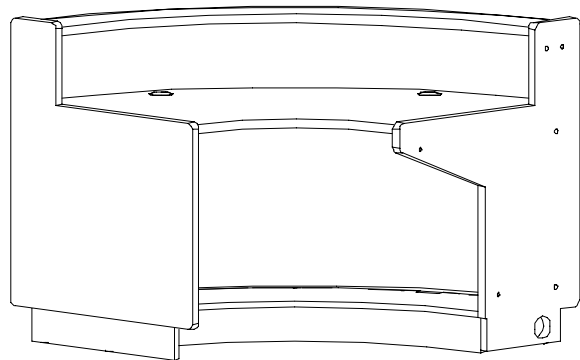

Constructed w/  
Finished End

**90 Degree Corner Patron Desk**  
***Left Finished End Right Knee Space***

This unit provides continuous knee space on the right side. The left side of this unit provides a finished end with a matching flat black laminate toe kick. The patron ledge is 7" deep. Two grommets are located at the rear approximately one quarter from each side. The work surface of this unit is 29"H. This unit also includes a wire chase in the base with a removable access cover for easy accessibility.

This unit can only connect to other units on the right panel and can only receive knee space end panels.

Catalog #	Description	Over All Height "	Work Surface Ht"	Width"	Depth"	Price
CDO-2902	90° Right Knee Patron Desk	39-3/4	29	48	48	

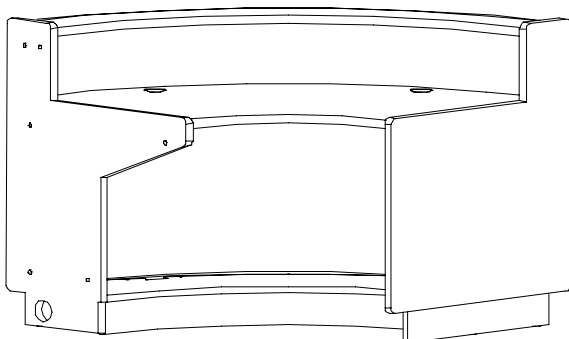

Constructed w/  
Finished End

**90 Degree Corner Patron Desk**  
***Left Knee Space Right Finished End***

This unit provides continuous knee space on the left side. The work surface of this unit is 29"H. The right side of this unit provides a finished end with a matching flat black laminate toe kick. The patron ledge is 7" deep. Two grommets are located at the rear approximately one quarter from each side. This unit also includes a wire chase in the base with a removable access cover for easy accessibility.

This unit can only connect to other units on the left panel and can only receive knee space end panels.

Catalog #	Description	Over All Height "	Work Surface Ht"	Width"	Depth"	Price
CDO-2901	90° Left Knee Patron Desk	39-3/4	29	48	48	

*mind with an open one."*      *Malcolm S. Forbes*

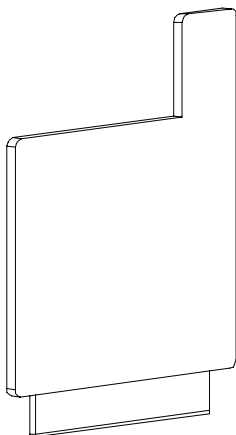

### ***Patron Unit Finished End Panel***

A finished end panel is needed to end a circulation desk with a square patron unit. The finished end panel is 1-1/4" thick and is banded with 1/2" T matching solid wood. The end panel also continues the flow of the 4"H flat black laminate toekick. The panel is bolted onto the terminating end. The left and right end of the desk is from the perspective of the staff side of the desk.

Catalog #	Description	Overall Height"	Thickness"	Width"	Price
CDO-2923	(L) Patron Desk Finished End Panel	39-1/4	1	30-1/2	
CDO-2922	(R) Patron Desk Finished End Panel	39-1/4	1	30-1/2	

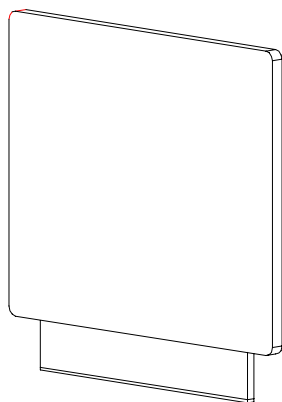

### **Finished End Panel**

A finished end panel is needed to end a circulation desk with a non-patron unit. The finished end panel is 1-1/4" thick and is banded with 1/2" T matching solid wood. The end panel also continues the flow of the 4"H flat black laminate toekick. The panel is bolted onto the terminating end. The left and right end of the desk is from the perspective of the staff side of the desk.

Catalog #	Description	Overall Height"	Thickness"	Width"	Price
CDO-2919	Left Finished End Panel	29-1/4	1	30-1/2	
CDO-2920	Right Finished End Panel	29-1/4	1	30-1/2	

## PROVIDENCE SERIES GENERAL SPECIFICATIONS

**All work surfaces** will be constructed of 1-1/8" thick, 45-pound density particleboard-core with .050" thick high-pressure laminate and .020" thick backer sheet glued to opposite faces for a finished thickness of 1-1/4". (Note: Table tops can be constructed from 5 PLY lumber core or 11 PLY veneer core (*for an additional charge*). Tops will be banded solid red oak with 3/4" T and profile determined by customer selection from edge band chart (EDGE DETAILS NOTED THROUGHOUT). The edge band will be of sufficient width to provide a 1/2" drop edge beneath the table core to hide mounting plates. Table edges will be finished to match table legs and/or end panels.

**Computer table and carrel tops only** will have grommets and J-wire managers to provide control and concealment of equipment wires.

**Tops 60" long or more** will have one 14-gauge, V-shaped steel keel that will be 5-1/2" shorter than the overall table length. **Tops longer than 72"** in length will receive a fifth leg at the center of the table with V-shaped keels along the length. **Tops wider than 48"** (and longer than 72") will receive two legs spaced evenly across the center.

**Curbing and Index Table Shelving** are constructed of 1" veneer-core red oak plywood secured to the table top by screws passing through the table top and into the shelving assembly. Exposed edges will have a 1/2" T solid red oak edge band. The banded edges of the uprights and shelves will receive an eased edge.

**Study and Computer Carrels** are "starter/adder" designed and have 3/4" veneer core plain-sliced plywood side and back panels. A 1/2" T solid red oak edge band is applied to exposed panel edges. Vertical panel edges are machined for Mod-Eze Clips (R) to receive shoulder fasteners mounted on leg posts and end panels.

**Study Carrels only** have an 8" D bookshelf mounted on the back panel above the work surface. 3/4" veneer core plywood, solid red oak edge band, fastened on three sides with solid wood cleats.

**Computer Carrels only** have a 12" D shelf mounted under the work surface made of 3/4" red oak veneer plywood, 1/4" T solid red oak edgeband, fastened on three

sides with solid wood cleats.

**Display Unit** side panels are 1" (back panels 3/4") core veneer plain sliced red oak plywood. A 5/8" x 5/8" red oak retainer strip is fastened to the front sloped edge. Shelves and pullouts are 3/4" veneer red oak plywood with 1/4" red oak edgeband. Atlas stand shelves are provided with full extension ball bearing glides rated for 200 lbs.

**All Providence Series legs** will be 2-1/4" square, glued-up red oak with a 1/4" radius on all edges. Legs will have an 1-3/4" diameter threaded leveling glide which is mounted in countersunk and recessed T-nut. Legs will be attached to the table top by means of a 5" x 5" x 1/2" steel plate. A threaded steel barrel nut will be inserted on the inner corner of the leg approx. 2" from the top. A 5/16"-18 x 3" machine bolt will pass through the 1/2" steel plate down through the top of the leg and in to the barrel nut, firmly securing the two pieces together. A #10 x 1-1/4" flat head wood screw is then set into the plate and leg to prevent the two pieces from turning. This assembly is then attached to the table top with three 5/16"-18 x 1" hex-head machine bolts, screwed into three T-nut inserts which are in the top side of the table.

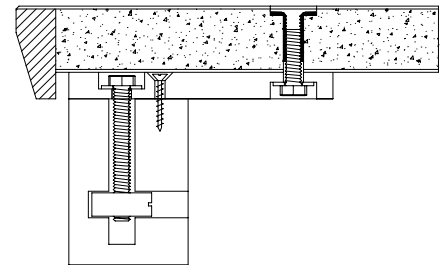

**An OPTIONAL 3/4" x 1-1/2" red oak apron** can be screw-attached around the underside of the top. The screw will be #8 x 2" and countersunk on underside of apron. *All apron options will be priced prior to order placement and must be specified on the order.*

**FINISH** - See page 5 for finish specifications.

Visit our web site at [www.russwood.net](http://www.russwood.net)

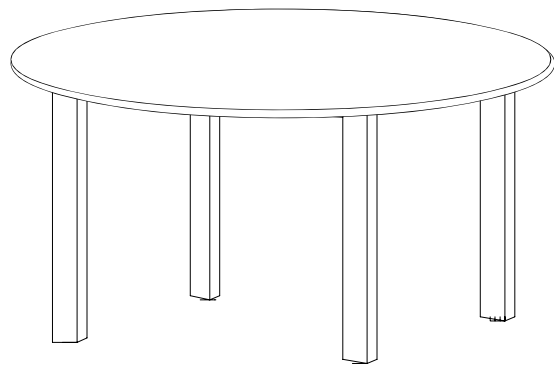

**Round Table**

Catalog #	Description	Height"	Diameter"		Price
PS-25R36	25"H Round Table	25	36		
PS-25R42	25"H Round Table	25	42		
PS-25R48	25"H Round Table	25	48		
PS-25R60	25"H Round Table	25	60		
PS-27R36	27"H Round Table	27	36		
PS-27R42	27"H Round Table	27	42		
PS-27R48	27"H Round Table	27	48		
PS-27R60	27"H Round Table	27	60		
PS-29R36	29"H Round Table	29	36		
PS-29R42	29"H Round Table	29	42		
PS-29R48	29"H Round Table	29	48		
PS-29R60	29"H Round Table	29	60		

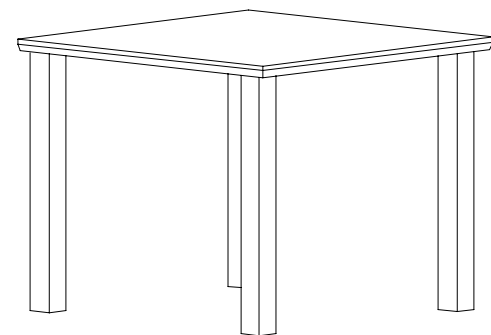

**Square Table**

Catalog #	Description	Height"	Length"	Width"	Price
PS-25S36	25"H Square Table	25	36	36	
PS-25S42	25"H Square Table	25	42	42	
PS-25S48	25"H Square Table	25	48	48	
PS-27S36	27"H Square Table	27	36	36	
PS-27S42	27"H Square Table	27	42	42	
PS-27S48	27"H Square Table	27	48	48	
PS-29S36	29"H Square Table	29	36	36	
PS-29S42	29"H Square Table	29	42	42	
PS-29S48	29"H Square Table	29	48	48	

**SEE PAGE 112 FOR EDGE DETAILS**

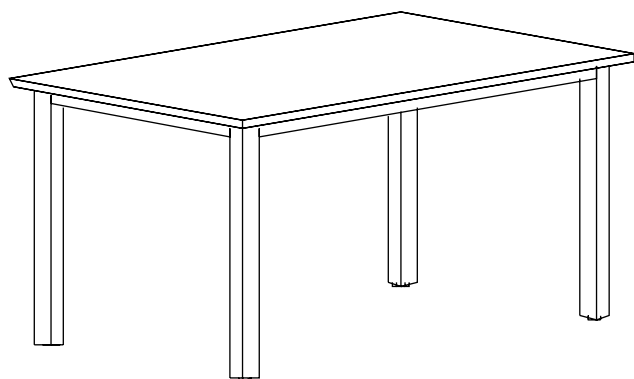

### Four-Person Reading Table

Table shown with OPTIONAL apron

Catalog #	Description	Height"	Length"	Width"	Price
PS-254R01	25"H Four-Person Reading Table	25	60	36	
PS-254R02	25"H Four-Person Reading Table	25	72	36	
PS-254R04	25"H Four-Person Reading Table	25	72	42	
PS-254R03	25"H Four-Person Reading Table	25	72	48	
PS-274R01	27"H Four-Person Reading Table	27	60	36	
PS-274R02	27"H Four-Person Reading Table	27	72	36	
PS-274R04	27"H Four-Person Reading Table	27	72	42	
PS-274R03	27"H Four-Person Reading Table	27	72	48	
PS-294R01	29"H Four-Person Reading Table	29	60	36	
PS-294R02	29"H Four-Person Reading Table	29	72	36	
PS-294R04	29"H Four-Person Reading Table	29	72	42	
PS-294R03	29"H Four-Person Reading Table	29	72	48	

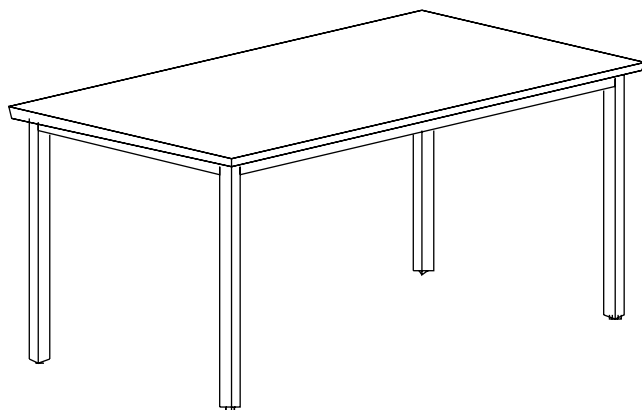

### Six-Person Reading Table

Table shown with OPTIONAL apron

Catalog #	Description	Height"	Length"	Width"	Price
PS-256R01	25"H Six-Person Reading Table	25	90	36	
PS-256R03	25"H Six-Person Reading Table	25	90	42	
PS-256R02	25"H Six-Person Reading Table	25	90	48	
PS-276R01	27"H Six-Person Reading Table	27	90	36	
PS-276R03	27"H Six-Person Reading Table	27	90	42	
PS-276R02	27"H Six-Person Reading Table	27	90	48	
PS-296R01	29"H Six-Person Reading Table	29	90	36	
PS-296R03	29"H Six-Person Reading Table	29	90	42	
PS-296R02	29"H Six-Person Reading Table	29	90	48	

**SEE PAGE 112 FOR EDGE DETAILS**

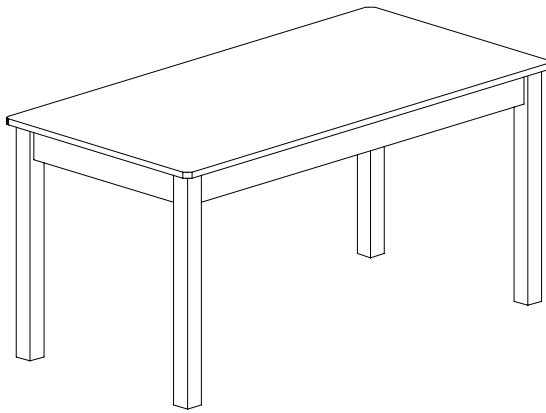

### Activity Table

Table top will be 3/4" T 45-pound density particleboard-core with .050" thick high-pressure laminate and .020" thick backer sheet glued to opposite faces. Top edges will be banded with 3/4" T solid red oak with a shallow bull nose drop detail. Aprons will be 3/4" T x 3-1/2" W solid red oak. Apron frame will be fastened together with (4) 35 gauge formed steel apron brackets via (6) wood screws. Aprons will fasten to the top using 1/4" bolts and threaded T-nuts placed in the top surface under the laminate. Legs will be 2-1/4" square, glued-up solid hardwood with a 1/8" radius on all edges. Legs will double bolt to the apron via the apron brackets.

Catalog #	Description	Height"	Length"	Width"	Price
PS-25A01	25"H Activity Table	25	30	30	
PS-25A02	25"H Activity Table	25	42	30	
PS-25A03	25"H Activity Table	25	48	30	
PS-25A04	25"H Activity Table	25	60	30	
PS-25A05	25"H Activity Table	25	72	30	
PS-25A06	25"H Activity Table	25	90	30	
PS-27A01	27"H Activity Table	27	30	30	
PS-27A02	27"H Activity Table	27	42	30	
PS-27A03	27"H Activity Table	27	48	30	
PS-27A04	27"H Activity Table	27	60	30	
PS-27A05	27"H Activity Table	27	72	30	
PS-27A06	27"H Activity Table	27	90	30	
PS-29A01	27"H Activity Table	29	30	30	
PS-29A02	27"H Activity Table	29	42	30	
PS-29A03	27"H Activity Table	29	48	30	
PS-29A04	27"H Activity Table	29	60	30	
PS-29A05	27"H Activity Table	29	72	30	
PS-29A06	27"H Activity Table	29	90	30	

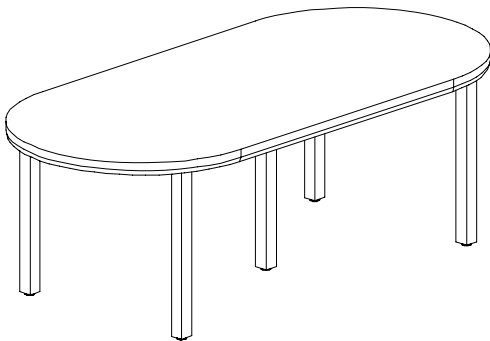

### Race Track Table

Catalog #	Description	Height"	Length"	Width"	Price
PS-904227RT	27"H Race Track Table	27	90	42	
PS-904827RT	27"H Race Track Table	27	90	48	
PS-904229RT	29"H Race Track Table	29	90	42	
PS-904829RT	29"H Race Track Table	29	90	48	

SEE PAGE 112 FOR EDGE DETAILS

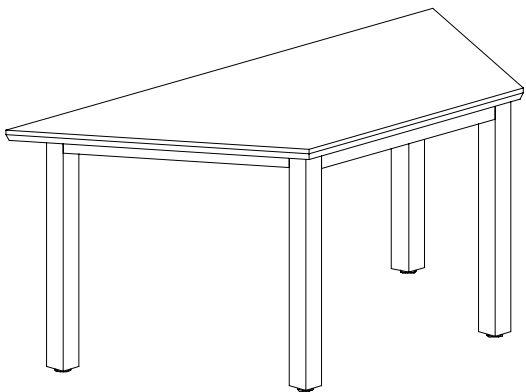

**Trapezoid Table**  
Table shown with OPTIONAL apron

For this configuration order two (2) tables  
(60"W x 50-1/2"D overall dimensions)

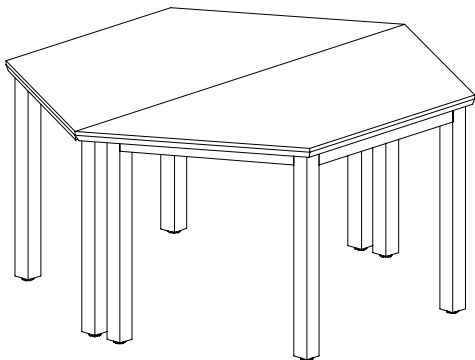

For this configuration order six (6) tables  
(120"W x 104"D overall dimensions)

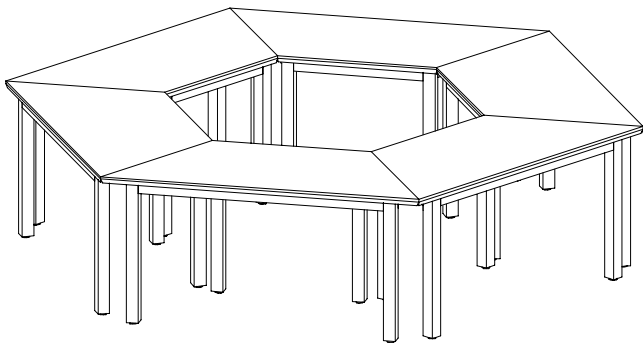

Catalog #	Description	Height"	Length"	Width"	Price
PS-306027TZ	27"H Trapezoidal Round Table	27	60	25	
PS-306029TZ	29"H Trapezoidal Round Table	29	60	25	
PS-306032TZ	32"H Trapezoidal Round Table	32	60	25	

*"The aim of education should be to teach us rather  
how to think, than what to think - rather to improve our minds,  
so as to enable us to think for ourselves, than to load the  
memory with thoughts of other men."*  
*Bill Beattie*

SEE PAGE 112 FOR EDGE DETAILS



**Planning For & Ordering Edgeband for Providence Series Activity & Reading Tables**

**Edge Detail  
for  
Providence Series  
Activity Table**

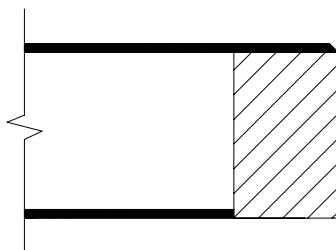

3/4" thick top (Internal)  
**Montana Drop**

**Edge Details  
for  
Providence Series  
Reading Tables  
Race Track Table  
Trapezoid Table**

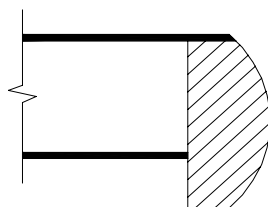

1 1/4" thick top (Internal)  
**Shallow Bullnose Drop**

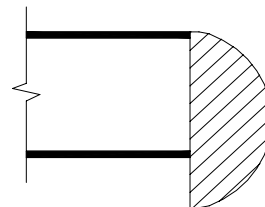

1 1/4" thick top (External)  
**Bullnose Drop**

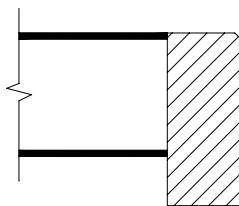

1 1/4" thick top (External)  
**Montana Drop**

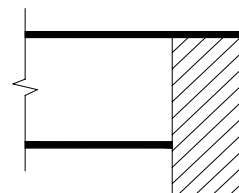

1 1/4" thick top (Internal)  
**Montana Drop**

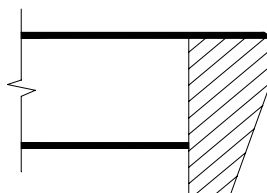

1 1/4" thick top (Internal)  
**Premier Drop**

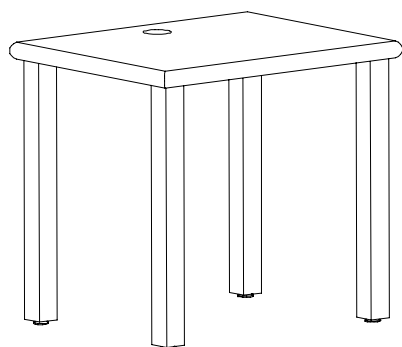

### 30"L x 24"W Flat Screen Computer Table

A grommet and J-channel wire management are provided in each unit to ensure concealment.

Catalog #	Description	Height"	Length"	Width"	Price
PS-302425	Sitting-Height Unit, child	25	30	24	
PS-302427	Intermediate -Height Unit	27	30	24	
PS-302429	Sitting-Height Unit, adult	29	30	24	
PS-302439	Standing-Height Unit	39	30	24	

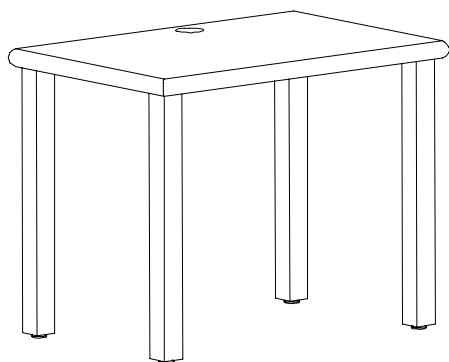

### 36"L x 24"W Flat Screen Computer Table

A grommet and J-channel wire management are provided in each unit to ensure concealment.

Catalog #	Description	Height"	Length"	Width"	Price
PS-362425	Sitting-Height Unit, child	25	36	24	
PS-362427	Intermediate -Height Unit	27	36	24	
PS-362429	Sitting-Height Unit, adult	29	36	24	
PS-362439	Standing-Height Unit	39	36	24	

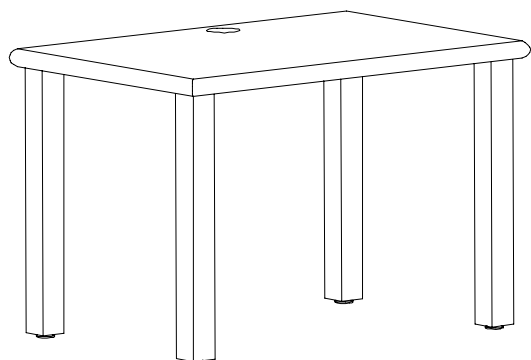

### 42"L x 24"W Flat Screen Computer Table

A grommet and J-channel wire management are provided in each unit to ensure concealment.

Catalog #	Description	Height"	Length"	Width"	Price
PS-422425	Sitting-Height Unit, child	25	42	24	
PS-422427	Intermediate-Height Unit	27	42	24	
PS-422429	Sitting-Height Unit, adult	29	42	24	
PS-422439	Standing-Height Unit	39	42	24	

**SEE PAGE 122 FOR EDGE DETAILS**

## Leg Based Furniture

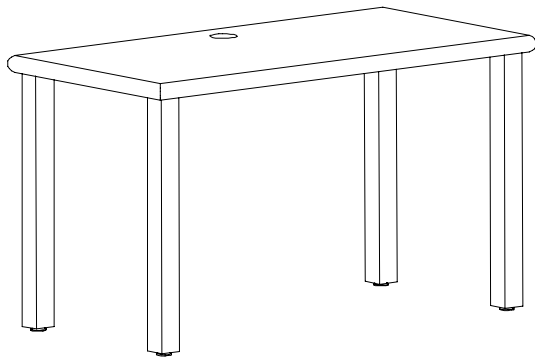

### 48"L x 24"W Flat Screen Computer Table

A grommet and wire manager are provided in each unit to ensure concealment.

Use these #'s to order 42"L units.

PS-422425

PS-422427

PS-422429

PS-422439

Catalog #	Description	Height"	Length"	Width"	Price
PS-482425	Sitting-Height Unit, child	25	48	24	
PS-482427	Intermediate-Height Unit	27	48	24	
PS-482429	Sitting-Height Unit, adult	29	48	24	
PS-482439	Standing-Height Unit	39	48	24	

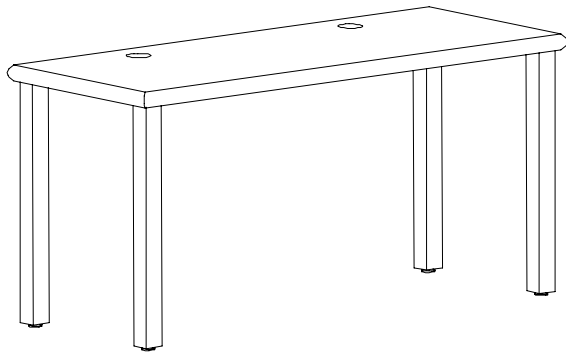

### 60"L x 24"W Flat Screen Computer Table

Two grommets and wire manager are provided in each unit to ensure concealment. Steel "V" keel provided on this unit.

Catalog #	Description	Height"	Length"	Width"	Price
PS-602425	Sitting-Height Unit, child	25	60	24	
PS-602427	Intermediate Height Unit	27	60	24	
PS-602429	Sitting-Height Unit, adult	29	60	24	
PS-602439	Standing-Height Unit	39	60	24	

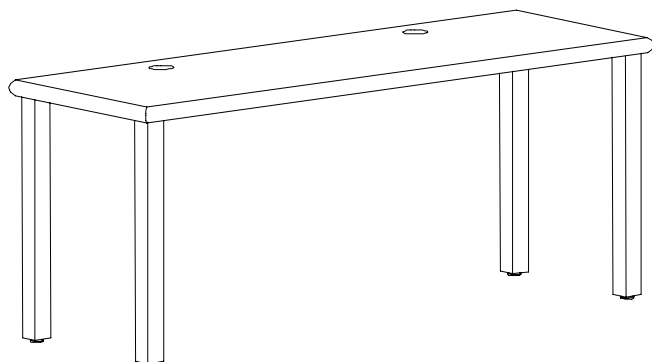

### 72"L x 24"W Flat Screen Computer Table

Two grommets and wire manager are provided in each unit to ensure concealment. Steel "V" keel provided on this unit.

See top of next page for  
90"L x 24"W Flat Screen  
Computer Table

Catalog #	Description	Height"	Length"	Width"	Price
PS-722425	Sitting-Height Unit, child	25	72	24	
PS-722427	Intermediate Height Unit	27	72	24	
PS-722429	Sitting-Height Unit, adult	29	72	24	
PS-722439	Standing-Height Unit	39	72	24	

SEE PAGE 122 FOR EDGE DETAILS

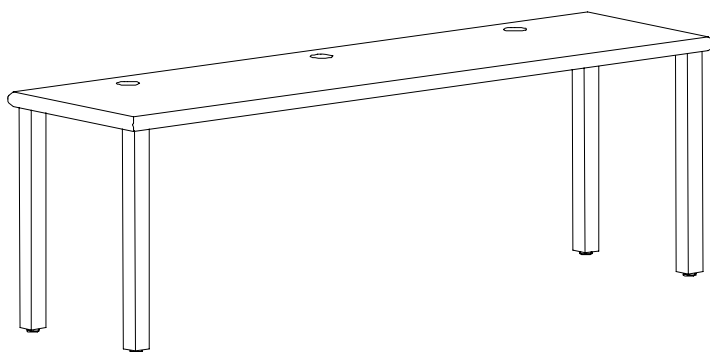

### 90”L x 24”W Flat Screen Computer Table

Three grommets and J-channel wire management are provided in each unit to ensure concealment. Two steel “V” keels provided on this unit.

Catalog #	Description	Height"	Length"	Width"	Price
PS-902425	Sitting-Height Unit, child	25	90	24	
PS-902427	Intermediate Height Unit	27	90	24	
PS-902429	Sitting-Height Unit, adult	29	90	24	
PS-902439	Standing-Height Unit	39	90	24	

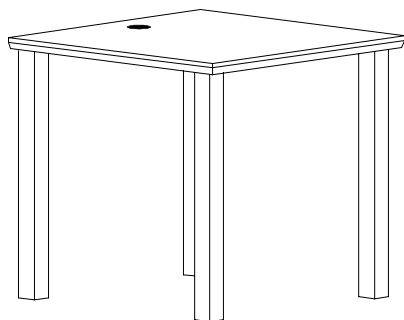

### 30” Square Computer Table

A grommet and wire manager are provided in each unit to ensure concealment.

Catalog #	Description	Height"	Length"	Width"	Price
PS-303025	Sitting-Height Unit, child	25	30	30	
PS-303027	Intermediate-Height Unit	27	30	30	
PS-303029	Sitting-Height Unit, adult	29	30	30	
PS-303039	Standing-Height Unit	39	30	30	

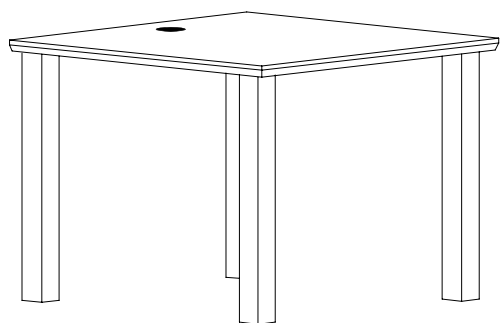

### 36”L x 30”W Computer Table

A grommet and wire manager are provided in each unit to ensure concealment.

Catalog #	Description	Height"	Length"	Width"	Price
PS-363025	Sitting-Height Unit, child	25	36	30	
PS-363027	Intermediate -Height Unit	27	36	30	
PS-363029	Sitting-Height Unit, adult	29	36	30	
PS-363039	Standing-Height Unit	39	36	30	

**SEE PAGE 122 FOR EDGE DETAILS**

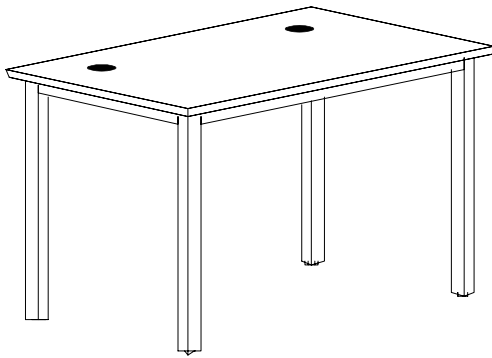
**48"L x 30"W Computer Table**

Two grommets and wire manager are provided in each unit to ensure concealment. Table shown with OPTIONAL apron

Catalog #	Description	Height"	Length"	Width"	Price
PS-483025	Sitting-Height Unit, child	25	48	30	
PS-483027	Intermediate-Height Unit	27	48	30	
PS-483029	Sitting-Height Unit, adult	29	48	30	
PS-483039	Standing-Height Unit	39	48	30	

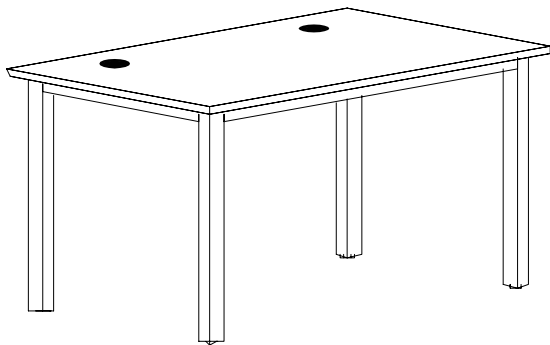
**60"L x 30"W Computer Table**

Two grommets and wire manager are provided in each unit to ensure concealment. Table shown with OPTIONAL apron

Catalog #	Description	Height"	Length"	Width"	Price
PS-603025	Sitting-Height Unit, child	25	60	30	
PS-603027	Intermediate Height Unit	27	60	30	
PS-603029	Sitting-Height Unit, adult	29	60	30	
PS-603039	Standing-Height Unit	39	60	30	

"A university professor set an examination question in which he asked, 'what is the difference between ignorance and apathy?' The professor had to give an A+ to a student who answered: 'I don't know and I don't care.'"

*Richard Pratt, Pacific Computer Weekly, 20 July 1990*

**SEE PAGE 122 FOR EDGE DETAILS**

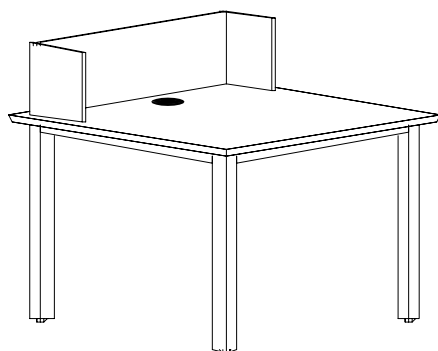

### 36" Square Computer Table w/curbing

10"H curbing will run the entire width inside the edgeband, as well as 10" along each side to aid with wire connection concealment to provide a computer work station. A grommet and wire manager are provided in each unit to ensure concealment. Table shown with OPTIONAL apron

Catalog #	Description	Height"	Length"	Width"	Price
PS-363625	Single-Station Unit, elementary sitting height	25	36	36	
PS-363627	Single-Station Unit, intermediate height	27	36	36	
PS-363629	Single-Station Unit, adult sitting height	29	36	36	
PS-363639	Single-Station Unit, standing height	39	36	36	

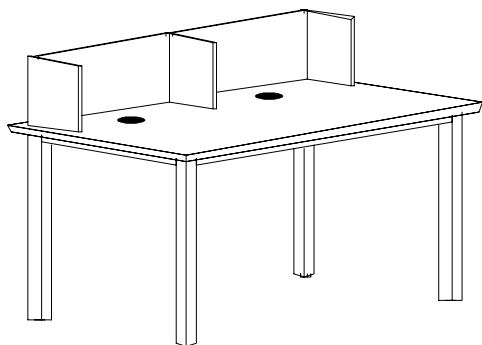

### 60"L x 36W" Computer Table w/curbing

10"H curbing will run the entire width inside the edgeband, as well as 10" along each side to aid with wire connection concealment to provide two computer work stations. Two grommets and wire manager are provided in each unit to ensure concealment.

Catalog #	Description	Height"	Length"	Width"	Price
PS-603625	Sitting-Height Unit, elementary	25	60	36	
PS-603627	Intermediate-Height Unit	27	60	36	
PS-603629	Sitting-Height Unit, adult	29	60	36	
PS-603639	Standing-Height Unit	39	60	36	

*"Genius without education is like silver in the mine."*

*Ben Franklin*

SEE PAGE 122 FOR EDGE DETAILS

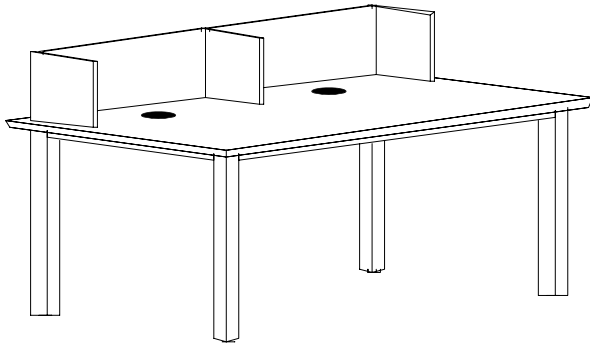

### 72”L x 36W” Computer Table w/curbing

10”H curbing will run the entire width inside the edgeband, as well as 10” along each side to aid with wire connection concealment to provide two computer work stations. Two grommets and wire manager are provided in each unit to ensure concealment.

Catalog #	Description	Height"	Length"	Width"	Price
PS-723625	Double-Station Unit, elementary sitting height	25	72	36	
PS-723627	Double-Station Unit, intermediate height	27	72	36	
PS-723629	Double-Station Unit, adult sitting height	29	72	36	
PS-723639	Double-Station Unit, standing height	39	72	36	

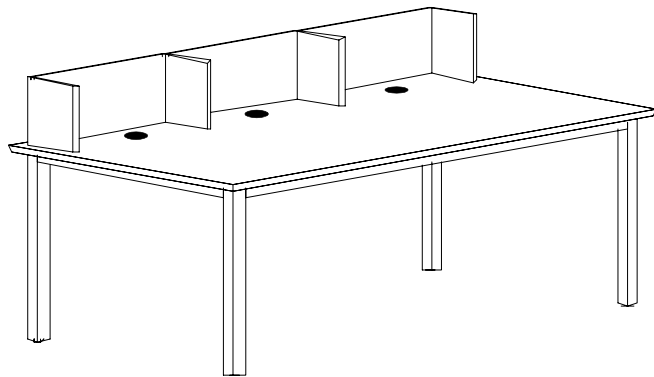

### 90”L x 36”W Computer Table w/curbing

10”H curbing will run the entire width inside the edgeband, as well as 10” along each side to aid with wire connection concealment to provide three computer work stations.. Three grommets and wire manager are provided in each unit to ensure concealment.

Catalog #	Description	Height"	Length"	Width"	Price
PS-903625	Triple-Station Unit, elementary sitting height	25	90	36	
PS-903627	Triple-Station Unit, intermediate height	27	90	36	
PS-903629	Triple-Station Unit, adult sitting height	29	90	36	
PS-903639	Triple-Station Unit, standing height	39	90	36	

**“I am still learning.”**  
**Michelangelo**

**SEE PAGE 122 FOR EDGE DETAILS**

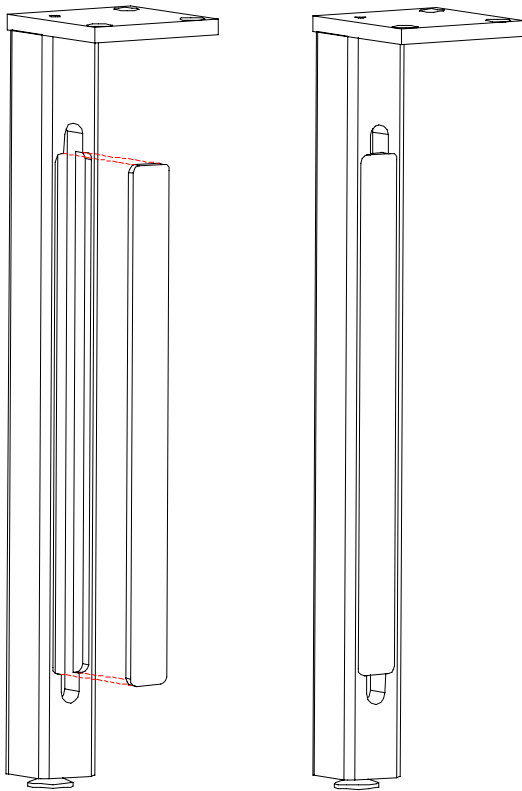

### Wire Access Leg

The wire access leg utilizes the standard solid red oak table leg and steel plate assembly (see pg. 107). An internal wire chase is machined into the leg which is designed to conceal wiring. Wiring enters the wire chase at the top of the chase and exits the bottom of the chase. A solid red oak wire chase cover (finished to match) conceals the wiring. Velcro strips are glued and machine fastened to both the leg inside the chase and the solid red oak wire chase cover. The inside dimensions of the wire chase is 1/2"D x 3/4"W. The oak wire chase cover is 3/8"T and fits flush with the leg when in place.

Also see Accessories section (pg. 205) for other helpful computer table accessories.

Catalog #	Description	Height"	Width"	Depth	Price
A-4725	Wire Access Leg for 25"H Table	25	2-14"	2-1/4"	
A-4727	Wire Access Leg for 27"H Table	27	2-14"	2-1/4"	
A-4729	Wire Access Leg for 29"H Table	29	2-14"	2-1/4"	
A-4739	Wire Access Leg for 39"H Table	39	2-14"	2-1/4"	

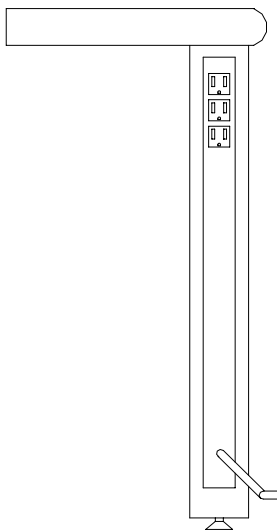

### Three Outlet Power Leg

Optional power leg is made of solid matching hardwood with a flush-mounted, UL-approved power strip. Power strip has three outlets and is supplied with a six-foot cord.

Catalog #	Description	Height"	Width"	Depth	Price
A-925	Power Leg for 25"H Table	25	2-14"	2-1/4"	
A-927	Power Leg for 27"H Table	27	2-14"	2-1/4"	
A-929	Power Leg for 29"H Table	29	2-14"	2-1/4"	
A-939	Power Leg for 39"H Table	39	2-14"	2-1/4"	



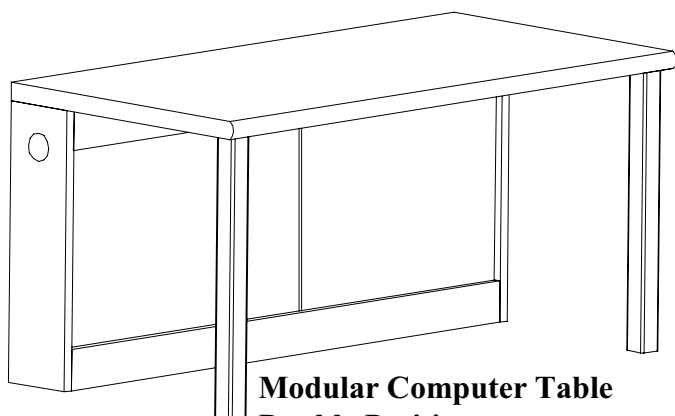

**Modular Computer Table  
Double Position (60"L x 30"D)**

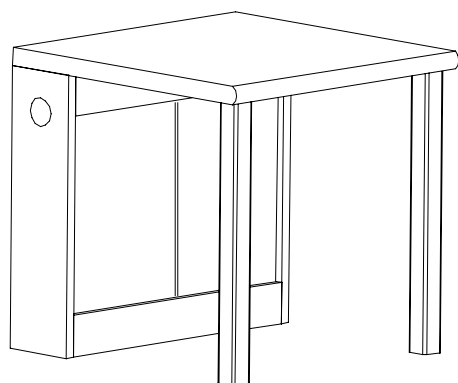

**Modular Computer Table  
Single Position (30"L x 30"D)**

### Modular Computer Tables

Table tops are banded with a 3/4" T solid red oak edge band. The front band is specifiable with standard edge details. The sides and back bands are internal flush. This allows for tables to be used in a series providing the utility of a continuous top. Tables in a series can be bolted (via the wire chase) and unbolted in order to re-configure a new series or add more tables.

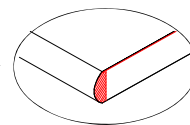

The wire chase is accessible through the front via 1/4" T red oak veneer plywood sliding doors and through the work surface via grommets. The bottom of the chase provides large access holes for floor mounted power and data jacks. Power and data connectivity between tables is accomplished with 3" grommets in each end of the wire chase on floor units. The wire chase is provided with a fully enclosed 3/4" T finished red oak veneer plywood back. On wall units, the wire chase has a partially open back to all for access to wall jacks and outlets.

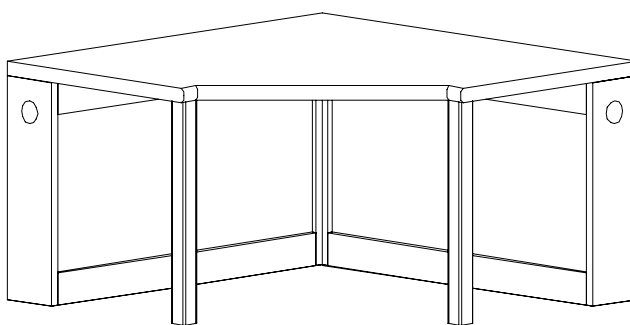

**Modular Computer Corner Table (53" x 53")**

This unit does provide continuous wire access around the corner.

*See page 158 if a computer counter is desired.*

Catalog #	Description	Height"	Length"	Width"	Price
<b>WALL UNITS HAVE OPEN BACKS</b>					
PS-M603025W	60"X30" Mod Comp Tab w/chase - 25"H - WALL UNIT	25	60	30	
PS-M603027W	60"X30" Mod Comp Tab w/chase - 27"H - WALL UNIT	27	60	30	
PS-M603029W	60"X30" Mod Comp Tab w/chase - 29"H - WALL UNIT	29	60	30	
PS-M303025W	30"X30" Mod Comp Tab w/chase - 25"H - WALL UNIT	25	30	30	
PS-M303027W	30"X30" Mod Comp Tab w/chase - 27"H - WALL UNIT	27	30	30	
PS-M303029W	30"X30" Mod Comp Tab w/chase - 29"H - WALL UNIT	29	30	30	
PS-M535325W	53"X53" Mod Comp Corner w/chase - 25"H - WALL UNIT	25	53	53	
PS-M535327W	53"X53" Mod Comp Corner w/ chase - 27"H - WALL UNIT	27	53	53	
PS-M535329W	53"X53" Mod Comp Corner w/chase - 29"H - WALL UNIT	29	53	53	
<b>FLOOR UNITS HAVE FINISHED BACKS</b>					
PS-M603025F	60"X30" Mod Comp Tab w/chase - 25"H - FLOOR UNIT	25	60	30	
PS-M603027F	60"X30" Mod Comp Tab w/chase - 27"H - FLOOR UNIT	27	60	30	
PS-M603029F	60"X30" Mod Comp Tab w/chase - 29"H - FLOOR UNIT	29	60	30	
PS-M303025F	30"X30" Mod Comp Tab w/chase - 25"H - FLOOR UNIT	25	30	30	
PS-M303027F	30"X30" Mod Comp Tab w/chase - 27"H - FLOOR UNIT	27	30	30	
PS-M303029F	30"X30" Mod Comp Tab w/chase - 29"H - FLOOR UNIT	29	30	30	
PS-M535325F	53"X53" Mod Comp Corner w/chase - 25"H - FLOOR UNIT	25	53	53	
PS-M535327F	53"X53" Mod Comp Corner w/chase - 27"H - FLOOR UNIT	27	53	53	
PS-M535329F	53"X53" Mod Comp Corner w/chase - 29"H - FLOOR UNIT	29	53	53	

**SEE PAGE 122 FOR EDGE DETAILS**

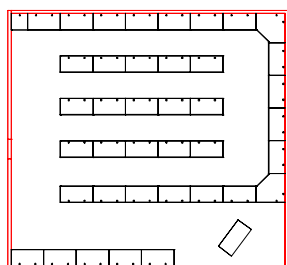
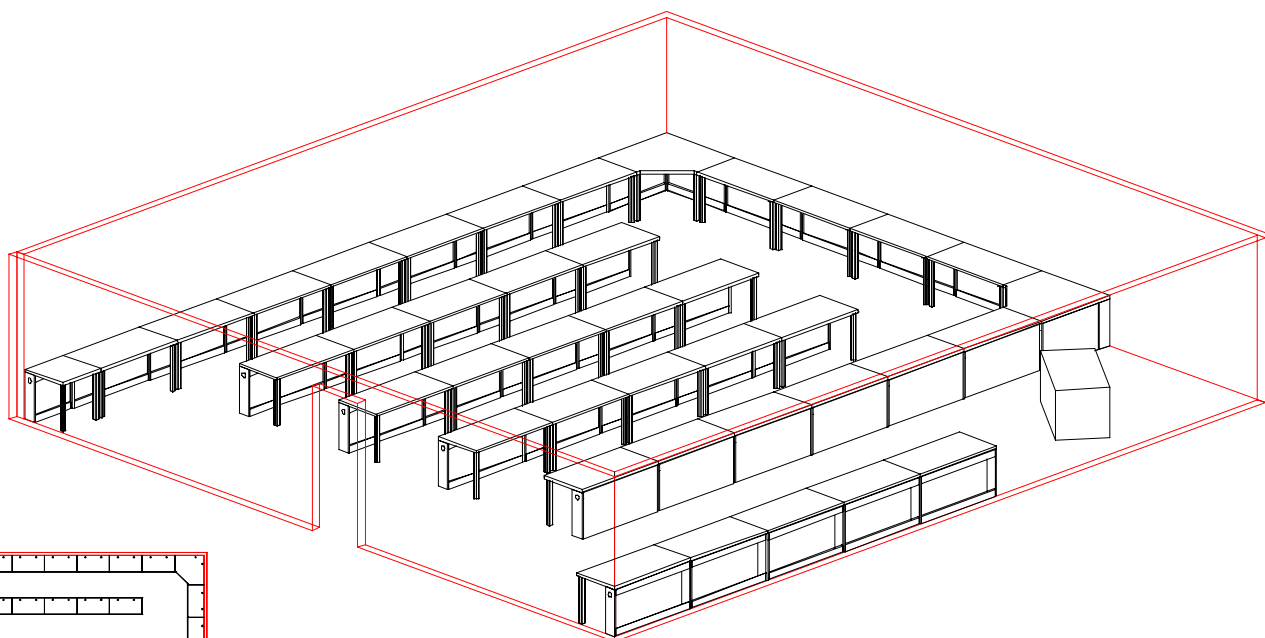

**Modular computer tables provide the flexibility to furnish an entire computer lab...**

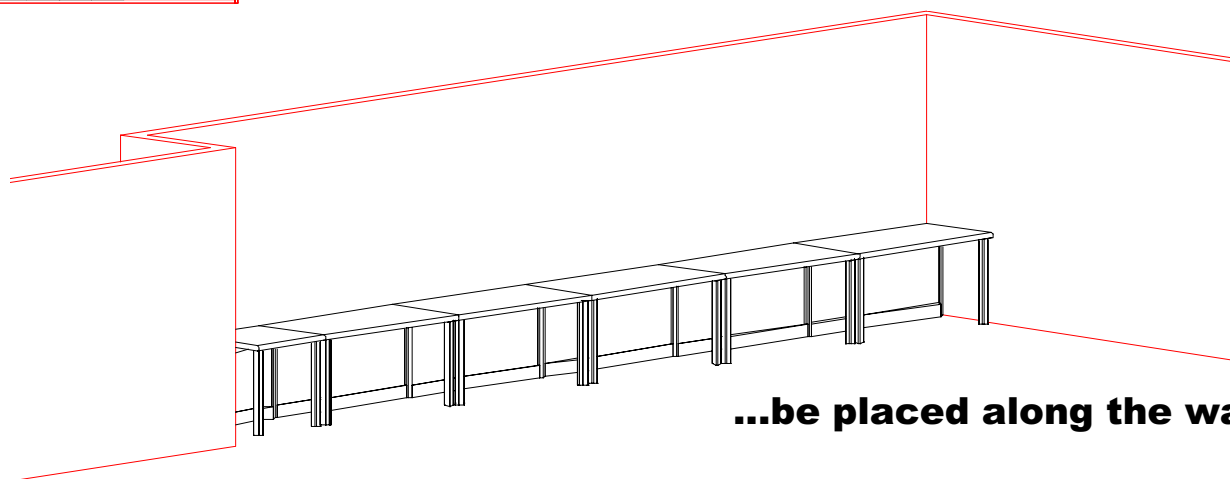

**...be placed along the wall...**

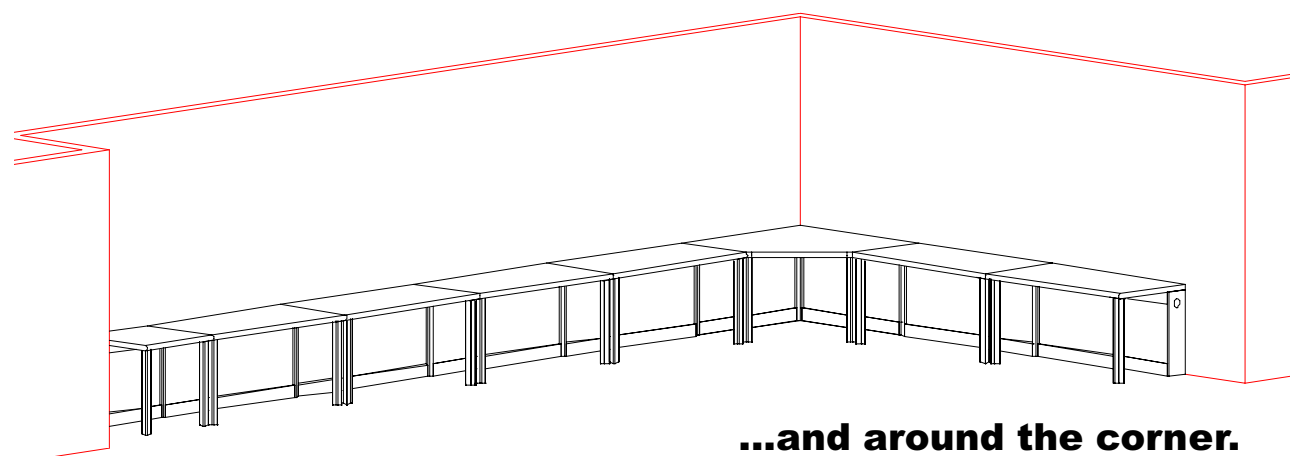

**...and around the corner.**

### Planning For & Ordering Edgeband for Providence Series Computer Tables

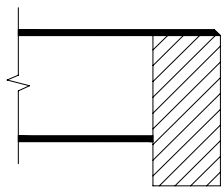

**Modular Computer Table** work surface will have a 3/4" T internal DROP solid red oak edgeband on back and sides.\*.

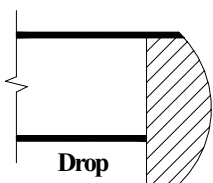

**Computer Tables Work surfaces** will be constructed with a 3/4" T solid red oak edgeband and can be ordered with any one of a variety of DROP edgeband details.

**\*Edge Details for  
front edge only  
of Modular Table**

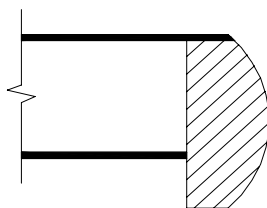

1 1/4" thick top (Internal)  
**Shallow Bullnose Drop**

**Edge Details  
for  
Providence Series  
Computer Tables**

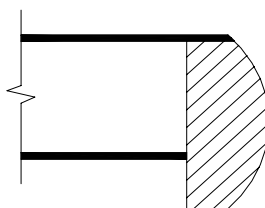

1 1/4" thick top (Internal)  
**Shallow Bullnose Drop**

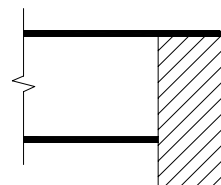

1 1/4" thick top (Internal)  
**Montana Drop**

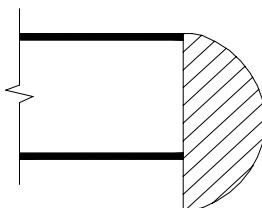

1 1/4" thick top (External)  
**Bullnose Drop**

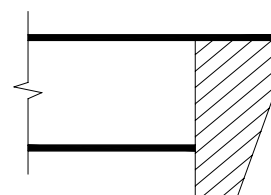

1 1/4" thick top (Internal)  
**Premier Drop**

## Study Carrels - Starter/Adder

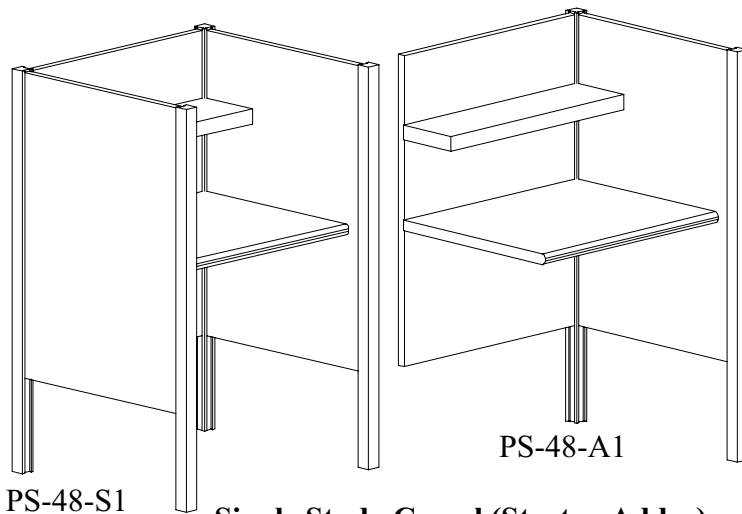

PS-48-S1

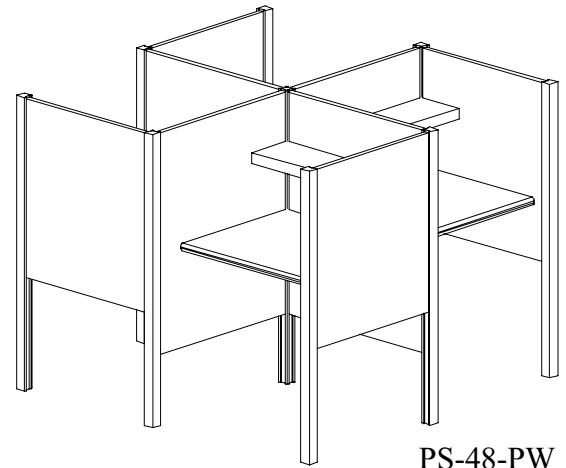
**Single Study Carrel (Starter-Adder)**

PS-48-PW

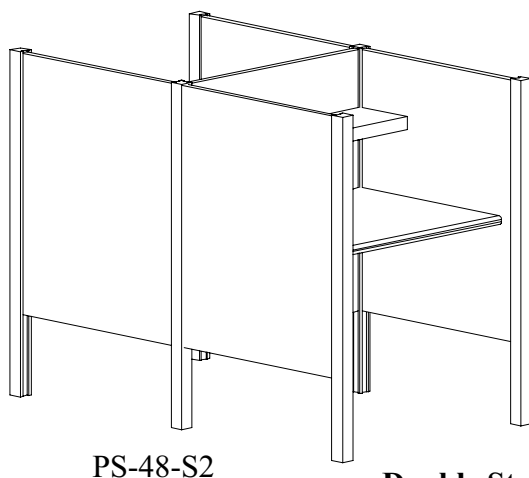
**Pinwheel Study Carrel**

PS-48-S2

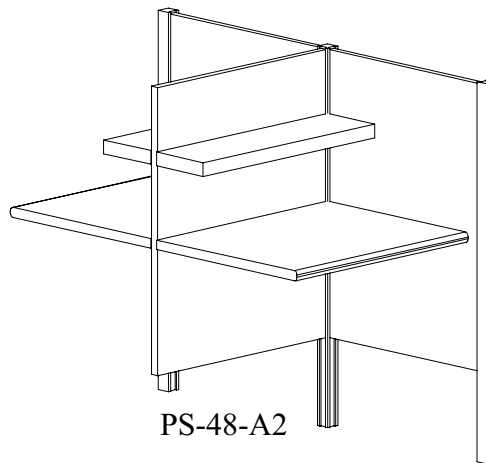
**Double Study Carrel (Starter-Adder)**

PS-48-A2

Computer  
Carrels  
Next Page

**Study and Computer Carrels** are “starter/adder” designed and have 3/4” veneer core plain-sliced plywood side and back panels. A 1/2”T solid red oak edge band is applied to exposed panel edges. Vertical panel edges are machined for Mod-Eze Clips (R) to receive shoulder fasteners mounted on leg posts and end panels. Leg posts are 1-3/4” square, dadoed to receive the side and back panels. Legs will have an 1-3/4” diameter threaded leveling glide which is mounted in countersunk and recessed T-nut. Work surface is attached to side panels via metal bolt cleats and 5/16” bolt. The bolt is received into the end panel via a 1/2” threaded insert, and is received into the top via a 7/8” flanged t-nut insert.

**Study Carrels only** have an 8”D bookshelf mounted on the back panel above the work surface. Shelf is 3/4” veneer core plywood. Front edge is banded with 3/4” x 1-3/4” solid red oak. Shelf is fastened on three sides with wood screws and metal cleats.

### SEE PAGE 131 FOR EDGE DETAILS

Catalog #	Description	Height"	Width"	Depth"	Price
PS-48S1	Single-Faced,starter	48	39	29-1/4	
PS-48A1	Single-Faced, adder	48	37-1/2	29-1/4	
PS-48S2	Double-Faced, starter	48	39	56-3/4	
PS-48A2	Double-Faced, adder	48	37-1/2	56-3/4	
PS-48PW	Pinwheel Configuration	48	76-1/4	76-1/4	

### Computer Carrels - Starter/Adder

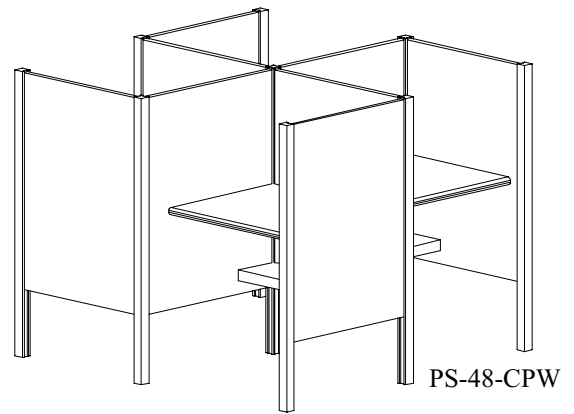
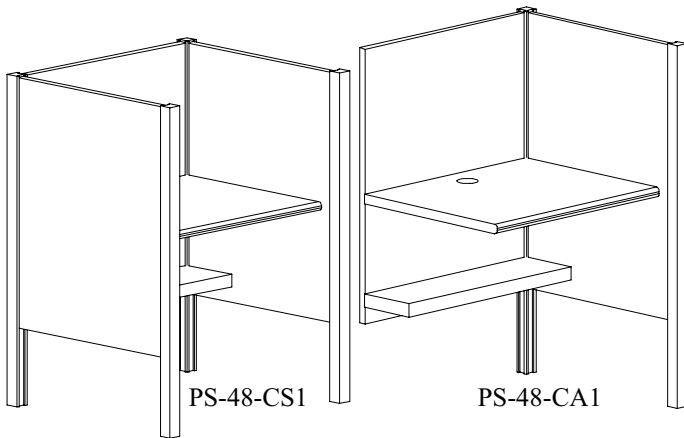

#### Single Computer Carrel (Starter-Adder)

#### Pinwheel Computer Carrel

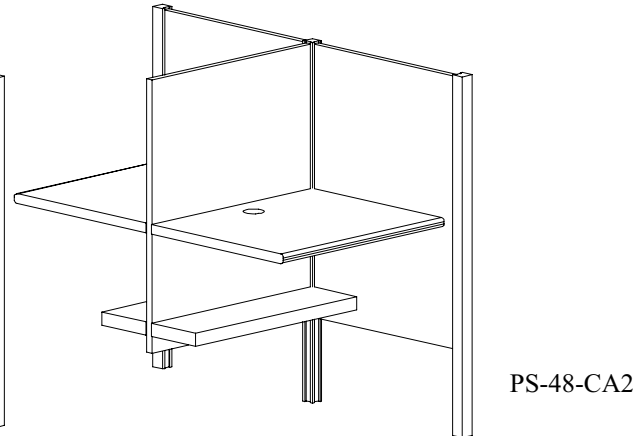
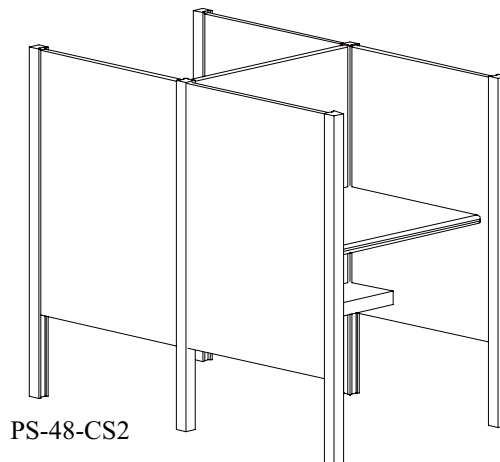

#### Double Computer Carrel (Starter-Adder)

**Computer Carrels only** have an 12"D shelf mounted under the work surface made of 3/4" veneer red oak plywood, 1/4"T solid red oak edgeband, fastened on three sides with solid wood cleats.

Catalog #	Description	Height"	Width"	Depth"	Price
PS-30CS1	Single-Faced, starter	48	33	33-1/2	
PS-30CA1	Single-Faced, adder	48	31-1/2	33-1/2	
PS-36CS1	Single-Faced, starter	48	39	33-1/2	
PS-36CA1	Single-Faced, adder	48	37-1/2	33-1/2	
PS-48CS1	Single-Faced, starter	48	50-1/2	33-1/2	
PS-48CA1	Single-Faced, adder	48	49	33-1/2	
PS-30CS2	Double-Faced, starter	48	33	64-1/4	
PS-30CA2	Double-faced, adder	48	31-1/2	64-1/4	
PS-36CS2	Double-Faced, starter	48	39	64-1/4	
PS-36CA2	Double-Faced, adder	48	37-1/2	64-1/4	
PS-48CS2	Double-Faced, starter	48	50-1/2	64-1/4	
PS-48CA2	Double-Faced, adder	48	49	64-1/4	
PS-30CPW	Pinwheel Configuration	48	64-1/4	64-1/4	
PS-36CPW	Pinwheel Configuration	48	76-1/4	76-1/4	
PS-48CPW	Pinwheel configuration	48	99-1/4"	99-1/4	

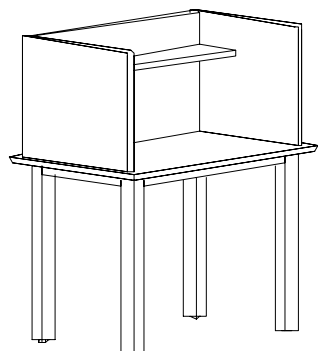

### Single Table Carrel Full Sided

Carrel shelving will be 19"H with side returns extending the full length of the work surface depth. A 3/4" T 7-ply veneer-core red oak shelf will be positioned 13" above the work surface. Shelf will be 7"D and front edge of shelf will have a 3/4" x 1-3/4" solid red oak drop edgeband.

Catalog #	Description	Height"	Width"	Depth"	Price
PS-1FR25	Table Carrel, single-faced (25"H worksurface)	44	36	24	
PS-1FR27	Table Carrel, single-faced (27"H worksurface)	46	36	24	
PS-1FR29	Table Carrel, single-faced (29"H worksurface)	48	36	24	

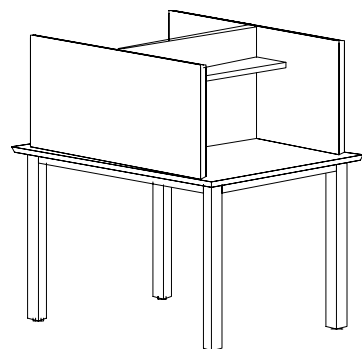

### Double Table Carrel Full Sided

Carrel shelving will be 19"H with side returns extending the full length of the work surface depth. A 3/4" T 7-ply veneer-core red oak shelf will be positioned 13" above the work surface. Shelf will be 7"D and front edge of shelf will have a 3/4" x 1-3/4" solid red oak drop edgeband.

Catalog #	Description	Height"	Width"	Depth"	Price
PS-2FR25	Table Carrel, double-faced (25"H worksurface)	44	36	48	
PS-2FR27	Table Carrel, double-faced (27"H worksurface)	46	36	48	
PS-2FR29	Table Carrel, double-faced (29"H worksurface)	48	36	48	

*"I have never let my schooling interfere with my education."*

===== *Mark Twain* =====

SEE PAGE 131 FOR EDGE DETAILS

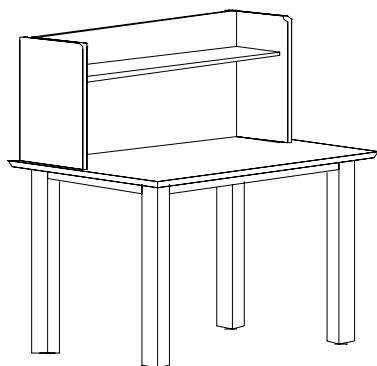

### Single Table Carrel *Short-Sided*

Carrel shelving will be 19"H with side returns extending 8" along the sides of the work surface. A 3/4" T 7-ply veneer-core red oak shelf will be positioned 13" above the work surface. Shelf will be 7"D and will have a 3/4" x 1-3/4" solid red oak drop edge band.

Catalog #	Description	Height"	Length	Width"	Price
PS-1SR25	Table Carrel, single-faced (25"H worksurface)	44	36	24	
PS-1SR27	Table Carrel, double-faced (27"H worksurface)	46	36	24	
PS-1SR29	Table Carrel, single-faced (29"H worksurface)	48	36	24	

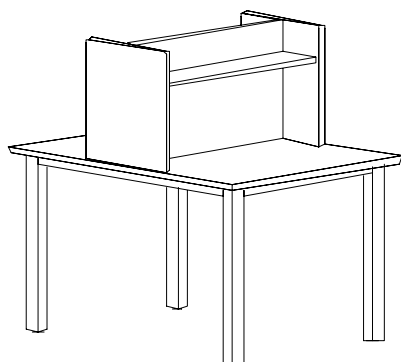

### Double Table Carrel *Short-Sided*

Carrel shelving will be 19"H with side returns extending 16" along the sides of the work surface. Two 3/4" T 7-ply veneer-core red oak shelves will be positioned 13" above the work surface. Each shelf will be 7"D and will have a 3/4" x 1-3/4" solid red oak drop edgeband.

Catalog #	Description	Height"	Width"	Depth"	Price
PS-2SR25	Table Carrel, double-faced (25"H worksurface)	44	36	48	
PS-2SR27	Table Carrel, double-faced (27"H worksurface)	46	36	48	
PS-2SR29	Table Carrel, double-faced (29"H worksurface)	48	36	48	

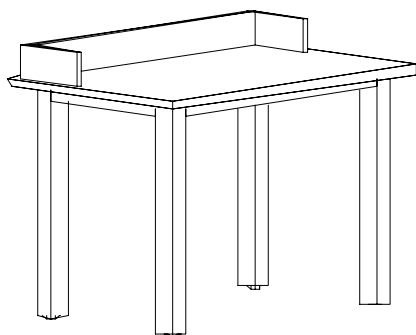

### Table Carrel

A 4"H x 1"T solid red oak book rail will be mounted on the work surface across the entire width at the back. Side returns will be the same height, fastened at right angles, and will extend 8" along the sides of the work surface. Book rails will be fastened by screws from the underside.

Catalog #	Description	Height"	Width"	Depth"	Price
PS-2FR25	Table Carrel, (25"H worksurface)	29	48	36	
PS-2FR27	Table Carrel, (27"H worksurface)	31	48	36	
PS-2FR29	Table Carrel, (29"H worksurface)	33	48	36	

SEE PAGE 131 FOR EDGE DETAILS

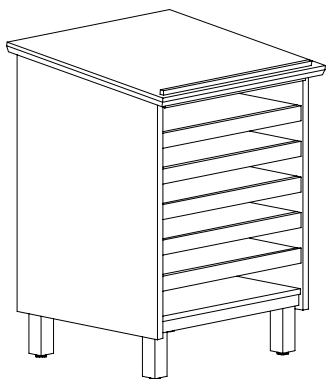

### Atlas Stand

Each Atlas Stand Unit will have pullout, full-extension shelves on ball bearing glides. Shelves will be 25-3/4"W x 23-7/8"D and will have stops to prevent accidental removal. Adult unit will have 5 shelves with 3" between shelves. Children's unit will have 4 shelves with 2-1/2" between shelves. Shelves and pullouts are 3/4" veneer red oak plywood with 1/4" red oak edgeband. Atlas stand shelves are provided with full extension ball bearing glides rated for 200 lbs. A 5/8"x5/8" red oak retainer strip is fastened to the front sloped edge.

Catalog #	Description	Height"	Width"	Depth"	Price
PS-36A T	Elementary height	35	29-3/8	27-1/16	
PS-42A T	Adult height	42	29-3/8	27-1/16	



### Dictionary Stand

Each Dictionary Stand Unit will have 2 adjustable shelves on 2" centers and 1 fixed base shelf. A 5/8" x 5/8" red oak retainer strip is fastened to the front sloped edge.

Catalog #	Description	Height"	Width"	Depth"	Price
PS-36DS	Elementary height	35	29-3/8	18	
PS-43DS	Adult height	43	29-3/8	18	

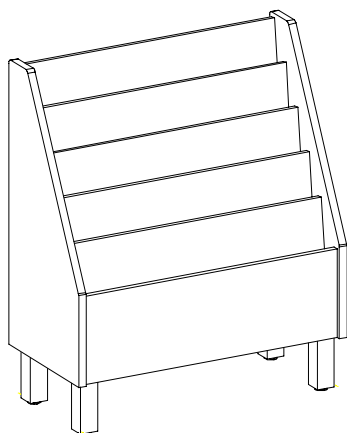

### Magazine Rack

Each Magazine Rack Unit will have 6 sloping display pockets formed by 3/4" thick, edgebanded veneer plywood dividers. Each display pocket will have a closed bottom. The back side will have a shelf and will be finished to allow for storage of back issues.

Catalog #	Description	Height"	Width"	Depth"	Price
PS-43MR	Vertical Magazine Rack	42	35-1/8	17	

SEE PAGE 131 FOR EDGE DETAILS



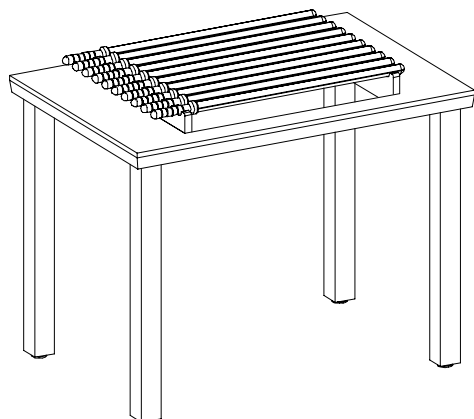

### Horizontal Newspaper Rack

Each Horizontal Newspaper Rack will have an open-top frame bordered by a holder on each side. Each holder will have 10 U-shaped grooves, each designed to accept a newspaper rod. Newspaper rods are included.

Catalog #	Description	Height"	Length	Width"	Price
PS-31HR	Universal height	31	36	26	

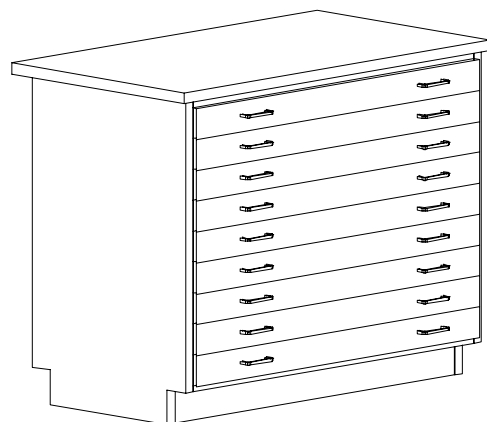

### Map Case Unit

Each unit is a stand-alone piece. Units will have 9 stacked drawers. Each drawer will be mounted on 18" full-extension, ball bearing glides with a load rating of 100 lbs. per pair.

Catalog #	Description	Height"	Width"	Depth"	Price
M C-42	Map Case	42	49	29	

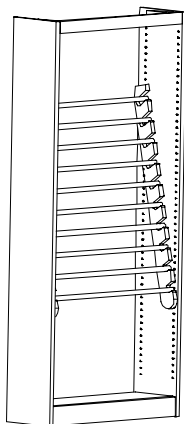

**Newspaper File Insert** will fit into 10" or 12" deep single-faced shelving, 82", 72" or 60" high. File insert will be made of two hardwood cleats, 1-1/4" thick with 1" notched slots for rods. Cleats will be attached to uprights with wood screws.

**Insert only is included in pricing.**

Catalog #	Description	Insert Height	Rod Length	Cleat Thickness	Price
INS-8260	Newspaper File Insert for 82"H Shelf (Holds 10 rods)	45-1/2"	34-7/16	1-1/4"	
INS-6042	Newspaper File Insert for 72"H Shelf (Holds 8 rods)	37"	34-7/16	1-1/4"	
INS-4236	Newspaper File Insert for 60"H Shelf (Holds 6 rods)	29-1/8"	34-7/16	1-1/4"	

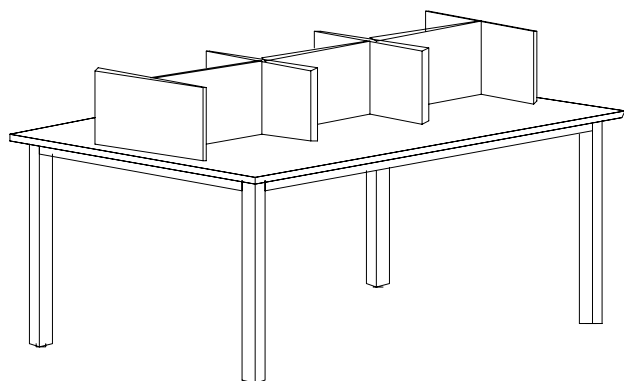

### 72" Index Table (Single or Double Tier)

The single tier shelving superstructure will be 10" high and will have 6 compartments which are 20-3/16" wide. The double tier shelving superstructure will be 24"H and will have 6 compartments which are 20-3/16" wide

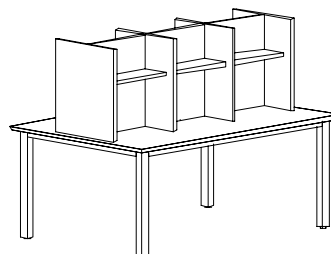

Catalog #	Description	Height"	Length"	Width"	Price
PS-1T72	Single-Tier Double-Faced	39	72	48	
PS-2T72	Double-Tier Double-Faced	53	72	48	

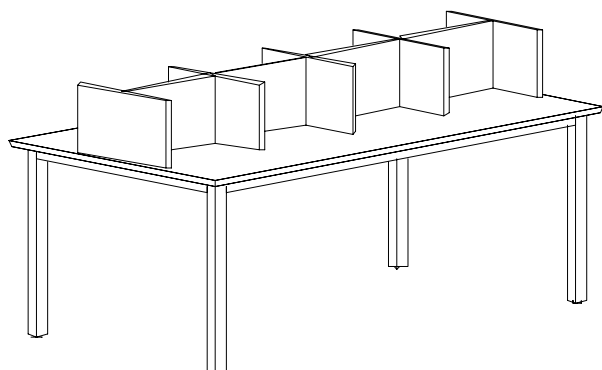

### 90" Index Table (Single or Double Tier)

The single tier shelving superstructure will be 10" high and will have 8 compartments which are 20-3/16" wide. Double tier shelving superstructure is 24"H and have 8 compartments 20-3/16"W.

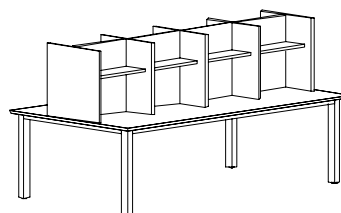

Catalog #	Description	Height"	Length"	Width"	Price
PS-1T90	Single-Tier Double-Faced	39	90	48	
PS-2T90	Double-Tier Double-Faced	53	90	48	

**SEE PAGE 131 FOR EDGE DETAILS**

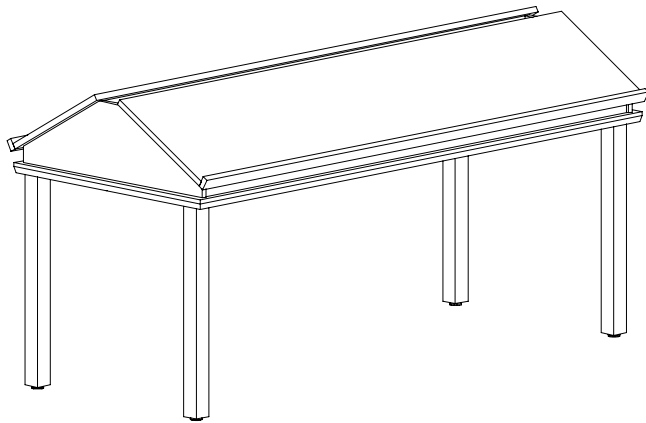

### Picture-Book Table

The table will consist of two 78"L x 15-3/4"W x 7/8"T tops mounted at a 27 degree angle. A 5/8" square retaining strip will be mounted on the lower edge of each top. A space of 3" will be provided between the tops to allow a full-length book well. Tables

Catalog #	Description	Height"	Length"	Width"	Price
PS-62PT	62"L Picture-Book Table	33-3/4	62	31	
PS-78PT	78"L Picture-Book Table	33-3/4	78	31	

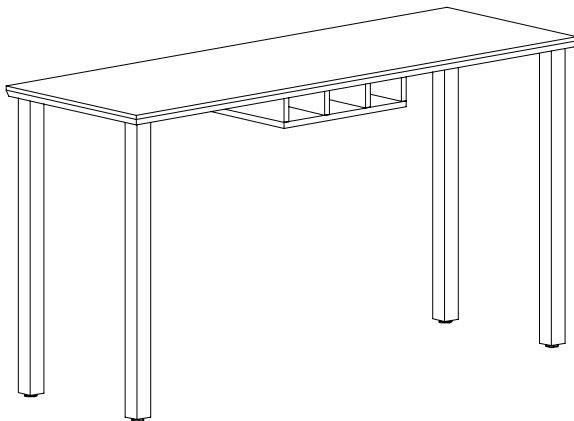

### Consultation Table

A three-compartment call-slip rack for 3" x 5" slips will be attached to the underside of the table. Tables are supplied without aprons, and must therefore be specified on order if so desired. (Aprons are necessary but not required for concealing the leg plate on tables with a flush edgeband)

Catalog #	Description	Height"	Length"	Width"	Price
PS-72CT	Consultation Table	39	72	24	

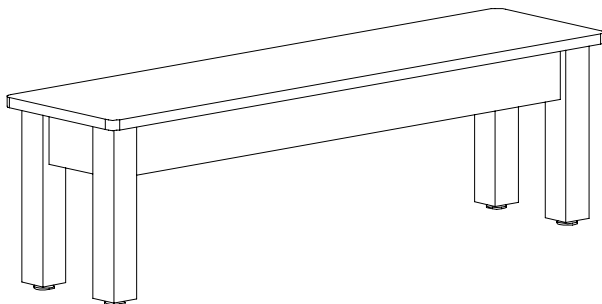

48"L bench shown

### Bench

Seat will be 3/4"T red oak veneer plywood edge banded with 1/4"T solid red oak. Leg are made of 2-1/4" square solid red oak with a 1-3/4" diameter threaded leveling glide which is mounted in countersunk and recessed T-nut. Apron is 3" x 1"T solid red

Catalog #	Description	Height"	Length"	Width"	Price
PS-69B	69"L Bench	15	69	12	
PS-48B	48"L Bench	15	48	12	

**Planning For & Ordering Edgeband for Providence Series  
Carrels, Carrel Tables and Display Furniture.**

**All display *tables* on pages 123-130 only come with a 3/4" T solid red oak DROP edgeband.**

Choose from any one of the DROP details below.

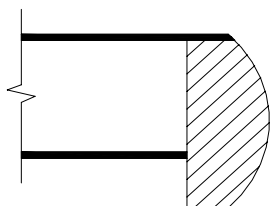

1 1/4" thick top (Internal)  
**Shallow Bullnose Drop**

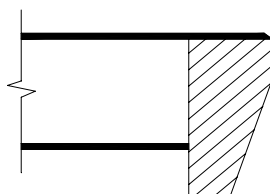

1 1/4" thick top (Internal)  
**Premier Drop**

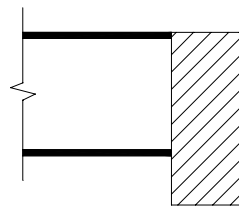

1 1/4" thick top (External)  
**Montana Drop**

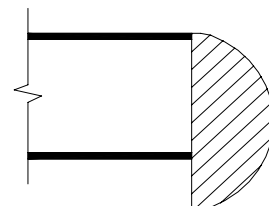

1 1/4" thick top (External)  
**Bullnose Drop**

**All other units in this  
section may use any  
one of these details.**

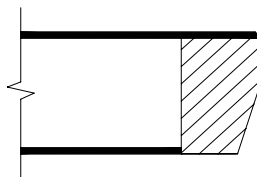

1 1/4" thick top (Internal)  
**Premier Flush**

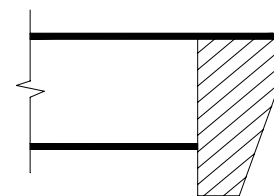

1 1/4" thick top (Internal)  
**Premier Drop**

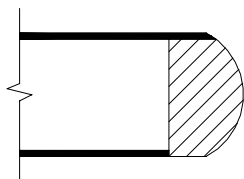

1 1/4" thick top (Internal)  
**Shallow Bullnose Flush**

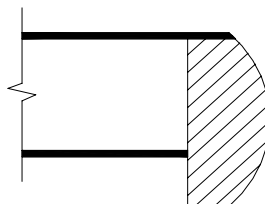

1 1/4" thick top (Internal)  
**Shallow Bullnose Drop**

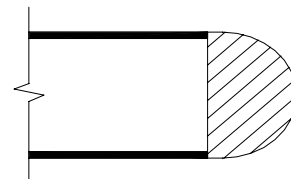

1 1/4" thick top (External)  
**Bullnose Flush**

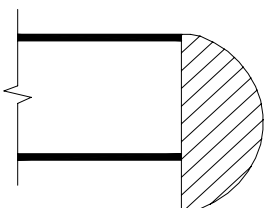

1 1/4" thick top (External)  
**Bullnose Drop**

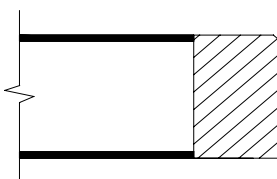

1 1/4" thick top (External)  
**Montana Flush**

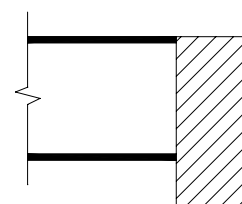

1 1/4" thick top (External)  
**Montana Drop**

***Providence*** <sup>TM</sup>

Leg Based Furniture

Russwood Library Furniture

---

## ELITE SERIES GENERAL SPECIFICATIONS

**All Elite Series table and unit tops** will be constructed of 1-1/8" thick, 45-pound density particleboard-core with .050" thick high-pressure laminate and .020" thick backer sheet glued to opposite faces for a finished thickness of 1-1/4". (Note: Table tops can be constructed from 9 or 11-ply lumber core or high pressure laminate *for an additional charge*). Tops will be banded with 3/4" T solid red oak with and profile determined by customer selection from edge band chart. (pg 135) Table edges will be finished to match table end panels.

**Tops are fastened to side/end/back panels** using 14 gauge steel brackets and top quality wood screws.

**Computer table and carrel tops only** will have grommets and J-wire managers to provide control and concealment of equipment wires.

**All two sided tables** will have a banded 12"W x 1"T red oak veneer plywood *keel* that runs the length of the table and doweled into the end panels. **All one sided tables** will have a banded full length *modesty panel* made of 3/4" T red oak veneer plywood.

**End panels** will be 1" T plain-sliced red oak veneer plywood. A solid wood 1/2" thick edge band is applied to all exposed panel edges and 1/8" radius. The bottom of each panel base will have two 7/8" diameter leveling glides.

**End panels** are glued and doweled to modesty/keel panel using 3/4" square solid wood cleats that are glued and screwed on two sides using wood screws.

**Curbing and Index Shelving** are constructed of 1" veneer-core red oak plywood secured to the table top by screws passing through the table top and into the assembly. Exposed edges will have a 1/2" T solid red oak edge band. The banded edges of the uprights and shelves will receive an 1/8" radius.

**Study and Computer Carrels** are "starter/adder" design and have 1" T red oak veneer plain-sliced plywood side panels and 3/4" T back panels. End panels are receive a 1/2" T solid red oak band with a 1/8" radius. Back panels receive a 1/4" T solid red oak band with a 1/8" radius. The back panel is aligned using dowels and fastened by 3/4" square solid red oak screw cleat.

**Study Carrels only** have an 8"D bookshelf mounted on the back panel above the work surface. Shelf is 3/4" red oak veneer plywood banded with 1-3/4"W x 3/4" T solid red oak edge band. Shelf is fastened to panels on three sides with solid red oak cleats.

**Computer Carrels only** have an 12"D bookshelf mounted on the back panel above the work surface. Shelf is 3/4" red oak veneer plywood banded with a 1-3/4"W x 3/4" T solid red oak edge band. Shelf is fastened to panels on three sides with solid red oak cleats.

**Display Unit** side panels are 1" T red oak veneer plain-sliced red oak plywood. Back panels are 3/4" T red oak rift cut veneer plywood. A 5/8" x 5/8" (radius on top edge) red oak retainer strip is fastened to the front of the work surface. Shelves and pullouts are 3/4" T red oak veneer plywood with 1/4" T solid red oak edge band. Shelves and pullouts are 3/4" veneer red oak plywood with 1/4" red oak edge band. Atlas stand shelves are provided with full extension ball bearing glides rated for 200 lbs.

**Shelves** will be 3/4" T red oak veneer plywood with 1/4" T solid red oak edge band unless otherwise noted.

**FINISH** - See page 5 for finish specifications.

Visit our web site at [www.russwood.net](http://www.russwood.net)

**IMPORTANT PLANNING AND ORDERING INFORMATION**

**Many of the tables in the Elite Series can be constructed with  
a “Captured” or an “Extended” work surface.**

Please note the differences in the two styles below as you plan - and particularly in ordering.

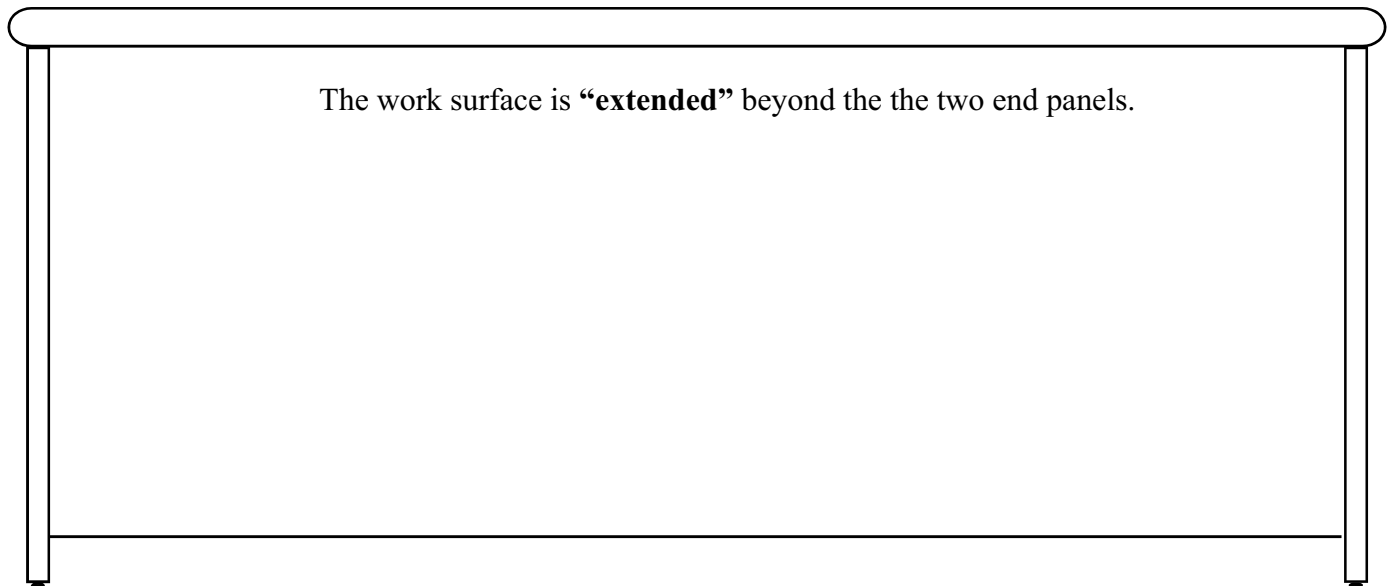
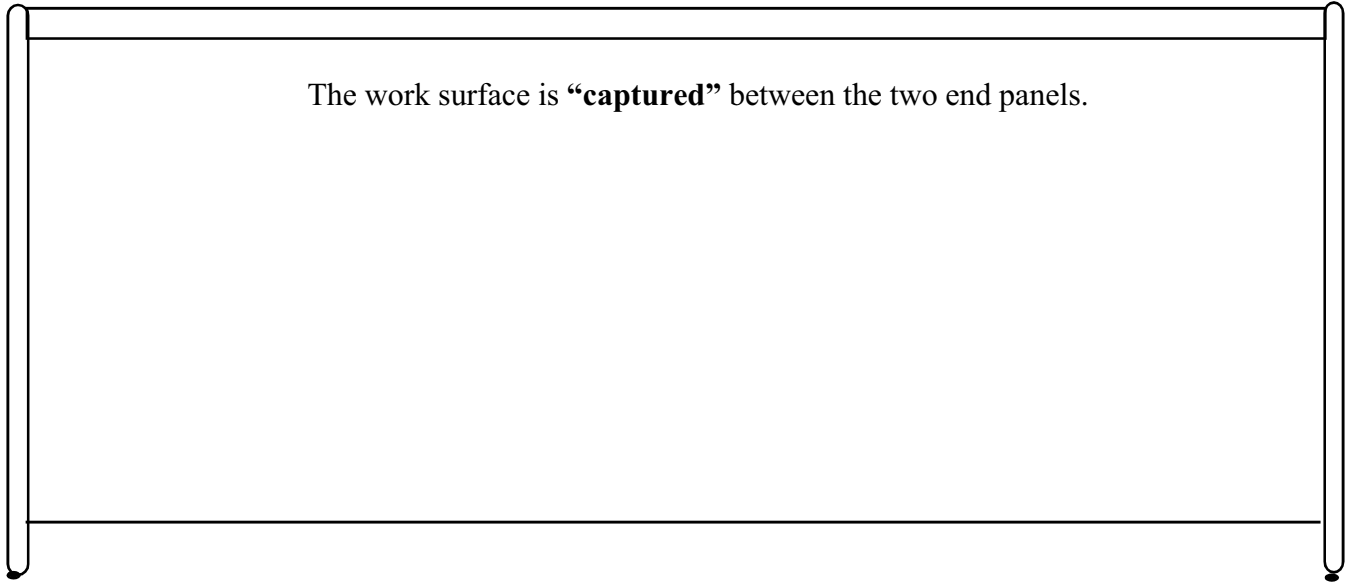

## **EDGE DETAILS FOR THE ELITE SERIES**

**Elite Series work surfaces\* may have any one of the 3/4" T solid red oak edge details below.**

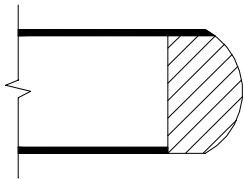

1 1/4" thick top (Internal)  
**Shallow Bullnose Flush**

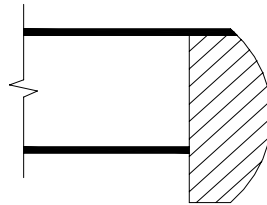

1 1/4" thick top (Internal)  
**Shallow Bullnose Drop**

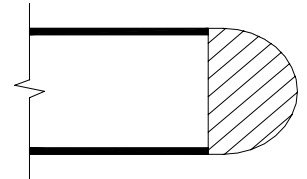

1 1/4" thick top (External)  
**Bullnose Flush**

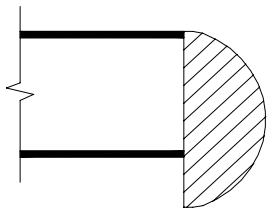

1 1/4" thick top (External)  
**Bullnose Drop**

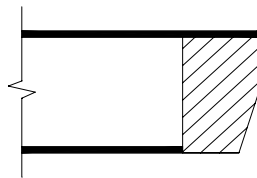

1 1/4" thick top (Internal)  
**Premier Flush**

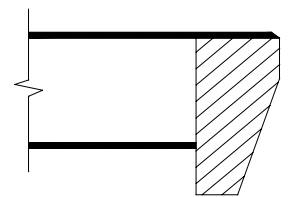

1 1/4" thick top (Internal)  
**Premier Drop**

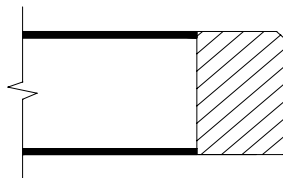

1 1/4" thick top (External)  
**Montana Flush**

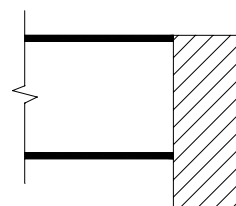

1 1/4" thick top (External)  
**Montana Drop**

**\* Edge Detail  
for Modular  
Computer Table  
Page 158**

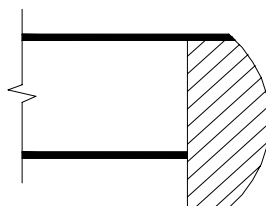

1 1/4" thick top (Internal)  
**Shallow Bullnose Drop**



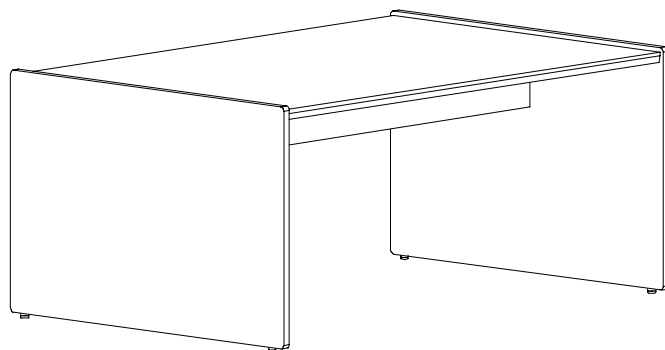

**Four-Person Study Table  
Captured Top**

Catalog #	Description	Height"	Length"	Width"	Price
ES-254R01	25" H Four-Person Reading Table	25	60	36	
ES-254R02	25" H Four-Person Reading Table	25	72	36	
ES-254R03	25" H Four-Person Reading Table	25	72	48	
ES-254R04	25" H Four-Person Reading Table	25	72	42	
ES-274R01	27"H Four-Person Reading Table	27	60	36	
ES-274R02	27" H Four-Person Reading Table	27	72	36	
ES-274R03	27"H Four-Person Reading Table	27	72	48	
ES-274R04	27" H Four-Person Reading Table	27	72	42	
ES-294R01	29" H Four-Person Reading Table	29	60	36	
ES-294R02	29" H Four-Person Reading Table	29	72	36	
ES-294R03	29" H Four-Person Reading Table	29	72	48	
ES-294R04	29" H Four-Person Reading Table	29	72	42	

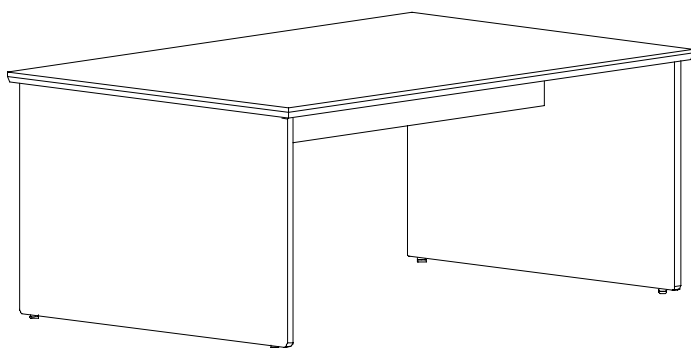

**Four-Person Study Table  
Extended Top**

Catalog #	Description	Height"	Length"	Width"	Price
ES-254R10	25"H Four-Person Reading Table	25	60	36	
ES-254R11	25"H Four-Person Reading Table	25	72	36	
ES-254R12	25"H Four-Person Reading Table	25	72	48	
ES-254R13	25"H Four-Person Reading Table	25	72	42	
ES-274R10	27"H Four-Person Reading Table	27	60	36	
ES-274R11	27"H Four-Person Reading Table	27	72	36	
ES-274R12	27"H Four-Person Reading Table	27	72	48	
ES-274R13	27"H Four-Person Reading Table	27	72	42	
ES-294R10	29"H Four-Person Reading Table	29	60	36	
ES-294R11	29"H Four-Person Reading Table	29	72	36	
ES-294R12	29"H Four-Person Reading Table	29	72	48	
ES-294R13	29"H Four-Person Reading Table	29	72	42	

See Page 135 For Edge Details

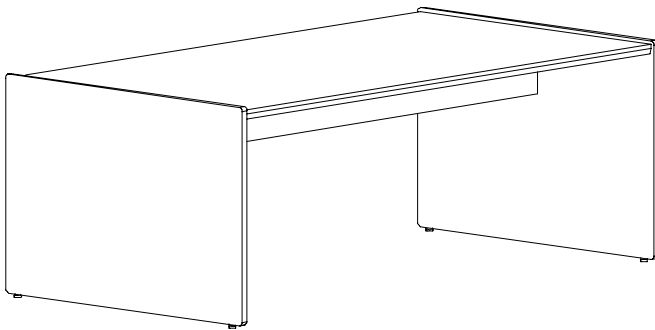

**Six-Person Study Table  
Captured Top**

Catalog #	Description	Height"	Length"	Width"	Price
ES-256R01	25"H Six-Person Reading Table	25	90	36	
ES-256R02	25"H Six-Person Reading Table	25	90	48	
ES-256R03	25"H Six-Person Reading Table	25	90	42	
ES-276R01	27"H Six-Person Reading Table	27	90	36	
ES-276R02	27"H Six-Person Reading Table	27	90	48	
ES-276R03	27"H Six-Person Reading Table	27	90	42	
ES-296R01	29"H Six-Person Reading Table	29	90	36	
ES-296R02	29"H Six-Person Reading Table	29	90	48	
ES-296R03	29"H Six-Person Reading Table	29	90	42	

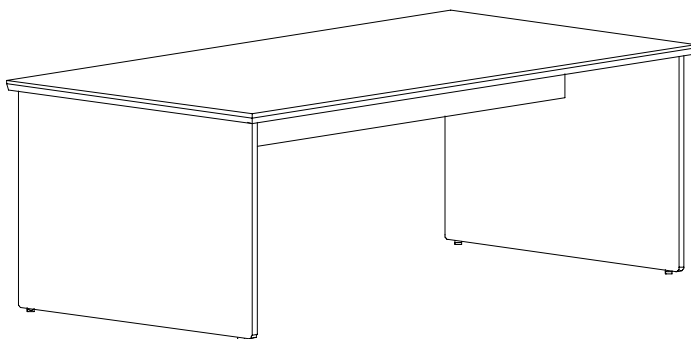

**Six-Person Study Table  
Extended Top**

Catalog #	Description	Height"	Length"	Width"	Price
ES-256R10	25"H Six-Person Reading Table	25	90	36	
ES-256R12	25"H Six-Person Reading Table	25	90	42	
ES-256R11	25"H Six-Person Reading Table	25	90	48	
ES-276R10	27"H Six-Person Reading Table	27	90	36	
ES-276R12	27"H Six-Person Reading Table	27	90	42	
ES-276R11	27"H Six-Person Reading Table	27	90	48	
ES-296R10	29"H Six-Person Reading Table	29	90	36	
ES-296R12	29"H Six-Person Reading Table	29	90	42	
ES-296R11	29"H Six-Person Reading Table	29	90	48	

See Page 135 For Edge Details



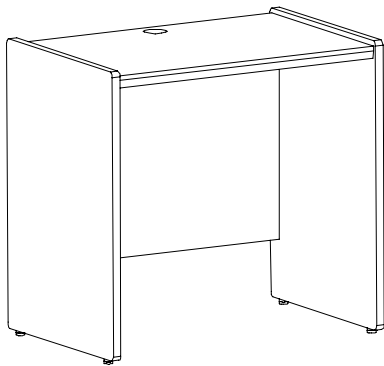

### 30"L x 24"W Flat Screen Computer Table (Starter) Captured Top

Work surface is connected to the end panels via 14 gauge metal bolt cleat using a threaded insert. The back panel is doweled into the end panel connected with 3/4" square wooden screw cleats.

This unit can be used in conjunction with any 24" W computer table adder. Starter and adder units will be shipped unassembled.

Catalog #	Description	Height"	Length"	Width"	Price
ES-302425	Sitting-Height Unit, child	25	30	24	
ES-302427	Intermediate-Height Unit	27	30	24	
ES-302429	Sitting-Height Unit, adult	29	30	24	
ES-302439	Standing-Height Unit	39	30	24	

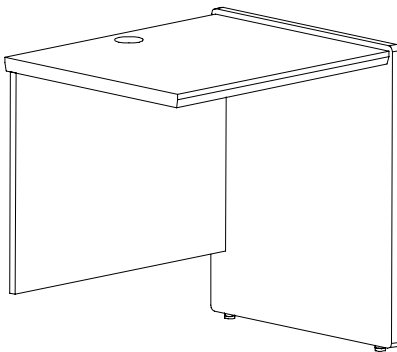

### 30"L x 24"W Flat Screen Computer Table (Adder) Captured Top

Work surface is connected to the end panels via 14 gauge metal bolt cleat using a threaded insert. The back panel is doweled into the end panel connected with 3/4" square wooden screw cleats.

This unit can be used in conjunction with any one 24"W starter and any series of 24"W adders. Starter and adder units will be shipped unassembled.

Catalog #	Description	Height"	Length"	Width"	Price
ES-302425A	Sitting-Height Unit, child	25	30	24	
ES-302427A	Intermediate-Height Unit	27	30	24	
ES-302429A	Sitting-Height Unit, adult	29	30	24	
ES-302439A	Standing-Height Unit	39	30	24	

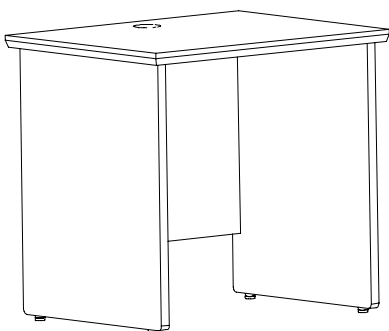

### 30"L x 24"W Flat Screen Computer Table Extended Top

Catalog #	Description	Height"	Length"	Width"	Price
ES-302425E	Sitting-Height Unit, child	25	30	24	
ES-302427E	Intermediate-Height Unit	27	30	24	
ES-302429E	Sitting-Height Unit, adult	29	30	24	
ES-302439E	Standing-Height Unit	39	30	24	

See Page 135 For Edge Details

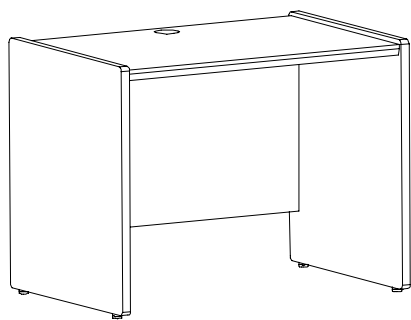

### 36"L x 24"W Flat Screen Computer Table (Starter) Captured Top

Work surface is connected to the end panels via 14 gauge metal bolt cleat using a threaded insert . The back panel is doweled into the end panel connected with 3/4" square wooden screw cleats.

This unit can be used in conjunction with any 24" W computer table adder. Starter and adder units will be shipped unassembled.

Catalog #	Description	Height"	Length"	Width"	Price
ES-362425	Sitting-Height Unit,child	25	36	24	
ES-362427	Intermediate-Height Unit	27	36	24	
ES-362429	Sitting-Height Unit, adult	29	36	24	
ES-362439	Standing-Height Unit	39	36	24	

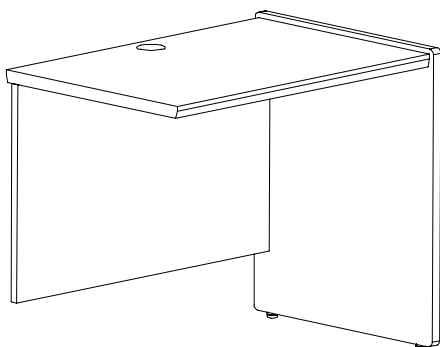

### 36"L x 24"W Flat Screen Computer Table (Adder) Captured Top

Work surface is connected to the end panels via 14 gauge metal bolt cleat using a threaded insert . The back panel is doweled into the end panel connected with 3/4" square wooden screw cleats.

This unit can be used in conjunction with any one 24"W starter and any series of 24"W adders. Starter and adder units will be shipped unassembled.

Catalog #	Description	Height"	Length"	Width"	Price
ES-362425A	Sitting-Height Unit,child	25	36	24	
ES-362427A	Intermediate-Height Unit	27	36	24	
ES-362429A	Sitting-Height Unit, adult	29	36	24	
ES-362439A	Standing-Height Unit	39	36	24	

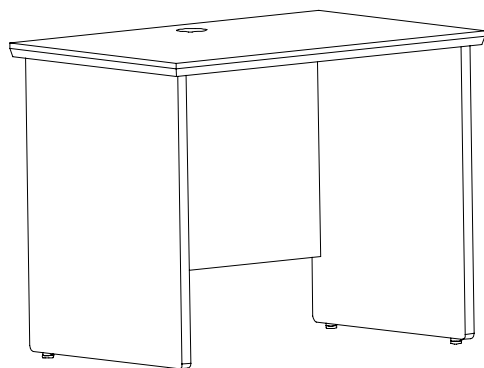

### 36"L x 24"W Flat Screen Computer Table Extended Top

Catalog #	Description	Height"	Length"	Width"	Price
ES-362425E	Sitting-Height Unit,child	25	36	24	
ES-362427E	Intermediate-Height Unit	27	36	24	
ES-362429E	Sitting-Height Unit, adult	29	36	24	
ES-362439E	Standing-Height Unit	39	36	24	

See Page 135 For Edge Details

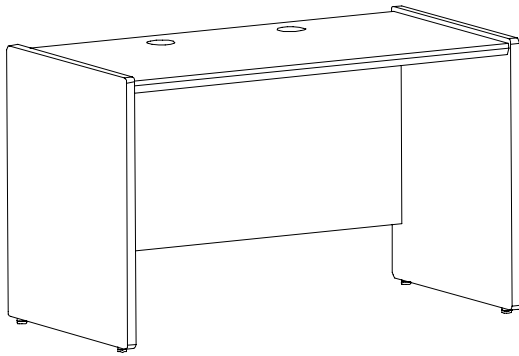

### 48"L x 24"W Flat Screen Computer Table (Starter) Captured Top

Work surface is connected to the end panels via 14 gauge metal bolt cleat using a threaded insert. The back panel is doweled into the end panel connected with 3/4" square wooden screw cleats.

This unit can be used in conjunction with any 24" W computer table adder. Starter and adder units will be shipped unassembled.

Catalog #	Description	Height"	Length"	Width"	Price
ES-482425	Sitting-Height Unit, child	25	48	24	
ES-482427	Intermediate Unit,	27	48	24	
ES-482429	Sitting-Height Unit	29	48	24	
ES-482439	Standing-Height Unit	39	48	24	

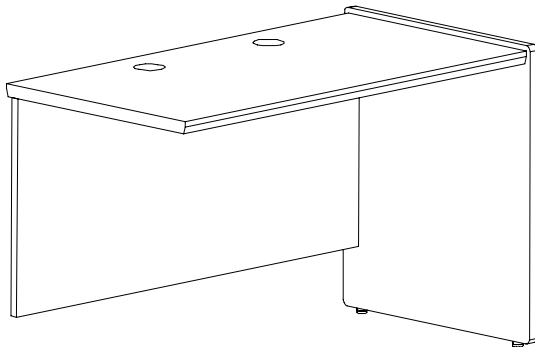

### 48"L x 24"W Flat Screen Computer Table (Adder) Captured Top

Work surface is connected to the end panels via 14 gauge metal bolt cleat using a threaded insert. The back panel is doweled into the end panel connected with 3/4" square wooden screw cleats.

This unit can be used in conjunction with any one 24"W starter and any series of 24"W adders. Starter and adder units will be shipped unassembled.

Catalog #	Description	Height"	Length"	Width"	Price
ES-482425A	Sitting-Height Unit, child	25	48	24	
ES-482427A	Intermediate Unit,	27	48	24	
ES-482429A	Sitting-Height Unit	29	48	24	
ES-482439A	Standing-Height Unit	39	48	24	

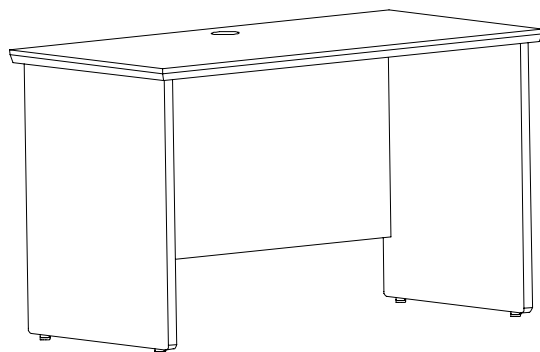

### 48"L x 24"W Flat Screen Computer Table Extended Top

Catalog #	Description	Height"	Length"	Width"	Price
ES-482425E	Sitting-Height Unit, child	25	48	24	
ES-482427E	Intermediate-Height Unit	27	48	24	
ES-482429E	Sitting-Height Unit, adult	29	48	24	
ES-482439E	Standing-Height Unit	39	48	24	

See Page 135 For Edge Details

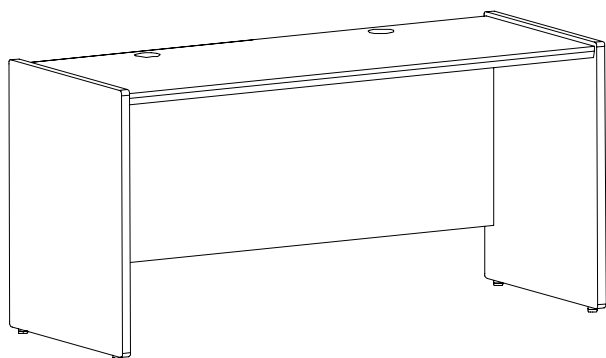

### 60"L x 24"W Flat Screen Computer Table (Starter) Captured Top

Work surface is connected to the end panels via 14 gauge metal bolt cleat using a threaded insert . The back panel is doweled into the end panel connected with 3/4" square wooden screw cleats.

This unit can be used in conjunction with any 24" W computer table adder. Starter and adder units will be shipped unassembled.

Catalog #	Description	Height"	Length"	Width"	Price
ES-602425	Sitting-Height Unit, child	25	60	24	
ES-602427	Intermediate Unit, 60" L x 24" W x 27" H (panel)	27	60	24	
ES-602429	Sitting-Height Unit, 60" L x 24" W x 29" H (panel)	29	60	24	
ES-602439	Standing-Height Unit, 60" L x 24" W x 39" H	39	60	24	

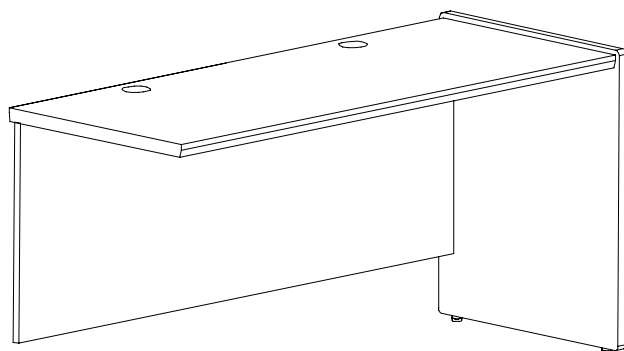

### 60"L x 24"W Flat Screen Computer Table (Adder) Captured Top

Work surface is connected to the end panels via 14 gauge metal bolt cleat using a threaded insert . The back panel is doweled into the end panel connected with 3/4" square wooden screw cleats.

This unit can be used in conjunction with any one 24"W starter and any series of 24"W adders. Starter and adder units will be shipped unassembled.

Catalog #	Description	Height"	Length"	Width"	Price
ES-602425A	Sitting-Height Unit, child	25	60	24	
ES-602427A	Intermediate Unit, 60" L x 24" W x 27" H (panel)	27	60	24	
ES-602429A	Sitting-Height Unit, 60" L x 24" W x 29" H (panel)	29	60	24	
ES-602439A	Standing-Height Unit, 60" L x 24" W x 39" H	39	60	24	

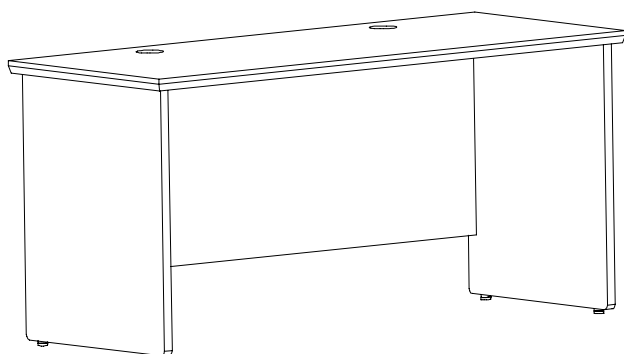

### 60"L x 24"W Flat Screen Computer Table Extended Top

Catalog #	Description	Height"	Length"	Width"	Price
ES-602425E	Sitting-Height Unit, child	25	60	24	
ES-602427E	Intermediate Unit, 60" L x 24" W x 27" H (panel)	27	60	24	
ES-602429E	Sitting-Height Unit, 60" L x 24" W x 29" H (panel)	29	60	24	
ES-602439E	Standing-Height Unit, 60" L x 24" W x 39" H	39	60	24	