Specifying Modular Power

Specifying

Modular Power

Modular-to-Hardwire Harnesses	296
Modular Extension Harnesses	297
Modular Connector Faceplates	298
Zone Boxes	299
Three-Way Branching Connectors	300
Harness-to-Harness Connectors	300
Dust Caps for Modular Connector	301
Floor Power-Infeeds or Base Power-In Transition Harnesses	302
Ceiling Power Transition Harnesses	306
Shallow Floor Access Boxes	306
Floor Access Boxes	307
Shallow Floor Access Box for Hardwire Connection	307
Floor Access Box for Hardwire Connection	308
Receptacles for Use with Floor Access Boxes	310

Modular Power

Modular-to-Hardwire Harnesses

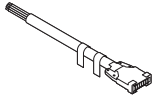

Standard Includes	Required to Specify
<ul style="list-style-type: none"> Need help? Product details, page 289 Harness Male modular connector Pigtail for hardwire connection to electrical panel 	Style number

Specification Information

Harness Length	Style Number	U.S. Price
----------------	--------------	------------

4-Circuit, 3+1

5'	GAPMH5X	\$159
10'	GAPMH10X	\$164
30'	GAPMH30X	\$343
50'	GAPMH50X	\$522
:	:	:

4-Circuit, 2+2

5'	GAPMH5Y	\$159
10'	GAPMH10Y	\$164
30'	GAPMH30Y	\$343
50'	GAPMH50Y	\$522
:	:	:

3-Circuit, Separate Neutrals

5'	GAPMH5Z	\$159
10'	GAPMH10Z	\$164
30'	GAPMH30Z	\$343
50'	GAPMH50Z	\$522
:	:	:



For Canadian Pricing

Multiply U.S. Price by the Canadian price factor.

► See page 1 for details.

Modular Extension Harnesses

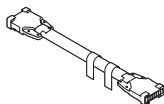

Tip: Connect multiple harnesses together for longer runs.

Tip: Modular power manufactured before May 2004 (round conduit) are not interchangeable after May 2004 (oval conduit). A power-out modular harness is available from Steelcase Service Parts to make a modular connection between the two versions.

Standard Includes	Required to Specify
<p>► Need help? Product details, page 289</p> <ul style="list-style-type: none"> • Harness • Male modular connectors 	Style number

Specification Information

Harness Length	Style Number	U.S. Price
4-Circuit, 3+1		
5'	GAPHM5X	\$149
10'	GAPHM10X	\$186
15'	GAPHM15X	\$251
20'	GAPHM20X	\$315
30'	GAPHM30X	\$426
40'	GAPHM40X	\$532
50'	GAPHM50X	\$619
:	:	:
4-Circuit, 2+2		
5'	GAPHM5Y	\$149
10'	GAPHM10Y	\$186
15'	GAPHM15Y	\$251
20'	GAPHM20Y	\$315
30'	GAPHM30Y	\$426
40'	GAPHM40Y	\$532
50'	GAPHM50Y	\$619
:	:	:
3-Circuit, Separate Neutrals		
5'	GAPHM5Z	\$149
10'	GAPHM10Z	\$186
15'	GAPHM15Z	\$251
20'	GAPHM20Z	\$315
30'	GAPHM30Z	\$426
40'	GAPHM40Z	\$532
50'	GAPHM50Z	\$619
:	:	:



For Canadian Pricing

Multiply U.S. Price by the Canadian price factor.

► See page 1 for details.

Modular Connector Faceplates

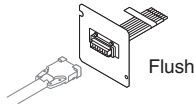

Flush

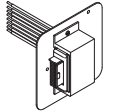

90°

Standard Includes	Required to Specify
<ul style="list-style-type: none"> Need help? Product details, page 289 Faceplate with flush connection: galvanized steel Faceplate with 90° connection: black paint Female modular connector Pigtail for hardwire connection 	Style number

Specification Information

Connection	Style Number	U.S. Price
------------	--------------	------------

4-Circuit, 3+1

Flush	GAPFCMX	\$ 58
90°	GAPFCM90X	\$106

4-Circuit, 2+2

Flush	GAPFCMY	\$ 58
90°	GAPFCM90Y	\$106

3-Circuit, Separate Neutrals

Flush	GAPFCMZ	\$ 58
90°	GAPFCM90Z	\$106



For Canadian Pricing

Multiply U.S. Price by the Canadian price factor.

► See page 1 for details.

Zone Boxes

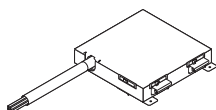

Tip: Zone boxes accommodating 150' and 200' infeed harnesses are 8 gauge.

Tip: Modular power manufactured before May 2004 (round conduit) are not interchangeable after May 2004 (oval conduit). A power-out modular harness is available from Steelcase Service Parts to make a modular connection between the two versions.

Standard Includes	Required to Specify
<p>► Need help? Product details, page 290</p> <ul style="list-style-type: none"> • Zone box: black zinc • Lengths of 50 to 125 feet are 10 gauge home run conductors with 3 harness ports and strain reliefs • Lengths of 150 and 200 feet are 8 gauge home run conductors with 2 harness ports and strain reliefs • One power infeed • Built-in anchoring tabs 	Style number

Specification Information

Harness Length	Style Number	U.S. Price
----------------	--------------	------------

4-Circuit, 3+1

Hardwired, 8 gauge	GAPZBHW8X	\$ 609
Hardwired, 10 gauge	GAPZBHW10X	\$ 609
50'	GAPZBM50X	\$1565
75'	GAPZBM75X	\$2176
100'	GAPZBM100X	\$2781
125'	GAPZBM125X	\$3299
150'	GAPZBM150X	\$3824
200'	GAPZBM200X	\$5031
:	:	:

4-Circuit, 2+2

Hardwired, 8 gauge	GAPZBHW8Y	\$ 609
Hardwired, 10 gauge	GAPZBHW10Y	\$ 609
50'	GAPZBM50Y	\$1565
75'	GAPZBM75Y	\$2176
100'	GAPZBM100Y	\$2781
125'	GAPZBM125Y	\$3299
150'	GAPZBM150Y	\$3824
200'	GAPZBM200Y	\$5031
:	:	:

3-Circuit, Separate Neutrals

Hardwired, 8 gauge	GAPZBHW8Z	\$ 609
Hardwired, 10 gauge	GAPZBHW10Z	\$ 609
50'	GAPZBM50Z	\$1565
75'	GAPZBM75Z	\$2176
100'	GAPZBM100Z	\$2781
125'	GAPZBM125Z	\$3299
150'	GAPZBM150Z	\$3824
200'	GAPZBM200Z	\$5031
:	:	:



For Canadian Pricing
Multiply U.S. Price by the
Canadian price factor.
► See page 1 for details.

Three-Way Branching Connectors

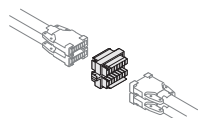

Tip: Branching connector distributes all circuits to each connection point.

Tip: Modular power manufactured before May 2004 (round conduit) are not interchangeable after May 2004 (oval conduit). A power-out modular harness is available from Steelcase Service Parts to make a modular connection between the two versions.

Standard Includes		Required to Specify
<p>► Need help? Product details, page 291</p> <ul style="list-style-type: none"> • Branching connector: Ultramid nylon • Three modular connection attachment points • One power infeed harness connection point 		Style number
Specification Information		
Style Number	U.S. Price	
4-Circuit, 3+1		
GAP3HCX	\$25	
4-Circuit, 2+2		
GAP3HCY	\$25	
3-Circuit, Separate Neutrals		
GAP3HCZ	\$25	

Harness-to-Harness Connectors

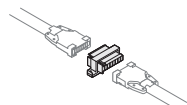

Standard Includes		Required to Specify
<p>► Need help? Product details, page 291</p> <ul style="list-style-type: none"> • Branching connector: Ultramid nylon • One modular connection attachment point • One power infeed harness connection point 		Style number
Specification Information		
Style Number	U.S. Price	
4-Circuit, 3+1		
GAPHHCX	\$25	
4-Circuit, 2+2		
GAPHHCY	\$25	
3-Circuit, Separate Neutrals		
GAPHHCZ	\$25	



For Canadian Pricing
Multiply U.S. Price by the Canadian price factor.
► See page 1 for details.

Dust Caps for Modular Connector



Standard Includes	Required to Specify
<ul style="list-style-type: none">Dust caps for modular connector: Ultramid nylonPackage of 20 caps	Style number

Specification Information	
Style Number	U.S. Price
GAPDC20	\$91



For Canadian Pricing
Multiply U.S. Price by the
Canadian price factor.
▶ See page 1 for details.

Floor Power-Infeeds or Base Power-In Transition Harnesses

Tip: Transition harnesses require a 3" diameter hole in floor tile.

Tip: Length of conduit between connection point wall or panel and transition point into floor is 3'.

Tip: A transition harness is not required for Answer and Montage where the power can be directly fed into the panel.

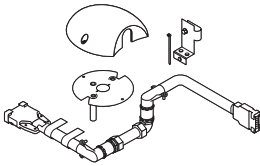

Standard Includes	Required to Specify
<ul style="list-style-type: none"> Need help? Product details, page 291 Power transition harness Male modular connector to Modular Power system Modular connector to connect to compatible system Power transition cover: black plastic only 	Style number

Specification Information

Length	Style Number	U.S. Price
:	:	:

For Post and Beam Floor Power-Infeeds Connecting to Powerkit Blocks

4-Circuit, 3+1

6'	GAPTHFLX	\$399
----	-----------------	-------

4-Circuit, 3+1 for New York

6'	GAPTHFNYX	\$370
----	------------------	-------

4-Circuit, 3+1 for San Francisco

6'	GAPTHFLSFX	\$399
----	-------------------	-------

4-Circuit, 2+2

6'	GAPTHFLY	\$399
----	-----------------	-------

4-Circuit, 2+2 for New York

6'	GAPTHFNYY	\$370
----	------------------	-------

4-Circuit, 2+2 for San Francisco

6'	GAPTHFLSFY	\$399
----	-------------------	-------

3-Circuit, Separate Neutrals

6'	GAPTHFLZ	\$399
----	-----------------	-------

3-Circuit, Separate Neutrals for New York

6'	GAPTHFNZY	\$370
----	------------------	-------

3-Circuit, Separate Neutrals for San Francisco

6'	GAPTHFLSFZ	\$399
----	-------------------	-------

► **Specification Information, continued on next page**



For Canadian Pricing

Multiply U.S. Price by the Canadian price factor.

► See page 1 for details.

► Specification Information, continued from previous page

Specification Information

Length	Style Number	U.S. Price
--------	-----------------	---------------

For Internode Floor Power-Infeeds**4-Circuit, 3+1**

6'	GAPTHINTX	\$399
----	------------------	-------

4-Circuit, 3+1 for New York

6'	GAPTHINNYX	\$370
----	-------------------	-------

4-Circuit, 3+1 for San Francisco

6'	GAPTHINTSFX	\$399
----	--------------------	-------

4-Circuit, 2+2

6'	GAPTHINTY	\$399
----	------------------	-------

4-Circuit, 2+2 for New York

6'	GAPTHINNY	\$370
----	------------------	-------

4-Circuit, 2+2 for San Francisco

6'	GAPTHINTSFY	\$399
----	--------------------	-------

3-Circuit, Separate Neutrals

6'	GAPTHINTZ	\$399
----	------------------	-------

3-Circuit, Separate Neutrals for New York

6'	GAPTHINNYZ	\$370
----	-------------------	-------

3-Circuit, Separate Neutrals San Francisco

6'	GAPTHINTSFZ	\$399
----	--------------------	-------

► Specification Information, continued on next page

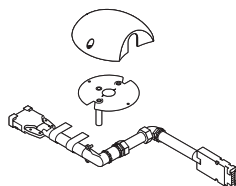
**For Canadian Pricing**

Multiply U.S. Price by the
Canadian price factor.

► See page 1 for details.

► Specification Information, continued from previous page

Specification Information

• Length	• Style Number	• U.S. Price
----------	----------------	--------------

For Answer and Montage Base Power-Ins at a Powerkit Receptacle Location

4-Circuit, 3+1

6'	GAPTHFBPX	\$399
----	------------------	-------

4-Circuit, 3+1 for New York

6'	GAPTHFBPNYX	\$370
----	--------------------	-------

4-Circuit, 3+1 for San Francisco

6'	GAPTHFBPSFX	\$399
----	--------------------	-------

4-Circuit, 2+2

6'	GAPTHFBPY	\$399
----	------------------	-------

4-Circuit, 2+2 for New York

6'	GAPTHFBPNYY	\$370
----	--------------------	-------

4-Circuit, 2+2 for San Francisco

6'	GAPTHFBPSFY	\$399
----	--------------------	-------

3-Circuit, Separate Neutrals

6'	GAPTHFBPZ	\$399
----	------------------	-------

3-Circuit, Separate Neutrals for New York

6'	GAPTHFBPNYZ	\$370
----	--------------------	-------

3-Circuit, Separate Neutrals for San Francisco

6'	GAPTHFBPSFZ	\$399
----	--------------------	-------

► Specification Information, continued on next page

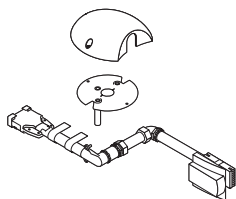
**For Canadian Pricing**

Multiply U.S. Price by the Canadian price factor.

► See page 1 for details.

► Specification Information, continued from previous page

Specification Information

Length	Style Number	U.S. Price
--------	--------------	------------

For Kick, Series 9000, and Avenir Base Power-Ins at a Powerkit Receptacle Location

4-Circuit, 3+1

6'	GAPTHBPBX	\$399
----	------------------	-------

4-Circuit, 3+1 for New York

6'	GAPTHBPNYX	\$370
----	-------------------	-------

4-Circuit, 3+1 for San Francisco

6'	GAPTHBPSFX	\$399
----	-------------------	-------

4-Circuit, 2+2

6'	GAPTHBPY	\$399
----	-----------------	-------

4-Circuit, 2+2 for New York

6'	GAPTHBPNY	\$370
----	------------------	-------

4-Circuit, 2+2 for San Francisco

6'	GAPTHBPSFY	\$399
----	-------------------	-------

3-Circuit, Separate Neutrals

6'	GAPTHBPZ	\$399
----	-----------------	-------

3-Circuit, Separate Neutrals for New York

6'	GAPTHBPNYZ	\$370
----	-------------------	-------

3-Circuit, Separate Neutrals for San Francisco

6'	GAPTHBPSFZ	\$399
----	-------------------	-------

:	:	:
---	---	---

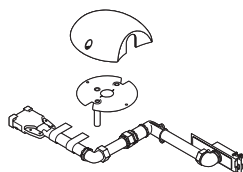

For Canadian Pricing

Multiply U.S. Price by the Canadian price factor.

► See page 1 for details.

Ceiling Power Transition Harnesses

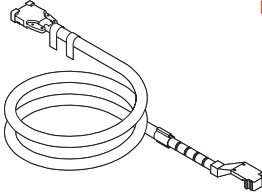

Tip: Modular power manufactured before May 2004 (round conduit) are not interchangeable after May 2004 (oval conduit). A power-out modular harness is available from Steelcase Service Parts to make a modular connection between the two versions.

Standard Includes		Required to Specify
► Need help? Product details, page 292	<ul style="list-style-type: none"> • Power transition harness • Male modular connector to Modular Power system • Modular connector to connect to compatible system 	Style number
Specification Information		
Length	Style Number	U.S. Price

For Kick, Series 9000, and Avenir Modular Connectors

4-Circuit, 3+1

12'	GAPTHPMP12X	\$329
24'	GAPTHPMP24X	\$449

4-Circuit, 2+2

12'	GAPTHPMP12Y	\$329
24'	GAPTHPMP24Y	\$449

3-Circuit, Separate Neutrals

12'	GAPTHPMP12Z	\$329
24'	GAPTHPMP24Z	\$449

Shallow Floor Access Boxes

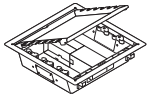

Tip: Access box requires a Low-Profile floor box access tile or a 10½" square cut-out in floor.

Tip: Remember to order receptacles for field installation.

► Page 310

Standard Includes		Required to Specify
► Need help? Product details, page 292	<ul style="list-style-type: none"> • Lid with frame and carpet insert space: black zinc • Low-profile floor access box: black zinc • Modular power block kit for two duplex receptacles • Furniture faceplate-size opening for communications faceplates • Furniture voice/data mounting adapter kit 	Style number

Specification Information

Dimensions	Style	U.S.
D W H	Number	Price

4-Circuit, 3+1

11½" 11½" 2½"	GAPFBSX	\$362

4-Circuit, 2+2

11½" 11½" 2½"	GAPFBSY	\$362

3-Circuit, Separate Neutrals

11½" 11½" 2½"	GAPFBSZ	\$362



For Canadian Pricing
Multiply U.S. Price by the Canadian price factor.
► See page 1 for details.

Floor Access Boxes

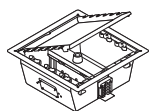

Tip: Access box requires a 10½" square cut-out in floor.

Tip: Remember to order receptacles for field installation.

► Page 310

Tip: Modular power manufactured before May 2004 (round conduit) are not interchangeable after May 2004 (oval conduit). A power-out modular harness is available from Steelcase Service Parts to make a modular connection between the two versions.

Standard Includes			Required to Specify	
<p>► Need help? Product details, page 293</p>			<p>Style number</p>	
<ul style="list-style-type: none">• Lid with frame and carpet insert space: black zinc• Standard floor access box: black zinc• Modular power block kit for four duplex receptacles• Two furniture faceplate-size openings adaptable to single gang size for communications faceplates• Furniture voice/data mounting adapter kit				

Specification Information				
• Dimensions			• Style	• U.S.
D	W	H	Number	Price

4-Circuit, 3+1				
11½"	11½"	4½"	GAPFBDX	\$421

4-Circuit, 2+2				
11½"	11½"	4½"	GAPFBDY	\$421

3-Circuit, Separate Neutrals				
11½"	11½"	4½"	GAPFBDZ	\$421

Shallow Floor Access Box for Hardwire Connection

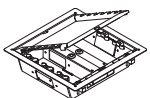

Tip: Decora-style receptacles must be supplied in the field.

Tip: Access box requires a Low-Profile floor box access tile or 10½" square cut-out in floor.

Standard Includes			Required to Specify	
<p>► Need help? Product details, page 292</p>			<p>Style number</p>	
<ul style="list-style-type: none">• Lid with frame and carpet insert space: black zinc• Low-profile floor access box: black zinc• Two duplex receptacle openings• Furniture faceplate-size opening for communications faceplates• Furniture voice/data mounting adapter kit				

Specification Information				
• Dimensions			• Style	• U.S.
D	W	H	Number	Price
11 1/2"	11 1/2"	2 1/2"	GAPFBSHW	\$199



For Canadian Pricing

Multiply U.S. Price by the Canadian price factor.

► See page 1 for details.

Floor Access Box for Hardwire Connection

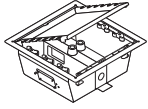

Tip: Decora-style receptacles must be supplied in the field.

Tip: Access box requires a 10½" square cut-out in floor.

Standard Includes			Required to Specify		
▶ Need help? Product details, page 293	<ul style="list-style-type: none">• Lid with frame and carpet insert space: black zinc• Standard floor access box: black zinc• Four duplex receptacle openings• Two furniture faceplate-size openings adaptable to single gang size for communications faceplates• Furniture voice/data mounting adapter kit			Style number	
	Specification Information				
	• Dimensions			• U.S.	
	D	W	H	Number	Price
	11½"	11½"	4½"	GAPFBDHW	\$234



For Canadian Pricing

Multiply U.S. Price by the Canadian price factor.

▶ See page 1 for details.

Receptacles for Use with Floor Access Boxes

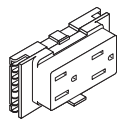

3/4"

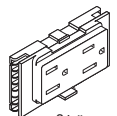

3/8"

Tip: All receptacle faces are 3/4" nominal height except 15-amp receptacles in the 3+1 and 2+2 wiring schematic.

Tip: Modular power manufactured before May 2004 (round conduit) are not interchangeable after May 2004 (oval conduit). A power-out modular harness is available from Steelcase Service Parts to make a modular connection between the two versions.

Standard Includes

► Need help?
Product details,
page 293

- Receptacle: black plastic

Required to Specify

Style number

Specification Information

15-Amp Receptacles

Line	Style Number	U.S. Price	Style Number	U.S. Price

4-Circuit, 3+1 Wiring Schematic

	System Ground		Isolated Ground	
Line 1	GAPR15L1SGX	\$25	GAPR15L1IGX	\$25
Line 2	GAPR15L2SGX	\$25	GAPR15L2IGX	\$25
Line 3	GAPR15L3SGX	\$25	GAPR15L3IGX	\$25
Line 4	GAPR15L4SGX	\$25	GAPR15L4IGX	\$25

4-Circuit, 2+2 Wiring Schematic

	System Ground		Isolated Ground	
Line 1	GAPR15L1SGY	\$25	GAPR15L1IGY	\$25
Line 2	GAPR15L2SGY	\$25	GAPR15L2IGY	\$25
Line 3	GAPR15L3SGY	\$25	GAPR15L3IGY	\$25
Line 4	GAPR15L4SGY	\$25	GAPR15L4IGY	\$25

3-Circuit, Separate Neutrals (3SN) Wiring Schematic

	System Ground		Isolated Ground	
Line 1	GAPR15L1SGZ	\$25	GAPR15L1IGZ	\$25
Line 2	GAPR15L2SGZ	\$25	GAPR15L2IGZ	\$25
Line 3	GAPR15L3SGZ	\$25	GAPR15L3IGZ	\$25

► Specification Information, continued on next page



For Canadian Pricing

Multiply U.S. Price by the Canadian price factor.

► See page 1 for details.

► Specification Information, continued from previous page

Specification Information

20-Amp Receptacles

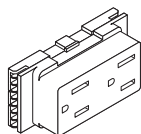

Line	Style Number	U.S. Price	Style Number	U.S. Price
------	--------------	------------	--------------	------------

4-Circuit, 3+1 Wiring Schematic

System Ground			Isolated Ground	
Line 1	GP1R1SGHX	\$49	GP1R1IGHX	\$49
Line 2	GP1R2SGHX	\$49	GP1R2IGHX	\$49
Line 3	GP1R3SGHX	\$49	GP1R3IGHX	\$49
Line 4	GP1R4SGHX	\$49	GP1R4IGHX	\$49
:	:	:	:	:

4-Circuit, 2+2 Wiring Schematic

System Ground			Isolated Ground	
Line 1	GP2R1SGHY	\$49	GP2R1IGHY	\$49
Line 2	GP2R2SGHY	\$49	GP2R2IGHY	\$49
Line 3	GP2R3SGHY	\$49	GP2R3IGHY	\$49
Line 4	GP2R4SGHY	\$49	GP2R4IGHY	\$49
:	:	:	:	:

3-Circuit, Separate Neutrals Wiring Schematic

System Ground			Isolated Ground	
Line 1	GP3R1SGHZ	\$49	GP3R1IGHZ	\$49
Line 2	GP3R2SGHZ	\$49	GP3R2IGHZ	\$49
Line 3	GP3R3SGHZ	\$49	GP3R3IGHZ	\$49
:	:	:	:	:

**For Canadian Pricing**

Multiply U.S. Price by the Canadian price factor.

► See page 1 for details.

