

powwow modular lounge

FREESTANDING COMPONENTS



PRODUCT SPECIFICATIONS

IN THE PAST, COLLABORATION WAS STRUCTURED, PLANNED, AND RESERVED FOR FORMAL SETTINGS. TODAY, COLLABORATION IS SPONTANEOUS, IMPROMPTU, AND REQUIRES A SOLUTION THAT SUPPORTS A NEW DYNAMIC. AS A WELCOMING, FREESTANDING, "ARENA-LIKE" SETTING, POWWOW FITS IN OPEN-PLAN SPACES TO DEFINE A SPACE ALL ITS OWN. WITH A DESIGN THAT'S LIGHT IN SCALE YET INCREDIBLY DURABLE, POWWOW INTEGRATES SEATING, TABLES, AND TECHNOLOGY TO CREATE RICH, SOCIAL EXPERIENCES. WHETHER IT'S A FLUID INTERACTION, SPONTANEOUS CONVERSATION, OR PLANNED GATHERING, POWWOW'S READY FOR IT ALL.

POWWOW'S SUPERIOR CONSTRUCTION INCLUDES CNC CUT FURNITURE GRADE PLYWOOD FRAMES ASSEMBLED WITH PUZZLE FIT JOINERY FOR SUPERIOR STRENGTH. TEXTILES ARE HAND-TAILORED OVER 100% POLYURETHANE FOAM THAT MEETS CAL 117 STANDARDS. TOP STITCH NEEDLE SEWING TECHNIQUE WITH COLOR MATCHED THREAD ADDS EXTRA STRENGTH TO SEAMS AND STYLISH FLAIR. TWO TONE TEXTILE APPLICATIONS AVAILABLE ON ALL UNITS.

DESIGNED BY JESS SOREL.

METAL PAINT COLORS

PC1 MILK GLOSS
PC2 CHARCOAL GLOSS
PC3 OATMEAL GLOSS
PC4 SILVER
PC5 CHROME
PC6 RAVEN

MODEL

DESCRIPTION

FABRIC LIST PRICE

COM CUE 2 3 4 5 6 7 8

50200

ARMLESS LOUNGE

875 925 1,020 1,085 1,145 1,215 1,275 1,340 1,465

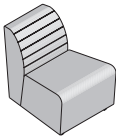

- BLACK PLASTIC FEET
- SUPPORTS 350 LBS.

50100

ARMLESS LOUNGE/MOBILE

900 950 1,045 1,110 1,170 1,240 1,300 1,365 1,490

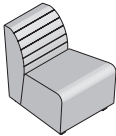

- FOUR BLACK NON-LOCKING CASTERS
- CASTERS FEATURE SEMI-SOFT TREADS FOR COMPATIBILITY ON ALL FLOOR SURFACES
- SUPPORTS 350 LBS.

50000

ARMLESS LOUNGE/SWIVEL BASE

1,375 1,425 1,520 1,585 1,645 1,715 1,775 1,840 1,965

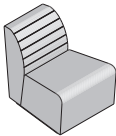

- LASER CUT METAL BASE WITH AUTO RETURN POSITION
- SUPPORTS 350 LBS.

POWWOW NOTES

1. SEATING MODELS FEATURE FIXED SEAT CUSHIONS.
2. WHEN SPECIFYING FABRIC IN DIFFERENT GRADES, THE HIGHEST PRICE GROUP PREVAILS.
3. THE COM YRDS. AND COL SQ. FT. LISTED REFLECT THE REQUIREMENTS FOR A SINGLE 54" FABRIC THAT IS NON-DIRECTIONAL AND APPLIED RAILROADED. FOR MULTI-FABRIC REQUIREMENTS PLEASE REFER TO THE POWWOW SECTION OF OUR WEBSITE FOR TWO-TONE UPHOLSTERY EXAMPLES, YARDAGE REQUIREMENTS AND PRICING.
4. VENEER INSET ARM PANELS, HANGOUT LEDGES, TABLES AND TABLETS ARE FLAT CUT WALNUT OR RIFF CUT WHITE OAK WOOD SPECIE AND FEATURE HORIZONTAL GRAIN DIRECTION. ALL EXPOSED RADIUS PLYWOOD EDGES WILL BE FINISHED TO MATCH SPECIFIED WOOD FINISH AS STANDARD. FOR CUSTOM WOOD FINISHES ADD \$300 ONE TIME CHARGE PER ORDER COLOR. VENEER HANGOUT LEDGES REQUIRE VENEER ON BOTH SIDES. THE EXPOSED RADIUS PLYWOOD EDGE WILL BE FINISHED TO MATCH SPECIFIED LEDGE WOOD FINISH AS STANDARD.
SPECIFY: (V2) FOR VENEER RIFT CUT OAK
(V3) FOR VENEER FLAT CUT WALNUT
5. LAMINATE HANGOUT LEDGES HAVE THE SAME LAMINATE ON BOTH SIDES. FOR DIFFERENT LAMINATES CONTACT CUSTOMER CARE FOR PRICING. WOOD GRAIN LAMINATES SPECIFIED WILL HAVE HORIZONTAL GRAIN PATTERN.
SPECIFY: (L) FOR STANDARD LAMINATE WITH MATCHING POLYMER EDGE
(L/EE) FOR LAMINATE WITH EXPOSED PLY EDGE FINISHED IN CLEAR COAT
6. LAMINATE TABLES AND TABLETS ARE STANDARD WITH MATCHING POLYMER EDGE. TABLES ARE ALSO AVAILABLE WITH EXPOSED RADIUS PLY EDGE. TABLETS MAY ALSO BE SPECIFIED WITH A REVERSE BEVEL EXPOSED EDGE.
SPECIFY: (L) FOR STANDARD LAMINATE WITH MATCHING POLYMER EDGE
(L/EE) FOR LAMINATE WITH EXPOSED PLY EDGE FINISHED IN CLEAR COAT
7. ARM INSET PANELS CANNOT BE RETROFIT TO PREVIOUSLY ORDERED UNITS.
8. HANGOUT LEDGE DIMENSIONS: OVERALL HEIGHT-42.5 INCHES, LEDGE HEIGHT-40 INCHES. LEDGES REQUIRE FIELD INSTALLATION.

LEATHER LIST PRICE

COL	C1	C2	C3	C4	C5	C6
	BASIC	FUNDAMENTAL	HAMPTON	VOLO	ANDES	VELLUTO PELLE

1,145	1,580	1,675	1,750	QUOTED UPON REQUEST
-------	-------	-------	-------	---------------------

1,170	1,605	1,700	1,775	QUOTED UPON REQUEST
-------	-------	-------	-------	---------------------

1,645	2,080	2,175	2,250	QUOTED UPON REQUEST
-------	-------	-------	-------	---------------------

DIMENSIONS

W	24
D	31
H	30
SW	24-20
SD	20
SH	17.5
BH	14

W	24
D	31
H	30
SW	24-20
SD	20
SH	17.5
BH	14

W	24
D	31
H	30
SW	24-20
SD	20
SH	17.5
BH	14

FIGURES

YARDAGE REQUIREMENTS SHOWN ARE BASED ON NON-DIRECTIONAL 54" TEXTILES. REFER TO PAGE 3 FOR HELP WITH TEXTILES WITH REPEATS OR SEND AN EMAIL TO: COM_HELP@EKOCONTRACT.COM

COM (YDS.)	3
COL (SQ. FT.)	54
WEIGHT (LBS.)	48
CUBIC FEET	13

COM (YDS.)	3
COL (SQ. FT.)	54
WEIGHT (LBS.)	48
CUBIC FEET	13

COM (YDS.)	3
COL (SQ. FT.)	54
WEIGHT (LBS.)	68
CUBIC FEET	13

powwow modular lounge

FREESTANDING COMPONENTS



PRODUCT SPECIFICATIONS

IN THE PAST, COLLABORATION WAS STRUCTURED, PLANNED, AND RESERVED FOR FORMAL SETTINGS. TODAY, COLLABORATION IS SPONTANEOUS, IMPROMPTU, AND REQUIRES A SOLUTION THAT SUPPORTS A NEW DYNAMIC. AS A WELCOMING, FREESTANDING, "ARENA-LIKE" SETTING, POWWOW FITS IN OPEN-PLAN SPACES TO DEFINE A SPACE ALL ITS OWN. WITH A DESIGN THAT'S LIGHT IN SCALE YET INCREDIBLY DURABLE, POWWOW INTEGRATES SEATING, TABLES, AND TECHNOLOGY TO CREATE RICH, SOCIAL EXPERIENCES. WHETHER IT'S A FLUID INTERACTION, SPONTANEOUS CONVERSATION, OR PLANNED GATHERING, POWWOW'S READY FOR IT ALL.

POWWOW'S SUPERIOR CONSTRUCTION INCLUDES CNC CUT FURNITURE GRADE PLYWOOD FRAMES ASSEMBLED WITH PUZZLE FIT JOINERY FOR SUPERIOR STRENGTH. TEXTILES ARE HAND-TAILORED OVER 100% POLYURETHANE FOAM THAT MEETS CAL 117 STANDARDS. TOP STITCH NEEDLE SEWING TECHNIQUE WITH COLOR MATCHED THREAD ADDS EXTRA STRENGTH TO SEAMS AND STYLISH FLAIR. TWO TONE TEXTILE APPLICATIONS AVAILABLE ON ALL UNITS.

DESIGNED BY JESS SOREL.

METAL PAINT COLORS

PC1	MILK GLOSS
PC2	CHARCOAL GLOSS
PC3	OATMEAL GLOSS
PC4	SILVER
PC5	CHROME
PC6	RAVEN

WOOD FINISHES

TC	TOP COAT ONLY
10	NATURAL
11	MONTECELLO
12	HUNTINGTON
13	WILD CHERRY
14	VERSAILLES
16	CAFELLE
53	LIGHT MAPLE
31	CINNAMON CHERRY
24	IMPERIAL CHERRY
15	EMPIRE MAHOGANY
46	ROYAL MAHOGANY
69	BOURBON MAHOGANY
64	APPALACHIAN MAHOGANY
42	LIGHT WALNUT
38	HERITAGE WALNUT
20	TRADITIONAL WALNUT
57	EBONY WALNUT
72	BLACK (LOW SHEEN)

LAMINATE FINISHES

SEE PAGE 5 FOR LAMINATE FINISHES

MODEL	DESCRIPTION	FABRIC LIST PRICE									
		COM	CUE	2	3	4	5	6	7	8	
50201	LOUNGE	1,205	1,325	1,510	1,625	1,740	1,855	1,970	2,085	2,320	

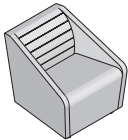

- BLACK PLASTIC FEET
- SUPPORTS 350 LBS.



ROUND PIVOT TABLE
150 LB. WEIGHT RATING
14 INCH DIAMETER
360° TURNING RADIUS

VENEER (ADD \$500 LIST)
RIGHT HANDED POSITION **PTV-R**
LEFT HANDED POSITION **PTV-L**

LAMINATE (ADD \$450 LIST)
RIGHT HANDED POSITION **PTL-R**
LEFT HANDED POSITION **PTL-L**

50101	LOUNGE/MOBILE	1,230	1,350	1,535	1,650	1,765	1,880	1,995	2,110	2,345	
--------------	---------------	-------	-------	-------	-------	-------	-------	-------	-------	-------	--

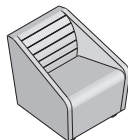

- FOUR BLACK NON-LOCKING CASTERS
- CASTERS FEATURE SEMI-SOFT TREADS FOR COMPATIBILITY ON ALL FLOOR SURFACES
- SUPPORTS 350 LBS.



ROUND PIVOT TABLE
150 LB. WEIGHT RATING
14 INCH DIAMETER
360° TURNING RADIUS

VENEER (ADD \$500 LIST)
RIGHT HANDED POSITION **PTV-R**
LEFT HANDED POSITION **PTV-L**

LAMINATE (ADD \$450 LIST)
RIGHT HANDED POSITION **PTL-R**
LEFT HANDED POSITION **PTL-L**

50001	LOUNGE/SWIVEL BASE	1,705	1,825	2,010	2,125	2,240	2,355	2,470	2,585	2,820	
--------------	--------------------	-------	-------	-------	-------	-------	-------	-------	-------	-------	--

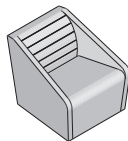

- LASER CUT METAL BASE WITH AUTO RETURN POSITION
- SUPPORTS 350 LBS.

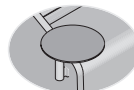

ROUND PIVOT TABLE
150 LB. WEIGHT RATING
14 INCH DIAMETER
360° TURNING RADIUS

VENEER (ADD \$500 LIST)
RIGHT HANDED POSITION **PTV-R**
LEFT HANDED POSITION **PTV-L**

LAMINATE (ADD \$450 LIST)
RIGHT HANDED POSITION **PTL-R**
LEFT HANDED POSITION **PTL-L**

POWWOW NOTES

1. SEATING MODELS FEATURE FIXED SEAT CUSHIONS.
2. WHEN SPECIFYING FABRIC IN DIFFERENT GRADES, THE HIGHEST PRICE GROUP PREVAILS.
3. THE COM YRDS. AND COL SQ. FT. LISTED REFLECT THE REQUIREMENTS FOR A SINGLE 54" FABRIC THAT IS NON-DIRECTIONAL AND APPLIED RAILROADED. FOR MULTI-FABRIC REQUIREMENTS PLEASE REFER TO THE POWWOW SECTION OF OUR WEBSITE FOR TWO-TONE UPHOLSTERY EXAMPLES, YARDAGE REQUIREMENTS AND PRICING.
4. VENEER INSET ARM PANELS, HANGOUT LEDGES, TABLES AND TABLETS ARE FLAT CUT WALNUT OR RIFF CUT WHITE OAK WOOD SPECIE AND FEATURE HORIZONTAL GRAIN DIRECTION. ALL EXPOSED RADIUS PLYWOOD EDGES WILL BE FINISHED TO MATCH SPECIFIED WOOD FINISH AS STANDARD. FOR CUSTOM WOOD FINISHES ADD \$300 ONE TIME CHARGE PER ORDER COLOR. VENEER HANGOUT LEDGES REQUIRE VENEER ON BOTH SIDES. THE EXPOSED RADIUS PLYWOOD EDGE WILL BE FINISHED TO MATCH SPECIFIED LEDGE WOOD FINISH AS STANDARD.
SPECIFY: (V2) FOR VENEER RIFT CUT OAK
(V3) FOR VENEER FLAT CUT WALNUT
5. LAMINATE HANGOUT LEDGES HAVE THE SAME LAMINATE ON BOTH SIDES. FOR DIFFERENT LAMINATES CONTACT CUSTOMER CARE FOR PRICING. WOOD GRAIN LAMINATES SPECIFIED WILL HAVE HORIZONTAL GRAIN PATTERN.
SPECIFY: (L) FOR STANDARD LAMINATE WITH MATCHING POLYMER EDGE
(L/EE) FOR LAMINATE WITH EXPOSED PLY EDGE FINISHED IN CLEAR COAT
6. LAMINATE TABLES AND TABLETS ARE STANDARD WITH MATCHING POLYMER EDGE. TABLES ARE ALSO AVAILABLE WITH EXPOSED RADIUS PLY EDGE. TABLETS MAY ALSO BE SPECIFIED WITH A REVERSE BEVEL EXPOSED EDGE.
SPECIFY: (L) FOR STANDARD LAMINATE WITH MATCHING POLYMER EDGE
(L/EE) FOR LAMINATE WITH EXPOSED PLY EDGE FINISHED IN CLEAR COAT
7. ARM INSET PANELS CANNOT BE RETROFIT TO PREVIOUSLY ORDERED UNITS.
8. HANGOUT LEDGE DIMENSIONS: OVERALL HEIGHT-42.5 INCHES, LEDGE HEIGHT-40 INCHES. LEDGES REQUIRE FIELD INSTALLATION.

LEATHER LIST PRICE

COL	C1	C2	C3	C4	C5	C5
	BASIC	FUNDAMENTAL	HAMPTON	VOLO	ANDES	VELLUTO PELLE
1,740	2,425	2,600	2,740	QUOTED UPON REQUEST		

DIMENSIONS

FIGURES

YARDAGE REQUIREMENTS SHOWN ARE BASED ON NON-DIRECTIONAL 54" TEXTILES. REFER TO PAGE 3 FOR HELP WITH TEXTILES WITH REPEATS OR SEND AN EMAIL TO: COM_HELP@EKOCONTRACT.COM

W	29	COM (YDS.)	5.5
D	31	COL (SQ. FT.)	99
H	30	WEIGHT (LBS.)	70
SW	24-20	CUBIC FEET	16
SD	20		
SH	17.5		
BH	14.5		
AH	1.5-10.5		

W	29	COM (YDS.)	5.5
D	31	COL (SQ. FT.)	99
H	30	WEIGHT (LBS.)	70
SW	24-20	CUBIC FEET	16
SD	20		
SH	17.5		
BH	14.5		
AH	1.5-10.5		

W	29	COM (YDS.)	5.5
D	31	COL (SQ. FT.)	99
H	30	WEIGHT (LBS.)	90
SW	24-20	CUBIC FEET	16
SD	20		
SH	17.5		
BH	14.5		
AH	1.5-10.5		

1,765	2,450	2,625	2,765	QUOTED UPON REQUEST		
-------	-------	-------	-------	---------------------	--	--

2,240	2,925	3,100	3,240	QUOTED UPON REQUEST		
-------	-------	-------	-------	---------------------	--	--

powwow modular lounge

FREESTANDING COMPONENTS



PRODUCT SPECIFICATIONS

IN THE PAST, COLLABORATION WAS STRUCTURED, PLANNED, AND RESERVED FOR FORMAL SETTINGS. TODAY, COLLABORATION IS SPONTANEOUS, IMPROMPTU, AND REQUIRES A SOLUTION THAT SUPPORTS A NEW DYNAMIC. AS A WELCOMING, FREESTANDING, "ARENA-LIKE" SETTING, POWWOW FITS IN OPEN-PLAN SPACES TO DEFINE A SPACE ALL ITS OWN. WITH A DESIGN THAT'S LIGHT IN SCALE YET INCREDIBLY DURABLE, POWWOW INTEGRATES SEATING, TABLES, AND TECHNOLOGY TO CREATE RICH, SOCIAL EXPERIENCES. WHETHER IT'S A FLUID INTERACTION, SPONTANEOUS CONVERSATION, OR PLANNED GATHERING, POWWOW'S READY FOR IT ALL.

POWWOW'S SUPERIOR CONSTRUCTION INCLUDES CNC CUT FURNITURE GRADE PLYWOOD FRAMES ASSEMBLED WITH PUZZLE FIT JOINERY FOR SUPERIOR STRENGTH. TEXTILES ARE HAND-TAILORED OVER 100% POLYURETHANE FOAM THAT MEETS CAL 117 STANDARDS. TOP STITCH NEEDLE SEWING TECHNIQUE WITH COLOR MATCHED THREAD ADDS EXTRA STRENGTH TO SEAMS AND STYLISH FLAIR. TWO TONE TEXTILE APPLICATIONS AVAILABLE ON ALL UNITS.

DESIGNED BY JESS SOREL.

METAL PAINT COLORS

PC1	MILK GLOSS
PC2	CHARCOAL GLOSS
PC3	OATMEAL GLOSS
PC4	SILVER
PC5	CHROME
PC6	RAVEN

WOOD FINISHES

TC	TOP COAT ONLY
10	NATURAL
11	MONTECELLO
12	HUNTINGTON
13	WILD CHERRY
14	VERSAILLES
16	CAFELLE
53	LIGHT MAPLE
31	CINNAMON CHERRY
24	IMPERIAL CHERRY
15	EMPIRE MAHOGANY
46	ROYAL MAHOGANY
69	BOURBON MAHOGANY
64	APPALACHIAN MAHOGANY
42	LIGHT WALNUT
38	HERITAGE WALNUT
20	TRADITIONAL WALNUT
57	EBONY WALNUT
72	BLACK (LOW SHEEN)

LAMINATE FINISHES

SEE PAGE 5 FOR LAMINATE FINISHES

MODEL	DESCRIPTION	FABRIC LIST PRICE								
		COM	CUE	2	3	4	5	6	7	8
S1201	LOUNGE/INSET ARM PANELS	1,805	1,925	2,110	2,225	2,340	2,455	2,570	2,685	2,920

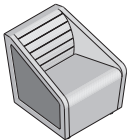

- WOOD OR LAMINATE INSET ARM PANELS
- BLACK PLASTIC FEET
- NOT AVAILABLE WITH TABLET
- SUPPORTS 350 LBS.

S1101	LOUNGE/MOBILE/INSET ARM PANELS	1,830	1,950	2,135	2,250	2,365	2,480	2,595	2,710	2,945
--------------	--------------------------------	-------	-------	-------	-------	-------	-------	-------	-------	-------

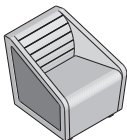

- WOOD OR LAMINATE INSET ARM PANELS
- FOUR BLACK NON-LOCKING CASTERS
- CASTERS FEATURE SEMI-SOFT TREADS FOR COMPATIBILITY ON ALL FLOOR SURFACES
- NOT AVAILABLE WITH TABLET
- SUPPORTS 350 LBS.

S1001	LOUNGE/SWIVEL/INSET ARM PANELS	2,305	2,425	2,610	2,725	2,840	2,955	3,070	3,185	3,420
--------------	--------------------------------	-------	-------	-------	-------	-------	-------	-------	-------	-------

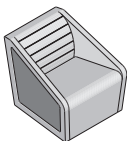

- WOOD OR LAMINATE INSET ARM PANELS
- LASER CUT METAL BASE WITH AUTO RETURN POSITION
- NOT AVAILABLE WITH TABLET
- SUPPORTS 350 LBS.

POWWOW NOTES

1. SEATING MODELS FEATURE FIXED SEAT CUSHIONS.
2. WHEN SPECIFYING FABRIC IN DIFFERENT GRADES, THE HIGHEST PRICE GROUP PREVAILS.
3. THE COM YRDS. AND COL SQ. FT. LISTED REFLECT THE REQUIREMENTS FOR A SINGLE 54" FABRIC THAT IS NON-DIRECTIONAL AND APPLIED RAILROADED. FOR MULTI-FABRIC REQUIREMENTS PLEASE REFER TO THE POWWOW SECTION OF OUR WEBSITE FOR TWO-TONE UPHOLSTERY EXAMPLES, YARDAGE REQUIREMENTS AND PRICING.
4. VENEER INSET ARM PANELS, HANGOUT LEDGES, TABLES AND TABLETS ARE FLAT CUT WALNUT OR RIFF CUT WHITE OAK WOOD SPECIE AND FEATURE HORIZONTAL GRAIN DIRECTION. ALL EXPOSED RADIUS PLYWOOD EDGES WILL BE FINISHED TO MATCH SPECIFIED WOOD FINISH AS STANDARD. FOR CUSTOM WOOD FINISHES ADD \$300 ONE TIME CHARGE PER ORDER COLOR. VENEER HANGOUT LEDGES REQUIRE VENEER ON BOTH SIDES. THE EXPOSED RADIUS PLYWOOD EDGE WILL BE FINISHED TO MATCH SPECIFIED LEDGE WOOD FINISH AS STANDARD.
SPECIFY: (V2) FOR VENEER RIFT CUT OAK
(V3) FOR VENEER FLAT CUT WALNUT
5. LAMINATE HANGOUT LEDGES HAVE THE SAME LAMINATE ON BOTH SIDES. FOR DIFFERENT LAMINATES CONTACT CUSTOMER CARE FOR PRICING. WOOD GRAIN LAMINATES SPECIFIED WILL HAVE HORIZONTAL GRAIN PATTERN.
SPECIFY: (L) FOR STANDARD LAMINATE WITH MATCHING POLYMER EDGE
(L/EE) FOR LAMINATE WITH EXPOSED PLY EDGE FINISHED IN CLEAR COAT
6. LAMINATE TABLES AND TABLETS ARE STANDARD WITH MATCHING POLYMER EDGE. TABLES ARE ALSO AVAILABLE WITH EXPOSED RADIUS PLY EDGE. TABLETS MAY ALSO BE SPECIFIED WITH A REVERSE BEVEL EXPOSED EDGE.
SPECIFY: (L) FOR STANDARD LAMINATE WITH MATCHING POLYMER EDGE
(L/EE) FOR LAMINATE WITH EXPOSED PLY EDGE FINISHED IN CLEAR COAT
7. ARM INSET PANELS CANNOT BE RETROFIT TO PREVIOUSLY ORDERED UNITS.
8. HANGOUT LEDGE DIMENSIONS: OVERALL HEIGHT-42.5 INCHES, LEDGE HEIGHT-40 INCHES. LEDGES REQUIRE FIELD INSTALLATION.

LEATHER LIST PRICE

COL	C1	C2	C3	C4	C5	C6
	BASIC	FUNDAMENTAL	HAMPTON	VOLO	ANDES	VELLUTO PELLE

2,340	3,025	3,200	3,340	QUOTED UPON REQUEST
-------	-------	-------	-------	---------------------

2,365	3,050	3,225	3,365	QUOTED UPON REQUEST
-------	-------	-------	-------	---------------------

2,840	3,525	3,700	3,840	QUOTED UPON REQUEST
-------	-------	-------	-------	---------------------

DIMENSIONS

W	29
D	31
H	30
SW	24-20
SD	20
SH	17.5
BH	14.5
AH	1.5-10.5

W	29
D	31
H	30
SW	24-20
SD	20
SH	17.5
BH	14.5
AH	1.5-10.5

W	29
D	31
H	30
SW	24-20
SD	20
SH	17.5
BH	14.5
AH	1.5-10.5

FIGURES

YARDAGE REQUIREMENTS SHOWN ARE BASED ON NON-DIRECTIONAL 54" TEXTILES. REFER TO PAGE 3 FOR HELP WITH TEXTILES WITH REPEATS OR SEND AN EMAIL TO: COM_HELP@EKOCONTRACT.COM

COM (YDS.)	5.5
COL (SQ. FT.)	99
WEIGHT (LBS.)	76
CUBIC FEET	16

COM (YDS.)	5.5
COL (SQ. FT.)	99
WEIGHT (LBS.)	76
CUBIC FEET	16

COM (YDS.)	5.5
COL (SQ. FT.)	99
WEIGHT (LBS.)	96
CUBIC FEET	16

powwow modular lounge

FREESTANDING COMPONENTS



PRODUCT SPECIFICATIONS

IN THE PAST, COLLABORATION WAS STRUCTURED, PLANNED, AND RESERVED FOR FORMAL SETTINGS. TODAY, COLLABORATION IS SPONTANEOUS, IMPROMPTU, AND REQUIRES A SOLUTION THAT SUPPORTS A NEW DYNAMIC. AS A WELCOMING, FREESTANDING, "ARENA-LIKE" SETTING, POWWOW FITS IN OPEN-PLAN SPACES TO DEFINE A SPACE ALL ITS OWN. WITH A DESIGN THAT'S LIGHT IN SCALE YET INCREDIBLY DURABLE, POWWOW INTEGRATES SEATING, TABLES, AND TECHNOLOGY TO CREATE RICH, SOCIAL EXPERIENCES. WHETHER IT'S A FLUID INTERACTION, SPONTANEOUS CONVERSATION, OR PLANNED GATHERING, POWWOW'S READY FOR IT ALL.

POWWOW'S SUPERIOR CONSTRUCTION INCLUDES CNC CUT FURNITURE GRADE PLYWOOD FRAMES ASSEMBLED WITH PUZZLE FIT JOINERY FOR SUPERIOR STRENGTH. TEXTILES ARE HAND-TAILORED OVER 100% POLYURETHANE FOAM THAT MEETS CAL 117 STANDARDS. TOP STITCH NEEDLE SEWING TECHNIQUE WITH COLOR MATCHED THREAD ADDS EXTRA STRENGTH TO SEAMS AND STYLISH FLAIR. TWO TONE TEXTILE APPLICATIONS AVAILABLE ON ALL UNITS.

DESIGNED BY JESS SOREL.

METAL PAINT COLORS

PC1	MILK GLOSS
PC2	CHARCOAL GLOSS
PC3	OATMEAL GLOSS
PC4	SILVER
PC5	CHROME
PC6	RAVEN

WOOD FINISHES

TC	TOP COAT ONLY
10	NATURAL
11	MONTECELLO
12	HUNTINGTON
13	WILD CHERRY
14	VERSAILLES
16	CAFELLE
53	LIGHT MAPLE
31	CINNAMON CHERRY
24	IMPERIAL CHERRY
15	EMPIRE MAHOGANY
46	ROYAL MAHOGANY
69	BOURBON MAHOGANY
64	APPALACHIAN MAHOGANY
42	LIGHT WALNUT
38	HERITAGE WALNUT
20	TRADITIONAL WALNUT
57	EBONY WALNUT
72	BLACK (LOW SHEEN)

LAMINATE FINISHES

SEE PAGE 5 FOR LAMINATE FINISHES

MODEL	DESCRIPTION	FABRIC LIST PRICE						LAMINATE FINISHES		
		COM	CUE	2	3	4	5	6	7	8
50002	LOVESEAT	2,140	2,300	2,525	2,675	2,810	2,950	3,095	3,240	3,520

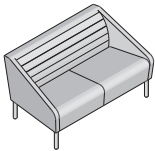

- METAL LEGS
- SUPPORTS 350 LBS PER SEAT



ROUND PIVOT TABLE
150 LB. WEIGHT RATING
14 INCH DIAMETER
360° TURNING RADIUS

VENEER (ADD \$500 LIST)
RIGHT HANDED POSITION **PTV-R**
LEFT HANDED POSITION **PTV-L**

LAMINATE (ADD \$450 LIST)
RIGHT HANDED POSITION **PTL-R**
LEFT HANDED POSITION **PTL-L**

51002	LOVESEAT/INSET ARM PANELS	2,740	2,900	3,125	3,275	3,410	3,550	3,695	3,840	4,120
--------------	----------------------------------	-------	-------	-------	-------	-------	-------	-------	-------	-------

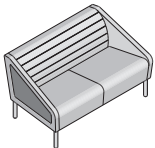

- WOOD OR LAMINATE INSET ARM PANELS
- METAL LEGS
- NOT AVAILABLE WITH TABLET
- SUPPORTS 350 LBS PER SEAT

50003	SOFA	2,985	3,175	3,475	3,690	3,875	4,050	4,260	4,450	4,815
--------------	-------------	-------	-------	-------	-------	-------	-------	-------	-------	-------

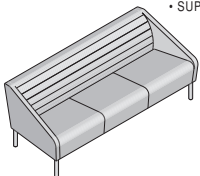

- METAL LEGS
- SUPPORTS 350 LBS PER SEAT



ROUND PIVOT TABLE
150 LB. WEIGHT RATING
14 INCH DIAMETER
360° TURNING RADIUS

VENEER (ADD \$500 LIST)
RIGHT HANDED POSITION **PTV-R**
LEFT HANDED POSITION **PTV-L**

LAMINATE (ADD \$450 LIST)
RIGHT HANDED POSITION **PTL-R**
LEFT HANDED POSITION **PTL-L**

51003	SOFA/INSET ARM PANELS	3,585	3,775	4,075	4,290	4,475	4,650	4,860	5,050	5,415
--------------	------------------------------	-------	-------	-------	-------	-------	-------	-------	-------	-------

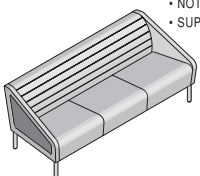

- WOOD OR LAMINATE INSET ARM PANELS
- METAL LEGS
- NOT AVAILABLE WITH TABLET
- SUPPORTS 350 LBS PER SEAT

POWWOW NOTES

1. SEATING MODELS FEATURE FIXED SEAT CUSHIONS.
2. WHEN SPECIFYING FABRIC IN DIFFERENT GRADES, THE HIGHEST PRICE GROUP PREVAILS.
3. THE COM YRDS. AND COL SQ. FT. LISTED REFLECT THE REQUIREMENTS FOR A SINGLE 54" FABRIC THAT IS NON-DIRECTIONAL AND APPLIED RAILROADED. FOR MULTI-FABRIC REQUIREMENTS PLEASE REFER TO THE POWWOW SECTION OF OUR WEBSITE FOR TWO-TONE UPHOLSTERY EXAMPLES, YARDAGE REQUIREMENTS AND PRICING.
4. VENEER INSET ARM PANELS, HANGOUT LEDGES, TABLES AND TABLETS ARE FLAT CUT WALNUT OR RIFF CUT WHITE OAK WOOD SPECIE AND FEATURE HORIZONTAL GRAIN DIRECTION. ALL EXPOSED RADIUS PLYWOOD EDGES WILL BE FINISHED TO MATCH SPECIFIED WOOD FINISH AS STANDARD. FOR CUSTOM WOOD FINISHES ADD \$300 ONE TIME CHARGE PER ORDER COLOR. VENEER HANGOUT LEDGES REQUIRE VENEER ON BOTH SIDES. THE EXPOSED RADIUS PLYWOOD EDGE WILL BE FINISHED TO MATCH SPECIFIED LEDGE WOOD FINISH AS STANDARD.
SPECIFY: (V2) FOR VENEER RIFT CUT OAK
(V3) FOR VENEER FLAT CUT WALNUT
5. LAMINATE HANGOUT LEDGES HAVE THE SAME LAMINATE ON BOTH SIDES. FOR DIFFERENT LAMINATES CONTACT CUSTOMER CARE FOR PRICING. WOOD GRAIN LAMINATES SPECIFIED WILL HAVE HORIZONTAL GRAIN PATTERN.
SPECIFY: (L) FOR STANDARD LAMINATE WITH MATCHING POLYMER EDGE
(L/EE) FOR LAMINATE WITH EXPOSED PLY EDGE FINISHED IN CLEAR COAT
6. LAMINATE TABLES AND TABLETS ARE STANDARD WITH MATCHING POLYMER EDGE. TABLES ARE ALSO AVAILABLE WITH EXPOSED RADIUS PLY EDGE. TABLETS MAY ALSO BE SPECIFIED WITH A REVERSE BEVEL EXPOSED EDGE.
SPECIFY: (L) FOR STANDARD LAMINATE WITH MATCHING POLYMER EDGE
(L/EE) FOR LAMINATE WITH EXPOSED PLY EDGE FINISHED IN CLEAR COAT
7. ARM INSET PANELS CANNOT BE RETROFIT TO PREVIOUSLY ORDERED UNITS.
8. HANGOUT LEDGE DIMENSIONS: OVERALL HEIGHT-42.5 INCHES, LEDGE HEIGHT-40 INCHES. LEDGES REQUIRE FIELD INSTALLATION.

LEATHER LIST PRICE

COL	C1	C2	C3	C4	C5	C6
	BASIC	FUNDAMENTAL	HAMPTON	VOLO	ANDES	VELLUTO PELLE

2,810	3,650	3,900	4,050	QUOTED UPON REQUEST
-------	-------	-------	-------	---------------------

3,410	4,250	4,500	4,650	QUOTED UPON REQUEST
-------	-------	-------	-------	---------------------

3,875	4,995	5,275	5,495	QUOTED UPON REQUEST
-------	-------	-------	-------	---------------------

4,475	5,595	5,875	6,095	QUOTED UPON REQUEST
-------	-------	-------	-------	---------------------

DIMENSIONS

FIGURES

YARDAGE REQUIREMENTS SHOWN ARE BASED ON NON-DIRECTIONAL 54" TEXTILES. REFER TO PAGE 3 FOR HELP WITH TEXTILES WITH REPEATS OR SEND AN EMAIL TO: COM_HELP@EKOCONTRACT.COM

W	55	COM (YDS.)	6.75
D	31	COL (SQ. FT.)	122
H	30	WEIGHT (LBS.)	85
SW	50-46.5	CUBIC FEET	30
SD	20		
SH	17.5		
BH	14.5		
AH	1.5-10.5		

W	55	COM (YDS.)	6.75
D	31	COL (SQ. FT.)	122
H	30	WEIGHT (LBS.)	90
SW	50-46.5	CUBIC FEET	30
SD	20		
SH	17.5		
BH	14.5		
AH	1.5-10.5		

W	79	COM (YDS.)	9
D	31	COL (SQ. FT.)	162
H	30	WEIGHT (LBS.)	110
SW	74-70.5	CUBIC FEET	43
SD	20		
SH	17.5		
BH	14.5		
AH	1.5-10.5		

W	79	COM (YDS.)	9
D	31	COL (SQ. FT.)	162
H	30	WEIGHT (LBS.)	115
SW	74-70.5	CUBIC FEET	43
SD	20		
SH	17.5		
BH	14.5		
AH	1.5-10.5		

powwow modular lounge

MODULAR STRAIGHT COMPONENTS



PRODUCT SPECIFICATIONS

IN THE PAST, COLLABORATION WAS STRUCTURED, PLANNED, AND RESERVED FOR FORMAL SETTINGS. TODAY, COLLABORATION IS SPONTANEOUS, IMPROMPTU, AND REQUIRES A SOLUTION THAT SUPPORTS A NEW DYNAMIC. AS A WELCOMING, FREESTANDING, "ARENA-LIKE" SETTING, POWWOW FITS IN OPEN-PLAN SPACES TO DEFINE A SPACE ALL ITS OWN. WITH A DESIGN THAT'S LIGHT IN SCALE YET INCREDIBLY DURABLE, POWWOW INTEGRATES SEATING, TABLES, AND TECHNOLOGY TO CREATE RICH, SOCIAL EXPERIENCES. WHETHER IT'S A FLUID INTERACTION, SPONTANEOUS CONVERSATION, OR PLANNED GATHERING, POWWOW'S READY FOR IT ALL.

POWWOW'S SUPERIOR CONSTRUCTION INCLUDES CNC CUT FURNITURE GRADE PLYWOOD FRAMES ASSEMBLED WITH PUZZLE FIT JOINERY FOR SUPERIOR STRENGTH. TEXTILES ARE HAND-TAILORED OVER 100% POLYURETHANE FOAM THAT MEETS CAL 117 STANDARDS. TOP STITCH NEEDLE SEWING TECHNIQUE WITH COLOR MATCHED THREAD ADDS EXTRA STRENGTH TO SEAMS AND STYLISH FLAIR. TWO TONE TEXTILE APPLICATIONS AVAILABLE ON ALL UNITS.

DESIGNED BY JESS SOREL.

METAL PAINT COLORS

PC1	MILK GLOSS
PC2	CHARCOAL GLOSS
PC3	OATMEAL GLOSS
PC4	SILVER
PC5	CHROME
PC6	RAVEN

WOOD FINISHES

TC	TOP COAT ONLY
10	NATURAL
11	MONTECELLO
12	HUNTINGTON
13	WILD CHERRY
14	VERSAILLES
16	CAFELLE
53	LIGHT MAPLE
31	CINNAMON CHERRY
24	IMPERIAL CHERRY
15	EMPIRE MAHOGANY
46	ROYAL MAHOGANY
69	BOURBON MAHOGANY
64	APPALACHIAN MAHOGANY
42	LIGHT WALNUT
38	HERITAGE WALNUT
20	TRADITIONAL WALNUT
57	EBONY WALNUT
72	BLACK (LOW SHEEN)

LAMINATE FINISHES

SEE PAGE 5 FOR LAMINATE FINISHES

MODEL	DESCRIPTION	FABRIC LIST PRICE								
		COM	CUE	2	3	4	5	6	7	8

50022

ARMLESS LOVESEAT

1,780

1,900

2,070

2,175

2,300

2,400

2,510

2,625

2,825

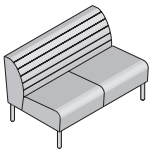

- METAL LEGS
- SUPPORTS 350 LBS PER SEAT

50012R

RIGHT ARM LOVESEAT

1,950

2,075

2,275

2,400

2,515

2,625

2,750

2,875

3,115

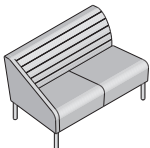

- METAL LEGS
- SUPPORTS 350 LBS PER SEAT



ROUND PIVOT TABLET
150 LB. WEIGHT RATING
14 INCH DIAMETER
360° TURNING RADIUS

veneer (ADD \$500 LIST)
RIGHT HANDED POSITION **PTV-R**

LAMINATE (ADD \$450 LIST)
RIGHT HANDED POSITION **PTL-R**

51012L

LEFT ARM LOVESEAT

1,950

2,075

2,275

2,400

2,515

2,625

2,750

2,875

3,115

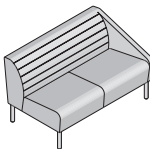

- METAL LEGS
- SUPPORTS 350 LBS PER SEAT



ROUND PIVOT TABLET
150 LB. WEIGHT RATING
14 INCH DIAMETER
360° TURNING RADIUS

veneer (ADD \$500 LIST)
LEFT HANDED POSITION **PTV-L**

LAMINATE (ADD \$450 LIST)
LEFT HANDED POSITION **PTL-L**

51012R

RIGHT ARM LOVESEAT/INSET ARM PANELS

2,250

2,375

2,575

2,700

2,815

2,925

3,050

3,175

3,415

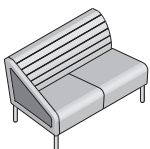

- WOOD OR LAMINATE INSET ARM PANELS
- METAL LEGS
- NOT AVAILABLE WITH TABLET
- SUPPORTS 350 LBS PER SEAT

ADDITIONAL PRODUCT ORDERING OPTIONS

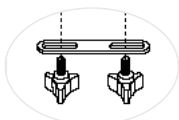
**GC GANGING CONNECTOR** (ADD \$50 LIST PER SET)

OPTIONAL GANGING BRACKET SET INCLUDES TWO BRACKETS AND FOUR 5/8" X 1" THREADED BLACK LOBE KNOBS FOR CONNECTING TWO UNITS TOGETHER. FIELD ASSEMBLY REQUIRED. CANNOT BE RETROFIT TO PREVIOUSLY ORDERED UNITS.

POWWOW NOTES

1. SEATING MODELS FEATURE FIXED SEAT CUSHIONS.
2. WHEN SPECIFYING FABRIC IN DIFFERENT GRADES, THE HIGHEST PRICE GROUP PREVAILS.
3. THE COM YRDS. AND COL SQ. FT. LISTED REFLECT THE REQUIREMENTS FOR A SINGLE 54" FABRIC THAT IS NON-DIRECTIONAL AND APPLIED RAILROADED. FOR MULTI-FABRIC REQUIREMENTS PLEASE REFER TO THE POWWOW SECTION OF OUR WEBSITE FOR TWO-TONE UPHOLSTERY EXAMPLES, YARDAGE REQUIREMENTS AND PRICING.
4. VENEER INSET ARM PANELS, HANGOUT LEDGES, TABLES AND TABLETS ARE FLAT CUT WALNUT OR RIFF CUT WHITE OAK WOOD SPECIE AND FEATURE HORIZONTAL GRAIN DIRECTION. ALL EXPOSED RADIUS PLYWOOD EDGES WILL BE FINISHED TO MATCH SPECIFIED WOOD FINISH AS STANDARD. FOR CUSTOM WOOD FINISHES ADD \$300 ONE TIME CHARGE PER ORDER COLOR. VENEER HANGOUT LEDGES REQUIRE VENEER ON BOTH SIDES. THE EXPOSED RADIUS PLYWOOD EDGE WILL BE FINISHED TO MATCH SPECIFIED LEDGE WOOD FINISH AS STANDARD.
SPECIFY: (V2) FOR VENEER RIFT CUT OAK
(V3) FOR VENEER FLAT CUT WALNUT
5. LAMINATE HANGOUT LEDGES HAVE THE SAME LAMINATE ON BOTH SIDES. FOR DIFFERENT LAMINATES CONTACT CUSTOMER CARE FOR PRICING. WOOD GRAIN LAMINATES SPECIFIED WILL HAVE HORIZONTAL GRAIN PATTERN.
SPECIFY: (L) FOR STANDARD LAMINATE WITH MATCHING POLYMER EDGE
(L/EE) FOR LAMINATE WITH EXPOSED PLY EDGE FINISHED IN CLEAR COAT
6. LAMINATE TABLES AND TABLETS ARE STANDARD WITH MATCHING POLYMER EDGE. TABLES ARE ALSO AVAILABLE WITH EXPOSED RADIUS PLY EDGE. TABLETS MAY ALSO BE SPECIFIED WITH A REVERSE BEVEL EXPOSED EDGE.
SPECIFY: (L) FOR STANDARD LAMINATE WITH MATCHING POLYMER EDGE
(L/EE) FOR LAMINATE WITH EXPOSED PLY EDGE FINISHED IN CLEAR COAT
7. ARM INSET PANELS CANNOT BE RETROFIT TO PREVIOUSLY ORDERED UNITS.
8. HANGOUT LEDGE DIMENSIONS: OVERALL HEIGHT-42.5 INCHES, LEDGE HEIGHT-40 INCHES. LEDGES REQUIRE FIELD INSTALLATION.

LEATHER LIST PRICE

COL	C1	C2	C3	C4	C5	C6
	BASIC	FUNDAMENTAL	HAMPTON	VOLO	ANDES	VELLUTO PELLE

2,300 2,950 3,125 3,250 QUOTED UPON REQUEST

2,515 3,225 3,425 3,575 QUOTED UPON REQUEST

2,515 3,225 3,425 3,575 QUOTED UPON REQUEST

2,815 3,525 3,725 3,875 QUOTED UPON REQUEST

DIMENSIONS

FIGURES

YARDAGE REQUIREMENTS SHOWN ARE BASED ON NON-DIRECTIONAL 54" TEXTILES. REFER TO PAGE 3 FOR HELP WITH TEXTILES WITH REPEATS OR SEND AN EMAIL TO: COM_HELP@EKOCONTRACT.COM

W	48	COM (YDS.)	5.25
D	31	COL (SQ. FT.)	95
H	30	WEIGHT (LBS.)	90
SW	48	CUBIC FEET	26
SD	20		
SH	17.5		
BH	14.5		

W	51.5	COM (YDS.)	5.75
D	31	COL (SQ. FT.)	104
H	30	WEIGHT (LBS.)	95
SW	49-47.25	CUBIC FEET	28
SD	20		
SH	17.5		
BH	14.5		
AH	1.5-10.5		

W	51.5	COM (YDS.)	5.75
D	31	COL (SQ. FT.)	104
H	30	WEIGHT (LBS.)	95
SW	49-47.25	CUBIC FEET	28
SD	20		
SH	17.5		
BH	14.5		
AH	1.5-10.5		

W	51.5	COM (YDS.)	5.75
D	31	COL (SQ. FT.)	104
H	30	WEIGHT (LBS.)	98
SW	49-47.25	CUBIC FEET	28
SD	20		
SH	17.5		
BH	14.5		
AH	1.5-10.5		

powwow modular lounge

MODULAR STRAIGHT COMPONENTS



PRODUCT SPECIFICATIONS

IN THE PAST, COLLABORATION WAS STRUCTURED, PLANNED, AND RESERVED FOR FORMAL SETTINGS. TODAY, COLLABORATION IS SPONTANEOUS, IMPROMPTU, AND REQUIRES A SOLUTION THAT SUPPORTS A NEW DYNAMIC. AS A WELCOMING, FREESTANDING, "ARENA-LIKE" SETTING, POWWOW FITS IN OPEN-PLAN SPACES TO DEFINE A SPACE ALL ITS OWN. WITH A DESIGN THAT'S LIGHT IN SCALE YET INCREDIBLY DURABLE, POWWOW INTEGRATES SEATING, TABLES, AND TECHNOLOGY TO CREATE RICH, SOCIAL EXPERIENCES. WHETHER IT'S A FLUID INTERACTION, SPONTANEOUS CONVERSATION, OR PLANNED GATHERING, POWWOW'S READY FOR IT ALL.

POWWOW'S SUPERIOR CONSTRUCTION INCLUDES CNC CUT FURNITURE GRADE PLYWOOD FRAMES ASSEMBLED WITH PUZZLE FIT JOINERY FOR SUPERIOR STRENGTH. TEXTILES ARE HAND-TAILORED OVER 100% POLYURETHANE FOAM THAT MEETS CAL 117 STANDARDS. TOP STITCH NEEDLE SEWING TECHNIQUE WITH COLOR MATCHED THREAD ADDS EXTRA STRENGTH TO SEAMS AND STYLISH FLAIR. TWO TONE TEXTILE APPLICATIONS AVAILABLE ON ALL UNITS.

DESIGNED BY JESS SOREL.

METAL PAINT COLORS

PC1	MILK GLOSS
PC2	CHARCOAL GLOSS
PC3	OATMEAL GLOSS
PC4	SILVER
PC5	CHROME
PC6	RAVEN

WOOD FINISHES

TC	TOP COAT ONLY
10	NATURAL
11	MONTECELLO
12	HUNTINGTON
13	WILD CHERRY
14	VERSAILLES
16	CAFELLE
53	LIGHT MAPLE
31	CINNAMON CHERRY
24	IMPERIAL CHERRY
15	EMPIRE MAHOGANY
46	ROYAL MAHOGANY
69	BOURBON MAHOGANY
64	APPALACHIAN MAHOGANY
42	LIGHT WALNUT
38	HERITAGE WALNUT
20	TRADITIONAL WALNUT
57	EBONY WALNUT
72	BLACK (LOW SHEEN)

LAMINATE FINISHES

SEE PAGE 5 FOR LAMINATE FINISHES

MODEL	DESCRIPTION	FABRIC LIST PRICE					LAMINATE FINISHES			
		COM	CUE	2	3	4	5	6	7	8

51012L

LEFT ARM LOVESEAT/INSET ARM PANELS

2,250 2,375 2,575 2,700 2,815 2,925 3,050 3,175 3,415

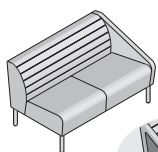

- WOOD OR LAMINATE INSET ARM PANELS
- METAL LEGS
- NOT AVAILABLE WITH TABLET
- SUPPORTS 350 LBS PER SEAT



50023

ARMLESS SOFA

2,725 2,925 3,175 3,350 3,500 3,675 3,825 3,995 4,325

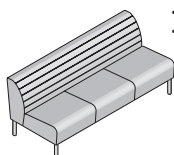

- METAL LEGS
- SUPPORTS 350 LBS PER SEAT

50013R

RIGHT ARM SOFA

2,825 3,025 3,325 3,500 3,675 3,850 4,025 4,225 4,575

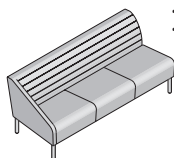

- METAL LEGS
- SUPPORTS 350 LBS PER SEAT



ROUND PIVOT TABLET
150 LB. WEIGHT RATING
14 INCH DIAMETER
360° TURNING RADIUS

VENEER (ADD \$500 LIST)
RIGHT HANDED POSITION **PTV-R**

LAMINATE (ADD \$450 LIST)
RIGHT HANDED POSITION **PTL-R**

50013L

LEFT ARM SOFA

2,825 3,025 3,325 3,500 3,675 3,850 4,025 4,225 4,575

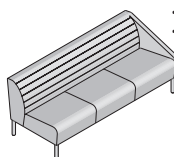

- METAL LEGS
- SUPPORTS 350 LBS PER SEAT



ROUND PIVOT TABLET
150 LB. WEIGHT RATING
14 INCH DIAMETER
360° TURNING RADIUS

VENEER (ADD \$500 LIST)
LEFT HANDED POSITION **PTV-L**

LAMINATE (ADD \$450 LIST)
LEFT HANDED POSITION **PTL-L**

ADDITIONAL PRODUCT ORDERING OPTIONS

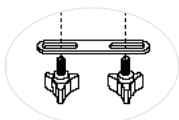
**GC GANGING CONNECTOR** (ADD \$50 LIST PER SET)

OPTIONAL GANGING BRACKET SET INCLUDES TWO BRACKETS AND FOUR 5/8" X 1" THREADED BLACK LOBE KNOBS FOR CONNECTING TWO UNITS TOGETHER. FIELD ASSEMBLY REQUIRED. CANNOT BE RETROFIT TO PREVIOUSLY ORDERED UNITS.

POWWOW NOTES

1. SEATING MODELS FEATURE FIXED SEAT CUSHIONS.
2. WHEN SPECIFYING FABRIC IN DIFFERENT GRADES, THE HIGHEST PRICE GROUP PREVAILS.
3. THE COM YRDS. AND COL SQ. FT. LISTED REFLECT THE REQUIREMENTS FOR A SINGLE 54" FABRIC THAT IS NON-DIRECTIONAL AND APPLIED RAILROADED. FOR MULTI-FABRIC REQUIREMENTS PLEASE REFER TO THE POWWOW SECTION OF OUR WEBSITE FOR TWO-TONE UPHOLSTERY EXAMPLES, YARDAGE REQUIREMENTS AND PRICING.
4. VENEER INSET ARM PANELS, HANGOUT LEDGES, TABLES AND TABLETS ARE FLAT CUT WALNUT OR RIFF CUT WHITE OAK WOOD SPECIE AND FEATURE HORIZONTAL GRAIN DIRECTION. ALL EXPOSED RADIUS PLYWOOD EDGES WILL BE FINISHED TO MATCH SPECIFIED WOOD FINISH AS STANDARD. FOR CUSTOM WOOD FINISHES ADD \$300 ONE TIME CHARGE PER ORDER COLOR. VENEER HANGOUT LEDGES REQUIRE VENEER ON BOTH SIDES. THE EXPOSED RADIUS PLYWOOD EDGE WILL BE FINISHED TO MATCH SPECIFIED LEDGE WOOD FINISH AS STANDARD.
SPECIFY: (V2) FOR VENEER RIFT CUT OAK
(V3) FOR VENEER FLAT CUT WALNUT
5. LAMINATE HANGOUT LEDGES HAVE THE SAME LAMINATE ON BOTH SIDES. FOR DIFFERENT LAMINATES CONTACT CUSTOMER CARE FOR PRICING. WOOD GRAIN LAMINATES SPECIFIED WILL HAVE HORIZONTAL GRAIN PATTERN.
SPECIFY: (L) FOR STANDARD LAMINATE WITH MATCHING POLYMER EDGE
(L/EE) FOR LAMINATE WITH EXPOSED PLY EDGE FINISHED IN CLEAR COAT
6. LAMINATE TABLES AND TABLETS ARE STANDARD WITH MATCHING POLYMER EDGE. TABLES ARE ALSO AVAILABLE WITH EXPOSED RADIUS PLY EDGE. TABLETS MAY ALSO BE SPECIFIED WITH A REVERSE BEVEL EXPOSED EDGE.
SPECIFY: (L) FOR STANDARD LAMINATE WITH MATCHING POLYMER EDGE
(L/EE) FOR LAMINATE WITH EXPOSED PLY EDGE FINISHED IN CLEAR COAT
7. ARM INSET PANELS CANNOT BE RETROFIT TO PREVIOUSLY ORDERED UNITS.
8. HANGOUT LEDGE DIMENSIONS: OVERALL HEIGHT-42.5 INCHES, LEDGE HEIGHT-40 INCHES. LEDGES REQUIRE FIELD INSTALLATION.

LEATHER LIST PRICE

COL	C1	C2	C3	C4	C5	C6
	BASIC	FUNDAMENTAL	HAMPTON	VOLO	ANDES	VELLUTO PELLE

2,815 3,525 3,725 3,875 QUOTED UPON REQUEST

3,500 4,475 4,750 4,925 QUOTED UPON REQUEST

3,675 4,725 5,025 5,225 QUOTED UPON REQUEST

3,675 4,725 5,025 5,225 QUOTED UPON REQUEST

DIMENSIONS

FIGURES

YARDAGE REQUIREMENTS SHOWN ARE BASED ON NON-DIRECTIONAL 54" TEXTILES. REFER TO PAGE 3 FOR HELP WITH TEXTILES WITH REPEATS OR SEND AN EMAIL TO: COM_HELP@EKOCONTRACT.COM

W	51.5	COM (YDS.)	5.75
D	31	COL (SQ. FT.)	104
H	30	WEIGHT (LBS.)	98
SW	49-47.25	CUBIC FEET	28
SD	20		
SH	17.5		
BH	14.5		
AH	1.5-10.5		

W	72	COM (YDS.)	7.75
D	31	COL (SQ. FT.)	140
H	30	WEIGHT (LBS.)	110
SW	72	CUBIC FEET	39
SD	20		
SH	17.5		
BH	14.5		

W	75.5	COM (YDS.)	8.5
D	31	COL (SQ. FT.)	153
H	30	WEIGHT (LBS.)	115
SW	73-71.25	CUBIC FEET	41
SD	20		
SH	17.5		
BH	14.5		
AH	1.5-10.5		

W	75.5	COM (YDS.)	8.5
D	31	COL (SQ. FT.)	153
H	30	WEIGHT (LBS.)	115
SW	73-71.25	CUBIC FEET	41
SD	20		
SH	17.5		
BH	14.5		
AH	1.5-10.5		

powwow modular lounge

MODULAR STRAIGHT COMPONENTS



PRODUCT SPECIFICATIONS

IN THE PAST, COLLABORATION WAS STRUCTURED, PLANNED, AND RESERVED FOR FORMAL SETTINGS. TODAY, COLLABORATION IS SPONTANEOUS, IMPROMPTU, AND REQUIRES A SOLUTION THAT SUPPORTS A NEW DYNAMIC. AS A WELCOMING, FREESTANDING, "ARENA-LIKE" SETTING, POWWOW FITS IN OPEN-PLAN SPACES TO DEFINE A SPACE ALL ITS OWN. WITH A DESIGN THAT'S LIGHT IN SCALE YET INCREDIBLY DURABLE, POWWOW INTEGRATES SEATING, TABLES, AND TECHNOLOGY TO CREATE RICH, SOCIAL EXPERIENCES. WHETHER IT'S A FLUID INTERACTION, SPONTANEOUS CONVERSATION, OR PLANNED GATHERING, POWWOW'S READY FOR IT ALL.

POWWOW'S SUPERIOR CONSTRUCTION INCLUDES CNC CUT FURNITURE GRADE PLYWOOD FRAMES ASSEMBLED WITH PUZZLE FIT JOINERY FOR SUPERIOR STRENGTH. TEXTILES ARE HAND-TAILORED OVER 100% POLYURETHANE FOAM THAT MEETS CAL 117 STANDARDS. TOP STITCH NEEDLE SEWING TECHNIQUE WITH COLOR MATCHED THREAD ADDS EXTRA STRENGTH TO SEAMS AND STYLISH FLAIR. TWO TONE TEXTILE APPLICATIONS AVAILABLE ON ALL UNITS.

DESIGNED BY JESS SOREL.

METAL PAINT COLORS

PC1	MILK GLOSS
PC2	CHARCOAL GLOSS
PC3	OATMEAL GLOSS
PC4	SILVER
PC5	CHROME
PC6	RAVEN

WOOD FINISHES

TC	TOP COAT ONLY
10	NATURAL
11	MONTICELLO
12	HUNTINGTON
13	WILD CHERRY
14	VERSAILLES
16	CAFELLE
53	LIGHT MAPLE
31	CINNAMON CHERRY
24	IMPERIAL CHERRY
15	EMPIRE MAHOGANY
46	ROYAL MAHOGANY
69	BOURBON MAHOGANY
64	APPALACHIAN MAHOGANY
42	LIGHT WALNUT
38	HERITAGE WALNUT
20	TRADITIONAL WALNUT
57	EBONY WALNUT
72	BLACK (LOW SHEEN)

LAMINATE FINISHES

SEE PAGE 5 FOR LAMINATE FINISHES

MODEL	DESCRIPTION	FABRIC LIST PRICE						LAMINATE FINISHES		
		COM	CUE	2	3	4	5	6	7	8
S1013R	RIGHT ARM SOFA/INSET ARM PANELS	3,125	3,325	3,625	3,800	3,975	4,150	4,325	4,525	4,875

- WOOD OR LAMINATE INSET ARM PANELS
- METAL LEGS
- NOT AVAILABLE WITH TABLET
- SUPPORTS 350 LBS PER SEAT

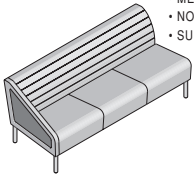

S1013L	LEFT ARM SOFA/INSET ARM PANELS	3,125	3,325	3,625	3,800	3,975	4,150	4,325	4,525	4,875
---------------	---------------------------------------	-------	-------	-------	-------	-------	-------	-------	-------	-------

- WOOD OR LAMINATE INSET ARM PANELS
- METAL LEGS
- NOT AVAILABLE WITH TABLET
- SUPPORTS 350 LBS PER SEAT

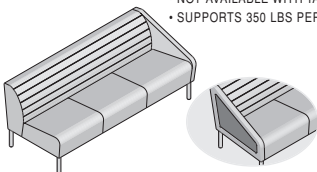

ADDITIONAL PRODUCT ORDERING OPTIONS

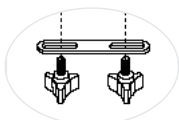

GC GANGING CONNECTOR (ADD \$50 LIST PER SET)
 OPTIONAL GANGING BRACKET SET INCLUDES TWO BRACKETS AND FOUR 5/8" X 1" THREADED BLACK LOBE KNOBS FOR CONNECTING TWO UNITS TOGETHER. FIELD ASSEMBLY REQUIRED. CANNOT BE RETROFIT TO PREVIOUSLY ORDERED UNITS.

POWWOW NOTES

1. SEATING MODELS FEATURE FIXED SEAT CUSHIONS.
2. WHEN SPECIFYING FABRIC IN DIFFERENT GRADES, THE HIGHEST PRICE GROUP PREVAILS.
3. THE COM YRDS. AND COL SQ. FT. LISTED REFLECT THE REQUIREMENTS FOR A SINGLE 54" FABRIC THAT IS NON-DIRECTIONAL AND APPLIED RAILROADED. FOR MULTI-FABRIC REQUIREMENTS PLEASE REFER TO THE POWWOW SECTION OF OUR WEBSITE FOR TWO-TONE UPHOLSTERY EXAMPLES, YARDAGE REQUIREMENTS AND PRICING.
4. VENEER INSET ARM PANELS, HANGOUT LEDGES, TABLES AND TABLETS ARE FLAT CUT WALNUT OR RIFF CUT WHITE OAK WOOD SPECIE AND FEATURE HORIZONTAL GRAIN DIRECTION. ALL EXPOSED RADIUS PLYWOOD EDGES WILL BE FINISHED TO MATCH SPECIFIED WOOD FINISH AS STANDARD. FOR CUSTOM WOOD FINISHES ADD \$300 ONE TIME CHARGE PER ORDER COLOR. VENEER HANGOUT LEDGES REQUIRE VENEER ON BOTH SIDES. THE EXPOSED RADIUS PLYWOOD EDGE WILL BE FINISHED TO MATCH SPECIFIED LEDGE WOOD FINISH AS STANDARD.
SPECIFY: (V2) FOR VENEER RIFT CUT OAK
(V3) FOR VENEER FLAT CUT WALNUT
5. LAMINATE HANGOUT LEDGES HAVE THE SAME LAMINATE ON BOTH SIDES. FOR DIFFERENT LAMINATES CONTACT CUSTOMER CARE FOR PRICING. WOOD GRAIN LAMINATES SPECIFIED WILL HAVE HORIZONTAL GRAIN PATTERN.
SPECIFY: (L) FOR STANDARD LAMINATE WITH MATCHING POLYMER EDGE
(L/EE) FOR LAMINATE WITH EXPOSED PLY EDGE FINISHED IN CLEAR COAT
6. LAMINATE TABLES AND TABLETS ARE STANDARD WITH MATCHING POLYMER EDGE. TABLES ARE ALSO AVAILABLE WITH EXPOSED RADIUS PLY EDGE. TABLETS MAY ALSO BE SPECIFIED WITH A REVERSE BEVEL EXPOSED EDGE.
SPECIFY: (L) FOR STANDARD LAMINATE WITH MATCHING POLYMER EDGE
(L/EE) FOR LAMINATE WITH EXPOSED PLY EDGE FINISHED IN CLEAR COAT
7. ARM INSET PANELS CANNOT BE RETROFIT TO PREVIOUSLY ORDERED UNITS.
8. HANGOUT LEDGE DIMENSIONS: OVERALL HEIGHT-42.5 INCHES, LEDGE HEIGHT-40 INCHES. LEDGES REQUIRE FIELD INSTALLATION.

LEATHER LIST PRICE

COL	C1	C2	C3	C4	C5	C6
	BASIC	FUNDAMENTAL	HAMPTON	VOLO	ANDES	VELLUTO PELLE

3,975 5,025 5,325 5,525 QUOTED UPON REQUEST

3,975 5,025 5,325 5,525 QUOTED UPON REQUEST

DIMENSIONS

W	75.5
D	31
H	30
SW	73-71.25
SD	20
SH	17.5
BH	14.5
AH	1.5-10.5

FIGURES

YARDAGE REQUIREMENTS SHOWN ARE BASED ON NON-DIRECTIONAL 54" TEXTILES. REFER TO PAGE 3 FOR HELP WITH TEXTILES WITH REPEATS OR SEND AN EMAIL TO: COM_HELP@EKOCONTRACT.COM

COM (YDS.)	8.5
COL (SQ. FT.)	153
WEIGHT (LBS.)	118
CUBIC FEET	41

W	75.5	COM (YDS.)	8.5
D	31	COL (SQ. FT.)	153
H	30	WEIGHT (LBS.)	118
SW	73-71.25	CUBIC FEET	41
SD	20		
SH	17.5		
BH	14.5		
AH	1.5-10.5		

powwow modular lounge

MODULAR ANGLED COMPONENTS



PRODUCT SPECIFICATIONS

IN THE PAST, COLLABORATION WAS STRUCTURED, PLANNED, AND RESERVED FOR FORMAL SETTINGS. TODAY, COLLABORATION IS SPONTANEOUS, IMPROMPTU, AND REQUIRES A SOLUTION THAT SUPPORTS A NEW DYNAMIC. AS A WELCOMING, FREESTANDING, "ARENA-LIKE" SETTING, POWWOW FITS IN OPEN-PLAN SPACES TO DEFINE A SPACE ALL ITS OWN. WITH A DESIGN THAT'S LIGHT IN SCALE YET INCREDIBLY DURABLE, POWWOW INTEGRATES SEATING, TABLES, AND TECHNOLOGY TO CREATE RICH, SOCIAL EXPERIENCES. WHETHER IT'S A FLUID INTERACTION, SPONTANEOUS CONVERSATION, OR PLANNED GATHERING, POWWOW'S READY FOR IT ALL.

POWWOW'S SUPERIOR CONSTRUCTION INCLUDES CNC CUT FURNITURE GRADE PLYWOOD FRAMES ASSEMBLED WITH PUZZLE FIT JOINERY FOR SUPERIOR STRENGTH. TEXTILES ARE HAND-TAILORED OVER 100% POLYURETHANE FOAM THAT MEETS CAL 117 STANDARDS. TOP STITCH NEEDLE SEWING TECHNIQUE WITH COLOR MATCHED THREAD ADDS EXTRA STRENGTH TO SEAMS AND STYLISH FLAIR. TWO TONE TEXTILE APPLICATIONS AVAILABLE ON ALL UNITS.

DESIGNED BY JESS SOREL.

METAL PAINT COLORS

PC1	MILK GLOSS
PC2	CHARCOAL GLOSS
PC3	OATMEAL GLOSS
PC4	SILVER
PC5	CHROME
PC6	RAVEN

WOOD FINISHES

TC	TOP COAT ONLY
10	NATURAL
11	MONTECELLO
12	HUNTINGTON
13	WILD CHERRY
14	VERSAILLES
16	CAFELLE
53	LIGHT MAPLE
31	CINNAMON CHERRY
24	IMPERIAL CHERRY
15	EMPIRE MAHOGANY
46	ROYAL MAHOGANY
69	BOURBON MAHOGANY
64	APPALACHIAN MAHOGANY
42	LIGHT WALNUT
38	HERITAGE WALNUT
20	TRADITIONAL WALNUT
57	EBONY WALNUT
72	BLACK (LOW SHEEN)

LAMINATE FINISHES

SEE PAGE 5 FOR LAMINATE FINISHES

MODEL	DESCRIPTION	FABRIC LIST PRICE					LAMINATE FINISHES			
		COM	CUE	2	3	4	5	6	7	8

50042

ARMLESS LOVESEAT

1,975

2,100

2,325

2,450

2,575

2,725

2,850

2,995

3,250

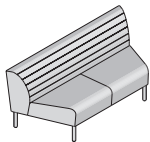

- ANGLED SIDES
- METAL LEGS
- SUPPORTS 350 LBS PER SEAT

50032R

RIGHT ARM LOVESEAT

2,125

2,275

2,500

2,650

2,800

2,925

3,075

3,225

3,500

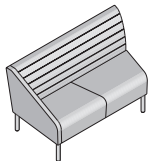

- ANGLED SIDES
- METAL LEGS
- SUPPORTS 350 LBS PER SEAT



ROUND PIVOT TABLE
150 LB. WEIGHT RATING
14 INCH DIAMETER
360° TURNING RADIUS

veneer (ADD \$500 LIST)
RIGHT HANDED POSITION **PTV-R**

LAMINATE (ADD \$450 LIST)
RIGHT HANDED POSITION **PTL-R**

50032L

LEFT ARM LOVESEAT

2,125

2,275

2,500

2,650

2,800

2,925

3,075

3,225

3,500

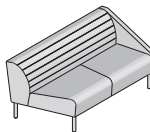

- ANGLED SIDES
- METAL LEGS
- SUPPORTS 350 LBS PER SEAT



ROUND PIVOT TABLE
150 LB. WEIGHT RATING
14 INCH DIAMETER
360° TURNING RADIUS

veneer (ADD \$500 LIST)
LEFT HANDED POSITION **PTV-L**

LAMINATE (ADD \$450 LIST)
LEFT HANDED POSITION **PTL-L**

51032R

RIGHT ARM LOVESEAT/INSET ARM PANELS

2,425

2,575

2,800

2,950

3,100

3,225

3,375

3,525

3,800

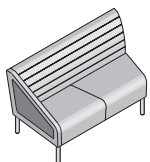

- ANGLED SIDES
- WOOD OR LAMINATE INSET ARM PANELS
- METAL LEGS
- NOT AVAILABLE WITH TABLET
- SUPPORTS 350 LBS PER SEAT

ADDITIONAL PRODUCT ORDERING OPTIONS

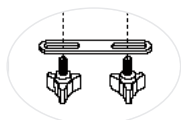
**GC GANGING CONNECTOR** (ADD \$50 LIST PER SET)

OPTIONAL GANGING BRACKET SET INCLUDES TWO BRACKETS AND FOUR 5/8" X 1" THREADED BLACK LOBE KNOBS FOR CONNECTING TWO UNITS TOGETHER. FIELD ASSEMBLY REQUIRED. CANNOT BE RETROFIT TO PREVIOUSLY ORDERED UNITS.

POWWOW NOTES

1. SEATING MODELS FEATURE FIXED SEAT CUSHIONS.
2. WHEN SPECIFYING FABRIC IN DIFFERENT GRADES, THE HIGHEST PRICE GROUP PREVAILS.
3. THE COM YRDS. AND COL SQ. FT. LISTED REFLECT THE REQUIREMENTS FOR A SINGLE 54" FABRIC THAT IS NON-DIRECTIONAL AND APPLIED RAILROADED. FOR MULTI-FABRIC REQUIREMENTS PLEASE REFER TO THE POWWOW SECTION OF OUR WEBSITE FOR TWO-TONE UPHOLSTERY EXAMPLES, YARDAGE REQUIREMENTS AND PRICING.
4. VENEER INSET ARM PANELS, HANGOUT LEDGES, TABLES AND TABLETS ARE FLAT CUT WALNUT OR RIFF CUT WHITE OAK WOOD SPECIE AND FEATURE HORIZONTAL GRAIN DIRECTION. ALL EXPOSED RADIUS PLYWOOD EDGES WILL BE FINISHED TO MATCH SPECIFIED WOOD FINISH AS STANDARD. FOR CUSTOM WOOD FINISHES ADD \$300 ONE TIME CHARGE PER ORDER COLOR. VENEER HANGOUT LEDGES REQUIRE VENEER ON BOTH SIDES. THE EXPOSED RADIUS PLYWOOD EDGE WILL BE FINISHED TO MATCH SPECIFIED LEDGE WOOD FINISH AS STANDARD.
SPECIFY: (V2) FOR VENEER RIFT CUT OAK
(V3) FOR VENEER FLAT CUT WALNUT
5. LAMINATE HANGOUT LEDGES HAVE THE SAME LAMINATE ON BOTH SIDES. FOR DIFFERENT LAMINATES CONTACT CUSTOMER CARE FOR PRICING. WOOD GRAIN LAMINATES SPECIFIED WILL HAVE HORIZONTAL GRAIN PATTERN.
SPECIFY: (L) FOR STANDARD LAMINATE WITH MATCHING POLYMER EDGE
(L/EE) FOR LAMINATE WITH EXPOSED PLY EDGE FINISHED IN CLEAR COAT
6. LAMINATE TABLES AND TABLETS ARE STANDARD WITH MATCHING POLYMER EDGE. TABLES ARE ALSO AVAILABLE WITH EXPOSED RADIUS PLY EDGE. TABLETS MAY ALSO BE SPECIFIED WITH A REVERSE BEVEL EXPOSED EDGE.
SPECIFY: (L) FOR STANDARD LAMINATE WITH MATCHING POLYMER EDGE
(L/EE) FOR LAMINATE WITH EXPOSED PLY EDGE FINISHED IN CLEAR COAT
7. ARM INSET PANELS CANNOT BE RETROFIT TO PREVIOUSLY ORDERED UNITS.
8. HANGOUT LEDGE DIMENSIONS: OVERALL HEIGHT-42.5 INCHES, LEDGE HEIGHT-40 INCHES. LEDGES REQUIRE FIELD INSTALLATION.

LEATHER LIST PRICE

COL	C1	C2	C3	C4	C5	C6
	BASIC	FUNDAMENTAL	HAMPTON	VOLO	ANDES	VELLUTO PELLE

2,575 3,375 3,575 3,725 QUOTED UPON REQUEST

2,800 3,625 3,850 3,995 QUOTED UPON REQUEST

2,800 3,625 3,850 3,995 QUOTED UPON REQUEST

3,100 3,925 4,150 4,295 QUOTED UPON REQUEST

DIMENSIONS

FIGURES

YARDAGE REQUIREMENTS SHOWN ARE BASED ON NON-DIRECTIONAL 54" TEXTILES. REFER TO PAGE 3 FOR HELP WITH TEXTILES WITH REPEATS OR SEND AN EMAIL TO: COM_HELP@EKOCONTRACT.COM

W	70	COM (YDS.)	6.25
D	31	COL (SQ. FT.)	113
H	30	WEIGHT (LBS.)	95
SW	44.5-61	CUBIC FEET	38
SD	20		
SH	17.5		
BH	14.5		

W	62.5	COM (YDS.)	6.75
D	31	COL (SQ. FT.)	122
H	30	WEIGHT (LBS.)	100
SW	47.25-53.75	CUBIC FEET	34
SD	20		
SH	17.5		
BH	14.5		
AH	1.5-10.5		

W	62.5	COM (YDS.)	6.75
D	31	COL (SQ. FT.)	122
H	30	WEIGHT (LBS.)	100
SW	47.25-53.75	CUBIC FEET	34
SD	20		
SH	17.5		
BH	14.5		
AH	1.5-10.5		

W	62.5	COM (YDS.)	6.75
D	31	COL (SQ. FT.)	122
H	30	WEIGHT (LBS.)	103
SW	47.25-53.75	CUBIC FEET	34
SD	20		
SH	17.5		
BH	14.5		
AH	1.5-10.5		

powwow modular lounge

MODULAR STRAIGHT COMPONENTS



PRODUCT SPECIFICATIONS

IN THE PAST, COLLABORATION WAS STRUCTURED, PLANNED, AND RESERVED FOR FORMAL SETTINGS. TODAY, COLLABORATION IS SPONTANEOUS, IMPROMPTU, AND REQUIRES A SOLUTION THAT SUPPORTS A NEW DYNAMIC. AS A WELCOMING, FREESTANDING, "ARENA-LIKE" SETTING, POWWOW FITS IN OPEN-PLAN SPACES TO DEFINE A SPACE ALL ITS OWN. WITH A DESIGN THAT'S LIGHT IN SCALE YET INCREDIBLY DURABLE, POWWOW INTEGRATES SEATING, TABLES, AND TECHNOLOGY TO CREATE RICH, SOCIAL EXPERIENCES. WHETHER IT'S A FLUID INTERACTION, SPONTANEOUS CONVERSATION, OR PLANNED GATHERING, POWWOW'S READY FOR IT ALL.

POWWOW'S SUPERIOR CONSTRUCTION INCLUDES CNC CUT FURNITURE GRADE PLYWOOD FRAMES ASSEMBLED WITH PUZZLE FIT JOINERY FOR SUPERIOR STRENGTH. TEXTILES ARE HAND-TAILORED OVER 100% POLYURETHANE FOAM THAT MEETS CAL 117 STANDARDS. TOP STITCH NEEDLE SEWING TECHNIQUE WITH COLOR MATCHED THREAD ADDS EXTRA STRENGTH TO SEAMS AND STYLISH FLAIR. TWO TONE TEXTILE APPLICATIONS AVAILABLE ON ALL UNITS.

DESIGNED BY JESS SOREL.

METAL PAINT COLORS

PC1	MILK GLOSS
PC2	CHARCOAL GLOSS
PC3	OATMEAL GLOSS
PC4	SILVER
PC5	CHROME
PC6	RAVEN

WOOD FINISHES

TC	TOP COAT ONLY
10	NATURAL
11	MONTICELLO
12	HUNTINGTON
13	WILD CHERRY
14	VERSAILLES
16	CAFELLE
53	LIGHT MAPLE
31	CINNAMON CHERRY
24	IMPERIAL CHERRY
15	EMPIRE MAHOGANY
46	ROYAL MAHOGANY
69	BOURBON MAHOGANY
64	APPALACHIAN MAHOGANY
42	LIGHT WALNUT
38	HERITAGE WALNUT
20	TRADITIONAL WALNUT
57	EBONY WALNUT
72	BLACK (LOW SHEEN)

LAMINATE FINISHES

SEE PAGE 5 FOR LAMINATE FINISHES

MODEL	DESCRIPTION	FABRIC LIST PRICE					LAMINATE FINISHES			
		COM	CUE	2	3	4	5	6	7	8

S1032L	LEFT ARM LOVESEAT/INSET ARM PANELS	2,425	2,575	2,800	2,950	3,100	3,225	3,375	3,525	3,800
---------------	------------------------------------	-------	-------	-------	-------	-------	-------	-------	-------	-------

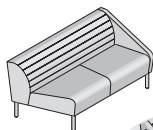

- ANGLED SIDES
- WOOD OR LAMINATE INSET ARM PANELS
- METAL LEGS
- NOT AVAILABLE WITH TABLET
- SUPPORTS 350 LBS PER SEAT



S0043	ARMLESS SOFA	2,875	3,050	3,325	3,500	3,700	3,850	4,025	4,200	4,550
--------------	--------------	-------	-------	-------	-------	-------	-------	-------	-------	-------

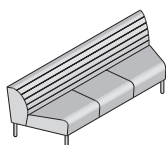

- ANGLED SIDES
- METAL LEGS
- SUPPORTS 350 LBS PER SEAT

S0033R	RIGHT ARM SOFA	2,925	3,125	3,425	3,625	3,800	3,975	4,175	4,350	4,725
---------------	----------------	-------	-------	-------	-------	-------	-------	-------	-------	-------

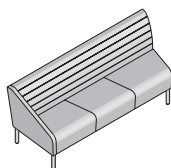

- ANGLED SIDES
- METAL LEGS
- SUPPORTS 350 LBS PER SEAT



ROUND PIVOT TABLET
150 LB. WEIGHT RATING
14 INCH DIAMETER
360° TURNING RADIUS

VENEER (ADD \$500 LIST)
RIGHT HANDED POSITION **PTV-R**

LAMINATE (ADD \$450 LIST)
RIGHT HANDED POSITION **PTL-R**

S0033L	LEFT ARM SOFA	2,925	3,125	3,425	3,625	3,800	3,975	4,175	4,350	4,725
---------------	---------------	-------	-------	-------	-------	-------	-------	-------	-------	-------

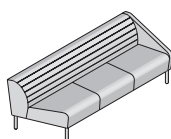

- ANGLED SIDES
- METAL LEGS
- SUPPORTS 350 LBS PER SEAT

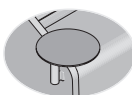

ROUND PIVOT TABLET
150 LB. WEIGHT RATING
14 INCH DIAMETER
360° TURNING RADIUS

VENEER (ADD \$500 LIST)
LEFT HANDED POSITION **PTV-L**

LAMINATE (ADD \$450 LIST)
LEFT HANDED POSITION **PTL-L**

ADDITIONAL PRODUCT ORDERING OPTIONS

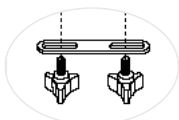
**GC GANGING CONNECTOR** (ADD \$50 LIST PER SET)

OPTIONAL GANGING BRACKET SET INCLUDES TWO BRACKETS AND FOUR 5/8" X 1" THREADED BLACK LOBE KNOBS FOR CONNECTING TWO UNITS TOGETHER. FIELD ASSEMBLY REQUIRED. CANNOT BE RETROFIT TO PREVIOUSLY ORDERED UNITS.

POWWOW NOTES

1. SEATING MODELS FEATURE FIXED SEAT CUSHIONS.
2. WHEN SPECIFYING FABRIC IN DIFFERENT GRADES, THE HIGHEST PRICE GROUP PREVAILS.
3. THE COM YRDS. AND COL SQ. FT. LISTED REFLECT THE REQUIREMENTS FOR A SINGLE 54" FABRIC THAT IS NON-DIRECTIONAL AND APPLIED RAILROADED. FOR MULTI-FABRIC REQUIREMENTS PLEASE REFER TO THE POWWOW SECTION OF OUR WEBSITE FOR TWO-TONE UPHOLSTERY EXAMPLES, YARDAGE REQUIREMENTS AND PRICING.
4. VENEER INSET ARM PANELS, HANGOUT LEDGES, TABLES AND TABLETS ARE FLAT CUT WALNUT OR RIFF CUT WHITE OAK WOOD SPECIE AND FEATURE HORIZONTAL GRAIN DIRECTION. ALL EXPOSED RADIUS PLYWOOD EDGES WILL BE FINISHED TO MATCH SPECIFIED WOOD FINISH AS STANDARD. FOR CUSTOM WOOD FINISHES ADD \$300 ONE TIME CHARGE PER ORDER COLOR. VENEER HANGOUT LEDGES REQUIRE VENEER ON BOTH SIDES. THE EXPOSED RADIUS PLYWOOD EDGE WILL BE FINISHED TO MATCH SPECIFIED LEDGE WOOD FINISH AS STANDARD.
SPECIFY: (V2) FOR VENEER RIFT CUT OAK
(V3) FOR VENEER FLAT CUT WALNUT
5. LAMINATE HANGOUT LEDGES HAVE THE SAME LAMINATE ON BOTH SIDES. FOR DIFFERENT LAMINATES CONTACT CUSTOMER CARE FOR PRICING. WOOD GRAIN LAMINATES SPECIFIED WILL HAVE HORIZONTAL GRAIN PATTERN.
SPECIFY: (L) FOR STANDARD LAMINATE WITH MATCHING POLYMER EDGE
(L/EE) FOR LAMINATE WITH EXPOSED PLY EDGE FINISHED IN CLEAR COAT
6. LAMINATE TABLES AND TABLETS ARE STANDARD WITH MATCHING POLYMER EDGE. TABLES ARE ALSO AVAILABLE WITH EXPOSED RADIUS PLY EDGE. TABLETS MAY ALSO BE SPECIFIED WITH A REVERSE BEVEL EXPOSED EDGE.
SPECIFY: (L) FOR STANDARD LAMINATE WITH MATCHING POLYMER EDGE
(L/EE) FOR LAMINATE WITH EXPOSED PLY EDGE FINISHED IN CLEAR COAT
7. ARM INSET PANELS CANNOT BE RETROFIT TO PREVIOUSLY ORDERED UNITS.
8. HANGOUT LEDGE DIMENSIONS: OVERALL HEIGHT-42.5 INCHES, LEDGE HEIGHT-40 INCHES. LEDGES REQUIRE FIELD INSTALLATION.

LEATHER LIST PRICE

COL	C1	C2	C3	C4	C5	C6
	BASIC	FUNDAMENTAL	HAMPTON	VOLO	ANDES	VELLUTO PELLE

3,100	3,925	4,150	4,295	QUOTED UPON REQUEST
-------	-------	-------	-------	---------------------

3,700	4,700	4,975	5,200	QUOTED UPON REQUEST
-------	-------	-------	-------	---------------------

3,800	4,900	5,200	5,400	QUOTED UPON REQUEST
-------	-------	-------	-------	---------------------

3,800	4,900	5,200	5,400	QUOTED UPON REQUEST
-------	-------	-------	-------	---------------------

DIMENSIONS

FIGURES

YARDAGE REQUIREMENTS SHOWN ARE BASED ON NON-DIRECTIONAL 54" TEXTILES. REFER TO PAGE 3 FOR HELP WITH TEXTILES WITH REPEATS OR SEND AN EMAIL TO: COM_HELP@EKOCONTRACT.COM

W	62.5	COM (YDS.)	6.75
D	31	COL (SQ. FT.)	122
H	30	WEIGHT (LBS.)	103
SW	47.25-53.75	CUBIC FEET	34
SD	20		
SH	17.5		
BH	14.5		
AH	1.5-10.5		

W	94	COM (YDS.)	8.25
D	31	COL (SQ. FT.)	149
H	30	WEIGHT (LBS.)	125
SW	68.5-85	CUBIC FEET	51
SD	20		
SH	17.5		
BH	14.5		

W	86.5	COM (YDS.)	8.75
D	31	COL (SQ. FT.)	158
H	30	WEIGHT (LBS.)	130
SW	71.25-77.75	CUBIC FEET	47
SD	20		
SH	17.5		
BH	14.5		
AH	1.5-10.5		

W	86.5	COM (YDS.)	8.75
D	31	COL (SQ. FT.)	158
H	30	WEIGHT (LBS.)	130
SW	71.25-77.75	CUBIC FEET	47
SD	20		
SH	17.5		
BH	14.5		
AH	1.5-10.5		

powwow modular lounge

MODULAR STRAIGHT COMPONENTS



PRODUCT SPECIFICATIONS

IN THE PAST, COLLABORATION WAS STRUCTURED, PLANNED, AND RESERVED FOR FORMAL SETTINGS. TODAY, COLLABORATION IS SPONTANEOUS, IMPROMPTU, AND REQUIRES A SOLUTION THAT SUPPORTS A NEW DYNAMIC. AS A WELCOMING, FREESTANDING, "ARENA-LIKE" SETTING, POWWOW FITS IN OPEN-PLAN SPACES TO DEFINE A SPACE ALL ITS OWN. WITH A DESIGN THAT'S LIGHT IN SCALE YET INCREDIBLY DURABLE, POWWOW INTEGRATES SEATING, TABLES, AND TECHNOLOGY TO CREATE RICH, SOCIAL EXPERIENCES. WHETHER IT'S A FLUID INTERACTION, SPONTANEOUS CONVERSATION, OR PLANNED GATHERING, POWWOW'S READY FOR IT ALL.

POWWOW'S SUPERIOR CONSTRUCTION INCLUDES CNC CUT FURNITURE GRADE PLYWOOD FRAMES ASSEMBLED WITH PUZZLE FIT JOINERY FOR SUPERIOR STRENGTH. TEXTILES ARE HAND-TAILORED OVER 100% POLYURETHANE FOAM THAT MEETS CAL 117 STANDARDS. TOP STITCH NEEDLE SEWING TECHNIQUE WITH COLOR MATCHED THREAD ADDS EXTRA STRENGTH TO SEAMS AND STYLISH FLAIR. TWO TONE TEXTILE APPLICATIONS AVAILABLE ON ALL UNITS.

DESIGNED BY JESS SOREL.

METAL PAINT COLORS

PC1	MILK GLOSS
PC2	CHARCOAL GLOSS
PC3	OATMEAL GLOSS
PC4	SILVER
PC5	CHROME
PC6	RAVEN

WOOD FINISHES

TC	TOP COAT ONLY
10	NATURAL
11	MONTICELLO
12	HUNTINGTON
13	WILD CHERRY
14	VERSAILLES
16	CAFELLE
53	LIGHT MAPLE
31	CINNAMON CHERRY
24	IMPERIAL CHERRY
15	EMPIRE MAHOGANY
46	ROYAL MAHOGANY
69	BOURBON MAHOGANY
64	APPALACHIAN MAHOGANY
42	LIGHT WALNUT
38	HERITAGE WALNUT
20	TRADITIONAL WALNUT
57	EBONY WALNUT
72	BLACK (LOW SHEEN)

LAMINATE FINISHES

SEE PAGE 5 FOR LAMINATE FINISHES

MODEL	DESCRIPTION	FABRIC LIST PRICE								LAMINATE FINISHES		
		COM	CUE	2	3	4	5	6	7	8	SEE PAGE 5 FOR LAMINATE FINISHES	

S1033R

RIGHT ARM SOFA/INSET ARM PANELS

3,225 3,425 3,725 3,925 4,100 4,275 4,475 4,650 5,025

- ANGLED SIDES
- WOOD OR LAMINATE INSET ARM PANELS
- METAL LEGS
- NOT AVAILABLE WITH TABLET
- SUPPORTS 350 LBS PER SEAT

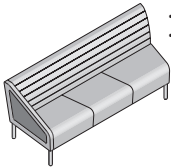

S1033L

LEFT ARM SOFA/INSET ARM PANELS

3,225 3,425 3,725 3,925 4,100 4,275 4,475 4,650 5,025

- ANGLED SIDES
- WOOD OR LAMINATE INSET ARM PANELS
- METAL LEGS
- NOT AVAILABLE WITH TABLET
- SUPPORTS 350 LBS PER SEAT

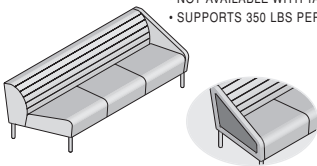

ADDITIONAL PRODUCT ORDERING OPTIONS

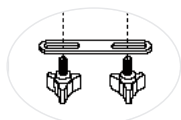

GC GANGING CONNECTOR (ADD \$50 LIST PER SET)
 OPTIONAL GANGING BRACKET SET INCLUDES TWO BRACKETS AND FOUR 5/8" X 1" THREADED BLACK LOBE KNOBS FOR CONNECTING TWO UNITS TOGETHER. FIELD ASSEMBLY REQUIRED. CANNOT BE RETROFIT TO PREVIOUSLY ORDERED UNITS.

POWWOW NOTES

- SEATING MODELS FEATURE FIXED SEAT CUSHIONS.
- WHEN SPECIFYING FABRIC IN DIFFERENT GRADES, THE HIGHEST PRICE GROUP PREVAILS.
- THE COM YRDS. AND COL SQ. FT. LISTED REFLECT THE REQUIREMENTS FOR A SINGLE 54" FABRIC THAT IS NON-DIRECTIONAL AND APPLIED RAILROADED. FOR MULTI-FABRIC REQUIREMENTS PLEASE REFER TO THE POWWOW SECTION OF OUR WEBSITE FOR TWO-TONE UPHOLSTERY EXAMPLES, YARDAGE REQUIREMENTS AND PRICING.
- VENEER INSET ARM PANELS, HANGOUT LEDGES, TABLES AND TABLETS ARE FLAT CUT WALNUT OR RIFF CUT WHITE OAK WOOD SPECIE AND FEATURE HORIZONTAL GRAIN DIRECTION. ALL EXPOSED RADIUS PLYWOOD EDGES WILL BE FINISHED TO MATCH SPECIFIED WOOD FINISH AS STANDARD. FOR CUSTOM WOOD FINISHES ADD \$300 ONE TIME CHARGE PER ORDER COLOR. VENEER HANGOUT LEDGES REQUIRE VENEER ON BOTH SIDES. THE EXPOSED RADIUS PLYWOOD EDGE WILL BE FINISHED TO MATCH SPECIFIED LEDGE WOOD FINISH AS STANDARD.
SPECIFY: (V2) FOR VENEER RIFT CUT OAK
(V3) FOR VENEER FLAT CUT WALNUT
- LAMINATE HANGOUT LEDGES HAVE THE SAME LAMINATE ON BOTH SIDES. FOR DIFFERENT LAMINATES CONTACT CUSTOMER CARE FOR PRICING. WOOD GRAIN LAMINATES SPECIFIED WILL HAVE HORIZONTAL GRAIN PATTERN.
SPECIFY: (L) FOR STANDARD LAMINATE WITH MATCHING POLYMER EDGE
(L/EE) FOR LAMINATE WITH EXPOSED PLY EDGE FINISHED IN CLEAR COAT
- LAMINATE TABLES AND TABLETS ARE STANDARD WITH MATCHING POLYMER EDGE. TABLES ARE ALSO AVAILABLE WITH EXPOSED RADIUS PLY EDGE. TABLETS MAY ALSO BE SPECIFIED WITH A REVERSE BEVEL EXPOSED EDGE.
SPECIFY: (L) FOR STANDARD LAMINATE WITH MATCHING POLYMER EDGE
(L/EE) FOR LAMINATE WITH EXPOSED PLY EDGE FINISHED IN CLEAR COAT
- ARM INSET PANELS CANNOT BE RETROFIT TO PREVIOUSLY ORDERED UNITS.
- HANGOUT LEDGE DIMENSIONS: OVERALL HEIGHT-42.5 INCHES, LEDGE HEIGHT-40 INCHES. LEDGES REQUIRE FIELD INSTALLATION.

LEATHER LIST PRICE

COL	C1	C2	C3	C4	C5	C6
	BASIC	FUNDAMENTAL	HAMPTON	VOLO	ANDES	VELLUTO PELLE

4,100	5,200	5,500	5,700	QUOTED UPON REQUEST
-------	-------	-------	-------	---------------------

4,100	5,200	5,500	5,700	QUOTED UPON REQUEST
-------	-------	-------	-------	---------------------

DIMENSIONS

FIGURES

YARDAGE REQUIREMENTS SHOWN ARE BASED ON NON-DIRECTIONAL 54" TEXTILES. REFER TO PAGE 3 FOR HELP WITH TEXTILES WITH REPEATS OR SEND AN EMAIL TO: COM_HELP@EKOCONTRACT.COM

W	86.5	COM (YDS.)	8.75
D	31	COL (SQ. FT.)	158
H	30	WEIGHT (LBS.)	133
SW	71.25-77.75	CUBIC FEET	47
SD	20		
SH	17.5		
BH	14.5		
AH	1.5-10.5		

W	86.5	COM (YDS.)	8.75
D	31	COL (SQ. FT.)	158
H	30	WEIGHT (LBS.)	133
SW	71.25-77.75	CUBIC FEET	47
SD	20		
SH	17.5		
BH	14.5		
AH	1.5-10.5		

powwow modular lounge

MODULAR FREESTANDING COMPONENTS WITH HANGOUT LEDGE



PRODUCT SPECIFICATIONS

IN THE PAST, COLLABORATION WAS STRUCTURED, PLANNED, AND RESERVED FOR FORMAL SETTINGS. TODAY, COLLABORATION IS SPONTANEOUS, IMPROMPTU, AND REQUIRES A SOLUTION THAT SUPPORTS A NEW DYNAMIC. AS A WELCOMING, FREESTANDING, "ARENA-LIKE" SETTING, POWWOW FITS IN OPEN-PLAN SPACES TO DEFINE A SPACE ALL ITS OWN. WITH A DESIGN THAT'S LIGHT IN SCALE YET INCREDIBLY DURABLE, POWWOW INTEGRATES SEATING, TABLES, AND TECHNOLOGY TO CREATE RICH, SOCIAL EXPERIENCES. WHETHER IT'S A FLUID INTERACTION, SPONTANEOUS CONVERSATION, OR PLANNED GATHERING, POWWOW'S READY FOR IT ALL.

POWWOW'S SUPERIOR CONSTRUCTION INCLUDES CNC CUT FURNITURE GRADE PLYWOOD FRAMES ASSEMBLED WITH PUZZLE FIT JOINERY FOR SUPERIOR STRENGTH. TEXTILES ARE HAND-TAILORED OVER 100% POLYURETHANE FOAM THAT MEETS CAL 117 STANDARDS. TOP STITCH NEEDLE SEWING TECHNIQUE WITH COLOR MATCHED THREAD ADDS EXTRA STRENGTH TO SEAMS AND STYLISH FLAIR. TWO TONE TEXTILE APPLICATIONS AVAILABLE ON ALL UNITS.

DESIGNED BY JESS SOREL.

METAL PAINT COLORS

PC1	MILK GLOSS
PC2	CHARCOAL GLOSS
PC3	OATMEAL GLOSS
PC4	SILVER
PC5	CHROME
PC6	RAVEN

WOOD FINISHES

TC	TOP COAT ONLY
10	NATURAL
11	MONTECELLO
12	HUNTINGTON
13	WILD CHERRY
14	VERSAILLES
16	CAFELLE
53	LIGHT MAPLE
31	CINNAMON CHERRY
24	IMPERIAL CHERRY
15	EMPIRE MAHOGANY
46	ROYAL MAHOGANY
69	BOURBON MAHOGANY
64	APPALACHIAN MAHOGANY
42	LIGHT WALNUT
38	HERITAGE WALNUT
20	TRADITIONAL WALNUT
57	EBONY WALNUT
72	BLACK (LOW SHEEN)

LAMINATE FINISHES

SEE PAGE 5 FOR LAMINATE FINISHES

MODEL	DESCRIPTION	FABRIC LIST PRICE									
		COM	CUE	2	3	4	5	6	7	8	
S0102	LOVESEAT/HANGOUT LEDGE	3,890	4,050	4,275	4,425	4,560	4,700	4,845	4,990	5,270	

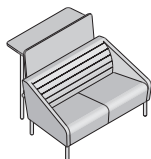

- METAL LEGS
- HANGOUT LEDGE POSTS WILL MATCH COLOR OF LEGS
- HANGOUT LEDGE AVAILABLE IN VENEER OR LAMINATE
- JUICED POWER OPTION AVAILABLE (ADD \$680 LIST)
- SUPPORTS 350 LBS PER SEAT

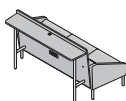

ROUND PIVOT TABLE
150 LB. WEIGHT RATING
14 INCH DIAMETER
360° TURNING RADIUS

VENEER (ADD \$500 LIST)
RIGHT HANDED POSITION **PTV-R**
LEFT HANDED POSITION **PTV-L**

LAMINATE (ADD \$450 LIST)
RIGHT HANDED POSITION **PTL-R**
LEFT HANDED POSITION **PTL-L**

S1102	LOVESEAT/INSET ARM PANELS/HANGOUT LEDGE	4,490	4,650	4,875	5,025	5,160	5,300	5,445	5,590	5,870	
--------------	---	-------	-------	-------	-------	-------	-------	-------	-------	-------	--

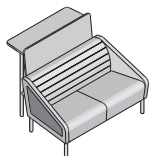

- METAL LEGS
- WOOD OR LAMINATE INSET ARM PANELS
- HANGOUT LEDGE POSTS WILL MATCH COLOR OF LEGS
- HANGOUT LEDGE AVAILABLE IN VENEER OR LAMINATE
- JUICED POWER OPTION AVAILABLE (ADD \$680 LIST)
- NOT AVAILABLE WITH TABLET
- SUPPORTS 350 LBS PER SEAT

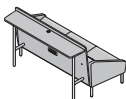

ROUND PIVOT TABLE
150 LB. WEIGHT RATING
14 INCH DIAMETER
360° TURNING RADIUS

VENEER (ADD \$500 LIST)
RIGHT HANDED POSITION **PTV-R**
LEFT HANDED POSITION **PTV-L**

LAMINATE (ADD \$450 LIST)
RIGHT HANDED POSITION **PTL-R**
LEFT HANDED POSITION **PTL-L**

S0103	SOFA/HANGOUT LEDGE	5,060	5,250	5,550	5,765	5,950	6,125	6,335	6,525	6,890	
--------------	--------------------	-------	-------	-------	-------	-------	-------	-------	-------	-------	--

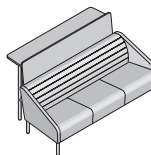

- METAL LEGS
- HANGOUT LEDGE POSTS WILL MATCH COLOR OF LEGS
- HANGOUT LEDGE AVAILABLE IN VENEER OR LAMINATE
- JUICED POWER OPTION AVAILABLE (ADD \$680 LIST)
- SUPPORTS 350 LBS PER SEAT

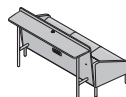

ROUND PIVOT TABLE
150 LB. WEIGHT RATING
14 INCH DIAMETER
360° TURNING RADIUS

VENEER (ADD \$500 LIST)
RIGHT HANDED POSITION **PTV-R**
LEFT HANDED POSITION **PTV-L**

LAMINATE (ADD \$450 LIST)
RIGHT HANDED POSITION **PTL-R**
LEFT HANDED POSITION **PTL-L**

S1103	SOFA/INSET ARM PANELS/HANGOUT LEDGE	5,660	5,850	6,150	6,365	6,550	6,725	6,935	7,125	7,490	
--------------	-------------------------------------	-------	-------	-------	-------	-------	-------	-------	-------	-------	--

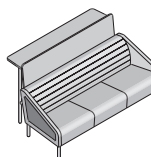

- METAL LEGS
- WOOD OR LAMINATE INSET ARM PANELS
- HANGOUT LEDGE POSTS WILL MATCH COLOR OF LEGS
- HANGOUT LEDGE AVAILABLE IN VENEER OR LAMINATE
- JUICED POWER OPTION AVAILABLE (ADD \$680 LIST)
- NOT AVAILABLE WITH TABLET
- SUPPORTS 350 LBS PER SEAT

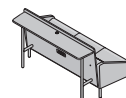

ROUND PIVOT TABLE
150 LB. WEIGHT RATING
14 INCH DIAMETER
360° TURNING RADIUS

VENEER (ADD \$500 LIST)
RIGHT HANDED POSITION **PTV-R**
LEFT HANDED POSITION **PTV-L**

LAMINATE (ADD \$450 LIST)
RIGHT HANDED POSITION **PTL-R**
LEFT HANDED POSITION **PTL-L**

ADDITIONAL PRODUCT ORDERING OPTIONS

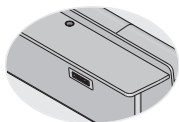
**HANGOUT LEDGE FLAT MOUNT
POWER/DATA CENTER** (ADD \$680 LIST)

FEATURING NEWLY ENGINEERED PATENTED WATER-PROOF OUTLETS. CONSTRUCTED OF ANODIZED ALUMINUM AND LASER CUT STEEL. CONTAINS TWO POWER OUTLETS, TWO ACTIVE USB PORTS AND 120-INCH POWER CORD. POSITIONED ON CENTER OF LEDGE AS STANDARD. FIELD INSTALLATION REQUIRED.

GVWT GLOSS WHITE
GBK GLOSS BLACK

POWWOW NOTES

1. SEATING MODELS FEATURE FIXED SEAT CUSHIONS.
2. WHEN SPECIFYING FABRIC IN DIFFERENT GRADES, THE HIGHEST PRICE GROUP PREVAILS.
3. THE COM YRDS. AND COL SQ. FT. LISTED REFLECT THE REQUIREMENTS FOR A SINGLE 54" FABRIC THAT IS NON-DIRECTIONAL AND APPLIED RAILROADED. FOR MULTI-FABRIC REQUIREMENTS PLEASE REFER TO THE POWWOW SECTION OF OUR WEBSITE FOR TWO-TONE UPHOLSTERY EXAMPLES, YARDAGE REQUIREMENTS AND PRICING.
4. VENEER INSET ARM PANELS, HANGOUT LEDGES, TABLES AND TABLETS ARE FLAT CUT WALNUT OR RIFF CUT WHITE OAK WOOD SPECIE AND FEATURE HORIZONTAL GRAIN DIRECTION. ALL EXPOSED RADIUS PLYWOOD EDGES WILL BE FINISHED TO MATCH SPECIFIED WOOD FINISH AS STANDARD. FOR CUSTOM WOOD FINISHES ADD \$300 ONE TIME CHARGE PER ORDER COLOR. VENEER HANGOUT LEDGES REQUIRE VENEER ON BOTH SIDES. THE EXPOSED RADIUS PLYWOOD EDGE WILL BE FINISHED TO MATCH SPECIFIED LEDGE WOOD FINISH AS STANDARD.
**SPECIFY: (V2) FOR VENEER RIFT CUT OAK
(V3) FOR VENEER FLAT CUT WALNUT**
5. LAMINATE HANGOUT LEDGES HAVE THE SAME LAMINATE ON BOTH SIDES. FOR DIFFERENT LAMINATES CONTACT CUSTOMER CARE FOR PRICING. WOOD GRAIN LAMINATES SPECIFIED WILL HAVE HORIZONTAL GRAIN PATTERN.
**SPECIFY: (L) FOR STANDARD LAMINATE WITH MATCHING POLYMER EDGE
(L/EE) FOR LAMINATE WITH EXPOSED PLY EDGE FINISHED IN CLEAR COAT**
6. LAMINATE TABLES AND TABLETS ARE STANDARD WITH MATCHING POLYMER EDGE. TABLES ARE ALSO AVAILABLE WITH EXPOSED RADIUS PLY EDGE. TABLETS MAY ALSO BE SPECIFIED WITH A REVERSE BEVEL EXPOSED EDGE.
**SPECIFY: (L) FOR STANDARD LAMINATE WITH MATCHING POLYMER EDGE
(L/EE) FOR LAMINATE WITH EXPOSED PLY EDGE FINISHED IN CLEAR COAT**
7. ARM INSET PANELS CANNOT BE RETROFIT TO PREVIOUSLY ORDERED UNITS.
8. HANGOUT LEDGE DIMENSIONS: OVERALL HEIGHT-42.5 INCHES, LEDGE HEIGHT-40 INCHES. LEDGES REQUIRE FIELD INSTALLATION.

LEATHER LIST PRICE

COL	C1	C2	C3	C4	C5	C6
	BASIC	FUNDAMENTAL	HAMPTON	VOLO	ANDES	VELLUTO PELLE

4,560 5,400 5,650 5,800 QUOTED UPON REQUEST

5,160 6,000 6,250 6,400 QUOTED UPON REQUEST

5,950 7,070 7,350 7,570 QUOTED UPON REQUEST

6,550 7,670 7,950 8,170 QUOTED UPON REQUEST

DIMENSIONS

FIGURES

YARDAGE REQUIREMENTS SHOWN ARE BASED ON NON-DIRECTIONAL 54" TEXTILES. REFER TO PAGE 3 FOR HELP WITH TEXTILES WITH REPEATS OR SEND AN EMAIL TO: COM_HELP@EKOCONTRACT.COM

W	55	COM (YDS.)	6.75
D	45.5	COL (SQ. FT.)	122
H	42.5	WEIGHT (LBS.)	140
SW	50-46.5	CUBIC FEET	62
SD	20		
SH	17.5		
BH	14.5		
AH	1.5-10.5		

W	55	COM (YDS.)	6.75
D	45.5	COL (SQ. FT.)	122
H	42.5	WEIGHT (LBS.)	145
SW	50-46.5	CUBIC FEET	62
SD	20		
SH	17.5		
BH	14.5		
AH	1.5-10.5		

W	79	COM (YDS.)	9
D	45.5	COL (SQ. FT.)	162
H	42.5	WEIGHT (LBS.)	140
SW	74-70.5	CUBIC FEET	88
SD	20		
SH	17.5		
BH	14.5		
AH	1.5-10.5		

W	79	COM (YDS.)	9
D	45.5	COL (SQ. FT.)	162
H	42.5	WEIGHT (LBS.)	145
SW	74-70.5	CUBIC FEET	88
SD	20		
SH	17.5		
BH	14.5		
AH	1.5-10.5		

powwow modular lounge

MODULAR STRAIGHT COMPONENTS WITH HANGOUT LEDGE



PRODUCT SPECIFICATIONS

IN THE PAST, COLLABORATION WAS STRUCTURED, PLANNED, AND RESERVED FOR FORMAL SETTINGS. TODAY, COLLABORATION IS SPONTANEOUS, IMPROMPTU, AND REQUIRES A SOLUTION THAT SUPPORTS A NEW DYNAMIC. AS A WELCOMING, FREESTANDING, "ARENA-LIKE" SETTING, POWWOW FITS IN OPEN-PLAN SPACES TO DEFINE A SPACE ALL ITS OWN. WITH A DESIGN THAT'S LIGHT IN SCALE YET INCREDIBLY DURABLE, POWWOW INTEGRATES SEATING, TABLES, AND TECHNOLOGY TO CREATE RICH, SOCIAL EXPERIENCES. WHETHER IT'S A FLUID INTERACTION, SPONTANEOUS CONVERSATION, OR PLANNED GATHERING, POWWOW'S READY FOR IT ALL.

POWWOW'S SUPERIOR CONSTRUCTION INCLUDES CNC CUT FURNITURE GRADE PLYWOOD FRAMES ASSEMBLED WITH PUZZLE FIT JOINERY FOR SUPERIOR STRENGTH. TEXTILES ARE HAND-TAILORED OVER 100% POLYURETHANE FOAM THAT MEETS CAL 117 STANDARDS. TOP STITCH NEEDLE SEWING TECHNIQUE WITH COLOR MATCHED THREAD ADDS EXTRA STRENGTH TO SEAMS AND STYLISH FLAIR. TWO TONE TEXTILE APPLICATIONS AVAILABLE ON ALL UNITS.

DESIGNED BY JESS SOREL.

METAL PAINT COLORS

PC1	MILK GLOSS
PC2	CHARCOAL GLOSS
PC3	OATMEAL GLOSS
PC4	SILVER
PC5	CHROME
PC6	RAVEN

WOOD FINISHES

TC	TOP COAT ONLY
10	NATURAL
11	MONTECELLO
12	HUNTINGTON
13	WILD CHERRY
14	VERSAILLES
16	CAFELLE
53	LIGHT MAPLE
31	CINNAMON CHERRY
24	IMPERIAL CHERRY
15	EMPIRE MAHOGANY
46	ROYAL MAHOGANY
69	BOURBON MAHOGANY
64	APPALACHIAN MAHOGANY
42	LIGHT WALNUT
38	HERITAGE WALNUT
20	TRADITIONAL WALNUT
57	EBONY WALNUT
72	BLACK (LOW SHEEN)

LAMINATE FINISHES

SEE PAGE 5 FOR LAMINATE FINISHES

MODEL	DESCRIPTION	FABRIC	LIST	PRICE							
		COM	CUE	2	3	4	5	6	7	8	
50122	ARMLESS LOVESEAT/HANGOUT LEDGE	3,530	3,650	3,820	3,925	4,050	4,150	4,260	4,375	4,575	

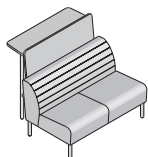

- METAL LEGS
- HANGOUT LEDGE POSTS WILL MATCH COLOR OF LEGS
- HANGOUT LEDGE AVAILABLE IN VENEER OR LAMINATE
- JUICED POWER OPTION AVAILABLE (ADD \$680 LIST)
- SUPPORTS 350 LBS PER SEAT

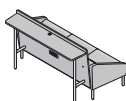

5012R	RIGHT ARM LOVESEAT/HANGOUT LEDGE	3,700	3,825	4,025	4,150	4,265	4,375	4,500	4,625	4,865	
--------------	---	-------	-------	-------	-------	-------	-------	-------	-------	-------	--

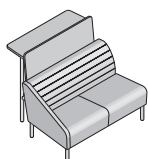

- METAL LEGS
- HANGOUT LEDGE POSTS WILL MATCH COLOR OF LEGS
- HANGOUT LEDGE AVAILABLE IN VENEER OR LAMINATE
- JUICED POWER OPTION AVAILABLE (ADD \$680 LIST)
- SUPPORTS 350 LBS PER SEAT

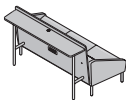

ROUND PIVOT TABLE
150 LB. WEIGHT RATING
14 INCH DIAMETER
360° TURNING RADIUS

VENEER (ADD \$500 LIST)
RIGHT HANDED POSITION **PTV-R**

LAMINATE (ADD \$450 LIST)
RIGHT HANDED POSITION **PTL-R**

5012L	LEFT ARM LOVESEAT/HANGOUT LEDGE	3,700	3,825	4,025	4,150	4,265	4,375	4,500	4,625	4,865	
--------------	--	-------	-------	-------	-------	-------	-------	-------	-------	-------	--

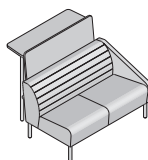

- METAL LEGS
- HANGOUT LEDGE POSTS WILL MATCH COLOR OF LEGS
- HANGOUT LEDGE AVAILABLE IN VENEER OR LAMINATE
- JUICED POWER OPTION AVAILABLE (ADD \$680 LIST)
- SUPPORTS 350 LBS PER SEAT

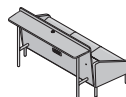

ROUND PIVOT TABLE
150 LB. WEIGHT RATING
14 INCH DIAMETER
360° TURNING RADIUS

VENEER (ADD \$500 LIST)
LEFT HANDED POSITION **PTV-L**

LAMINATE (ADD \$450 LIST)
LEFT HANDED POSITION **PTL-L**

5112R	RIGHT ARM LOVESEAT/INSET ARM PANELS/ HANGOUT LEDGE	4,000	4,125	4,325	4,450	4,565	4,675	4,800	4,925	5,165	
--------------	---	-------	-------	-------	-------	-------	-------	-------	-------	-------	--

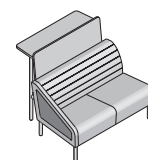

- METAL LEGS
- WOOD OR LAMINATE INSET ARM PANELS
- HANGOUT LEDGE POSTS WILL MATCH COLOR OF LEGS
- HANGOUT LEDGE AVAILABLE IN VENEER OR LAMINATE
- JUICED POWER OPTION AVAILABLE (ADD \$680 LIST)
- NOT AVAILABLE WITH TABLET
- SUPPORTS 350 LBS PER SEAT

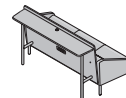

ADDITIONAL PRODUCT ORDERING OPTIONS

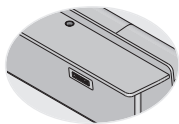
**HANGOUT EDGE FLAT MOUNT
POWER/DATA CENTER** (ADD \$680 LIST)

FEATURING NEWLY ENGINEERED PATENTED WATER-PROOF OUTLETS, CONSTRUCTED OF ANODIZED ALUMINUM AND LASER CUT STEEL. CONTAINS TWO POWER OUTLETS, TWO ACTIVE USB PORTS AND 120-INCH POWER CORD. POSITIONED ON CENTER OF LEDGE AS STANDARD. FIELD INSTALLATION REQUIRED.

GVWT GLOSS WHITE
GBK GLOSS BLACK

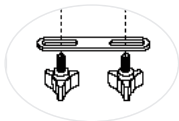
**GC GANGING CONNECTOR** (ADD \$50 LIST PER SET)

OPTIONAL GANGING BRACKET SET INCLUDES TWO BRACKETS AND FOUR 5/8" X 1" THREADED BLACK LOBE KNOBS FOR CONNECTING TWO UNITS TOGETHER. FIELD ASSEMBLY REQUIRED. CANNOT BE RETROFIT TO PREVIOUSLY ORDERED UNITS.

POWWOW NOTES

1. SEATING MODELS FEATURE FIXED SEAT CUSHIONS.
2. WHEN SPECIFYING FABRIC IN DIFFERENT GRADES, THE HIGHEST PRICE GROUP PREVAILS.
3. THE COM YRDS. AND COL SQ. FT. LISTED REFLECT THE REQUIREMENTS FOR A SINGLE 54" FABRIC THAT IS NON-DIRECTIONAL AND APPLIED RAILROADED. FOR MULTI-FABRIC REQUIREMENTS PLEASE REFER TO THE POWWOW SECTION OF OUR WEBSITE FOR TWO-TONE UPHOLSTERY EXAMPLES, YARDAGE REQUIREMENTS AND PRICING.
4. VENEER INSET ARM PANELS, HANGOUT LEDGES, TABLES AND TABLETS ARE FLAT CUT WALNUT OR RIFF CUT WHITE OAK WOOD SPECIE AND FEATURE HORIZONTAL GRAIN DIRECTION. ALL EXPOSED RADIUS PLYWOOD EDGES WILL BE FINISHED TO MATCH SPECIFIED WOOD FINISH AS STANDARD. FOR CUSTOM WOOD FINISHES ADD \$300 ONE TIME CHARGE PER ORDER COLOR. VENEER HANGOUT LEDGES REQUIRE VENEER ON BOTH SIDES. THE EXPOSED RADIUS PLYWOOD EDGE WILL BE FINISHED TO MATCH SPECIFIED LEDGE WOOD FINISH AS STANDARD.
**SPECIFY: (V2) FOR VENEER RIFT CUT OAK
(V3) FOR VENEER FLAT CUT WALNUT**
5. LAMINATE HANGOUT LEDGES HAVE THE SAME LAMINATE ON BOTH SIDES. FOR DIFFERENT LAMINATES CONTACT CUSTOMER CARE FOR PRICING. WOOD GRAIN LAMINATES SPECIFIED WILL HAVE HORIZONTAL GRAIN PATTERN.
**SPECIFY: (L) FOR STANDARD LAMINATE WITH MATCHING POLYMER EDGE
(L/EE) FOR LAMINATE WITH EXPOSED PLY EDGE FINISHED IN CLEAR COAT**
6. LAMINATE TABLES AND TABLETS ARE STANDARD WITH MATCHING POLYMER EDGE. TABLES ARE ALSO AVAILABLE WITH EXPOSED RADIUS PLY EDGE. TABLETS MAY ALSO BE SPECIFIED WITH A REVERSE BEVEL EXPOSED EDGE.
**SPECIFY: (L) FOR STANDARD LAMINATE WITH MATCHING POLYMER EDGE
(L/EE) FOR LAMINATE WITH EXPOSED PLY EDGE FINISHED IN CLEAR COAT**
7. ARM INSET PANELS CANNOT BE RETROFIT TO PREVIOUSLY ORDERED UNITS.
8. HANGOUT LEDGE DIMENSIONS: OVERALL HEIGHT-42.5 INCHES, LEDGE HEIGHT-40 INCHES. LEDGES REQUIRE FIELD INSTALLATION.

LEATHER LIST PRICE

COL	C1	C2	C3	C4	C5	C6
	BASIC	FUNDAMENTAL	HAMPTON	VOLO	ANDES	VELLUTO PELLE

4,050 4,700 4,875 5,000 QUOTED UPON REQUEST

4,265 4,975 5,175 5,325 QUOTED UPON REQUEST

4,265 4,975 5,175 5,325 QUOTED UPON REQUEST

4,565 5,275 5,475 5,625 QUOTED UPON REQUEST

DIMENSIONS

FIGURES

YARDAGE REQUIREMENTS SHOWN ARE BASED ON NON-DIRECTIONAL 54" TEXTILES. REFER TO PAGE 3 FOR HELP WITH TEXTILES WITH REPEATS OR SEND AN EMAIL TO: COM_HELP@EKOCONTRACT.COM

W	48	COM (YDS.)	5.25
D	45.5	COL (SQ. FT.)	95
H	42.5	WEIGHT (LBS.)	90
SW	48	CUBIC FEET	54
SD	20		
SH	17.5		
BH	14.5		

W	51.5	COM (YDS.)	5.75
D	45.5	COL (SQ. FT.)	104
H	42.5	WEIGHT (LBS.)	95
SW	49-47.25	CUBIC FEET	58
SD	20		
SH	17.5		
BH	14.5		
AH	1.5-10.5		

W	51.5	COM (YDS.)	5.75
D	45.5	COL (SQ. FT.)	104
H	42.5	WEIGHT (LBS.)	95
SW	49-47.25	CUBIC FEET	58
SD	20		
SH	17.5		
BH	14.5		
AH	1.5-10.5		

W	51.5	COM (YDS.)	5.75
D	45.5	COL (SQ. FT.)	104
H	42.5	WEIGHT (LBS.)	98
SW	49-47.25	CUBIC FEET	58
SD	20		
SH	17.5		
BH	14.5		
AH	1.5-10.5		

powwow modular lounge

MODULAR STRAIGHT COMPONENTS WITH HANGOUT LEDGE



PRODUCT SPECIFICATIONS

IN THE PAST, COLLABORATION WAS STRUCTURED, PLANNED, AND RESERVED FOR FORMAL SETTINGS. TODAY, COLLABORATION IS SPONTANEOUS, IMPROMPTU, AND REQUIRES A SOLUTION THAT SUPPORTS A NEW DYNAMIC. AS A WELCOMING, FREESTANDING, "ARENA-LIKE" SETTING, POWWOW FITS IN OPEN-PLAN SPACES TO DEFINE A SPACE ALL ITS OWN. WITH A DESIGN THAT'S LIGHT IN SCALE YET INCREDIBLY DURABLE, POWWOW INTEGRATES SEATING, TABLES, AND TECHNOLOGY TO CREATE RICH, SOCIAL EXPERIENCES. WHETHER IT'S A FLUID INTERACTION, SPONTANEOUS CONVERSATION, OR PLANNED GATHERING, POWWOW'S READY FOR IT ALL.

POWWOW'S SUPERIOR CONSTRUCTION INCLUDES CNC CUT FURNITURE GRADE PLYWOOD FRAMES ASSEMBLED WITH PUZZLE FIT JOINERY FOR SUPERIOR STRENGTH. TEXTILES ARE HAND-TAILORED OVER 100% POLYURETHANE FOAM THAT MEETS CAL 117 STANDARDS. TOP STITCH NEEDLE SEWING TECHNIQUE WITH COLOR MATCHED THREAD ADDS EXTRA STRENGTH TO SEAMS AND STYLISH FLAIR. TWO TONE TEXTILE APPLICATIONS AVAILABLE ON ALL UNITS.

DESIGNED BY JESS SOREL.

METAL PAINT COLORS

PC1	MILK GLOSS
PC2	CHARCOAL GLOSS
PC3	OATMEAL GLOSS
PC4	SILVER
PC5	CHROME
PC6	RAVEN

WOOD FINISHES

TC	TOP COAT ONLY
10	NATURAL
11	MONTECELLO
12	HUNTINGTON
13	WILD CHERRY
14	VERSAILLES
16	CAFELLE
53	LIGHT MAPLE
31	CINNAMON CHERRY
24	IMPERIAL CHERRY
15	EMPIRE MAHOGANY
46	ROYAL MAHOGANY
69	BOURBON MAHOGANY
64	APPALACHIAN MAHOGANY
42	LIGHT WALNUT
38	HERITAGE WALNUT
20	TRADITIONAL WALNUT
57	EBONY WALNUT
72	BLACK (LOW SHEEN)

LAMINATE FINISHES

SEE PAGE 5 FOR LAMINATE FINISHES

MODEL	DESCRIPTION	FABRIC LIST PRICE									
		COM	CUE	2	3	4	5	6	7	8	

5112L	LEFT ARM LOVESEAT/INSET ARM PANELS/ HANGOUT LEDGE	4,000	4,125	4,325	4,450	4,565	4,675	4,800	4,925	5,165	
--------------	--	-------	-------	-------	-------	-------	-------	-------	-------	-------	--

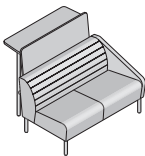

- METAL LEGS
- WOOD OR LAMINATE INSET ARM PANELS
- HANGOUT LEDGE POSTS WILL MATCH COLOR OF LEGS
- HANGOUT LEDGE AVAILABLE IN VENEER OR LAMINATE
- JUICED POWER OPTION AVAILABLE (ADD \$680 LIST)
- NOT AVAILABLE WITH TABLET
- SUPPORTS 350 LBS PER SEAT

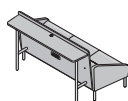

50123	ARMLESS SOFA/HANGOUT LEDGE	4,800	5,000	5,250	5,425	5,575	5,750	5,900	6,070	6,400	
--------------	----------------------------	-------	-------	-------	-------	-------	-------	-------	-------	-------	--

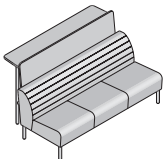

- METAL LEGS
- HANGOUT LEDGE POSTS WILL MATCH COLOR OF LEGS
- HANGOUT LEDGE AVAILABLE IN VENEER OR LAMINATE
- JUICED POWER OPTION AVAILABLE (ADD \$680 LIST)
- SUPPORTS 350 LBS PER SEAT

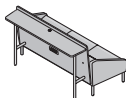

50113R	RIGHT ARM SOFA/HANGOUT LEDGE	4,900	5,100	5,400	5,575	5,750	5,925	6,100	6,300	6,650	
---------------	------------------------------	-------	-------	-------	-------	-------	-------	-------	-------	-------	--

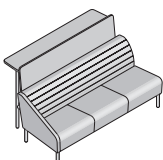

- METAL LEGS
- HANGOUT LEDGE POSTS WILL MATCH COLOR OF LEGS
- HANGOUT LEDGE AVAILABLE IN VENEER OR LAMINATE
- JUICED POWER OPTION AVAILABLE (ADD \$680 LIST)
- SUPPORTS 350 LBS PER SEAT

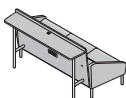

ROUND PIVOT TABLET
150 LB. WEIGHT RATING
14 INCH DIAMETER
360° TURNING RADIUS

VENEER (ADD \$500 LIST)
RIGHT HANDED POSITION **PTV-R**

LAMINATE (ADD \$450 LIST)
RIGHT HANDED POSITION **PTL-R**

50113L	LEFT ARM SOFA/HANGOUT LEDGE	4,900	5,100	5,400	5,575	5,750	5,925	6,100	6,300	6,650	
---------------	-----------------------------	-------	-------	-------	-------	-------	-------	-------	-------	-------	--

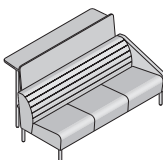

- METAL LEGS
- HANGOUT LEDGE POSTS WILL MATCH COLOR OF LEGS
- HANGOUT LEDGE AVAILABLE IN VENEER OR LAMINATE
- JUICED POWER OPTION AVAILABLE (ADD \$680 LIST)
- SUPPORTS 350 LBS PER SEAT

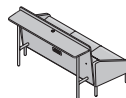

ROUND PIVOT TABLET
150 LB. WEIGHT RATING
14 INCH DIAMETER
360° TURNING RADIUS

VENEER (ADD \$500 LIST)
LEFT HANDED POSITION **PTV-L**

LAMINATE (ADD \$450 LIST)
LEFT HANDED POSITION **PTL-L**

ADDITIONAL PRODUCT ORDERING OPTIONS

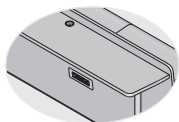
**HANGOUT LEDGE FLAT MOUNT POWER/DATA CENTER** (ADD \$680 LIST)

FEATURING NEWLY ENGINEERED PATENTED WATER-PROOF OUTLETS, CONSTRUCTED OF ANODIZED ALUMINUM AND LASER CUT STEEL. CONTAINS TWO POWER OUTLETS, TWO ACTIVE USB PORTS AND 120-INCH POWER CORD. POSITIONED ON CENTER OF LEDGE AS STANDARD. FIELD INSTALLATION REQUIRED.

GVWT GLOSS WHITE
GBK GLOSS BLACK

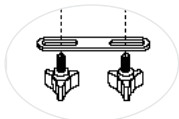
**GC GANGING CONNECTOR** (ADD \$50 LIST PER SET)

OPTIONAL GANGING BRACKET SET INCLUDES TWO BRACKETS AND FOUR 5/8" X 1" THREADED BLACK LOBE KNOBS FOR CONNECTING TWO UNITS TOGETHER. FIELD ASSEMBLY REQUIRED. CANNOT BE RETROFIT TO PREVIOUSLY ORDERED UNITS.

POWWOW NOTES

1. SEATING MODELS FEATURE FIXED SEAT CUSHIONS.
2. WHEN SPECIFYING FABRIC IN DIFFERENT GRADES, THE HIGHEST PRICE GROUP PREVAILS.
3. THE COM YRDS. AND COL SQ. FT. LISTED REFLECT THE REQUIREMENTS FOR A SINGLE 54" FABRIC THAT IS NON-DIRECTIONAL AND APPLIED RAILROADED. FOR MULTI-FABRIC REQUIREMENTS PLEASE REFER TO THE POWWOW SECTION OF OUR WEBSITE FOR TWO-TONE UPHOLSTERY EXAMPLES, YARDAGE REQUIREMENTS AND PRICING.
4. VENEER INSET ARM PANELS, HANGOUT LEDGES, TABLES AND TABLETS ARE FLAT CUT WALNUT OR RIFF CUT WHITE OAK WOOD SPECIE AND FEATURE HORIZONTAL GRAIN DIRECTION. ALL EXPOSED RADIUS PLYWOOD EDGES WILL BE FINISHED TO MATCH SPECIFIED WOOD FINISH AS STANDARD. FOR CUSTOM WOOD FINISHES ADD \$300 ONE TIME CHARGE PER ORDER COLOR. VENEER HANGOUT LEDGES REQUIRE VENEER ON BOTH SIDES. THE EXPOSED RADIUS PLYWOOD EDGE WILL BE FINISHED TO MATCH SPECIFIED LEDGE WOOD FINISH AS STANDARD.
SPECIFY: (V2) FOR VENEER RIFT CUT OAK
(V3) FOR VENEER FLAT CUT WALNUT
5. LAMINATE HANGOUT LEDGES HAVE THE SAME LAMINATE ON BOTH SIDES. FOR DIFFERENT LAMINATES CONTACT CUSTOMER CARE FOR PRICING. WOOD GRAIN LAMINATES SPECIFIED WILL HAVE HORIZONTAL GRAIN PATTERN.
SPECIFY: (L) FOR STANDARD LAMINATE WITH MATCHING POLYMER EDGE
(L/EE) FOR LAMINATE WITH EXPOSED PLY EDGE FINISHED IN CLEAR COAT
6. LAMINATE TABLES AND TABLETS ARE STANDARD WITH MATCHING POLYMER EDGE. TABLES ARE ALSO AVAILABLE WITH EXPOSED RADIUS PLY EDGE. TABLETS MAY ALSO BE SPECIFIED WITH A REVERSE BEVEL EXPOSED EDGE.
SPECIFY: (L) FOR STANDARD LAMINATE WITH MATCHING POLYMER EDGE
(L/EE) FOR LAMINATE WITH EXPOSED PLY EDGE FINISHED IN CLEAR COAT
7. ARM INSET PANELS CANNOT BE RETROFIT TO PREVIOUSLY ORDERED UNITS.
8. HANGOUT LEDGE DIMENSIONS: OVERALL HEIGHT-42.5 INCHES, LEDGE HEIGHT-40 INCHES. LEDGES REQUIRE FIELD INSTALLATION.

LEATHER LIST PRICE

COL	C1	C2	C3	C4	C5	C6
	BASIC	FUNDAMENTAL	HAMPTON	VOLO	ANDES	VELLUTO PELLE

4,565 5,275 5,475 5,625 QUOTED UPON REQUEST

5,575 6,550 6,825 7,000 QUOTED UPON REQUEST

5,750 6,800 7,100 7,300 QUOTED UPON REQUEST

5,750 6,800 7,100 7,300 QUOTED UPON REQUEST

DIMENSIONS

W	51.5
D	45.5
H	42.5
SW	49-47.25
SD	20
SH	17.5
BH	14.5
AH	1.5-10.5

W	72
D	45.5
H	42.5
SW	72
SD	20
SH	17.5
BH	14.5

W	75.5
D	45.5
H	42.5
SW	73-71.25
SD	20
SH	17.5
BH	14.5
AH	1.5-10.5

W	75.5
D	45.5
H	42.5
SW	73-71.25
SD	20
SH	17.5
BH	14.5
AH	1.5-10.5

FIGURES

YARDAGE REQUIREMENTS SHOWN ARE BASED ON NON-DIRECTIONAL 54" TEXTILES. REFER TO PAGE 3 FOR HELP WITH TEXTILES WITH REPEATS OR SEND AN EMAIL TO: COM_HELP@EKOCONTRACT.COM

COM (YDS.)	5.75
COL (SQ. FT.)	104
WEIGHT (LBS.)	98
CUBIC FEET	58

COM (YDS.)	7.75
COL (SQ. FT.)	140
WEIGHT (LBS.)	120
CUBIC FEET	81

COM (YDS.)	8.5
COL (SQ. FT.)	153
WEIGHT (LBS.)	125
CUBIC FEET	84

COM (YDS.)	8.5
COL (SQ. FT.)	153
WEIGHT (LBS.)	125
CUBIC FEET	84

powwow modular lounge

MODULAR STRAIGHT COMPONENTS WITH HANGOUT LEDGE



PRODUCT SPECIFICATIONS

IN THE PAST, COLLABORATION WAS STRUCTURED, PLANNED, AND RESERVED FOR FORMAL SETTINGS. TODAY, COLLABORATION IS SPONTANEOUS, IMPROMPTU, AND REQUIRES A SOLUTION THAT SUPPORTS A NEW DYNAMIC. AS A WELCOMING, FREESTANDING, "ARENA-LIKE" SETTING, POWWOW FITS IN OPEN-PLAN SPACES TO DEFINE A SPACE ALL ITS OWN. WITH A DESIGN THAT'S LIGHT IN SCALE YET INCREDIBLY DURABLE, POWWOW INTEGRATES SEATING, TABLES, AND TECHNOLOGY TO CREATE RICH, SOCIAL EXPERIENCES. WHETHER IT'S A FLUID INTERACTION, SPONTANEOUS CONVERSATION, OR PLANNED GATHERING, POWWOW'S READY FOR IT ALL.

POWWOW'S SUPERIOR CONSTRUCTION INCLUDES CNC CUT FURNITURE GRADE PLYWOOD FRAMES ASSEMBLED WITH PUZZLE FIT JOINERY FOR SUPERIOR STRENGTH. TEXTILES ARE HAND-TAILORED OVER 100% POLYURETHANE FOAM THAT MEETS CAL 117 STANDARDS. TOP STITCH NEEDLE SEWING TECHNIQUE WITH COLOR MATCHED THREAD ADDS EXTRA STRENGTH TO SEAMS AND STYLISH FLAIR. TWO TONE TEXTILE APPLICATIONS AVAILABLE ON ALL UNITS.

DESIGNED BY JESS SOREL.

METAL PAINT COLORS

PC1	MILK GLOSS
PC2	CHARCOAL GLOSS
PC3	OATMEAL GLOSS
PC4	SILVER
PC5	CHROME
PC6	RAVEN

WOOD FINISHES

TC	TOP COAT ONLY
10	NATURAL
11	MONTICELLO
12	HUNTINGTON
13	WILD CHERRY
14	VERSAILLES
16	CAFELLE
53	LIGHT MAPLE
31	CINNAMON CHERRY
24	IMPERIAL CHERRY
15	EMPIRE MAHOGANY
46	ROYAL MAHOGANY
69	BOURBON MAHOGANY
64	APPALACHIAN MAHOGANY
42	LIGHT WALNUT
38	HERITAGE WALNUT
20	TRADITIONAL WALNUT
57	EBONY WALNUT
72	BLACK (LOW SHEEN)

LAMINATE FINISHES

SEE PAGE 5 FOR LAMINATE FINISHES

MODEL	DESCRIPTION	FABRIC LIST PRICE					LAMINATE FINISHES			
		COM	CUE	2	3	4	5	6	7	8

S1113R	RIGHT ARM SOFA/INSET ARM PANELS/ HANGOUT LEDGE	5,200	5,400	5,700	5,875	6,050	6,225	6,400	6,600	6,950
---------------	---	-------	-------	-------	-------	-------	-------	-------	-------	-------

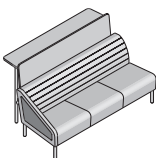

- METAL LEGS
- WOOD OR LAMINATE INSET ARM PANELS
- HANGOUT LEDGE POSTS WILL MATCH COLOR OF LEGS
- HANGOUT LEDGE AVAILABLE IN VENEER OR LAMINATE
- JUICED POWER OPTION AVAILABLE (ADD \$680 LIST)
- NOT AVAILABLE WITH TABLET
- SUPPORTS 350 LBS PER SEAT

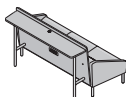

S1113L	LEFT ARM SOFA/INSET ARM PANELS/ HANGOUT LEDGE	5,200	5,400	5,700	5,875	6,050	6,225	6,400	6,600	6,950
---------------	--	-------	-------	-------	-------	-------	-------	-------	-------	-------

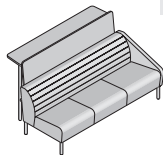

- METAL LEGS
- WOOD OR LAMINATE INSET ARM PANELS
- HANGOUT LEDGE POSTS WILL MATCH COLOR OF LEGS
- HANGOUT LEDGE AVAILABLE IN VENEER OR LAMINATE
- JUICED POWER OPTION AVAILABLE (ADD \$680 LIST)
- NOT AVAILABLE WITH TABLET
- SUPPORTS 350 LBS PER SEAT

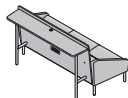
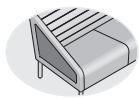

ADDITIONAL PRODUCT ORDERING OPTIONS

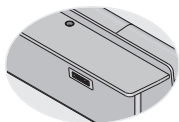
**HANGOUT LEDGE FLAT MOUNT
POWER/DATA CENTER** (ADD \$680 LIST)

FEATURING NEWLY ENGINEERED PATENTED WATER-PROOF OUTLETS. CONSTRUCTED OF ANODIZED ALUMINUM AND LASER CUT STEEL. CONTAINS TWO POWER OUTLETS, TWO ACTIVE USB PORTS AND 120-INCH POWER CORD. POSITIONED ON CENTER OF LEDGE AS STANDARD. FIELD INSTALLATION REQUIRED.

GVWT GLOSS WHITE
GBK GLOSS BLACK

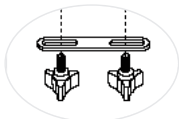
**GC GANGING CONNECTOR** (ADD \$50 LIST PER SET)

OPTIONAL GANGING BRACKET SET INCLUDES TWO BRACKETS AND FOUR 5/8" X 1" THREADED BLACK LOBE KNOBS FOR CONNECTING TWO UNITS TOGETHER. FIELD ASSEMBLY REQUIRED. CANNOT BE RETROFIT TO PREVIOUSLY ORDERED UNITS.

POWWOW NOTES

1. SEATING MODELS FEATURE FIXED SEAT CUSHIONS.
2. WHEN SPECIFYING FABRIC IN DIFFERENT GRADES, THE HIGHEST PRICE GROUP PREVAILS.
3. THE COM YRDS. AND COL SQ. FT. LISTED REFLECT THE REQUIREMENTS FOR A SINGLE 54" FABRIC THAT IS NON-DIRECTIONAL AND APPLIED RAILROADED. FOR MULTI-FABRIC REQUIREMENTS PLEASE REFER TO THE POWWOW SECTION OF OUR WEBSITE FOR TWO-TONE UPHOLSTERY EXAMPLES, YARDAGE REQUIREMENTS AND PRICING.
4. VENEER INSET ARM PANELS, HANGOUT LEDGES, TABLES AND TABLETS ARE FLAT CUT WALNUT OR RIFF CUT WHITE OAK WOOD SPECIE AND FEATURE HORIZONTAL GRAIN DIRECTION. ALL EXPOSED RADIUS PLYWOOD EDGES WILL BE FINISHED TO MATCH SPECIFIED WOOD FINISH AS STANDARD. FOR CUSTOM WOOD FINISHES ADD \$300 ONE TIME CHARGE PER ORDER COLOR. VENEER HANGOUT LEDGES REQUIRE VENEER ON BOTH SIDES. THE EXPOSED RADIUS PLYWOOD EDGE WILL BE FINISHED TO MATCH SPECIFIED LEDGE WOOD FINISH AS STANDARD.
**SPECIFY: (V2) FOR VENEER RIFT CUT OAK
(V3) FOR VENEER FLAT CUT WALNUT**
5. LAMINATE HANGOUT LEDGES HAVE THE SAME LAMINATE ON BOTH SIDES. FOR DIFFERENT LAMINATES CONTACT CUSTOMER CARE FOR PRICING. WOOD GRAIN LAMINATES SPECIFIED WILL HAVE HORIZONTAL GRAIN PATTERN.
**SPECIFY: (L) FOR STANDARD LAMINATE WITH MATCHING POLYMER EDGE
(L/EE) FOR LAMINATE WITH EXPOSED PLY EDGE FINISHED IN CLEAR COAT**
6. LAMINATE TABLES AND TABLETS ARE STANDARD WITH MATCHING POLYMER EDGE. TABLES ARE ALSO AVAILABLE WITH EXPOSED RADIUS PLY EDGE. TABLETS MAY ALSO BE SPECIFIED WITH A REVERSE BEVEL EXPOSED EDGE.
**SPECIFY: (L) FOR STANDARD LAMINATE WITH MATCHING POLYMER EDGE
(L/EE) FOR LAMINATE WITH EXPOSED PLY EDGE FINISHED IN CLEAR COAT**
7. ARM INSET PANELS CANNOT BE RETROFIT TO PREVIOUSLY ORDERED UNITS.
8. HANGOUT LEDGE DIMENSIONS: OVERALL HEIGHT-42.5 INCHES, LEDGE HEIGHT-40 INCHES. LEDGES REQUIRE FIELD INSTALLATION.

LEATHER LIST PRICE

COL	C1	C2	C3	C4	C5	C6
	BASIC	FUNDAMENTAL	HAMPTON	VOLO	ANDES	VELLUTO PELLE

6,050 7,100 7,400 7,600 QUOTED UPON REQUEST

6,050 7,100 7,400 7,600 QUOTED UPON REQUEST

DIMENSIONS

W	75.5
D	45.5
H	42.5
SW	73-71.25
SD	20
SH	17.5
BH	14.5
AH	1.5-10.5

FIGURES

YARDAGE REQUIREMENTS SHOWN ARE BASED ON NON-DIRECTIONAL 54" TEXTILES. REFER TO PAGE 3 FOR HELP WITH TEXTILES WITH REPEATS OR SEND AN EMAIL TO: COM_HELP@EKOCONTRACT.COM

COM (YDS.)	8.5
COL (SQ. FT.)	153
WEIGHT (LBS.)	128
CUBIC FEET	84

W	75.5	COM (YDS.)	8.5
D	45.5	COL (SQ. FT.)	153
H	42.5	WEIGHT (LBS.)	128
SW	73-71.25	CUBIC FEET	84
SD	20		
SH	17.5		
BH	14.5		
AH	1.5-10.5		

powwow modular lounge

MODULAR ANGLED COMPONENTS WITH HANGOUT LEDGE



PRODUCT SPECIFICATIONS

IN THE PAST, COLLABORATION WAS STRUCTURED, PLANNED, AND RESERVED FOR FORMAL SETTINGS. TODAY, COLLABORATION IS SPONTANEOUS, IMPROMPTU, AND REQUIRES A SOLUTION THAT SUPPORTS A NEW DYNAMIC. AS A WELCOMING, FREESTANDING, "ARENA-LIKE" SETTING, POWWOW FITS IN OPEN-PLAN SPACES TO DEFINE A SPACE ALL ITS OWN. WITH A DESIGN THAT'S LIGHT IN SCALE YET INCREDIBLY DURABLE, POWWOW INTEGRATES SEATING, TABLES, AND TECHNOLOGY TO CREATE RICH, SOCIAL EXPERIENCES. WHETHER IT'S A FLUID INTERACTION, SPONTANEOUS CONVERSATION, OR PLANNED GATHERING, POWWOW'S READY FOR IT ALL.

POWWOW'S SUPERIOR CONSTRUCTION INCLUDES CNC CUT FURNITURE GRADE PLYWOOD FRAMES ASSEMBLED WITH PUZZLE FIT JOINERY FOR SUPERIOR STRENGTH. TEXTILES ARE HAND-TAILORED OVER 100% POLYURETHANE FOAM THAT MEETS CAL 117 STANDARDS. TOP STITCH NEEDLE SEWING TECHNIQUE WITH COLOR MATCHED THREAD ADDS EXTRA STRENGTH TO SEAMS AND STYLISH FLAIR. TWO TONE TEXTILE APPLICATIONS AVAILABLE ON ALL UNITS.

DESIGNED BY JESS SOREL.

METAL PAINT COLORS

PC1	MILK GLOSS
PC2	CHARCOAL GLOSS
PC3	OATMEAL GLOSS
PC4	SILVER
PC5	CHROME
PC6	RAVEN

WOOD FINISHES

TC	TOP COAT ONLY
10	NATURAL
11	MONTECELLO
12	HUNTINGTON
13	WILD CHERRY
14	VERSAILLES
16	CAFELLE
53	LIGHT MAPLE
31	CINNAMON CHERRY
24	IMPERIAL CHERRY
15	EMPIRE MAHOGANY
46	ROYAL MAHOGANY
69	BOURBON MAHOGANY
64	APPALACHIAN MAHOGANY
42	LIGHT WALNUT
38	HERITAGE WALNUT
20	TRADITIONAL WALNUT
57	EBONY WALNUT
72	BLACK (LOW SHEEN)

LAMINATE FINISHES

SEE PAGE 5 FOR LAMINATE FINISHES

MODEL	DESCRIPTION	FABRIC	LIST	PRICE	COM	CUE	2	3	4	5	6	7	8
50142	ARMLESS LOVESEAT/HANGOUT LEDGE				3,925	4,050	4,275	4,400	4,525	4,675	4,800	4,945	5,200

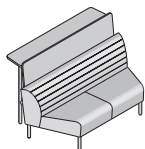

- ANGLED SIDES
- METAL LEGS
- HANGOUT LEDGE POSTS WILL MATCH COLOR OF LEGS
- HANGOUT LEDGE AVAILABLE IN VENEER OR LAMINATE
- JUICED POWER OPTION AVAILABLE (ADD \$680 LIST)
- SUPPORTS 350 LBS PER SEAT

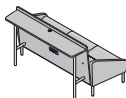

50132R	RIGHT ARM LOVESEAT/HANGOUT LEDGE				4,075	4,225	4,450	4,600	4,750	4,875	5,025	5,175	5,450
---------------	---	--	--	--	-------	-------	-------	-------	-------	-------	-------	-------	-------

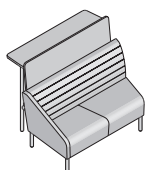

- ANGLED SIDES
- METAL LEGS
- HANGOUT LEDGE POSTS WILL MATCH COLOR OF LEGS
- HANGOUT LEDGE AVAILABLE IN VENEER OR LAMINATE
- JUICED POWER OPTION AVAILABLE (ADD \$680 LIST)
- SUPPORTS 350 LBS PER SEAT

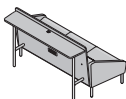

ROUND PIVOT TABLE
150 LB. WEIGHT RATING
14 INCH DIAMETER
360° TURNING RADIUS

VENEER (ADD \$500 LIST)
RIGHT HANDED POSITION **PTV-R**

LAMINATE (ADD \$450 LIST)
RIGHT HANDED POSITION **PTL-R**

50132L	LEFT ARM LOVESEAT/HANGOUT LEDGE				4,075	4,225	4,450	4,600	4,750	4,875	5,025	5,175	5,450
---------------	--	--	--	--	-------	-------	-------	-------	-------	-------	-------	-------	-------

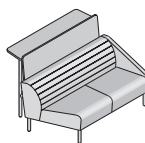

- ANGLED SIDES
- METAL LEGS
- HANGOUT LEDGE POSTS WILL MATCH COLOR OF LEGS
- HANGOUT LEDGE AVAILABLE IN VENEER OR LAMINATE
- JUICED POWER OPTION AVAILABLE (ADD \$680 LIST)
- SUPPORTS 350 LBS PER SEAT

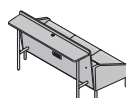

ROUND PIVOT TABLE
150 LB. WEIGHT RATING
14 INCH DIAMETER
360° TURNING RADIUS

VENEER (ADD \$500 LIST)
LEFT HANDED POSITION **PTV-L**

LAMINATE (ADD \$450 LIST)
LEFT HANDED POSITION **PTL-L**

51132R	RIGHT ARM LOVESEAT/INSET ARM PANELS/ HANGOUT LEDGE				4,375	4,525	4,750	4,900	5,050	5,175	5,325	5,475	5,750
---------------	---	--	--	--	-------	-------	-------	-------	-------	-------	-------	-------	-------

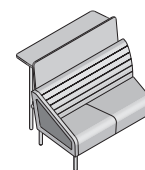

- ANGLED SIDES
- METAL LEGS
- WOOD OR LAMINATE INSET ARM PANELS
- HANGOUT LEDGE POSTS WILL MATCH COLOR OF LEGS
- HANGOUT LEDGE AVAILABLE IN VENEER OR LAMINATE
- JUICED POWER OPTION AVAILABLE (ADD \$680 LIST)
- NOT AVAILABLE WITH TABLE
- SUPPORTS 350 LBS PER SEAT

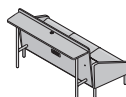

ADDITIONAL PRODUCT ORDERING OPTIONS

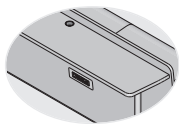
**HANGOUT EDGE FLAT MOUNT
POWER/DATA CENTER** (ADD \$680 LIST)

FEATURING NEWLY ENGINEERED PATENTED WATER-PROOF OUTLETS. CONSTRUCTED OF ANODIZED ALUMINUM AND LASER CUT STEEL. CONTAINS TWO POWER OUTLETS, TWO ACTIVE USB PORTS AND 120-INCH POWER CORD. POSITIONED ON CENTER OF LEDGE AS STANDARD. FIELD INSTALLATION REQUIRED.

GVWT GLOSS WHITE
GBK GLOSS BLACK

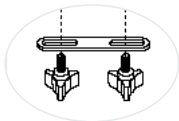
**GC GANGING CONNECTOR** (ADD \$50 LIST PER SET)

OPTIONAL GANGING BRACKET SET INCLUDES TWO BRACKETS AND FOUR 5/8" X 1" THREADED BLACK LOBE KNOBS FOR CONNECTING TWO UNITS TOGETHER. FIELD ASSEMBLY REQUIRED. CANNOT BE RETROFIT TO PREVIOUSLY ORDERED UNITS.

POWWOW NOTES

1. SEATING MODELS FEATURE FIXED SEAT CUSHIONS.
2. WHEN SPECIFYING FABRIC IN DIFFERENT GRADES, THE HIGHEST PRICE GROUP PREVAILS.
3. THE COM YRDS. AND COL SQ. FT. LISTED REFLECT THE REQUIREMENTS FOR A SINGLE 54" FABRIC THAT IS NON-DIRECTIONAL AND APPLIED RAILROADED. FOR MULTI-FABRIC REQUIREMENTS PLEASE REFER TO THE POWWOW SECTION OF OUR WEBSITE FOR TWO-TONE UPHOLSTERY EXAMPLES, YARDAGE REQUIREMENTS AND PRICING.
4. VENEER INSET ARM PANELS, HANGOUT LEDGES, TABLES AND TABLETS ARE FLAT CUT WALNUT OR RIFF CUT WHITE OAK WOOD SPECIE AND FEATURE HORIZONTAL GRAIN DIRECTION. ALL EXPOSED RADIUS PLYWOOD EDGES WILL BE FINISHED TO MATCH SPECIFIED WOOD FINISH AS STANDARD. FOR CUSTOM WOOD FINISHES ADD \$300 ONE TIME CHARGE PER ORDER COLOR. VENEER HANGOUT LEDGES REQUIRE VENEER ON BOTH SIDES. THE EXPOSED RADIUS PLYWOOD EDGE WILL BE FINISHED TO MATCH SPECIFIED LEDGE WOOD FINISH AS STANDARD.
**SPECIFY: (V2) FOR VENEER RIFT CUT OAK
(V3) FOR VENEER FLAT CUT WALNUT**
5. LAMINATE HANGOUT LEDGES HAVE THE SAME LAMINATE ON BOTH SIDES. FOR DIFFERENT LAMINATES CONTACT CUSTOMER CARE FOR PRICING. WOOD GRAIN LAMINATES SPECIFIED WILL HAVE HORIZONTAL GRAIN PATTERN.
**SPECIFY: (L) FOR STANDARD LAMINATE WITH MATCHING POLYMER EDGE
(L/EE) FOR LAMINATE WITH EXPOSED PLY EDGE FINISHED IN CLEAR COAT**
6. LAMINATE TABLES AND TABLETS ARE STANDARD WITH MATCHING POLYMER EDGE. TABLES ARE ALSO AVAILABLE WITH EXPOSED RADIUS PLY EDGE. TABLETS MAY ALSO BE SPECIFIED WITH A REVERSE BEVEL EXPOSED EDGE.
**SPECIFY: (L) FOR STANDARD LAMINATE WITH MATCHING POLYMER EDGE
(L/EE) FOR LAMINATE WITH EXPOSED PLY EDGE FINISHED IN CLEAR COAT**
7. ARM INSET PANELS CANNOT BE RETROFIT TO PREVIOUSLY ORDERED UNITS.
8. HANGOUT LEDGE DIMENSIONS: OVERALL HEIGHT-42.5 INCHES, LEDGE HEIGHT-40 INCHES. LEDGES REQUIRE FIELD INSTALLATION.

LEATHER LIST PRICE

COL	C1	C2	C3	C4	C5	C6
	BASIC	FUNDAMENTAL	HAMPTON	VOLO	ANDES	VELLUTO PELLE

4,525 5,325 5,525 5,675 QUOTED UPON REQUEST

4,750 5,575 5,800 5,945 QUOTED UPON REQUEST

4,750 5,575 5,800 5,945 QUOTED UPON REQUEST

5,050 5,875 6,100 6,245 QUOTED UPON REQUEST

DIMENSIONS

FIGURES

YARDAGE REQUIREMENTS SHOWN ARE BASED ON NON-DIRECTIONAL 54" TEXTILES. REFER TO PAGE 3 FOR HELP WITH TEXTILES WITH REPEATS OR SEND AN EMAIL TO: COM_HELP@EKOCONTRACT.COM

W	70	COM (YDS.)	6.25
D	45.5	COL (SQ. FT.)	113
H	42.5	WEIGHT (LBS.)	100
SW	44.5-61	CUBIC FEET	78
SD	20		
SH	17.5		
BH	14.5		

W	62.5	COM (YDS.)	6.75
D	45.5	COL (SQ. FT.)	122
H	42.5	WEIGHT (LBS.)	105
SW	47.25-53.75	CUBIC FEET	70
SD	20		
SH	17.5		
BH	14.5		
AH	1.5-10.5		

W	62.5	COM (YDS.)	6.75
D	45.5	COL (SQ. FT.)	122
H	42.5	WEIGHT (LBS.)	105
SW	47.25-53.75	CUBIC FEET	70
SD	20		
SH	17.5		
BH	14.5		
AH	1.5-10.5		

W	62.5	COM (YDS.)	6.75
D	45.5	COL (SQ. FT.)	122
H	42.5	WEIGHT (LBS.)	108
SW	47.25-53.75	CUBIC FEET	70
SD	20		
SH	17.5		
BH	14.5		
AH	1.5-10.5		

powwow modular lounge

MODULAR ANGLED COMPONENTS WITH HANGOUT LEDGE



PRODUCT SPECIFICATIONS

IN THE PAST, COLLABORATION WAS STRUCTURED, PLANNED, AND RESERVED FOR FORMAL SETTINGS. TODAY, COLLABORATION IS SPONTANEOUS, IMPROMPTU, AND REQUIRES A SOLUTION THAT SUPPORTS A NEW DYNAMIC. AS A WELCOMING, FREESTANDING, "ARENA-LIKE" SETTING, POWWOW FITS IN OPEN-PLAN SPACES TO DEFINE A SPACE ALL ITS OWN. WITH A DESIGN THAT'S LIGHT IN SCALE YET INCREDIBLY DURABLE, POWWOW INTEGRATES SEATING, TABLES, AND TECHNOLOGY TO CREATE RICH, SOCIAL EXPERIENCES. WHETHER IT'S A FLUID INTERACTION, SPONTANEOUS CONVERSATION, OR PLANNED GATHERING, POWWOW'S READY FOR IT ALL.

POWWOW'S SUPERIOR CONSTRUCTION INCLUDES CNC CUT FURNITURE GRADE PLYWOOD FRAMES ASSEMBLED WITH PUZZLE FIT JOINERY FOR SUPERIOR STRENGTH. TEXTILES ARE HAND-TAILORED OVER 100% POLYURETHANE FOAM THAT MEETS CAL 117 STANDARDS. TOP STITCH NEEDLE SEWING TECHNIQUE WITH COLOR MATCHED THREAD ADDS EXTRA STRENGTH TO SEAMS AND STYLISH FLAIR. TWO TONE TEXTILE APPLICATIONS AVAILABLE ON ALL UNITS.

DESIGNED BY JESS SOREL.

METAL PAINT COLORS

PC1	MILK GLOSS
PC2	CHARCOAL GLOSS
PC3	OATMEAL GLOSS
PC4	SILVER
PC5	CHROME
PC6	RAVEN

WOOD FINISHES

TC	TOP COAT ONLY
10	NATURAL
11	MONTECELLO
12	HUNTINGTON
13	WILD CHERRY
14	VERSAILLES
16	CAFELLE
53	LIGHT MAPLE
31	CINNAMON CHERRY
24	IMPERIAL CHERRY
15	EMPIRE MAHOGANY
46	ROYAL MAHOGANY
69	BOURBON MAHOGANY
64	APPALACHIAN MAHOGANY
42	LIGHT WALNUT
38	HERITAGE WALNUT
20	TRADITIONAL WALNUT
57	EBONY WALNUT
72	BLACK (LOW SHEEN)

LAMINATE FINISHES

SEE PAGE 5 FOR LAMINATE FINISHES

MODEL	DESCRIPTION	FABRIC	LIST PRICE	COM	CUE	2	3	4	5	6	7	8
-------	-------------	--------	------------	-----	-----	---	---	---	---	---	---	---

51132L	LEFT ARM LOVESEAT/INSET ARM PANELS/ HANGOUT LEDGE			4,375	4,525	4,750	4,900	5,050	5,175	5,325	5,475	5,750
---------------	--	--	--	-------	-------	-------	-------	-------	-------	-------	-------	-------

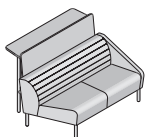

- ANGLED SIDES
- METAL LEGS
- WOOD OR LAMINATE INSET ARM PANELS
- HANGOUT LEDGE POSTS WILL MATCH COLOR OF LEGS
- HANGOUT LEDGE AVAILABLE IN VENEER OR LAMINATE
- JUICED POWER OPTION AVAILABLE (ADD \$680 LIST)
- NOT AVAILABLE WITH TABLET
- SUPPORTS 350 LBS PER SEAT

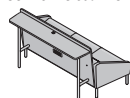
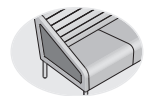

50143	ARMLESS SOFA/HANGOUT LEDGE			4,950	5,125	5,400	5,575	5,775	5,925	6,100	6,275	6,625
--------------	----------------------------	--	--	-------	-------	-------	-------	-------	-------	-------	-------	-------

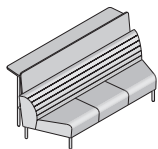

- ANGLED SIDES
- METAL LEGS
- HANGOUT LEDGE POSTS WILL MATCH COLOR OF LEGS
- HANGOUT LEDGE AVAILABLE IN VENEER OR LAMINATE
- JUICED POWER OPTION AVAILABLE (ADD \$680 LIST)
- SUPPORTS 350 LBS PER SEAT

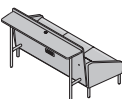

50133R	RIGHT ARM SOFA/HANGOUT LEDGE			5,000	5,200	5,500	5,700	5,875	6,050	6,250	6,425	6,800
---------------	------------------------------	--	--	-------	-------	-------	-------	-------	-------	-------	-------	-------

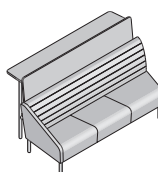

- ANGLED SIDES
- METAL LEGS
- HANGOUT LEDGE POSTS WILL MATCH COLOR OF LEGS
- HANGOUT LEDGE AVAILABLE IN VENEER OR LAMINATE
- JUICED POWER OPTION AVAILABLE (ADD \$680 LIST)
- SUPPORTS 350 LBS PER SEAT

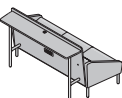

ROUND PIVOT TABLE
150 LB. WEIGHT RATING
14 INCH DIAMETER
360° TURNING RADIUS

VENEER (ADD \$500 LIST)
RIGHT HANDED POSITION **PTV-R**

LAMINATE (ADD \$450 LIST)
RIGHT HANDED POSITION **PTL-R**

50133L	LEFT ARM SOFA/HANGOUT LEDGE			5,000	5,200	5,500	5,700	5,875	6,050	6,250	6,425	6,800
---------------	-----------------------------	--	--	-------	-------	-------	-------	-------	-------	-------	-------	-------

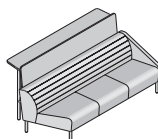

- ANGLED SIDES
- METAL LEGS
- HANGOUT LEDGE POSTS WILL MATCH COLOR OF LEGS
- HANGOUT LEDGE AVAILABLE IN VENEER OR LAMINATE
- JUICED POWER OPTION AVAILABLE (ADD \$680 LIST)
- SUPPORTS 350 LBS PER SEAT

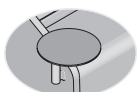
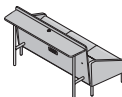

ROUND PIVOT TABLE
150 LB. WEIGHT RATING
14 INCH DIAMETER
360° TURNING RADIUS

VENEER (ADD \$500 LIST)
LEFT HANDED POSITION **PTV-L**

LAMINATE (ADD \$450 LIST)
LEFT HANDED POSITION **PTL-L**

ADDITIONAL PRODUCT ORDERING OPTIONS

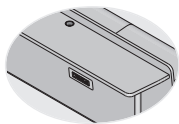
**HANGOUT LEDGE FLAT MOUNT
POWER/DATA CENTER** (ADD \$680 LIST)

FEATURING NEWLY ENGINEERED PATENTED WATER-PROOF OUTLETS. CONSTRUCTED OF ANODIZED ALUMINUM AND LASER CUT STEEL. CONTAINS TWO POWER OUTLETS, TWO ACTIVE USB PORTS AND 120-INCH POWER CORD. POSITIONED ON CENTER OF LEDGE AS STANDARD. FIELD INSTALLATION REQUIRED.

GVWT GLOSS WHITE
GBK GLOSS BLACK

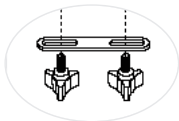
**GC GANGING CONNECTOR** (ADD \$50 LIST PER SET)

OPTIONAL GANGING BRACKET SET INCLUDES TWO BRACKETS AND FOUR 5/8" X 1" THREADED BLACK LOBE KNOBS FOR CONNECTING TWO UNITS TOGETHER. FIELD ASSEMBLY REQUIRED. CANNOT BE RETROFIT TO PREVIOUSLY ORDERED UNITS.

POWWOW NOTES

1. SEATING MODELS FEATURE FIXED SEAT CUSHIONS.
2. WHEN SPECIFYING FABRIC IN DIFFERENT GRADES, THE HIGHEST PRICE GROUP PREVAILS.
3. THE COM YRDS. AND COL SQ. FT. LISTED REFLECT THE REQUIREMENTS FOR A SINGLE 54" FABRIC THAT IS NON-DIRECTIONAL AND APPLIED RAILROADED. FOR MULTI-FABRIC REQUIREMENTS PLEASE REFER TO THE POWWOW SECTION OF OUR WEBSITE FOR TWO-TONE UPHOLSTERY EXAMPLES, YARDAGE REQUIREMENTS AND PRICING.
4. VENEER INSET ARM PANELS, HANGOUT LEDGES, TABLES AND TABLETS ARE FLAT CUT WALNUT OR RIFF CUT WHITE OAK WOOD SPECIE AND FEATURE HORIZONTAL GRAIN DIRECTION. ALL EXPOSED RADIUS PLYWOOD EDGES WILL BE FINISHED TO MATCH SPECIFIED WOOD FINISH AS STANDARD. FOR CUSTOM WOOD FINISHES ADD \$300 ONE TIME CHARGE PER ORDER COLOR. VENEER HANGOUT LEDGES REQUIRE VENEER ON BOTH SIDES. THE EXPOSED RADIUS PLYWOOD EDGE WILL BE FINISHED TO MATCH SPECIFIED LEDGE WOOD FINISH AS STANDARD.
**SPECIFY: (V2) FOR VENEER RIFT CUT OAK
(V3) FOR VENEER FLAT CUT WALNUT**
5. LAMINATE HANGOUT LEDGES HAVE THE SAME LAMINATE ON BOTH SIDES. FOR DIFFERENT LAMINATES CONTACT CUSTOMER CARE FOR PRICING. WOOD GRAIN LAMINATES SPECIFIED WILL HAVE HORIZONTAL GRAIN PATTERN.
**SPECIFY: (L) FOR STANDARD LAMINATE WITH MATCHING POLYMER EDGE
(L/EE) FOR LAMINATE WITH EXPOSED PLY EDGE FINISHED IN CLEAR COAT**
6. LAMINATE TABLES AND TABLETS ARE STANDARD WITH MATCHING POLYMER EDGE. TABLES ARE ALSO AVAILABLE WITH EXPOSED RADIUS PLY EDGE. TABLETS MAY ALSO BE SPECIFIED WITH A REVERSE BEVEL EXPOSED EDGE.
**SPECIFY: (L) FOR STANDARD LAMINATE WITH MATCHING POLYMER EDGE
(L/EE) FOR LAMINATE WITH EXPOSED PLY EDGE FINISHED IN CLEAR COAT**
7. ARM INSET PANELS CANNOT BE RETROFIT TO PREVIOUSLY ORDERED UNITS.
8. HANGOUT LEDGE DIMENSIONS: OVERALL HEIGHT-42.5 INCHES, LEDGE HEIGHT-40 INCHES. LEDGES REQUIRE FIELD INSTALLATION.

LEATHER LIST PRICE

COL	C1	C2	C3	C4	C5	C6
	BASIC	FUNDAMENTAL	HAMPTON	VOLO	ANDES	VELLUTO PELLE

5,050 5,875 6,100 6,245 QUOTED UPON REQUEST

5,775 6,775 7,050 7,275 QUOTED UPON REQUEST

5,875 6,975 7,275 7,475 QUOTED UPON REQUEST

5,875 6,975 7,275 7,475 QUOTED UPON REQUEST

DIMENSIONS

FIGURES

YARDAGE REQUIREMENTS SHOWN ARE BASED ON NON-DIRECTIONAL 54" TEXTILES. REFER TO PAGE 3 FOR HELP WITH TEXTILES WITH REPEATS OR SEND AN EMAIL TO: COM_HELP@EKOCONTRACT.COM

W	62.5	COM (YDS.)	6.75
D	45.5	COL (SQ. FT.)	122
H	42.5	WEIGHT (LBS.)	108
SW	47.25-53.75	CUBIC FEET	70
SD	20		
SH	17.5		
BH	14.5		
AH	1.5-10.5		

W	94	COM (YDS.)	8.25
D	45.5	COL (SQ. FT.)	149
H	42.5	WEIGHT (LBS.)	120
SW	68.5-85	CUBIC FEET	105
SD	20		
SH	17.5		
BH	14.5		

W	86.5	COM (YDS.)	8.75
D	45.5	COL (SQ. FT.)	158
H	42.5	WEIGHT (LBS.)	125
SW	71.25-77.75	CUBIC FEET	97
SD	20		
SH	17.5		
BH	14.5		
AH	1.5-10.5		

W	86.5	COM (YDS.)	8.75
D	45.5	COL (SQ. FT.)	158
H	42.5	WEIGHT (LBS.)	125
SW	71.25-77.75	CUBIC FEET	97
SD	20		
SH	17.5		
BH	14.5		
AH	1.5-10.5		

powwow modular lounge

MODULAR ANGLED COMPONENTS WITH HANGOUT LEDGE



PRODUCT SPECIFICATIONS

IN THE PAST, COLLABORATION WAS STRUCTURED, PLANNED, AND RESERVED FOR FORMAL SETTINGS. TODAY, COLLABORATION IS SPONTANEOUS, IMPROMPTU, AND REQUIRES A SOLUTION THAT SUPPORTS A NEW DYNAMIC. AS A WELCOMING, FREESTANDING, "ARENA-LIKE" SETTING, POWWOW FITS IN OPEN-PLAN SPACES TO DEFINE A SPACE ALL ITS OWN. WITH A DESIGN THAT'S LIGHT IN SCALE YET INCREDIBLY DURABLE, POWWOW INTEGRATES SEATING, TABLES, AND TECHNOLOGY TO CREATE RICH, SOCIAL EXPERIENCES. WHETHER IT'S A FLUID INTERACTION, SPONTANEOUS CONVERSATION, OR PLANNED GATHERING, POWWOW'S READY FOR IT ALL.

POWWOW'S SUPERIOR CONSTRUCTION INCLUDES CNC CUT FURNITURE GRADE PLYWOOD FRAMES ASSEMBLED WITH PUZZLE FIT JOINERY FOR SUPERIOR STRENGTH. TEXTILES ARE HAND-TAILORED OVER 100% POLYURETHANE FOAM THAT MEETS CAL 117 STANDARDS. TOP STITCH NEEDLE SEWING TECHNIQUE WITH COLOR MATCHED THREAD ADDS EXTRA STRENGTH TO SEAMS AND STYLISH FLAIR. TWO TONE TEXTILE APPLICATIONS AVAILABLE ON ALL UNITS.

DESIGNED BY JESS SOREL.

METAL PAINT COLORS

PC1	MILK GLOSS
PC2	CHARCOAL GLOSS
PC3	OATMEAL GLOSS
PC4	SILVER
PC5	CHROME
PC6	RAVEN

WOOD FINISHES

TC	TOP COAT ONLY
10	NATURAL
11	MONTICELLO
12	HUNTINGTON
13	WILD CHERRY
14	VERSAILLES
16	CAFELLE
53	LIGHT MAPLE
31	CINNAMON CHERRY
24	IMPERIAL CHERRY
15	EMPIRE MAHOGANY
46	ROYAL MAHOGANY
69	BOURBON MAHOGANY
64	APPALACHIAN MAHOGANY
42	LIGHT WALNUT
38	HERITAGE WALNUT
20	TRADITIONAL WALNUT
57	EBONY WALNUT
72	BLACK (LOW SHEEN)

LAMINATE FINISHES

SEE PAGE 5 FOR LAMINATE FINISHES

MODEL	DESCRIPTION	FABRIC LIST PRICE					LAMINATE FINISHES			
		COM	CUE	2	3	4	5	6	7	8

S1133R	RIGHT ARM SOFA/INSET ARM PANELS/ HANGOUT LEDGE	5,300	5,500	5,800	6,000	6,175	6,350	6,550	6,725	7,100
---------------	---	-------	-------	-------	-------	-------	-------	-------	-------	-------

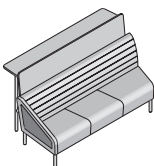

- ANGLED SIDES
- METAL LEGS
- WOOD OR LAMINATE INSET ARM PANELS
- HANGOUT LEDGE POSTS WILL MATCH COLOR OF LEGS
- HANGOUT LEDGE AVAILABLE IN VENEER OR LAMINATE
- JUICED POWER OPTION AVAILABLE (ADD \$680 LIST)
- NOT AVAILABLE WITH TABLET
- SUPPORTS 350 LBS PER SEAT

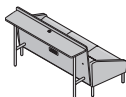

S1133L	LEFT ARM SOFA/INSET ARM PANELS/ HANGOUT LEDGE	5,300	5,500	5,800	6,000	6,175	6,350	6,550	6,725	7,100
---------------	--	-------	-------	-------	-------	-------	-------	-------	-------	-------

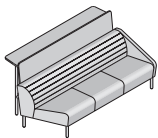

- ANGLED SIDES
- METAL LEGS
- WOOD OR LAMINATE INSET ARM PANELS
- HANGOUT LEDGE POSTS WILL MATCH COLOR OF LEGS
- HANGOUT LEDGE AVAILABLE IN VENEER OR LAMINATE
- JUICED POWER OPTION AVAILABLE (ADD \$680 LIST)
- NOT AVAILABLE WITH TABLET
- SUPPORTS 350 LBS PER SEAT

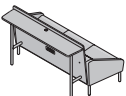

ADDITIONAL PRODUCT ORDERING OPTIONS

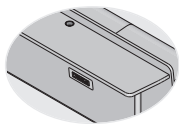
**HANGOUT LEDGE FLAT MOUNT
POWER/DATA CENTER** (ADD \$680 LIST)

FEATURING NEWLY ENGINEERED PATENTED WATER-PROOF OUTLETS. CONSTRUCTED OF ANODIZED ALUMINUM AND LASER CUT STEEL. CONTAINS TWO POWER OUTLETS, TWO ACTIVE USB PORTS AND 120-INCH POWER CORD. POSITIONED ON CENTER OF LEDGE AS STANDARD. FIELD INSTALLATION REQUIRED.

GVWT GLOSS WHITE
GBK GLOSS BLACK

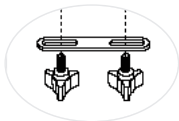
**GC GANGING CONNECTOR** (ADD \$50 LIST PER SET)

OPTIONAL GANGING BRACKET SET INCLUDES TWO BRACKETS AND FOUR 5/8" X 1" THREADED BLACK LOBE KNOBS FOR CONNECTING TWO UNITS TOGETHER. FIELD ASSEMBLY REQUIRED. CANNOT BE RETROFIT TO PREVIOUSLY ORDERED UNITS.

POWWOW NOTES

1. SEATING MODELS FEATURE FIXED SEAT CUSHIONS.
2. WHEN SPECIFYING FABRIC IN DIFFERENT GRADES, THE HIGHEST PRICE GROUP PREVAILS.
3. THE COM YRDS. AND COL SQ. FT. LISTED REFLECT THE REQUIREMENTS FOR A SINGLE 54" FABRIC THAT IS NON-DIRECTIONAL AND APPLIED RAILROADED. FOR MULTI-FABRIC REQUIREMENTS PLEASE REFER TO THE POWWOW SECTION OF OUR WEBSITE FOR TWO-TONE UPHOLSTERY EXAMPLES, YARDAGE REQUIREMENTS AND PRICING.
4. VENEER INSET ARM PANELS, HANGOUT LEDGES, TABLES AND TABLETS ARE FLAT CUT WALNUT OR RIFF CUT WHITE OAK WOOD SPECIE AND FEATURE HORIZONTAL GRAIN DIRECTION. ALL EXPOSED RADIUS PLYWOOD EDGES WILL BE FINISHED TO MATCH SPECIFIED WOOD FINISH AS STANDARD. FOR CUSTOM WOOD FINISHES ADD \$300 ONE TIME CHARGE PER ORDER COLOR. VENEER HANGOUT LEDGES REQUIRE VENEER ON BOTH SIDES. THE EXPOSED RADIUS PLYWOOD EDGE WILL BE FINISHED TO MATCH SPECIFIED LEDGE WOOD FINISH AS STANDARD.
**SPECIFY: (V2) FOR VENEER RIFT CUT OAK
(V3) FOR VENEER FLAT CUT WALNUT**
5. LAMINATE HANGOUT LEDGES HAVE THE SAME LAMINATE ON BOTH SIDES. FOR DIFFERENT LAMINATES CONTACT CUSTOMER CARE FOR PRICING. WOOD GRAIN LAMINATES SPECIFIED WILL HAVE HORIZONTAL GRAIN PATTERN.
**SPECIFY: (L) FOR STANDARD LAMINATE WITH MATCHING POLYMER EDGE
(L/EE) FOR LAMINATE WITH EXPOSED PLY EDGE FINISHED IN CLEAR COAT**
6. LAMINATE TABLES AND TABLETS ARE STANDARD WITH MATCHING POLYMER EDGE. TABLES ARE ALSO AVAILABLE WITH EXPOSED RADIUS PLY EDGE. TABLETS MAY ALSO BE SPECIFIED WITH A REVERSE BEVEL EXPOSED EDGE.
**SPECIFY: (L) FOR STANDARD LAMINATE WITH MATCHING POLYMER EDGE
(L/EE) FOR LAMINATE WITH EXPOSED PLY EDGE FINISHED IN CLEAR COAT**
7. ARM INSET PANELS CANNOT BE RETROFIT TO PREVIOUSLY ORDERED UNITS.
8. HANGOUT LEDGE DIMENSIONS: OVERALL HEIGHT-42.5 INCHES, LEDGE HEIGHT-40 INCHES. LEDGES REQUIRE FIELD INSTALLATION.

LEATHER LIST PRICE

COL	C1	C2	C3	C4	C5	C6
	BASIC	FUNDAMENTAL	HAMPTON	VOLO	ANDES	VELLUTO PELLE

6,175 7,275 7,575 7,775 QUOTED UPON REQUEST

6,175 7,275 7,575 7,775 QUOTED UPON REQUEST

DIMENSIONS

W	86.5
D	45.5
H	42.5
SW	71.25-77.75
SD	20
SH	17.5
BH	14.5
AH	1.5-10.5

FIGURES

YARDAGE REQUIREMENTS SHOWN ARE BASED ON NON-DIRECTIONAL 54" TEXTILES. REFER TO PAGE 3 FOR HELP WITH TEXTILES WITH REPEATS OR SEND AN EMAIL TO: COM_HELP@EKOCONTRACT.COM

COM (YDS.)	8.75
COL (SQ. FT.)	158
WEIGHT (LBS.)	128
CUBIC FEET	97

W	86.5	COM (YDS.)	8.75
D	45.5	COL (SQ. FT.)	158
H	42.5	WEIGHT (LBS.)	128
SW	71.25-77.75	CUBIC FEET	97
SD	20		
SH	17.5		
BH	14.5		
AH	1.5-10.5		

powwow modular lounge

FREESTANDING TABLES



PRODUCT SPECIFICATIONS

IN THE PAST, COLLABORATION WAS STRUCTURED, PLANNED, AND RESERVED FOR FORMAL SETTINGS. TODAY, COLLABORATION IS SPONTANEOUS, IMPROMPTU, AND REQUIRES A SOLUTION THAT SUPPORTS A NEW DYNAMIC. AS A WELCOMING, FREESTANDING, "ARENA-LIKE" SETTING, POWWOW FITS IN OPEN-PLAN SPACES TO DEFINE A SPACE ALL ITS OWN. WITH A DESIGN THAT'S LIGHT IN SCALE YET INCREDIBLY DURABLE, POWWOW INTEGRATES SEATING, TABLES, AND TECHNOLOGY TO CREATE RICH, SOCIAL EXPERIENCES. WHETHER IT'S A FLUID INTERACTION, SPONTANEOUS CONVERSATION, OR PLANNED GATHERING, POWWOW'S READY FOR IT ALL.

POWWOW'S SUPERIOR CONSTRUCTION INCLUDES CNC CUT FURNITURE GRADE PLYWOOD FRAMES ASSEMBLED WITH PUZZLE FIT JOINERY FOR SUPERIOR STRENGTH. TEXTILES ARE HAND-TAILORED OVER 100% POLYURETHANE FOAM THAT MEETS CAL 117 STANDARDS. TOP STITCH NEEDLE SEWING TECHNIQUE WITH COLOR MATCHED THREAD ADDS EXTRA STRENGTH TO SEAMS AND STYLISH FLAIR. TWO TONE TEXTILE APPLICATIONS AVAILABLE ON ALL UNITS.

DESIGNED BY JESS SOREL.

METAL PAINT COLORS

PC1	MILK GLOSS
PC2	CHARCOAL GLOSS
PC3	OATMEAL GLOSS
PC4	SILVER
PC5	CHROME
PC6	RAVEN

WOOD FINISHES

TC	TOP COAT ONLY
10	NATURAL
11	MONTICELLO
12	HUNTINGTON
13	WILD CHERRY
14	VERSAILLES
16	CAFELLE
53	LIGHT MAPLE
31	CINNAMON CHERRY
24	IMPERIAL CHERRY
15	EMPIRE MAHOGANY
46	ROYAL MAHOGANY
69	BOURBON MAHOGANY
64	APPALACHIAN MAHOGANY
42	LIGHT WALNUT
38	HERITAGE WALNUT
20	TRADITIONAL WALNUT
57	EBONY WALNUT
72	BLACK (LOW SHEEN)

LAMINATE FINISHES

SEE PAGE 5 FOR LAMINATE FINISHES

MODEL	DESCRIPTION	PRICE	
		LAMINATE	VENEER

50046	SMALL WORK TABLE	750	850
-------	------------------	-----	-----



- WOOD OR LAMINATE
- METAL LEGS

50047	MEDIUM WORK TABLE	795	895
-------	-------------------	-----	-----



- WOOD OR LAMINATE
- METAL LEGS

50148	SMALL CLIQUE TABLE	1,230	1,430
-------	--------------------	-------	-------



- WOOD OR LAMINATE
- METAL LEGS

50048	SMALL CLIQUE TABLE/POWER	2,225	2,400
-------	--------------------------	-------	-------



- WOOD OR LAMINATE
- METAL LEGS
- STANDARD WITH POWER (SPECIFY GBK-GLOSS BLACK OR GWT-GLOSS WHITE)
- CONTAINS TWO POWER OUTLETS, TWO ACTIVE USB PORTS AND 120-INCH POWER CORD
- CYLINDER UNDER TABLE IS STANDARD IN LS7 GRAPHITE

POWWOW NOTES

1. SEATING MODELS FEATURE FIXED SEAT CUSHIONS.
2. WHEN SPECIFYING FABRIC IN DIFFERENT GRADES, THE HIGHEST PRICE GROUP PREVAILS.
3. THE COM YRDS. AND COL SQ. FT. LISTED REFLECT THE REQUIREMENTS FOR A SINGLE 54" FABRIC THAT IS NON-DIRECTIONAL AND APPLIED RAILROADED. FOR MULTI-FABRIC REQUIREMENTS PLEASE REFER TO THE POWWOW SECTION OF OUR WEBSITE FOR TWO-TONE UPHOLSTERY EXAMPLES, YARDAGE REQUIREMENTS AND PRICING.
4. VENEER INSET ARM PANELS, HANGOUT LEDGES, TABLES AND TABLETS ARE FLAT CUT WALNUT OR RIFF CUT WHITE OAK WOOD SPECIE AND FEATURE HORIZONTAL GRAIN DIRECTION. ALL EXPOSED RADIUS PLYWOOD EDGES WILL BE FINISHED TO MATCH SPECIFIED WOOD FINISH AS STANDARD. FOR CUSTOM WOOD FINISHES ADD \$300 ONE TIME CHARGE PER ORDER COLOR. VENEER HANGOUT LEDGES REQUIRE VENEER ON BOTH SIDES. THE EXPOSED RADIUS PLYWOOD EDGE WILL BE FINISHED TO MATCH SPECIFIED LEDGE WOOD FINISH AS STANDARD.
SPECIFY: (V2) FOR VENEER RIFT CUT OAK
(V3) FOR VENEER FLAT CUT WALNUT
5. LAMINATE HANGOUT LEDGES HAVE THE SAME LAMINATE ON BOTH SIDES. FOR DIFFERENT LAMINATES CONTACT CUSTOMER CARE FOR PRICING. WOOD GRAIN LAMINATES SPECIFIED WILL HAVE HORIZONTAL GRAIN PATTERN.
SPECIFY: (L) FOR STANDARD LAMINATE WITH MATCHING POLYMER EDGE
(L/EE) FOR LAMINATE WITH EXPOSED PLY EDGE FINISHED IN CLEAR COAT
6. LAMINATE TABLES AND TABLETS ARE STANDARD WITH MATCHING POLYMER EDGE. TABLES ARE ALSO AVAILABLE WITH EXPOSED RADIUS PLY EDGE. TABLETS MAY ALSO BE SPECIFIED WITH A REVERSE BEVEL EXPOSED EDGE.
SPECIFY: (L) FOR STANDARD LAMINATE WITH MATCHING POLYMER EDGE
(L/EE) FOR LAMINATE WITH EXPOSED PLY EDGE FINISHED IN CLEAR COAT
7. ARM INSET PANELS CANNOT BE RETROFIT TO PREVIOUSLY ORDERED UNITS.
8. HANGOUT LEDGE DIMENSIONS: OVERALL HEIGHT-42.5 INCHES, LEDGE HEIGHT-40 INCHES. LEDGES REQUIRE FIELD INSTALLATION.

DIMENSIONS

FIGURES

YARDAGE REQUIREMENTS SHOWN ARE BASED ON NON-DIRECTIONAL 54" TEXTILES. REFER TO PAGE 3 FOR HELP WITH TEXTILES WITH REPEATS OR SEND AN EMAIL TO: COM_HELP@EKOCONTRACT.COM

W 16
D 16
H 25.5

WEIGHT (LBS.) 18
CUBIC FEET 4

W 20
D 20
H 25.5

WEIGHT (LBS.) 20
CUBIC FEET 6

W 36
D 36
H 18

WEIGHT (LBS.) 25
CUBIC FEET 14

W 36
D 36
H 18

WEIGHT (LBS.) 35
CUBIC FEET 14

powwow modular lounge

FREESTANDING TABLES



PRODUCT SPECIFICATIONS

IN THE PAST, COLLABORATION WAS STRUCTURED, PLANNED, AND RESERVED FOR FORMAL SETTINGS. TODAY, COLLABORATION IS SPONTANEOUS, IMPROMPTU, AND REQUIRES A SOLUTION THAT SUPPORTS A NEW DYNAMIC. AS A WELCOMING, FREESTANDING, "ARENA-LIKE" SETTING, POWWOW FITS IN OPEN-PLAN SPACES TO DEFINE A SPACE ALL ITS OWN. WITH A DESIGN THAT'S LIGHT IN SCALE YET INCREDIBLY DURABLE, POWWOW INTEGRATES SEATING, TABLES, AND TECHNOLOGY TO CREATE RICH, SOCIAL EXPERIENCES. WHETHER IT'S A FLUID INTERACTION, SPONTANEOUS CONVERSATION, OR PLANNED GATHERING, POWWOW'S READY FOR IT ALL.

POWWOW'S SUPERIOR CONSTRUCTION INCLUDES CNC CUT FURNITURE GRADE PLYWOOD FRAMES ASSEMBLED WITH PUZZLE FIT JOINERY FOR SUPERIOR STRENGTH. TEXTILES ARE HAND-TAILORED OVER 100% POLYURETHANE FOAM THAT MEETS CAL 117 STANDARDS. TOP STITCH NEEDLE SEWING TECHNIQUE WITH COLOR MATCHED THREAD ADDS EXTRA STRENGTH TO SEAMS AND STYLISH FLAIR. TWO TONE TEXTILE APPLICATIONS AVAILABLE ON ALL UNITS.

DESIGNED BY JESS SOREL.

METAL PAINT COLORS

PC1	MILK GLOSS
PC2	CHARCOAL GLOSS
PC3	OATMEAL GLOSS
PC4	SILVER
PC5	CHROME
PC6	RAVEN

WOOD FINISHES

TC	TOP COAT ONLY
10	NATURAL
11	MONTICELLO
12	HUNTINGTON
13	WILD CHERRY
14	VERSAILLES
16	CAFELLE
53	LIGHT MAPLE
31	CINNAMON CHERRY
24	IMPERIAL CHERRY
15	EMPIRE MAHOGANY
46	ROYAL MAHOGANY
69	BOURBON MAHOGANY
64	APPALACHIAN MAHOGANY
42	LIGHT WALNUT
38	HERITAGE WALNUT
20	TRADITIONAL WALNUT
57	EBONY WALNUT
72	BLACK (LOW SHEEN)

LAMINATE FINISHES

SEE PAGE 5 FOR LAMINATE FINISHES

MODEL	DESCRIPTION	PRICE	
		LAMINATE	VENEER

50149	MEDIUM CLIQUE TABLE	1,330	1,530
--------------	---------------------	-------	-------

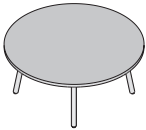

- WOOD OR LAMINATE
- METAL LEGS

50049	MEDIUM CLIQUE TABLE/POWER	2,325	2,500
--------------	---------------------------	-------	-------



- WOOD OR LAMINATE
- METAL LEGS
- STANDARD WITH POWER (SPECIFY **GBK**-GLOSS BLACK OR **GWT**-GLOSS WHITE)
- CONTAINS TWO POWER OUTLETS, TWO ACTIVE USB PORTS AND 120-INCH POWER CORD
- CYLINDER UNDER TABLE IS STANDARD IN LS7 GRAPHITE

50150	LARGE CLIQUE TABLE	1,430	1,630
--------------	--------------------	-------	-------

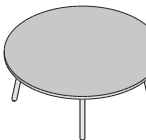

- WOOD OR LAMINATE
- METAL LEGS

50050	LARGE CLIQUE TABLE/POWER	2,425	2,600
--------------	--------------------------	-------	-------

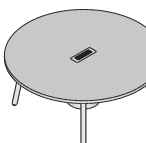

- WOOD OR LAMINATE
- METAL LEGS
- STANDARD WITH POWER (SPECIFY **GBK**-GLOSS BLACK OR **GWT**-GLOSS WHITE)
- CONTAINS TWO POWER OUTLETS, TWO ACTIVE USB PORTS AND 120-INCH POWER CORD
- CYLINDER UNDER TABLE IS STANDARD IN LS7 GRAPHITE

POWWOW NOTES

1. SEATING MODELS FEATURE FIXED SEAT CUSHIONS.
2. WHEN SPECIFYING FABRIC IN DIFFERENT GRADES, THE HIGHEST PRICE GROUP PREVAILS.
3. THE COM YRDS. AND COL SQ. FT. LISTED REFLECT THE REQUIREMENTS FOR A SINGLE 54" FABRIC THAT IS NON-DIRECTIONAL AND APPLIED RAILROADED. FOR MULTI-FABRIC REQUIREMENTS PLEASE REFER TO THE POWWOW SECTION OF OUR WEBSITE FOR TWO-TONE UPHOLSTERY EXAMPLES, YARDAGE REQUIREMENTS AND PRICING.
4. VENEER INSET ARM PANELS, HANGOUT LEDGES, TABLES AND TABLETS ARE FLAT CUT WALNUT OR RIFF CUT WHITE OAK WOOD SPECIE AND FEATURE HORIZONTAL GRAIN DIRECTION. ALL EXPOSED RADIUS PLYWOOD EDGES WILL BE FINISHED TO MATCH SPECIFIED WOOD FINISH AS STANDARD. FOR CUSTOM WOOD FINISHES ADD \$300 ONE TIME CHARGE PER ORDER COLOR. VENEER HANGOUT LEDGES REQUIRE VENEER ON BOTH SIDES. THE EXPOSED RADIUS PLYWOOD EDGE WILL BE FINISHED TO MATCH SPECIFIED LEDGE WOOD FINISH AS STANDARD.
SPECIFY: (V2) FOR VENEER RIFT CUT OAK
(V3) FOR VENEER FLAT CUT WALNUT
5. LAMINATE HANGOUT LEDGES HAVE THE SAME LAMINATE ON BOTH SIDES. FOR DIFFERENT LAMINATES CONTACT CUSTOMER CARE FOR PRICING. WOOD GRAIN LAMINATES SPECIFIED WILL HAVE HORIZONTAL GRAIN PATTERN.
SPECIFY: (L) FOR STANDARD LAMINATE WITH MATCHING POLYMER EDGE
(L/EE) FOR LAMINATE WITH EXPOSED PLY EDGE FINISHED IN CLEAR COAT
6. LAMINATE TABLES AND TABLETS ARE STANDARD WITH MATCHING POLYMER EDGE. TABLES ARE ALSO AVAILABLE WITH EXPOSED RADIUS PLY EDGE. TABLETS MAY ALSO BE SPECIFIED WITH A REVERSE BEVEL EXPOSED EDGE.
SPECIFY: (L) FOR STANDARD LAMINATE WITH MATCHING POLYMER EDGE
(L/EE) FOR LAMINATE WITH EXPOSED PLY EDGE FINISHED IN CLEAR COAT
7. ARM INSET PANELS CANNOT BE RETROFIT TO PREVIOUSLY ORDERED UNITS.
8. HANGOUT LEDGE DIMENSIONS: OVERALL HEIGHT-42.5 INCHES, LEDGE HEIGHT-40 INCHES. LEDGES REQUIRE FIELD INSTALLATION.

DIMENSIONS

FIGURES

YARDAGE REQUIREMENTS SHOWN ARE BASED ON NON-DIRECTIONAL 54" TEXTILES. REFER TO PAGE 3 FOR HELP WITH TEXTILES WITH REPEATS OR SEND AN EMAIL TO: COM_HELP@EKOCONTRACT.COM

W 42
D 42
H 18

WEIGHT (LBS.) 32
CUBIC FEET 18

W 42
D 42
H 18

WEIGHT (LBS.) 42
CUBIC FEET 18

W 47
D 47
H 18

WEIGHT (LBS.) 34
CUBIC FEET 23

W 47
D 47
H 18

WEIGHT (LBS.) 44
CUBIC FEET 23

powwow modular lounge

FREESTANDING TABLES



PRODUCT SPECIFICATIONS

IN THE PAST, COLLABORATION WAS STRUCTURED, PLANNED, AND RESERVED FOR FORMAL SETTINGS. TODAY, COLLABORATION IS SPONTANEOUS, IMPROMPTU, AND REQUIRES A SOLUTION THAT SUPPORTS A NEW DYNAMIC. AS A WELCOMING, FREESTANDING, "ARENA-LIKE" SETTING, POWWOW FITS IN OPEN-PLAN SPACES TO DEFINE A SPACE ALL ITS OWN. WITH A DESIGN THAT'S LIGHT IN SCALE YET INCREDIBLY DURABLE, POWWOW INTEGRATES SEATING, TABLES, AND TECHNOLOGY TO CREATE RICH, SOCIAL EXPERIENCES. WHETHER IT'S A FLUID INTERACTION, SPONTANEOUS CONVERSATION, OR PLANNED GATHERING, POWWOW'S READY FOR IT ALL.

POWWOW'S SUPERIOR CONSTRUCTION INCLUDES CNC CUT FURNITURE GRADE PLYWOOD FRAMES ASSEMBLED WITH PUZZLE FIT JOINERY FOR SUPERIOR STRENGTH. TEXTILES ARE HAND-TAILORED OVER 100% POLYURETHANE FOAM THAT MEETS CAL 117 STANDARDS. TOP STITCH NEEDLE SEWING TECHNIQUE WITH COLOR MATCHED THREAD ADDS EXTRA STRENGTH TO SEAMS AND STYLISH FLAIR. TWO TONE TEXTILE APPLICATIONS AVAILABLE ON ALL UNITS.

DESIGNED BY JESS SOREL.

METAL PAINT COLORS

PC1	MILK GLOSS
PC2	CHARCOAL GLOSS
PC3	OATMEAL GLOSS
PC4	SILVER
PC5	CHROME
PC6	RAVEN

WOOD FINISHES

TC	TOP COAT ONLY
10	NATURAL
11	MONTICELLO
12	HUNTINGTON
13	WILD CHERRY
14	VERSAILLES
16	CAFELLE
53	LIGHT MAPLE
31	CINNAMON CHERRY
24	IMPERIAL CHERRY
15	EMPIRE MAHOGANY
46	ROYAL MAHOGANY
69	BOURBON MAHOGANY
64	APPALACHIAN MAHOGANY
42	LIGHT WALNUT
38	HERITAGE WALNUT
20	TRADITIONAL WALNUT
57	EBONY WALNUT
72	BLACK (LOW SHEEN)

LAMINATE FINISHES

SEE PAGE 5 FOR LAMINATE FINISHES

MODEL	DESCRIPTION	PRICE	
		LAMINATE	VENEER

S01S1	MINI COFFEE TABLE	1,090	1,175
--------------	-------------------	-------	-------

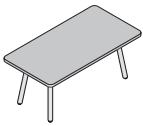

- WOOD OR LAMINATE
- METAL LEGS

S00S1	MINI COFFEE TABLE/POWER	2,085	2,175
--------------	-------------------------	-------	-------

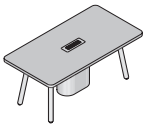

- WOOD OR LAMINATE
- METAL LEGS
- STANDARD WITH POWER (SPECIFY **GBK**-GLOSS BLACK OR **GWT**-GLOSS WHITE)
- CONTAINS TWO POWER OUTLETS, TWO ACTIVE USB PORTS AND 120-INCH POWER CORD
- CYLINDER UNDER TABLE IS STANDARD IN LS7 GRAPHITE

S01S2	SMALL COFFEE TABLE	1,230	1,430
--------------	--------------------	-------	-------

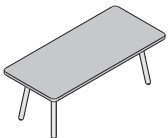

- WOOD OR LAMINATE
- METAL LEGS

S00S2	SMALL COFFEE TABLE/POWER	2,225	2,400
--------------	--------------------------	-------	-------

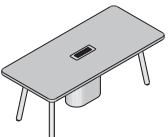

- WOOD OR LAMINATE
- METAL LEGS
- STANDARD WITH POWER (SPECIFY **GBK**-GLOSS BLACK OR **GWT**-GLOSS WHITE)
- CONTAINS TWO POWER OUTLETS, TWO ACTIVE USB PORTS AND 120-INCH POWER CORD
- CYLINDER UNDER TABLE IS STANDARD IN LS7 GRAPHITE

POWWOW NOTES

1. SEATING MODELS FEATURE FIXED SEAT CUSHIONS.
2. WHEN SPECIFYING FABRIC IN DIFFERENT GRADES, THE HIGHEST PRICE GROUP PREVAILS.
3. THE COM YRDS. AND COL SQ. FT. LISTED REFLECT THE REQUIREMENTS FOR A SINGLE 54" FABRIC THAT IS NON-DIRECTIONAL AND APPLIED RAILROADED. FOR MULTI-FABRIC REQUIREMENTS PLEASE REFER TO THE POWWOW SECTION OF OUR WEBSITE FOR TWO-TONE UPHOLSTERY EXAMPLES, YARDAGE REQUIREMENTS AND PRICING.
4. VENEER INSET ARM PANELS, HANGOUT LEDGES, TABLES AND TABLETS ARE FLAT CUT WALNUT OR RIFF CUT WHITE OAK WOOD SPECIE AND FEATURE HORIZONTAL GRAIN DIRECTION. ALL EXPOSED RADIUS PLYWOOD EDGES WILL BE FINISHED TO MATCH SPECIFIED WOOD FINISH AS STANDARD. FOR CUSTOM WOOD FINISHES ADD \$300 ONE TIME CHARGE PER ORDER COLOR. VENEER HANGOUT LEDGES REQUIRE VENEER ON BOTH SIDES. THE EXPOSED RADIUS PLYWOOD EDGE WILL BE FINISHED TO MATCH SPECIFIED LEDGE WOOD FINISH AS STANDARD.
SPECIFY: (V2) FOR VENEER RIFT CUT OAK
(V3) FOR VENEER FLAT CUT WALNUT
5. LAMINATE HANGOUT LEDGES HAVE THE SAME LAMINATE ON BOTH SIDES. FOR DIFFERENT LAMINATES CONTACT CUSTOMER CARE FOR PRICING. WOOD GRAIN LAMINATES SPECIFIED WILL HAVE HORIZONTAL GRAIN PATTERN.
SPECIFY: (L) FOR STANDARD LAMINATE WITH MATCHING POLYMER EDGE
(L/EE) FOR LAMINATE WITH EXPOSED PLY EDGE FINISHED IN CLEAR COAT
6. LAMINATE TABLES AND TABLETS ARE STANDARD WITH MATCHING POLYMER EDGE. TABLES ARE ALSO AVAILABLE WITH EXPOSED RADIUS PLY EDGE. TABLETS MAY ALSO BE SPECIFIED WITH A REVERSE BEVEL EXPOSED EDGE.
SPECIFY: (L) FOR STANDARD LAMINATE WITH MATCHING POLYMER EDGE
(L/EE) FOR LAMINATE WITH EXPOSED PLY EDGE FINISHED IN CLEAR COAT
7. ARM INSET PANELS CANNOT BE RETROFIT TO PREVIOUSLY ORDERED UNITS.
8. HANGOUT LEDGE DIMENSIONS: OVERALL HEIGHT-42.5 INCHES, LEDGE HEIGHT-40 INCHES. LEDGES REQUIRE FIELD INSTALLATION.

DIMENSIONS

FIGURES

YARDAGE REQUIREMENTS SHOWN ARE BASED ON NON-DIRECTIONAL 54" TEXTILES. REFER TO PAGE 3 FOR HELP WITH TEXTILES WITH REPEATS OR SEND AN EMAIL TO: COM_HELP@EKOCONTRACT.COM

W 42
D 22
H 18

WEIGHT (LBS.) 30
CUBIC FEET 10

W 42
D 22
H 18

WEIGHT (LBS.) 40
CUBIC FEET 10

W 48
D 22
H 18

WEIGHT (LBS.) 32
CUBIC FEET 11

W 48
D 22
H 18

WEIGHT (LBS.) 32
CUBIC FEET 11

powwow modular lounge

FREESTANDING TABLES



PRODUCT SPECIFICATIONS

IN THE PAST, COLLABORATION WAS STRUCTURED, PLANNED, AND RESERVED FOR FORMAL SETTINGS. TODAY, COLLABORATION IS SPONTANEOUS, IMPROMPTU, AND REQUIRES A SOLUTION THAT SUPPORTS A NEW DYNAMIC. AS A WELCOMING, FREESTANDING, "ARENA-LIKE" SETTING, POWWOW FITS IN OPEN-PLAN SPACES TO DEFINE A SPACE ALL ITS OWN. WITH A DESIGN THAT'S LIGHT IN SCALE YET INCREDIBLY DURABLE, POWWOW INTEGRATES SEATING, TABLES, AND TECHNOLOGY TO CREATE RICH, SOCIAL EXPERIENCES. WHETHER IT'S A FLUID INTERACTION, SPONTANEOUS CONVERSATION, OR PLANNED GATHERING, POWWOW'S READY FOR IT ALL.

POWWOW'S SUPERIOR CONSTRUCTION INCLUDES CNC CUT FURNITURE GRADE PLYWOOD FRAMES ASSEMBLED WITH PUZZLE FIT JOINERY FOR SUPERIOR STRENGTH. TEXTILES ARE HAND-TAILORED OVER 100% POLYURETHANE FOAM THAT MEETS CAL 117 STANDARDS. TOP STITCH NEEDLE SEWING TECHNIQUE WITH COLOR MATCHED THREAD ADDS EXTRA STRENGTH TO SEAMS AND STYLISH FLAIR. TWO TONE TEXTILE APPLICATIONS AVAILABLE ON ALL UNITS.

DESIGNED BY JESS SOREL.

METAL PAINT COLORS

PC1	MILK GLOSS
PC2	CHARCOAL GLOSS
PC3	OATMEAL GLOSS
PC4	SILVER
PC5	CHROME
PC6	RAVEN

WOOD FINISHES

TC	TOP COAT ONLY
10	NATURAL
11	MONTICELLO
12	HUNTINGTON
13	WILD CHERRY
14	VERSAILLES
16	CAFELLE
53	LIGHT MAPLE
31	CINNAMON CHERRY
24	IMPERIAL CHERRY
15	EMPIRE MAHOGANY
46	ROYAL MAHOGANY
69	BOURBON MAHOGANY
64	APPALACHIAN MAHOGANY
42	LIGHT WALNUT
38	HERITAGE WALNUT
20	TRADITIONAL WALNUT
57	EBONY WALNUT
72	BLACK (LOW SHEEN)

LAMINATE FINISHES

SEE PAGE 5 FOR LAMINATE FINISHES

MODEL	DESCRIPTION	PRICE	
		LAMINATE	VENEER

50153	MEDIUM COFFEE TABLE	1,330	1,530
--------------	---------------------	-------	-------

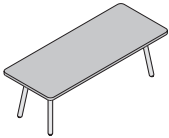

- WOOD OR LAMINATE
- METAL LEGS

50053	MEDIUM COFFEE TABLE/POWER	2,325	2,500
--------------	---------------------------	-------	-------

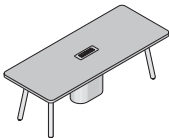

- WOOD OR LAMINATE
- METAL LEGS
- STANDARD WITH POWER (SPECIFY **GBK**-GLOSS BLACK OR **GWT**-GLOSS WHITE)
- CONTAINS TWO POWER OUTLETS, TWO ACTIVE USB PORTS AND 120-INCH POWER CORD
- CYLINDER UNDER TABLE IS STANDARD IN LS7 GRAPHITE

50154	LARGE COFFEE TABLE	1,430	1,630
--------------	--------------------	-------	-------

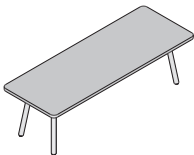

- WOOD OR LAMINATE
- METAL LEGS

50054	LARGE COFFEE TABLE/POWER	2,425	2,600
--------------	--------------------------	-------	-------

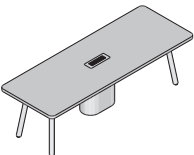

- WOOD OR LAMINATE
- METAL LEGS
- STANDARD WITH POWER (SPECIFY **GBK**-GLOSS BLACK OR **GWT**-GLOSS WHITE)
- CONTAINS TWO POWER OUTLETS, TWO ACTIVE USB PORTS AND 120-INCH POWER CORD
- CYLINDER UNDER TABLE IS STANDARD IN LS7 GRAPHITE

POWWOW NOTES

1. SEATING MODELS FEATURE FIXED SEAT CUSHIONS.
2. WHEN SPECIFYING FABRIC IN DIFFERENT GRADES, THE HIGHEST PRICE GROUP PREVAILS.
3. THE COM YRDS. AND COL SQ. FT. LISTED REFLECT THE REQUIREMENTS FOR A SINGLE 54" FABRIC THAT IS NON-DIRECTIONAL AND APPLIED RAILROADED. FOR MULTI-FABRIC REQUIREMENTS PLEASE REFER TO THE POWWOW SECTION OF OUR WEBSITE FOR TWO-TONE UPHOLSTERY EXAMPLES, YARDAGE REQUIREMENTS AND PRICING.
4. VENEER INSET ARM PANELS, HANGOUT LEDGES, TABLES AND TABLETS ARE FLAT CUT WALNUT OR RIFF CUT WHITE OAK WOOD SPECIE AND FEATURE HORIZONTAL GRAIN DIRECTION. ALL EXPOSED RADIUS PLYWOOD EDGES WILL BE FINISHED TO MATCH SPECIFIED WOOD FINISH AS STANDARD. FOR CUSTOM WOOD FINISHES ADD \$300 ONE TIME CHARGE PER ORDER COLOR. VENEER HANGOUT LEDGES REQUIRE VENEER ON BOTH SIDES. THE EXPOSED RADIUS PLYWOOD EDGE WILL BE FINISHED TO MATCH SPECIFIED LEDGE WOOD FINISH AS STANDARD.
SPECIFY: (V2) FOR VENEER RIFT CUT OAK
(V3) FOR VENEER FLAT CUT WALNUT
5. LAMINATE HANGOUT LEDGES HAVE THE SAME LAMINATE ON BOTH SIDES. FOR DIFFERENT LAMINATES CONTACT CUSTOMER CARE FOR PRICING. WOOD GRAIN LAMINATES SPECIFIED WILL HAVE HORIZONTAL GRAIN PATTERN.
SPECIFY: (L) FOR STANDARD LAMINATE WITH MATCHING POLYMER EDGE
(L/EE) FOR LAMINATE WITH EXPOSED PLY EDGE FINISHED IN CLEAR COAT
6. LAMINATE TABLES AND TABLETS ARE STANDARD WITH MATCHING POLYMER EDGE. TABLES ARE ALSO AVAILABLE WITH EXPOSED RADIUS PLY EDGE. TABLETS MAY ALSO BE SPECIFIED WITH A REVERSE BEVEL EXPOSED EDGE.
SPECIFY: (L) FOR STANDARD LAMINATE WITH MATCHING POLYMER EDGE
(L/EE) FOR LAMINATE WITH EXPOSED PLY EDGE FINISHED IN CLEAR COAT
7. ARM INSET PANELS CANNOT BE RETROFIT TO PREVIOUSLY ORDERED UNITS.
8. HANGOUT LEDGE DIMENSIONS: OVERALL HEIGHT-42.5 INCHES, LEDGE HEIGHT-40 INCHES. LEDGES REQUIRE FIELD INSTALLATION.

DIMENSIONS

FIGURES

YARDAGE REQUIREMENTS SHOWN ARE BASED ON NON-DIRECTIONAL 54" TEXTILES. REFER TO PAGE 3 FOR HELP WITH TEXTILES WITH REPEATS OR SEND AN EMAIL TO: COM_HELP@EKOCONTRACT.COM

W 54
D 22
H 18

WEIGHT (LBS.) 34
CUBIC FEET 12

W 54
D 22
H 18

WEIGHT (LBS.) 34
CUBIC FEET 12

W 60
D 22
H 18

WEIGHT (LBS.) 38
CUBIC FEET 14

W 60
D 22
H 18

WEIGHT (LBS.) 38
CUBIC FEET 14

powwow modular lounge

FREESTANDING TABLES



PRODUCT SPECIFICATIONS

IN THE PAST, COLLABORATION WAS STRUCTURED, PLANNED, AND RESERVED FOR FORMAL SETTINGS. TODAY, COLLABORATION IS SPONTANEOUS, IMPROMPTU, AND REQUIRES A SOLUTION THAT SUPPORTS A NEW DYNAMIC. AS A WELCOMING, FREESTANDING, "ARENA-LIKE" SETTING, POWWOW FITS IN OPEN-PLAN SPACES TO DEFINE A SPACE ALL ITS OWN. WITH A DESIGN THAT'S LIGHT IN SCALE YET INCREDIBLY DURABLE, POWWOW INTEGRATES SEATING, TABLES, AND TECHNOLOGY TO CREATE RICH, SOCIAL EXPERIENCES. WHETHER IT'S A FLUID INTERACTION, SPONTANEOUS CONVERSATION, OR PLANNED GATHERING, POWWOW'S READY FOR IT ALL.

POWWOW'S SUPERIOR CONSTRUCTION INCLUDES CNC CUT FURNITURE GRADE PLYWOOD FRAMES ASSEMBLED WITH PUZZLE FIT JOINERY FOR SUPERIOR STRENGTH. TEXTILES ARE HAND-TAILORED OVER 100% POLYURETHANE FOAM THAT MEETS CAL 117 STANDARDS. TOP STITCH NEEDLE SEWING TECHNIQUE WITH COLOR MATCHED THREAD ADDS EXTRA STRENGTH TO SEAMS AND STYLISH FLAIR. TWO TONE TEXTILE APPLICATIONS AVAILABLE ON ALL UNITS.

DESIGNED BY JESS SOREL.

METAL PAINT COLORS

PC1	MILK GLOSS
PC2	CHARCOAL GLOSS
PC3	OATMEAL GLOSS
PC4	SILVER
PC5	CHROME
PC6	RAVEN

WOOD FINISHES

TC	TOP COAT ONLY
10	NATURAL
11	MONTICELLO
12	HUNTINGTON
13	WILD CHERRY
14	VERSAILLES
16	CAFELLE
53	LIGHT MAPLE
31	CINNAMON CHERRY
24	IMPERIAL CHERRY
15	EMPIRE MAHOGANY
46	ROYAL MAHOGANY
69	BOURBON MAHOGANY
64	APPALACHIAN MAHOGANY
42	LIGHT WALNUT
38	HERITAGE WALNUT
20	TRADITIONAL WALNUT
57	EBONY WALNUT
72	BLACK (LOW SHEEN)

LAMINATE FINISHES

SEE PAGE 5 FOR LAMINATE FINISHES

MODEL	DESCRIPTION	PRICE	
		LAMINATE	VENEER

S0144	ANGLED TABLE	675	750
--------------	---------------------	-----	-----



- FREESTANDING
- WOOD OR LAMINATE
- METAL LEGS

S0044	ANGLED TABLE/POWER	1,575	1,650
--------------	---------------------------	-------	-------



- FREESTANDING
- WOOD OR LAMINATE
- METAL LEGS
- STANDARD WITH POWER (SPECIFY **GBK**-GLOSS BLACK OR **GWT**-GLOSS WHITE)
- CONTAINS TWO POWER OUTLETS, TWO ACTIVE USB PORTS AND 120-INCH POWER CORD
- CYLINDER UNDER TABLE IS STANDARD IN LS7 GRAPHITE

S0145	CORNER TABLE	775	850
--------------	---------------------	-----	-----

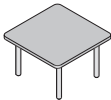

- FREESTANDING
- WOOD OR LAMINATE
- METAL LEGS

S0045	CORNER TABLE/POWER	1,675	1,750
--------------	---------------------------	-------	-------

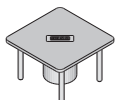

- FREESTANDING
- WOOD OR LAMINATE
- METAL LEGS
- STANDARD WITH POWER (SPECIFY **GBK**-GLOSS BLACK OR **GWT**-GLOSS WHITE)
- CONTAINS TWO POWER OUTLETS, TWO ACTIVE USB PORTS AND 120-INCH POWER CORD
- CYLINDER UNDER TABLE IS STANDARD IN LS7 GRAPHITE

POWWOW NOTES

1. SEATING MODELS FEATURE FIXED SEAT CUSHIONS.
2. WHEN SPECIFYING FABRIC IN DIFFERENT GRADES, THE HIGHEST PRICE GROUP PREVAILS.
3. THE COM YRDS. AND COL SQ. FT. LISTED REFLECT THE REQUIREMENTS FOR A SINGLE 54" FABRIC THAT IS NON-DIRECTIONAL AND APPLIED RAILROADED. FOR MULTI-FABRIC REQUIREMENTS PLEASE REFER TO THE POWWOW SECTION OF OUR WEBSITE FOR TWO-TONE UPHOLSTERY EXAMPLES, YARDAGE REQUIREMENTS AND PRICING.
4. VENEER INSET ARM PANELS, HANGOUT LEDGES, TABLES AND TABLETS ARE FLAT CUT WALNUT OR RIFF CUT WHITE OAK WOOD SPECIE AND FEATURE HORIZONTAL GRAIN DIRECTION. ALL EXPOSED RADIUS PLYWOOD EDGES WILL BE FINISHED TO MATCH SPECIFIED WOOD FINISH AS STANDARD. FOR CUSTOM WOOD FINISHES ADD \$300 ONE TIME CHARGE PER ORDER COLOR. VENEER HANGOUT LEDGES REQUIRE VENEER ON BOTH SIDES. THE EXPOSED RADIUS PLYWOOD EDGE WILL BE FINISHED TO MATCH SPECIFIED LEDGE WOOD FINISH AS STANDARD.
SPECIFY: (V2) FOR VENEER RIFT CUT OAK
(V3) FOR VENEER FLAT CUT WALNUT
5. LAMINATE HANGOUT LEDGES HAVE THE SAME LAMINATE ON BOTH SIDES. FOR DIFFERENT LAMINATES CONTACT CUSTOMER CARE FOR PRICING. WOOD GRAIN LAMINATES SPECIFIED WILL HAVE HORIZONTAL GRAIN PATTERN.
SPECIFY: (L) FOR STANDARD LAMINATE WITH MATCHING POLYMER EDGE
(L/EE) FOR LAMINATE WITH EXPOSED PLY EDGE FINISHED IN CLEAR COAT
6. LAMINATE TABLES AND TABLETS ARE STANDARD WITH MATCHING POLYMER EDGE. TABLES ARE ALSO AVAILABLE WITH EXPOSED RADIUS PLY EDGE. TABLETS MAY ALSO BE SPECIFIED WITH A REVERSE BEVEL EXPOSED EDGE.
SPECIFY: (L) FOR STANDARD LAMINATE WITH MATCHING POLYMER EDGE
(L/EE) FOR LAMINATE WITH EXPOSED PLY EDGE FINISHED IN CLEAR COAT
7. ARM INSET PANELS CANNOT BE RETROFIT TO PREVIOUSLY ORDERED UNITS.
8. HANGOUT LEDGE DIMENSIONS: OVERALL HEIGHT-42.5 INCHES, LEDGE HEIGHT-40 INCHES. LEDGES REQUIRE FIELD INSTALLATION.

DIMENSIONS

FIGURES

YARDAGE REQUIREMENTS SHOWN ARE BASED ON NON-DIRECTIONAL 54" TEXTILES. REFER TO PAGE 3 FOR HELP WITH TEXTILES WITH REPEATS OR SEND AN EMAIL TO: COM_HELP@EKOCONTRACT.COM

W 29.4
D 27
H 15

WEIGHT (LBS.) 15
CUBIC FEET 7

W 29.4
D 27
H 15

WEIGHT (LBS.) 15
CUBIC FEET 7

W 29
D 29
H 15

WEIGHT (LBS.) 18
CUBIC FEET 7

W 29
D 29
H 15

WEIGHT (LBS.) 18
CUBIC FEET 7

powwow modular lounge

CONNECTING TABLES



PRODUCT SPECIFICATIONS

IN THE PAST, COLLABORATION WAS STRUCTURED, PLANNED, AND RESERVED FOR FORMAL SETTINGS. TODAY, COLLABORATION IS SPONTANEOUS, IMPROMPTU, AND REQUIRES A SOLUTION THAT SUPPORTS A NEW DYNAMIC. AS A WELCOMING, FREESTANDING, "ARENA-LIKE" SETTING, POWWOW FITS IN OPEN-PLAN SPACES TO DEFINE A SPACE ALL ITS OWN. WITH A DESIGN THAT'S LIGHT IN SCALE YET INCREDIBLY DURABLE, POWWOW INTEGRATES SEATING, TABLES, AND TECHNOLOGY TO CREATE RICH, SOCIAL EXPERIENCES. WHETHER IT'S A FLUID INTERACTION, SPONTANEOUS CONVERSATION, OR PLANNED GATHERING, POWWOW'S READY FOR IT ALL.

POWWOW'S SUPERIOR CONSTRUCTION INCLUDES CNC CUT FURNITURE GRADE PLYWOOD FRAMES ASSEMBLED WITH PUZZLE FIT JOINERY FOR SUPERIOR STRENGTH. TEXTILES ARE HAND-TAILORED OVER 100% POLYURETHANE FOAM THAT MEETS CAL 117 STANDARDS. TOP STITCH NEEDLE SEWING TECHNIQUE WITH COLOR MATCHED THREAD ADDS EXTRA STRENGTH TO SEAMS AND STYLISH FLAIR. TWO TONE TEXTILE APPLICATIONS AVAILABLE ON ALL UNITS.

DESIGNED BY JESS SOREL.

METAL PAINT COLORS

PC1	MILK GLOSS
PC2	CHARCOAL GLOSS
PC3	OATMEAL GLOSS
PC4	SILVER
PC5	CHROME
PC6	RAVEN

WOOD FINISHES

TC	TOP COAT ONLY
10	NATURAL
11	MONTICELLO
12	HUNTINGTON
13	WILD CHERRY
14	VERSAILLES
16	CAFELLE
53	LIGHT MAPLE
31	CINNAMON CHERRY
24	IMPERIAL CHERRY
15	EMPIRE MAHOGANY
46	ROYAL MAHOGANY
69	BOURBON MAHOGANY
64	APPALACHIAN MAHOGANY
42	LIGHT WALNUT
38	HERITAGE WALNUT
20	TRADITIONAL WALNUT
57	EBONY WALNUT
72	BLACK (LOW SHEEN)

LAMINATE FINISHES

SEE PAGE 5 FOR LAMINATE FINISHES

MODEL	DESCRIPTION	PRICE	
		LAMINATE	VENEER

S1144	ANGLED CONNECTING TABLE	415	475
--------------	-------------------------	-----	-----

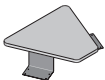

- WOOD OR LAMINATE
- METAL LEGS

S1044	ANGLED CONNECTING TABLE/POWER	1,315	1,375
--------------	-------------------------------	-------	-------



- WOOD OR LAMINATE
- METAL LEGS
- STANDARD WITH POWER (SPECIFY **GBK**-GLOSS BLACK OR **GWT**-GLOSS WHITE)
- CONTAINS TWO POWER OUTLETS, TWO ACTIVE USB PORTS AND 120-INCH POWER CORD
- CYLINDER UNDER TABLE IS STANDARD IN LS7 GRAPHITE

S1145	CORNER CONNECTING TABLE	515	575
--------------	-------------------------	-----	-----

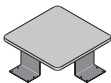

- WOOD OR LAMINATE
- METAL LEGS

S1045	CORNER CONNECTING TABLE/POWER	1,415	1,475
--------------	-------------------------------	-------	-------



- WOOD OR LAMINATE
- METAL LEGS
- STANDARD WITH POWER (SPECIFY **GBK**-GLOSS BLACK OR **GWT**-GLOSS WHITE)
- CONTAINS TWO POWER OUTLETS, TWO ACTIVE USB PORTS AND 120-INCH POWER CORD
- CYLINDER UNDER TABLE IS STANDARD IN LS7 GRAPHITE

POWWOW NOTES

1. SEATING MODELS FEATURE FIXED SEAT CUSHIONS.
2. WHEN SPECIFYING FABRIC IN DIFFERENT GRADES, THE HIGHEST PRICE GROUP PREVAILS.
3. THE COM YRDS. AND COL SQ. FT. LISTED REFLECT THE REQUIREMENTS FOR A SINGLE 54" FABRIC THAT IS NON-DIRECTIONAL AND APPLIED RAILROADED. FOR MULTI-FABRIC REQUIREMENTS PLEASE REFER TO THE POWWOW SECTION OF OUR WEBSITE FOR TWO-TONE UPHOLSTERY EXAMPLES, YARDAGE REQUIREMENTS AND PRICING.
4. VENEER INSET ARM PANELS, HANGOUT LEDGES, TABLES AND TABLETS ARE FLAT CUT WALNUT OR RIFF CUT WHITE OAK WOOD SPECIE AND FEATURE HORIZONTAL GRAIN DIRECTION. ALL EXPOSED RADIUS PLYWOOD EDGES WILL BE FINISHED TO MATCH SPECIFIED WOOD FINISH AS STANDARD. FOR CUSTOM WOOD FINISHES ADD \$300 ONE TIME CHARGE PER ORDER COLOR. VENEER HANGOUT LEDGES REQUIRE VENEER ON BOTH SIDES. THE EXPOSED RADIUS PLYWOOD EDGE WILL BE FINISHED TO MATCH SPECIFIED LEDGE WOOD FINISH AS STANDARD.
SPECIFY: (V2) FOR VENEER RIFT CUT OAK
(V3) FOR VENEER FLAT CUT WALNUT
5. LAMINATE HANGOUT LEDGES HAVE THE SAME LAMINATE ON BOTH SIDES. FOR DIFFERENT LAMINATES CONTACT CUSTOMER CARE FOR PRICING. WOOD GRAIN LAMINATES SPECIFIED WILL HAVE HORIZONTAL GRAIN PATTERN.
SPECIFY: (L) FOR STANDARD LAMINATE WITH MATCHING POLYMER EDGE
(L/EE) FOR LAMINATE WITH EXPOSED PLY EDGE FINISHED IN CLEAR COAT
6. LAMINATE TABLES AND TABLETS ARE STANDARD WITH MATCHING POLYMER EDGE. TABLES ARE ALSO AVAILABLE WITH EXPOSED RADIUS PLY EDGE. TABLETS MAY ALSO BE SPECIFIED WITH A REVERSE BEVEL EXPOSED EDGE.
SPECIFY: (L) FOR STANDARD LAMINATE WITH MATCHING POLYMER EDGE
(L/EE) FOR LAMINATE WITH EXPOSED PLY EDGE FINISHED IN CLEAR COAT
7. ARM INSET PANELS CANNOT BE RETROFIT TO PREVIOUSLY ORDERED UNITS.
8. HANGOUT LEDGE DIMENSIONS: OVERALL HEIGHT-42.5 INCHES, LEDGE HEIGHT-40 INCHES. LEDGES REQUIRE FIELD INSTALLATION.

DIMENSIONS

FIGURES

YARDAGE REQUIREMENTS SHOWN ARE BASED ON NON-DIRECTIONAL 54" TEXTILES. REFER TO PAGE 3 FOR HELP WITH TEXTILES WITH REPEATS OR SEND AN EMAIL TO: COM_HELP@EKOCONTRACT.COM

W 29.5
D 27
H 14.5

WEIGHT (LBS.) 8
CUBIC FEET 7

W 29.5
D 27
H 14.5

WEIGHT (LBS.) 8
CUBIC FEET 7

W 29
D 29
H 14.5

WEIGHT (LBS.) 8
CUBIC FEET 7

W 29
D 29
H 14.5

WEIGHT (LBS.) 8
CUBIC FEET 7