

MOBILE WALL SYSTEMS, CABINETS
& SCIENCE CASEWORK

VISION™

mobile casework



Casework • Wall Systems • Mobile Cabinets • Science Casework

Vision: Imagine Your Space™

Flexible facilities are a must in today's educational environments. Maco Vision modular casework allows you to overcome the antiquated, inflexible use of built-in millwork. By doing so, you enable your educators to create dynamic learning environments free from stagnant layouts.

The ability to meet changing classroom configurations and allow for renovations, expansions and fluctuations in your district's needs is paramount. Our products provide innovative storage solutions that can be repositioned and reconfigured as needed.

Your decision to invest in Vision modular casework today will have long-term pay-offs to your district for years to come. You'll see immediate return on your investment because our systems don't require costly installations and future change outs are easy with our ***built-in concealed casters***.

Reduce future costs. Simply by moving and reusing cabinets one time you can reduce furniture costs by 50%. Do it twice, and you'll save even more on reinstallation expenses and repairs to walls and floors as compared to traditional built-in millwork.

Value Delivered. Maco Vision modular casework features heavy-duty construction, premium grade materials and innovative designs to provide high quality, high value storage solutions. To prove that, we stand behind our mobile products with an industry-leading 15 year warranty!

Breathe Free. Maco products are MAS Certified.



contents

Introduction/Finishes	2
Vision: Imagine Your Space	4
Mobile Casework	8
Enhance Your Vision	10
Mobile Cabinets	13
Science Casework	14
The Maco Story	Back Cover



finishes

Maco is pleased to offer a range of standard laminate designs to coordinate with your school décor. Stock colors are inventoried at our factory, offering the shortest lead time to build. Non stock colors may require longer lead times. Maco can also work with you to custom match to your design needs. Contact us for pricing and lead times.



Solar Oak



Fusion Maple

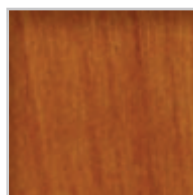

Wild Cherry



Nepal Teak



Grey Nebula

Choose from a wide variety of laminate finishes. The choices are too many to show. Please contact your Maco sales rep for more information.



VISION:

Make the most of classroom wall space with the Maco Vision modular casework system. Each unit offers highly functional storage and display areas as well as sliding marker board panels that eliminate the need for extra wall space. Offering the ultimate in flexibility, Vision modules can be disassembled, moved and reassembled easily to meet changing classroom needs or accommodate cleaning or repair work. Expand systems with additional modules as needed.

The four modules shown here meet the most common classroom needs. Looking for something special? Maco can customize modules for your school district. Just give us a call!

Vision offers:

- Complete, moveable solutions that replace built-in casework
- Modules are fully assembled at the factory, and are joined together on site
- Easy disassembly and re-assembly gives you maximum Flexibility
- Maximizes room layout by combining usable 18" storage behind sliding marker panels
- Full 10-Year Warranty

Specifications:

- Standard configuration: 8'w x 78"h x 26"d
 - Custom configurations available
- Each unit incorporates 2 base cabinets, 2 hutches and 2 sliding marker boards
 - Multiple base cabinet configurations
 - All models include 2 hutches, each with 4 adjustable shelves
 - All models come with 2 marker boards on separate tracks
- All-laminate construction
 - Panels are 3/4" all laminate construction with PVC edges
 - Shelves are adjustable, 1" all laminate construction with PVC edges
- Heavy duty 3" ball bearing casters
- Hardwood, dovetailed drawers with ball-bearing glides
- Locks on doors and drawers are optional

Imagine Your Space



The four modules shown here meet the most common classroom needs. Looking for something special? Maco can customize modules for your school district. Just give us a call!

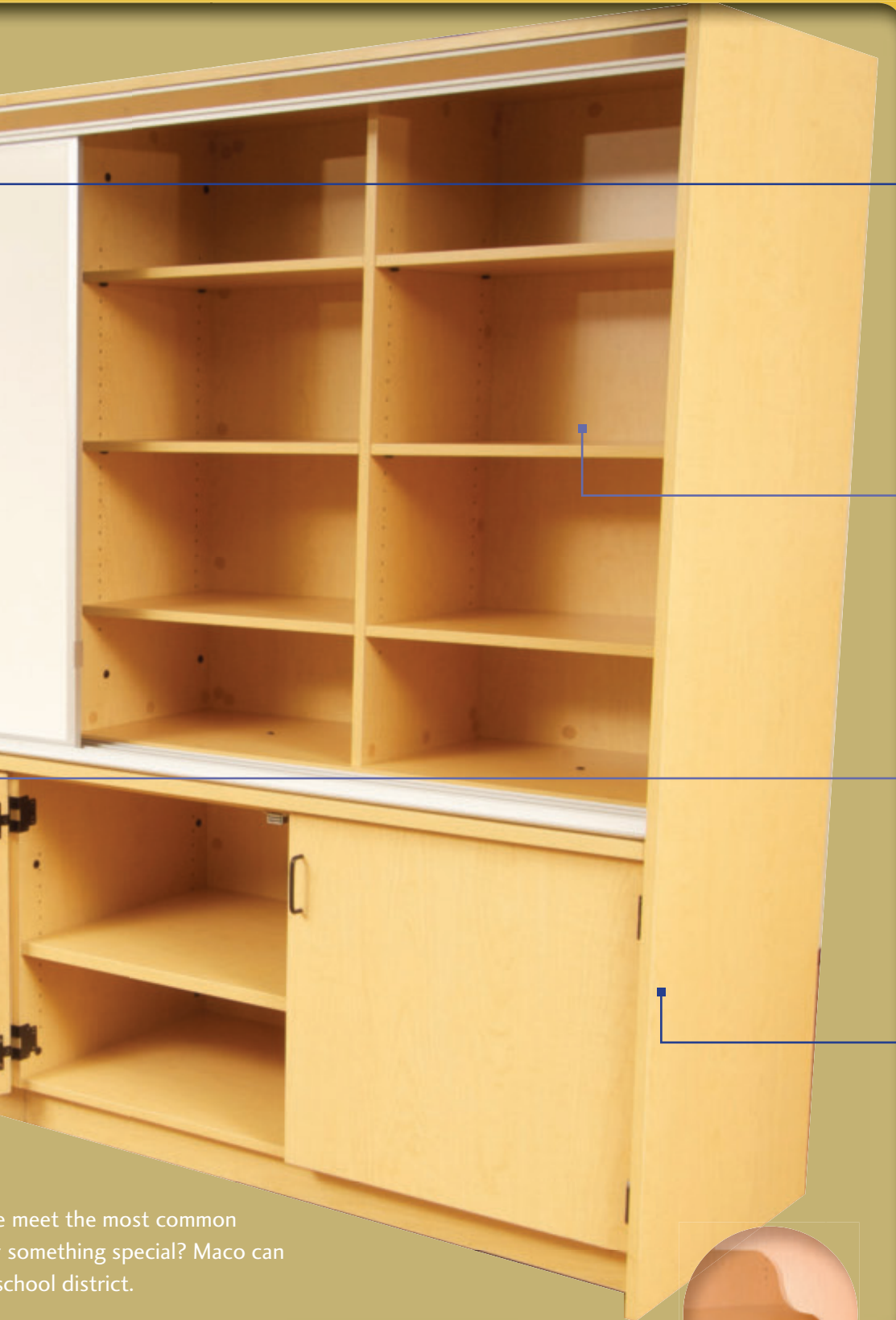

to meet the most common
something special? Maco can
school district.

Hidden casters
allow you to easily
move this unit

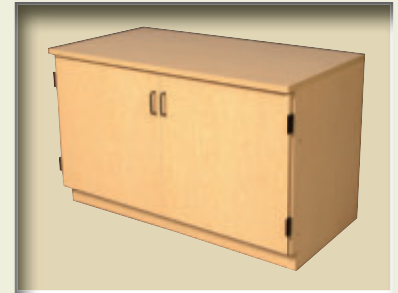
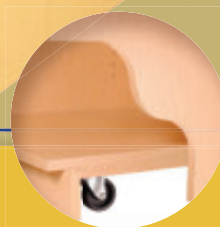

VWB2D0DW 48" Base - 2 required
(2 doors, no drawers)



VWUP2646 48" Upper Cabinet
2 required



VWUP2646 Dry Erase Board



Applied End Panels

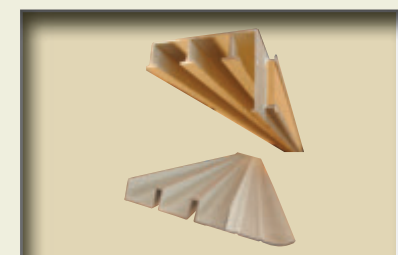

Upper & Lower Rails

VISION: IMAGINE

BASIC COMPONENTS



EMVW9678
96" w x 78" h x 26" d



VWUP2646
48" Upper Cabinet
48" w x 48" h x 18" d



VWB2DODW
48" Base (2 doors, no drawers)
48" w x 30" h x 26" d



IWUP2646
Dry Erase Board



VWEP2678
Applied End Panels



IWUP2646
Upper & Lower Rails

OPTIONS



VWB2D1D
48" Base (2 doors, 1 drawer)



48" Base (4 drawers)



VWB4DW1D
48" w x 30" h x 26" d



VWB4DDW
48" w x 30" h x 26" d (4 deep drawers)



VWB2DRWOP
48" w x 30" h x 26" d

YOUR SPACE



VWBODWOD
48" Base - open storage
48"w x 30"h x 26"d



VWB4DWOP
48" Base - 4 drawers with open storage
48"w x 30"h x 26"d



VWB2DWOPT
48" Base - 2 deep drawers with open storage
48"w x 30"h x 26"d



VWB0DWODD
48" Base - divided storage
48"w x 30"h x 26"d





MOBILE CASEWORK



Base Cabinets



EMBDO2435 24"w x 36"h x 24"d
 EMBDO3033 30"w x 33"h x 24"d
 EMBDO3035 30"w x 36"h x 24"d
 EMBDO3633 36"w x 33"h x 24"d
 EMBDO3635 36"w x 36"h x 24"d

Base Cabinets with Drawers



EMBDD3035 30"w x 36"h x 24"d
 EMBDD3635 36"w x 36"h x 24"d



EMBCR2435 24"w x 36"h x 24"d
 Corner Filler

Sink Base Cabinets



EMSBD7233 72"w x 33"h x 24"d
 Sink and Fixtures not included



EMSBD3633 36"w x 33"h x 24"d
 EMSBD4833 48"w x 33"h x 24"d
 Sink and Fixtures not included



EMSBD3635 36"w x 35"h x 24"d
 Sink and Fixtures not included

Wall Cabinets



EMWC3030 30"w x 30"h x 12"d
 EMWC3630 36"w x 30"h x 12"d
 EMWC4230 42"w x 30"h x 12"d
 EMWC4830 48"w x 30"h x 12"d



EMWC3615 36"w x 15"h x 12"d



EMWC2430 24" w x 30"h x 12"d
 Diagonal Corner Wall Cabinet

Teacher's Desk



EMTD6030
 60"w x 29"h x 30"d
 Teacher's Desk



General Storage

EMGS3678 36"w x 78"h x 24"d
 EMGS4878 48"w x 78"h x 24"d

Teacher's Wardrobe

EMTW3678 36"w x 78"h x 24"d
 EMTW4878 48"w x 78"h x 24"d

ENHANCE

YOUR

Maco Mobile Casework offers that perfect blend of style and flexibility. Concealed casters allow you to easily move units in and out of the classroom, while the high quality construction and design give every classroom a stylish, tailored look. Staff can easily move pieces around the classroom, or around the school as needs change.

Get the assurance of quality and reliable consistency from Maco Mobile Casework, which are manufactured and fully assembled in our factory. No on-site construction is required.

Features:

- High quality all-laminate construction
- Durable HPL tops on base cabinets and work surfaces
(Available with or without backsplash)
- 1" thick standard shelves, all adjustable
- Hardwood, dovetail drawers with ball-bearing glides
- Heavy-duty 3" ball-bearing casters



VISION



MOBILE CASEWORK



Easy to re-configure for multiple classroom layouts and uses.



Accessory Stand
WUPS2424 24"w x 30"h x 24"d



Peninsula Return with Bookcase
WURT7230 72"w x 30"h x 30"d



Teacher's Desk with 5 Drawers
WU6030 60"w x 30"h x 30"d

Lectern with Omni-directional Slide-out Shelf

Features flexibility of arrangement.



FLWU1848
22"w x 48"h x 18"d

Teacher's Station



FEATURES: Flat panel monitor support with wire raceway, pull-out keyboard tray, pull-out shelf for computer, 2 locking drawers, fold-down projector shelf, security back and side rails, concealed wire chase.



EMTS4824
48w x 40h x 24d

Lectern with Visual Presenter (ELMO) Shelf

Features large shelf for visual presenter (ELMO) can be mounted on left or right side panel, grommets provide easy wire access and management.



LPOD3048
30"w x 48"h x 24"
Shelf: 23"w x 24"d

MOBILE CABINETS

When the need is for good quality, rugged mobile cabinetry, Maco Mobile Cabinets fit the bill. Whether you simply need extra storage space in a classroom, or a truly moveable cabinet that follows a teacher around, we've got a variety of units that provide both function and flexibility.

Featuring a full 10-Year Warranty, Maco Mobile Cabinets offer:

- All-laminate construction
- 5" swivel casters standard
- Full width shelves or with divider (all shelves are adjustable)
- Hinged doors with 270° full swing
- Locks available (not standard)
- Fully assembled at our factory



LDC4836M 48"w x 36"h x 24"d
5 Drawer Cabinet



LDSC4836M 48w x 36h x 24d
Drawer/ Door Cabinet



LGPW4868M 48"w x 68"h x 24"d
Coat Wardrobe Storage



LDS4868M 48w x 68h x 24d
Tall Divided Storage



LTS4868M 48w x 68h x 24d
Tall Storage 5 Shelf



LTW4868 48"w x 68"h x 24"d
Wardrobe - Divided Storage

Metal Frame Mobile Cabinets



LTW4868M
48"w x 68"h x 24"d



SCIENCE CASEWORK



READY LAB SCIENCE CASEWORK

At Maco manufacturing we know the science behind science casework and lab designs for layout solutions in today's learning environments.

Our project team can assist you with the following:

- Design assistance including layout drawings and measurements
- Coordination assistance with your plumber/electrician/HVAC providers
- Casework and equipment including fume hoods, tops & sinks, and lab-grade fixtures



MATERIALS/CONSTRUCTION

Plywood: Furniture Grade Red oak, hardwood core

Lumber: Red Oak, grade FAS or better.

Lab Grade Casework Finish: Chemical Resistant, factory applied UV finish (100% solids) with no VOC's expelled to the atmosphere on both the exterior and interior surfaces.

Cabinet: All oak hardwood plywood construction using 32mm doweling system. 1" top rails.

Drawers: All hardwood plywood construction, dove tailed all 4 corners.

Shelves: 1" plywood, edge banded with 3mm red oak edging

Open Frame Tables: Solid oak legs and frame rails, steel plate supports at each leg.

Hardware:

Pulls: 96mm wire pulls.

Locks: Laboratory grade cylinder cam locks.

Hinges: 5 Knuckle Institutional hinges.

Drawer Slides:

Epoxy powder coated, cold rolled steel, heavy duty, side mounted, 150 lb load capacity.

Equipped with heavy-duty, ball bearing nylon rollers for smooth effortless operation. Slides have automatic positive stop to prevent drawer's accidental removal, but allows for quick removal without tools.

Fixtures:

Service Fixtures: Laboratory Grade, Polished chrome plated brass, water and gas fixtures.

Electrical Fixtures: GFI, 3 wire grounded, 20A, 125V AC.



Work surfaces and sinks:

Laboratory Tops: Chemical resistant molded modified epoxy resin 1" thick black with 4" applied back and side splashes.

Sinks: Chemical resistant molded modified epoxy resin, drop in style, black, with outlet.

Science Lab Equipment Including:

- Fume Hoods
- Barrier Free Eye Wash / Emergency Shower Combination
- Germicidal Goggle Cabinets
- Fire Blanket with cabinet
- First Aid Kit
- Peg Boards

IN-STOCK CABINETS

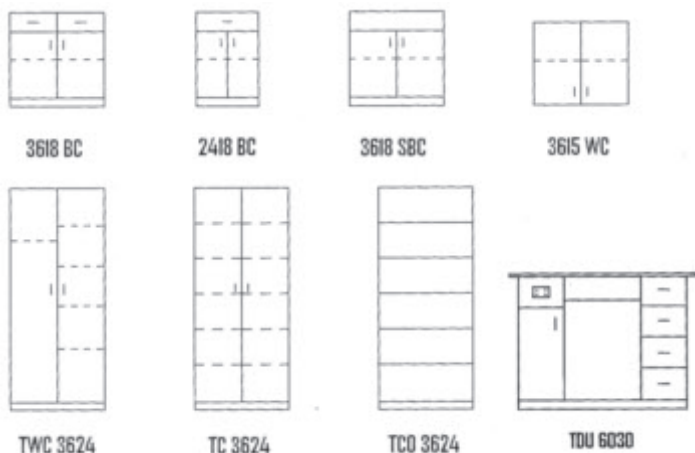

SCIENCE TABLES



Heavy duty lab grade tables are available with laminate or Epoxy resin tops.

Please specify desired top material when requesting price quotes.



The Maco Manufacturing Indeco Sales Story



INDECO Sales, Inc. / MACO MFG., is a family owned and operated business. We have been serving the education market since 1969. We own and operate two corporations, one being a sales company, the other a manufacturing plant.

Our motto is "A satisfied customer is our best salesman" and we would like to earn your business.

We offer the finest quality products at the lowest price in the educational market.

Our service is second to none, we service what we sell and we sell service. If you purchase our products, we guarantee you will be satisfied.

We have our own fleet of trucks and when possible, deliver all of our products on our trucks.

The corporate headquarters is located in Belton, Texas on 16 acres of land with 300,000 square feet of manufacturing and warehouse facility.

CUSTOM CAPABILITIES

Whether you need a special size, design or edge detail, Maco can modify its products to fit your special needs and applications.

Maco Products can be ordered in other wood species, custom stains, steel colors and other laminates not part of our standard offering.



Maco Manufacturing A Division of Indeco Sales

805 East 4TH AVE.
Belton, Texas 76513
800-692-4256
254-939-5742
254-939-1760 (FAX)
www.macomfg.com

We invite you to come see us anytime at your convenience. Please come visit and tour our facilities.