



Reels

AKRON BRASS COMPANY | PH. 800.228.1161 (330.264.5678) | akronbrass.com





The Akron Brass Booster Reel is designed to be lightweight and extremely durable. There are more options than ever as these reels are available in multiple sizes, and in both electric and manual rewind.

ERWB & MRWB

- Heavy-duty construction for durability
- All stainless steel hardware
- Powder coated finish, standard colors are red and silver (Must Specify)
- Enclosed Hub
- Rolled edge discs
- Swept axle for reduced friction loss
- NFPA compliant
- Standard inlet: 90° super swivel with 1" female NPT threads
- Standard outlet: 1" male NST threads (1 3/8" x 8 TPI)
- 1000 PSI pressure rating
- Hand crank & brake
- Handles 3/4" (19 mm) and 1" (25 mm) Booster Hose
- 1/3 hp motor

Additional Options:

- Chrome plated spools & rollers
- Control box with switch & breaker
- Speed control
- 1/2 hp motor
- 24V motor
- NPSH or BSP outlet threads
- Front access location options
 - 30°
 - Vertical
- Hose - See below

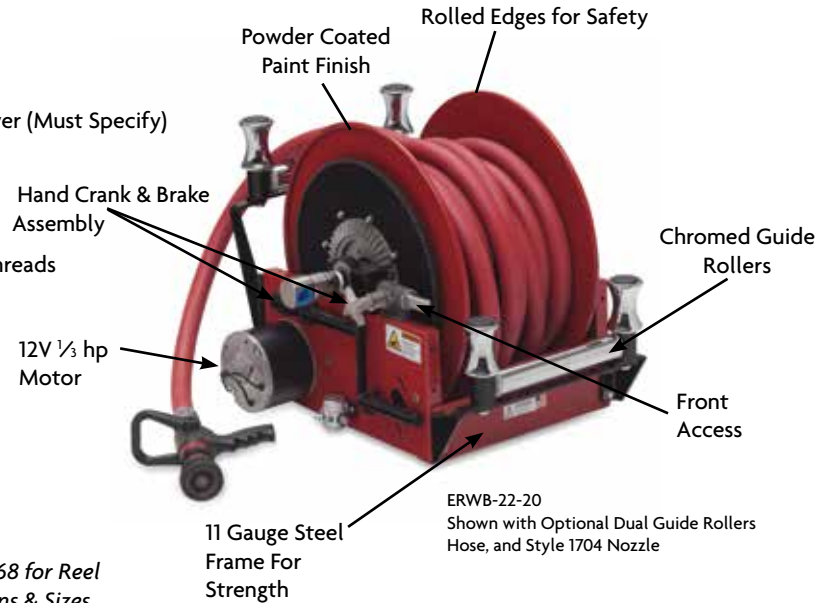

See Page 168 for Reel Dimensions & Sizes



Boostlite® Forestry Hose

Akron Brass is now offering a superior **lightweight**, heavy-duty fire hose. This hose works great for wildland brush fire truck attack hose, range control attack hose, and booster reel hose.

- Kink resistant, even at low pressures.
- Bend radius is less than 3.5" (8.9 cm) for a 3/4 inch (19mm) hose, and 4.5" (11.4 cm) for a 1 inch (25mm) hose.
- Non-Collapsible and fits standard Akron Brass hose reels.
- Heavy duty spun yarn construction.
- The lining process produces an amazingly thin but smooth inner waterway, yielding an extremely low friction loss for maximum flow.
- Standard Strobe Yellow Permatek™ HP treatment for greater visibility & abrasion resistance and also greatly reduces moisture absorption through the jacket.
- Resistant to most chemicals, petrol products, ozone & U.V. exposure, hydrolysis, and rot & mildew.
- Temperature range of -60° F to 140° F (- 50° C to 60° C).



Lightweight



Booster 1"
Standard Booster
Hose also available.

Hose Type	Internal Diameter	Operating Pressure (psi)	Burst Pressure (psi)	Weight (lb/foot)	Color	Lengths	Hose Fittings
Lightweight	1" (25 mm)	400 (27 bar)	2000 (138 bar)	.193 w/o couplings	Yellow	50', 100', 150', & 200' (15.2 m, 30.5 m, 45.7 m & 61 m) (lengths over 100' are spliced)	NST or NPSH aluminum couplings (rocker lug or pin hole)"
Booster 1"	3/4" or 1" (19 m or 25 m)	800 (55 bar)	3200 (220 bar)	3/4" = .42 1" = .60	Red	50', 100', 150', & 200' (15.2 m, 30.5 m, 45.7 m, 60 m, 61 m & 90 m)	NST or BSP aluminum couplings (metric hoses have brass NST)"



Booster Reels

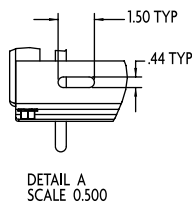
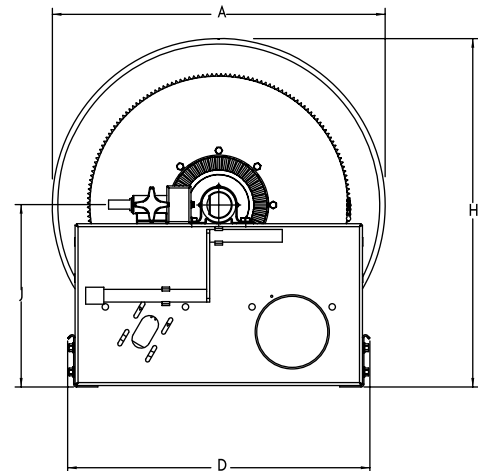
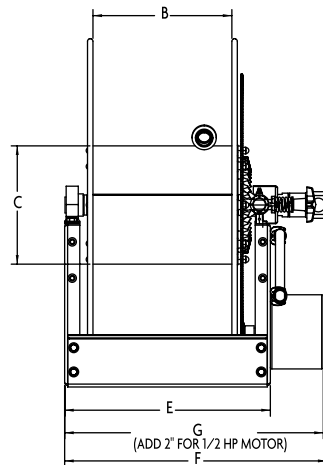
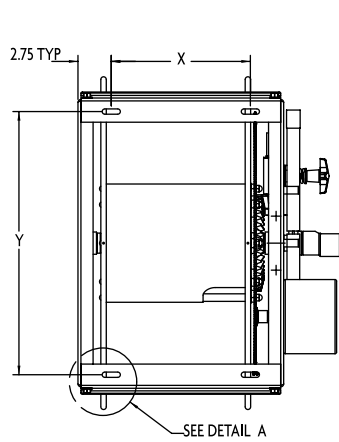

Booster Reel Options

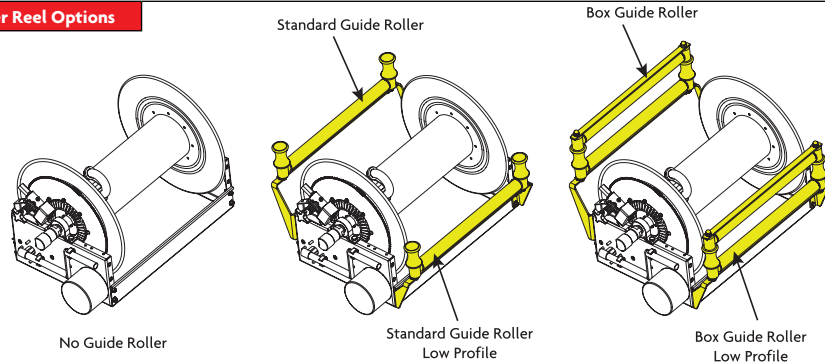

MODEL	HOSE CAPACITY		Weight (Less Hose)	A	B	C	D	E	F	G	H	J	X	Y
	3/4" (19mm)	1" (25mm)												
ERWB-16-24	125' (38m)	75' (23m)	-	16.00 (406)	24 (610)	8.00 (203)	17.50 (445)	29.83 (758)	34.54 (877)	34.15 (867)	17.57 (446)	9.30 (236)	24.00 (610)	14.25 (362)
ERWB-16-28	150' (46m)	100' (31m)	114 lbs. (52.7 kg)	16.00 (406)	28 (711)	8.00 (203)	17.50 (445)	33.83 (859)	38.54 (979)	38.15 (969)	17.57 (446)	9.30 (236)	28.00 (711)	14.25 (362)
ERWB-22-11	125' (38m)	75' (23m)	-	22.00 (559)	11.50 (292)	10.00 (254)	21.00 (533)	17.00 (432)	21.68 (551)	21.38 (543)	22.41 (569)	11.45 (291)	11.50 (292)	17.75 (451)
ERWB-22-15	175' (54m)	100' (31m)	-	22.00 (559)	15.50 (394)	10.00 (254)	21.00 (533)	21.00 (533)	25.68 (652)	25.38 (645)	22.41 (569)	11.45 (291)	15.50 (394)	17.75 (451)
ERWB-22-20	225' (69m)	150' (46m)	115 lbs. (52.1 kg)	22.00 (559)	20.00 (508)	10.00 (254)	21.00 (533)	25.50 (648)	30.18 (767)	29.88 (759)	22.41 (569)	11.45 (291)	20.00 (508)	17.75 (451)
ERWB-22-24	300' (92m)	200' (61m)	-	22.00 (559)	24.00 (610)	8.00 (203)	21.00 (533)	29.85 (758)	34.31 (871)	34.23 (870)	22.41 (569)	11.45 (291)	24.00 (610)	17.75 (451)
ERWB-22-28	350' (107m)	225' (69m)	-	22.00 (559)	28.00 (711)	8.00 (203)	21.00 (533)	33.85 (860)	38.31 (973)	38.23 (971)	22.41 (569)	11.45 (291)	28.00 (711)	17.75 (451)
ERWB-24-11	150' (46m)	100' (31m)	-	24.00 (610)	11.50 (292)	10.00 (254)	25.00 (635)	17.00 (432)	21.68 (551)	21.38 (543)	27.04 (687)	15.08 (383)	11.50 (292)	21.75 (553)
ERWB-24-15	225' (69m)	125' (38m)	-	24.00 (610)	15.50 (394)	10.00 (254)	25.00 (635)	21.00 (533)	25.68 (652)	25.38 (645)	27.04 (687)	15.08 (383)	15.50 (394)	21.75 (553)
ERWB-24-20	300' (92m)	175' (54m)	117 lbs. (53 kg)	24.00 (610)	20.00 (508)	10.00 (254)	25.00 (635)	25.50 (648)	30.18 (767)	29.88 (759)	27.04 (687)	15.08 (383)	20.00 (508)	21.75 (553)
ERWB-27-11	225' (69m)	150' (46m)	114 lbs. (52.7 kg)	27.50 (699)	11.50 (292)	10.00 (254)	25.00 (635)	17.00 (432)	21.68 (551)	21.38 (543)	28.79 (731)	15.08 (383)	11.50 (292)	21.75 (553)
ERWB-27-15	300' (92m)	200' (61m)	27.50 lbs. (52.6 kg)	27.50 (699)	15.50 (394)	10.00 (254)	25.00 (635)	21.00 (533)	25.68 (652)	25.38 (645)	28.79 (731)	15.08 (383)	15.50 (394)	21.75 (553)
ERWB-27-20	400' (122m)	250' (77m)	-	27.50 (699)	20.00 (508)	10.00 (254)	25.00 (635)	25.50 (648)	30.18 (767)	29.88 (759)	28.79 (731)	15.08 (383)	20.00 (508)	21.75 (553)
ERWB-29-11	250' (77m)	175' (54m)	-	29.00 (737)	11.50 (292)	10.00 (254)	25.00 (635)	17.00 (432)	21.68 (551)	21.38 (543)	29.54 (750)	15.08 (383)	11.50 (292)	21.75 (553)
ERWB-29-15	350' (107m)	225' (69m)	-	29.00 (737)	15.50 (394)	10.00 (254)	25.00 (635)	21.00 (533)	25.68 (652)	25.38 (645)	29.54 (750)	15.08 (383)	15.50 (394)	21.75 (553)
ERWB-29-20	450' (138m)	300' (92m)	-	29.00 (737)	20.00 (508)	10.00 (254)	25.00 (635)	25.50 (648)	30.18 (767)	29.88 (759)	29.54 (750)	15.08 (383)	20.00 (508)	21.75 (553)

NOTES:

1. When installing guide rollers ERWB-GR, Add 4-1/2" to "D" dimension.
2. The "G" dimension is for 1/3 HP motors. Add 2" for 1/2 HP motors. Reels handling 200' or more must use 1/2 HP motor.
3. Reels can be supplied with 1/3 HP And 1/2 HP motors in 12V or 24V.
4. A flexible connector must be used between the inlet pipe and the inlet swivel joint.
5. For manual rewind reels, use prefix "MRWB" in place of "ERWB".
6. Additional configurations are available upon request.



Electric Rewind Hydraulic Reel

The Electric Rewind Hydraulic Reel (ERWH) has many of the same features and durability as all Akron Reels such as a powder coated finish, stainless steel hardware and ease with installation.

ERWH-15-10, ERWH-16-6, ERWH-10-16

- Heavy-duty construction for durability
- All stainless steel hardware and rollers
- Powder coated finish, standard colors are red and silver
- Rolled edge discs
- Universal frames for flexibility of installation (4 motor locations)
- Rear motor mount option for narrower profile; maximizes compartment space
- Removable hub for ease of installation
 - Hub is easily removed to mount frame to apparatus
- Inlet: 1/4" NPT female threads
- Outlet: #4 JIC male threads
- Hydraulic hose packages available
- Meets NFPA requirements, allows for 10% overage of hose
- Acceptable for use with phosphate ester hydraulic fluid
- Tested at a 2:1 safety factor

Part Number	Rated PSI *	1/4" (6.4 mm) Hose Max Capacity	Side Mount Motor	Rear Mount Motor
ERWH-15-10	10,000 (690 bar)	100' (30.5 m)	Yes	Yes
ERWH-10-16	10,000 (690 bar)	80' (24.4 m)	No	Yes
ERWH-16-6	10,000 (690 bar)	100' (30.5 m)	Yes	Yes

* Tested at 2:1 safety factor

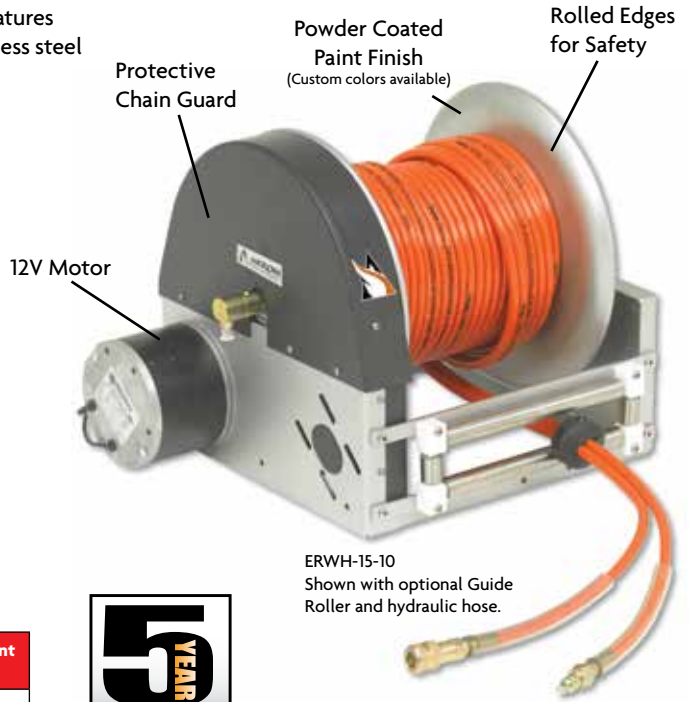

ERWH-15-10
Shown with optional Guide Roller and hydraulic hose.



See Page 172 for Reel Dimensions & Options



ERWH-16-6
Shown with optional hydraulic hose.



ERWH-10-16
Compact configuration for use with limited compartment space. Standard with guide rollers and speed control. Shown with optional hydraulic hose.

Hydraulic Hose Options

Hydraulic Twinline Hose *	Internal Diameter	Operating Pressure (psi)	Burst Pressure (psi)	Colors Available	Lengths	Hose Fittings **
5,000 psi	1/4" (6.4 mm)	5,000 psi (345 bar)	20,000 psi (1379 bar)	Orange Blue Green Red Yellow	50' & 100' (15 & 31 m)	#4 Female JIC swivel x #6 Male O-Ring BOSS
10,000 psi	1/4" (6.4 mm)	10,000 psi (690 bar)	40,000 psi (2758 bar)	Orange Black Blue Red Yellow	100' (31 m)	#4 Female JIC swivel x #6 Male O-Ring BOSS or #4 Female JIC swivel x 1/4 Male BSP thread

* Single line lead-in hose available (need 2)

** Quick connect couplers available - call for availability





Electric Rewind Reels

Electric Rewind Air Reel

The Electric Rewind Air Reels have many of the same features and durability as all Akron Reels. These include a powder coated finish, stainless steel hardware and ease with installation. There are two versions: the utility air reel (ERWU) for air tools (300 psi), and breathing air (ERWBA) reels that work with both low pressure (3000 psi) and high (6,000 psi).

ERWU-15-10; ERWU-10-16; ERWU-16-6; ERWA-15-10; ERWA-10-16; ERWA-16-6

- Heavy-duty construction for durability
- All stainless steel hardware and rollers
- Powder coated finish, standard colors are red and silver
- Rolled edge discs
- Universal frames for flexibility of installation (4 motor locations)
- Rear motor mount option for narrower profile; maximizes compartment space
- Removable hub for ease of installation
 - Hub is easily removed to mount frame to apparatus
- Inlet: Utility air is 1/4" female NPT threads and breathing air is #4 JIC male threads
- Outlet: Utility air is 1/4" female NPT threads and breathing air is #4 JIC male threads
- Air hose packages available

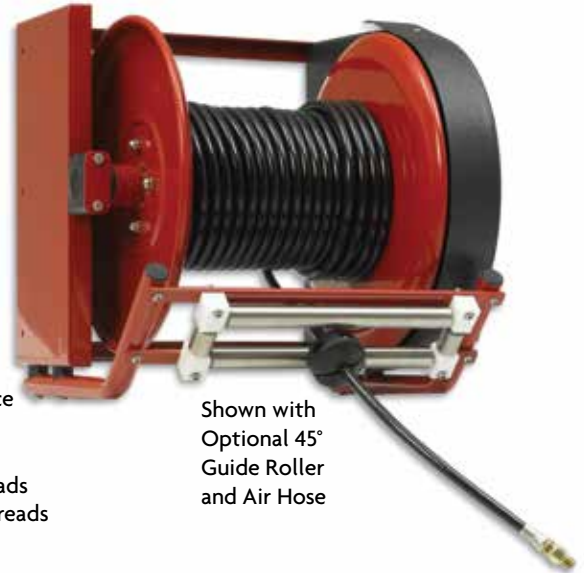

Shown with
Optional 45°
Guide Roller
and Air Hose

Part Number	Rated PSI *	Hose Capacity**	Side Mount Motor	Rear Mount Motor
ERWU-15-10	300 (21 bar)	200' of 3/8" (61 m of 9.5 mm) 150' of 1/2" (45.7 m of 12.7 mm)	YES	YES
ERWA-15-10	6000 (414 bar)	Up to 300' of 1/4" (92 m of 4.6 mm)	YES	YES
ERWU-16-6	300 (21 bar)	150' of 3/8" (46 m of 9.5 mm) 100' of 1/2" (31 m of 12.7 mm)	YES	YES
ERWA-16-6	6000 (414 bar)	Up to 200' of 1/4" (61 m of 6.4 mm)	YES	YES
ERWU-10-16	300 (21 bar)	100' of 3/8" (31 m of 9.5 mm) 50' of 1/2" (15 m of 12.7 mm)	NO	YES
ERWA-10-16	6000 (414 bar)	Up to 150' of 1/4" (46 m of 6.4 mm)	NO	YES

* Tested at a 2:1 safety factor

** Allows for 10% overage of hose capacity

Utility Air Hose	ID	"Working Pressure (psi)"	Lengths	Hose Fittings
300 psi	3/8"	300	100', 150', & 200'	1/4" Male NPT
300 psi	1/2"	300	150' & 200'	1/4" x 3/8" Male NPT

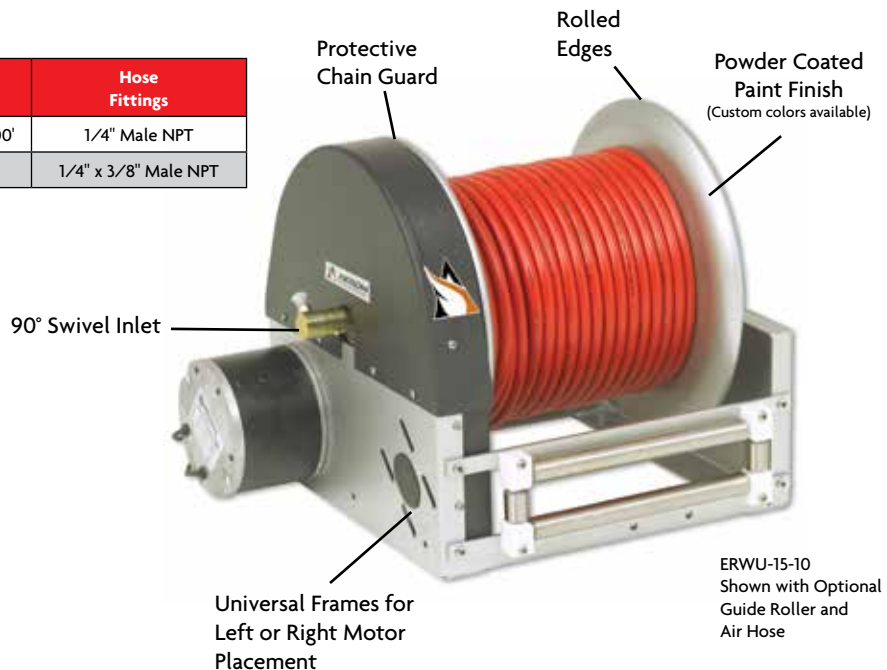

ERWU-15-10
Shown with Optional
Guide Roller and
Air Hose

See Page 172 for Air Reel
Dimensions & Options



These reels are built to Akron Brass' standard of performance and reliability. They have a powder coated finish and stainless steel hardware for years of durable service life. In addition, these reels are some of the most versatile reels available. If the desired motor location is known, simply specify and we will ship the reel ready to mount. They can be mounted on the floor, back wall or even the ceiling of any compartment. The guide rollers can be ordered in various configurations to make sure the cord or hose wraps correctly no matter where the reel is mounted.

Electric Rewind Cord Reel

The Electric Rewind Cord Reel is a natural extension of our current line of power distribution equipment.

ERWC-15-10, ERWC-16-6, ERWC-10-16 & ERWC-10-28

- Internally grounded
- Heavy-duty construction for durability
- All stainless steel hardware and rollers
- Powder coated finish, standard colors are red and silver
- Rolled edge discs
- Live slip ring design
- Custom length cords and connections available
- Meets NFPA requirements, allows for 10% overage of cord

Cord

Part Number	12/3 600 V Cord Capacity	10/3 600 V Cord Capacity	10/4 & 12/4 Cord Capacity	Side Mount Motor	Rear Mount Motor
ERWC-15-10	250' (76.2m)	200' (61m)	200' (61m)	Yes	Yes
ERWC-16-6	175' (53.3m)	150' (45.7m)	-	Yes	Yes
ERWC-10-16	150' (45.7m)	100' (30.5m)	100' (30.5m)	No	Yes
ERWC-10-28	250' (76.2m)	200' (61m)	200' (61m)	No	Yes

See Page 172 for Cord Reel Dimensions & Options



ERWC-16-6
New compact configuration for use with limited compartment space, Shown with optional guide rollers and cord



ERWC-10-16
Shown with optional cord (Standard with speed control and guide rollers.)



ERWC-10-28
Shown with optional cord (Standard with speed control and guide rollers.)

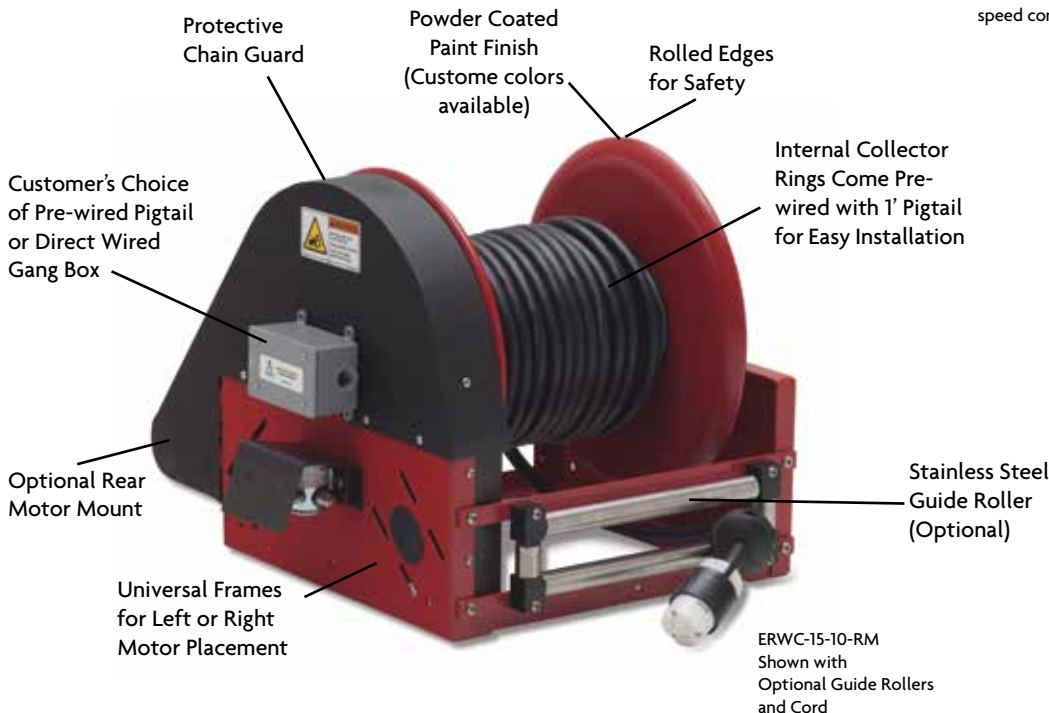



Electric Rewind Reels

AKRON BRASS COMPANY | P.H. 800.228.1161 (330.264.5678) | akronbrass.com

MOTOR POSITIONS
1-4 DIMENSIONS

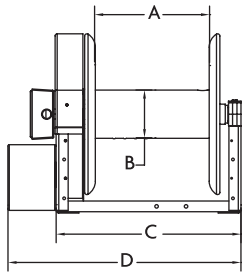

MOTOR POSITIONS
1-4 DIMENSIONS

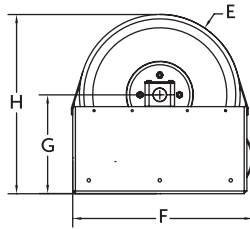

REAR MOTOR
POSITION DIMENSIONS

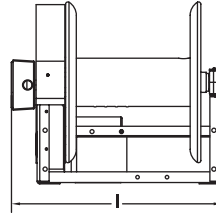

REAR MOTOR
CONFIG DIMENSIONS

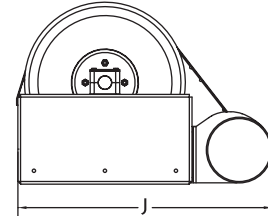

Standard Reel Chart

PART NUMBER	REEL TYPE	A	B	C	D	E	F**	G	H	I*	J*
ERWC-15-10	CORD	10.7	4.5	17.3	22	15	17	9.3	16.8	19.6	23.9
ERWC-16-6	CORD	5.6	4.5	11	15.2	16.5	17	9.3	17.7	13.3	23.9
ERWH-15-10	HYDRAULIC	10.7	4.5	17.3	22.7	15	17	9.3	16.8	19.1	23.9
ERWH-16-6	HYDRAULIC	5.6	4.5	11	16.1	16.5	17	9.3	17.7	12.7	23.9
ERWA-15-10	BREATHING AIR	10.7	4.5	17.3	22	15	17	9.3	16.8	19.1	23.9
ERWA-16-6	BREATHING AIR	5.6	4.5	11	16.1	16.5	17	9.3	17.7	12.7	23.9
ERWU-15-10	UTILITY	10.7	4.5	17.3	22	15	17	9.3	16.8	19.1	23.9
ERWU-16-6	UTILITY	5.6	4.5	11	16.1	16.5	17	9.3	17.7	12.7	23.9

*I and J are for rear motor mount only

**F does not apply to rear mount

Low Profile Chart

PART NUMBER	REEL TYPE	A	B	C	D	E	F	G	H
ERWC-10-16	CORD	16	4.5	21.3	23.7	10	19.6	6.2	11.2
ERWC-10-28	CORD	16	4.5	33.4	35.7	10	19.6	6.2	11.2
ERWH-10-16	HYDRAULIC	16	4.5	21.3	23.9	10	19.6	6.2	11.2
ERWU-10-16	UTILITY	16	4.5	21.3	23	10	19.6	6.2	11.2
ERWA-10-16	BREATHING AIR	16	4.5	21.3	23.7	10	19.6	6.2	11.2

NOTE: Some dimensions may vary slightly.

LOW PROFILE DIMENSIONS

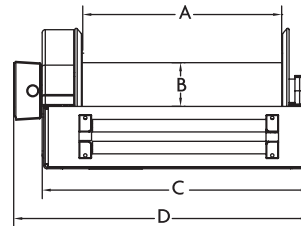

LOW PROFILE DIMENSIONS

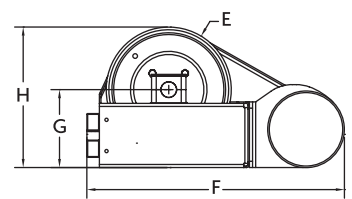

Ball Stops

CS-08	Cord Stop for 8 Gauge Wire
CS-10	Cord Stop for 10 Gauge Wire
CS-12	Cord Stop for 12 Gauge Wire
HS-BA	Hose Stop for Breathing Air Hose
HS-TOOL	Hose Stop for Utility Air Hose
HS-TWIN	Hose Stop for 1/4" Twin Line Hose

Guide Rollers

GR	Guide Roller Assembly
GR-V45	Guide Roller Assembly (Vertical 45 Degree Angle)
GR-V90	Guide Roller Assembly (Vertical 90 Degree Angle)
GR-V0	Guide Roller Assembly (Vertical 0 Degree Angle)
GR-THRU	Guide Roller Assembly (Thru Compartment Flush Mount)

Control Boxes

ERW-SL	Control Box with Switch and Breaker Only
ERW-SCS	Control Box with Speed Control

Rear Mount

ERW-RMC	Rear Mount Conversion Kit for Electric Rewind Reels
---------	---

Brake

ERW-BR1	Brake For All Reels With Hose
---------	-------------------------------

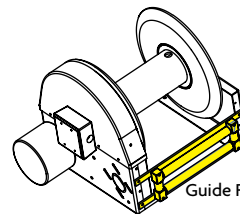

Guide Roller (GR)

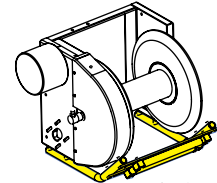

Optional 45° Guide Roller

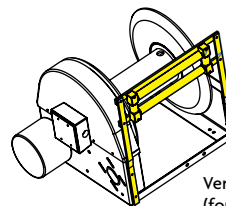

Vertical (GR-V0)
(for upside down
applications)

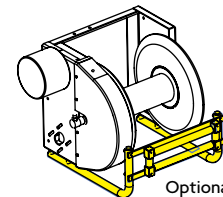

Optional 90°
Guide Roller

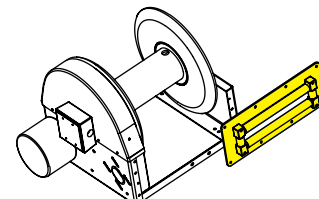

Thru Compartment/Flush
Mount (GR-THRU)



Akron Brass Cord Reels are the ultimate in managing portable power cords. The Cord Reel allows for fast, easy deployment and retraction of extension cords without the hassle of twisting or knotting. Akron Cord Reels are available in Live and Non-Live configurations.

- All live reels are internally grounded
- Available in 3 sizes 10", 15" & 18"
- Heavy-duty construction
- Powder coated
- Live slip ring design
- Adjustable tension nut
- 6' direct wire pigtail (10/3 Black)
- Meets NFPA requirements

Additional Options

- NEMA configuration connectors
- Heavy-duty cord & connectors (custom lengths)
- ECR-MT cord reel mounting bracket

ECRP-18, ECRP-15, & ECRP-10 are live cord reels allowing continuous power to the cord as it is deployed or retracted while providing excellent storage and organization of extension cords.

ECRP-18-GB, ECRP-15-GB, & ECRP-10-GB are live cord reels with a gang box permanently mounted to the axle. Simply plug the cord into a receptacle and carry the reel to the fire ground or work site.

NCRP-18, NCRP-15, & NCRP-10 are non-live cord reels providing excellent storage and organization of extension cords.

NCRP-18-GB, NCRP-15-GB, & NCRP-10-GB are non-live cord reels with a gang box permanently mounted to the reel. Simply plug the cord into a receptacle and carry the reel to the fire ground or work site.



ECRP-15
15" Cord Reel with
optional cord



ECRP-10-GB
10" Live Cord Reel
with gang box



NCRP-18
18" Non-Live
Cord Reel



ECR-MT
Cord Reel
mounting brackets

Cord Type	10" Cord Reel Capacity	Weight W/cord	15" Cord Reel Capacity	Weight W/cord	18" Cord Reel Capacity	Weight W/cord
14/3-300 Volt	150' (45.7 m)	22# (10 kg)	300' (91.5 m)	46# (20.1 kg)	450' (137 m)	61# (27.7 kg)
12/3-300 Volt	100' (30.5 m)	22# (10 kg)	200' (61 m)	46# (20.1 kg)	300' (91.5 m)	61# (27.7 kg)
10/3-300 Volt	N/A	N/A	100' (30.5 m)	42# (19 kg)	175' (53.3 m)	60# (27.2 kg)
14/3-600 Volt	50 (15.2 m)	17# (7.7 kg)	125' (38 m)	37# (16.8 kg)	225' (68.7 m)	54# (24.5 kg)
12/3-600 Volt	N/A	N/A	100' (30.5 m)	41# (18.6 kg)	150' (46 m)	54# (24.5 kg)
10/3-600 Volt	N/A	N/A	75' (22.8 m)	40# (18.1 kg)	100' (30.5 m)	49# (22.3 kg)



18" Cord Reel

15" Cord Reel

10" Cord Reel

Cord Reel Lights are Available on page 162



ECRP-10-ELBE-500
10" Cord Reel Light
with optional
yellow cord



ECRP-10-ELSS-XLAC