



## TYPICAL LAYOUTS





## Straight Desks

---

### Quote #234769

**Description:**

72" x 30" rectangular shell, self edge, with Offset Full Modesty, File/File ped, Box/Box/File ped.

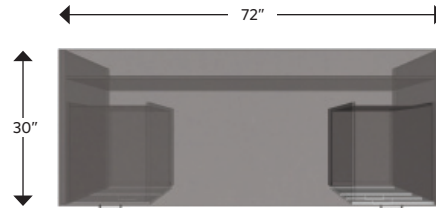

### Quote #234770

**Description:**

60" x 24" rectangular shell, with wood bullnose trim along front edge of worksurface, Box/File ped, 40mm cable entry grommet, 24" high credenza hutch with horizontal paper management options left and right. 1" finished top for hutch with bullnose trim along front edge.

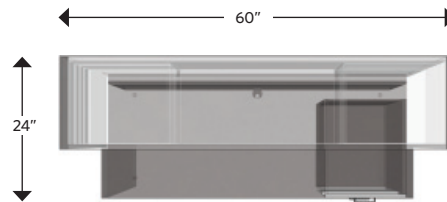

### Quote #234771

**Description:**

78" x 36" pedestal desk, with wood bullnose trim on all 4 sides of top. Includes 2 x tapered beech legs, hand stained to match laminate color and bullnose trim on desk. Pedestal frame is built in - choice of pedestal. Shown is extended depth Box/Box/File.

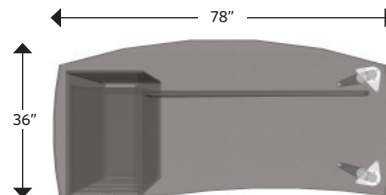

---

\*Shading is for creating 3D image only. Color choices can be made for the decor (body), door/drawer fronts, and worksurfaces/tops in any combination of our offered laminates.



## Quote #234772

### Description:

72" x 72" L-shape station. Wood bullnose edge on working side of worksurfaces. Radius keyboard tray, with wood bullnose edge on working side. Tray/Box/Box/File ped. Open shelf ped. 2 x 80mm cable entry grommets, 44" high barn door corner hutch and extension with laminate doors.

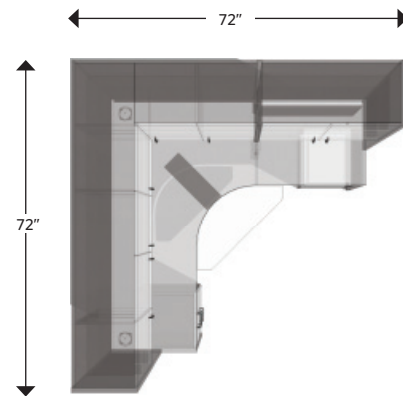

## Quote #234773

### Description:

72" x 84" L-shape station. 3mm PVC trim on working side of worksurfaces. 31" wide multi-file ped with lateral file drawer, 2 box drawers and letter file drawer. 40mm cable entry grommet, 38" high barn door hutch with organizer option, tackboard with accessory rail. 1" finished top for hutch with 3mm PVC trim on front edge.

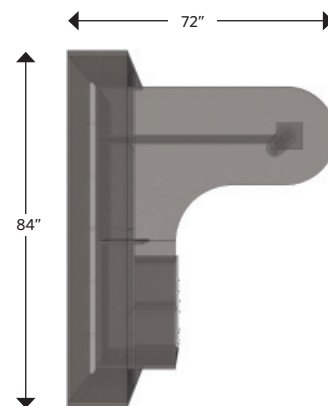

\*Shading is for creating 3D image only. Color choices can be made for the decor (body), door/drawer fronts, and worksurfaces/tops in any combination of our offered laminates.



## L-Shapes

---

### Quote #234774

#### Description:

78" x 78" L-shape station. Wood bullnose edge on working side, and on visitor side of main desk. Offset modesty panel on main desk. Box/Box/File and Storage peds. 23 3/4" pencil drawer, 2 x 40mm cable entry grommets, 38" high hutch - side door style with laminate framed clear glass. Fabric tackboard.

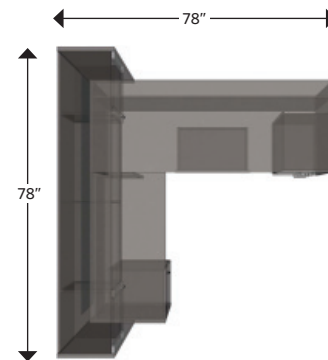

### Quote #234775

#### Description:

78" x 46" bow front executive corner desk with glass modesty panel. Straight cut on corner, 46" x 24" return. 30" Lateral File ped, Box/Box/File extended depth ped. 2 x 40mm cable entry grommets. 44" high storage hutch, aluminum framed etched glass doors, and organizer cubbies. Tackboard and accessory rail combination included.

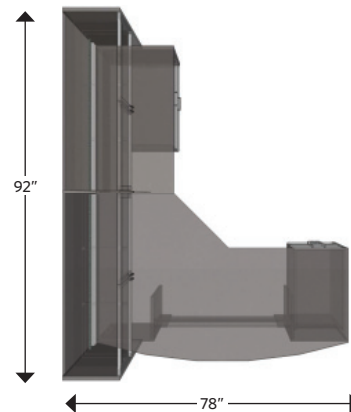

---

\*Shading is for creating 3D image only. Color choices can be made for the decor (body), door/drawer fronts, and worksurfaces/tops in any combination of our offered laminates.



## Quote #234776

### Description:

66" x 66" corner station, radius corner desk, 24" deep surfaces, self edge. Articulating radius corner keyboard tray. 80mm cable entry grommet. Box/Box/Box/Box ped and File/File ped. Open inside corner radius hutch, 38" high with barn door extensions left and right.

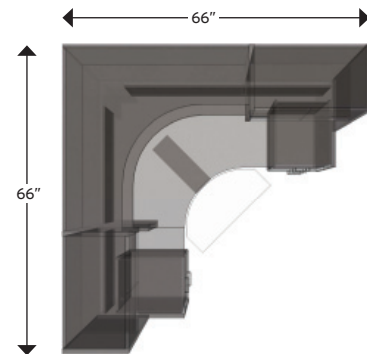

## Quote #234777

### Description:

72" x 38" mouse cut corner desk with 60" angled P-top return. Half modesty panels and self edge. 80mm cable entry grommet. Tray/Box/Box/File ped. Articulating rectangular keyboard tray. 38" high side door organizer hutch.

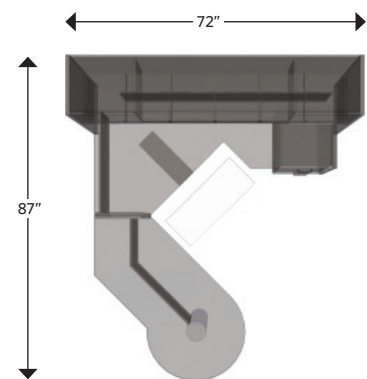

\*Shading is for creating 3D image only. Color choices can be made for the decor (body), door/drawer fronts, and worksurfaces/tops in any combination of our offered laminates.



## U-Shapes

---

### Quote #234778

**Description:**

72" x 99" x 72" U-shaped station. Self edge. D-top main desk. Box/File suspended pedestal. 38" high barn door hutch.

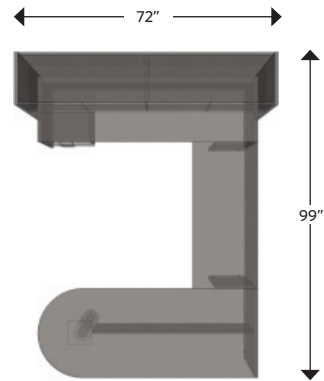

### Quote #234779

**Description:**

78" x 108" U-shaped station. Wood bullnose trim on worksurfaces. 72" corner P-top, 15" bridge, and 78" x 41" corner. Multi-file ped. Articulating keyboard tray with bullnose trim along front edge. 38" high hutch with aluminum etched glass doors. Tackboard and accessory rail combination included. 2 x 40mm cable entry grommets.

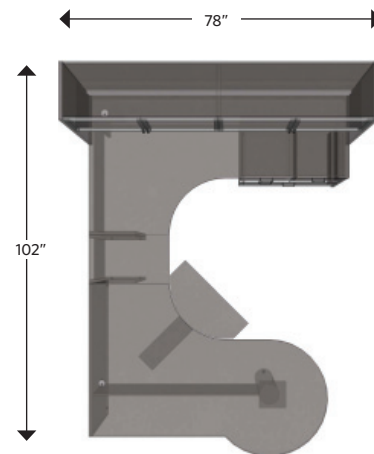

---

\*Shading is for creating 3D image only. Color choices can be made for the decor (body), door/drawer fronts, and worksurfaces/tops in any combination of our offered laminates.



## Quote #234780

### Description:

96" x 96" U-shaped station. 72" x 30" main desk, with offset full modesty panel and 3mm prestige wood trim on working and visitor sides. 42" x 21" bridge and 66" x 24" rear desk. Storage and Box/Box/File peds. 66" wide x 38" high storage hutch with flipper doors and organizer cubbies. 2 x 40mm cable grommets. Independent 30" wide lateral file and closed bookcase above can be separated from main station.

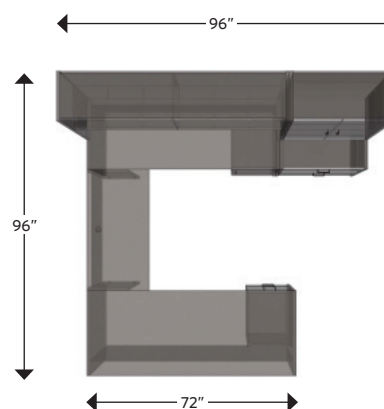

## Quote #234781

### Description:

96" x 100" x 72" U-shaped station. 72" rear desk with 24" radius desk/bookcase extension. 30" bridge and 72" x 46" corner D-top with full modesty panel and wood bullnose trim on working edge of all worksurfaces. 3 x 40mm cable entry grommets. 35" wide combo file ped. 72" x 44" high side door storage hutch with laminate framed clear glass. Connecting 44" high radius hutch extension. Paper management sorter for under hutch.

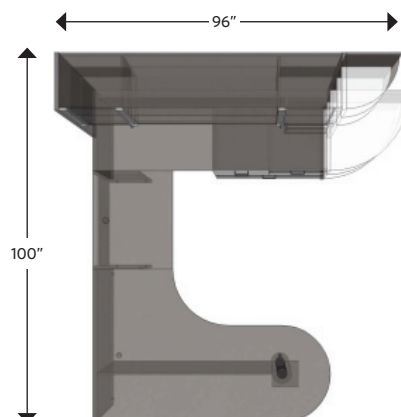

\*Shading is for creating 3D image only. Color choices can be made for the decor (body), door/drawer fronts, and worksurfaces/tops in any combination of our offered laminates.





## Executive Groupings

### Quote #234782

#### Description:

118" x 96" U-shaped station. Wave corner executive bow front desk with wood bullnose trim working and visitor sides, radius corner bridge desk, 80" rear shell. Articulating wave cut keyboard tray with cobra mechanism, with bullnose along front edge. 2 x 40mm and 1 x 80mm cable entry grommets, recessed power data module with data and voice jacks. File/File ped, Tray/Box/Box/File ped, 2 door storage cabinet. 44" high organizer hutch with barn doors and 4 x cubbie drawers. Tasklight. Aluminum framed etched glass door tower extension, with glass shelves and halogen lights built-in. 84" fabric tackboard and 1" finished tops with wood bullnose on hutches.

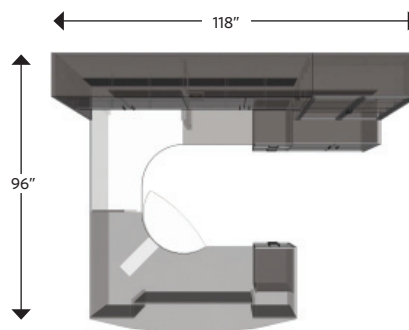

### Quote #234783

#### Description:

126" credenza/storage wall, with 84" x 42" rectangular executive desk with overhangs and floating glass modesty panel. 2 x extended depth Box/Box/File peds under main desk, 2 x standard Box/Box/File peds under credenza. 44" high aluminum framed etched glass door storage hutch. 74" high general storage units left and right, with filing on the bottom, open shelving in the middle and closed storage at the top. 2 x 40mm cable entry grommets. 1" finished tops with wood bullnose along front edge for hutch and storage units.

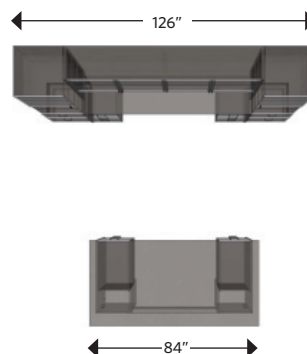

\*Shading is for creating 3D image only. Color choices can be made for the decor (body), door/drawer fronts, and worksurfaces/tops in any combination of our offered laminates.



## Quote #237727

### Description:

Corner reception station, extended radius corner with 2 x 54" returns at 45°. Overall width 144 1/4". Raised bowed transaction tops, low shaped center transaction. Rear 41" high storage showing aluminum framed glass doors and 3 high file cabinets. Solid wood bullnose edge on surfaces.

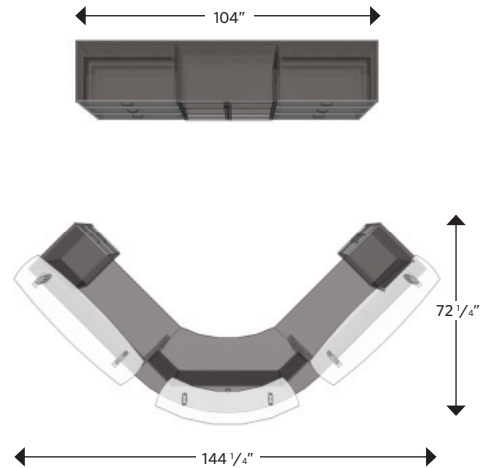
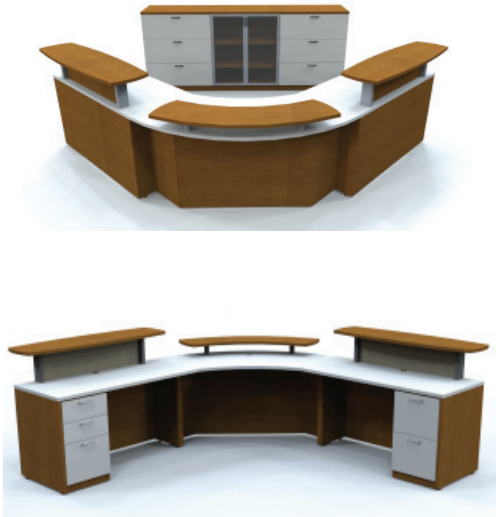

## Quote #237728

### Description:

Reception gallery station, U-shaped, 90" x 67" x 67". Bow front center top with glass on surface, accessibility transaction counter left, reception counter right. Organizer shelf under main top. Rear storage combines 54" high storage with 4 High filing in between. Box/Box/File pedestal and additional storage also included.

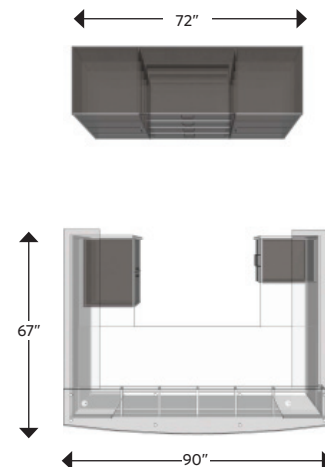

\*Shading is for creating 3D image only. Color choices can be made for the decor (body), door/drawer fronts, and worksurfaces/tops in any combination of our offered laminates.



## Reception Groupings

---

### Quote #237729

#### Description:

Three sided corner reception desk, 101" x 89". Radius corner worksurface, straight corner reception counter with translucent panels on corner. Tackable fabric inside reception counters, Tray/Box/Box/File and combo peds. 3mm Prestige wood edge on working side of desk, and on working and visitor's sides of counters.

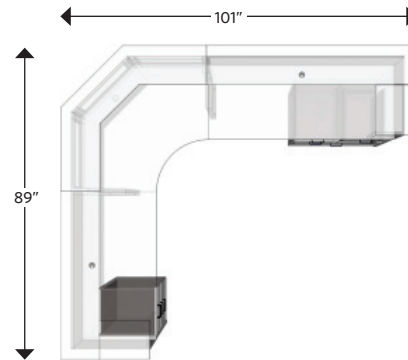

### Quote #237730

#### Description:

Three section reception desk. 72" x 48" x 27" at 45° angles. All three dimensions are variable in 1" increments from 30" to 84". One product code. Matching reception hutch with organizer spaces. Reception sorters fit nicely into the corners. Includes combo file and mobile Box/File pedestal. Solid wood bullnose edge on working and visitor sides.

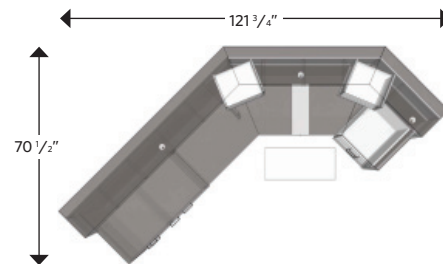
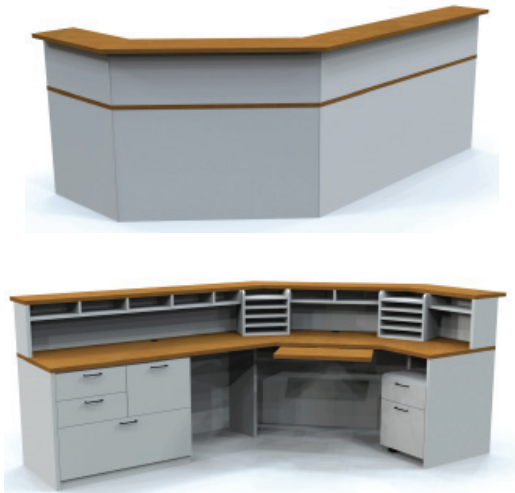

---

\*Shading is for creating 3D image only. Color choices can be made for the decor (body), door/drawer fronts, and worksurfaces/tops in any combination of our offered laminates.

## Quote #237735

### Description:

Racetrack table, 120" x 48", 2 5/8" thick, wood bullnose edge. Power modules included with rectangular slab base with wire management spacer. 35" high storage credenza and 54" x 48" visual presentation board complement the room.

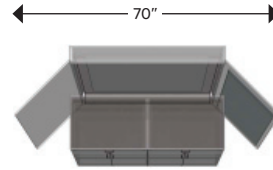

## Quote #237736

### Description:

Octagonal boardroom table, 168" x 54" with 2 5/8" top. Wood bullnose edge on all tops. Octagonal pedestal bases. Storage wall includes 35" closed storage and 74" high closed storage with credenza bridge top.

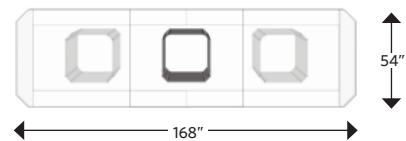
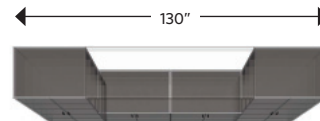

\*Shading is for creating 3D image only. Color choices can be made for the decor (body), door/drawer fronts, and worksurfaces/tops in any combination of our offered laminates.



# Mailrooms

Quote #237739

**Description:**  
Mailroom wall - 138 1/2" wide x 24" deep. 35" high banked storage and filing units, 44" high mailroom sorter and storage hutch.

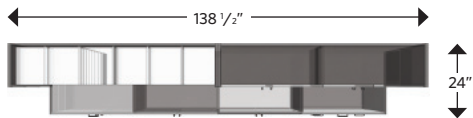

Quote #237740

**Description:**  
Corner mailroom grouping. 35" high multi-storage/filing combinations 105 3/4" x 105 3/4". 38" high mailroom sorter and radius corner hutch.

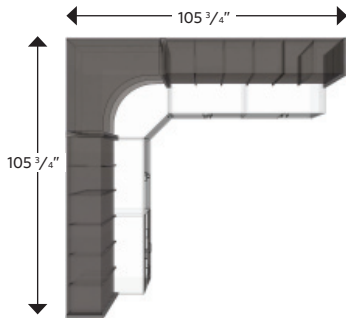

\*Shading is for creating 3D image only. Color choices can be made for the decor (body), door/drawer fronts, and worksurfaces/tops in any combination of our offered laminates.



## Quote #225349

### Description:

8 pack, back to back stations. Full laminate back and side panels, aluminum support posts on spine. Each station is 54" wide with 24" deep surfaces and 12" deep shelf. Mobile Box/File ped and one cable access grommet per station. 3mm PVC edge across front of worksurfaces. With simple laminate structure, this option has the lowest price point.

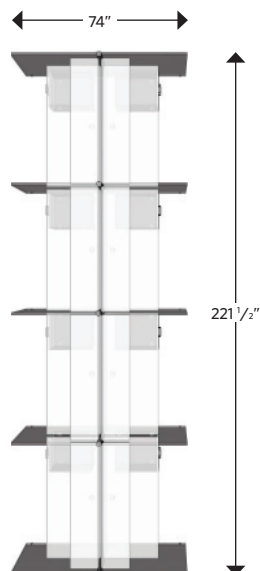

## Quote #240128

### Description:

MultiStations OS™ Aluminum framed call stations - for more elaborate designs. The MultiStations OS™ call centers offer additional components such as fabric, glass, accessory rail and markerboard in addition to laminate. This particular station features fabric and glass on wing panels, and fabric and laminate on spine panels. Each station is 54" wide x 24" deep x 57" high. 3mm PVC edge on surfaces. One mobile Box/File ped per person. Price points can vary significantly depending on which components are used on the panels.

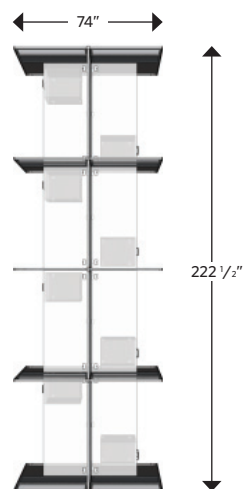

\*Shading is for creating 3D image only. Color choices can be made for the decor (body), door/drawer fronts, and worksurfaces/tops in any combination of our offered laminates.



## Quote #240338

### Description:

Two person station featuring split translucent glass and markerboard spine. Laminate and accessory rail on front panels, and metal ladder leg supports. Each station is 72" x 90". Box/Box/File pedestal for each user.

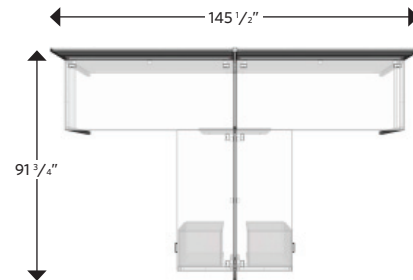

## Quote #240254

### Description:

Three person station, 120 degree surfaces. Laminate and accessory rail combination, 122 3/4" x 113 1/2" footprint. 42" x 42" surfaces with connected half round meeting tables supported by 2 1/2" post legs in aluminum finish. Mobile Box/File pedestals with cushion included.

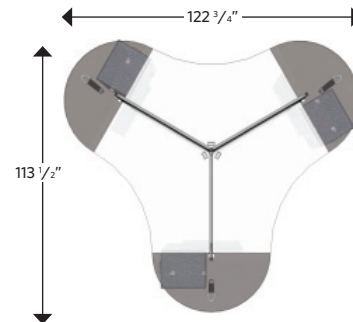

\*Shading is for creating 3D image only. Color choices can be made for the decor (body), door/drawer fronts, and worksurfaces/tops in any combination of our offered laminates.



Quote #256547

**Description:**

Eight person grouping - L-shaped stations, each is 78" x 60". One Box/Box/File per user. All laminate divider panels and laminate support legs help keep lower price point.

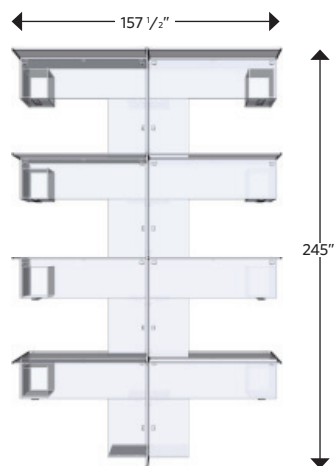

Quote #257646

**Description:**

Six person grouping - L shapes. Each station is 72" x 72" with 64" high panels. Box/Box/File pedestal each, overhead storage - 72" with barn doors. Clear glass on upper tile in front of each user, metal ladder legs for open look and feel. Tackable fabric on spine, 21" high.

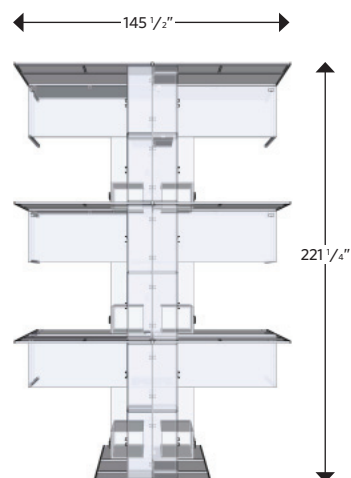

\*Shading is for creating 3D image only. Color choices can be made for the decor (body), door/drawer fronts, and worksurfaces/tops in any combination of our offered laminates.





## MultiStations OS™

### Quote 257647

#### Description:

Shared storage, 57" high. 36" wide lateral files, open storage next to worksurface with tackable back and mobile Box/File with cushion per user. Open metal ladder leg. 72" x 30" worksurfaces. Accessory rail and tackable fabric elements on the 57" high panel which connects to the storage end panel. Increased savings with multiple units.

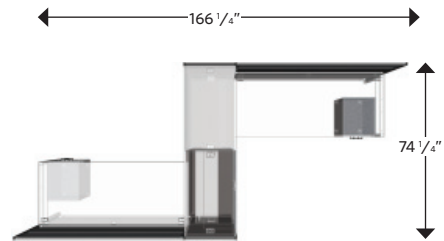

### Quote #232594

#### Description:

Six person grouping with two touch down stations. Shared storage between four users. Each person receives open/Box/Box/File storage and open cabinet, along with a tackable back. Accessory rail in front of each user. Mobile Box/File pedestals for temporary users.

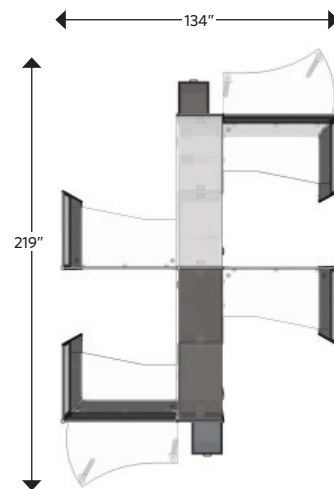

\*Shading is for creating 3D image only. Color choices can be made for the decor (body), door/drawer fronts, and worksurfaces/tops in any combination of our offered laminates.



**Quote #258599**

**Description:**

Manager's station includes 64" high panel with accessory rail and fabric, overhead storage, galley shaped main surface with square post legs. Low storage cabinets at 22" high for layered look. Filing and storage also included. Accessories include aluminum paper trays and pencil trays.

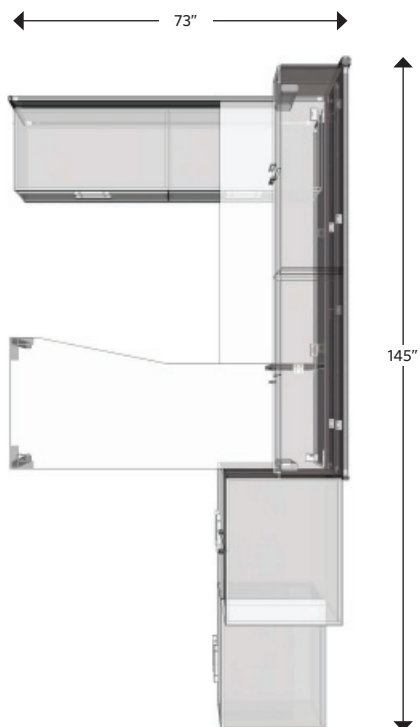

\*Shading is for creating 3D image only. Color choices can be made for the decor (body), door/drawer fronts, and worksurfaces/tops in any combination of our offered laminates.



MultiStations OS™

Quote #258600

**Description:**  
OS reception station incorporates different panel heights for privacy and style. 64" high panels support closed overhead bins, accessory rail/fabric/glass combination panel aisle side, 50" high translucent glass around main worksurface with 36" high counter to direct traffic to receptionist. Combo file ped included.

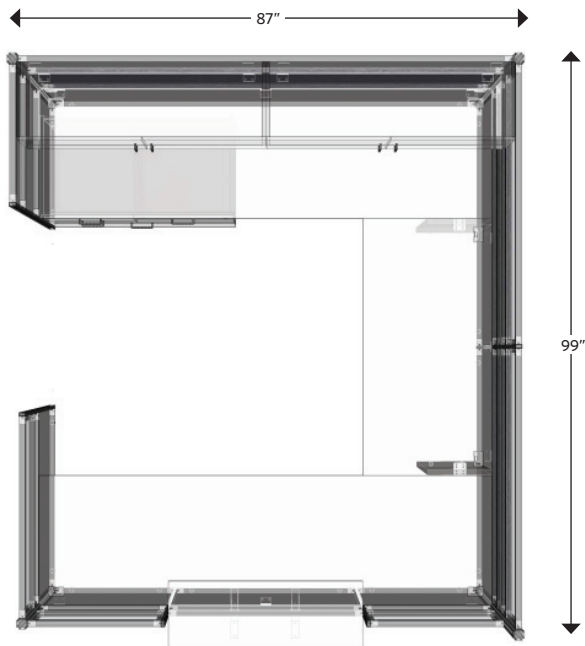

\*Shading is for creating 3D image only. Color choices can be made for the decor (body), door/drawer fronts, and worksurfaces/tops in any combination of our offered laminates.



Quote #258598

**Description:**

OS benching application, seamless surfaces divided by lower storage with seat cushion. Accessory rail and ladder legs for added aluminum components. Reverse side features low storage, OS Powerbox™ cable management, and standard surface for temporary users. Pricing includes 7wire, 3 circuit power, base feed.

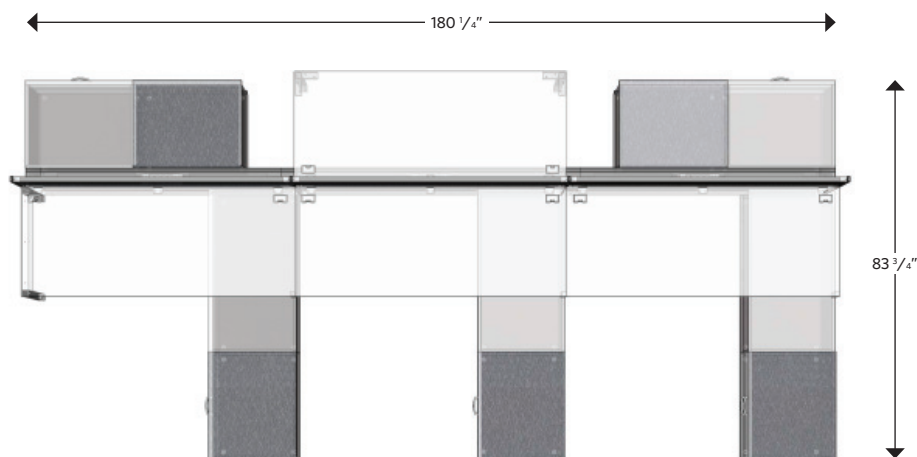

\*Shading is for creating 3D image only. Color choices can be made for the decor (body), door/drawer fronts, and worksurfaces/tops in any combination of our offered laminates.



## MultiStations OS™

Quote #258597

**Description:**

Four person workstation with 36" high panels, panel mounted shared storage bins, galley shaped worksurfaces with ladder legs and low storage bins with optional cushion. Accessory rail on spine and clear glass on divider panels. OS Powerbox™ cable management conceals wiring in this open design. Pricing includes power - 7 wire/3circuit via base feed.

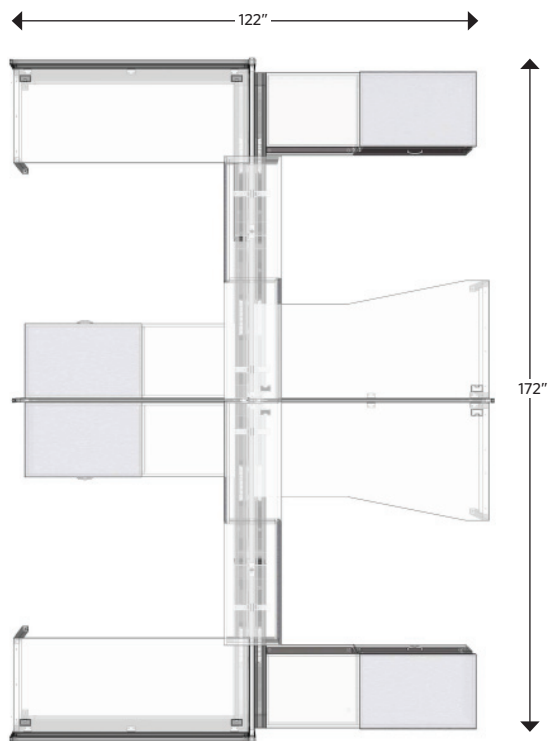

\*Shading is for creating 3D image only. Color choices can be made for the decor (body), door/drawer fronts, and worksurfaces/tops in any combination of our offered laminates.





Three H Furniture Systems Limited  
156462 Clover Valley Rd.  
New Liskeard, ON  
Canada POJ 1P0

T. 1.800.767.5374  
F. 1.888.484.5786

[customer.service@three-h.com](mailto:customer.service@three-h.com)  
[www.three-h.com](http://www.three-h.com)